



APC Easy Rack Double Mounting Bracket Kit Installation Guide

[Home](#) » [APC](#) » APC Easy Rack Double Mounting Bracket Kit Installation Guide

APC Easy Rack Double Mounting Bracket Kit Installation Guide







Contents [[hide](#)]

- [1 Kit Instructions](#)
- [2 Install the cage nut:](#)
- [3 Remove the cage nut:](#)
- [4 Install the Mounting Brackets:](#)
- [5 Documents / Resources](#)
 - [5.1 References](#)
- [6 Related Posts](#)

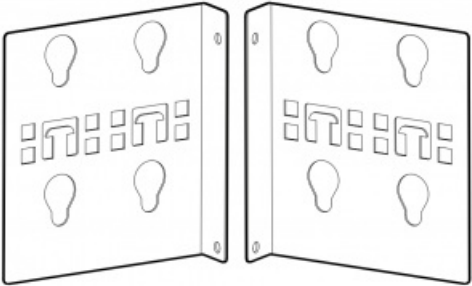
Kit Instructions

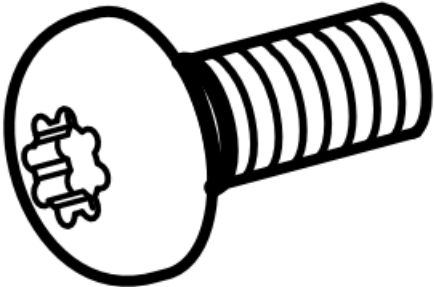
The Double Mounting Brackets are used to mount Rack PDUs or other equipment to the vertical mounting rails inside the rack. The location of the Mounting Brackets depends on the equipment you want to install. The Mounting Brackets have cut outs to accommodate the toolless mounting pegs of your Rack PDUs.

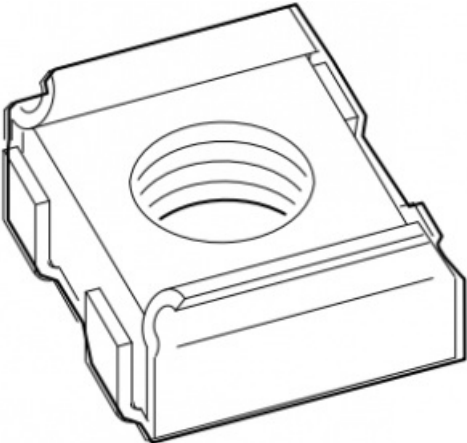
ER7PDUBRKT Inventory	Tools required (not provided)
 <p data-bbox="212 533 699 566">Single PDU Bracket (2 Left and 2 Right)</p>	 <p data-bbox="1054 472 1222 506">Torx® wrench</p>
 <p data-bbox="244 949 663 983">Screw M6 x 12 Pan Head T30 (40)</p>	 <p data-bbox="1058 918 1225 952">Cage nut tool</p>
 <p data-bbox="272 1523 643 1556">Cage Nut M6 14/16 SWG (40)</p>	

Proper location in the rack for the cage nuts:

1. Locate the top and bottom U space on the vertical mounting rails. Every third hole on the mounting rails is numbered to indicate the middle of a U space.
2. Install the cage nuts on the interior of the vertical mounting rail; then install the shelf.

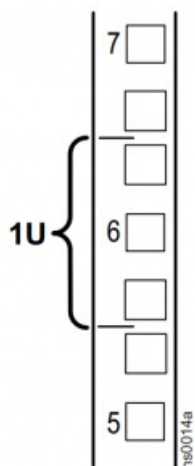

CAUTION

FALLING EQUIPMENT HAZARD

Do NOT install cage nuts vertically with the tabs engaging the top and bottom of the square hole.

Failure to follow these instructions can result in injury or equipment damage.

- Install cage nuts horizontally, with the tabs engaging the sides of the square hole.
- Install the cage nuts on the interior of the vertical mounting rail.



Install the cage nut:

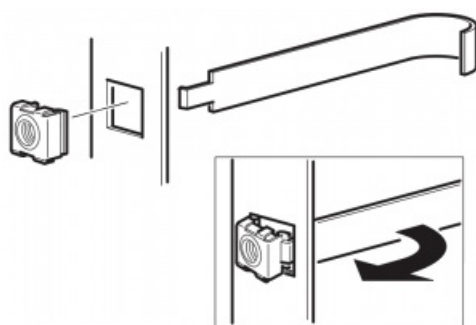

1. From the inside of the rack, insert the cage nut into the square hole.
2. Hook one tab of the cage nut assembly through the far side of the hole.
3. Place the cage nut tool on the other side of the cage nut and pull to snap into position.

Remove the cage nut:

1. Remove any attached screw.
2. Grasp the cage nut, squeeze the tabs on the sides, and push to release it from the square hole

Install the Mounting Brackets:

Using the hardware provided, install the Mounting Brackets in the location where you plan to install your Rack PDU or other equipment. There are four Mounting Brackets in the Kit; two (2) for the left side of the rack and two (2) for the right side of the rack.

Make sure to position the Mounting Brackets so that the small end of the cut out is at the bottom so the toolless mounting peg of a Rack PDU installs securely.

The Easy Rack in the illustration is shown without doors or side panels for clarity.

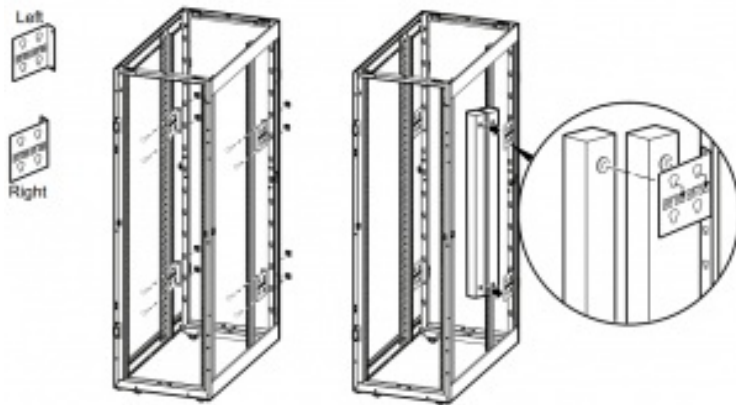

APC by Schneider Electric 70 Mechanic Street 02035 Foxboro, MA USA

WEB: www.apc.com

Documents / Resources

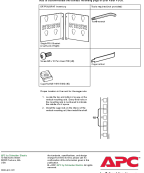
	<p>APC Easy Rack Double Mounting Bracket Kit [pdf] Installation Guide APC, Schneider, ER7PDUBRKT, Bracket Kit</p>
---	---

References

- [APC, a flagship brand of Schneider Electric - APC USA](#)