



AOC G2 24G2ZU/BK FHD Gaming Monitor User Manual

[Home](#) » [AOC](#) » AOC G2 24G2ZU/BK FHD Gaming Monitor User Manual 

Contents

- [1 AOC G2 24G2ZU/BK FHD Gaming Monitor](#)
- [2 Safety](#)
- [3 Setup](#)
- [4 Adjusting Viewing Angle](#)
- [5 Adjusting](#)
- [6 Specification](#)
- [7 Preset Display Modes](#)
- [8 Pin Assignments](#)
- [9 Plug and Play](#)
- [10 Frequently Ask Questions](#)
- [11 Related Posts](#)



AOC G2 24G2ZU/BK FHD Gaming Monitor



Safety

National Conventions

The following subsections describe the notational conventions used in this document.

Notes, Cautions, and Warnings

Throughout this guide, blocks of text may be accompanied by an icon and printed in bold type or in italic type. These blocks are notes, cautions, and warnings, and they are used as follows:

- **NOTE:** A NOTE indicates important information that helps you make better use of your computer system.
- **CAUTION:** A CAUTION indicates either potential damage to hardware or loss of data and tells you how to avoid the problem.
- **WARNING:** A WARNING indicates the potential for bodily harm and tells you how to avoid the problem. Some warnings may appear in alternate formats and may be unaccompanied by an icon. In such cases, the specific presentation of the warning is mandated by a regulatory authority.

Power

- The monitor should be operated only from the type of power source indicated on the label. If you are not sure of the type of power supplied to your home, consult your dealer or local power company.
- The monitor is equipped with a three-pronged grounded plug and a plug with a third (grounding) pin. This plug will fit only into a grounded power outlet as a safety feature. If your outlet does not accommodate the three-wire plug, have an electrician install the correct outlet, or use an adapter to ground the appliance safely. Do not defeat the safety purpose of the grounded plug.
- Unplug the unit during a lightning storm or when it will not be used for long periods of time. This will protect the monitor from damage due to power surges.
- Do not overload power strips and extension cords. Overloading can result in fire or electric shock.
- To ensure satisfactory operation, use the monitor only with UL-listed computers which have appropriate configured receptacles marked between 100-240V AC, Min. 5A.
- The wall socket shall be installed near the equipment and shall be easily accessible.

Installation

- Do not place the monitor on an unstable cart, stand, tripod, bracket, or table. If the monitor falls, it can injure a person and cause serious damage to this product. Use only a cart, stand, tripod, bracket, or table recommended by the manufacturer or sold with this product. Follow the manufacturer's instructions when installing the product and use mounting accessories recommended by the manufacturer. A product and cart combination should be moved with care.
- Never push any object into the slot on the monitor cabinet. It could damage circuit parts causing a fire or electric shock. Never spill liquids on the monitor.
- Do not place the front of the product on the floor.
- If you mount the monitor on a wall or shelf, use a mounting kit approved by the manufacturer and follow the kit instructions.
- Leave some space around the monitor as shown below. Otherwise, air circulation may be inadequate hence overheating may cause a fire or damage to the monitor.

See below the recommended ventilation areas around the monitor when the monitor is installed on the wall or on the stand:

Installed with stand

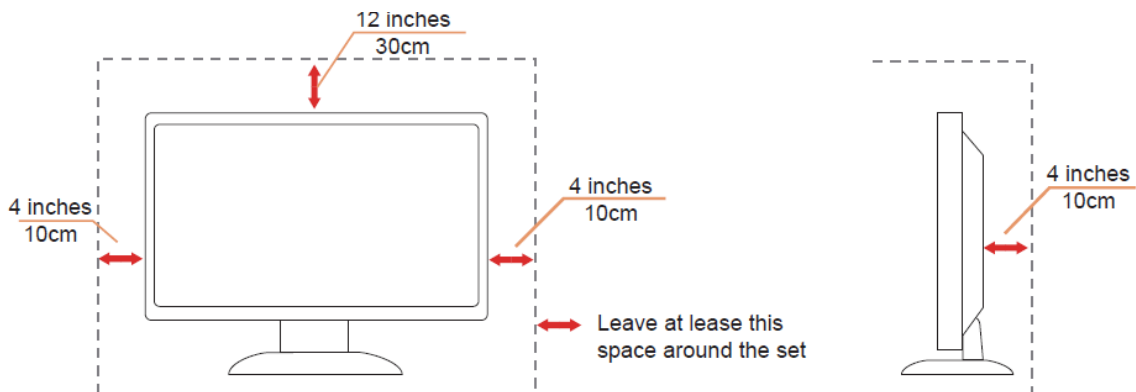

Cleaning

- Clean the cabinet regularly with a cloth. You can use soft detergent to wipe out the stain, instead of strong detergent which will cauterize the product cabinet.
- When cleaning, make sure no detergent is leaked into the product. The cleaning cloth should not be too rough as it will scratch the screen surface.
- Please disconnect the power cord before cleaning the product.



Other

- If the product is emitting a strange smell, sound, or smoke, disconnect the power plug IMMEDIATELY and contact a Service Center.
- Make sure that the ventilating openings are not blocked by a table or curtain.
- Do not engage the LCD monitor in severe vibration or high-impact conditions during operation.
- Do not knock or drop the monitor during operation or transportation.

Setup

Contents in Box

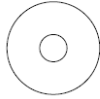

CD Manual

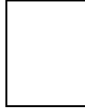

Warranty Card



Stand



Base



Power Cable



DP Cable



HDMI Cable



USB Cable

Not all signal cables (DP, HDMI, USB cables) will be provided for all countries and regions. Please check with the local dealer or AOC branch office for confirmation.

Setup Stand & Base

Please set up or remove the base by following the steps as below.

Setup

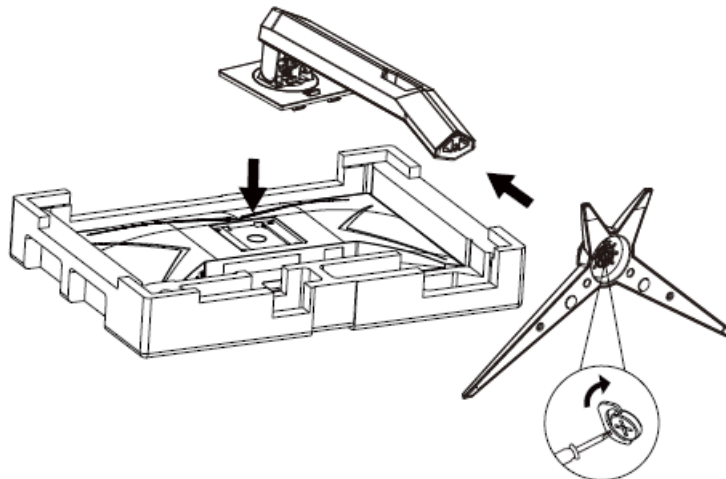

Remove

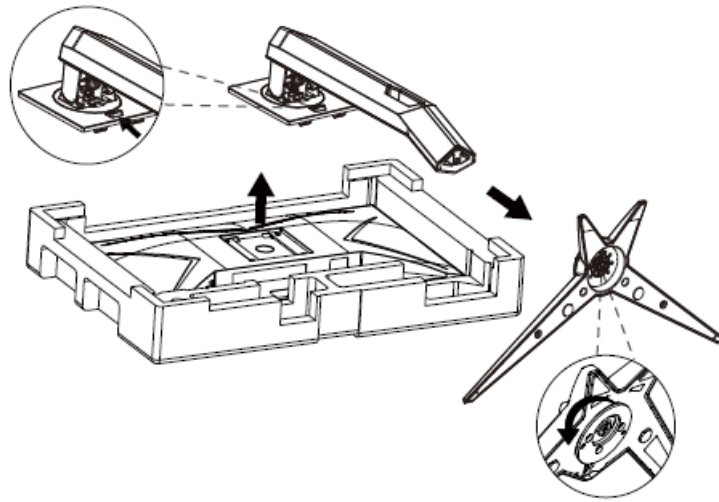

Adjusting Viewing Angle

For optimal viewing it is recommended to look at the full face of the monitor, then adjust the monitor's angle to your own preference.

Hold the stand so you will not topple the monitor when you change the monitor's angle.

You are able to adjust the monitor as below:

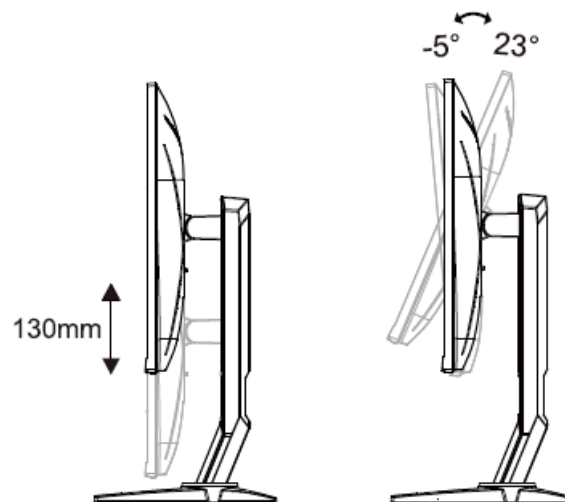

NOTE:

Do not touch the LCD screen when you change the angle. It may cause damage or break the LCD screen.

Connecting the Monitor

Cable Connections In Back of Monitor and Computer:

24G2Z

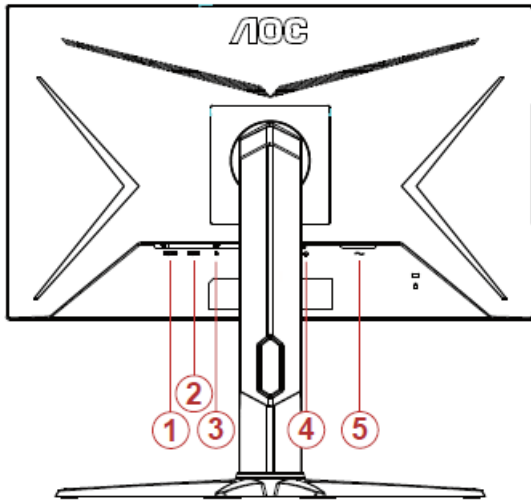

24G2ZU

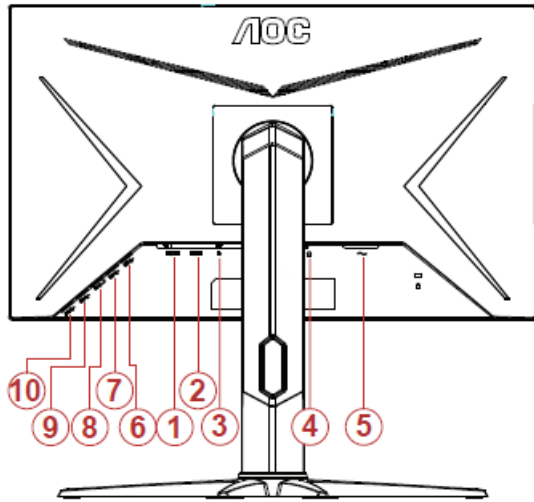

1. HDMI-2
2. HDMI-1
3. DP
4. Earphone
5. Power
6. USB-PC upstream
7. USB 3.2 Gen 1
8. USB 3.2 Gen1+Quick Charging
9. USB 3.2 Gen 1
10. USB 3.2 Gen 1

Connect to PC

1. Connect the power cord to the back of the display firmly.
2. Turn off your computer and unplug its power cable.
3. Connect the display signal cable to the video connector on the back of your computer.
4. Plug the power cord of your computer and your display into a nearby outlet.
5. Turn on your computer and display.

If your monitor displays an image, installation is complete. If it does not display an image, please refer to Troubleshooting. To protect equipment, always turn off the PC and LCD monitor before connecting.

Wall Mounting

Preparing to Install An Optional Wall Mounting Arm.

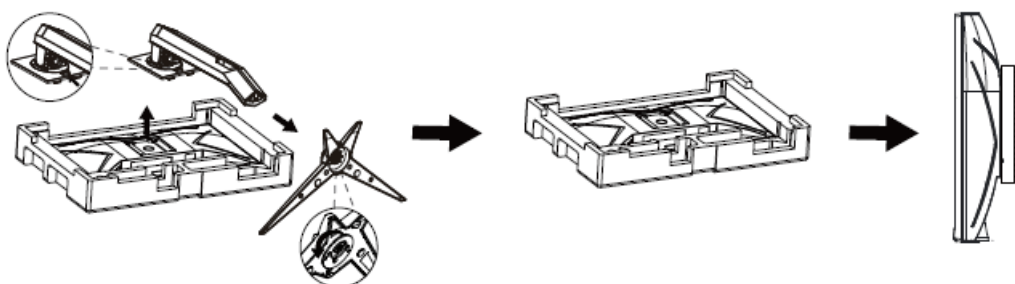

This monitor can be attached to a wall mounting arm you purchase separately. Disconnect power before this procedure. Follow these steps

1. Remove the base.
2. Follow the manufacturer's instructions to assemble the wall mounting arm.
3. Place the wall mounting arm onto the back of the monitor. Line up the holes of the arm with the holes in the back of the monitor.
4. Reconnect the cables. Refer to the user's manual that came with the optional wall mounting arm for instructions on attaching it to the wall.

Noted: VESA mounting screw holes are not available for all models, please check with the dealer or official department of AOC.

Adaptive sync function

1. The adaptive sync function is working with DP/HDMI
2. Compatible Graphics Card: Recommend list is as the below
 - Radeon™ RX Vega series
 - Radeon™ RX 500 series
 - Radeon™ RX 400 series
 - Radeon™ R9/R7 300 series R9 370/X, R7 370/X, R7 265 except
 - Radeon™ Pro Duo (2016)
 - Radeon™ R9 Nano series
 - Radeon™ R9 Fury series
 - Radeon™ R9/R7 200 series (R9 270/X, R9 280/X except)

Adjusting

Hotkeys

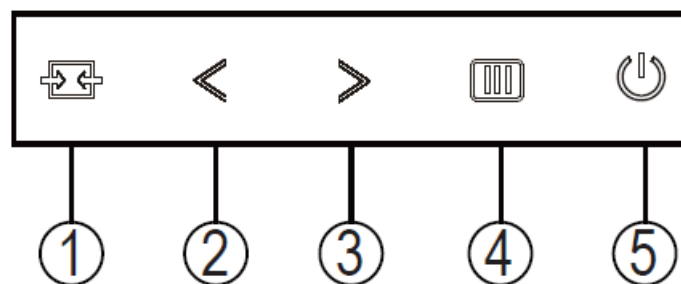

1. Source/Exit
2. Game Mode/<
3. Dial Point/>
4. Menu/Enter
5. Power

- **Power**

Press the Power button to turn on the monitor.

- **Menu/Enter**

When there is no OSD, Press to display the OSD or confirm the selection.

- **Game Mode/<**

When there is no OSD, press the "<" key to open the game mode function, then press the "<" or ">" key to select game mode (FPS, RTS, Racing, Gamer 1, Gamer 2 or Gamer 3) based on the different game types.

- **Dial Point/>**

When there is no OSD, press the Dial Point button to show/hide Dial Point.

- **Source/Exit**

When the OSD is closed, pressing the Source/Exit button will be Source hot key function.

OSD Setting

Basic and simple instructions on the control keys.











1. Press the MENU button to activate the OSD window.
2. Press < or > to navigate through the functions. Once the desired function is highlighted, press the MENU button to activate it, and press < or > to navigate through the sub-menu functions. Once the desired function is highlighted, press the MENU button to activate it.
3. Press < or > to change the settings of the selected function. Press the AUTO-button to exit. If you want to adjust any other function, repeat steps 2-3.
4. OSD Lock Function: To lock the OSD, press and hold the MENU button while the monitor is off and then press the power button to turn the monitor on. To un-lock the OSD – press and hold the MENU button while the monitor is off and then press the power button to turn the monitor on.

Notes:

1. If the product has only one signal input, the item of "Input Select" is disabled to adjust.
2. DCR, Color Boost, and Picture Boost, for these states that only one state can exist

Luminance



	Contrast	0-100		Contrast from Digital-register.
	Brightness	0-100		Backlight Adjustment
	Eco mode	Standard		Standard Mode
		Text		Text Mode
		Internet		Internet Mode
		Game		Game Mode
		Movie		Movie Mode
		Sports		Sports Mode
		Reading		Reading Mode
	Gamma	Gamma1		Adjust to Gamma 1
		Gamma2		Adjust to Gamma 2
		Gamma3		Adjust to Gamma 3
	DCR	Off		Disable dynamic contrast ratio
		On		Enable dynamic contrast ratio
	HDR Mode	OFF		Adjust HDR Mode.
		HDR Picture		
		HDR Movie		
		HDR Game		

Color Setup

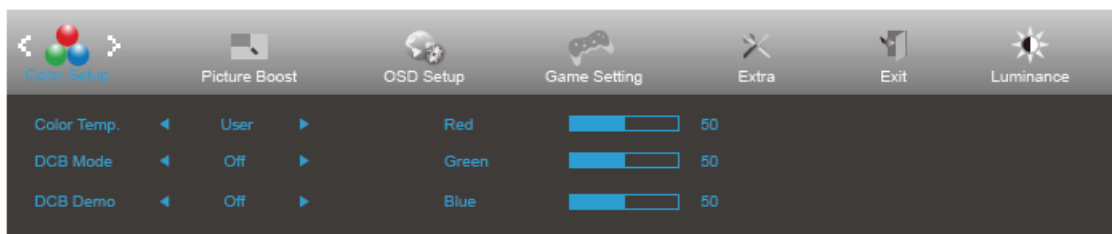



	Color Temp.	Warm		Recall Warm Color Temperature from EEPROM.
		Normal		Recall Normal Color Temperature from EEPROM.
		Cool		Recall Cool Color Temperature from EEPROM.
		sRGB		Recall SRGB Color Temperature from EEPROM.
		User	Red	Red Gain from Digital-register
			Green	Green Gain Digital-register.
			Blue	Blue Gain from Digital-register
	DCB Mode	Full Enhance	on or off	Disable or Enable Full Enhance Mode
		Nature Skin	on or off	Disable or Enable Nature Skin Mode
		Green Field	on or off	Disable or Enable Green Field Mode
		Sky-blue	on or off	Disable or Enable Sky-blue Mode
		Auto Detect	on or off	Disable or Enable AutoDetect Mode
		OFF	on or off	Disable or Enable OFF Mode
	DCB Demo		on or off	Disable or Enable Demo
	Red		0-100	Red gain from Digital-register.
	Green		0-100	Green gain from Digital-register.
	Blue		0-100	Blue gain from Digital-register.

Picture Boost

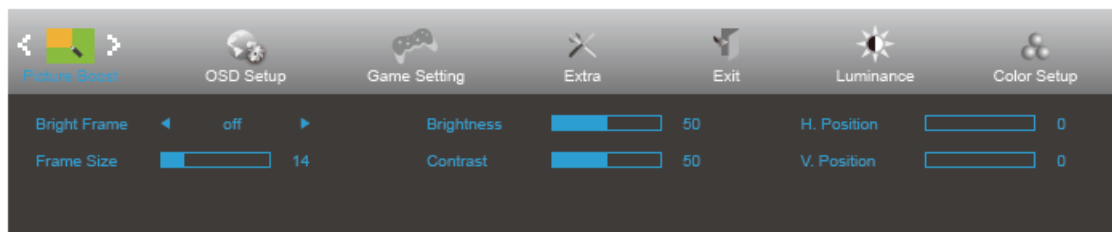



	Bright Frame	on or off	Disable or Enable Bright Frame
	Frame Size	14-100	Adjust Frame Size
	Brightness	0-100	Adjust Frame Brightness
	Contrast	0-100	Adjust Frame Contrast
	H. position	0-100	Adjust Frame horizontal Position
	V. position	0-100	Adjust Frame vertical Position

Note:

Adjust the brightness, contrast, and position of the Bright Frame for a better viewing experience.

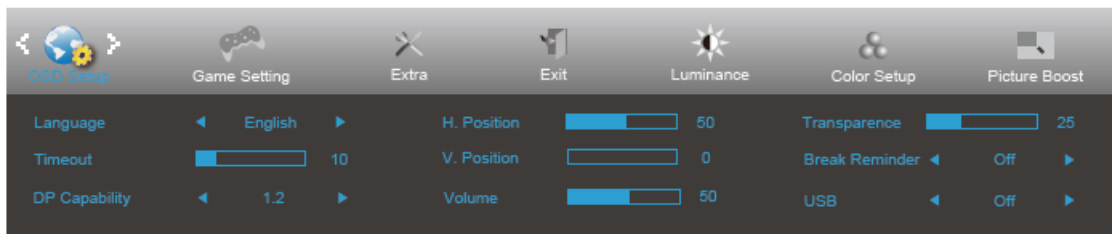
OSD Setup





	Language		Select the OSD language
	Timeout	5-120	Adjust the OSD Timeout
	DP Capability	1.1/1.2	Please be noted that only DP1.2 support Adaptive sync function
	H. Position	0-100	Adjust the horizontal position of OSD
	V. Position	0-100	Adjust the vertical position of OSD
	Volume	0-100	Volume Adjustment.
	Transparence	0-100	Adjust the transparence of OSD
	Break Reminder	on or off	Break reminder if the user continuously work for more than 1hrs
	USB (24G2ZU)	on or off	USB on or off

Note:

If the DP video content supports DP1.2, please select DP1.2 for DP Capability; otherwise, please select DP1.1

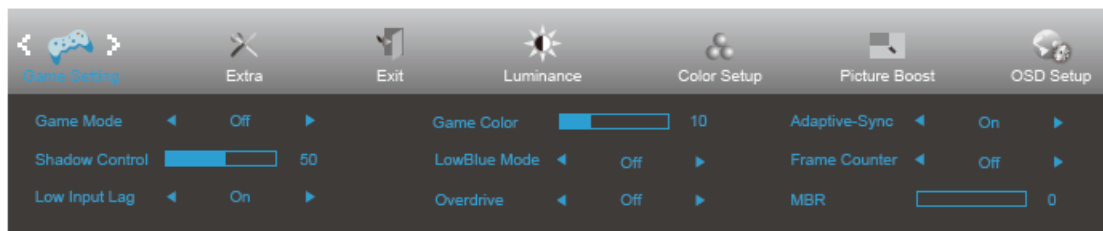
Game Setting





	Game Mode	FPS	For playing FPS (first Person Shooters) games. Improves dark theme black level details.
		RTS	For playing RTS (Real Time Strategy). Improves the image quality.
		Racing	For playing Racing games, Provides fastest response time and high color saturation.
		Gamer 1	User's preference settings saved as Gamer 1.
		Gamer 2	User's preference settings saved as Gamer 2.
		Gamer 3	User's preference settings saved as Gamer 3.
		off	No optimization by Smart image game
	Shadow Control	0-100	Shadow Control Default is 50, then end-user can adjust from 50 to 100 or 0 to increase contrast for clear picture. 1. If picture is too dark to be saw the detail clearly, adjusting from 50 to 100 for clear picture. 2. If picture is too white to be saw the detail clearly, adjusting from 50 to 0 for clear picture
	Low Input Lag	On/Off	Turn off frame buffer to decrease input lag
	Game Color	0-20	Game Color will provide 0-20 level for adjusting saturation to get better picture.
	Low Blue Mode	Reading / Office / Internet / Multimedia / Off	Decrease blue light wave by controlling color temperature.
	Overdrive	Weak	Adjust the response time.
		Medium	
		Strong	
		Boost	
		Off	
	Adaptive-Sync	On/Off	Adjust the Adaptive-Sync.
	Frame Counter	Off / Right-up / Right-Down / Left-Down / Left-Up	Display V frequency on the corner selected
	MBR	0 ~ 20	Adjust the Motion Blur Reduction.

Note:

The function MBR and Overdrive Boost are available only when Adaptive sync is off and the vertical frequency is up to 75 Hz.

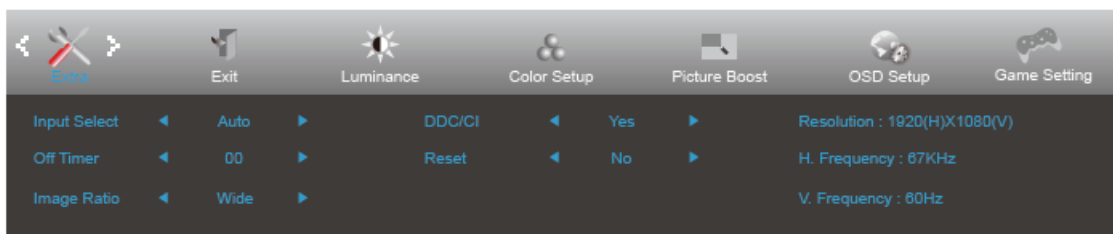
Extra



	Input Select		Select Input Signal Source
	Off timer	0-24hrs	Select DC off time
	Image Ratio	Wide	Select image ratio for display.
		4:3	
		1:1	
		17" (4:3)	
		19" (4:3)	
		19"W (16:10)	
		21.5"W (16:9)	
		23"W (16:9)	
	DDC/CI	yes or no	Turn ON/OFF DDC/CI Support
	Reset	Yes or no	Reset the menu to default. (ENERGY STAR® available for selective models.)
		ENERGY STAR® / no	

Exit

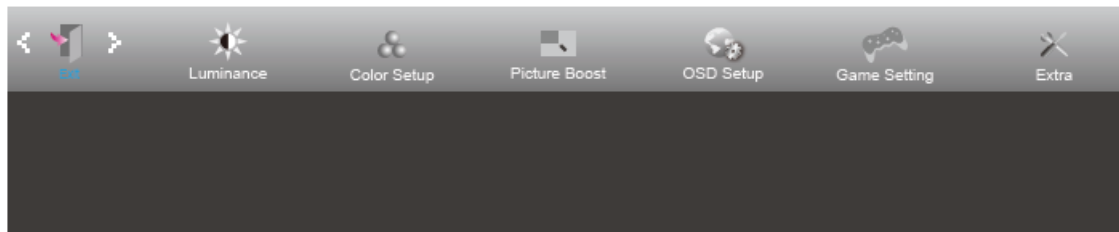

	Exit		Exit the main OSD
---	------	--	-------------------

LED Indicator

Status	LED Color
Full Power Mode	White
Active-off Mode	Orange

Problem & Question	Possible Solutions
Power LED Is Not ON	Make sure the power button is ON and the Power Cord is properly connected to a grounded power outlet and to the monitor.

<p>No images on the screen</p>	<p>Is the power cord connected properly?</p> <p>Check the power cord connection and power supply. Is the cable connected correctly?</p> <p>(Connected using the VGA cable) Check the VGA cable connection. (Connected using the HDMI cable) Check the HDMI cable connection. (Connected using the DP cable) Check the DP cable connection.</p> <p>* VGA/HDMI/DP input is not available on every model.</p> <p>If the power is on, reboot the computer to see the initial screen (the login screen), which can be seen.</p> <p>If the initial screen (the login screen) appears, boot the computer in the applicable mode (the safe mode for Windows 7/8/10) and then change the frequency of the video card.</p> <p>(Refer to the Setting the Optimal Resolution)</p> <p>If the initial screen (the login screen) does not appear, contact the Service Center or your dealer.</p> <p>Can you see "Input Not Supported" on the screen?</p> <p>You can see this message when the signal from the video card exceeds the maximum resolution and frequency that the monitor can handle properly.</p> <p>Adjust the maximum resolution and frequency that the monitor can handle properly.</p> <p>Make sure the AOC Monitor Drivers are installed.</p>
<p>Picture Is Fuzzy & Has Ghosting Shadowing Problem</p>	<p>Adjust the Contrast and Brightness Controls. Press to auto adjust.</p> <p>Make sure you are not using an extension cable or switch box. We recommend plugging the monitor directly to the video card output connector on the back.</p>
<p>Picture Bounces, Flickers Or Wave Pattern Appears In The Picture</p>	<p>Move electrical devices that may cause electrical interference as far away from the monitor as possible.</p> <p>Use the maximum refresh rate your monitor is capable of at the resolution you are using.</p>

Monitor Is Stuck In Active Off-Mode”	<p>The Computer Power Switch should be in the ON position.</p> <p>The Computer Video Card should be snugly fitted in its slot.</p> <p>Make sure the monitor’s video cable is properly connected to the computer. Inspect the monitor’s video cable and make sure no pin is bent.</p> <p>Make sure your computer is operational by hitting the CAPS LOCK key on the keyboard while observing the CAPS LOCK LED. The LED should either turn ON or OFF after hitting the CAPS LOCK key.</p>
Missing one of the primary colors (RED, GREEN, or BLUE)	Inspect the monitor’s video cable and make sure that no pin is damaged. Make sure the monitor’s video cable is properly connected to the computer.
Screen image is not centered or sized properly	Adjust H-Position and V-Position or press hot-key (AUTO).
Picture has color defects (white does not look white)	Adjust RGB color or select desired color temperature.
Horizontal or vertical disturbances on the screen	Use Windows 7/8/10 shut-down mode to adjust CLOCK and FOCUS. Press to auto-adjust.
Regulation & Service	Please refer to Regulation & Service Information which is in the CD manual or www.aoc.com (to find the model you purchase in your country and to find Regulation & Service Information on the Support page.)

Specification

General Specification

Panel	Model name	24G2Z / 24G2ZU/BK / 24G2ZU
	Driving system	TFT Color LCD
	Viewable Image Size	60.5 cm diagonal
	Pixel pitch	0.2745mm(H) x 0.2745mm(V)
	Video	HDMI Interface & DP Interface
	Separate Sync.	H/V TTL
	Display Color	16.7M Colors
	Horizontal scan range	30k-280kHz
	Horizontal scan Size(Maximum)	527.04 mm
	Vertical scan range	48-240Hz
	Vertical Scan Size(Maximum)	296.46 mm

Others	Optimal preset resolution	1920×1080@60Hz	
	Max resolution	1920×1080@240Hz	
	Plug & Play	VESA DDC2B/CI	
	Input Connector	HDMI×2/DP	
	Input Video Signal	Analog: 0.7Vp-p(standard), 75 OHM, TMDS	
	Output Connector	Earphone out	
	Power Source	100-240V~, 50/60Hz,1.5A	
	Power Consumption	Typical(Brightness = 50,Contrast = 50)	25W (24G2Z) 26W (24G2ZU)
		Max. (brightness = 100, contrast =100)	≤ 46W (24G2Z) 80W (24G2ZU)
		Standby mode	≤ 0.3W
Physical Characteristics	Connector Type	HDMI/DP/Earphone out	
	Signal Cable Type	Detachable	
Environmental	Temperature	Operating	0°~ 40°
		Non-Operating	-25°~ 55°
	Humidity	Operating	10% ~ 85% (non-condensing)
		Non-Operating	5% ~ 93% (non-condensing)
	Altitude	Operating	0~ 5000 m (0~ 16404ft)
		Non-Operating	0~ 12192m (0~ 40000ft)

Preset Display Modes

STANDARD	RESOLUTION	HORIZONTAL FREQUENCY(kHz)	VERTICAL FREQUENCY(Hz)
VGA	640×480@60Hz	31.469	59.94
VGA	640×480@72Hz	37.861	72.809
VGA	640×480@75Hz	37.5	75
VGA	640×480@100Hz	50.313	99.826
VGA	640×480@120Hz	60.938	119.72
SVGA	800×600@56Hz	35.156	56.25

SVGA	800×600@60Hz	37.879	60.317
SVGA	800×600@72Hz	48.077	72.188
SVGA	800×600@75Hz	46.875	75
SVGA	800×600@100Hz	62.76	99.778
SVGA	800×600@120Hz	76.302	119.972
XGA	1024×768@60Hz	48.363	60.004
XGA	1024×768@70Hz	56.476	70.069
XGA	1024×768@75Hz	60.023	75.029
XGA	1024×768@100Hz	80.448	99.811
XGA	1024×768@120Hz	97.551	119.989
SXGA	1280×1024@60Hz	63.981	60.02
SXGA	1280×1024@75Hz	79.976	75.025
WXGA+	1440×900@60Hz	55.935	59.887
WXGA+	1440×900@60Hz	55.469	59.901
WSXGA	1680×1050@60Hz	65.29	59.954
WSXGA	1680×1050@60Hz	64.674	59.883
FHD	1920×1080@60Hz	67.5	60
FHD	1920×1080@100Hz	113	100
FHD	1920×1080@120Hz	135	120
FHD	1920×1080@144Hz	136	145
FHD	1920×1080@240Hz	275	240
IBM MODES			
DOS	640×350@70Hz	31.469	70.087
DOS	720×400@70Hz	31.469	70.087
MAC MODES			
VGA	640×480@67Hz	35	66.667
SVGA	832×624@75Hz	49.725	74.551
XGA	1024×768@75Hz	60.241	74.927

Pin Assignments



19-Pin Color Display Signal Cable

Pin No.	Signal Name	Pin No.	Signal Name	Pin No.	Signal Name
1.	TMDS Data 2+	9.	TMDS Data 0-	17.	DDC/CEC Ground
2.	TMDS Data 2 Shield	10.	TMDS Clock +	18.	+5V Power
3.	TMDS Data 2-	11.	TMDS Clock Shield	19.	Hot Plug Detect
4.	TMDS Data 1+	12.	TMDS Clock-		
5.	TMDS Data 1Shield	13.	CEC		
6.	TMDS Data 1-	14.	Reserved (N.C. on device)		
7.	TMDS Data 0+	15.	SCL		
8.	TMDS Data 0 Shield	16.	SDA		

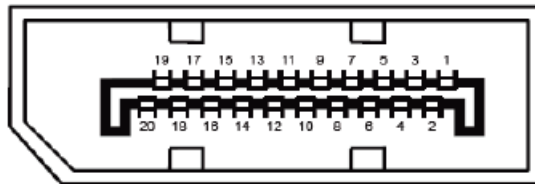

20-Pin Color Display Signal Cable

Pin No.	Signal Name	Pin No.	Signal Name
1	ML_Lane 3 (n)	11	GND
2	GND	12	ML_Lane 0 (p)
3	ML_Lane 3 (p)	13	CONFIG1
4	ML_Lane 2 (n)	14	CONFIG2
5	GND	15	AUX_CH(p)
6	ML_Lane 2 (p)	16	GND
7	ML_Lane 1 (n)	17	AUX_CH(n)
8	GND	18	Hot Plug Detect
9	ML_Lane 1 (p)	19	Return DP_PWR
10	ML_Lane 0 (n)	20	DP_PWR

Plug and Play

Plug & Play DDC2B Feature

This monitor is equipped with VESA DDC2B capabilities according to the VESA DDC STANDARD. It allows the monitor to inform the host system of its identity and, depending on the level of DDC used, communicate additional information about its display capabilities.

The DDC2B is a bi-directional data channel based on the I2C protocol. The host can request EDID information over the DDC2B channel.

Frequently Ask Questions

Can AOC 24G2 be mounted?

The design of the AOC 24G2 IPS gaming monitor is impressive considering the price. You get full ergonomic support with up to 130mm height adjustment, 90° pivot, +/- 30° swivel, -5°/22° tilt, and 100x100mm VESA mount compatibility.

Can AOC monitor rotate?

AOC AS110D0 – Single Computer Monitor Arm Mount, Gas Struts Supporting up to 19.4 lbs and up to 27". Grommet and C-clamp mounts Included. Easy Swivel, tilt, and Rotate for Ergonomic Setup. Brief content is visible, double tap to read the full content.

Does the AOC 24G2 have speakers?

It also includes up-firing 2 x 2W speakers, which offer basic and not particularly rich or high-quality sound output. The remaining ports are the same on the 'SPU' and 'SP' and include; 2 HDMI 1.4 ports, DP 1.2a, VGA, 3.5mm audio input, a 3.5mm headphone jack, and AC power input (internal power converter).

Can I use an AOC monitor as a TV?

Yes, you can, but you will need ports for RCA and digital sound cables, depending on what kind your cable box uses.

Do you have to charge AOC monitor?

This switch has to be on all the time for the monitor to receive power. The AOC 16T2 has a built-in battery with a 4-hour battery life. You charge this battery via the USB-C port when you turn on the charging switch.

Is 24G2 curved?

C24G2 23.6" Curved Gaming Monitor – AOC Monitor. Engineered with Adaptive Sync technology, AOC's C24G2 offers a 165Hz refresh rate and 1 ms response time to allow an ultra-smooth experience.

What is the frame rate of the AOC monitor?

144 Hz refresh rate coupled with 1 ms response time and FreeSync Premium support.

Can you adjust AOC monitor?

If you type "Calibrate display color" in the search bar, you'll open the Display Color Calibration tool. The on-screen instructions will guide you through the gamma, brightness, contrast, and color balance adjustments, where you can judge the obvious errors with your own eyes and adjust the on-screen sliders accordingly.

What is the best FPS setting for AOC 24G2?

The AOC 24G2SP monitor has four response time overdrive modes: Off, Weak, Medium, and Strong. For the best performance at 165Hz, we recommend using the Strong mode, though you may need to dial it back at lower refresh rates: Below 120Hz, go with 'Medium' and at around 60Hz, go with 'Weak'.

What type of backlight is AOC 24G2?

The 24G2U (24G2) uses DC (Direct Current) to dim the backlight and does not use PWM (Pulse Width Modulation) at any brightness setting. The backlight is therefore considered 'flicker-free', which will come as welcome news to users who are sensitive to flickering or worried about the side effects of PWM usage.

What cable does AOC monitor use?

USB-C | AOC Monitors.

How do I clean my AOC monitor?

How do I clean my Monitor? You can use Windex® to clean the screen and 409® to clean the outer casing of the monitor. Please use a "soft" non-fibrous cloth to clean the screen.

What is the price of AOC 24G2 in Pakistan?

AOC 24G2 Gaming Monitor Available at Best Price in Pakistan at Globalcomputers. pk for RS. 46000.

Download This PDF Link: [AOC G2 24G2ZU/BK FHD Gaming Monitor User Manual](#)