



AOC 27G2 144Hz AGON LCD Monitor User Manual

[Home](#) » [Support](#) » AOC 27G2 144Hz AGON LCD Monitor User Manual 

Contents

- [1 AOC 27G2 144Hz AGON LCD Monitor](#)
- [2 Safety](#)
 - [2.1 National Conventions](#)
 - [2.2 Power](#)
 - [2.3 Installation](#)
 - [2.4 Cleaning](#)
- [3 Setup](#)
 - [3.1 Contents in Box](#)
 - [3.2 Setup Base](#)
 - [3.3 Adjusting the monitor](#)



AOC 27G2 144Hz AGON LCD Monitor



Safety

National Conventions

The following subsections describe the notational conventions used in this document. Notes, Cautions, and Warnings Throughout this guide, blocks of text may be accompanied by an icon and printed in bold type or in italic type. These blocks are notes, cautions, and warnings, and they are used as

- **NOTE:** A NOTE indicates important information that helps you make better use of your computer system
- **CAUTION:** A CAUTION indicates either potential damage to hardware or loss of data and tells you how to avoid the problem.
- **WARNING:** A WARNING indicates the potential for bodily harm and tells you how to avoid the problem. Some warnings may appear in alternate formats and may be unaccompanied by an icon. In such cases, the specific presentation of the warning is mandated by regulatory authorities.

Power

- The monitor should be operated only from the type of power source indicated on the label. If you are not sure of the type of power supplied to your home, consult your dealer or local power company.
- The monitor is equipped with a three-pronged grounded plug and a plug with a third (grounding) pin. This plug will fit only into a grounded power outlet as a safety feature. If your outlet does not accommodate the three-wire plug, have an electrician install the correct outlet, or use an adapter to ground the appliance safely. Do not defeat the safety purpose of the grounded plug.
- Unplug the unit during a lightning storm or when it will not be used for long periods of time. This will protect the monitor from damage due to power surges.
- Do not overload power strips and extension cords. Overloading can result in fire or electric shock.
- To ensure satisfactory operation, use the monitor only with UL-listed computers that have appropriate

configured receptacles marked between 100 240V ~~, Min. 5A

- The wall socket shall be installed near the equipment and shall be easily accessible.

Installation

- Do not place the monitor on an unstable cart, stand, tripod, bracket, or table. If the monitor falls, it can injure a person and cause serious damage to this product. Use only a cart, stand, tripod, bracket, or table recommended by the manufacturer or sold with this product. Follow the manufacturer's instructions when installing the product and use mounting accessories recommended by the manufacturer. A product and cart combination should be moved with care.
- Never push any object into the slot on the monitor cabinet. It could damage circuit parts causing a fire or electric shock. Never spill liquids on the monitor.
- Do not place the front of the product on the floor.
- Leave some space around the monitor as shown below. Otherwise, air circulation may be inadequate hence overheating may cause a fire or damage to the monitor.

See below the recommended ventilation areas around the monitor when the monitor is installed on the wall or with the stand:

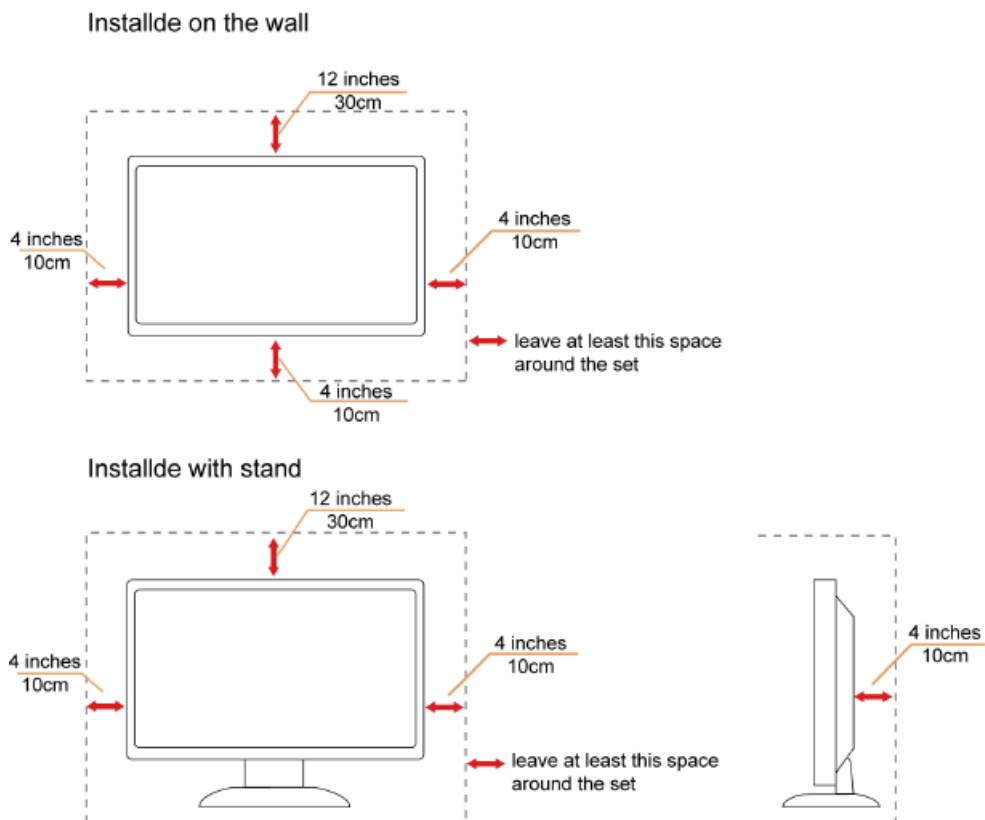

Cleaning

- Clean the cabinet regularly with a cloth. You can use soft detergent to wipe out the stain, instead of strong detergent which will cauterize the product cabinet.
- When cleaning, make sure no detergent is leaked into the product.
- The cleaning cloth should not be too rough as it will scratch the screen surface. Please disconnect the power cord before cleaning the product.



Setup

Contents in Box

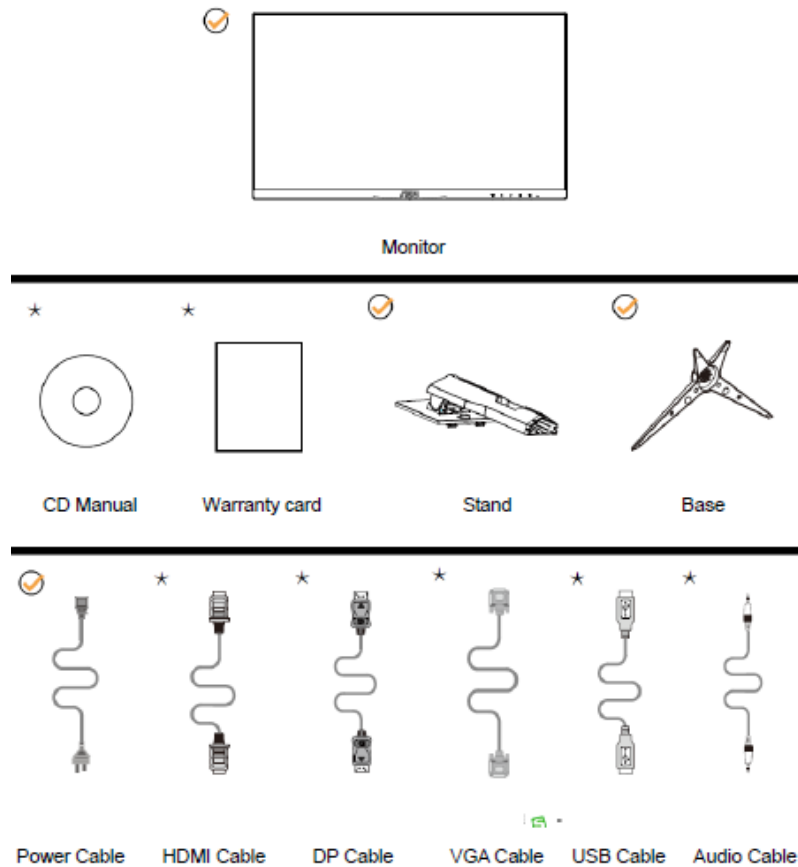

Not all signal cables (HDMI / D P / VGA / USB /Audio cables) CD manual will be provided for all countries and regions. Please check with the local dealer or AOC branch office for confirmation.

Setup Base

Please set up or remove the base by following the steps as below. Please place the monitor on a soft and flat surface to prevent the scratch

Setup:

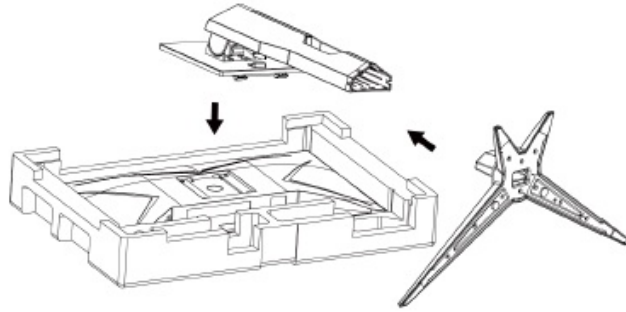

Remove:

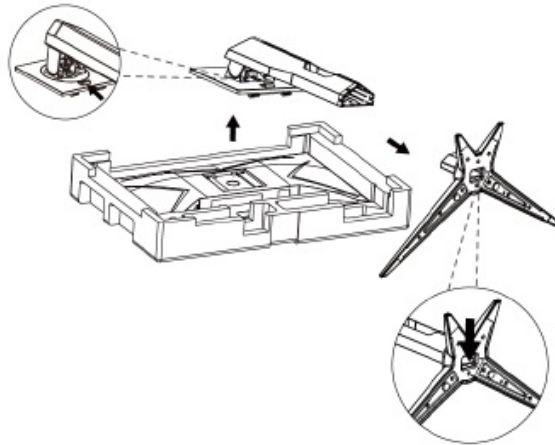

Adjusting the monitor

- For optimal viewing, it is recommended to look at the full face of the monitor, and then adjust the monitor's angle to your own preference.
- Hold the stand so you will not topple the monitor when you change the monitor's angle.

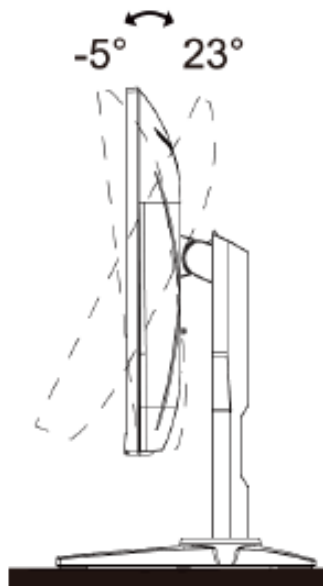

NOTE:

Do not touch the LCD screen when you change the angle. It may cause damage or break the LCD screen.