



AOC 27G4E Fast IPS Gaming Monitor User Manual

[Home](#) » [AOC](#) » AOC 27G4E Fast IPS Gaming Monitor User Manual 

AOC 27G4E Fast IPS Gaming Monitor User Manual



Contents

- 1 Safety
- 2 Power
- 3 Installation
- 4 Installed with stand
- 5 Cleaning
- 6 Setup
- 7 Set-up Stand & Base
- 8 Adjusting Viewing Angle
- 9 Wall Mounting
- 10 Adaptive-Sync function
- 11 H D R
- 12 Adjusting
- 13 O S D Setting
- 14 Luminance
- 15 LED Indicator
- 16 Troubleshoot
- 17 Specification
- 18 Documents / Resources
 - 18.1 References
- 19 Related Posts

Safety

National Conventions

The following subsections describe national conventions used in this document.

Notes, Cautions, and Warnings

Throughout this guide, blocks of text may be accompanied by an icon and printed in bold type or in italic type. These blocks are notes, cautions, and warnings, and they are used as follows:



NOTE: A NOTE indicates important information that helps you make better use of your computer system.



CAUTION: A CAUTION indicates either potential damage to hardware or loss of data and tells you how to avoid the problem.



WARNING: A WARNING indicates the potential for bodily harm and tells you how to avoid the problem. Some warnings may appear in alternate formats and may be unaccompanied by an icon. In such cases, the specific presentation of the warning is mandated by regulatory authority

Power



The **monitor** should be operated only from the type of power source indicated on the label. If you are not sure of the type of power supplied to your home, consult your dealer or local power company.



The **monitor** is equipped with a three-pronged grounded plug, a plug with a third (grounding) pin. This plug will fit only into a grounded power outlet as a safety feature. If your outlet does not accommodate the three-wire plug, have an electrician install the correct outlet, or use an adapter to ground the appliance safely. Do not

defeat the safety purpose of the grounded plug.



Unplug the unit during a lightning storm or when it will not be used for long periods of time. This will protect the [monitor](#) from damage due to power surges.



Do not overload power strips and extension cords. Overloading can result in fire or electric shock.



To ensure satisfactory operation, use the [monitor](#) only with UL listed computers which have appropriate configured receptacles marked between 100-240V AC, Min. 5A.



The wall socket shall be installed near the equipment and shall be easily accessible.

Installation



Do not place the monitor on an unstable cart, stand, tripod, bracket, or table. If the monitor falls, it can injure a person and cause serious damage to this product. Use only a cart, stand, tripod, bracket, or table recommended by the manufacturer or sold with this product. Follow the manufacturer's instructions when installing the product and use mounting accessories recommended by the manufacturer. A product and cart combination should be moved with care.



Never push any object into the slot on the [monitor](#) cabinet. It could damage circuit parts causing a fire or electric shock. Never spill liquids on the [monitor](#).



Do not place the front of the product on the floor.

If you mount the monitor on a wall or shelf, use a mounting kit approved by the manufacturer and follow the kit instructions.



Leave some space around the monitor as shown below. Otherwise, air-circulation may be inadequate hence overheating may cause a fire or damage to the monitor.



To avoid potential damage, for example the panel peeling from the bezel, ensure that the monitor does not tilt downward by more than -5 degrees. If the -5 degree downward tilt angle maximum is exceeded, the [monitor](#) damage will not be covered under warranty.

See below the recommended ventilation areas around the [monitor](#) when the monitor is installed on the wall or on the stand:

Installed with stand

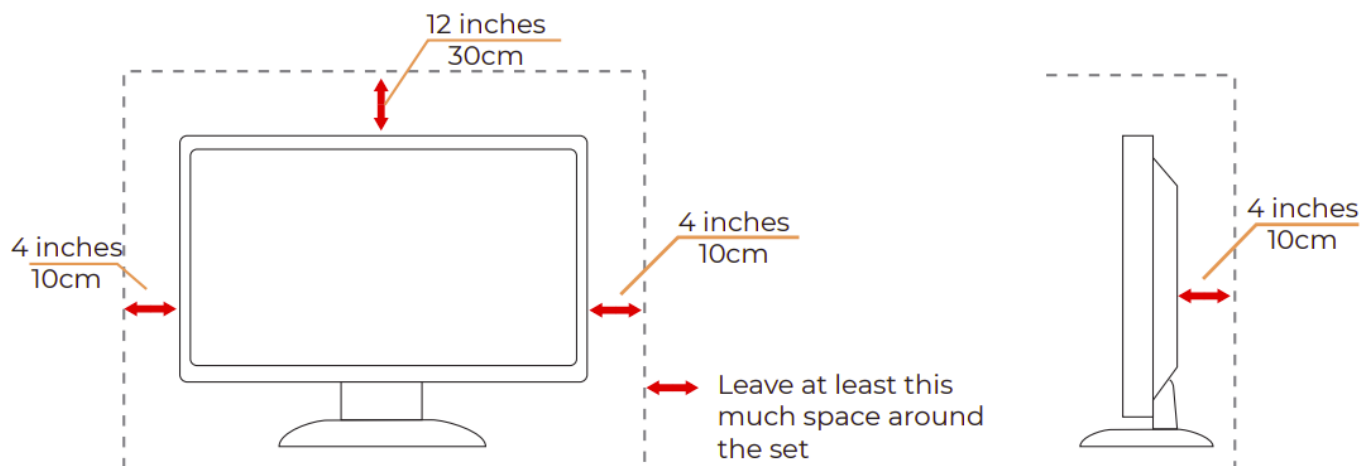

Cleaning



Clean the cabinet regularly with a water-dampened, soft cloth.



When cleaning use a soft cotton or microfiber cloth. The cloth should be damp and almost dry, do not allow liquid into the case.

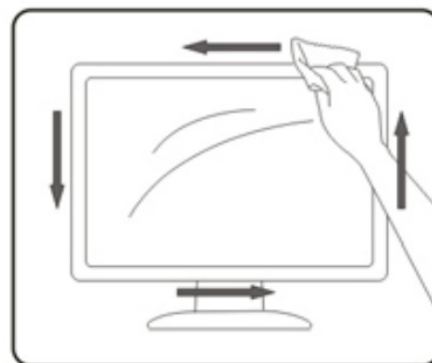
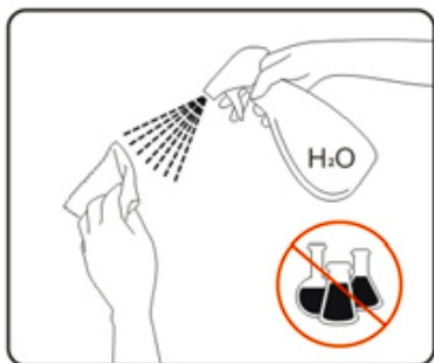

Please disconnect the power cord before cleaning the product.

Other



If the product is emitting a strange smell, sound or smoke, disconnect the power plug IMMEDIATELY and contact a Service Center.

Make sure that the ventilating openings are not blocked by a table or curtain.



Do not engage the LCD [monitor](#) in severe vibration or high impact conditions during operation.



Do not knock or drop the [monitor](#) during operation or transportation.







The power cords shall be safety approved. For Germany, it shall be H03VV-F, 3G, 0.75 mm², or better. For other countries, the suitable types shall be used accordingly.



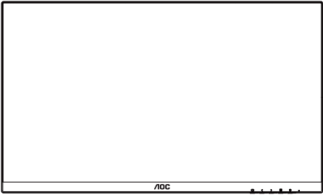
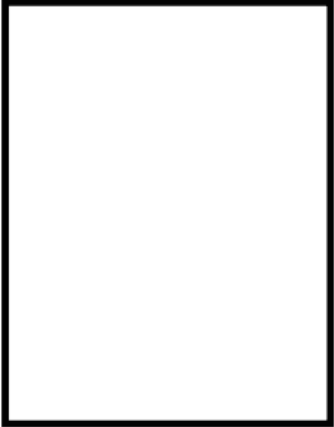

Excessive sound pressure from earphones and headphones can cause hearing loss. Adjustment of the equalizer to maximum increases the earphones and headphones output voltage and therefore the sound pressure level.

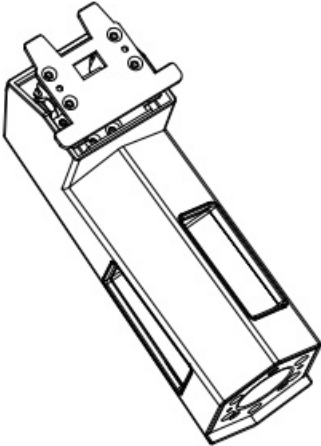
Setup

Contents in Box

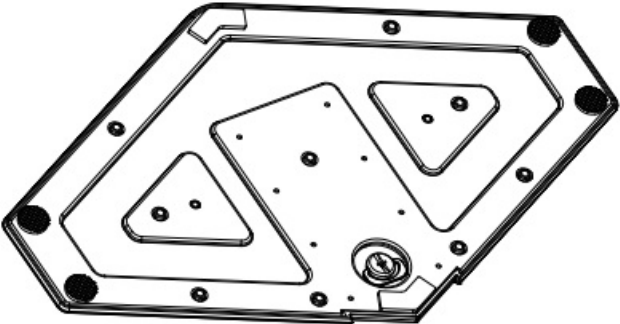
Monitor	
Quick Start Guide	
Warranty Card	
Stand	<div></div>

<p>Base</p>	<div data-bbox="639 91 799 248"></div> <div data-bbox="767 591 1390 913"></div>
<p>Power Cable</p>	<div data-bbox="970 972 1118 1570"></div>
<p>HDMI Cable</p>	<div data-bbox="979 1608 1118 2130"></div>

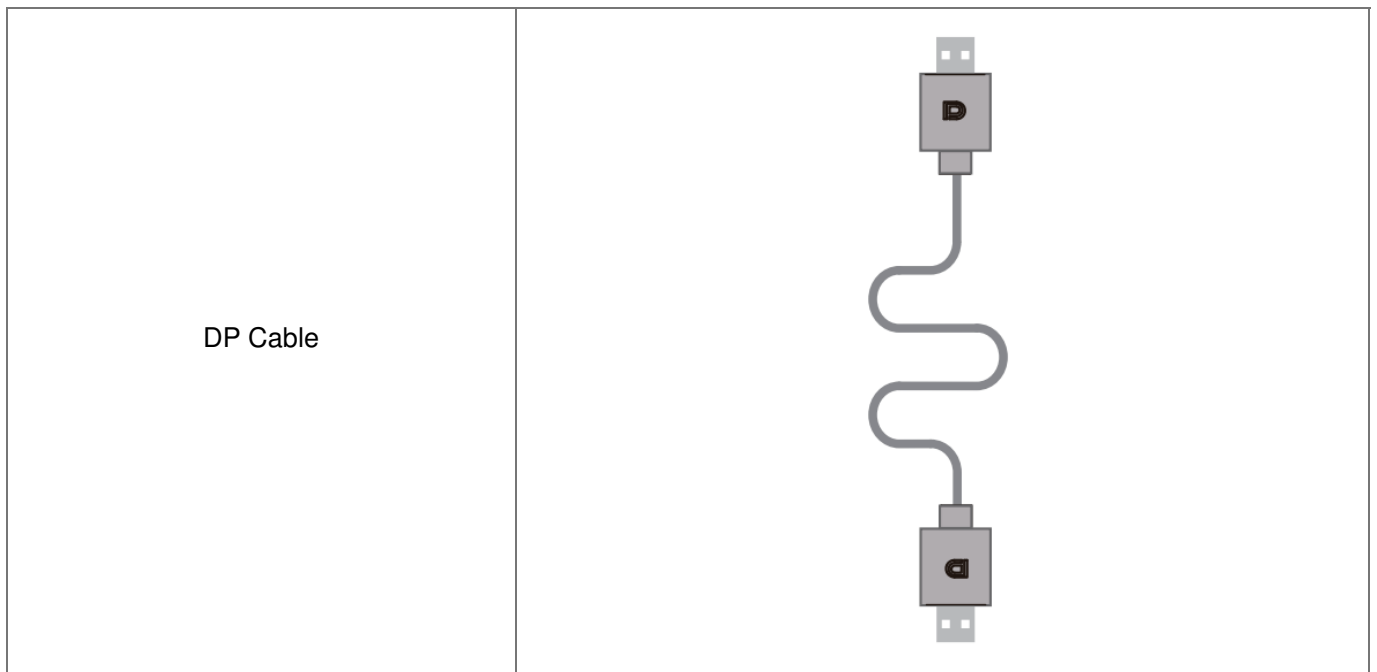

Not all signal cables will be provided for all countries and regions. Please check with the local dealer or AOC branch office for confirmation.

Set-up Stand & Base

Please setup or remove the base following the steps as below.

Setup :

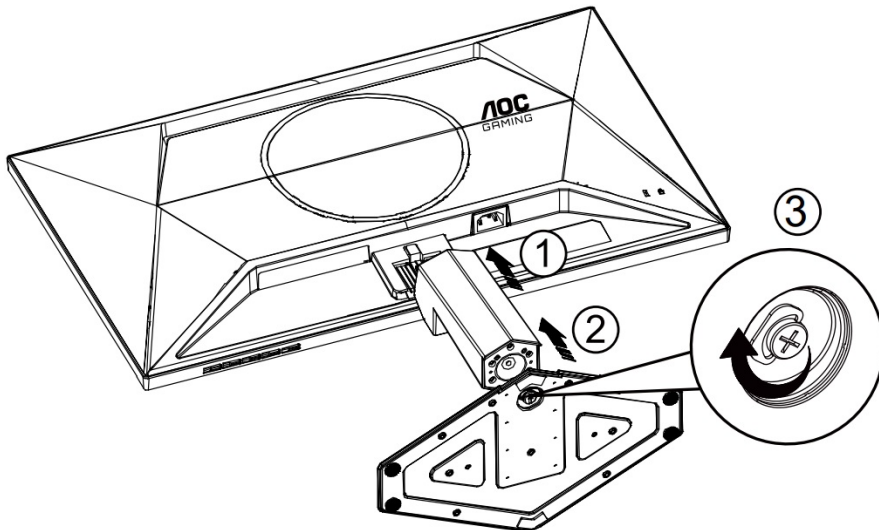

Remove :

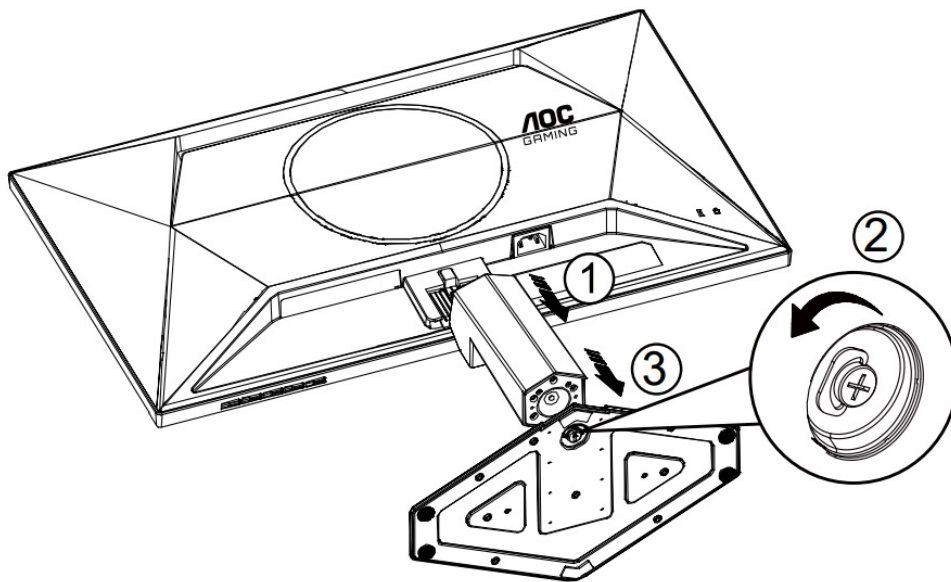

Adjusting Viewing Angle

To achieve the best viewing experience, it is recommended that the user can make sure they are able to look at their whole face on the screen, then adjust the monitor's angle based on personal preference. Hold the stand so you will not topple the monitor when you change the monitor's angle. You are able to adjust the monitor as below:

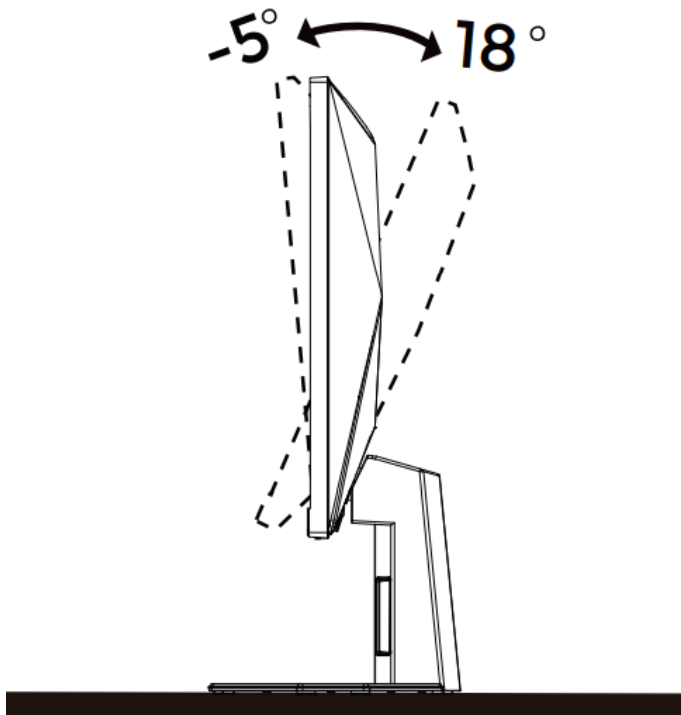

NOTE

Do not touch the LCD [screen](#) when you change the angle. Touching the LCD screen may cause damage.



Warning

- To avoid potential screen damage, such as panel peeling, ensure that the monitor does not tilt downward by more than -5 degrees.

- Do not press the screen while adjusting the angle of the monitor. Grasp only the bezel.

Connecting the [Monitor](#)

Cable Connections In Back of [Monitor](#) and Computer:

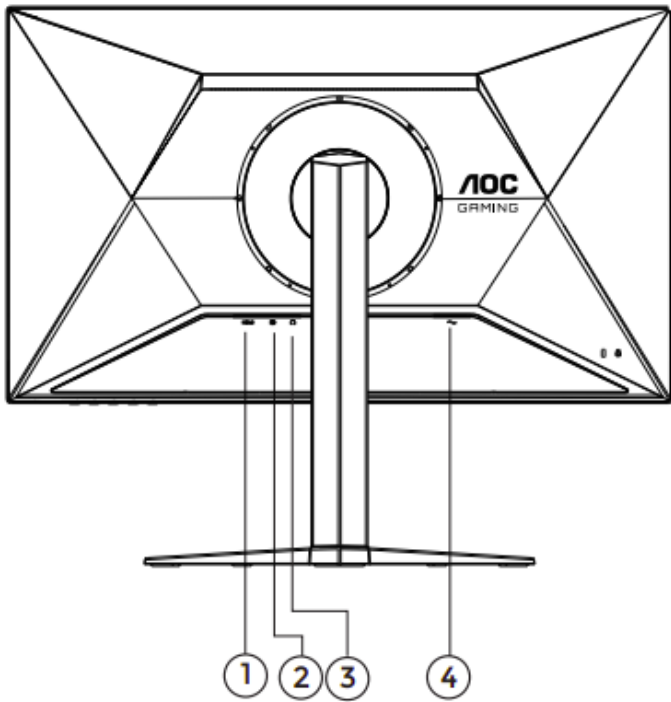

1. HDMI
2. DisplayPort
3. Earphone
4. Power

Connect to PC

1. Connect the power cord to the back of the [display](#) firmly.
2. Turn off your computer and unplug its power cable.
3. Connect the [display](#) signal cable to the video connector on the back of your computer.
4. Plug the power cord of your computer and your display into a nearby outlet.
5. Turn on your computer and display.

If your [monitor](#) displays an image, installation is complete. If it does not display an image, please refer to Troubleshoot.

To protect equipment, always turn off the PC and LCD [monitor](#) before connecting.

Wall Mounting

Preparing to Install An Optional Wall Mounting Arm.

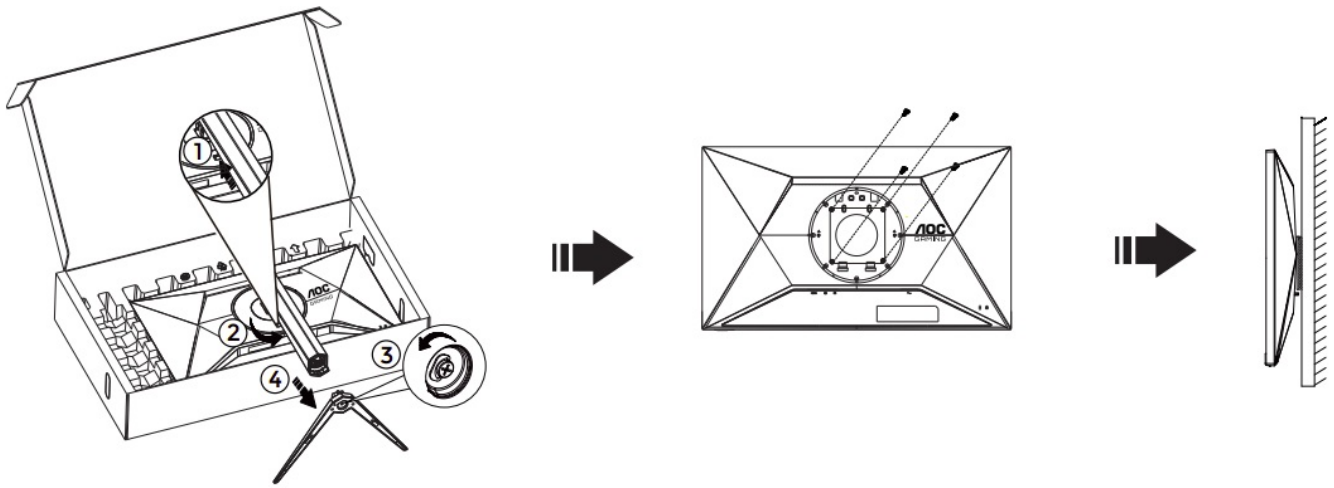

1. This monitor can be attached to a wall mounting arm you purchase separately. Disconnect power before this procedure. Follow these steps:
2. Remove the base.
3. Follow the manufacturer's instructions to assemble the wall mounting arm.
4. Place the wall mounting arm onto the back of the monitor. Line up the holes of the arm with the holes in the back of the [monitor](#).
5. Insert the 4 screws into the holes and tighten.
6. Reconnect the cables. Refer to the user's manual that came with the optional wall mounting arm for instructions on attaching it to the wall.

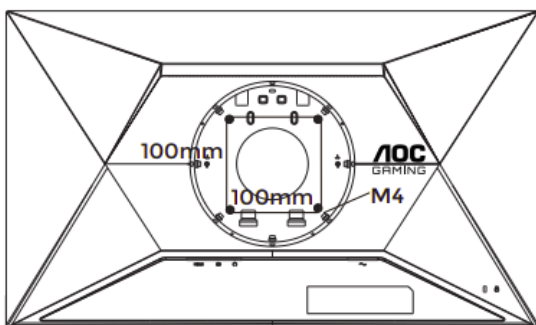

Specification of wall hanger screws: $M4*(10+X)mm$ (X =Thickness of Wall mount bracket)

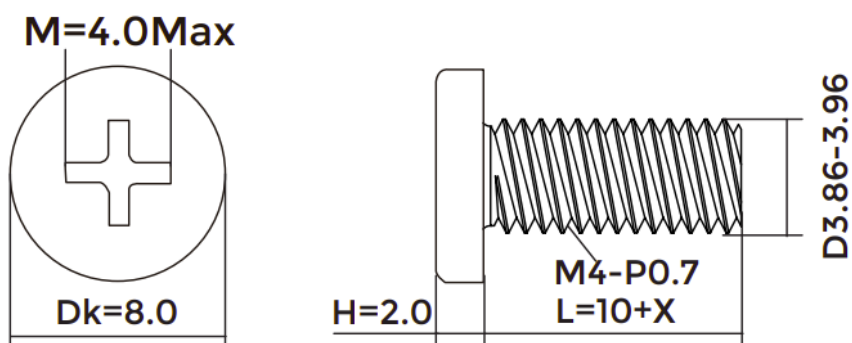

Note: VESA mounting screw holes are not available for all models, please check with the dealer or official department of AOC.

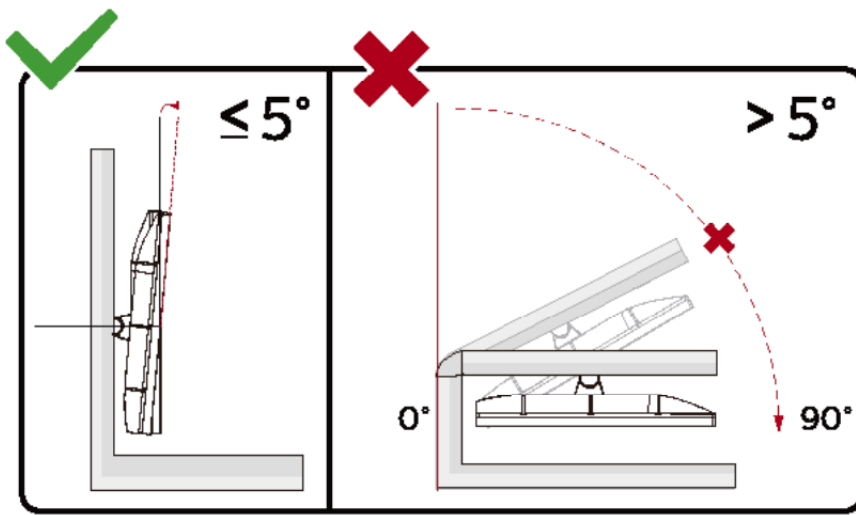

Display design may differ from those illustrated.



WARNING:

1. To avoid potential **screen** damage, such as panel peeling, ensure that the **monitor** does not tilt downward by more than -5 degrees.
2. Do not press the **screen** while adjusting the angle of the **monitor**. Grasp only the bezel.

Adaptive-Sync function

1. Adaptive-Sync function works with DP/HDMI
2. Compatible Graphics Card: Recommended list is as below, also could be checked by visiting www.AMD.com

Graphics Cards

- Graphics Cards
- Radeon™ RX Vega series
- Radeon™ RX 500 series
- Radeon™ RX 400 series
- Radeon™ R9/R7 300 series R9 370/X, R7 370/X, R7 265 except
- Radeon™ Pro Duo (2016)
- Radeon™ R9 Nano series
- Radeon™ R9 Fury series
- Radeon™ R9/R7 200 series (R9 270/X, R9 280/X except)

Processors

- AMD Ryzen™ 7 2700U
- AMD Ryzen™ 5 2500U
- AMD Ryzen™ 5 2400G
- AMD Ryzen™ 3 2300U
- AMD Ryzen™ 3 2200G

- AMD PRO A12-9800
- AMD PRO A12-9800E
- MD PRO A10-9700
- AMD PRO A10-9700E
- AMD PRO A8-9600
- AMD PRO A6-9500
- AMD PRO A6-9500E
- AMD PRO A12-8870
- AMD PRO A12-8870E
- AMD PRO A10-8770
- AMD PRO A10-8770E
- AMD PRO A10-8750B
- AMD PRO A8-8650B
- AMD PRO A6-8570
- AMD PRO A6-8570E
- AMD PRO A4-8350B
- AMD A10-7890K
- AMD A10-7870K
- AMD A10-7850K
- AMD A10-7800
- AMD A10-7700K
- AMD A8-7670K
- AMD A8-7650K
- AMD A8-7600
- AMD A6-7400K

H D R

It is compatible with input signals in HDR10 format.

The [display](#) may automatically activate the HDR function if the player and content are compatible. Please contact the device manufacturer and the content provider for information on the compatibility of your device and content. Please select “OFF” for the HDR function when you have no need for automatical activation function.

Note:

1. No special setting is needed for the DisplayPort/HDMI interface in WIN10 versions lower (older) than V1703.
2. Only the HDMI interface is available and the DisplayPort interface cannot function in WIN10 version V1703.
3840×2160 only suggest for Blu-ray Player, Xbox and PlayStation.
 - a. The [display](#) resolution is set to 1920*1080, and HDR is preset to ON.
 - b. After entering an application, the best HDR effect can be achieved when the resolution is changed to 1920*1080 (if available).

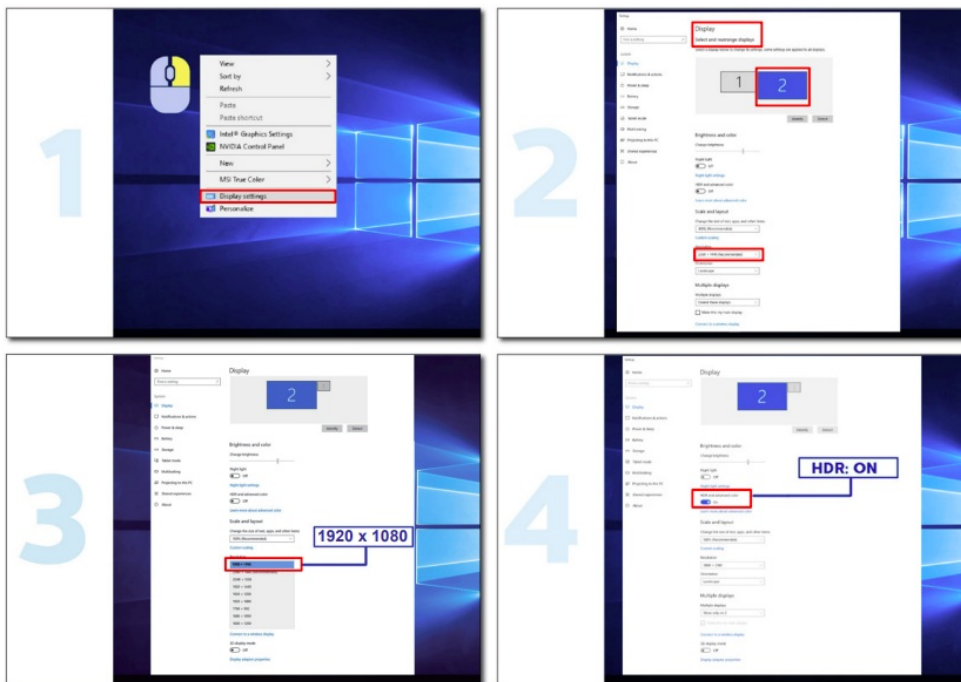

Adjusting

Hotkeys

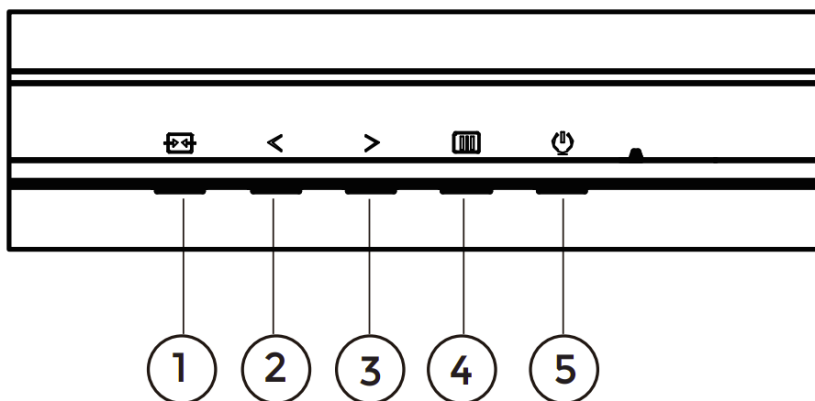

1	Source/Exit
2	Game Mode
3	Dial Point
4	Menu/Enter
5	Power

Menu/Enter

Press to [display](#) the OSD or confirm the selection.

Power

Press the Power button to turn on the [monitor](#).

Dial Point

When there is no OSD, press Dial Point button to show / hide Dial Point.

Game Mode

When there is no OSD, press “ ” key to open game mode function, then press “ ” or “ ” key to select game mode (FPS, RTS, Racing, Gamer 1, Gamer 2 or Gamer 3) basing on the different game types.

Source/Exit





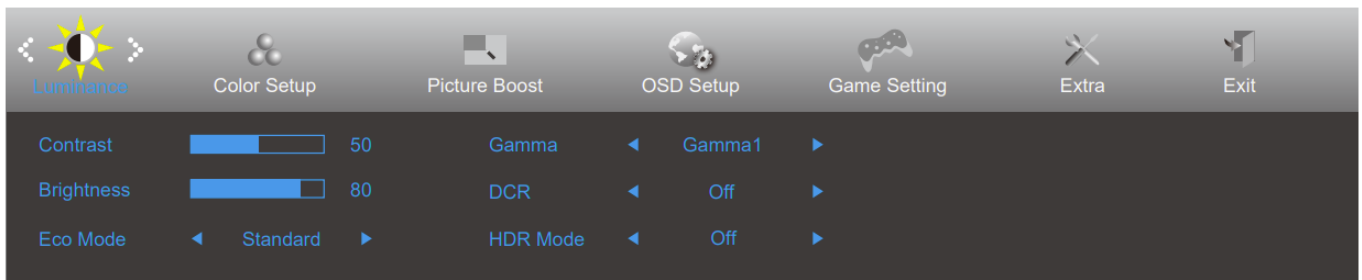

When the OSD is closed, press Source/Exit button will be Source hot key function.

When the OSD menu is active, this button acts as an exit key (to exit the OSD menu).

O S D Setting

Basic and simple instruction on the control keys.



1. Press the  **MENU-button** to activate the OSD window.
2. Press **Left or Right** to navigate through the functions. Once the desired function is highlighted, press the  **MENU-button** to activate it, press **Left or Right** to navigate through the sub-menu functions. Once the desired function is highlighted, press  **MENU-button** to activate it.
3. Press Left or to change the settings of the selected function. Press to exit. If you want to adjust any other function, repeat steps 2-3.
4. **OSD Lock Function:** To lock the OSD, press and hold the  MENU-button while the [monitor](#) is off and then press  power button to turn the [monitor](#) on. To unlock the OSD – press and hold the MENU button while the monitor is off and then press  power button to turn the monitor on.







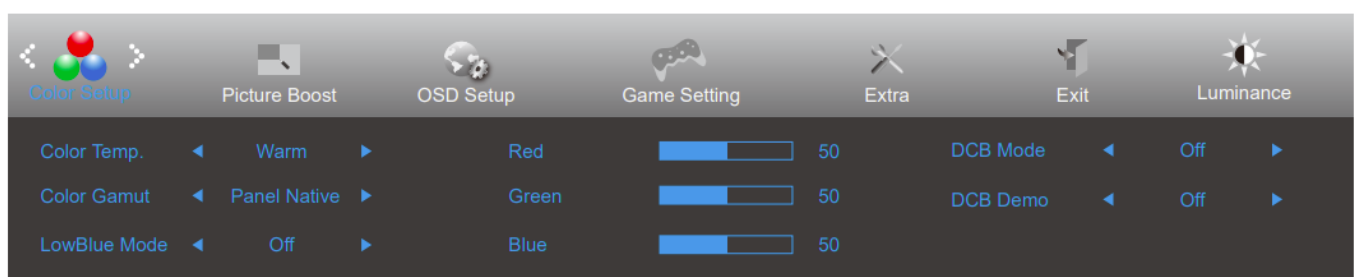

Notes:

1. If the product has only one signal input, the item of “Input Select” is unable to be adjusted.
2. If the input signal resolution is the native resolution or Adaptive-Sync, then the item “Image Ratio” is invalid.
3. Eco Modes (except Standard mode), DCR, DCB mode and Picture Boost, for these four states that only one state can exist.

Luminance





Contrast	0-100		Contrast from Digital-register.
Brightness	0-100		Backlight Adjustment.
Eco Mode	Standard		Standard Mode.
	Text		Text Mode.
	Internet		Internet Mode.
	Game		Game Mode.
	Movie		Movie Mode.
	Sports		Sports Mode.
	Reading		Reading Mode.
Gamma	Gamma 1		Adjust to Gamma 1.
	Gamma 2		Adjust to Gamma 2.
	Gamma 3		Adjust to Gamma 3.
D C R	Off		Disable dynamic contrast ratio.
	On		Enable dynamic contrast ratio.
HDR	Off		Set the HDR profile according to your usagerequirements. Note:When HDR is detected, t he HDR option is displayed for adjustment.
	Display H D R		
	HDR Picture		
	HDR Movie		
	HDR Game		
	Off		Optimized for the color and contrast of the picture, which will simulate showing the HDR effect.
	HDR Picture		

	HDR Mode	HDR Movie	Note: When HDR is not detected, the HDR Mode option is displayed for adjustment.
		HDR Game	

Note:

1. When “HDR Mode” is set to “non-off”, the items “Contrast”, “Eco Mode”, “Gamma” cannot be adjusted.
2. When “HDR” is set to “non-off”, the items “Contrast”, “Brightness”, “Eco Mode”, “Gamma”, “DCR” cannot be adjusted.
3. When the “Color Gamut” under “Color Setup” is set to sRGB, the items “Contrast”, “Eco Mode”, “Gamma”, “HDR” and “HDR Mode” cannot be adjusted.

Color Setup

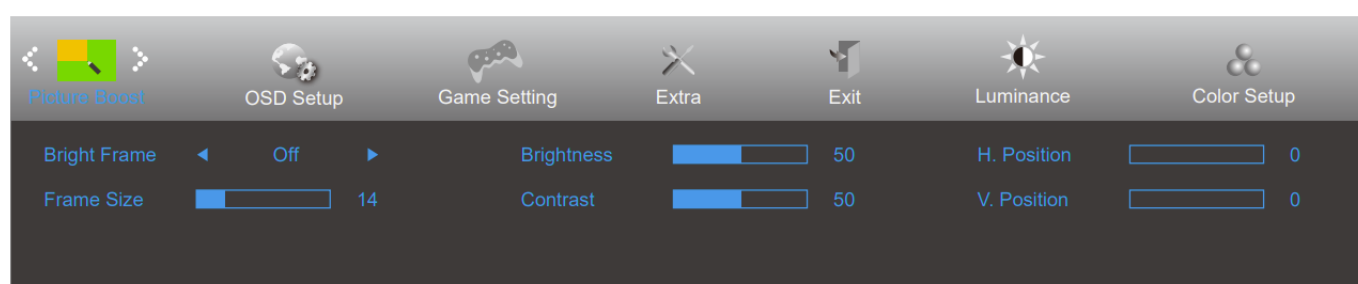





	Color Temp.	Warm	Recall Warm Color Temperature from EEPROM.
		Normal	Recall Normal Color Temperature from EEPROM.
		Cool	Recall Cool Color Temperature from EEPROM.
		User	Restore Color Temperature from EEPROM.
	Color Gamut	Panel Native	Standard color space panel.
		sRGB	sRGB Color space.
	Low Blue Mode	Reading/ Office / Internet / Multimedia / Off	Decrease blue light wave by controlling color temperature.
	Red	0-100	Red gain from Digital-register.
	Green	0-100	Green gain from Digital-register.
	Blue	0-100	Blue gain from Digital-register.
	DCB Mode	Off	Disable DCB Mode.
		Full Enhance	Enable Full Enhance Mode.
		Nature Skin	Enable Nature Skin Mode.
		Green Field	Enable Green Field Mode.
		Sky-blue	Enable Sky-blue Mode.
		Auto Detect	Enable AutoDetect Mode.
	DCB Demo	On or Off	Disable or Enable Demo.

Note:

1. When “HDR Mode” or “HDR” under “Luminance” is set to “non-off”, all items under “Color Setup” cannot be adjusted.
2. When the “Color Gamut” under “Color Setup” is set to sRGB , all items under “Color Setup” cannot be adjusted.

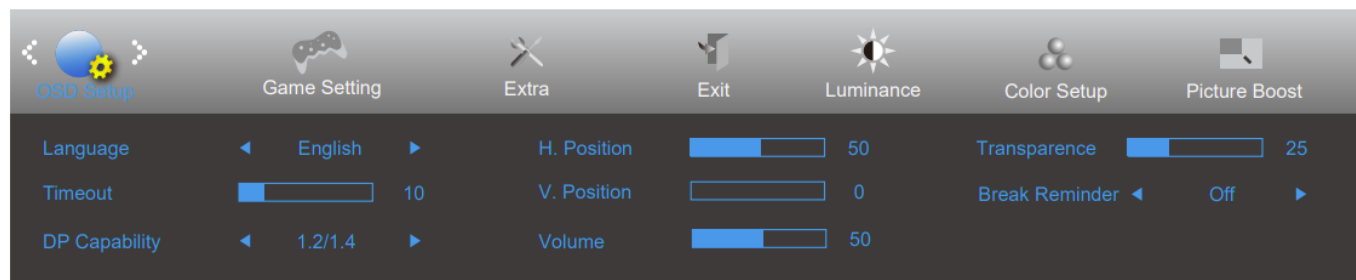
Picture Boost





	Bright Frame	On or Off	Disable or Enable Bright Frame.
	Frame Size	14-100	Adjust Frame Size.
	Brightness	0-100	Adjust Frame Brightness.
	Contrast	0-100	Adjust Frame Contrast.
	H. position	0-100	Adjust Frame horizontal Position.
	V. position	0-100	Adjust Frame vertical Position.

Note:

1. Adjust the brightness, contrast, and position of the Bright Frame for better viewing experience.
2. When “HDR Mode” or “HDR” under “Luminance” is set to “non-off”, all items under “Picture Boost” cannot be adjusted.

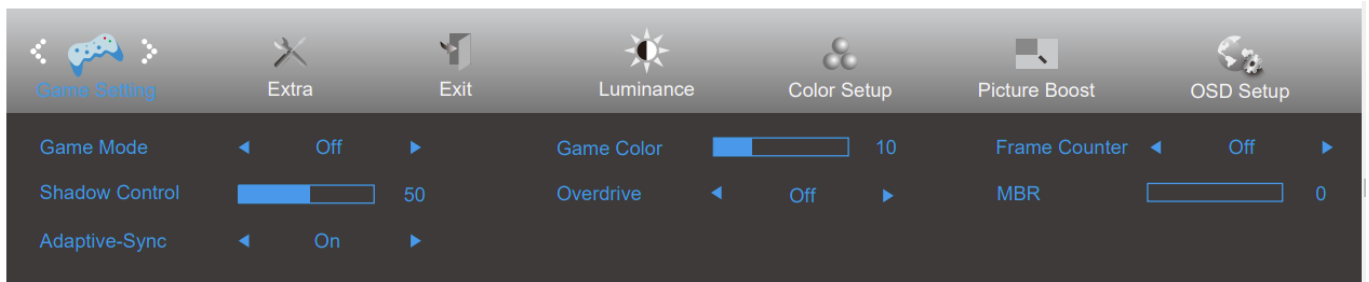
OSD Setup



	Language		Select the OSD language.
	Timeout	5-120	Adjust the OSD Timeout.
	DP Capability	1.1/1.2/1.4	If the DP video content supports DP1.2/1.4, please select DP1.2/1.4 for DP Capability; otherwise, please select Displeasure be noted that only DP1.2/1.4 support Adaptive-Sync function.
	H. Position	0-100	Adjust the horizontal position of OSD.
	V. Position	0-100	Adjust the vertical position of OSD.
	Volume	0-100	Volume Adjustment.
	Transparence	0-100	Adjust the transparence of OSD.
	BreakReminder	On or Off	Break reminder if the user continuously works formore t han 1hrs.

Game Setting

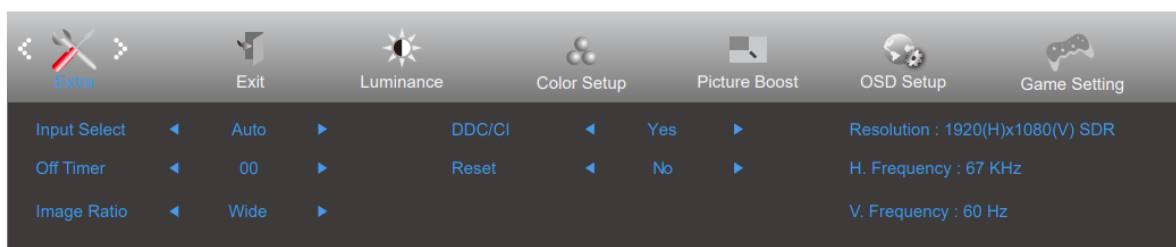

	Game Mode	Off	No optimization by Smart image game
		FPS	For playing FPS (first Person Shooters) games.Improves black level in dark theme.
		RTS	For playing RTS (Real Time Strategy). Improves the image quality.
		Racing	For playing Racing games, Provides fastest response time and high color saturation.
		Gamer 1	User's preference settings saved as Gamer 1.
		Gamer 2	User's preference settings saved as Gamer 2.
		Gamer 3	User's preference settings saved as Gamer 3.
	Shadow Control	0-100	Shadow Control Default is 50, then end-user can adjust from 50 to 100 or 0 to increase/decrease contrast for clear picture.1. If picture is too dark to be saw the detail clearly, adjusting from 50 to100 for clear picture.2. If picture is too white to be saw the detail clearly, adjusting from 50 to0 for clear picture
	Adaptive-Sync	On or Off	Disable or Enable Adaptive-Sync. Adaptive-Sync Run Reminder: When the Adaptive- Sync feature is enabled, there may be flashing in some game environments.
	Game Color	0-20	Game Color will provide 0-20 level for adjusting saturation to get better picture.
	Overdrive	Off	Adjust the response time.Note:1. If the user adjusts Overdriven to "Strong" the displayed image may be blurred. Users can adjust the Overdrive level or turn it off according to their preferences. 2. The "Boost" function is optional when Adaptive-Sync is turned off, the low input delay is turned on, and the refresh rate is ≥75Hz.3. The screen brightness will decrease when the "Boost" function is turned on.
		Weak	
		Medium	
		Strong	
		Boost	
	Frame Counter	Off / Right-up / Right-Down / Left- Down / Left-Up	Display V frequency on the corner selected
	MBR	0 ~ 20	MBR (Motion Blur Reduction) Provides 0-20 levels of adjustments to reduce motion blur. Note:1. The MBR function can be adjusted when Adaptive-Sync is turned off, and the refresh rate≥75Hz.2. The brightness of the screen will decrease as theadjustment value increases.

Note:

1. When “HDR Mode” under “Luminance” is set to “non-off”, the items “Game Mode”, “Shadow Control”, “Game Color” cannot be adjusted.
2. When “HDR” under “Luminance” is set to “non-off”, the items “Game Mode”, “Shadow Control”, “Game Color”, “MBR” can not be adjusted. “Boost” under “Overdrive” is not available.
3. When the “Color Gamut” under “Color Setup” is set to sRGB, the items “Game Mode”, “Shadow Control”, and “Game Color” cannot be adjusted.

Extra

	Input Select	Auto/HDMI/DP	Select Input Signal Source.
	Off timer	0-24hrs	Select DC off time.
	Image Ratio	Wide / 4:3	Select image ratio for display .
	DDC/CI	Yes or No	Turn ON/OFF DDC/CI Support.
	Reset	Yes or No	Reset the menu to default.

Exit

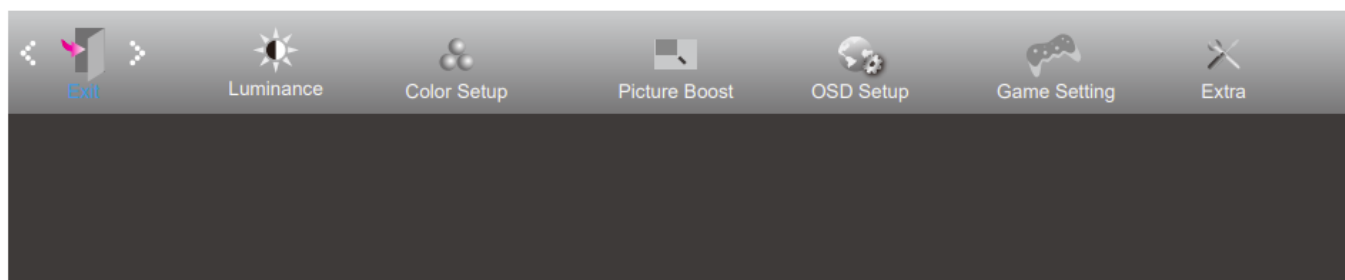

	Exit		Exit the main OSD
---	------	--	-------------------

LED Indicator

Status	LED Color
Full Power Mode	White
Active-off Mode	Orange

Troubleshoot

Problem & Question	Possible Solutions
Power LED Is Not ON	Make sure the power button is ON and the Power Cord is properly connected to a grounded power outlet and to the monitor .
No image on the screen	Is the power cord connected properly? Check the power cord connection and power supply. Is the video cable connected correctly? (Connected using the HDMI cable) Check the HDMI cable connection. (Connected using the DP cable) Check the DP cable connection.*HDMI/DP input is not available on every model. If the power is on, reboot the computer to see the initial screen (the login screen.) If the initial screen (the login screen) appears, boot the computer in the applicable mode (the safe mode for Windows 7/8/10) and then change the frequency of the video card. (Refer to the Setting the Optimal Resolution) If the initial screen (the login screen) does not appear, contact the Service Center or your dealer. Can you see "Input Not Supported" on the screen? You can see this message when the signal from the video card exceeds the maximum resolution and frequency that the monitor can handle properly. Adjust the maximum resolution and frequency that the monitor can handle properly. Make sure the AOC Monitor Drivers are installed.
Picture Is Fuzzy & Has Ghosting Shadowing Problem	Adjust the Contrast and Brightness Controls. Press hot-key (AUTO) to auto-adjust. Make sure you are not using an extension cable or switch box. We recommend plugging the monitor directly to the video card output connector on the back.
Picture Bounces, Flickers Or Wave Pattern Appears In The Picture	Move electrical devices that may cause electrical interference as far away from the monitor as possible. Use the maximum refresh rate your monitor is capable of at the resolution you are using.
Monitor Is Stuck In Active Off-Mode"	The Computer Power Switch should be in the ON position. The Computer Video Card should be snugly fitted in its slot. Make sure the monitor 's video cable is properly connected to the computer. Inspect the monitor 's video cable and make sure no pin is bent. Make sure your computer is operational by hitting the CAPS LOCK key on the keyboard while observing the CAPS LOCK LED. The LED should either turn ON or OFF after hitting the CAPS LOCK key.
Missing one of the primary colors (RED, GREEN, or BLUE)	Inspect the monitor's video cable and make sure that no pin is damaged. Make sure the monitor's video cable is properly connected to the computer.
Screen image is not centered or sized properly	Adjust H-Position and V-Position or press hot-key (AUTO).
Picture has color defects (white does not look white)	Adjust RGB color or select desired color temperature.
Horizontal or vertical disturbances on the screen	Use Windows 7/8/10/11 shut-down mode to adjust CLOCK and FOCUS. Press hot-key (AUTO) to auto-adjust.
Regulation & Service	Please refer to Regulation & Service Information which is in the CD manual or www.aoc.com (to find the model you purchase in your country and to find Regulation & Service Information in Support page).

Specification

General Specification

Panel	Model name	27G4	
	Driving system	TFT Color LCD	
	Viewable Image Size	68.6 cm diagonal	
	Pixel pitch	0.31125mm(H) x 0.31125mm(V)	
	Video	HDMI Interface & DP Interface	
	Display Color	16.7M Colors	
Others	Horizontal scan range	30k~200kHz	
	Horizontal scanSize(Maximum)	597.6mm	
	Vertical scan range	48~180Hz	
	Vertical Scan Size(Maximum)	336.15mm	
	Optimal preset resolution	1920×1080@60Hz	
	Max resolution	1920×1080@180Hz	
	Plug & Play	VESA DDC2B/CI	
	Power Source	100-240V~, 50/60Hz, 1.5A	
	Power Consumption	Typical(default brightness and contrast)	31W
		Max. (brightness = 100, contrast=100)	≤46W
		Standby Mode	≤0.3W
Physical Characteristics	Connector Type	HDMI/DP/Earphone out	
	Signal Cable Type	Detachable	
Environmental	Temperature	Operating	0°C~40°C
		Non-Operating	-25°C~55°C
	Humidity	Operating	10%~85% (Non-Condensing)
		Non-Operating	5%~93% (Non-Condensing)
	Altitude	Operating	0m~5000m (0ft~16404ft)
		Non-Operating	0m~12192m (0ft~40000ft)

Preset [Display](#) Modes

STANDARD	RESOLUTION(±1Hz)	HORIZONTAL FREQUENCY(KHz)	VERTICAL FREQUENCY(Hz)
VGA	640×480@60Hz	31.469	59.94
	640×480@67Hz	35	66.667
	640×480@72 Hz	37.861	72.809
	640×480@75 Hz	37.5	75
	640×480@100 Hz	51.08	99.769
	640×480@120 Hz	61.91	119.518
SD	720×576@50 Hz	31.25	50
SVGA	800×600@56Hz	35.156	56.25
	800×600@60Hz	37.879	60.317
	800×600@72 Hz	48.077	72.188
	800×600@75 Hz	46.875	75
	800×600@100 Hz	62.76	99.778
	800×600@120 Hz	76.302	119.972
XGA	1024×768@60 Hz	48.363	60.004
	1024×768@70 Hz	56.476	70.069
	1024×768@75 Hz	60.023	75.029
	1024×768@100 Hz	80.448	99.811
	1024×768@120Hz	97.551	119.989
SXGA	1280×1024@60Hz	63.981	60.02
	1280×1024@75Hz	79.976	75.025
FHD	1920×1080@60Hz	67.5	60
	1920×1080@120Hz	137.283	120.003
FHD(DP)	1920×1080@144Hz	158.4	144.00
FHD	1920×1080@180Hz	199.803	180.003
MAC MODES			
SVGA	832×624@75Hz	49.725	74.551
DOS	720×400@70Hz	31.469	70.087

Note: According to the VESA standard, there may be a certain error (+/-1Hz) when calculating the refresh rate (field frequency) of different operating systems and graphics cards. In order to improve compatibility, the nominal refresh rate of this product has been rounded off. Please refer to the actual product.

Pin Assignments

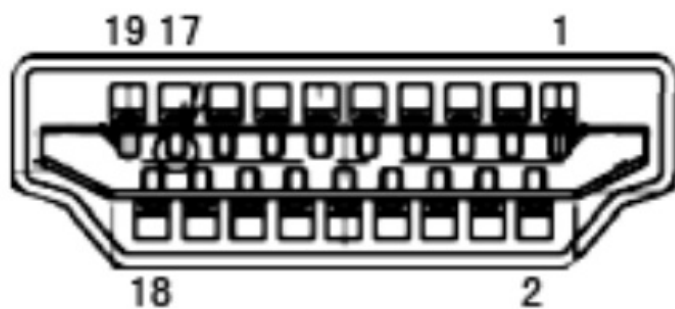

19-Pin Color [Display](#) Signal Cable

Pin No.	Signal Name	Pin No.	Signal Name	Pin No.	Signal Name
1.	TMDS Data 2+	9.	TMDS Data 0-	17.	DDC/CEC Ground
2.	TMDS Data 2 Shield	10.	TMDS Clock +	18.	+5V Power
3.	TMDS Data 2-	11.	TMDS Clock Shield	19.	Hot Plug Detect
4.	TMDS Data 1+	12.	TMDS Clock-		
5.	TMDS Data 1Shield	13.	CEC		
6.	TMDS Data 1-	14.	Reserved (N.C. on device)		
7.	TMDS Data 0+	15.	SCL		
8.	TMDS Data 0 Shield	16.	SDA		

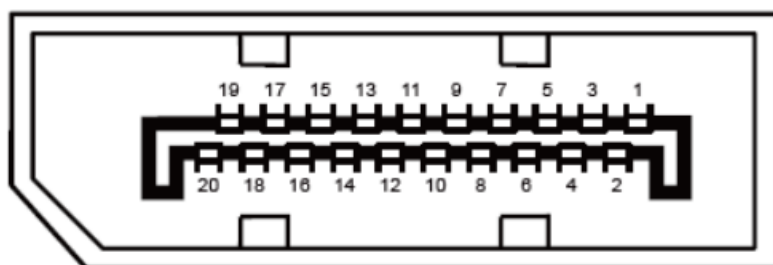

20-Pin Color [Display](#) Signal Cable

Pin No.	Signal Name	Pin No.	Signal Name
1	ML_Lane 3 (n)	11	GND
2	GND	12	ML_Lane 0 (p)
3	ML_Lane 3 (p)	13	CONFIG1
4	ML_Lane 2 (n)	14	CONFIG2
5	GND	15	AUX_CH(p)
6	ML_Lane 2 (p)	16	GND
7	ML_Lane 1 (n)	17	AUX_CH(n)
8	GND	18	Hot Plug Detect
9	ML_Lane 1 (p)	19	Return DP_PWR
10	ML_Lane 0 (n)	20	DP_PWR

Plug and Play

Plug & Play DDC2B Feature

This [monitor](#) is equipped with VESA DDC2B capabilities according to the VESA DDC STANDARD. It allows the [monitor](#) to inform the host system of its identity and, depending on the level of DDC used, communicate additional information about its [display](#) capabilities.

The DDC2B is a bi-directional data channel based on the I2C protocol. The host can request EDID information over the DDC2B channel.



Documents / Resources

	<p>AOC 27G4E Fast IPS Gaming Monitor [pdf] User Manual 27G4E Fast IPS Gaming Monitor, 27G4E, Fast IPS Gaming Monitor, IPS Gaming Monitor, Gaming Monitor, Monitor</p>
---	--

References

- [User Manual](#)

[Manuals+](#), [Privacy Policy](#)

This website is an independent publication and is neither affiliated with nor endorsed by any of the trademark owners. The "Bluetooth®" word mark and logos are registered trademarks owned by Bluetooth SIG, Inc. The "Wi-Fi®" word mark and logos are registered trademarks owned by the Wi-Fi Alliance. Any use of these marks on this website does not imply any affiliation with or endorsement.