



Antari Z-1520 RGB Fog Machine User Manual

[Home](#) » [Antari](#) » Antari Z-1520 RGB Fog Machine User Manual 





Contents

- [1 Safety Information](#)
- [2 Unpacking and Inspection](#)
- [3 Product Dimensions](#)
- [4 Product Overview](#)
- [5 Operation](#)
- [6 Service and Maintenance](#)
- [7 Technical Specifications](#)
- [8 Documents / Resources](#)
 - [8.1 References](#)
- [9 Related Posts](#)

Safety Information



Please read the following safety information carefully before operating the machine. This information

includes important safeguards about installation, usage, and maintenance. Pay attention to all warning labels and instructions in this manual and printed on the machine.

If you have questions about how to operate the machine safely, please contact your local Antari dealer for help.

- Keep this device dry
- Always connect to a grounded circuit to avoid the risk of electrocution.
- Before connecting the machine to power, always check the voltage indicated on the machine matches your local AC voltage
- Do not use the machine if the AC power voltage does not match.
- Disconnect the machine from the AC power before servicing and when not in use.
- This product is for indoor use only! Do not expose to rain or moisture
- If the fluid is spilled, disconnect the AC power and clean it with a damp cloth.
- If the fluid is spilled onto electronic parts, immediately unplug the machine and contact your local Antari dealer for advice.
- No user-serviceable and modifiable parts inside
- Never try to repair this product, an unauthorized technician may cause damage or malfunction to the machine.
- For adult use only. Never leave the machine running unattended
- Install the machine in a well-ventilated area. Provide at least 50 cm of space around the machine.
- Never add flammable liquid of any kind to the machine.
- Make sure there are no flammable materials close to the machine while operating.
- Only use Antari fluid. Other fluids may lead to heater clogging and malfunction.
- If the machine fails to work, unplug the machine and stop operation immediately.
Contact your local Antari dealer for advice.
- Before transporting the machine, make sure the fluid tank is completely drained.
- Fog fluid may present health risks if swallowed. Do not drink fog fluid. Store it securely. In case of eye contact or if fluid is swallowed, immediately look for medical advice.

Unpacking and Inspection

Immediately upon receiving the machine, carefully unpack the carton, and check the content to ensure that all parts are present and have been received in good condition. If any parts appear damaged or mishandled from shipping, notify the shipper immediately and retain the packing material for inspection.

What is included:

- 1 x Z-1520 RGB Fogger
- 1 x W-2 Wireless Remote
- 1 x Power Cord
- 1 x User Manual

Product Dimensions



3

Product Overview



Setting Up

Step 1: Place the machine on a flat surface and in a suitably large area with at least 50 cm of open space around the machine.

Step 2: Fill the fluid tank with Antari-approved fluid.

Step 3: Connect the machine to a suitably rated power supply. To determine the power requirement for the machine refer to the label on the back of the machine.

 Always connect the machine to a protected circuit and ensure it is properly grounded to avoid the risk of electrocution.

Step 4: Turn on the machine and allow it to heat up. The heat-up takes approximately 5 minutes. Once the machine has reached operating temperature, the LCD display will show "Ready To Fog". Now the machine is ready for operation.

Step 5: To start making fog, locate the Volume!  button on the control panel, and press the button to start making fog.

Step 6: To turn off the machine, press the STOP button and turn Powercon to the OFF position.

Operation

Control Panel Operation

The machine can be operated with the onboard digital control interface.

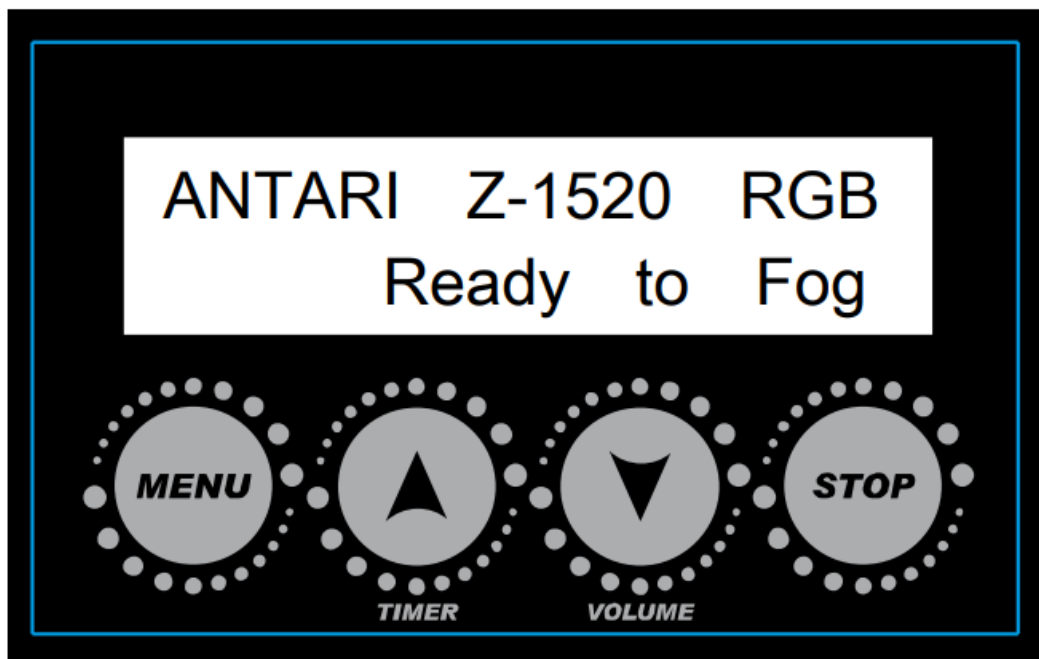

Button	Function
[MENU]	Scroll through the setting menu
▲ [UP]/[TIMER]	Up/Activate Timer function
▼ [DOWN]/[VOLUME]	Down/Activate Volume function
[STOP]	Deactivate Timer/Volume function

Control Menu

DMX512 Address: 1	Set DMX address from 1 to 504
Stand Alone Set Master	Set machine as Master of Slave unit
Color Mode On	Turn LED on or off
Color Mode Macro:01	Set LED output color from macro 1 to 10
Color Mode Chase:01	Set LED chase from 1 to 15
Timer Interval 15 Sec	The set interval from 15 to 360 seconds
Timer Duration 5 Sec	Set duration from 1 to 5 seconds
Wireless Setting On	Turn the wireless control on or off
Wireless Setting Button A: M01	Set the wireless remote button function macro color 1 to 10 or chase 1 to 15 and off.
Wireless Setting Button B: M01	Set the wireless remote button function macro color 1 to 10 or chase 1 to 15 and off.
Wireless Setting Button C: M01	Set the wireless remote button function macro color 1 to 10 or chase 1 to 15 and off.
Wireless Setting Button D: M01	Set wireless remote button function macro color 1 to 10 or chase
LED Setting Fog Only	1 to 15 and off. Setting for LED to turn on with fog only or always on.
LED Fade Out Delay: 0 Sec	Set LED delay time from 0 to 5 seconds.
Run Last Setting On	Turn run last setting function on/off

Wireless Operation

The wireless remote control system W-2 consists of a transmitter equipped with four buttons to activate four user-configurable LED settings and fog; with an onboard receiver attached to the rear panel of Z-1520 RGB.



W-2 Wireless Transmitter



Wireless Receiver

Wireless settings are configurable through the onboard control panel, refer to the control menu section to set up each button.

In free open space, the effective distance is 50 meters, and actual usage depending on obstacle level is 10-25 meters.

Registering transmitters

Transmitters can be paired or deleted from the receiver. Each receiver can pair up to 10 transmitters. Follow the steps below to pair or delete a transmitter from a receiver.

Step 1: Power off the Z-1520 RGB Fogger.

Step 2: Press and hold the [DOWN] button.

Step 3: Turn the power on and release the [DOWN] button when the LCD display blinks.

Step 4: Follow the menu instruction to pair or delete transmitters.

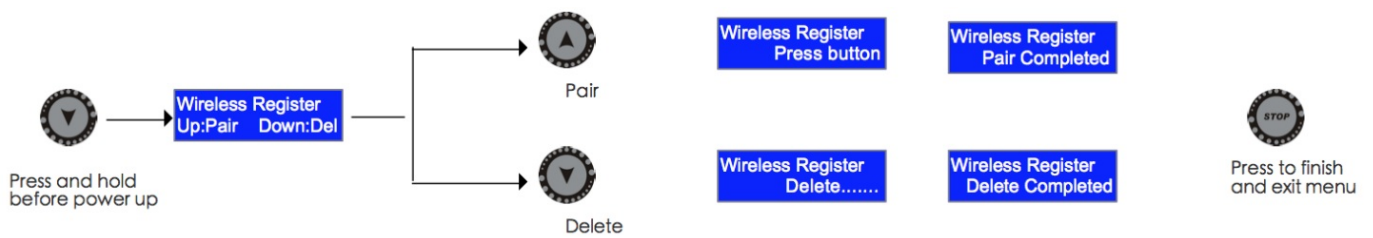

If the effective distance seems to decrease, it is possible the battery level is low and requires replacement. In order to replace the battery, undo the three screws on the back of the transmitter to release the cover. Replace with the same type and specification of battery which is 27A 12V.

DMX Connector Pin Assignment

The machine provides 3-pin and 5-pin XLR connectors for DMX connection. The diagram below indicates pin assignment information.

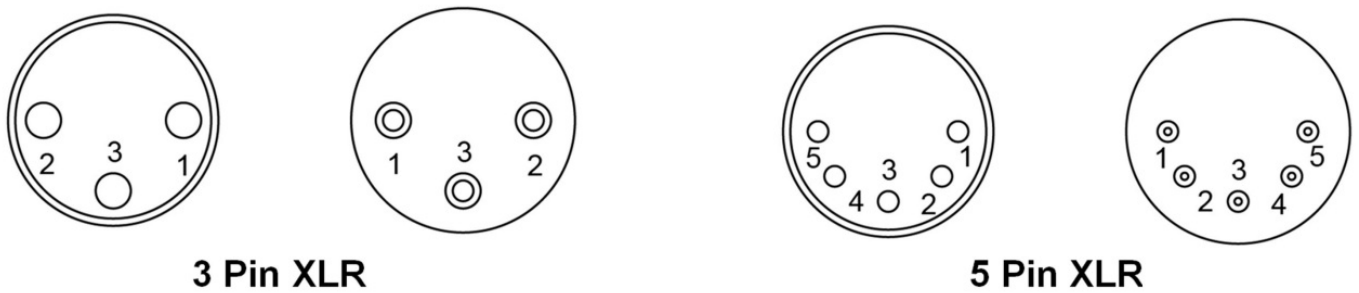

Pin	Function
1	Ground
2	Data-
3	Data+
4	N/A
5	N/A

DMX Channel Function

Channel 1	DMX Value Range	Function
Fog	0 – 4 5 – 255	Fog Off Fog On
Channel 2	DMX Value Range	Function
Red LED	0-255	0-100%
Channel 3	DMX Value Range	Function
Green LED	0-255	0-100%
Channel 4	DMX Value Range	Function
Blue LED	0-255	0-100%
Channel 5	DMX Value Range	Function
Chase	15-Jan	Chase 1
	16-31	Chase 2
	32-47	Chase 3
	48-63	Chase 4
	64-79	Chase 5
	80-95	Chase 6
	96-111	Chase 7
	112-127	Chase 8
	128-143	Chase 9
	144-159	Chase 10
	160-175	Chase 11
	176-191	Chase 12
	192-207	Chase 13
	208-223	Chase 14
	224-255	Chase 15
Channel 6	DMX Value Range	Function
Chase Speed	0-255	0-255 steps per min
Channel 7	DMX Value Range	Function
Master Dimmer	0-255	0-100%
Channel 8	DMX Value Range	Function
Strobe	0-255	1-20 Hz

Fluid

Only use Antari FLC water-based liquid for the Z-1520 RGB Fogger. The machine is tested and calibrated with this liquid to get the best output performance. Warranty will be voided if any other type of liquid is used, improper use of liquid may lead to machine failure and

malfunction.

Service and Maintenance

- Do not allow the machine to become contaminated.
- Remove dust from air vents with an air compressor, vacuum, or a soft brush.
- Only use a damp cloth to clean the casing.
- Before storing run distilled water through the system to help avoid condensing the pump or heater.
- It is recommended to run the machine on a monthly basis in order to achieve the best performance and output condition.
- Excessive dust, liquid, and dirt built up will degrade performance and cause overheating.

Breaker Reset



Disconnect the AC power before resetting the breaker. Only replace the fuse with the same type and rating.

Step 1: Disconnect the AC power.

Step 2: Flip the breaker to the ON position.

Step 3: Turn on the machine for testing.

Breaker

100V = 16A 250V

120V = 15A 250V

240V = 9A 250V



Technical Specifications

– Input voltage	US model : AC 100-120V, 50 / 60Hz 13.5A EU model : AC 220-240V, 50 / 60Hz 7A
– Rated power	1600W
– Light source	22 x 3W LED (8 Red, 7 Green, 7 Blue)
– Warm-up time	5 minutes (approx.)
– Fluid consumption	150 ml/min
– Fluid tank capacity	2.41 (0.63ga1)
– Compatible fluid	Antari FLC Super Light Fog Fluid
– Ambient temp. range	0°C – 40 °C (32 °F-104 °F)
– Output	6 meters height
– Control	DMX512, Timer, Manual, Master/Slave, Wireless
– DMX channels	8 channels
– Connection	Neutrik Powercon (Power) XLR 3-pin and 5-pin (DMX)
– Optional accessories	FX-4 Flightcase
– Dimension	L418 W295 H210 mm (L16.46 W11.61 148.27 inch)
– Weight	10.4 kg (22.93 lbs)

For current product information
visit Antari at: www.av.antari.com
For Information requests please contact us
at: sales@antari.com



<http://www.antari.com.tw/index.php/mobile>

<http://www.antari.com/index.php/mobile>



Documents / Resources

	Antari Z-1520 RGB Fog Machine [pdf] User Manual Z-1520 RGB Fog Machine, Z-1520, RGB Fog Machine, Fog Machine, Fog
---	--

References

- [User Manual](#)

[Manuals+](#), [Privacy Policy](#)

This website is an independent publication and is neither affiliated with nor endorsed by any of the trademark owners. The "Bluetooth®" word mark and logos are registered trademarks owned by Bluetooth SIG, Inc. The "Wi-Fi®" word mark and logos are registered trademarks owned by the Wi-Fi Alliance. Any use of these marks on this website does not imply any affiliation with or endorsement.