



anslut 024724 Ceiling Led Instruction Manual

[Home](#) » [anslut](#) » anslut 024724 Ceiling Led Instruction Manual 

Contents

- [1 anslut 024724 Ceiling Led](#)
- [2 Product Information](#)
- [3 Product Usage Instructions](#)
- [4 SAFETY INSTRUCTIONS](#)
- [5 TECHNICAL DATA](#)
- [6 DESCRIPTION](#)
- [7 ASSEMBLY](#)
- [8 USE](#)
- [9 Documents / Resources](#)
 - [9.1 References](#)
- [10 Related Posts](#)



anslut 024724 Ceiling Led



Product Information

- **Product Name:** Ceiling LED
- **Model Number:** 024724
- **Manufacturer:** Jula AB
- **Copyright:** Jula AB claims copyright on the documentation

Technical Specifications

- **Voltage:** 230 V ~ 50 Hz
- **Power:** 24 W
- **Control Battery:** 2 x AAA
- **Color Rendering** Index (CRI): 80
- **Color Temperature:** 2700 K – 6500 K
- **Adjustable:** Yes
- **Lifespan:** 50,000 hours
- **IP Rating:** IP20
- **Weight:** 1009 g

Description

The Ceiling LED is a smart product that can be connected to existing WiFi and controlled through the Smart Life app or voice assistants. It does not require a separate hub or router. With the app, you can control all smart products and use features such as timer control, scheduling, and automated events.

System Requirements:

- WiFi router
- iPhone, iPad (iOS 11.0 or newer) or Android (5.0 or newer)
- Compatible with Google Assistant, Amazon Alexa, and more

Contents of the Package:

- Ceiling LED
- Screws (3x)
- Expansion plugs (3x)
- Silicone sleeves (2x)
- Remote control

Product Usage Instructions

Mounting

- Screw the ceiling plate of the LED fixture
- Connect the wiring terminals of the fixture.

Disassembling LED in the fixture

- Disconnect the phase and neutral wires.
- Remove the LED modules from the fixture.

Operation

- Use the remote control to adjust the brightness, switch between warm white and cool white light, set a 30-minute timer, and change the color temperature.
- The remote control also has a night mode and a mode selector for brightness.

Installing the App

- Download and install the Smart Life app on your smartphone.
- Register an account using the app.

Connecting the Product

- Make sure your WiFi is enabled and connected to the internet.
- Open the Smart Life app and follow the on-screen instructions to connect the Ceiling LED to your WiFi network.
- Once the connection is successful, the LED fixture will be displayed in the app. Please note that these instructions are a summary. For detailed instructions, refer to the original user manual or visit the Jula website for the latest version of operating instructions.

SAFETY INSTRUCTIONS



- For indoor use only.
- The light source cannot be replaced. If the light source fails, the entire product must be replaced.
- Always disconnect from the power supply before installation, connection and service.
- Do not connect the product to the mains while it is still in the pack.
- Check that all connecting cables comply with the applicable regulations and that they are connected correctly.
- Check that the mains voltage corresponds to the rated voltage on the type plate. Incorrect connection can result in electric shock. The electrical installation should be carried out by an authorized electrician.
- Never modify the product, this could result in serious personal injury and will invalidate the warranty.
- Never overload the mains. This can result in fire or a risk of electric shock.
- Keep out of the reach of children.
- Do not store the product in a damp or very cold/hot place to avoid damaging the electronics.
- The electronics in the product are sensitive to knocks and blows.
- Never attempt to replace damaged electrical cables yourself.
- The product must be discarded if the glass front is cracked.
- The LED light source is not replaceable. When the light source has reached the end of its useful life the complete product must be replaced.

WARNING!

New installations and extensions to existing systems must always be carried out by an authorized electrician. If you have the necessary experience and knowledge (otherwise contact an electrician), you can replace power switches and wall sockets, fit plugs, extension cords and light sockets. Incorrect installation can result in fatal

injury and the risk of fire.

SYMBOLS

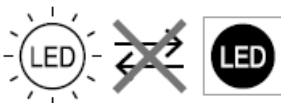
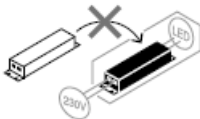
	Read the instructions.
	Approved in accordance with the relevant directives.
	Recycle discarded product in accordance with local regulations.
	The light source is not replaceable.
	Non-replaceable actuator.

TECHNICAL DATA

- Rated voltage 230 V ~ 50 Hz
- Power 24 W
- Battery for control 2 x AAA
- Colour rendering index CRI 80
- Colour temperature 2700 K – 6500 K
- Colour tone Adjustable
- Contains light source with energy class D
- Luminous flux 2400 lm 360°
- Life span 50000 h
- Protection rating IP20
- Size D 28 x Ø 420 mm
- Weight 1009 g

DESCRIPTION

This is a SMART product that can be connected to existing WiFi and controlled via the app Smart Life, or with a voice assistant. Does not require a separate hub/router. You can control all SMART products in the app and use functions such as timer control, scheduling and automatized events.

Alternatively it can also be controlled without WiFi and internet with the remote control. The remote control runs on 2 x AAA batteries (sold separately).

SYSTEM REQUIREMENTS

Check that the smartphone is connected to the 2.4 GHz WiFi network and switch on the light. WiFi router. iPhone, iPad (IOS 11.0 or higher) or Android (5.0 or higher). Compatible with Google Assistant, Amazon Alexa etc.

PACKAGE CONTENTS

1. Ceiling light
2. Screws, 3x
3. Expander plugs, 3x
4. Silicone sleeves, 2x
5. Remote control FIG. 1

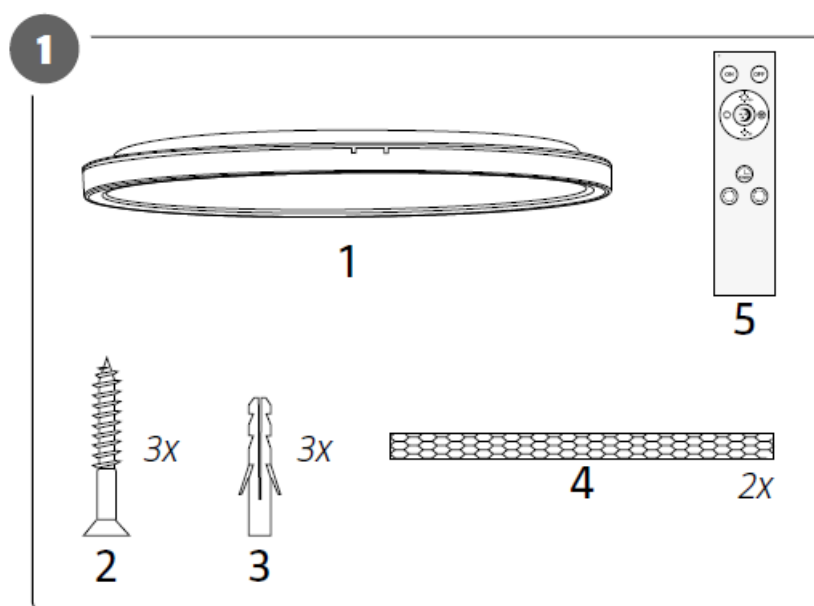

REMOTE CONTROL

		• Off/On
		• Dimmer brightness
		• Night mode
		• Warm white light
		• Cold white light
		• 30 minute timer
		• Changing of color temperature
		• Mode selector for brightness

ASSEMBLY

1. Switch off the power supply.

FIG. 2

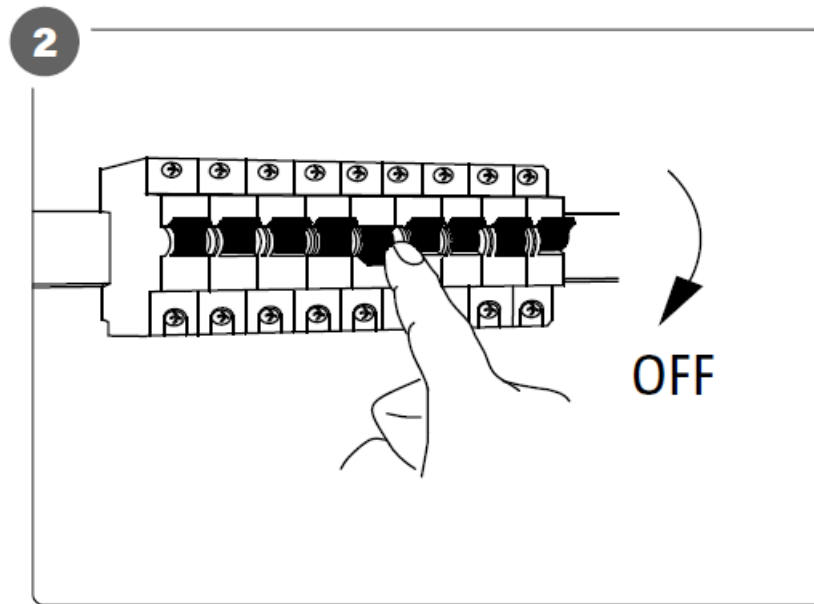

2. Mark where the light is to be mounted.
3. Drill holes for installation.
4. Insert expander plugs in the drilled holes.
5. Slide the silicone sleeves onto the two cables from the ceiling.
6. Screw up the ceiling plate for the ceiling light.

FIG. 3

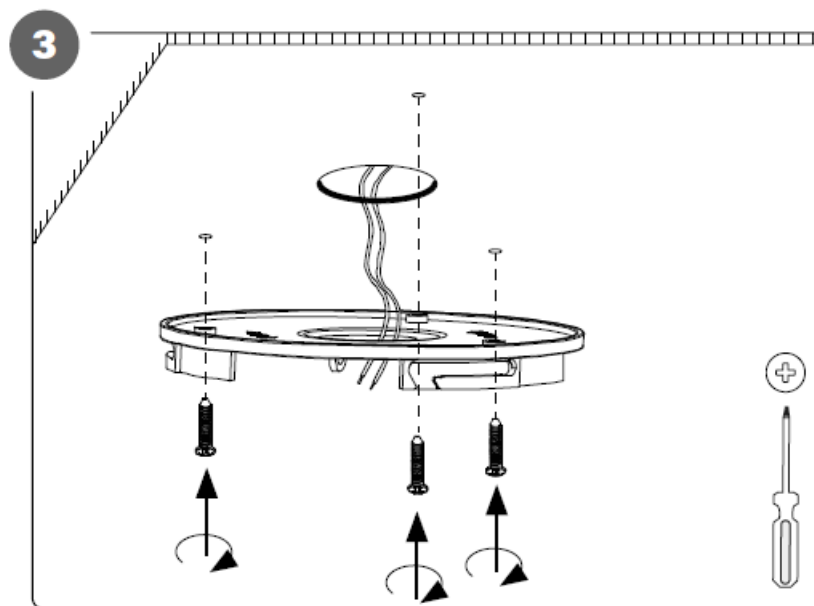

7. Hook in the hook from the ceiling light to the ceiling plate.

FIG. 4

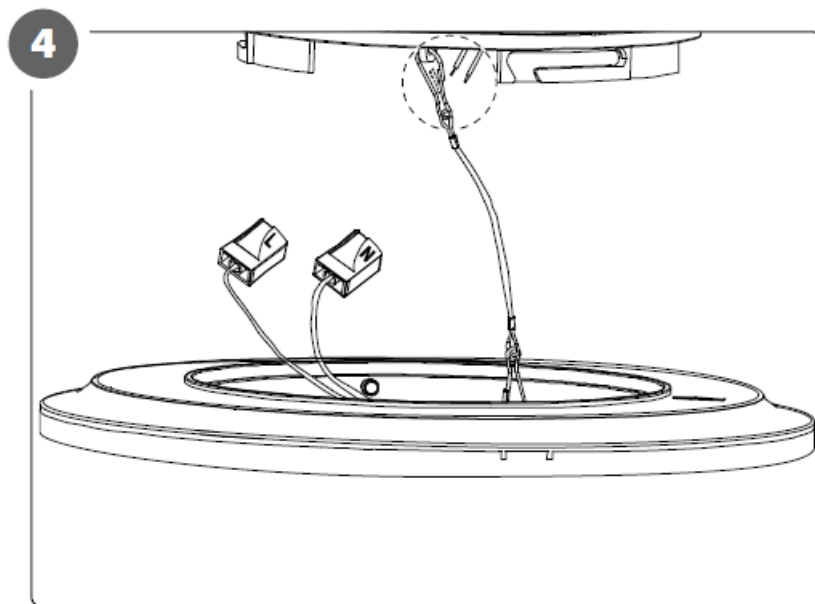

8. Connect the wires to the terminal blocks on the light.

FIG. 5

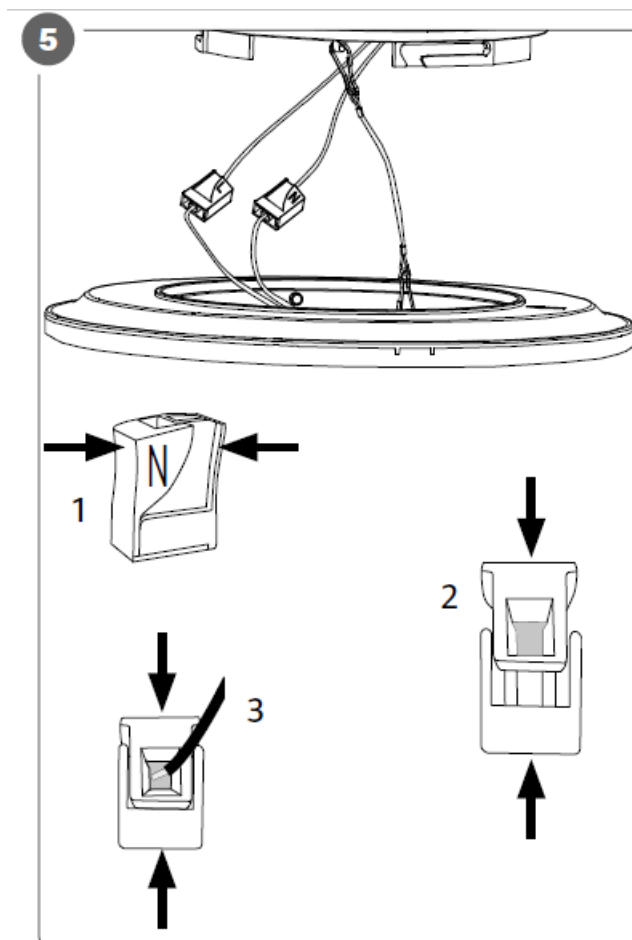

9. Attach the terminal blocks to their holders in the ceiling plate.

FIG. 6

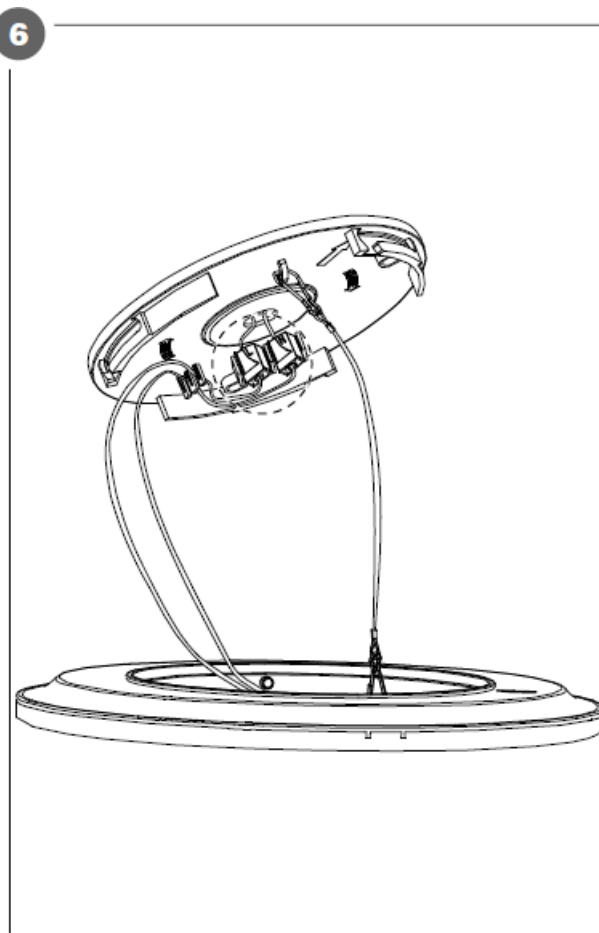

10. Fit the ceiling light with the plate.

FIG. 7

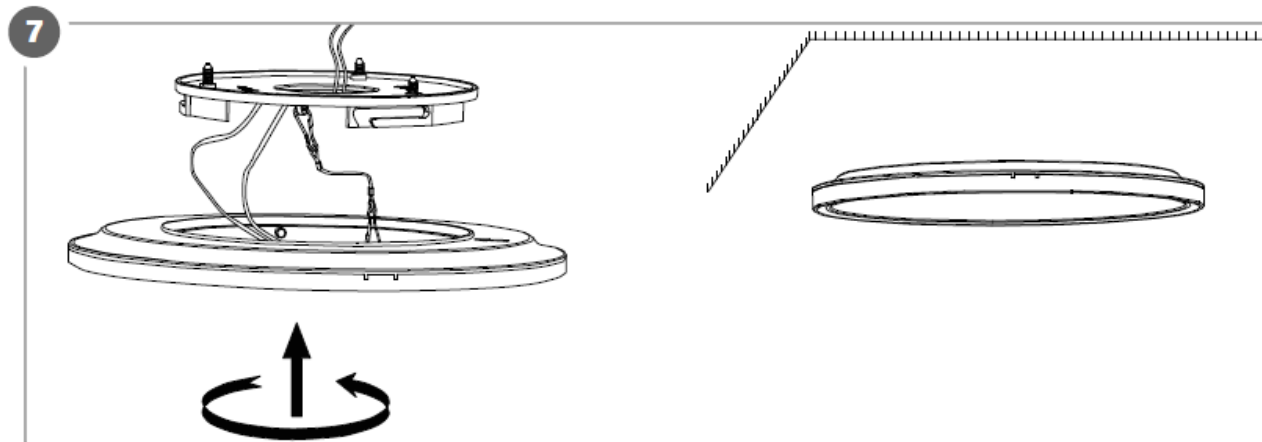

REMOVING THE LEDS IN THE FITTING

1. Open the lamp holder along the opening mark.

FIG. 8

8

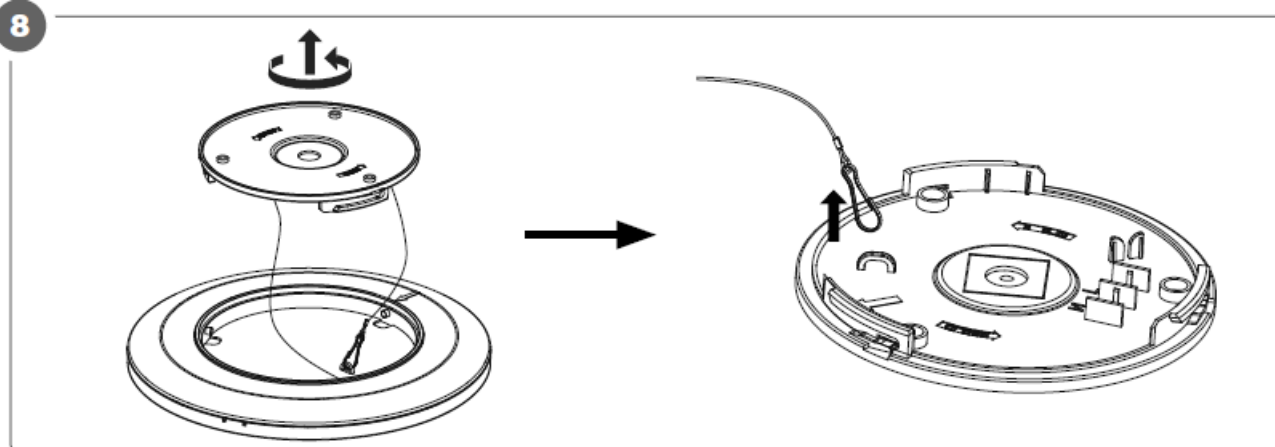

2. Disconnect the live wire and neutral wires.

FIG. 9

9

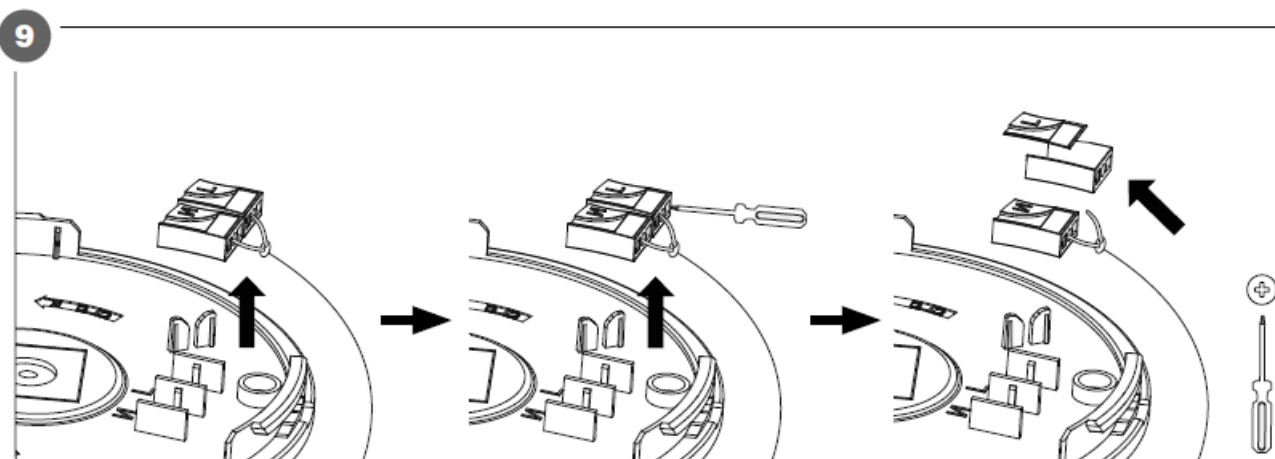

3. Remove the front frame.

FIG. 10

10

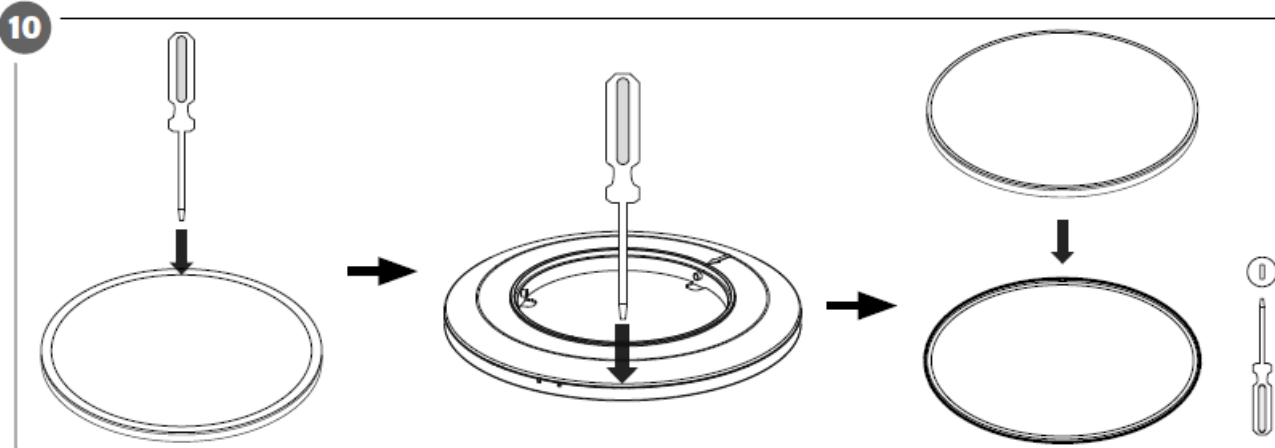

4. Undo the stress relief clip.

FIG. 11

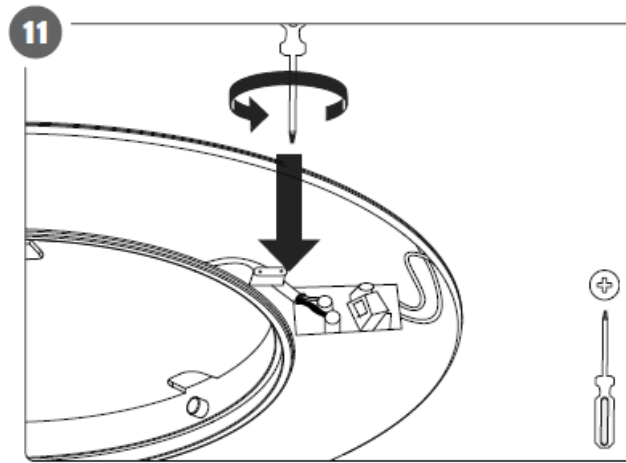

5. Remove the power switch.

FIG. 12

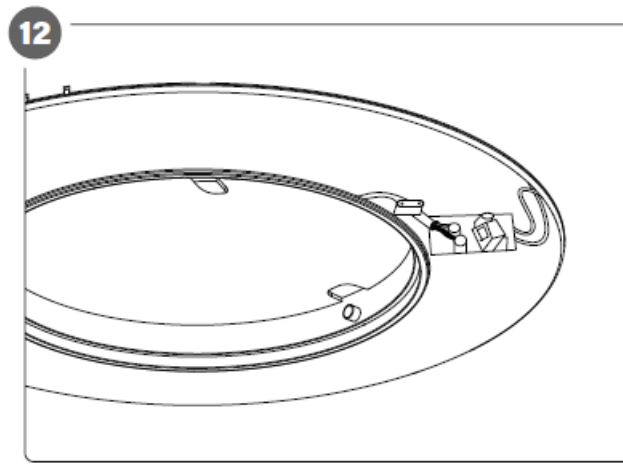

6. Remove the light source.

FIG. 13

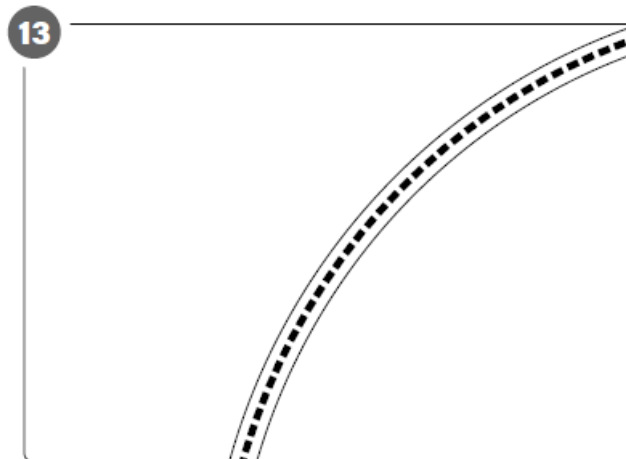

7. Light source and power switch.

FIG. 14

14

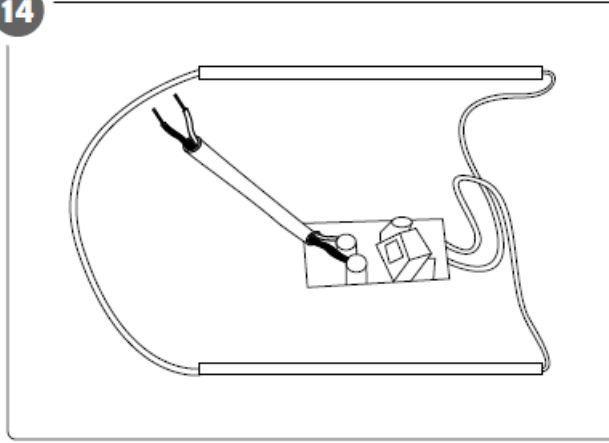

USE

INSTALL APP

1. Scan the QR code to download the Smart Life app. Or search at App Store or Google Play.

FIG. 15

15



2. Register account with mobile phone number or email address. A verification code is sent with SMS or email. Enter the code in the app and choose a password. If you already have an account, log in using your mobile phone number or email address and password.

FIG. 16

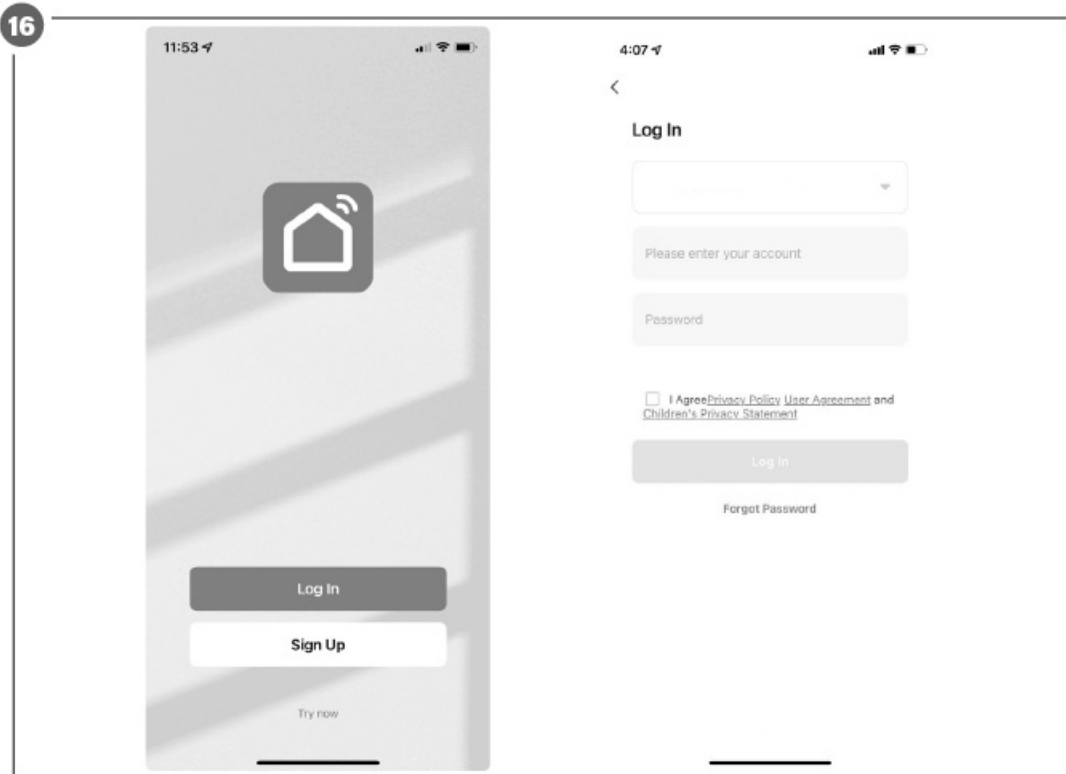

CONNECT PRODUCT

1. Check that the smartphone is connected to the WiFi network and that the ceiling light is switched on.
2. The ceiling light should flash rapidly in order to be connected to the Wi-Fi network. If the ceiling light does not flash rapidly when switched on with the power switch, press on/off 3 times in quick succession to reset the light source to pairing mode.
3. Press “+” (add device) to select the product category ceiling light (Lighting – Ceiling Light WiFi) and the follow the instructions on the screen.

FIG. 17

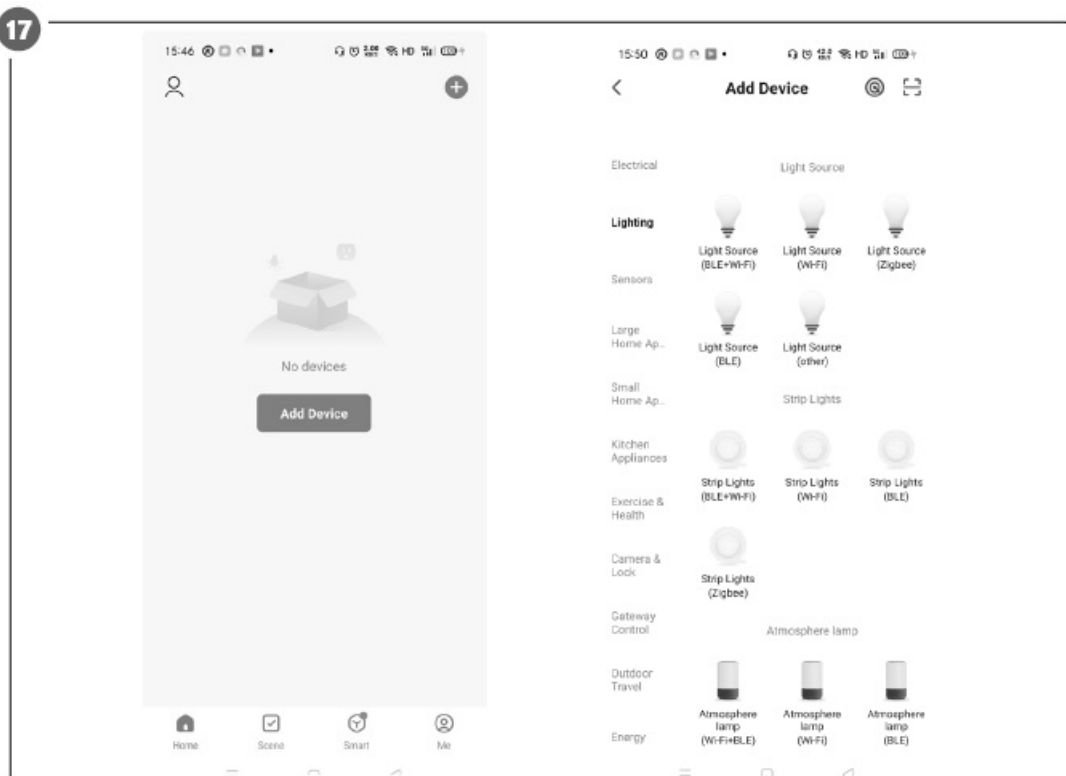

4. Enter the WiFi password and click on “Next” – “Confirm the indicator is blinking or breathing rapidly” – “Blink Quickly”.

FIG. 18

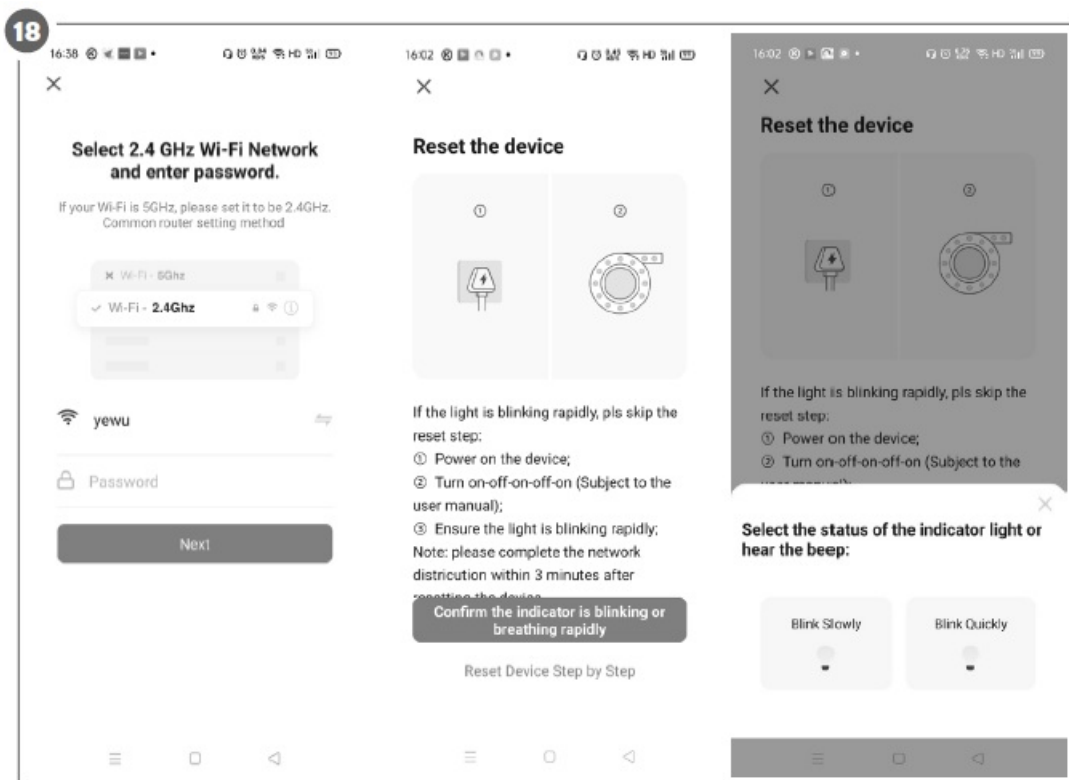

5. Click on “Done” when the connection is completed. If the connection is successful, the ceiling light will be shown in the app.

FIG. 19

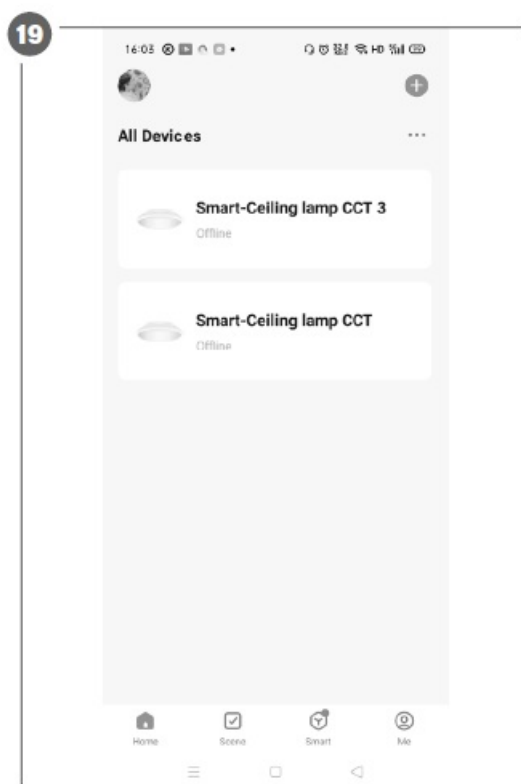

NOTE:

- Check that the smartphone has connected to a 2.4 GHz WiFi network (5 GHz WiFi is not supported) and press

the phone's Bluetooth button.

- Do not disconnect the power supply to the ceiling light when it is connected to WiFi.

Documents / Resources

 <p>anslut.</p> <p>CEILING LED</p> <p>024724 Ceiling Led, 024724, Ceiling Led, Led</p>	<p>anslut 024724 Ceiling Led [pdf] Instruction Manual</p> <p>024724 Ceiling Led, 024724, Ceiling Led, Led</p>
--	---

References

- [Jula](#) “products for home and garden”