



anslut 024369 Dimmable Globe LED Bulb Instruction Manual

[Home](#) » [anslut](#) » anslut 024369 Dimmable Globe LED Bulb Instruction Manual 

anslut 024369 Dimmable Globe LED Bulb Instruction Manual



SYMBOLS



Approved in accordance with the relevant directives.



Recycle discarded product in accordance with local regulations

Contents

[1 TECHNICAL DATA](#)

[2 DESCRIPTION](#)

[3 USE](#)

[4 Documents /
Resources](#)

[4.1 References](#)

[5 Related Posts](#)

TECHNICAL DATA

Rated voltage	230 V, 50 Hz
Output	4,9 W
Temperature range	-15 – 45°C
Diffusion angle	240°
Frequency	2.4 GHz
Socket	E14
Colour rendering index	CRI 80
Colour temperature	2700 – 6500 K
Colour tone	Adjustable
Equivalent x W incandescent bulb	40 W
Luminous flux	470 lm 360°
Life span	15000 h

DESCRIPTION

This is a SMART product that can be connected to existing Wi-Fi and controlled via the app Smart Life, or with a voice assistant. Does not require a separate hub/ router. You can control all SMART products in the app and use functions such as timer control, scheduling and automatized events.

- App controlled
- Switching On/Off of remote control switch from mobile phone
- Simple installation
- Supports Amazon Alexa and Google Assistant
- Supports Smart Remote control
- Supports control with only BLE gateway in the event of loss of WiFi.

- Supports Biorhythm
- Supports Scenario Mode for indication of user alignment function

SYSTEM REQUIREMENTS

WiFi router. iPhone, iPad (IOS 11.0 or higher) or Android (5.0 or higher). Compatible with Google Assistant, Amazon Alexa and others.

USE

INSTALL APP

Scan the QR code to download the Smart Life app. Or search on App Store or Google Play. **FIG. 1**



Start the app to register or log-in to your account.

Registration

Register with mobile phone number or email address. *Country settings follow the mobile telephone system, but it is possible to change country number/settings manually before registering is completed (cannot be changed after registering).

Login

If you already have an account, click on "Log in with an existing account" under "Create a new account", enter the mobile phone number or email address used to register and enter the password to log in, after which the operative system iOS can use Apple ID to log in.

CONNECT PRODUCT

1. The device distribution network only supports 2.4 GHz WiFi and Bluetooth. Activate the mobile phone's Bluetooth function and connect the 2.4 GHz WiFi network before the device is added.
2. Click on the button "Add device" in the middle of the screen, or click the + button on the top right. If the phone's Bluetooth function is activated the device information is shown automatically. "Add" can be selected to add the device to go directly to the WiFi password to complete the connection. **FIG. 2**

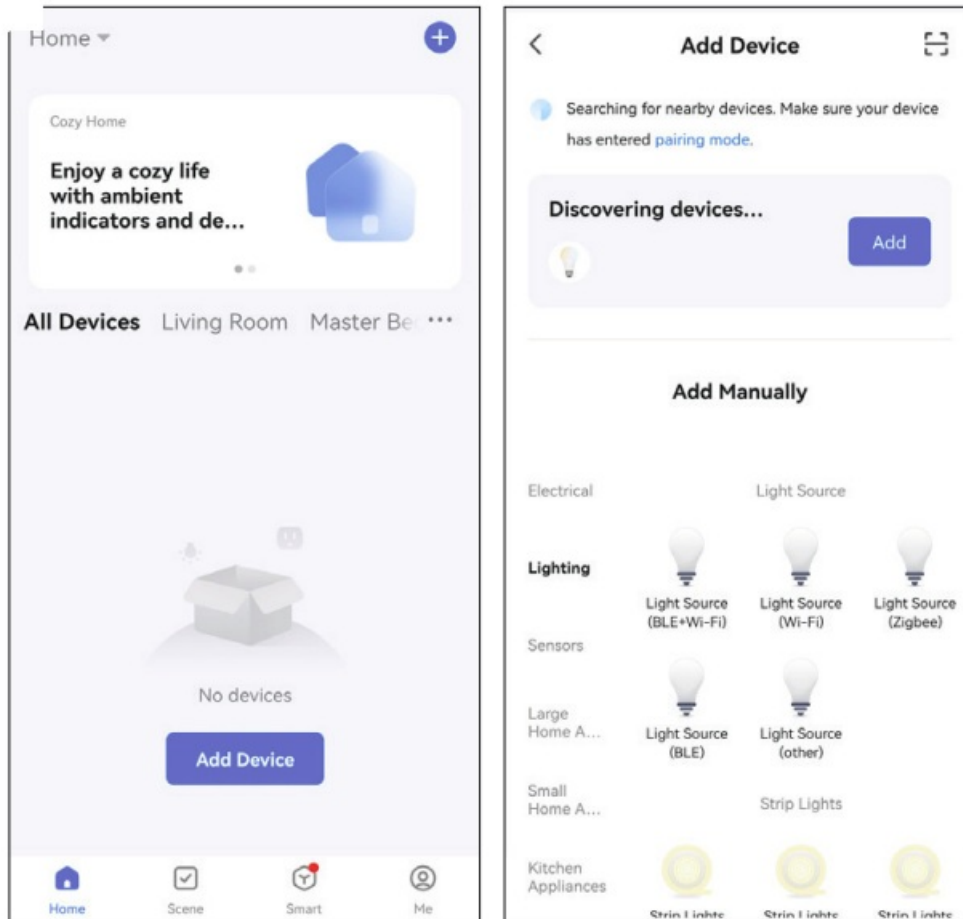

3. If the device information is not shown, select "Add Manually" or "Auto Scan" to add the device.

Add Manually (under Wi-Fi Mode)

Blinking or breathing (the light flashes quickly): press on/off/on/off/on in rapid sequence (within 2 seconds). After 3–5 seconds the light flashes rapidly (0.5 s interval) and the network connection process starts.

Blinking or breathing (the light flashes slowly): If the home network is a mixed 2.4 GHz/5 GHz network the following connection method should be used: press on/off/on/off/on in rapid sequence (within 2 seconds), when the light flashes rapidly (0.5 s interval) press off/on/off/on/off/on in rapid sequence (within 2 seconds). After 3–5 seconds the light flashes slowly (2 s interval), which means that the product has found the WiFi setting in the phone and pairing with WiFi hotspot and Smart Life can start. Click on the link, wait until the pairing is ready, return to the app and start the network connection process. FIG. 3

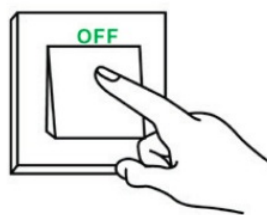
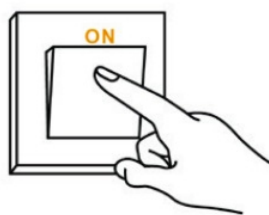
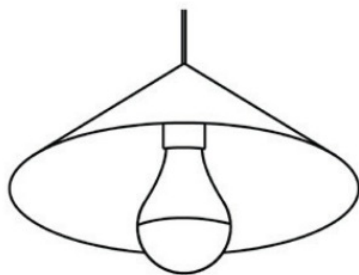

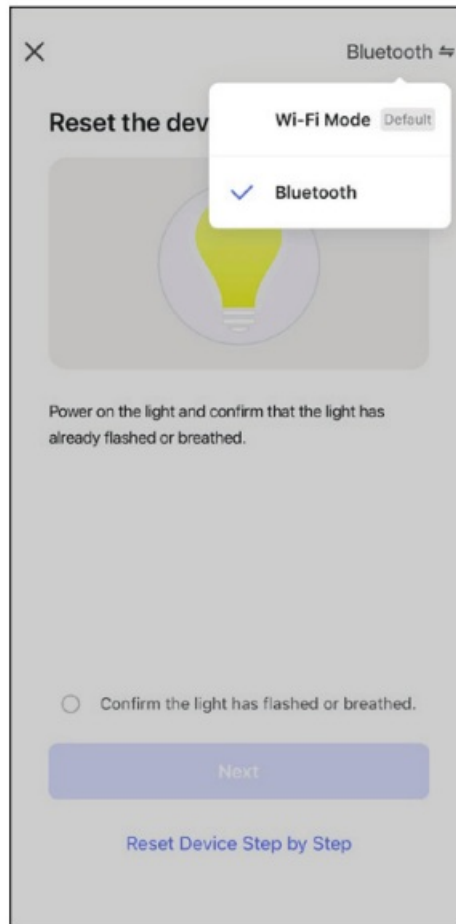
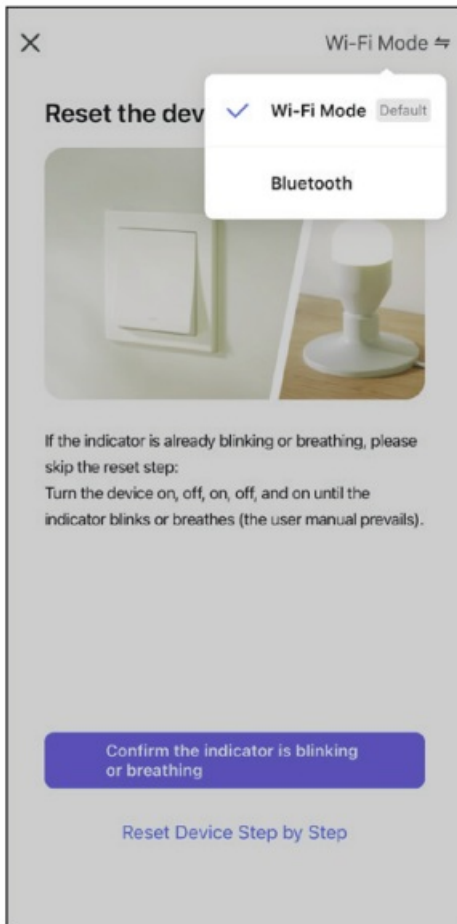

Auto Scan

1. When the light flashes rapidly (0.5 s interval) or slowly (2 s interval:), select "Auto Scan" to activate automatic searching after devices and start the network connection process. **FIG. 4**

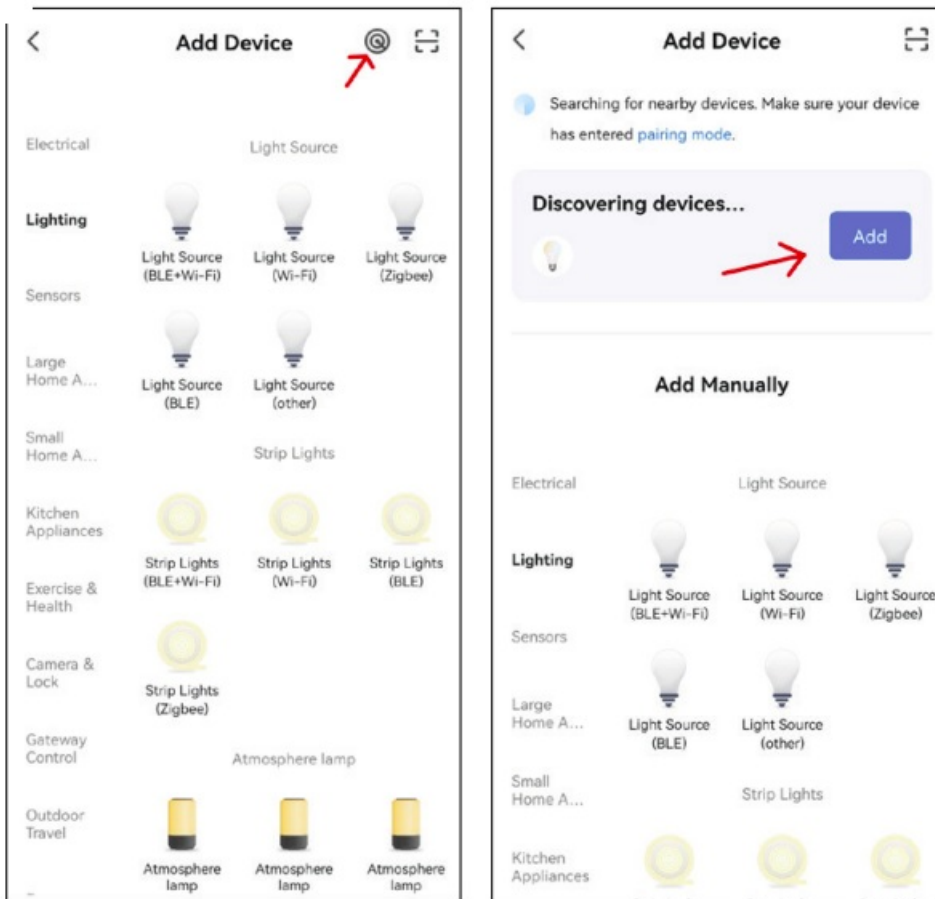

2. When the light flashes (rapidly or slowly) enter the WiFi password to complete the connection. (Only supports 2.4 GHz network.)

Tips: Normally the device connects to the network within 3 minutes. If the network connection is not made within 3 minutes the light stays on continuously. Repeat the connection process as per steps 3 and 4.

3. The status light goes on after connecting to the network and the functions scene, mode and timing etc. can be selected in the app. **FIG. 5**



Additional services are available in the app menu "Me", for example connection to Alexa and using voice controlled services in Google Assistant. Click on the required service and connect to the device for third party service according to the instructions.

Pairing of device

When the connection of the device is completed accounts can be added to share the device so that it can be controlled by other users.

In the app menu "Me" there is information, feedback and comments concerning commonly occurring problems.

NOTE:

Never attempt to use the light with incorrect voltage.

DIMMABLE GLOBE LED BULB

Operating instructions (Translation of the original instructions)

Important! Read the user instructions carefully before use. Save them for future reference. Julia reserves the right to make changes. For latest version of operating instructions, see www.jula.com

EU SAMSVARSKLÄRING

Tuotenumero

024369

Model no.: G45-14 WIFI+BLE DIM+CCT 4.9W E14 X-Y

Jula AB, Box 363, SE-532 24 SKARA, SWEDEN

Directive/ Regulation	Harmonised standard
RED 2014/53/EU	EN 300 328 V2.2.2, EN 301 489-1 V2.2.3, EN 50665:2017, EN 61547:2009, EN 61000-3-3:2013+A1, EN 62493:2015, EN 301 489-17 V3.2.4, EN 50663:2017, EN IEC55015:2019+A11, EN IEC 61000-3-2:2019+A1, EN 62560:2012+A11, IEC TR 62778:2014
Eco design Directive 2009/125/EC	
Lightsources Regulation (EU) 2019/2020 + (EU)2021/341	
RoHS 2011/65/EU + 2015/86	EN 50581:2012

Skara 2022-08-30



FREDRIK BOHMAN
BUSINESS AREA MANAGER



Documents / Resources

	anslut 024369 Dimmable Globe LED Bulb [pdf] Instruction Manual 024369 Dimmable Globe LED Bulb, 024369, Dimmable Globe LED Bulb, Globe LED Bulb, LED Bulb, Bulb
---	---

References

-  [Jula – products for home and garden](#)