



anslut 019941 Ceiling Light Instruction Manual

[Home](#) » [anslut](#) » anslut 019941 Ceiling Light Instruction Manual 

Contents

- [1 anslut 019941 Ceiling Light](#)
- [2 OPERATING INSTRUCTIONS](#)
- [3 INSTALLATION](#)
- [4 SAFETY INSTRUCTIONS](#)
- [5 Symbols](#)
- [6 TECHNICAL DATA](#)
- [7 PRODUCT INFORMATION SHEET](#)
- [8 Documents / Resources](#)
- [9 Related Posts](#)

anslut

anslut 019941 Ceiling Light



OPERATING INSTRUCTIONS

Important! Read the user instructions carefully before use. Save them for future reference. (Translation of the

original instructions)

- Jula reserves the right to make changes. For latest version of operating instructions, see www.jula.com

INSTALLATION

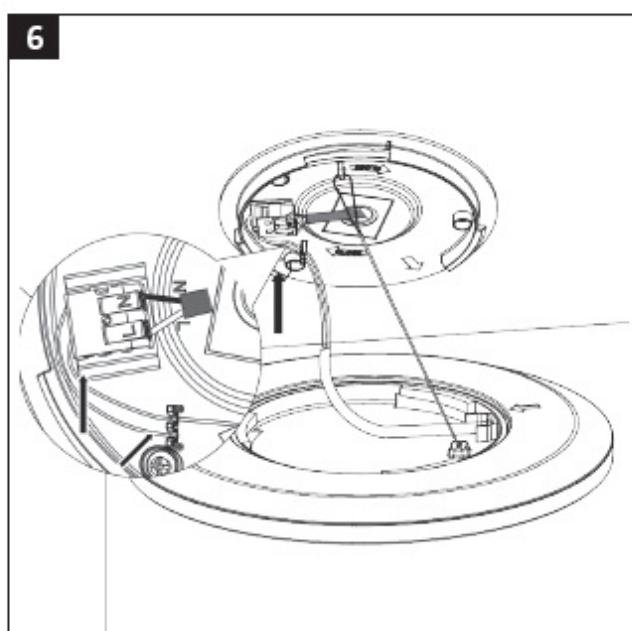
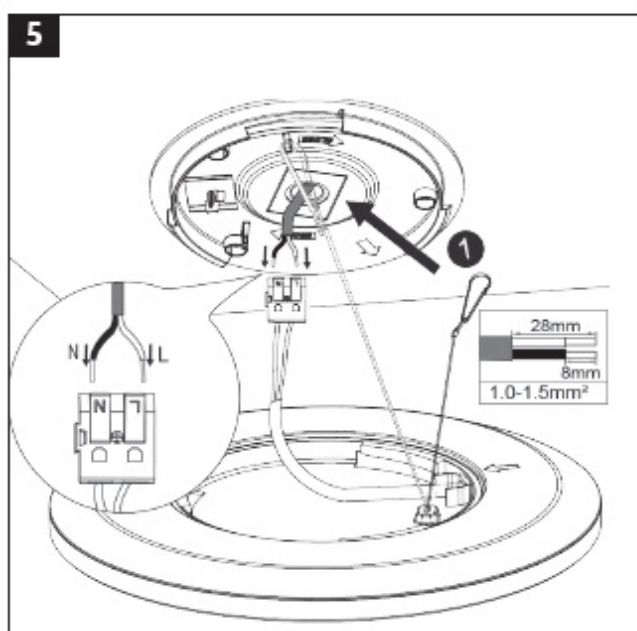
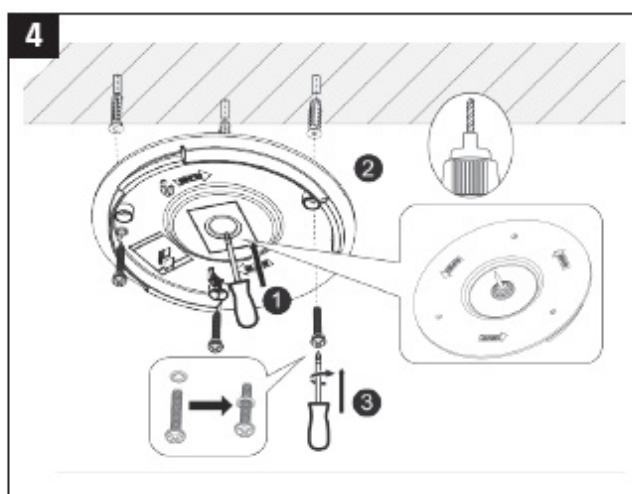
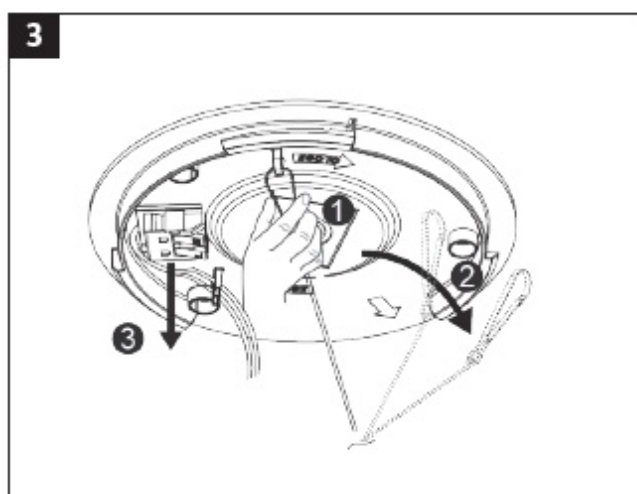
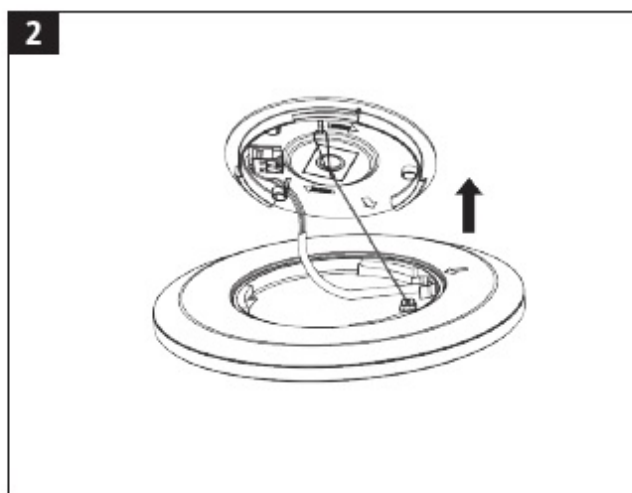
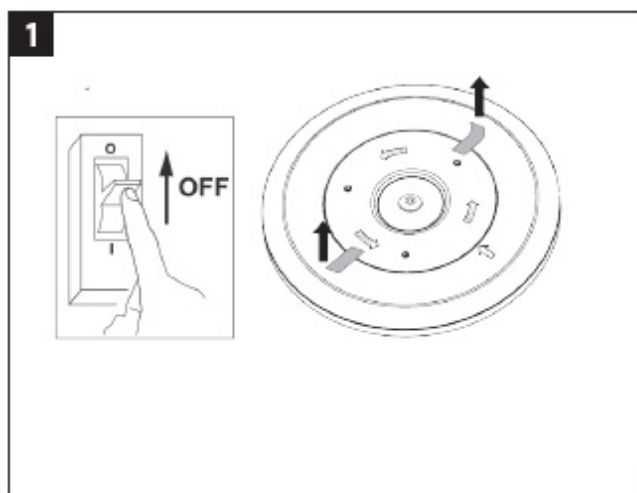

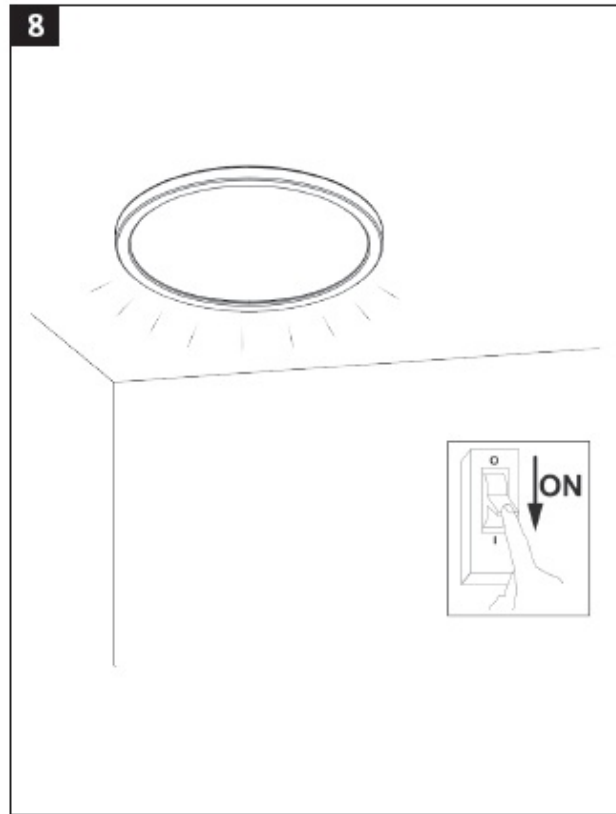
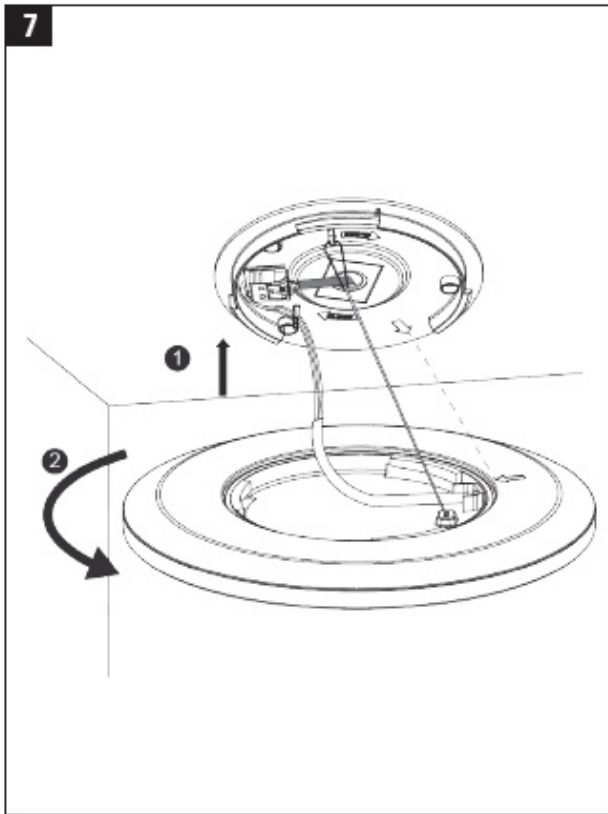







SAFETY INSTRUCTIONS

- Only intended for indoor use.
- The light source of this luminaire is not replaceable; when the light source reaches its end of life the whole luminaire shall be replaced.
- Always disconnect from the power supply before installation, connection and service.
- Do not connect the product to the mains while it is still in the pack.
- Check that all connecting cables comply with the applicable regulations and that they are connected correctly.
- Check that the mains voltage corresponds to the rated voltage on the type plate. Incorrect connection can result in a risk of electric shock. The electrical installation should be carried out by an authorised electrician.
- Never modify the product, this could result in serious personal injury and will invalidate the warranty.
- Never overload the mains. This can result in fire or a risk of electric shock.
- Keep out of the reach of children.
- Do not store the product in a damp or very cold/hot place to avoid damaging the electronics.
- The electronics in the product are sensitive to knocks and blows.
- Never attempt to replace damaged power cords yourself.
- The product must be discarded if the glass front is cracked.
- The LED light source is not replaceable. When the light source has reached the end of its useful life the complete product must be replaced.

WARNING!

New installations and extensions to existing systems should always be carried out by an authorised electrician. If you have the necessary experience and knowledge (otherwise contact an electrician), you can replace power switches and wall sockets, fit plugs, extension cords and light sockets. Incorrect installation can result in fatal injury and the risk of fire.

Symbols

	Read the instructions.
	Safety class II.
	Only intended for indoor use.
	Approved in accordance with the relevant directives.
	WARNING: Risk of electric shock.
	Recycle end-of-life product in accordance with local regulations.

TECHNICAL DATA

Rated voltage	220-240V ~ 50 Hz
Output	19 W
Luminous flux	2100 lm
Colour temperature	3000 K
Life span	30000 h
Off/On	30 000 times
Energy class	E
Dimmable	Yes
Safety class	II
Protection rating	IP54
Diffusion angle	120°
Size	Ø 424 x 23 mm

PRODUCT INFORMATION SHEET

Supplier's name or trademark:		Anslut	
Supplier's address (*):		Jula AB, Julagatan, 2, 53237 Skara, SE	
Model identifier:		019941	
Type of light source:			
Lighting technology used:	LED	Non-directional or directional:	NDLS
Light source connected to mains supply or light source not connected to mains supply:	MLS	Connected light source (CLS):	no
Colour-tuneable light source:	no	Envelope:	-
High luminance light source:	no		
Anti-glare shield:	no	Dimmable:	yes
Product parameters			
Parameter	Value	Parameter	Value
General product parameters:			
Energy consumption in on-mode (kWh/1000 h)	15	Energy efficiency class	E
Useful luminous flux (Φ_{use}), indicating if it refers to the flux in a sphere (360°), in a wide cone (120°) or in a narrow cone (90°).	2 100 in Sphere (360°)	Correlated colour temperature, rounded to the nearest 100 K, or the range of correlated colour temperatures, rounded to the nearest 100 K, that can be set.	3 000
On-mode power (P_{on}), expressed in W.	19,0	Standby power (P_{sb}), expressed in W and rounded to the second decimal.	0,00
Networked standby power (P_{net}) for CLS, expressed in W and rounded to the second decimal.	-	Colour rendering index, rounded to the nearest integer, or the range of CRI-values that can be set.	80
Outer dimensions without separate control gear, lighting control parts and non-lighting control parts, if any (millimetre).	Height	Spectral power distribution in the range 250 nm to 800 nm, at full-load.	See image in last page
	Width		
	Depth		
Claim of equivalent power (%)	-	If yes, equivalent power (W)	-
		Chromaticity coordinates (x and y)	0,434 0,403
Parameters for directional light sources:			
Peak luminous intensity (cd)		Beam angle in degrees, or the range of beam angles that can be set	
Parameters for LED and OLED light sources:			
R9 colour rendering index value	0	Survival factor	0,90
The lumen maintenance factor	0,96		
Parameters for LED and OLED mains light sources:			
Displacement factor ($\cos \phi_1$)	0,90	Colour consistency in mcadam ellipses	6
Claims that an LED light source replaces a fluorescent light source without integrated ballast of a particular wattage.	-(b)	If yes then replacement claim (W)	-
Flicker metric (Pst LM)	1,0	Stroboscopic effect metric (SVM)	0,4

Documents / Resources

	<p>anslut 019941 Ceiling Light [pdf] Instruction Manual 019941 Ceiling Light, 019941, Ceiling Light, Light</p>
---	--