



anslut 019915 LED Strip Instruction Manual

[Home](#) » [anslut](#) » anslut 019915 LED Strip Instruction Manual 



019915 LED Strip
Instruction Manual
LED STRIP
LED-LIST

anslut 019915 LED Strip - Featured Image



Contents

- [1 OPERATING INSTRUCTIONS](#)
- [2 SAFETY INSTRUCTIONS](#)
- [3 TECHNICAL DATA](#)
- [4 INSTALLATION](#)
- [5 USE](#)
- [6 REMOVAL](#)
- [7 Documents / Resources](#)
- [8 Related Posts](#)

OPERATING INSTRUCTIONS

Important! Read the user instructions carefully before use. Save them for future reference. (Translation of the original instructions)

Jula reserves the right to make changes.

For the latest version of operating instructions, see www.jula.com

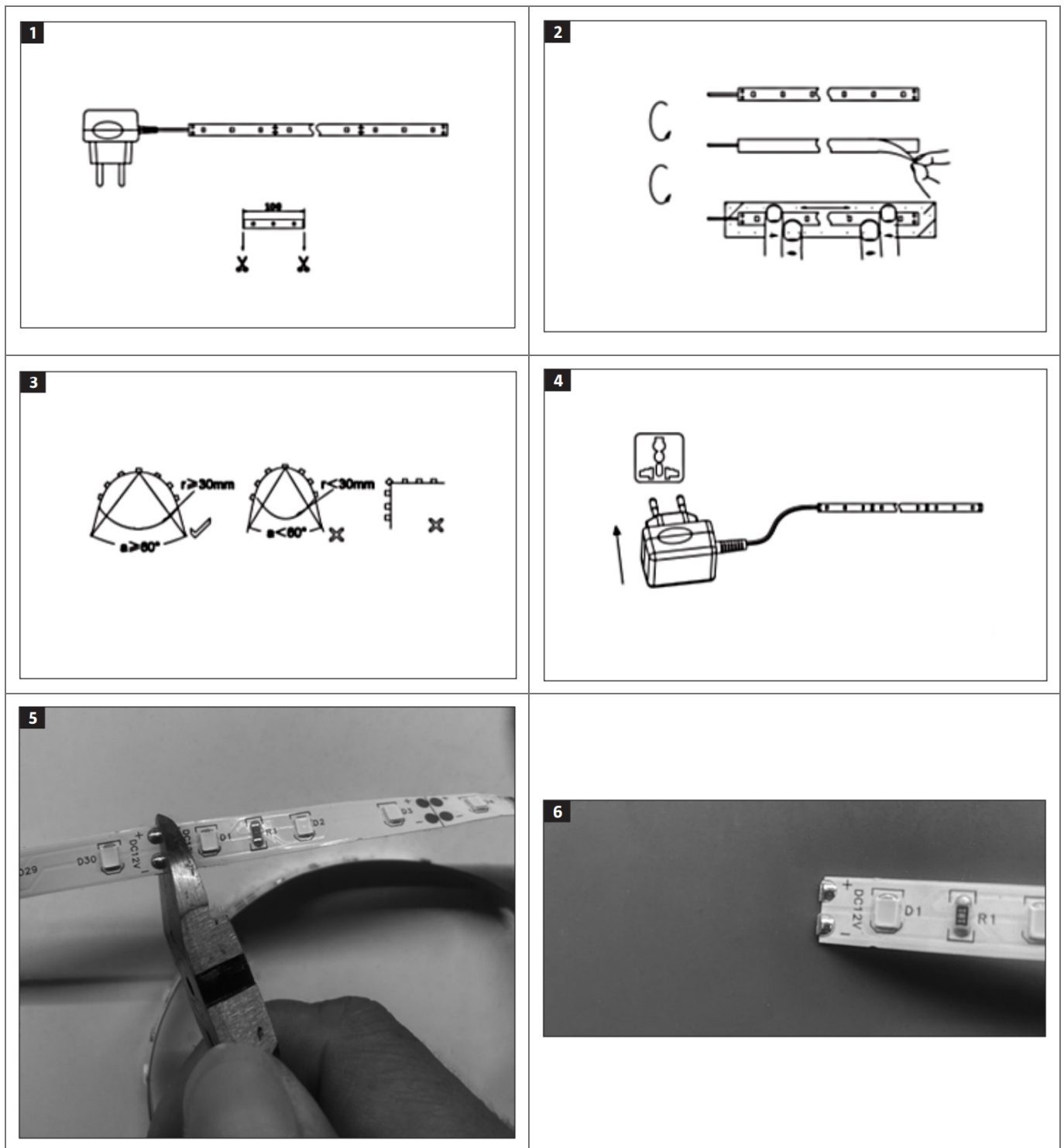





SAFETY INSTRUCTIONS

Carefully read the instructions before use!

- Save them for future reference.
- Check that all connections are properly made before switching on the product.
- If the product does not work, check that the circuit is supplied with voltage.
- Keep children at a safe distance from the product when it is in use.
- Exceeding the permitted maximum voltage can damage the product, or reduce its life span.
- If the permitted maximum temperature is exceeded this can also damage the product, or reduce its life span.

SYMBOLS

	Read the instructions.
	Only intended for indoor use.
	Safety class II.
	Approved in accordance with the relevant directives.
	Recycle discarded products in accordance with local regulations.

TECHNICAL DATA

Rated voltage	230 V ~ 50 Hz
Protection rating	IP20
Operating temperature	-20 to 40°C
Storage temperature	-20 to 45°C
Energy class	F
Life span	30000 h

019915

Output	4.5 W
No. of LEDs	60
Color temperature	2700 K
Luminous flux	450 lm
Size	2000 x 8 x 2 mm

019916

Output	16 W
No. of LEDs	180
Color temperature	2700 K
Luminous flux	1200 lm
Size	3000 x 8 x 3 mm

019917

Output	20 W
No. of LEDs	300
Color temperature	2700 K
Luminous flux	1600 lm
Size	5000 x 8 x 3 mm

INSTALLATION

FIG. 1

FIG. 2

FIG. 3

FIG. 4

USE

1. Remove the protective paper and attach the LED strip to the required place.
2. Plug the plug into a powerpoint.

REMOVAL

1. Cut off in the middle of the 50 mm long soldered joint.
2. Test the light source by connecting to 12 VDC.

FIG. 5

FIG. 6

2022-03-16

© Julia AB

JULA AB, BOX 363, SE-532 24 SKARA

Documents / Resources

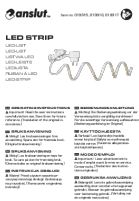
	anslut 019915 LED Strip [pdf] Instruction Manual 019915, 019916, 019917, LED Strip, 019915 LED Strip, Strip
---	--