



anslut 018834 Flood Light with Motion Detector Instruction Manual

[Home](#) » [anslut](#) » anslut 018834 Flood Light with Motion Detector Instruction Manual 

Contents

- [1 anslut 018834 Flood Light with Motion Detector](#)
- [2 SAFETY INSTRUCTIONS](#)
- [3 TECHNICAL DATA](#)
- [4 INSTALLATION](#)
- [5 OVERRIDING THE DETECTOR](#)
- [6 Documents / Resources](#)
- [7 Related Posts](#)

anslut

anslut 018834 Flood Light with Motion Detector



SAFETY INSTRUCTIONS

- Always switch off the power supply before installation, connection and service.
- The product must be connected to an earthed power supply on installation.
- The product can be mounted on a surface of flammable material.
- The recommended installation height is max 3 metres above the ground.
- Check that the mains voltage corresponds to the rated voltage on the type plate. Incorrect connection can result in electric shock. The electrical installation should be carried out by an authorised electrician.
- The product detects heat and movement and goes on when someone comes within the detection range. The product is not guaranteed to maintain security or prevent unauthorised entry.
- Never modify the product, this could result in serious personal injury and will invalidate the warranty.
- The product must be discarded if the glass front is cracked.
- The LED light source is not replaceable. When the light source has reached the end of its useful life the complete product must be replaced.



ELECTRICAL SAFETY

New installations and extensions to existing systems should always be carried out by an authorised electrician. If you have the necessary experience and knowledge (otherwise contact an electrician), you can replace power switches and wall sockets, fit plugs, extension cords and light sockets. Incorrect installation can result in fatal injury and the risk of fire.

SYMBOLS

-  DANGER: Risk of electric shock.

-  Approved in accordance

-   Recycle discarded product

TECHNICAL DATA

- Rated voltage 230 V ~ 50 Hz
- Output 20W
- Protection rating IP54
- Energy class f
- Luminous flux 1650 lm
- Colour temperature 4000 K
- Life span 30 000 h
- Detection range 10 m/120° (max)
- Dimmable No

INSTALLATION

1. Switch off the power supply. FIG. 1

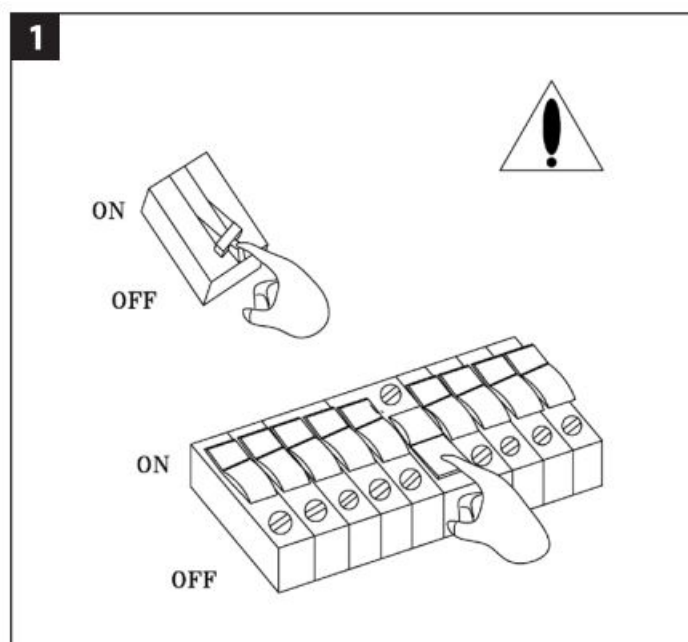

2. Remove the bracket from the housing. FIG. 2

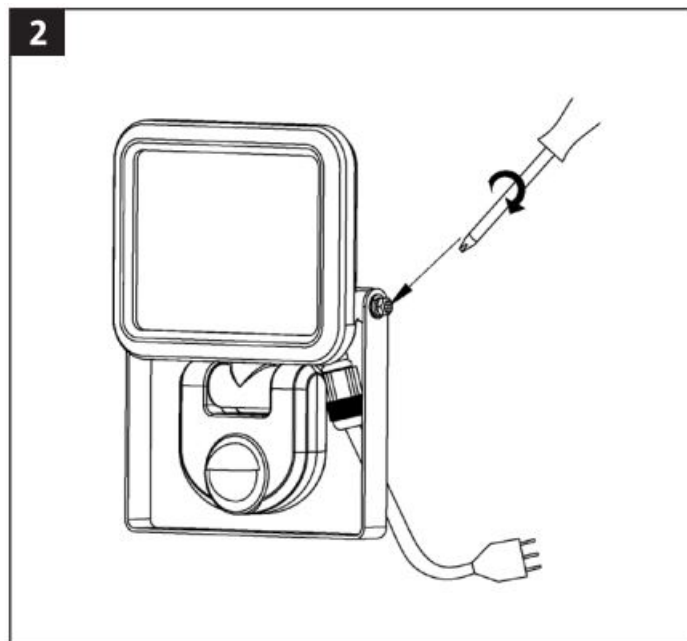

3. Use the bracket as a template to mark out the mounting holes and drill holes in these positions. Put expander plugs in the holes. Screw on the bracket.FIG. 3

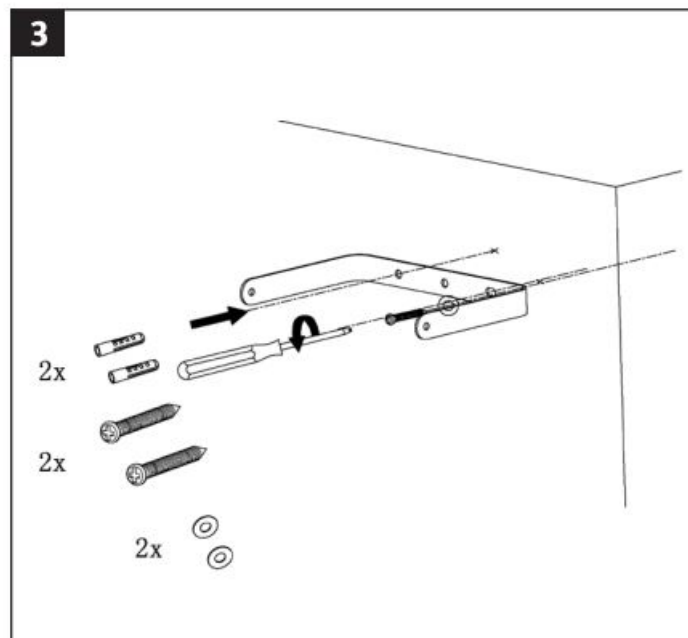

4. Fit the lamp housing on the bracket. FIG. 4

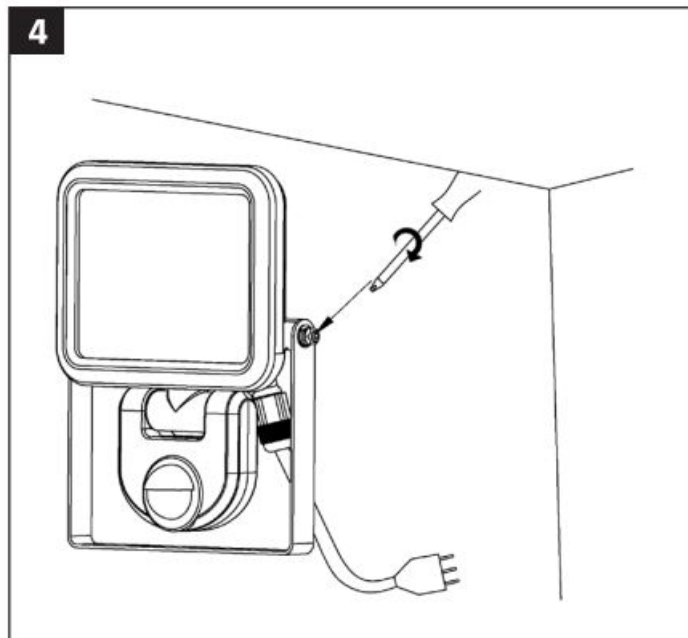

5. Connect the live wire L (brown), neutral wire N (blue) and earth wire (yellow/green). FIG. 5

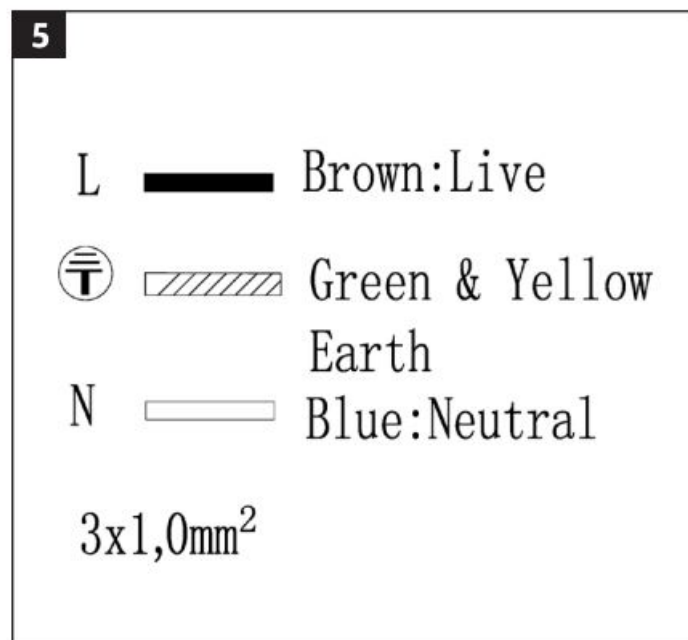

6. Fit the cable grommet. FIG. 6

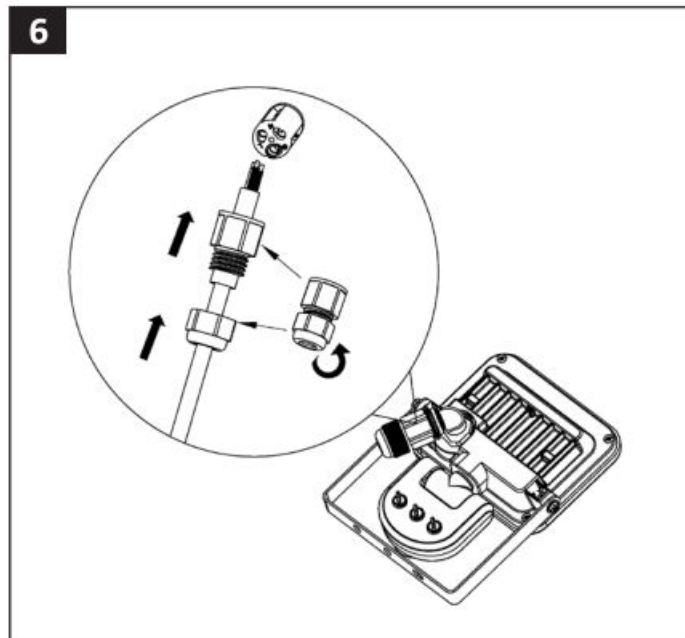

7. Put the power switch in the ON position. NOTE: The product is only intended to be mounted on a wall. The maximum mounting height is 3 metres.

1. The product can be angled down at 90° and angled up at 70°. FIG. 7

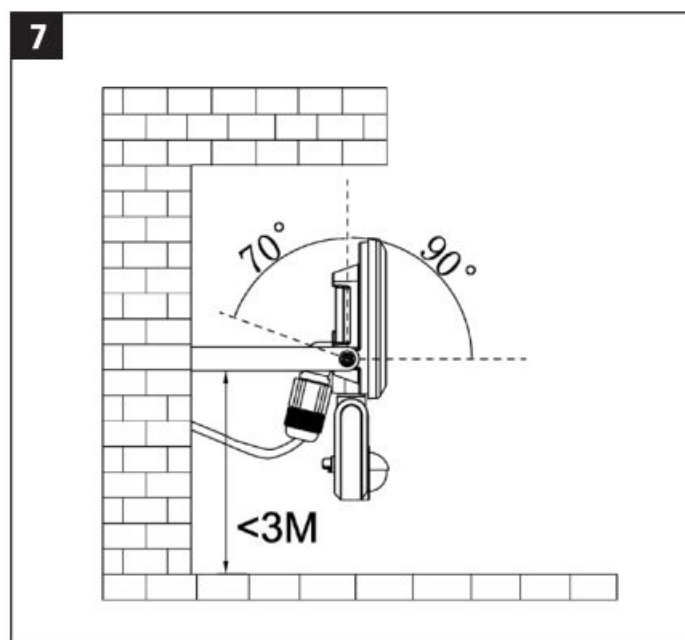

2. The detector can be turned 70° to the right and left, and up 90° and down 80°. FIG. 8

8

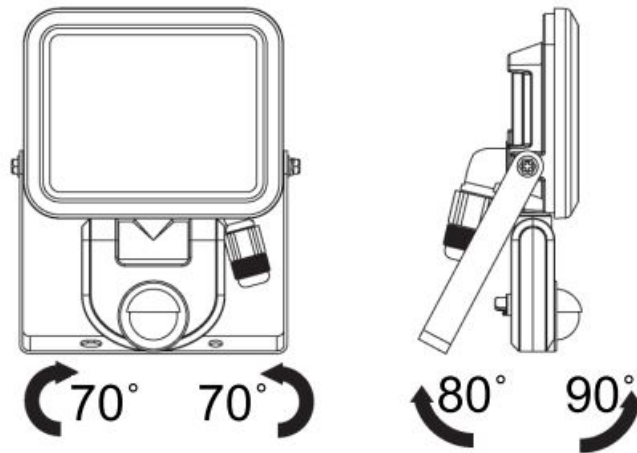

3. There are three control dials for the infrared detector.

1. TIME- To set how long the floodlight stays on.
2. LUX-To set the brightness of the floodlight.
3. SENS-To set the sensitivity of the detector.

TIME -TIME SETTING

This dial is used to set the time the light stays on after the last detected movement. The time interval is 10 seconds to 5 minutes. Turn the dial clockwise for shorter time and anticlockwise for longer time.FIG. 9

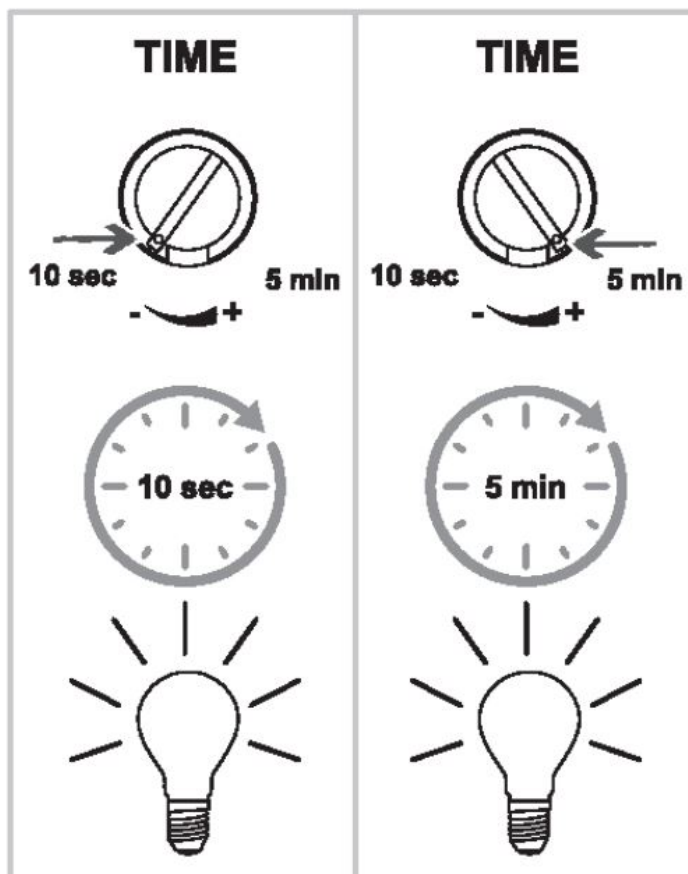
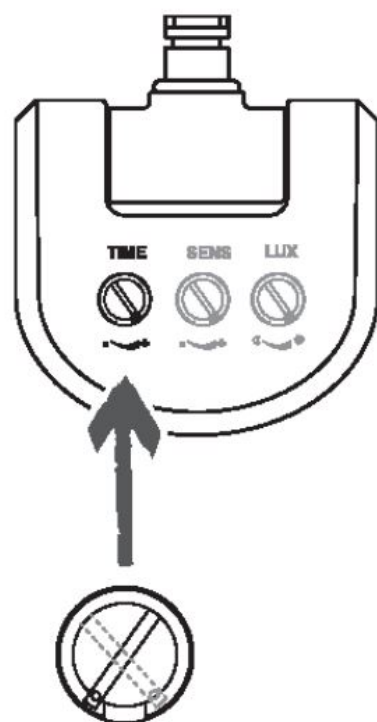

LUX -TO ADJUST THE BRIGHTNESS

This dial is used to set the brightness at which the detector switches on the light. With the dial set to the sun symbol the light goes on both during the day (bright surrounding light) and night (poor surrounding light), and with the dial set to the moon symbol the light only goes on at night. To correctly set the brightness, wait until the surrounding light reaches the required brightness. Turn the dial all the way to the moon symbol. Now turn the dial slowly back to the sun symbol until the movement detector switches on the light. The light will now switch on when movement is detected and the surrounding light is the same as or less than the brightness setting. FIG. 10

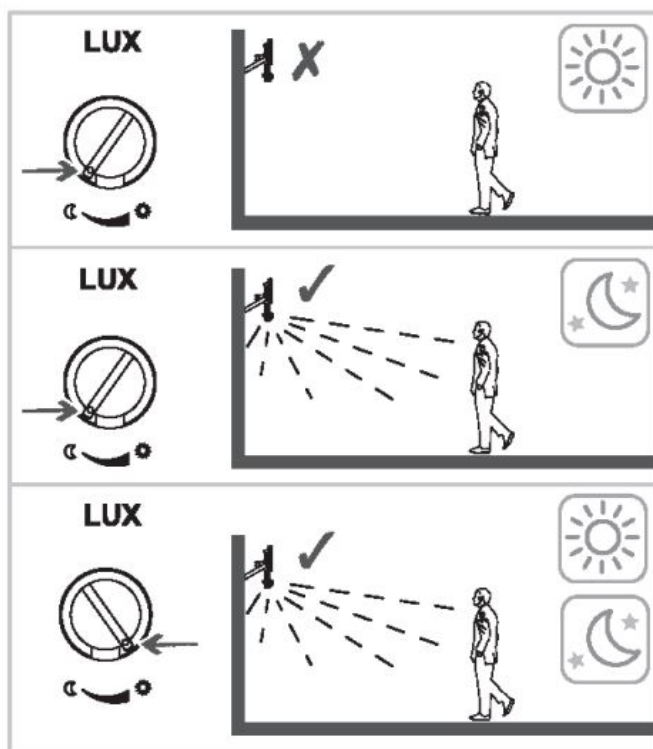

SENS -DETECTOR SENSITIVITY

The sensitivity of the detector varies with the ambient temperature. The sensitivity is higher at low ambient temperature. The detector is most sensitive when the SENS dial is turned all the way to(+).FIG. 11

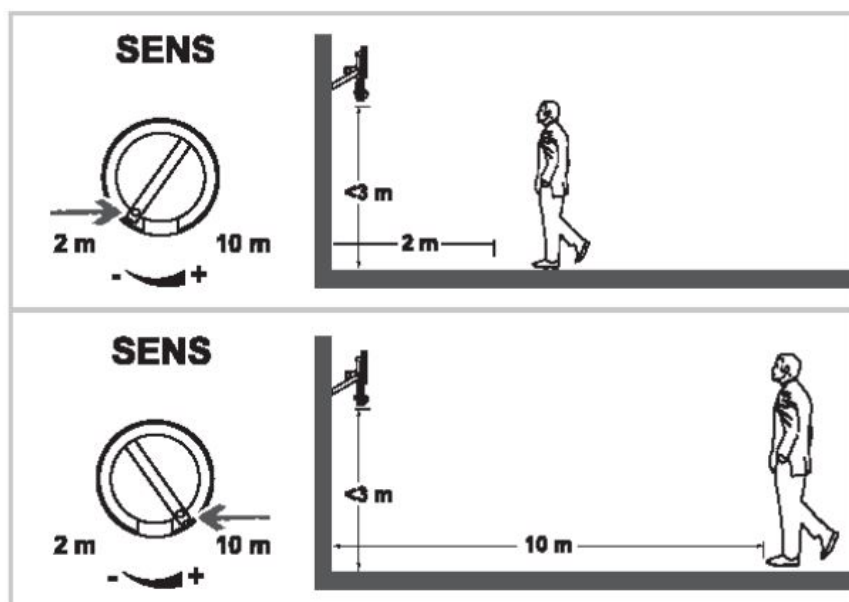
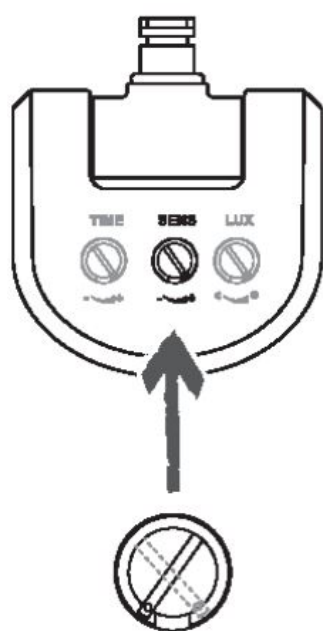

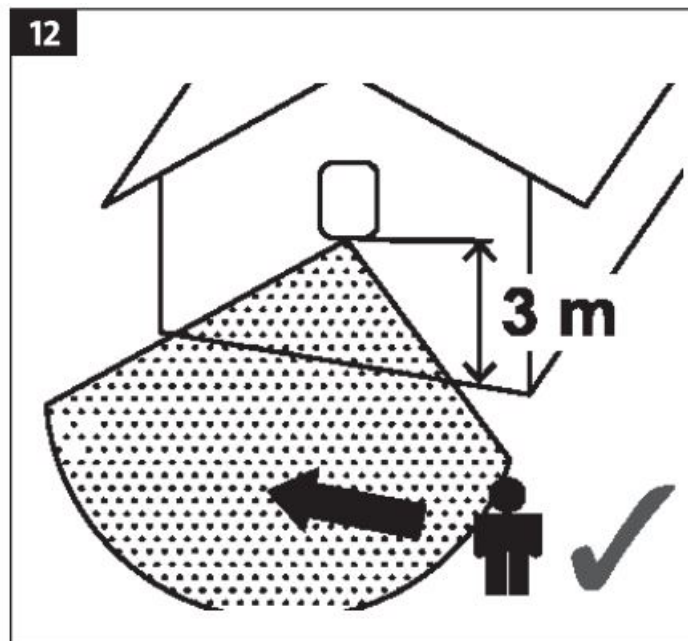

FIG. 12

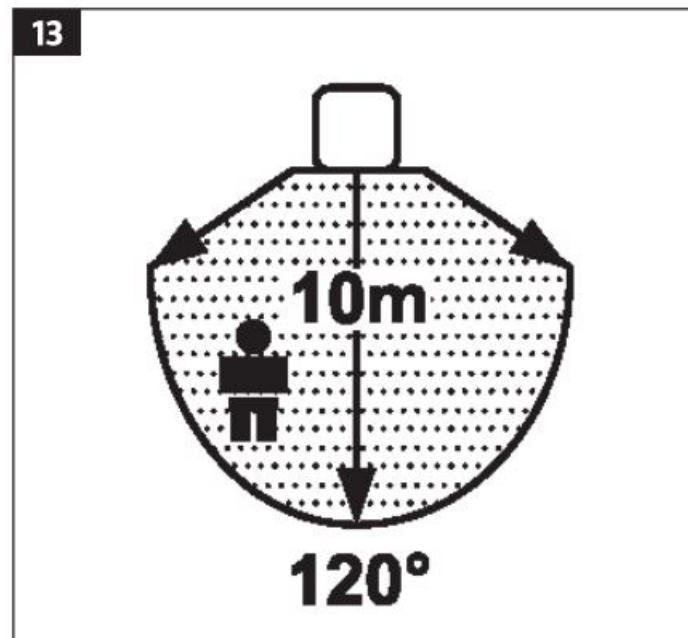

FIG. 13

OVERRIDING THE DETECTOR

1. Activate detector override. FIG. 14

