



## anslut 015591 Ceiling LED Light Instruction Manual

[Home](#) » [anslut](#) » anslut 015591 Ceiling LED Light Instruction Manual 



**CEILING LED**  
**PLAFOND LED**



### OPERATING INSTRUCTIONS

An Important! Read the user instructions carefully before use. Save them for future reference. (Translation of the original instructions)

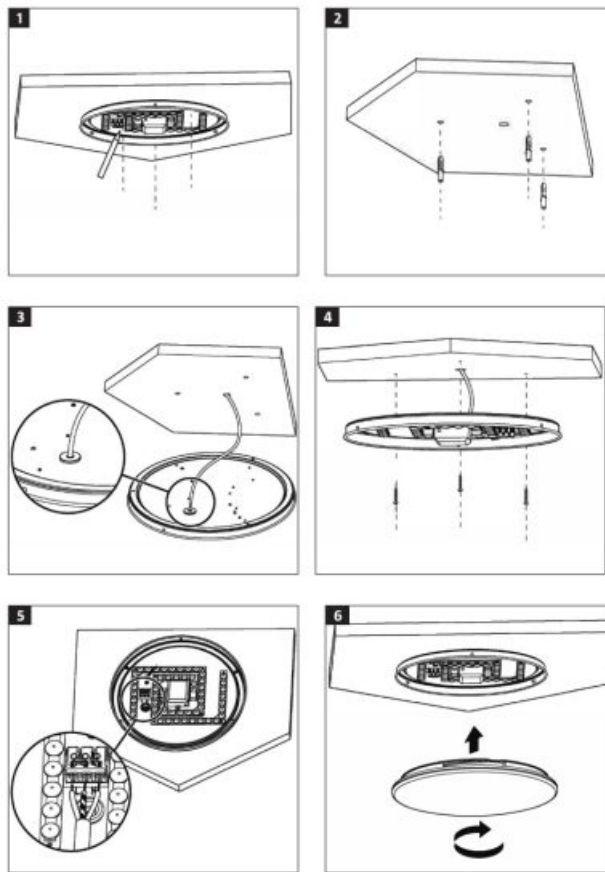

## SAFETY INSTRUCTIONS

- Read these instructions carefully before installing the product. New installations and extensions to existing systems should always be carried out by an authorized electrician.
- Only intended to be used indoors.
- Designed for installation on the ceiling.
- The light source must only be replaced by a specialist.
- Disconnect the power supply before starting the installation.
- The product must not be covered with anything that obstructs ventilation, e.g. insulation, foil, paper, plastic, or the equivalent.
- Check that the mains voltage corresponds to the rated voltage on the type plate.
- Always follow the electrical specifications on the product labeling.
- Never modify the product, this could result in serious material damage/personal injury, and will invalidate the warranty.
- Check that no parts of the product are missing or damaged. Replace damaged parts before installation.
- Never touch the product when it is in use. Switch off the product and allow it to cool before touching it.
- Do not install the product near sources of heat, or in damp conditions.
- If the cable to this light is damaged it must only be replaced by the manufacturer or service technician, or another qualified person, to eliminate any risks.

## ELECTRICAL SAFETY

New installations and extensions to existing systems should always be carried out by an authorized electrician. If you have the necessary experience and knowledge (otherwise contact an electrician), you can replace power switches and wall sockets, fit plugs, extension cords, and light sockets. Incorrect installation can result in fatal

injury and the risk of fire.

Contents

1 SYMBOLS

2 TECHNICAL DATA





3 INSTALLATION

4 MAINTENANCE

5 Documents / Resources

6 Related Posts

SYMBOLS

	Read the instructions.
	intended to be used indoors.
	The product is not dimmable.
	Approved in accordance with the relevant directives.
	Recycle discarded products in accordance with local regulations.

TECHNICAL DATA

Rated voltage	230 V – 50 Hz/12 VDC
Output	12 W
Protection rating	IP20
Energy class	F
Light source	1200 l'm
Color temperature	2700 K
CRI	≥80
Life span	20000 h
On/Off	10000 times
Dimmable	No
Diffusion angle	120°
Weight	430 g

INSTALLATION

IMPORTANT:  
Disconnect the power supply before installing the product.

- 1. Mark where the light is to be mounted.  
FIG. 1
- 2. Drill holes for installation.
- 3. Insert expander plugs in the drilled holes.

- FIG. 2
- 4. Insert the mains wire through the grommet in the light.

- FIG. 3
- 5. Fasten the light to the ceiling with screws.  
FIG. 4
- 6. Connect the wires to the terminal block on the light.

- FIG. 5
- 7. Screw the glass on the light.  
FIG. 6
- 8. Switch on the power supply.

MAINTENANCE

IMPORTANT:  
Disconnect the power supply before cleaning the product. 1. Wipe the light with a dry or slightly damp cloth. 2. Wait until the light is completely dry before switching the power supply on again.

NOTE:  
Do not use detergents, alcohol, solvents, or the equivalent to clean.

Documents / Resources

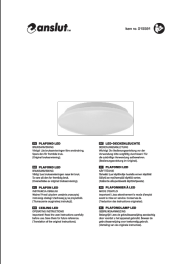
	<a href="#">anslut 015591 Ceiling LED Light</a> [pdf] Instruction Manual 015591, Ceiling LED Light
	<a href="#">anslut 015591 Ceiling LED Light</a> [pdf] Instruction Manual 015591, Ceiling LED Light, 015591 Ceiling LED Light