



anslut 014780 Floor Fan with Remote Control Instruction Manual

[Home](#) » [anslut](#) » anslut 014780 Floor Fan with Remote Control Instruction Manual 

Contents

- 1 [anslut 014780 Floor Fan with Remote Control](#)
- 2 [SAFETY INSTRUCTIONS](#)
- 3 [TECHNICAL DATA](#)
- 4 [DESCRIPTION](#)
- 5 [ASSEMBLY](#)
- 6 [HOW TO USE](#)
- 7 [REMOTE CONTROL](#)
- 8 [MAINTENANCE](#)
- 9 [Documents / Resources](#)
 - 9.1 [References](#)
- 10 [Related Posts](#)



anslut 014780 Floor Fan with Remote Control



SAFETY INSTRUCTIONS

1. Only intended to be used indoors.
2. This product can be used by children from eight years and upwards and by persons with physical, sensorial or mental disabilities, or persons who lack experience or knowledge, if they are supervised or receive instructions concerning the safe use of the product and understand the risks involved with its use. Do not allow children to play with the product.
3. The product must only be used for its intended purpose and in accordance with these instructions.
4. Do not cover the product, this can result in overheating or fire.
5. Place the product standing upright on a level, stable surface.
6. When using the product it must always stand upright- it must never be used on its side.
7. Pull out the plug from the power point when the product is not in use. Do not pull the power cord to pull out the plug.
8. Leave a free space of at least
9. 30 cm round the product to ensure safe and correct functionality.
10. Check that the product can oscillate without colliding with or being obstructed by anything in the near vicinity.
11. Never poke any objects into the grille in the product. It is especially important to explain this to children to make

sure they understand the risks.

12. Do not use the product if the power cord or plug are damaged, if the product has tipped over, or if it is not working properly.
13. A damaged cord or plug must be replaced by an authorized service center or qualified person to ensure safe use.
14. Do not use the product near a bath, shower, or swimming pool.
15. Do not expose the product to direct sunlight.
16. Do not use the product together with an external speed controller.
17. Do not use the product near flammable liquids or gas.
18. Switch off the product and pull out the plug before cleaning.
19. Never leave the product unattended when switched on.
20. Repairs must only be carried out by an authorised service centre.
21. If the product stops working properly, switch it off with the switch on the control panel and contact the retailer

SYMBOLS

1. Read the instructions.
2. Safety class II.
3. Approved in accordance with the relevant directives.
4. Recycle discarded product in accordance with local regulations.

TECHNICAL DATA

1. Rated voltage 230 V ~ 50 Hz
2. Input power 19W
3. Safety class II

DESCRIPTION

1. Plastic nut
2. Hub nut
3. Rear grille
4. Fan blade
5. Front grille
6. Screw
7. Washer
8. Foot
9. Bottom upright
10. Top upright with control panel
11. Motor unit

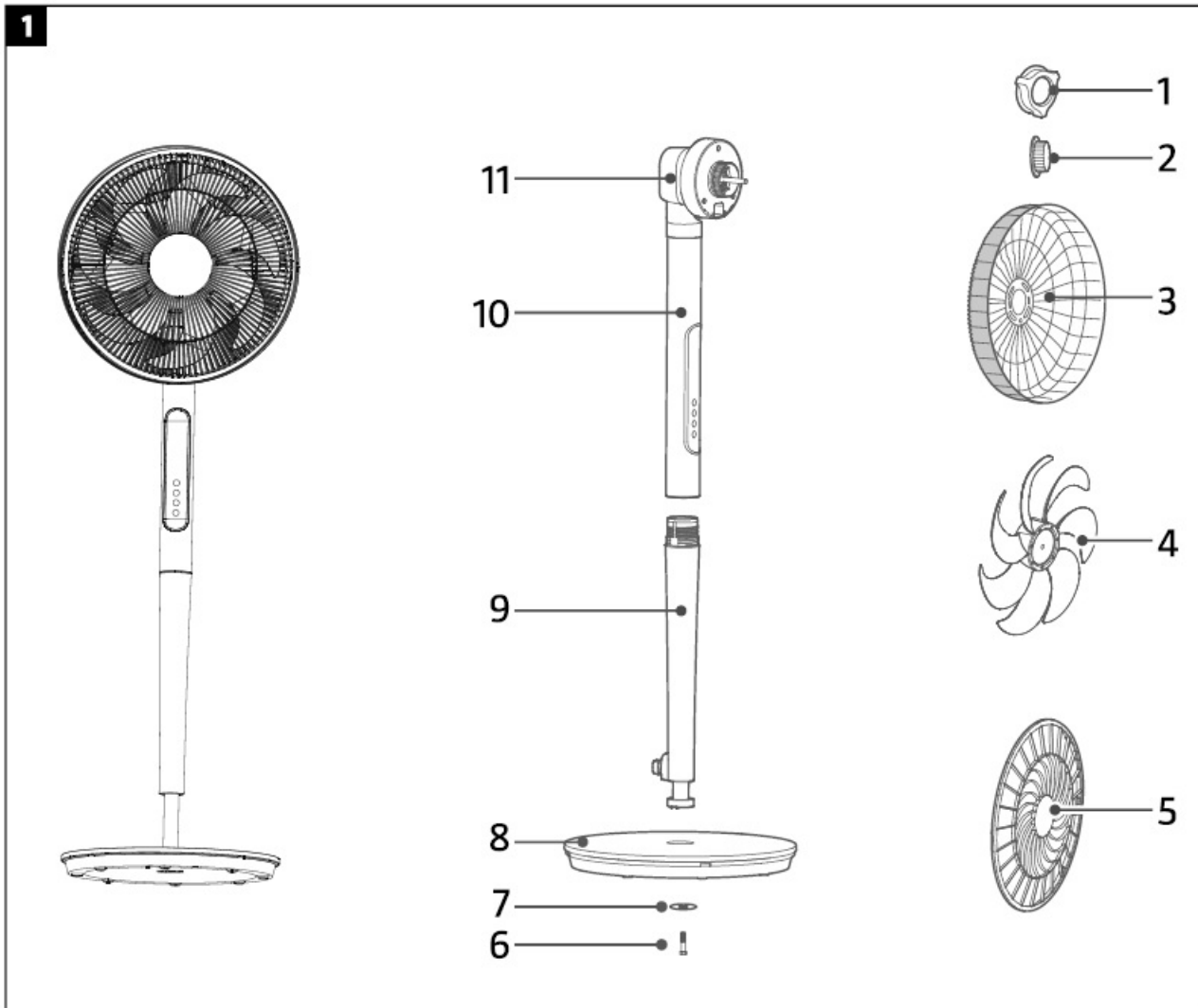

ASSEMBLY

- Put the bottom upright in the foot and screw in place with screw and washer. FIG. 2

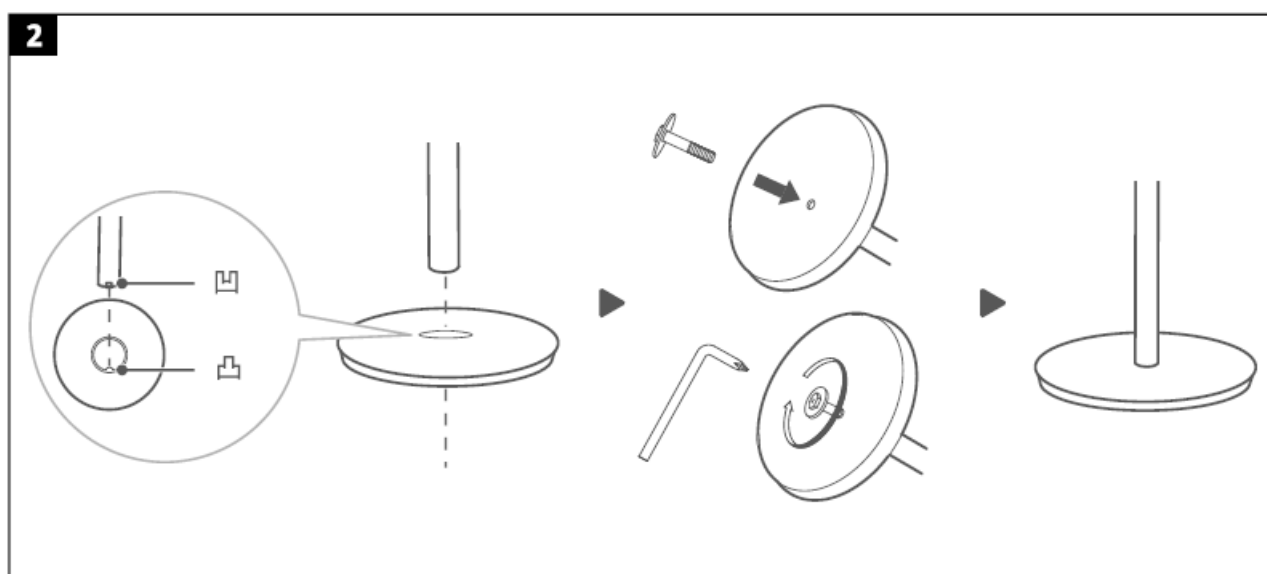

- Screw the motor unit on the top upright.
- Join the top and bottom uprights to each other.
- Unscrew the plastic nut anticlockwise from the motor unit.
- Fit the back grille on the motor unit and lock in place with the plastic nut. Tighten the plastic nut clockwise to

lock the back grille. FIG. 3

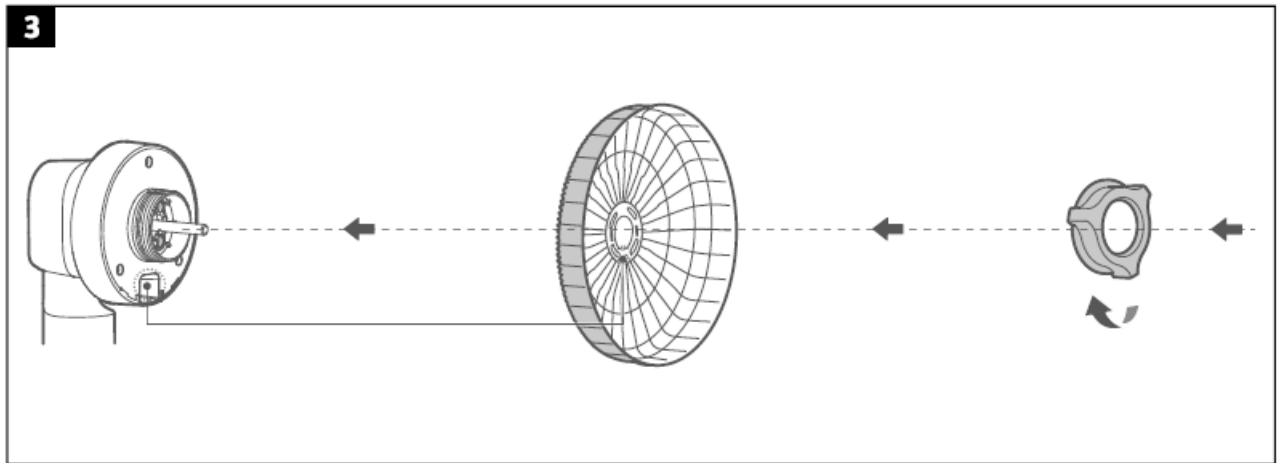

- Put the fan blade on the motor spindle. Align the taps to the slot in the fan blade. Tighten the hub nut anticlockwise to lock the fan blade. FIG. 4

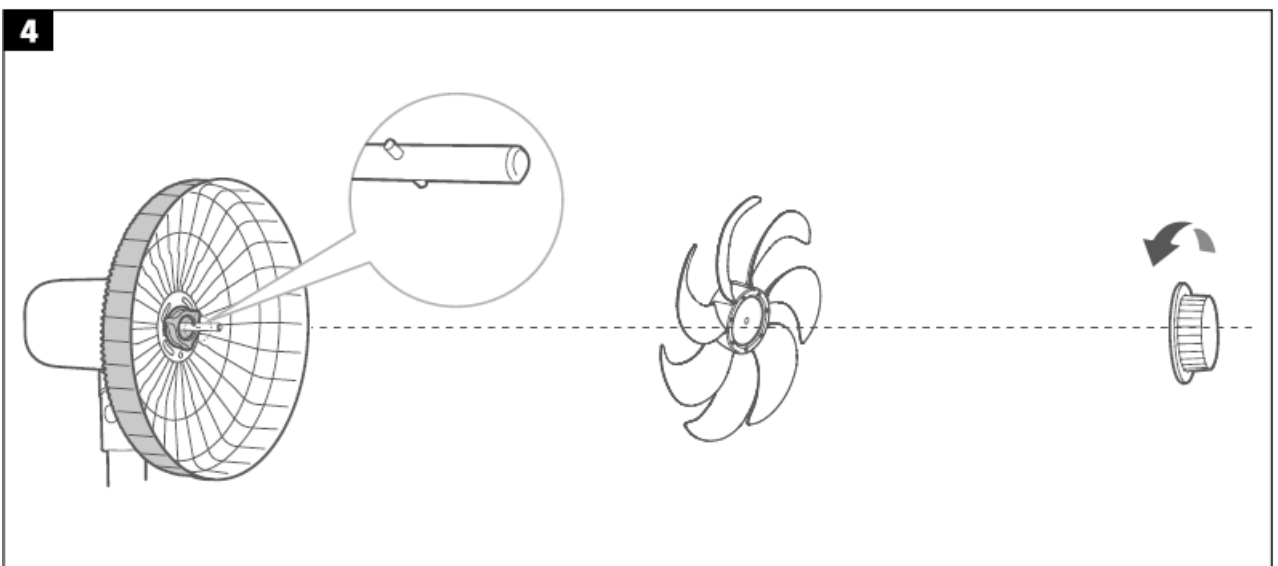

- Fit the grille with the logotype right side up with the clip. FIG. 5

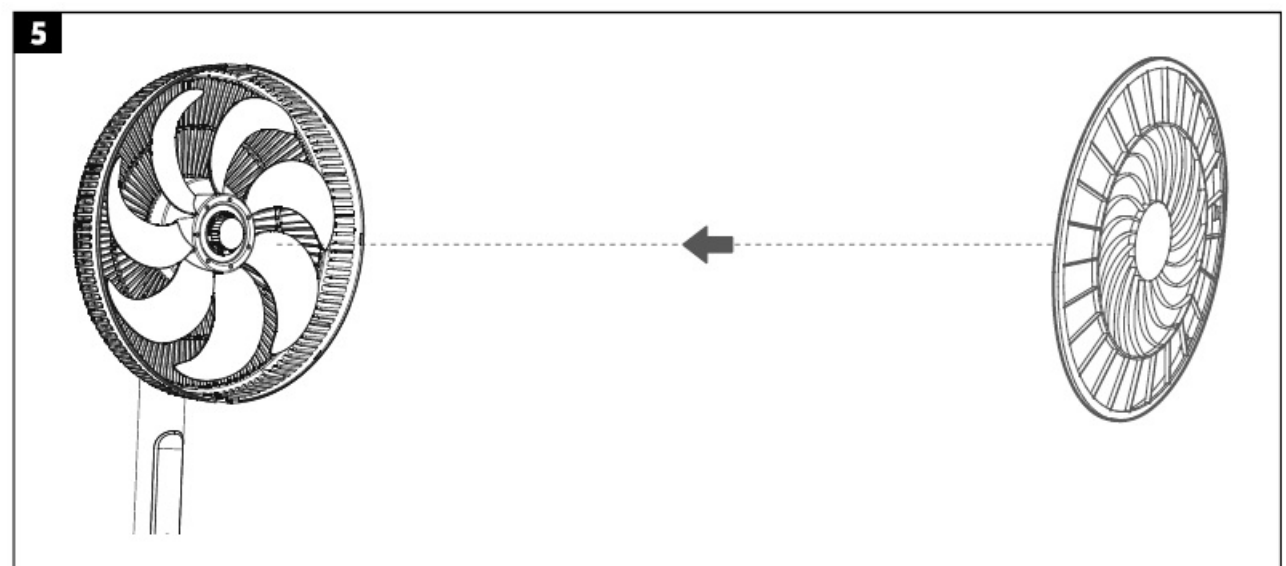

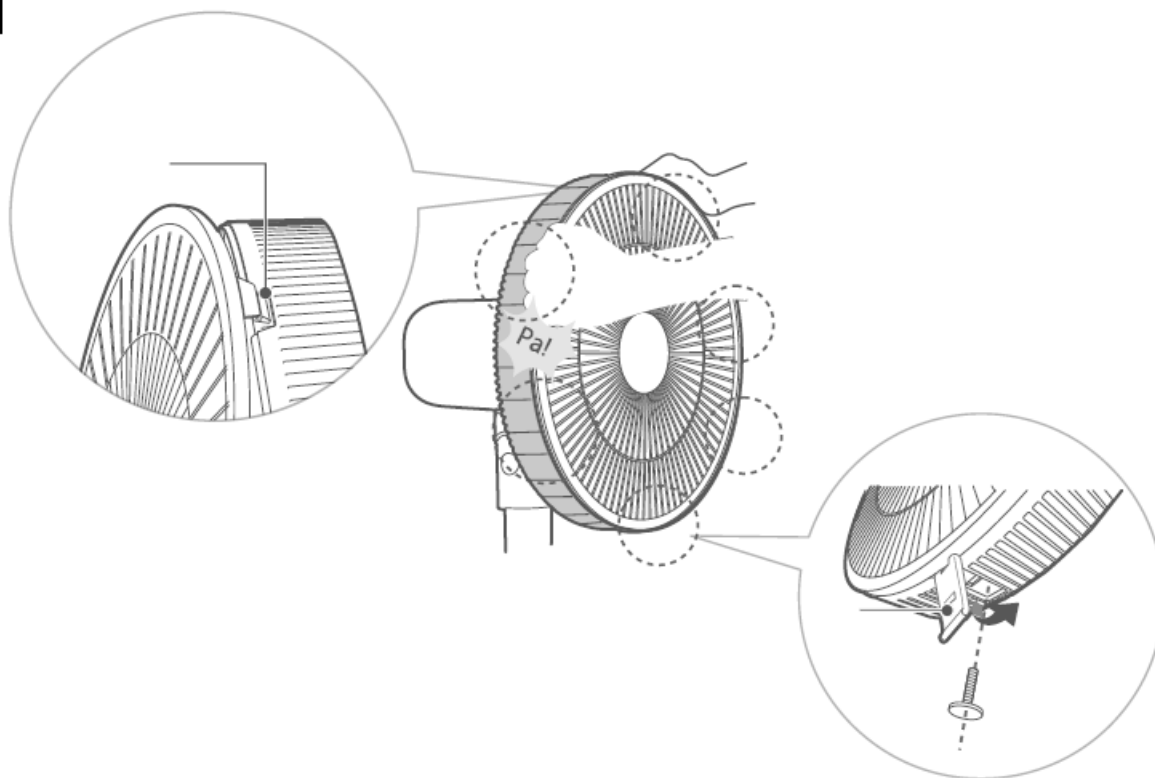

- Lock the front grille firmly to the back grille. Press the grille with both hands so that it clicks in place and fix with the screw.



HOW TO USE

CONTROL PANEL

	Power switch/standby mode.
	Press the oscillation button repeatedly to set the angle. The adjustment order is $60^{\circ} \rightarrow 90^{\circ} \rightarrow 120^{\circ} \rightarrow$ no oscillation. The display shows 60° , 90° and 120° . The display does not indicate that the oscillation is switched off.







	Tap the button to set the fan speed. Press the button to switch between fan modes normal -> low -> sleep mode-> normal.
1 – 9	The set fan speed is shown on the display as 1–9.
	Tap the button to activate/deactivate high fan speed mode. Press and hold the button to activate/deactivate fan speed mode to temperature.
	In high fan speed mode H is show on the display.
	This icon is shown in sleep mode and the fan speed is changed automatically according to the programming. There are three modes (1, 2, 3). Set the required fan speed for sleep mode by pressing the button for fan speed.
	This icon is shown when the mode to adjust fan speed to temperature is activated.
	This icon is shown on the display when timer control is activated.

FIG. 7

8



REMOTE CONTROL





	Power switch/standby mode.
	Setting fan mode.
	Activation/deactivation of mode to adjust fan speed to temperature.
	Setting fan speed or time.
	Setting timer mode.
	Activation/deactivation of oscillating mode and fan function.

FIG. 8

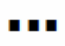
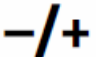

MAINTENANCE

REPLACING THE BATTERY

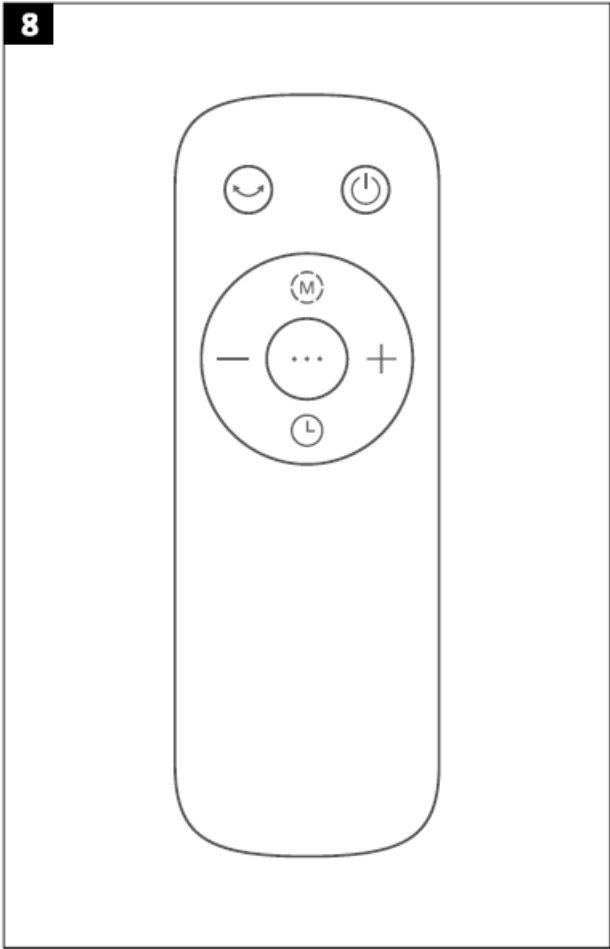
1. Open the battery compartment by pressing the lid and pulling it out.
2. Insert the batteries with the correct polarity in accordance with the markings inside the battery compartment.
3. Replace the cover. Fig. 9

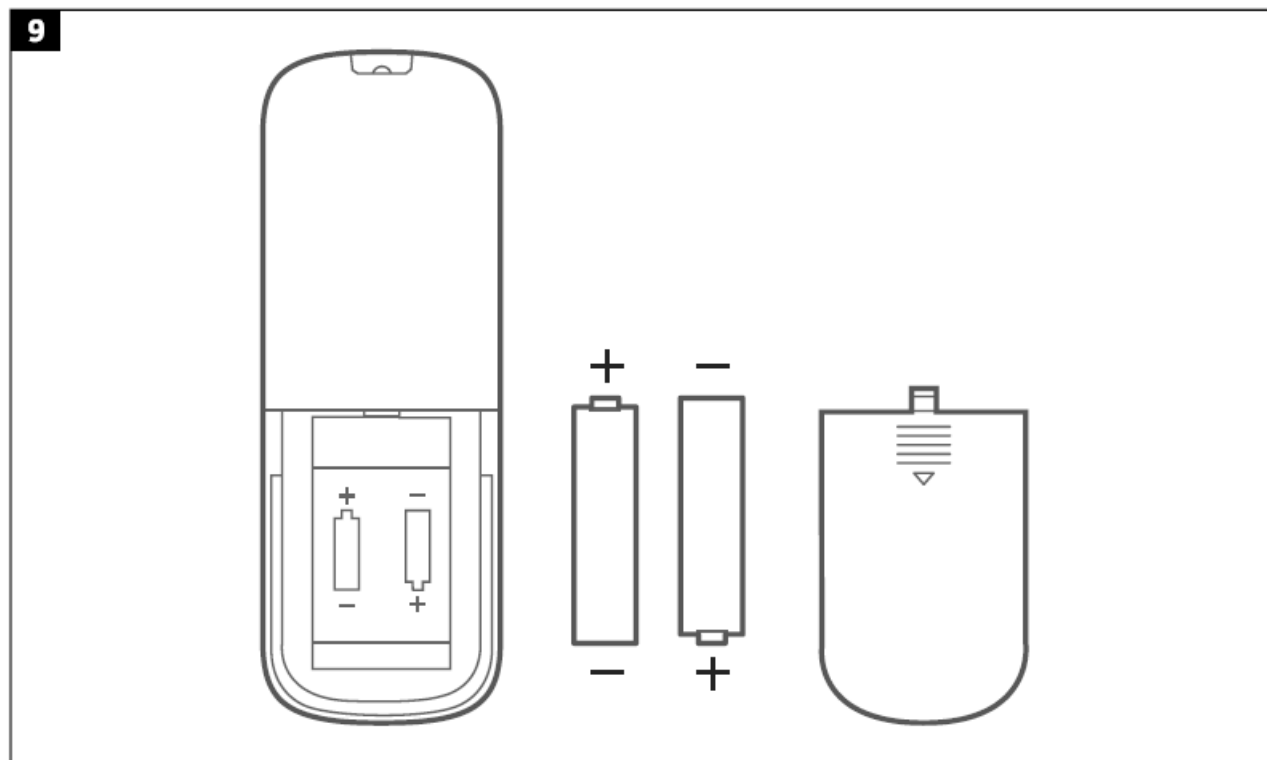

CLEANING

Pull out the plug from the PowerPoint before installation and/or cleaning.



- The fan should be cleaned once a month.
- Clean the fan with a soft cloth moistened with a mild detergent. Make sure that no water or other liquid gets into the fan.

NOTE

Do not use petrol, solvents or detergents that can damage the plastic parts.

014780			
Description	Designation	Value	Unit
Max air speed		33.17	m'/min
Input power of fan	p	16.60	w
Operating value	Sv	2.00	(m'/min) W
Power consumption in standby mode	Pss	0,61	w
Sound power level	LwA	53.73	dB(A)
Maximum flow speed	C	4.22	m/s
Annual power consumption	kWh/a	6,00	kWh/a
Service value standard: IEC 60879:7986 (corr. 7992)			
Contact details: www.jula.com			

Documents / Resources

	<p>anslut 014780 Floor Fan with Remote Control [pdf] Instruction Manual 014780, Floor Fan with Remote Control, 014780 Floor Fan with Remote Control</p>
	<p>anslut 014780 Floor Fan with Remote Control [pdf] Instruction Manual 014780 Floor Fan with Remote Control, 014780, Floor Fan with Remote Control, Floor Fan, Fan</p>

References

-  [Jula – products for home and garden](#)
-  [Jula – Teraz nic Cię nie powstrzyma!](#)