



## anslut 007294 Lamp Socket DCL Instruction Manual

[Home](#) » [anslut](#) » anslut 007294 Lamp Socket DCL Instruction Manual 

### Contents

- [1 anslut 007294 Lamp Socket DCL](#)
- [2 OPERATING INSTRUCTIONS](#)
- [3 SAFETY INSTRUCTIONS](#)
- [4 ELECTRICAL SAFETY](#)
- [5 TECHNICAL DATA](#)
- [6 ASSEMBLY](#)
- [7 Documents / Resources](#)
- [8 Related Posts](#)



anslut 007294 Lamp Socket DCL



LAMP SOCKET DCL

## OPERATING INSTRUCTIONS

Important! Read the user instructions carefully before use. Save them for future reference.  
(Translation of the original instructions).

### Care for the environment!

Recycle discarded product in accordance with local regulations.

## SAFETY INSTRUCTIONS

- Do not connect power strips to each other.
- Do not cover the power strip.

## ELECTRICAL SAFETY

New installations and extensions to existing systems should always be carried out by an authorised electrician. If you have the necessary experience and knowledge (otherwise contact an electrician), you can replace power switches and wall sockets, fit plugs, extension cords and light sockets. Incorrect installation can result in fatal injury and the risk of fire.

### WARNING

The product is only intended for permanent installation.

## SYMBOLS

- Read the instructions.
- Approved in accordance with the relevant directives.
- Recycle discarded product as electrical waste.

## TECHNICAL DATA

- Rated voltage  
230 V ~ 50 Hz
- Max. capacity  
15 kg
- Current  
6A

## ASSEMBLY

## INSTALLATION

1. Connect the wires.
2. Lock in place with the screws.
3. Open the cable inlet, if necessary.
4. Put on the casing and tighten the screw.

FIG. 1

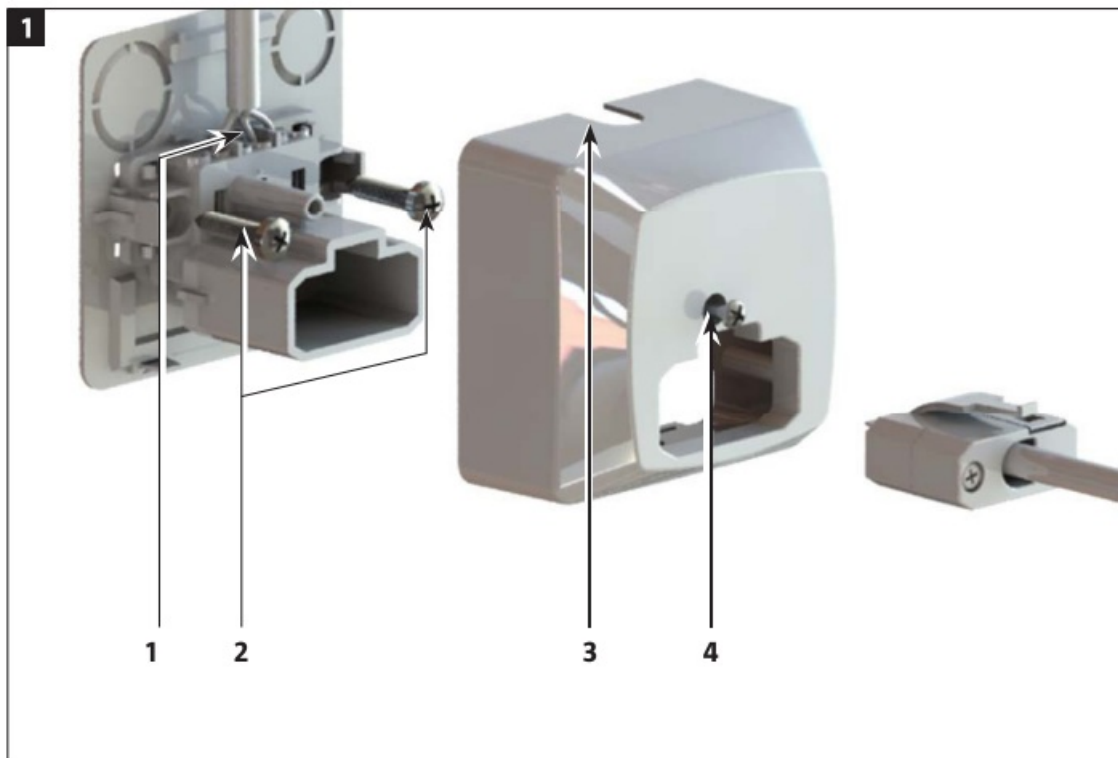

#### Releasing the casing

Release the casing as shown.

FIG. 2



#### Disconnection of the conductors

FIG. 3

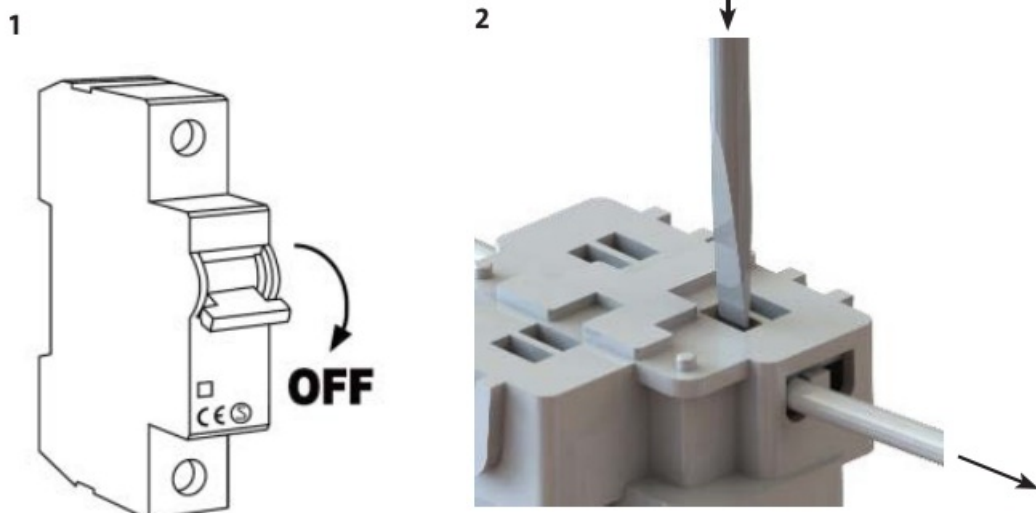

## Documents / Resources



[anslut 007294 Lamp Socket DCL](#) [pdf] Instruction Manual  
007294, Lamp Socket DCL, 007294 Lamp Socket DCL, Socket DCL, DCL