



ANOLiS Divine 60 UV LED Luminaire Instruction Manual

[Home](#) » [ANOLiS](#) » ANOLiS Divine 60 UV LED Luminaire Instruction Manual 



Divine 60 UV LED Luminaire Instruction Manual INSTALLATION INSTRUCTIONS DIVINE™ 60 UV

Contents

- [1 Divine 60 UV LED Luminaire](#)
- [2 TYPE OF ACCESSORIES](#)
- [3 Documents / Resources](#)
 - [3.1 References](#)
- [4 Related Posts](#)

Divine 60 UV LED Luminaire



The unit must be installed by a qualified electrician in accordance with all national and local electrical and construction codes and regulations. 

This device falls under class one and must be grounded!

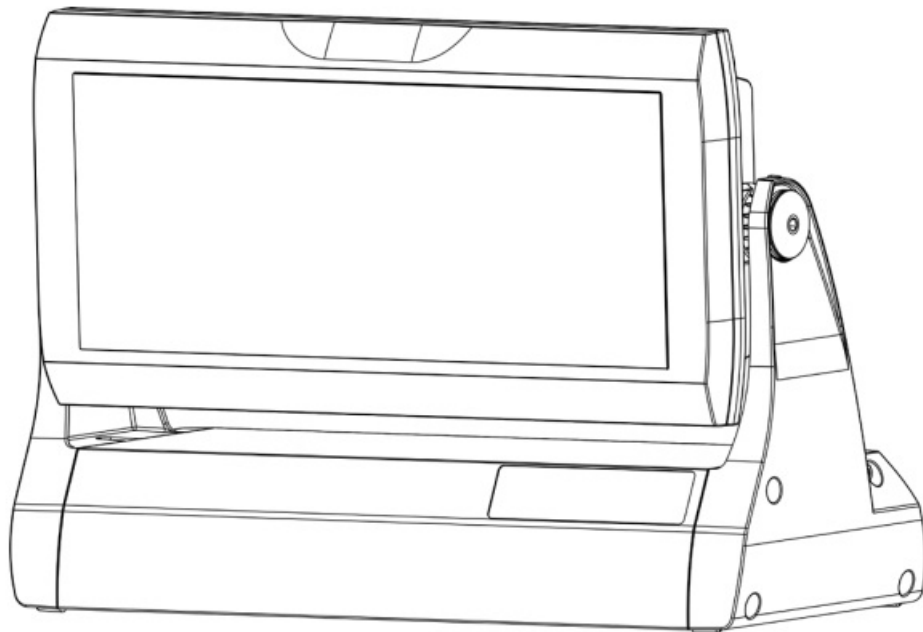

STEP 1

CABLE GLAND

1A For bottom connection

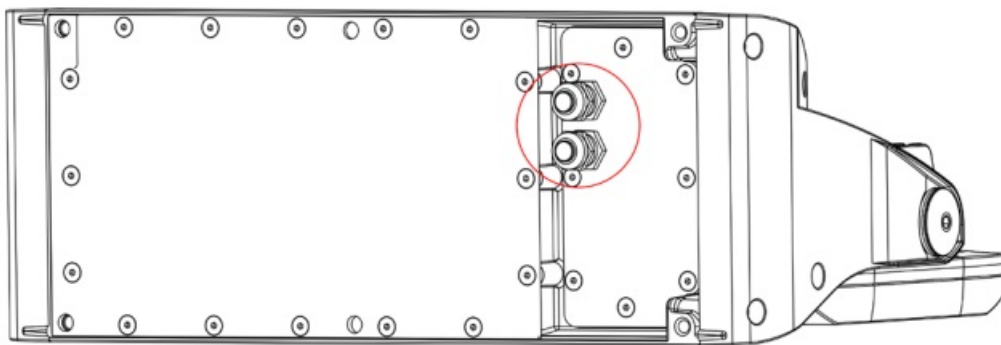

Inlets for power and data from bottom side of the luminaire.

1B For side connection

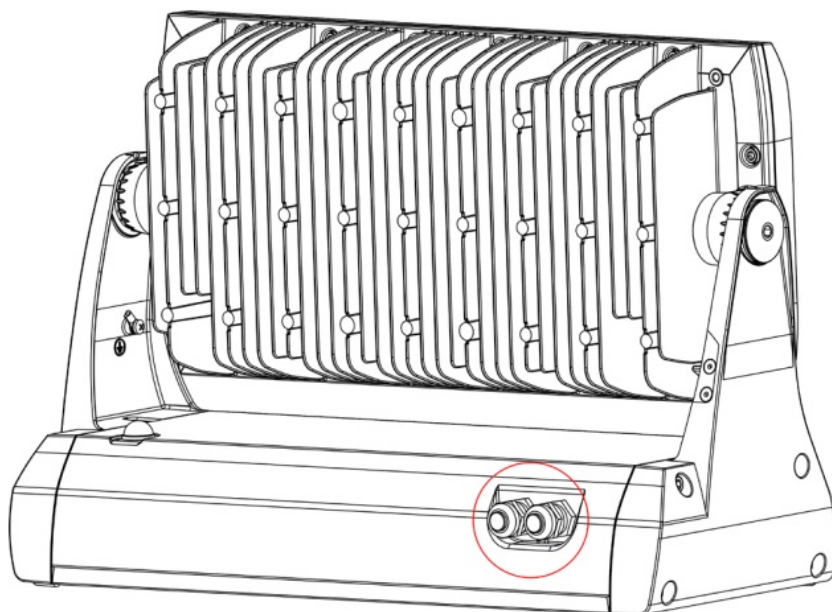

Inlets for power and data from side of the luminaire.

STEP 2 UNCOVER JUNCTION BOX

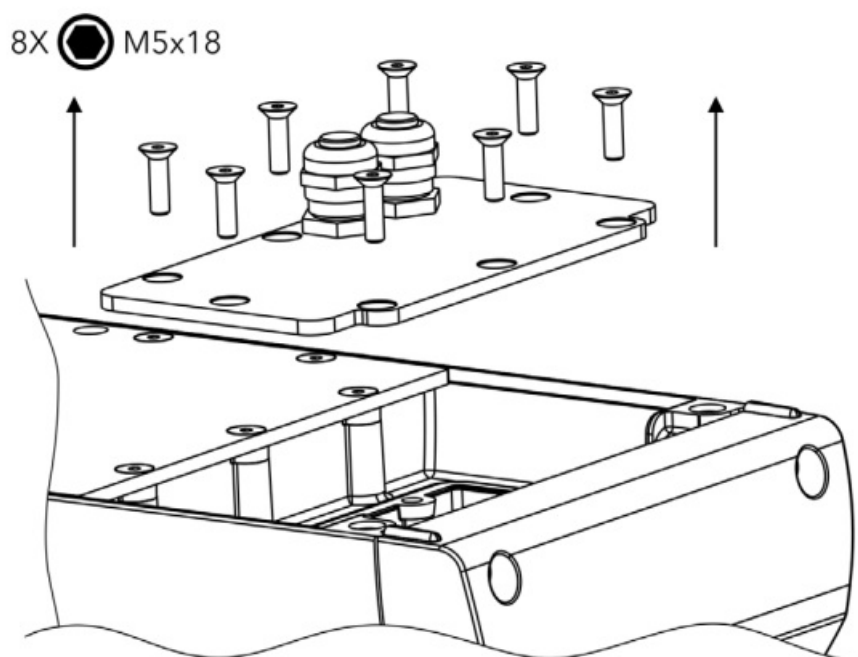

Uncover junction box located on the bottom side of luminaire.

STEP 3 CONNECTION

1 Strip these lengths for cable connections

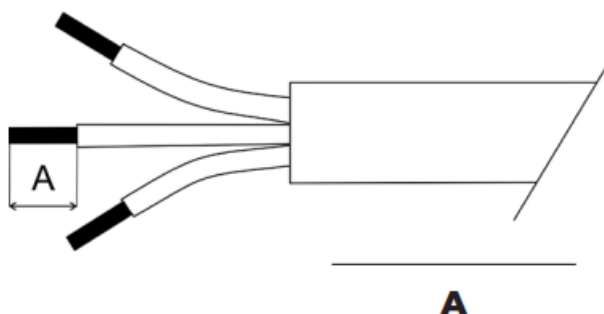

Power Connection	9mm
Data Connection	7mm

Connection – colour coding

To connect the Divine 60 UV to mains and a DMX controller, use a 5-cored cable Flamar Li9YC11Y. The 3 colors serve for the power supply and 2 shielded cores are intended for DMX connection.

Power and Data Connection

WIRE	POWER CONNECTION	WIRE	DATA CONNECTION
Brown	L	White	Data – (D-)
Blue	N	Red	Data + (D+)
Yellow/Green	Ground	Shielding	Data Ground (0V)

3A Wiring connection (control menu inside)

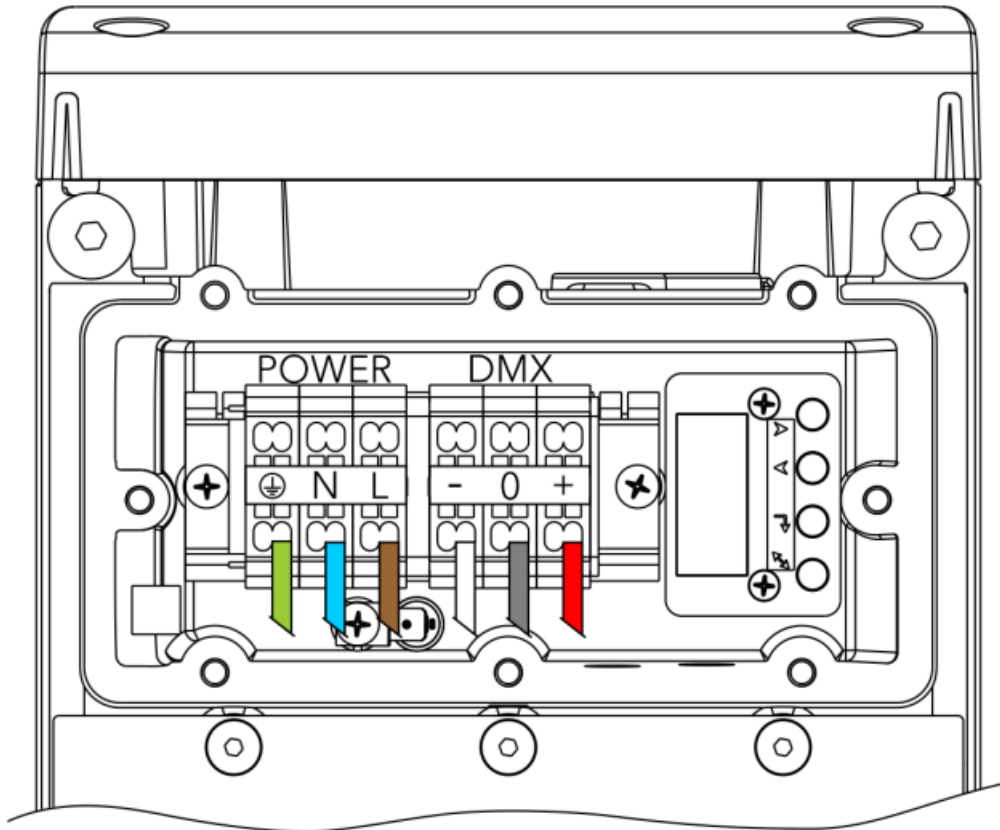

3B Wiring connection (control menu outside)

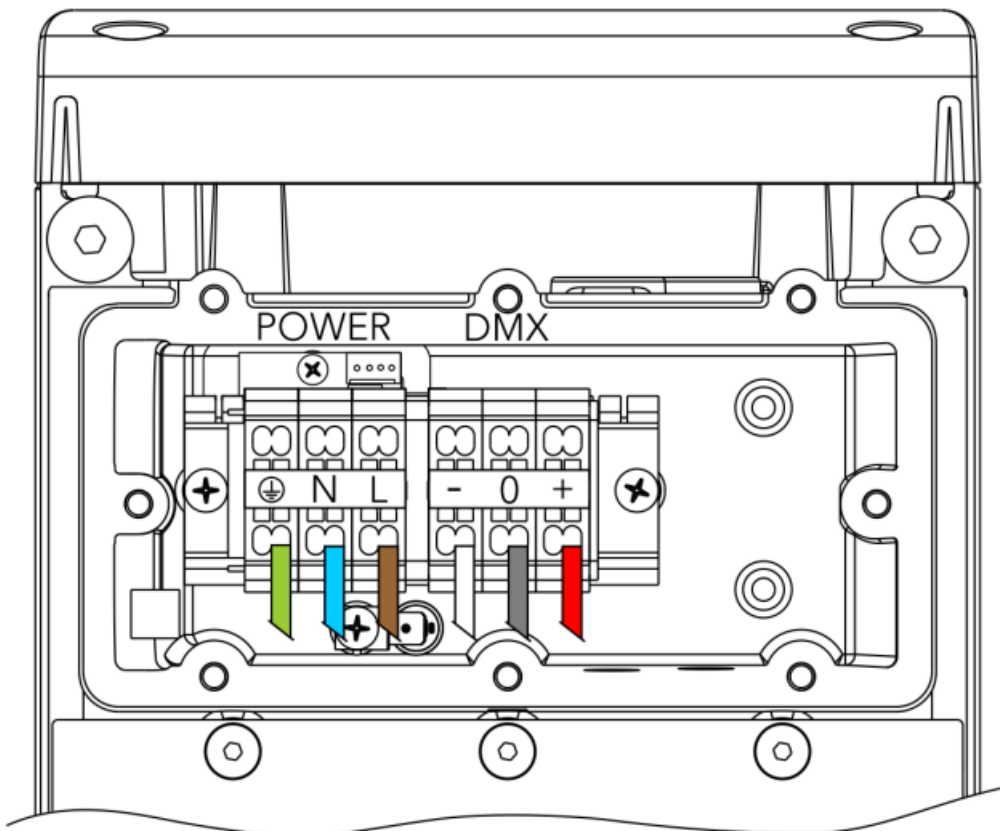

STEP 4 CONTROL MENU

1A Control menu inside

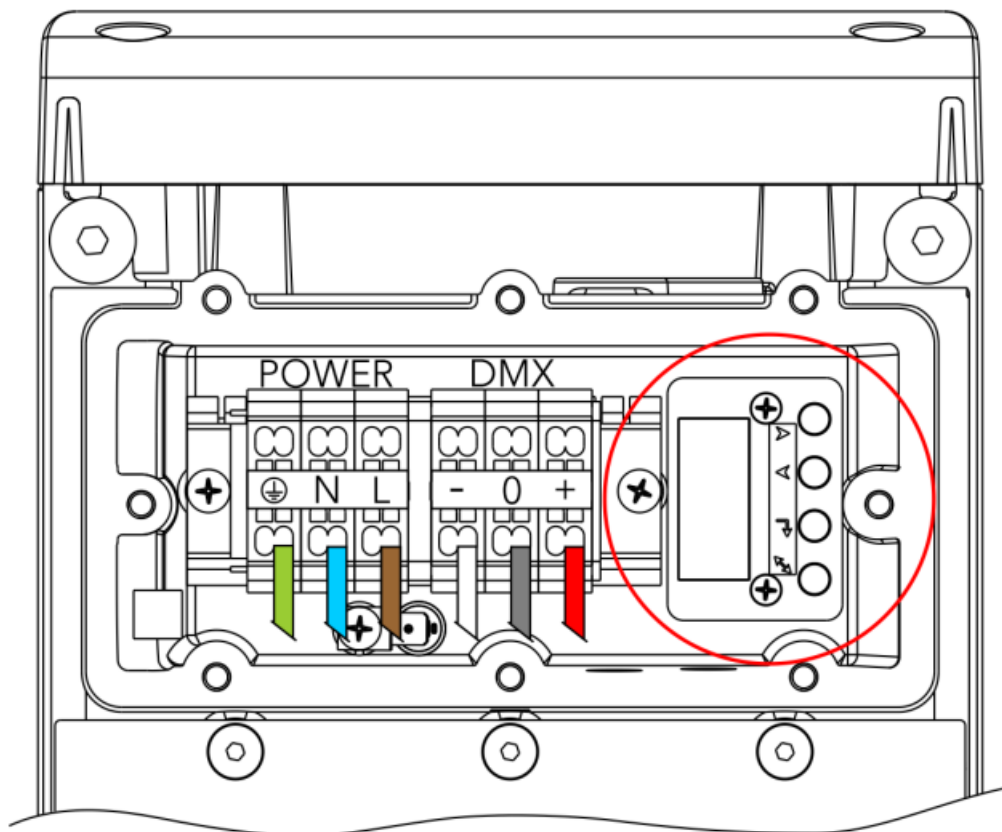

Set control menu inside junction box.

1B Control menu outside

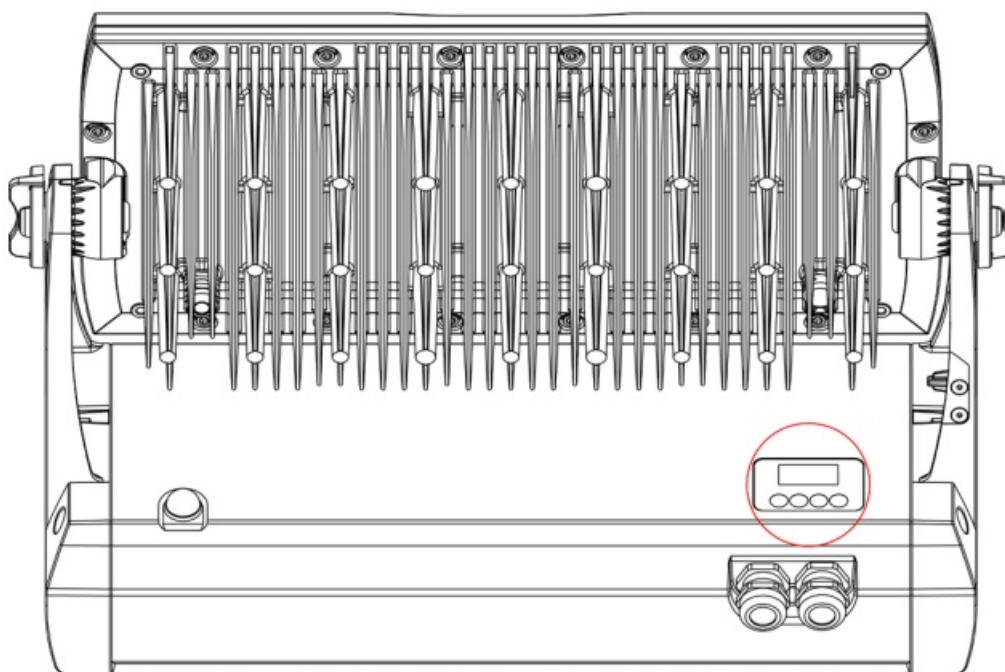

Set control menu.

STEP 5 CLOSE JUNCTION BOX

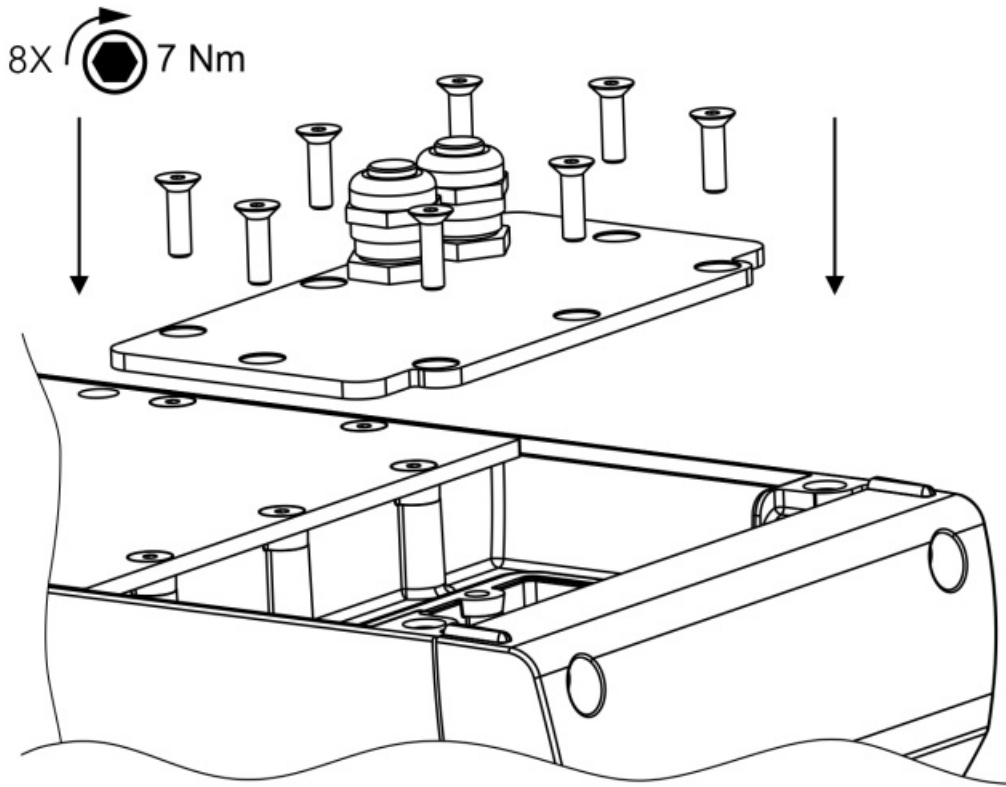

Before applying the torque, make sure the thread is clean and functional.

STEP 6 CABLE GLAND INSTALLATION

Use wrench size 24 for cable gland M20x1.5

Use wrench size 16 for cable gland M12x1.5

Install Cable glands individually!

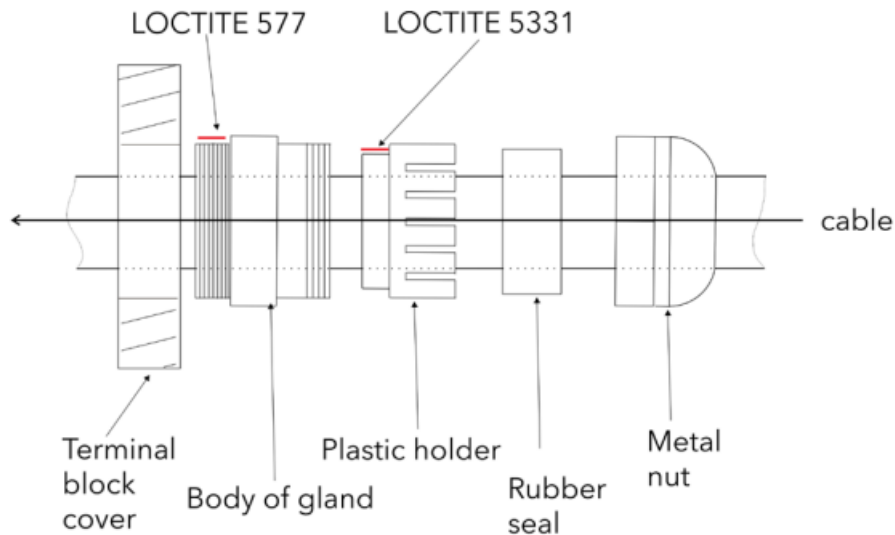

We recommend to apply an adequate layer of the paste LOCTITE 5331 on the plastic holder of the cable gland before inserting it into the body of the gland and an adequate layer of the paste LOCTITE 577 on the thread of the gland body.



Failure to properly install cable glands will result in failure of the water tight seal!

STEP 7.A INSTALLATION WITH SURFACE MOUNT ADAPTOR

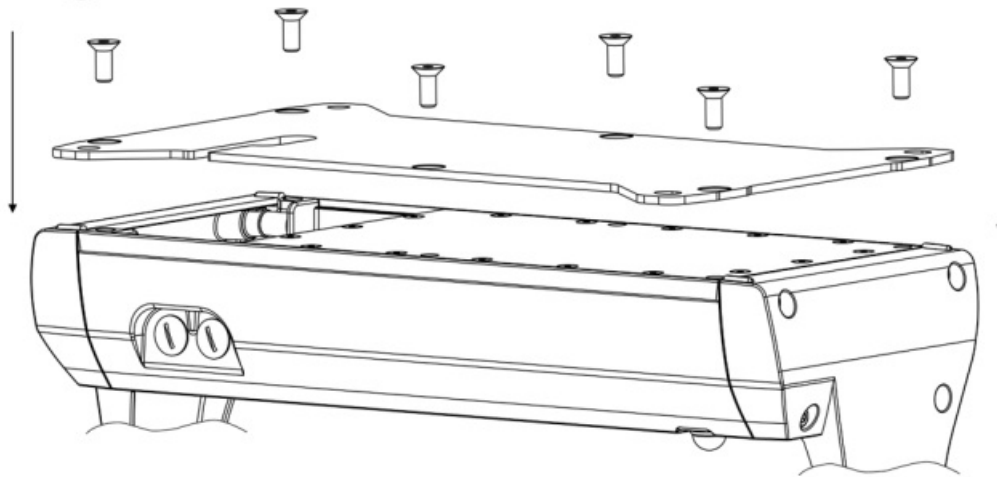
6X  M8x20



Mount the adaptor using 6 mounting screws.

 Use fasteners that are appropriate for use with your mounting surface. 

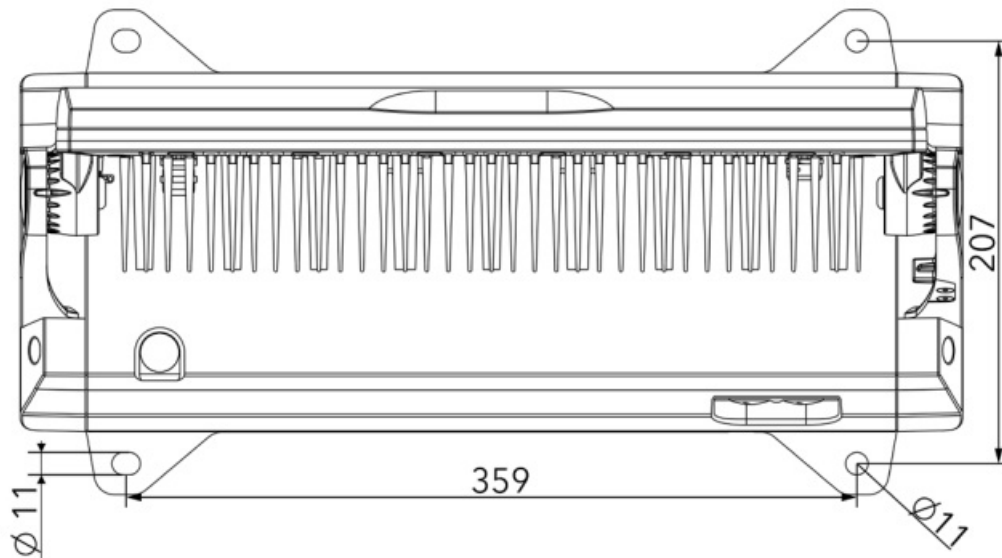

Drill holes to the surface according to holes spacing. Mount Divine via mounting holes on the surface.

STEP 7.B INSTALLATION WITH SET OF RUBBER FEET

4X  M8x20

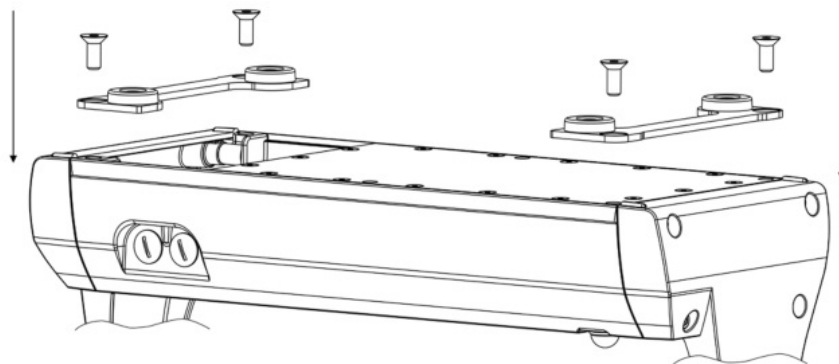

Mount pair of rubber feet using 4 screws.

STEP 7.C INSTALLATION WITH C-CLAMP ADAPTOR

5X  M8x25

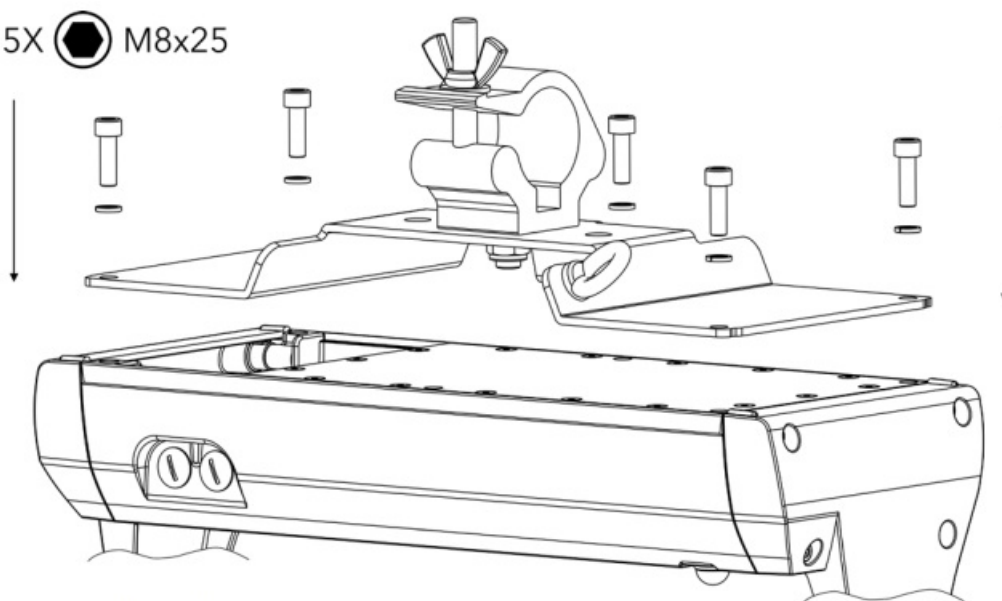

Mount the adaptor using 5 screws.

TYPE OF ACCESSORIES

Adaptor Black Glass

Adaptor Black Glass

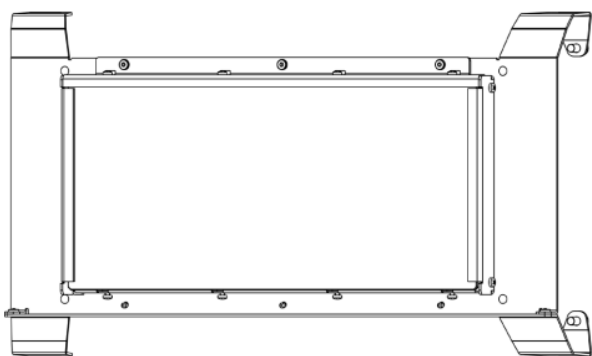

Half Top Hat

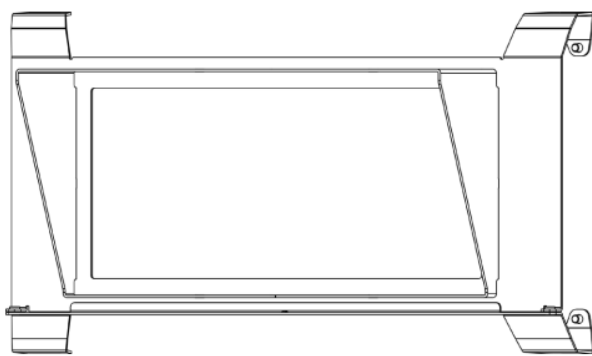

Top Hat

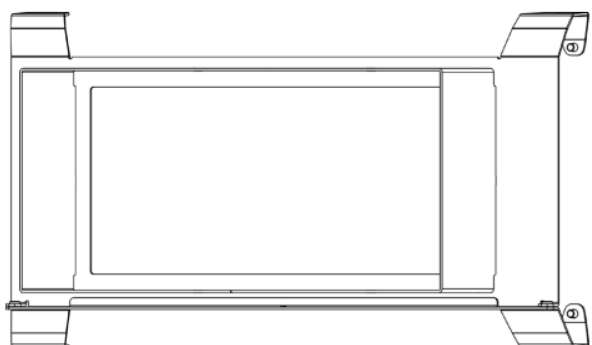

Wire Guard/Anti-Glare

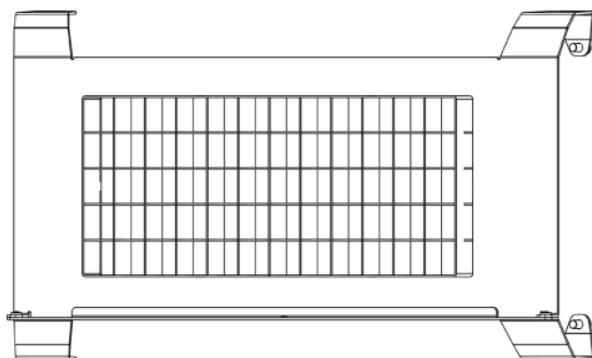

STEP 8 INSTALLATION OF ACCESSORIES

1

2X ⊕ M3x5

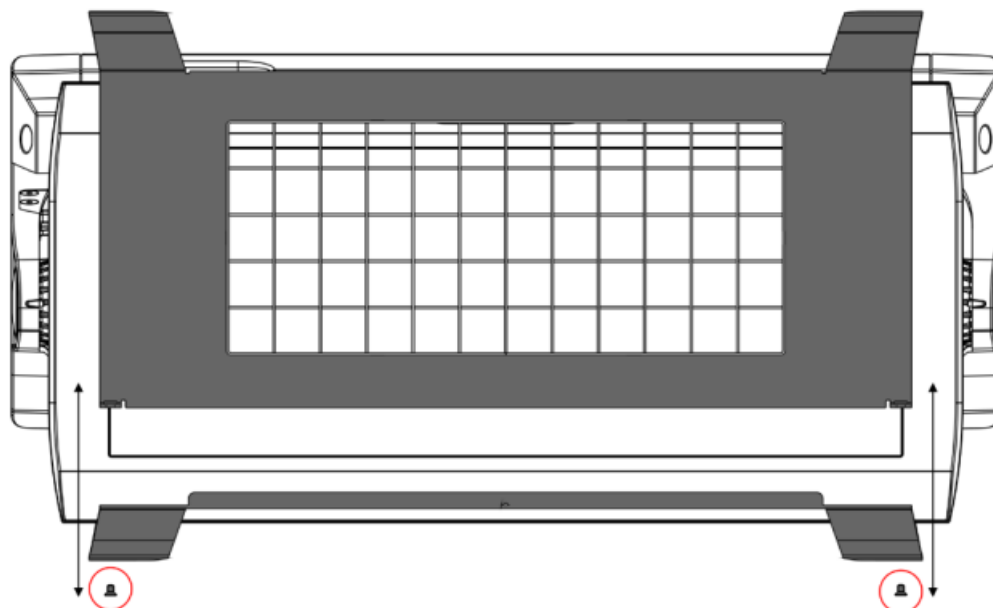

Unscrew two screws and split accessory to two parts. Place each part onto the luminaire's head and screw them together.

2

4X  M5x10

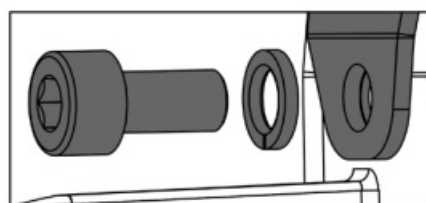
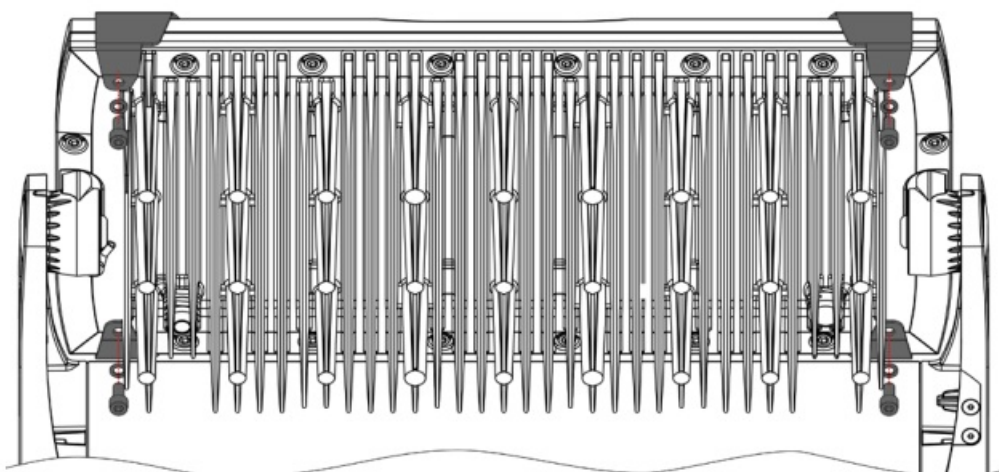

Secure accessory by 4 screws with spring washer at the back side of luminaire's head.

STEP 9 HEAD POSITION ADJUSTMENT

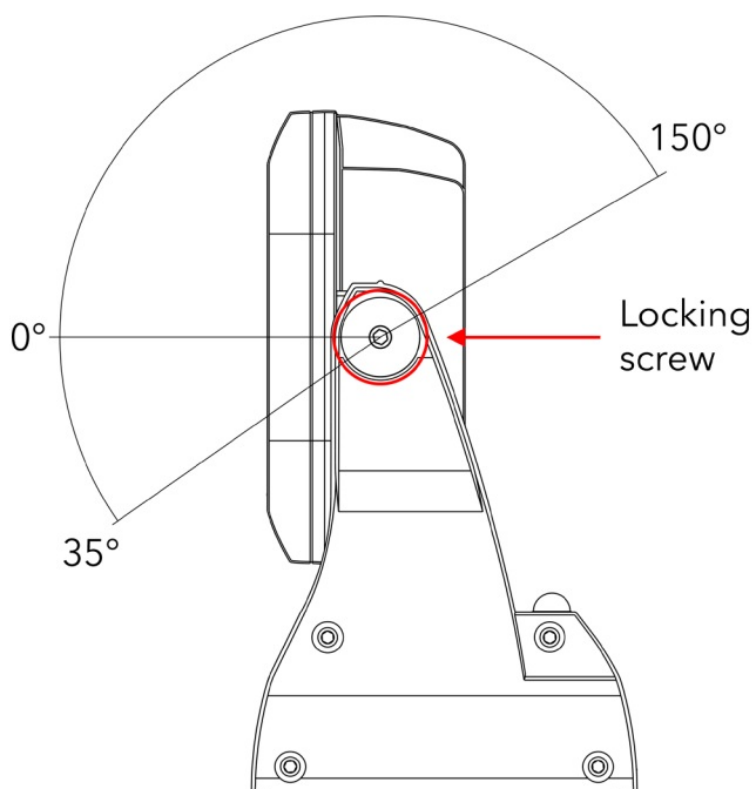

Release locking screw on each sides. Angle fixture to desired position and tighten locking screw on each sides.

Palackeho 416 | 757 01 Valasske Mezirici
Czech Republic | Tel.: +420 571 751 500

E-mail: info@anolis.eu

VERSION 1 / 10_05_2021



Documents / Resources

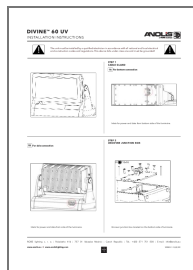

[ANOLIS Divine 60 UV LED Luminaire](#) [pdf] Instruction Manual
Divine 60 UV LED Luminaire, Divine 60 UV, LED Luminaire, Luminaire

References

-  [Anolis - Architectural LED Lighting Solutions](#)
-  [Anolis - Architectural LED Lighting Solutions](#)

[Manuals+](#).