



Anolis Arcpixel Power ArcSource Outdoor 4MC Pixel Instruction Manual

[Home](#) » [ANOLiS](#) » Anolis Arcpixel Power ArcSource Outdoor 4MC Pixel Instruction Manual 

Contents

- [1 Anolis Arcpixel Power ArcSource Outdoor 4MC Pixel](#)
- [2 Product Information](#)
- [3 INSTALLATION INSTRUCTIONS](#)
- [4 Documents / Resources](#)
 - [4.1 References](#)
- [5 Related Posts](#)

Anolis[®]

Anolis Arcpixel Power ArcSource Outdoor 4MC Pixel



Product Information

The Arcpixel Power is a lighting fixture manufactured by ROBE lighting s. r. o. It is designed for installation by a qualified electrician in accordance with national and local electrical and construction codes and regulations.

Installation Instructions

Step 1: Fixture's Housing

1. Ensure the fixture is mounted on a non-flammable surface.
2. Use three screws with a diameter of 4.3mm to securely mount the fixture's base.

Step 2: Install with Standard Base

1. Fasten the base of the luminaire into the mounting surface using three screws.

Step 3: Install with Standard Base and Adaptor

1. Fasten the base of the luminaire into the mounting surface using three screws.
2. Unscrew the M5x14 screw from the bottom part of the base and detach the base from the luminaire.
3. Assemble the 31mm adaptor between the luminaire and the base. Ensure the locking pin of the adaptor is correctly placed into the matching part of the luminaire.
4. Screw the luminaire, adaptor, and base together using an M5x45 screw, spring washer, and standard washer.

Step 4: Installation of 100mm Adaptor Stand and Mounting

1. Unscrew the M5x14 screw from the bottom part of the base and detach the base from the luminaire.
2. Screw the 100mm adaptor into the luminaire using the bolt on the adaptor.
3. Fasten the base to the adaptor using the original M5x14 screw and washers.

Step 5: Install with Land Spike or Floor Stand

Land Spike:

- Insert the Land Spike into the ground. Ensure the underground part of the Land Spike is placed perpendicularly into the ground. If tools are needed to insert the spike, use a protective layer and apply pressure in the middle to prevent damage.

Floor Stand:

- Fasten the Floor Stand into the mounting surface using four screws and the provided mounting holes.

Note: The specific instructions for using Land Spike 1 ASO 4 MC Pixel 100mm and Land Spike 2 ASO 4 MC Pixel 100mm are not provided in the user manual.

INSTALLATION INSTRUCTIONS

Fixture must be installed by a qualified electrician in accordance with all national and local electrical and construction codes and regulations.

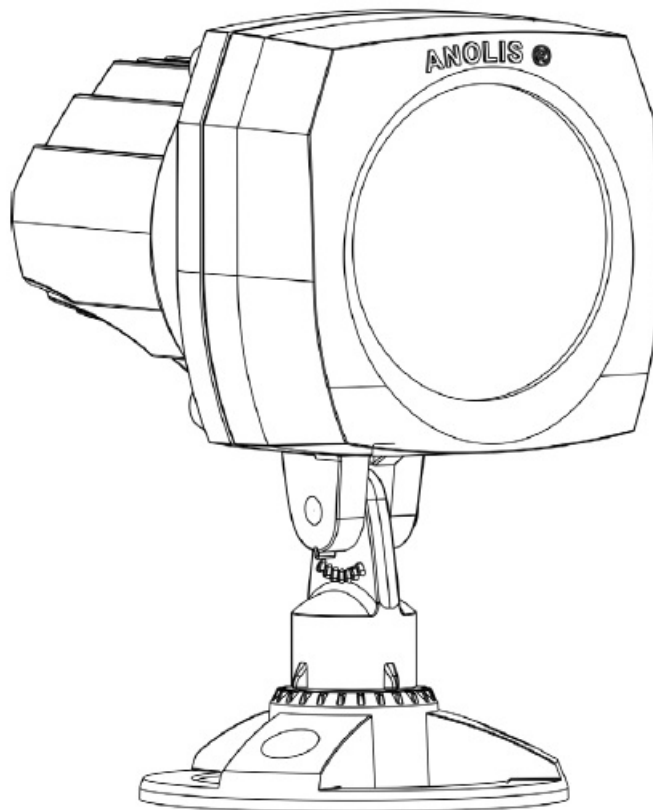

STEP 1 FIXTURE'S HOUSING

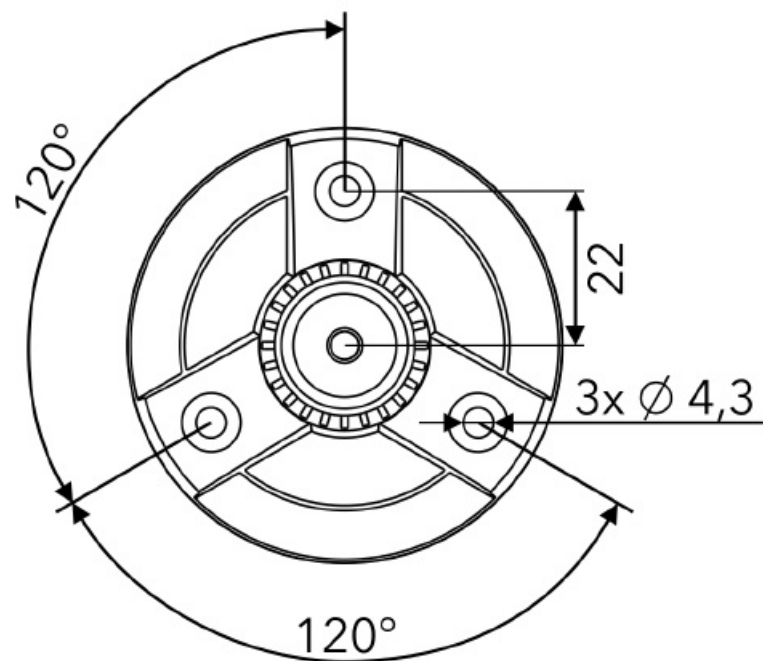

1

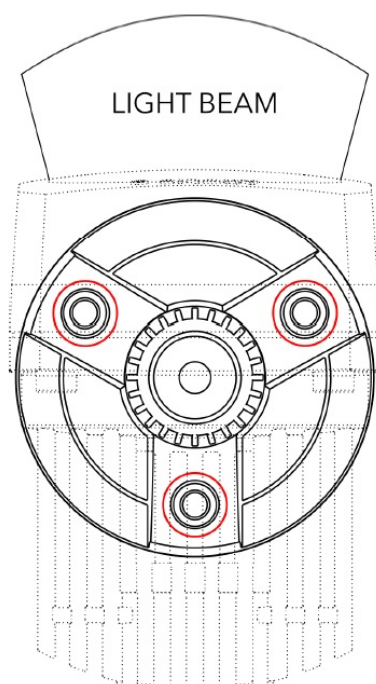

2

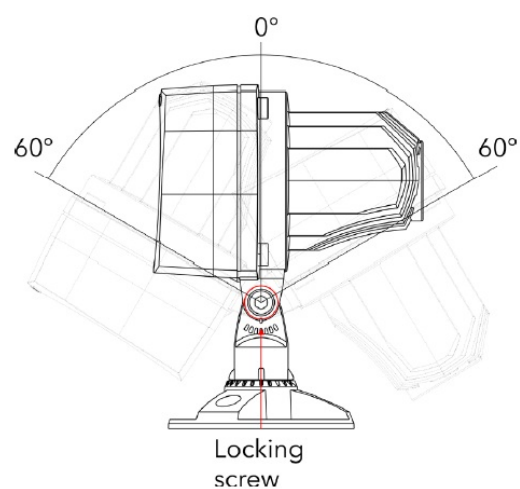

1. Three holes of diameter 4.3mm in the base serve for mounting on the non-flammable surface.
2. The luminaire head can be adjusted in range of 120°. Loosen a locking screw M5x12, tilt it to desired position and tighten the screw.

STEP 2A

INSTALL WITH STANDARD BASE

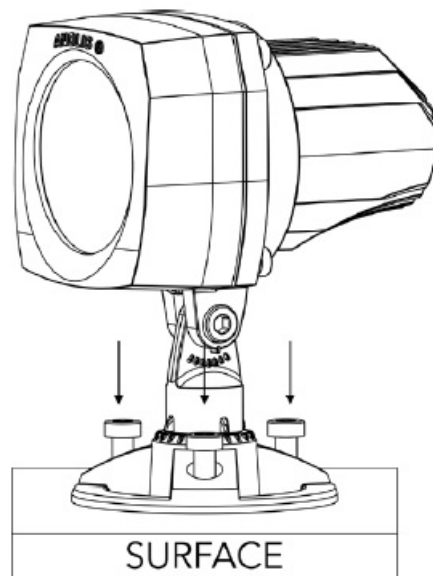

Fasten the base of luminaire into the mounting surface with three screws.

STEP 2B

INSTALL WITH STANDARD BASE AND ADAPTOR

Use fasteners that are appropriate for use with your mounting surface.

1X  M5x14

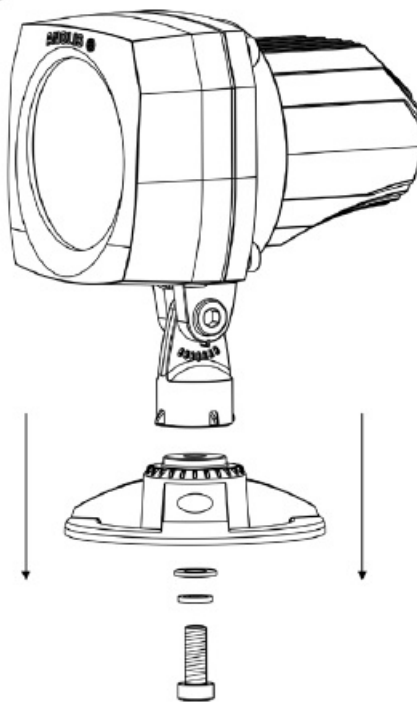

Unscrew M5x14 from the bottom part of base and disassemble the base from the luminaire.

1X  M5x45

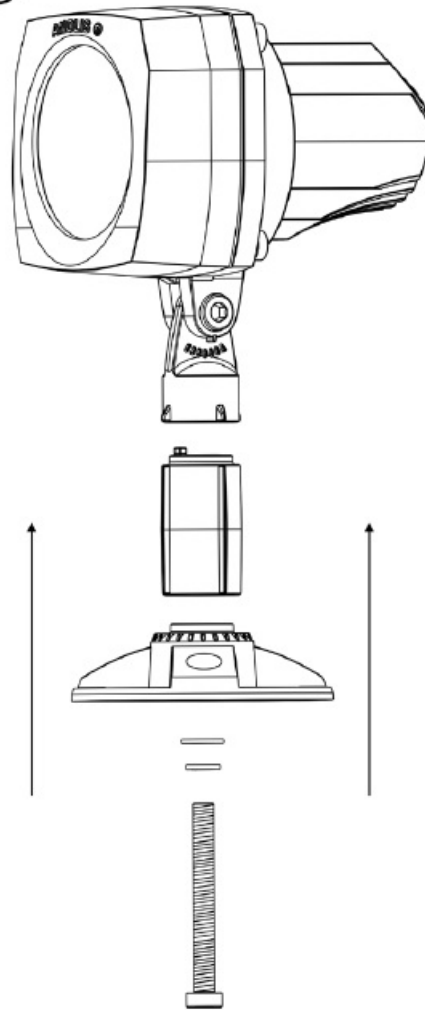

1. standard washer
2. spring washer
3. screw

Assemble the 31mm adaptor between the luminaire and the base. Locking pin of the adaptor has to be placed correctly into matching part of the luminaire. Screw the luminaire, adaptor and base together with M5x45, spring washer and standard washer.

Use fasteners that are appropriate for use with your mounting surface.

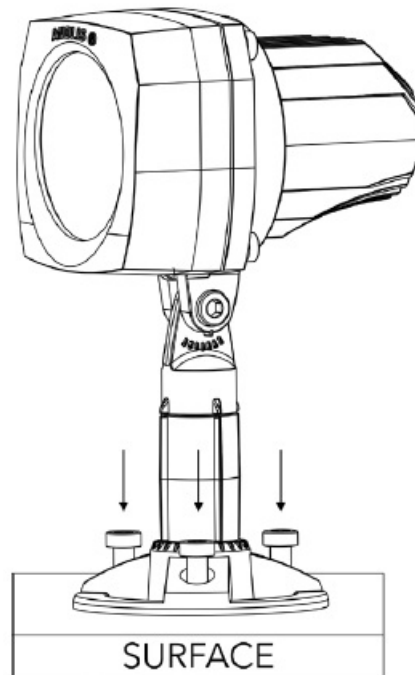

Fasten the base of luminaire into the mounting surface with three screws.

1X  M5x14

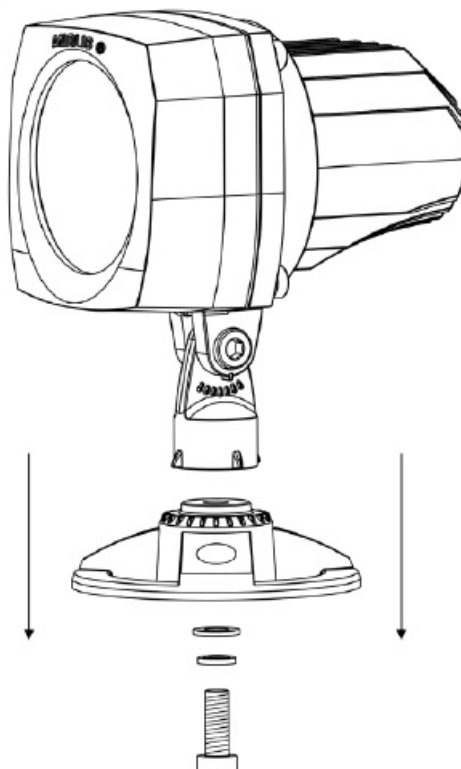

STEP 2C
INSTALLATION OF 100MM ADAPTOR STAND AND MOUNTING

1X  M5x14

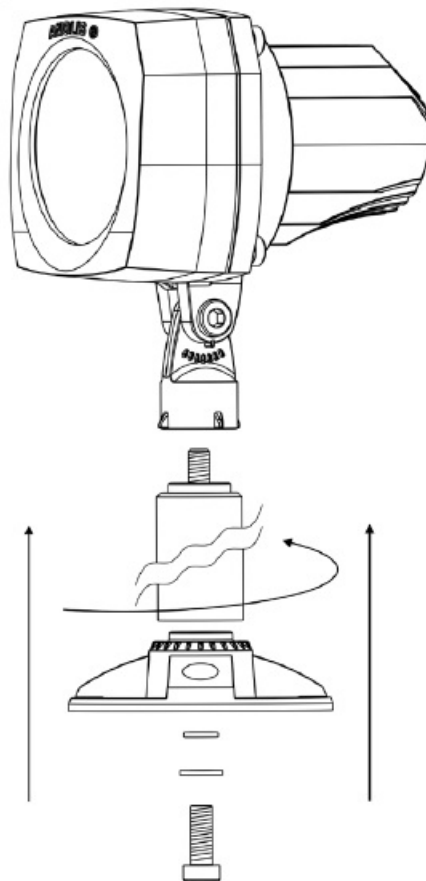

Unscrew M5x14 from the bottom part of base and disassemble the base from the luminaire.

1. standard washer
2. spring washer
3. screw

Screw the 100mm adaptor into luminaire by bolt on adaptor. Fasten the base to the adaptor with original M5x14 screw and washers

Use fasteners that are appropriate for use with your mounting surface.

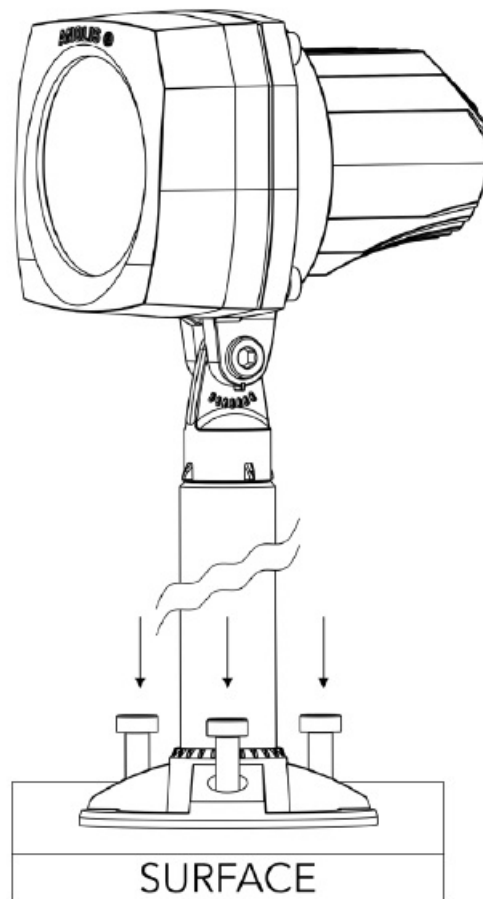

Fasten the base of luminaire into the mounting surface with three screws.

STEP 2D

INSTALL WITH LAND SPIKE OR FLOOR STAND

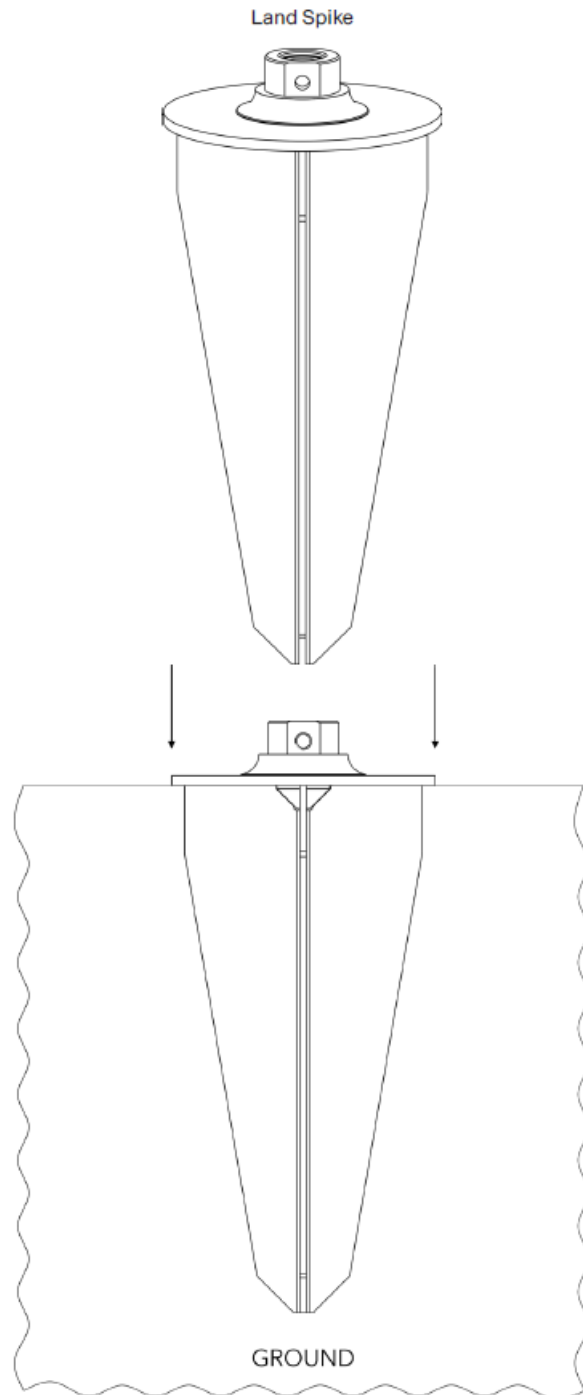

Insert the Land Spike into ground. Underground part of Land Spike should be placed perpendicularly into the ground. (if you need to use tools to insert spike in the ground, use of some protective layer, and applying pressure in the middle is recommended to prevent damaging of land spike)

Floor Stand

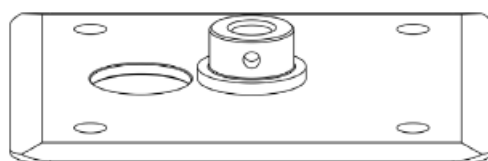

Use fasteners that are appropriate for use with your mounting surface.

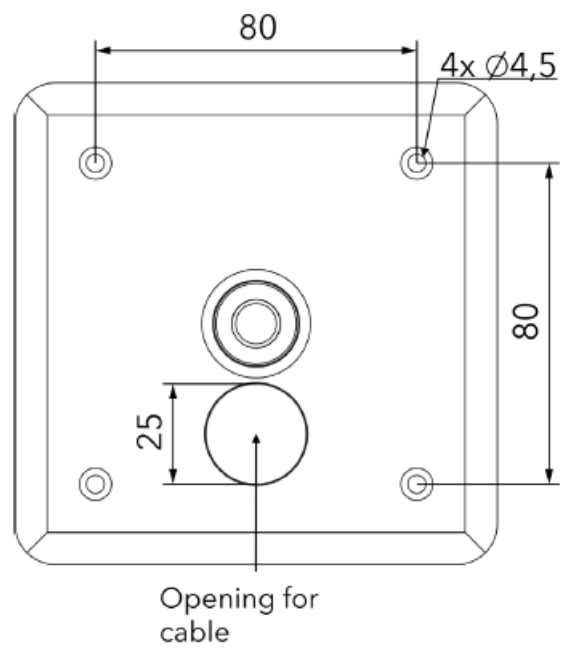

Fasten the Floor stand into the mounting surface by four screws and prepared mounting holes.

Land spike 1 ASO 4 MC Pixel 100 mm

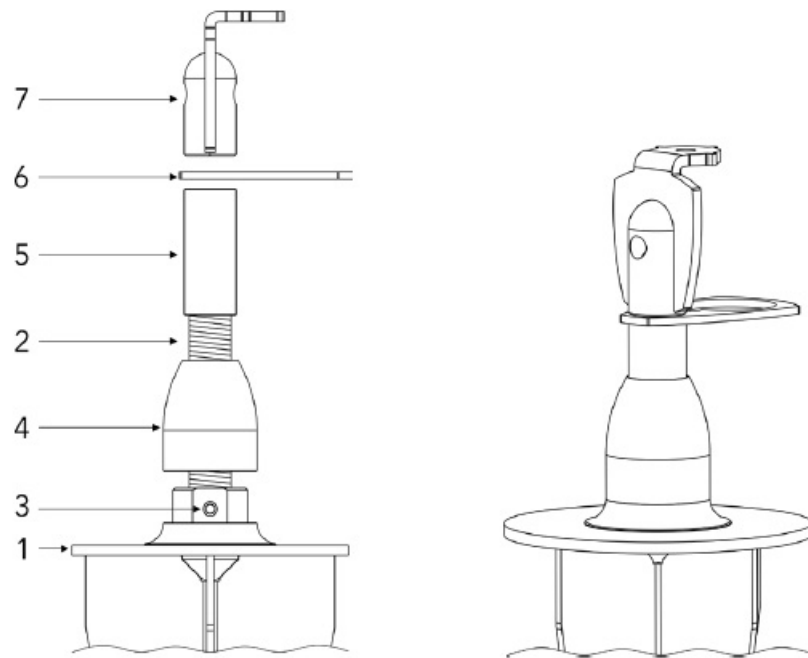

1X  M5x14

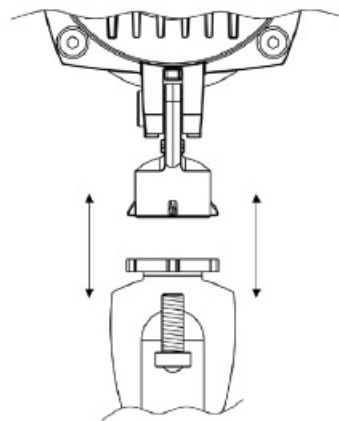

1. Insert the Land Spike into the ground. Underground part of Land spike (1) should be placed perpendicularly into the ground. (if you need to use tools to insert spike in the ground, use of some protective layer and applying pressure in the middle is recommended to prevent damaging of land spike).
2. Screw the threaded bar (2) into the top of underground part (1) and fasten it with the socket head M5x5 (3).
3. Slide the cover (4) on the threaded bar (2).
4. Slide the 36.5mm pipe cover (5) on the threaded bar (2).
5. Slide the cable holder (6) on the threaded bar (2).
6. Screw the nut with mount (7) on the threaded bar (2).
7. Fasten the luminaire on the mount (7) with one M5x14 screw from the bottom of luminaire.
8. Pass cable through the cable holder (6).

Land spike 2 ASO 4 MC Pixel 100 mm

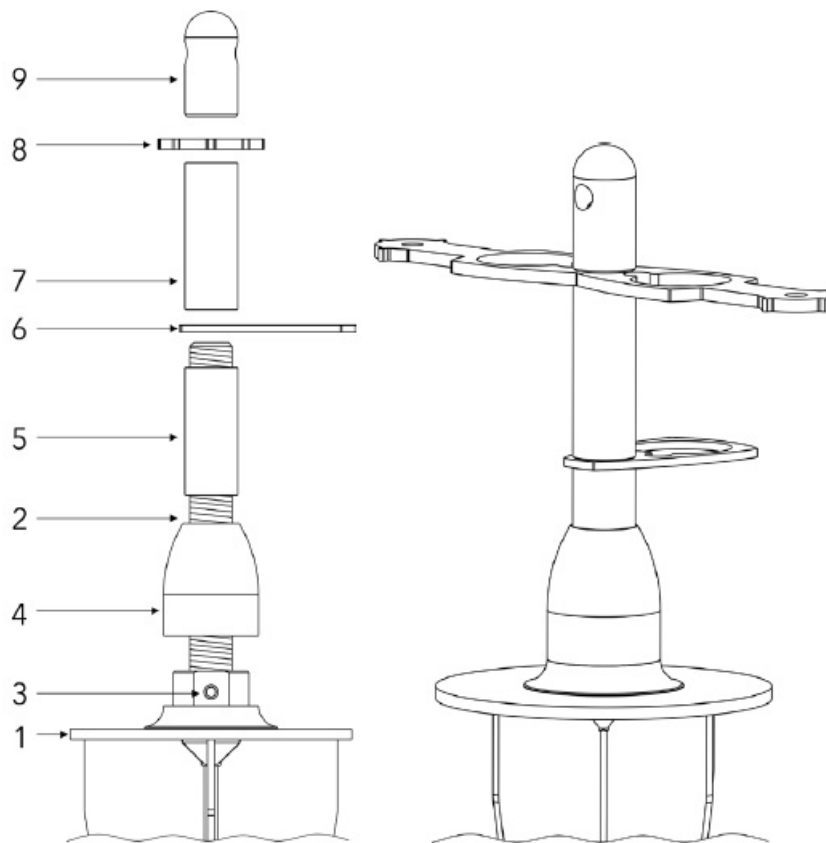

2X  M5x14

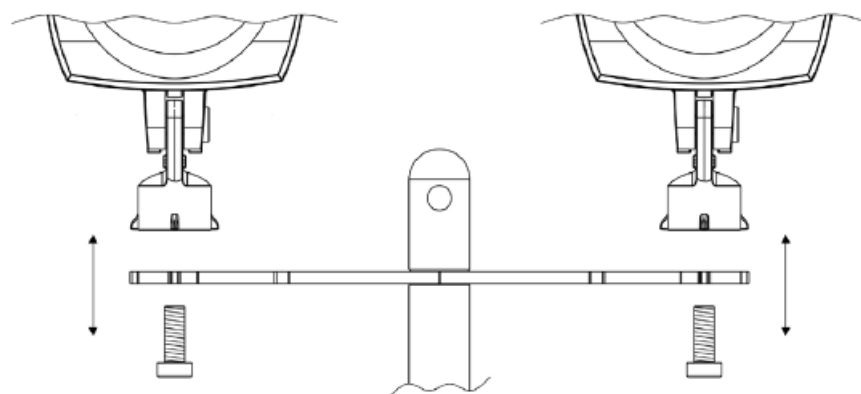

1. Insert the Land Spike into the ground. Underground part of Land spike (1) should be placed perpendicularly into the ground. (if you need to use tools to insert spike in the ground, use of some protective layer and applying pressure in the middle is recommended to prevent damaging of land spike).
2. Screw the threaded bar (2) into the top of underground part (1) and fasten it with the socket head M5x5 (3).
3. Slide the cover (4) on the threaded bar (2).
4. Slide the 36.5mm pipe cover (5) on the threaded bar (2).
5. Slide the cable holder (6) on the threaded bar (2).
6. Slide the 36.5mm pipe cover (5) on the threaded bar (2).
7. Slide the ArcSources holder (8) on the threaded bar.
8. Screw the nut (9) on the threaded bar.
9. Fasten both luminaires to the holder (8) with M5x14 screws from the bottom of each luminaire and its mount on the holder.
10. Pass the cable through the cable holder (6).

Land spike 1 ASO 4 MC Pixel 500 mm

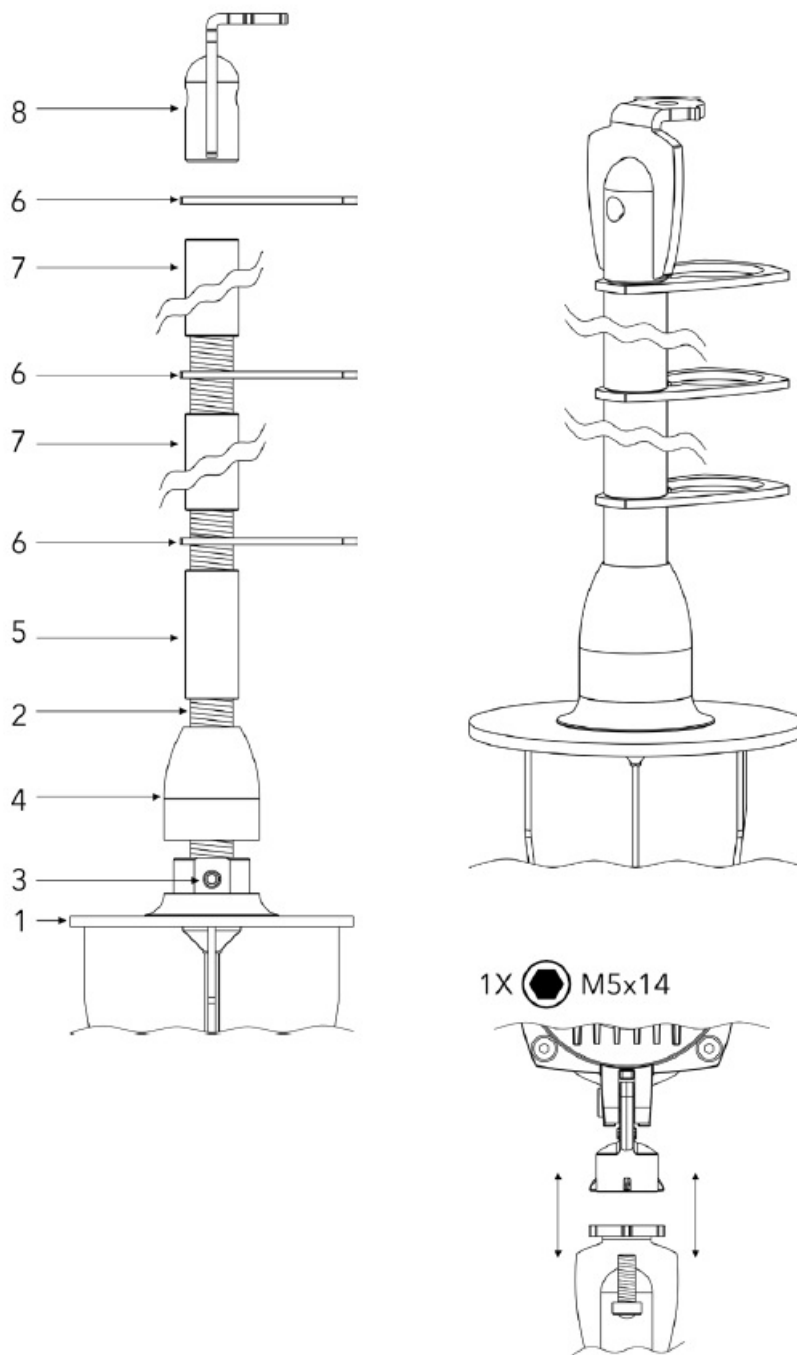

1. Underground part of Land spike (1) should be placed perpendicularly into the ground. (if you need to use tools to insert spike in the ground, use of some protective layer and applying pressure in the middle is recommended to prevent damaging of land spike)
2. Screw the threaded bar (2) onto the underground part of spike (1) and fasten it with the socket head M5x5 (3).
3. Slide the cover (4) on the treaded bar (2) and the socket head (3).
4. Slide the 36.5mm pipe cover (5) on the threaded bar (2).
5. Slide the cable holder (6) on the threaded bar (2).
6. Slide the 198mm pipe cover (7) on the threaded bar (2).
7. Slide the cable holder (6) on the threaded bar (2).
8. Slide the 198mm pipe cover (7) on the threaded bar (2).

9. Slide the cable holder (6) on the threaded bar (2).
10. Screw the nut with mount (8) on the threaded bar (2).
11. Fasten the luminaire on the mount (8) with one M5x14 screw from the bottom of luminaire and its mount.
12. Pass cable through the cable holders (6).

Land spike 2 ASO 4 MC Pixel 500 mm

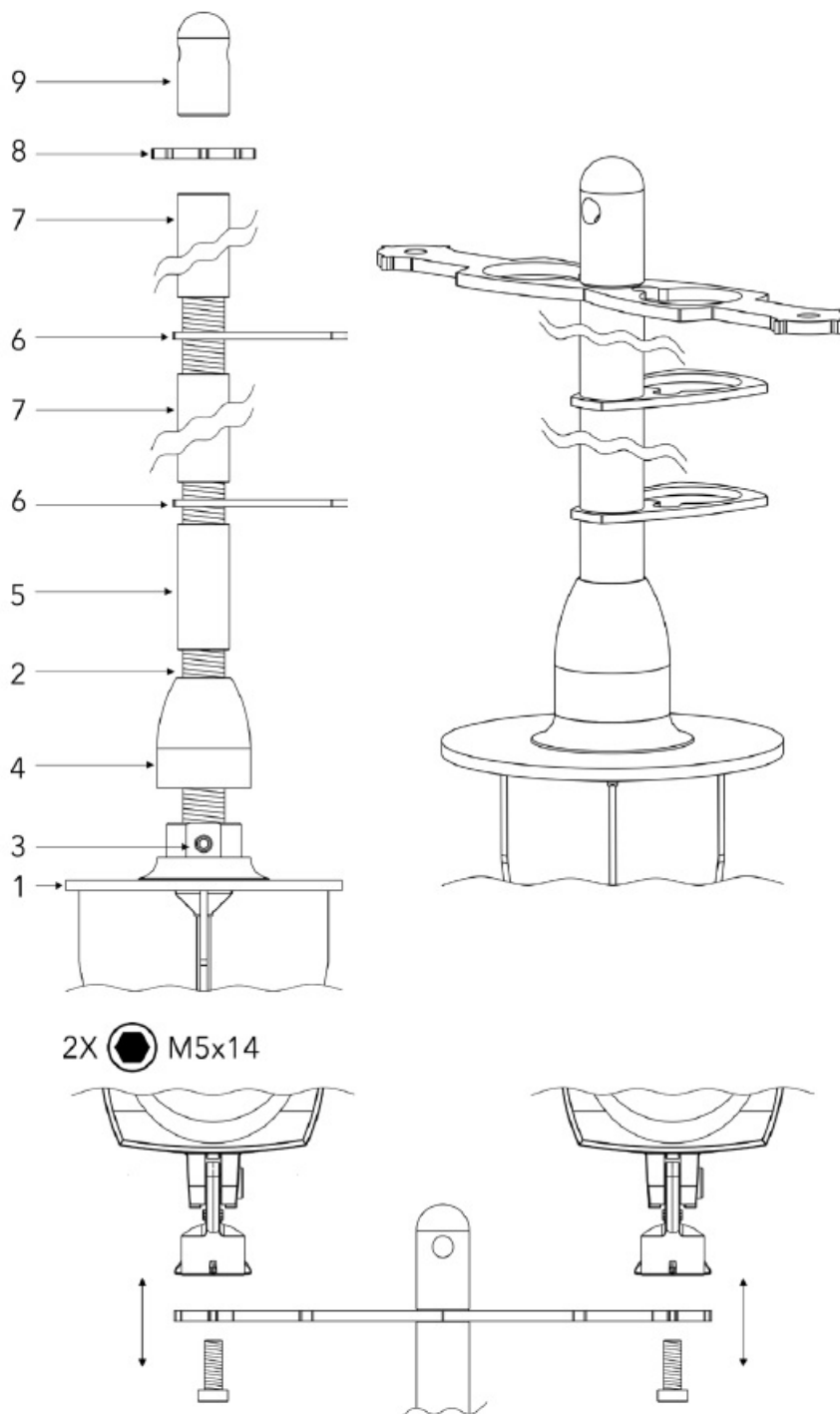

1. Underground part of Land spike (1) should be placed perpendicularly into the ground. (if you need to use tools to insert spike in the ground, use of some protective layer and applying pressure in the middle is recommended to prevent damaging of land spike)
2. Screw the threaded bar (2) onto the underground part of spike (1) and fasten it with the socket head M5x5 (3).
3. Slide the cover (4) on the treaded bar (2) and the socket head (3).

4. Slide the 36.5mm pipe cover (5) on the threaded bar (2).
5. Slide the cable holder (6) on the threaded bar (2).
6. Slide the 198mm pipe cover (7) on the threaded bar (2).
7. Slide the cable holder (6) on the threaded bar (2).
8. Slide the 198mm pipe cover (7) on the threaded bar (2).
9. Slide the ArcSources holder (8) on the threaded bar (2).
10. Screw the nut (9) on the threaded bar (2).
11. Fasten both luminaires to the holder (8) with M5x14 screws from the bottom of each luminaire and its mount.
12. Pass cables through the cable holder (6).

Land spike 3 ASO 4 MC Pixel 500 mm

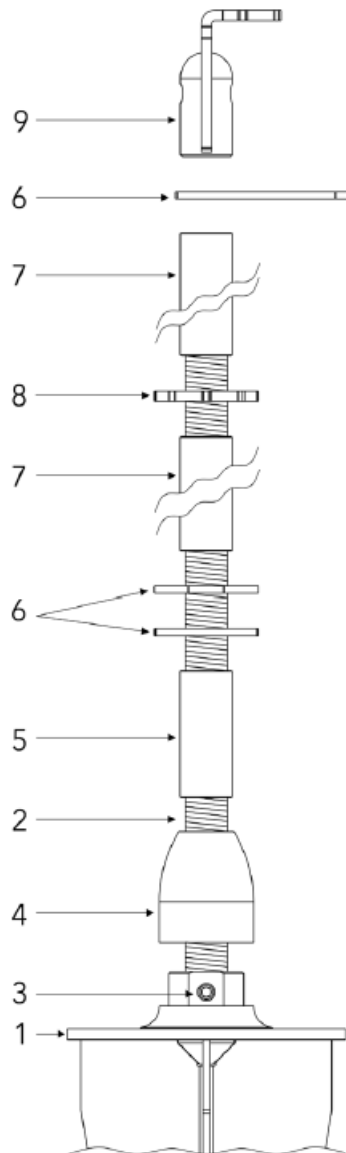

1. Underground part of Land spike (1) should be placed perpendicularly into the ground. (if you need to use tools to insert spike in the ground, use of some protective layer and applying pressure in the middle is recommended to prevent damaging of land spike)
2. Screw the threaded bar (2) onto the underground part of spike (1) and fasten it with the socket head M5x5 (3).
3. Slide the cover (4) on the treaded bar (2) and the socket head (3).
4. Slide the 36.5mm pipe cover (5) on the threaded bar (2).

5. Slide two cable holders (6) on the threaded bar (2).
6. Slide the 198mm pipe cover (7) on the threaded bar (2).
7. Slide the ArcSources holder (8) on the threaded bar (2).
8. Slide the 198mm pipe cover (7) on the threaded bar (2).
9. Slide the cable holder (6) on the threaded bar (2).
10. Screw the nut with mount (9) on the threaded bar (2).
11. Fasten three luminaires to their holders (8,9) with M5x14 screws from the bottom of each luminaire and its mount.
12. Pass cables through the cable holders (6).

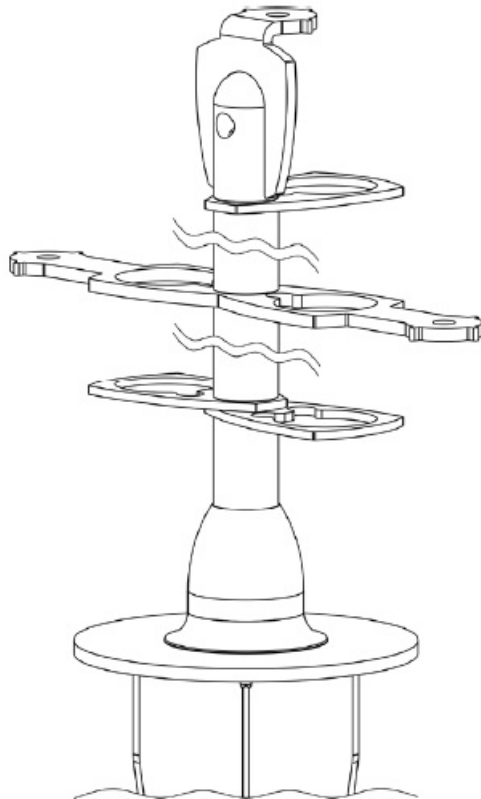

3X  M5x14

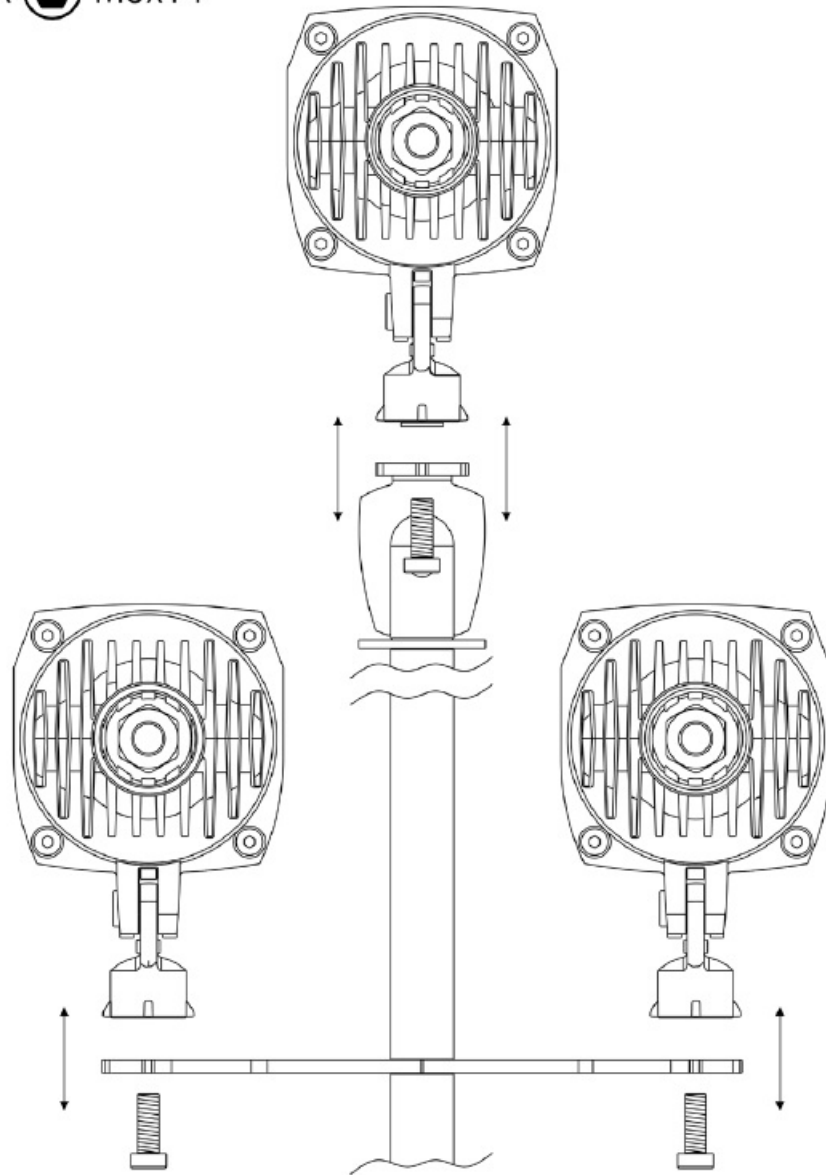

STEP 3 CONNECTION

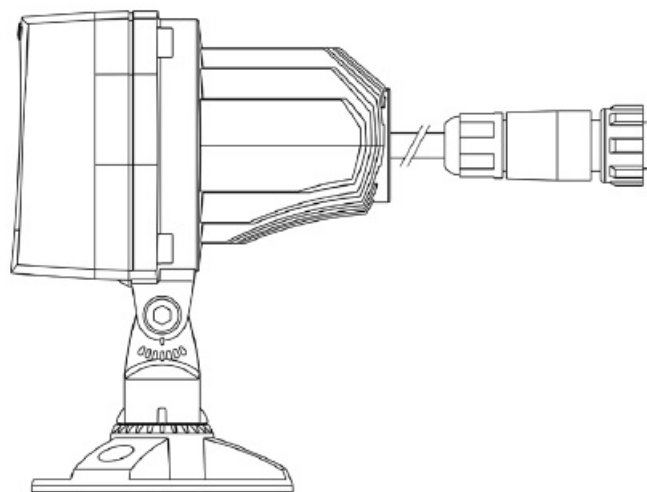

Connection of ArcSource Outdoor 4MC Pixel is provided by 50cm long cable with male connector. (variety of cable adaptors is available)

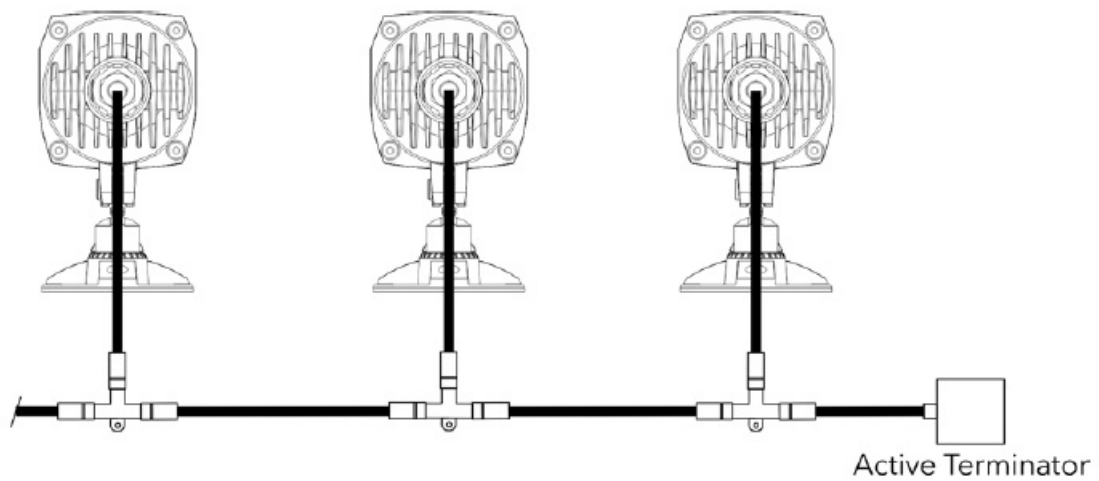

Before ASO 4MC Pixel are connected to power source, you have to connect the Active Terminator on the last luminaire in the row. That is necessary for correct identification of every single ASO 4MC Pixel and this has to be done for setup of eve-ry ASO 4MC Pixel row. You can change the Active Terminator box for Passive Terminator box, when the set up is finished.

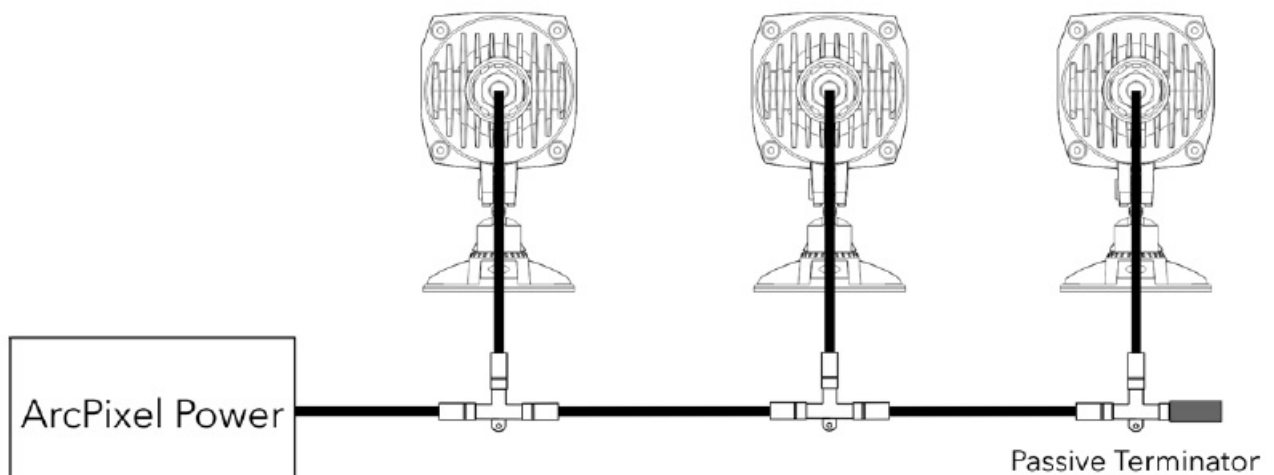

Connect luminaires to each other and to power supply via T-connectors and cables.

Recommended power supplies:

ArcPixel Rack Unit, ArcPixel Power.

Male connector

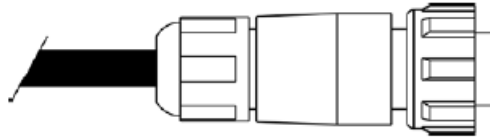

Female connector

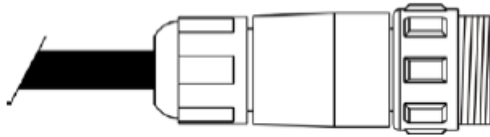

T-connector

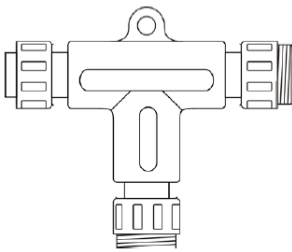

Active Terminator

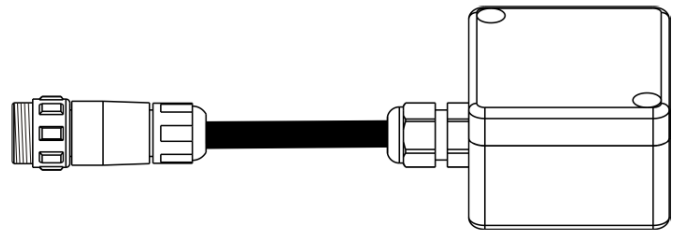

Passive Terminator

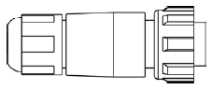

STEP 4
INSTALLATION ACCESSORIES
Half Top Hat and Top Hat

Half Top Hat

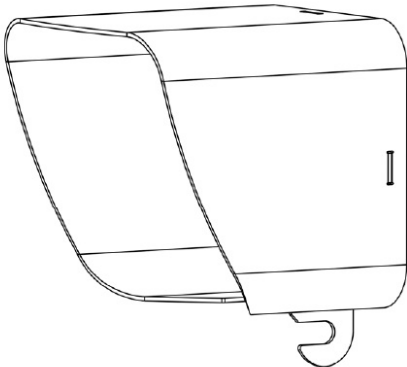

Top Hat

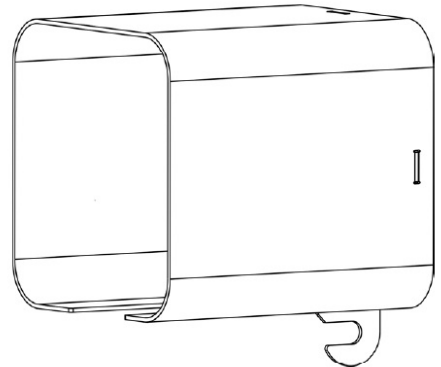

1X  M5x12

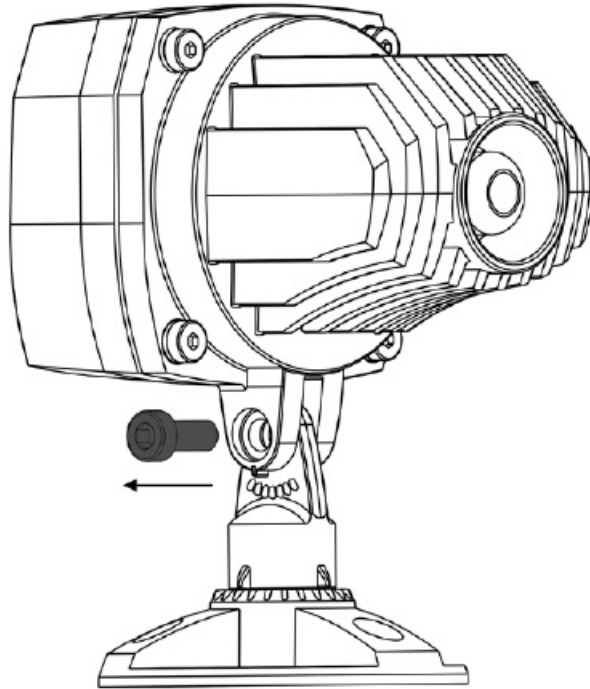

Unscrew the Allen head screw M5x12 from the ArcSource Outdoor 4MC Pixel housing and its base.

1X  M5x25

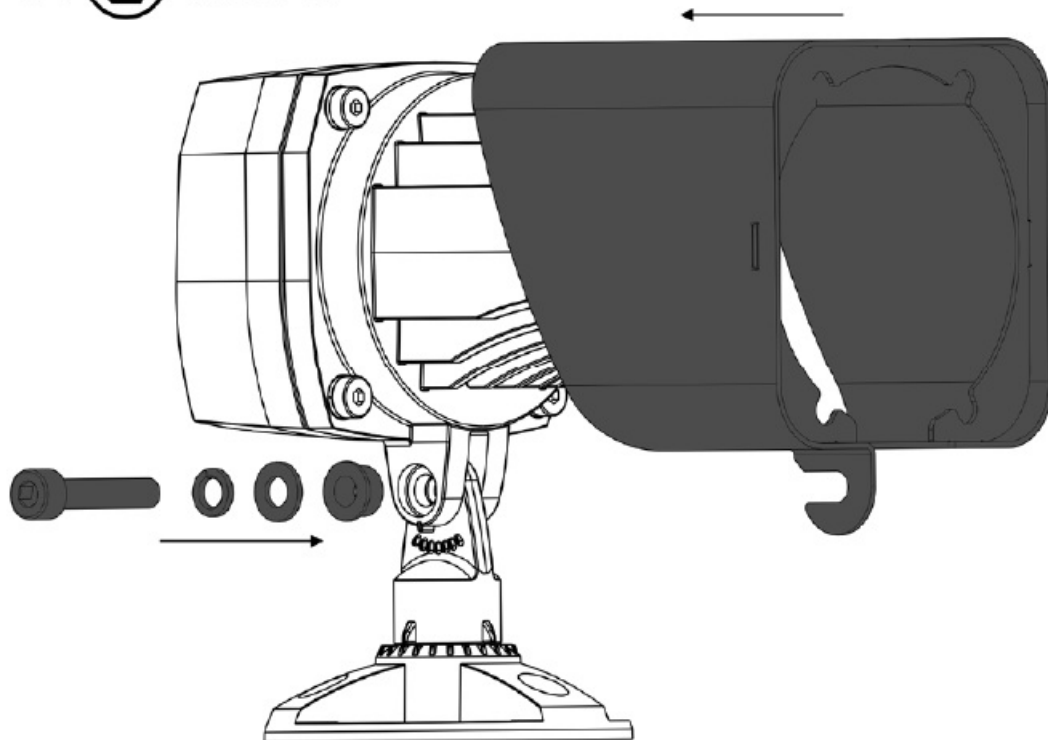

Screw the half top hat to luminaire body as is shown at the picture above.

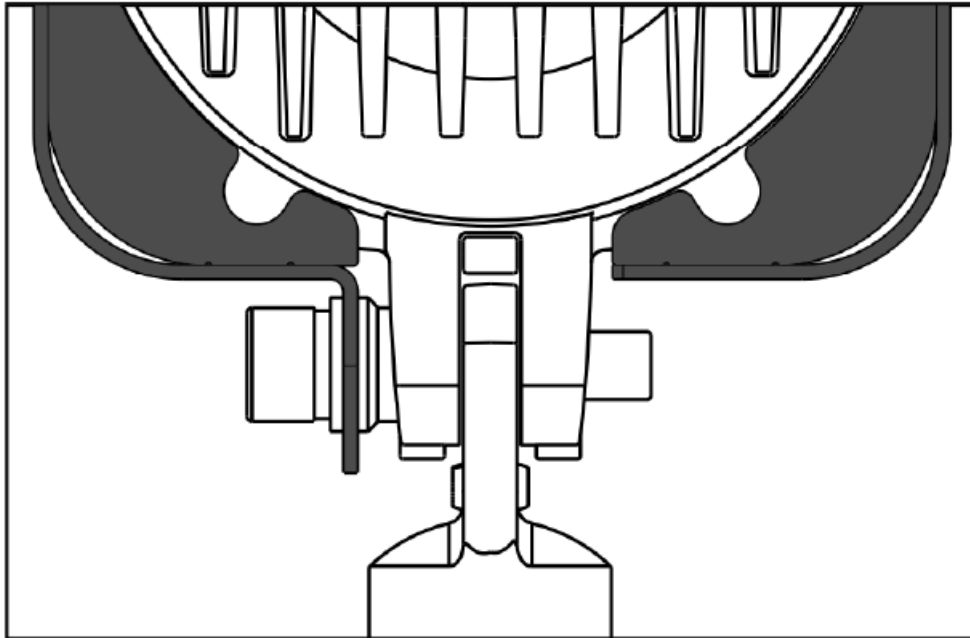

The accessories must be tightened between two washers. The correct position of the spring washer is in contact with the bolt head.

Twin Wall Cover (Flat / Round)

Flat

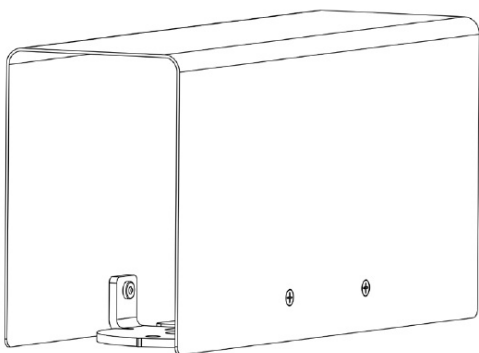

Round

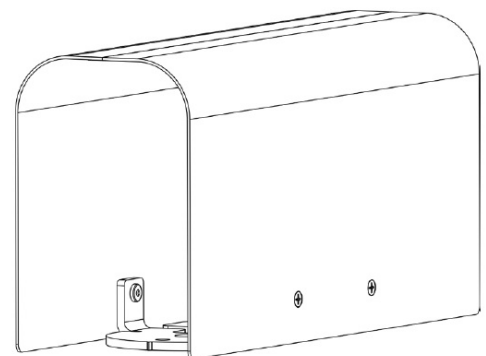

1

4X  M3x6

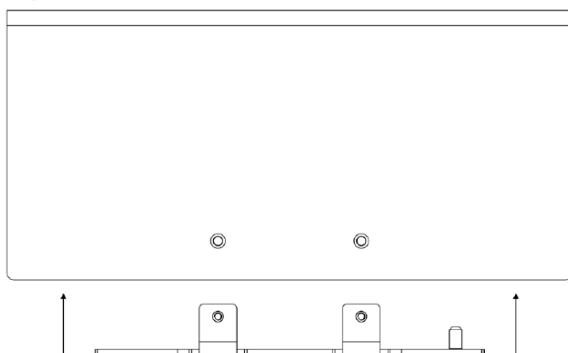

2

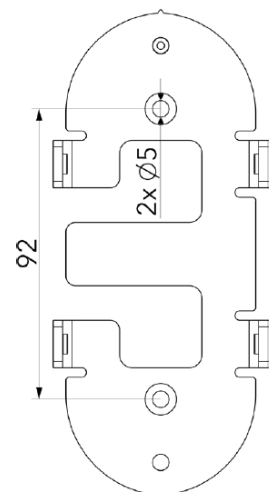

1. Unscrew four M3x6 screws from Twin Wall Cover and remove the cover from the luminares base holder.
2. Prepare openings for cables in the mounting surface, minimal diameter of 21mm, and if necessary also two mounting holes according to disposition above.

3

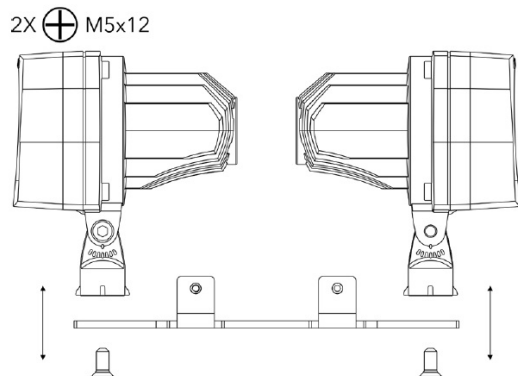

4

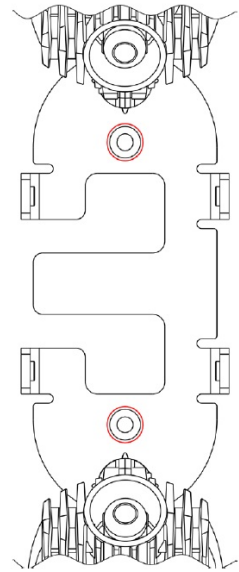

3. Fasten the luminaires (without their bases) to the holder with two M5x12 screws via two outer mounting holes.
4. Fasten the holder with luminaires to the mounting surface via two inner holes and fasteners suitable to mounting surface.

Twin Wall Cover (Flat / Round)

5

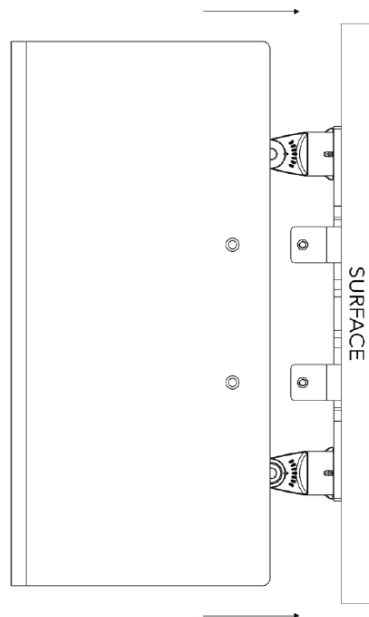

6

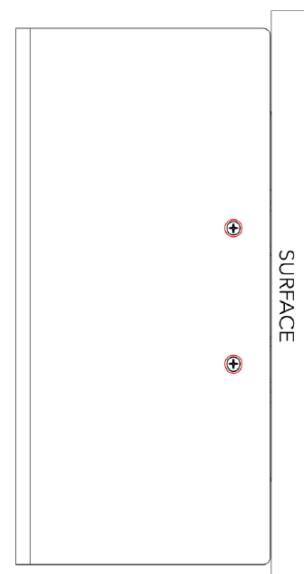

5. Slide the cover on the luminaires holder mounted on the surface.
6. Fasten the cover to the holder by four M3x6 screws.

Pipe Clamp diameter 19

1

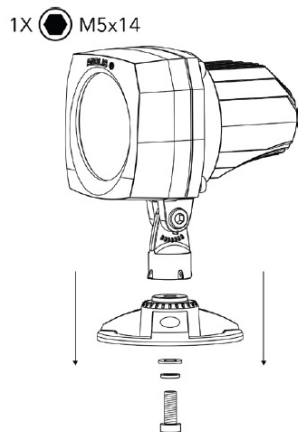

2

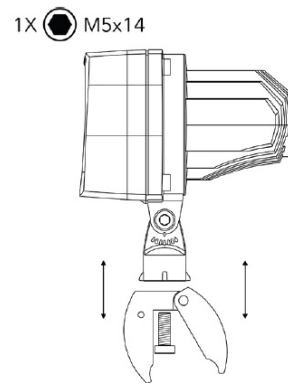

1. Unscrew M5x14 from the bottom of luminaire and remove its base.
2. Fasten the Pipe Clamp to the luminaire with M5x14 as illustrated.

3

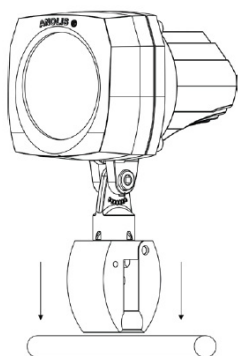

4

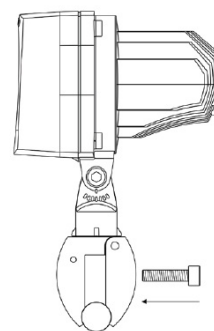

3. Place the Pipe Clamp on a construction rod of 19mm in diameter.
4. Fasten the Pipe Clamp to the construction rod by MX screw until it is tightened well and holds luminaire firmly.

Optical Demo Set

Holder with spring clips and Optical foil

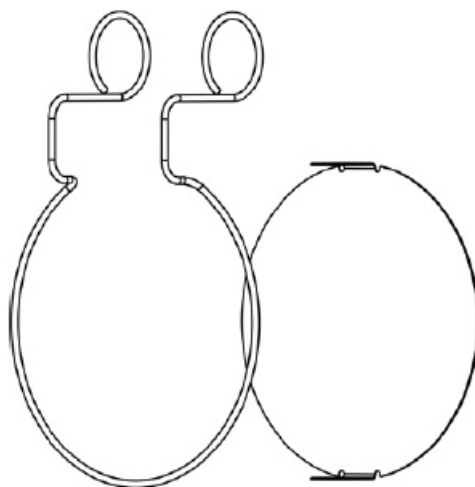

1

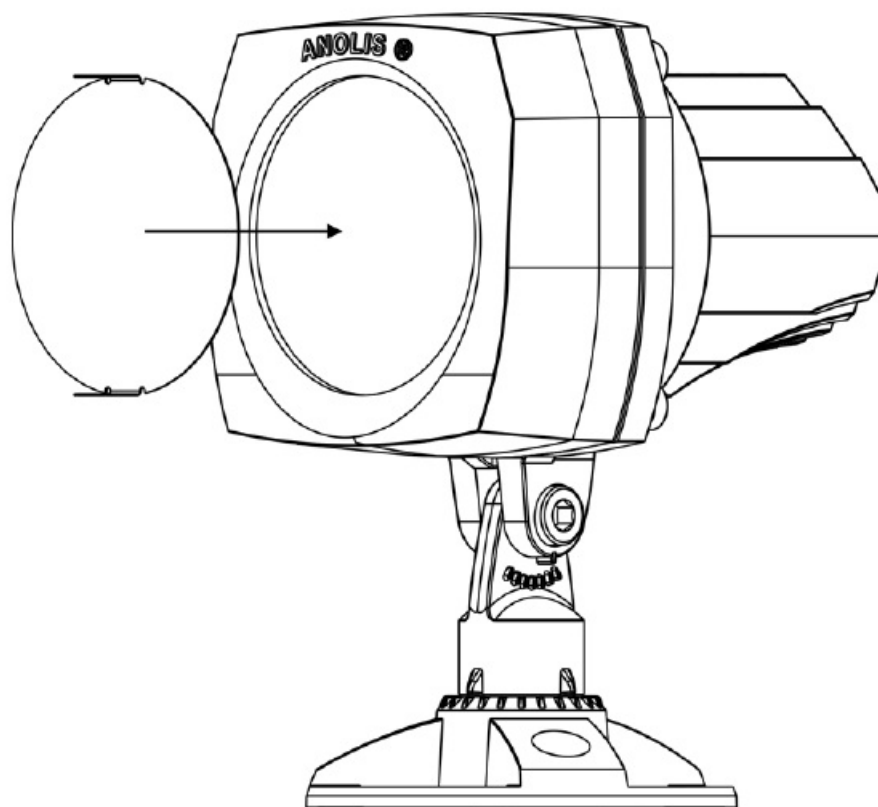

1. Put the Optical Foil on the luminaire's optic.

2

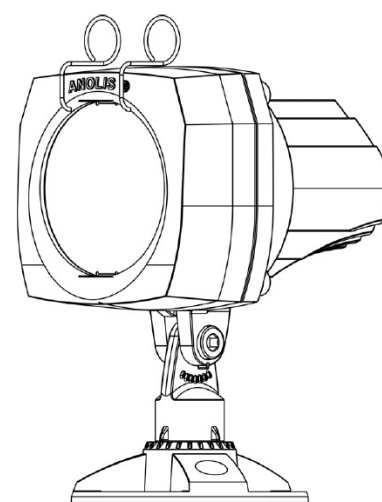
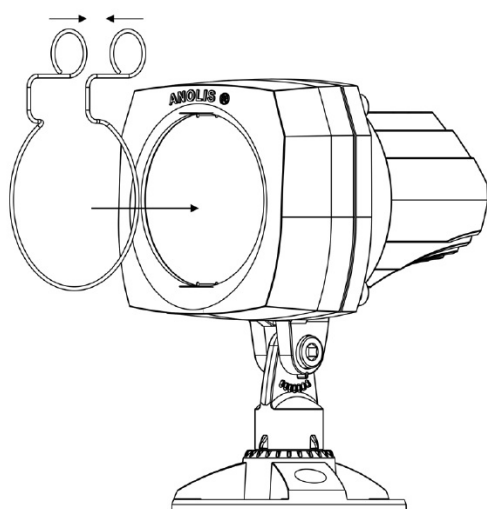

2. Press the springs of the Holder together, place the Holder on top of the Optical Foil and secure it on the luminaire by releasing the springs.
3. ArcSource Outdoor 4MC Pixel with Optical Demo Set in-stalled. Holder secures the Optical Foil on the luminaire firmly.

Documents / Resources

	<p>Anolis Arcpixel Power ArcSource Outdoor 4MC Pixel [pdf] Instruction Manual Arcpixel Power ArcSource Outdoor 4MC Pixel, Arcpixel Power, ArcSource Outdoor 4MC Pixel, Outdoor 4MC Pixel, 4MC Pixel</p>
---	---

References

- [User Manual](#)