

anko TB-2052 Mini Eyelash and Brow Set



anko TB-2052 Mini Eyelash and Brow Set Instruction Manual

[Home](#) » [Anko](#) » anko TB-2052 Mini Eyelash and Brow Set Instruction Manual 

Contents

- 1 anko TB-2052 Mini Eyelash and Brow Set
- 2 Specifications:
 - 2.1 Product Usage Instructions
 - 2.2 Safety Instructions
 - 2.3 Device Specifications
 - 2.4 Device Description
 - 2.5 Preparing the Device for Use:
 - 2.6 How to Use
 - 2.7 Cleaning & Maintenance
 - 2.8 Warranty & Support
 - 2.9 Device Description
 - 2.10 FEATURES
 - 2.11 TROUBLE CLEARING
 - 2.12 Documents / Resources
 - 2.12.1 References

anko

anko TB-2052 Mini Eyelash and Brow Set



Specifications:

- **Name:** Heated Eyelash Curler
- **Model No.:** TB-2052
- **Type of Battery:** AAA x 1 (Not Included)

Product Usage Instructions

Preparing the Device for Use:

1. Install the Battery:

- Ensure the device is switched off before installing the battery.
- Remove the battery compartment cover by holding the upper area of the device with one hand and pulling firmly with the other hand.
- Insert one AAA battery according to the correct polarity as indicated in the battery compartment.

How to Use:

1. Apply mascara on the eyelashes from root to tip, repeating 2-3 times.
2. Remove the protective cap and switch on the device by sliding up the on/off switch. The device will start preheating automatically.
3. When the temperature sensor changes from blue to red, indicating the ideal curling temperature, the device is ready to use.
4. Hold the heating comb against the root of the upper eyelashes for approximately 3 seconds, then brush upwards to the tip. Gently press the tip for 3 seconds. Repeat this process 2-3 times. For corner eyelashes, comb upwards diagonally.
5. To curl bottom eyelashes, brush from root to tip, repeating 2-3 times.
6. After use, switch off the device.

Cleaning & Maintenance:

1. Ensure the device is switched off before cleaning.
2. Do not immerse or wash under running water. Clean with a clean slightly wet cloth.
3. Avoid using steel wool, abrasive cleansers, chemicals, or corrosive liquids.
4. Do not use lubricants, detergents, polishing agents, or air fresheners on the device.
5. Remove mascara on the heated comb with a cotton swab moistened with makeup remover and clean with a cotton swab moistened with water. Allow to dry in a well-ventilated place.

Storage:

Do not leave the device in a wet or humid place. If not using for an extended period, remove the battery and store properly.

Recycling:

Batteries may contain harmful substances. Before disposal, remove the battery and do not dispose of together with domestic waste. Hand over to an official recycling point.

FAQ:

Q: Can I use rechargeable batteries with this device?

A: It is recommended to use a standard AAA battery for optimal performance.

MINI EYELASH AND BROW SET
TB-2052 & TB-858
INSTRUCTION MANUAL

Safety Instructions

To ensure proper operation of this device, please read this instruction manual carefully before using the device and keep it for further reference.

WARNING

- The following persons should not use this device: persons with allergies; persons with wounds, inflamed or swollen skin in the eye contour; persons with conjunctivitis or other eye condition.
- This device is not intended for use by persons (including children) with reduced physical, sensory or mental capabilities, or lack of experience and knowledge, unless they have been given supervision or instruction concerning the use of the device by a person responsible for their safety.
- Do not use the device while wearing contact lenses. Please check the device before you start using it. Do not use this device if you detect any damage or malfunction.
- Immediately discontinue use and consult a doctor if you feel any discomfort or abnormality in your eyes or eyelids during use.

CAUTION

- Keep the device out of reach of children.

- Clean the device regularly to extend its lifetime.
- Do not share the same device with others.
- Do not attempt to modify, disassemble, or repair the device by yourself to prevent accidents.
- This device is powered by a battery. If you do not intend to use the device for an extended period of time, remove the battery.

Device Specifications

- **Name:** Heated Eyelash Curler
- **Model No.:** TB-2052
- **Type of Battery:** AAA x 1 (Not Included)

Device Description

1. Protective Cap
2. Heated Comb
3. Silicone Temperature Sensor
4. ON/OFF Switch
5. Battery Compartment Cover

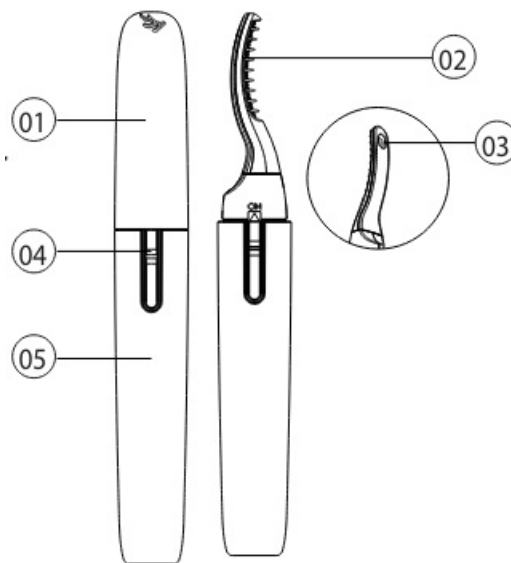

Picture 1

Preparing the Device for Use:

Install the Battery

Ensure the device is switch off before you install the battery. Remove the battery compartment cover by holding the upper area of the device with one hand, with the other hand hold the battery compartment cover, and pull firmly to remove it. Insert one AAA battery according to the correct polarity (positive and negative), as indicated in the battery compartment. (Picture 2)

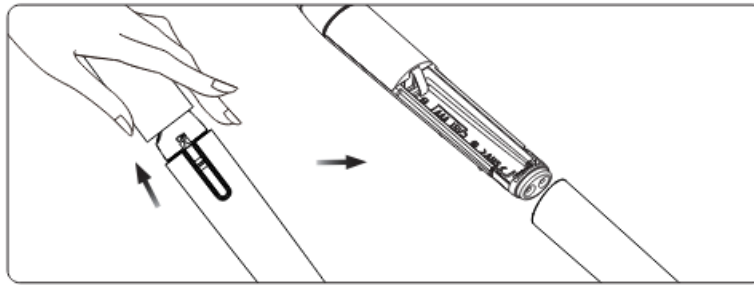

Picture 2

How to Use

To ensure the correct operation of this device, please read the instructions carefully before use.

1. Apply mascara on the eyelashes from root to tip, repeat 2- 3 times. (Picture 3)
2. Remove the protective cap. Switch on the device by sliding up the on/off switch. The device starts preheating automatically.
3. When the temperature sensor changes from blue to red, the device reached the ideal curling temperature, and the device is ready to use. (Picture 4)



Picture 3

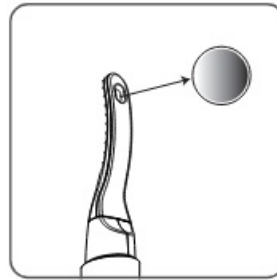

Picture 4

4. Hold the heating comb against the root of the upper eyelashes for approximately 3 sec, and brush upwards until you reach the tip of the eyelashes. Gently press the tip for approximately 3 sec. Repeat this process 2-3 times. For eyelashes at the corner of the eyes, comb upwards in a diagonal motion. (Picture 5)

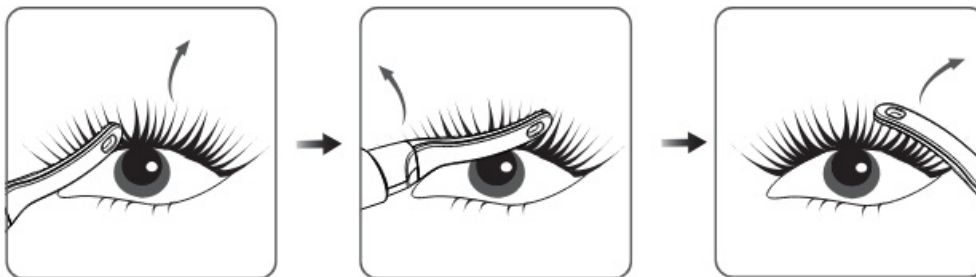

Picture 5

5. To curl bottom eyelashes, brush from root to tip, repeat this procedure 2-3 times. (Picture 6)
6. After use, switch off the device.



Picture 6

Cleaning & Maintenance

1. Ensure the device is switch off before you start cleaning.
2. Do not immerse it or wash under running water. Clean the device with a clean slightly wet cloth.
3. Do not use steel wool, abrasive cleansers, chemicals, or corrosive liquids to clean the device.
4. Do not use lubricants, detergents, polishing agents, or air fresheners on this device.
5. Remove the mascara on the heated comb with a cotton swab moistened with makeup remover, afterward clean it with a cotton swab moistened with water. Allow it to dry in a well-ventilated place.

Storage:

Do not leave the device in a wet or humid place. If you do not intend to use the device for an extended period of time, remove the battery and store the device properly.

Recycling:

Batteries may contain substances harmful to the environment. Before disposing of this device, remove the battery. Do not dispose of this device and battery together with the domestic waste. Instead, hand them over to an official recycling point to contribute to environmental protection.

Warranty & Support

Troubleshooting

Problem	Possible Cause	Solution
The heated comb temperature is low.	The battery is low.	Replace the battery as instructed in this instruction manual.
	Using the device in a room with a temperature below 15°C.	This is normal.
The curling effect is not satisfying.	The heated comb has not preheated completely.	Use the device only after the temperature sensor on the back of the heated comb changes from blue to red.
Eyelids feel hot when using the device.	You are pressing the heated comb against the eyelids.	Use the device in front of a mirror to avoid pressing the heating comb on the eyelids.
Other problems.		Consult your local dealer.

Note: If the device still does not work properly after using the above solutions, please stop using the device and

contact your local dealer.

Device Description

1. Trimmer Blade
2. Power Switch
3. Blade Release Button
4. Battery Cover
5. Protective Cap
6. Long Eyebrow Comb
7. Short Eyebrow Comb
8. Cleaning Brush

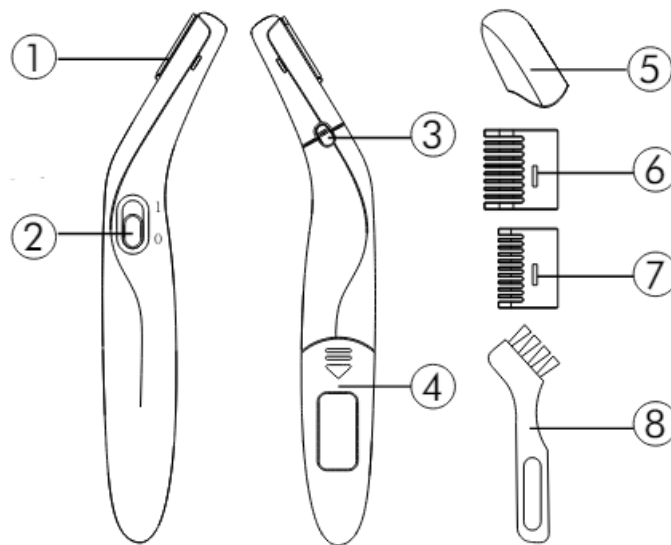

Picture 1

FEATURES

1. Gently, quickly and painlessly removes and trims hair without irritation. Also safe for sensitive skin.
2. Ideal for removing hair from Bikini area and also eyebrows, face, underarms and whole body.
3. Tilted cutting head is good for holding and trimming.
4. With 2 combs. The big comb for body hair trimming and the small comb for eyebrow.
5. Sleek and compact, this shaver fits easily in your purse and cosmetic bag.
6. x 1 AAA battery required (not provided).

HOW TO USE

How to install battery

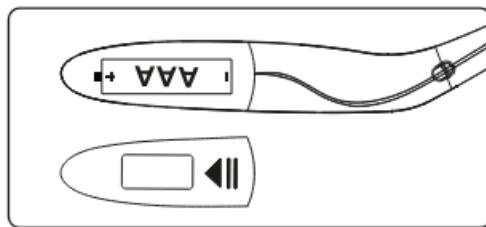

Slide the battery cover down and insert 1 AAA battery as shown above. Replace the cover. (Battery not included)

How to use:

1. Remove the cap before use.
2. Slide the power switch up to the "ON" position to turn on the unit.
3. Close the blade head to your skin and remove unwanted hair by moving it in the opposite direction of hair growth.
4. Attach the big comb or small comb to the blade head for body hair trimming or eyebrows.
5. Slide the power switch down to turn off the unit after each use.

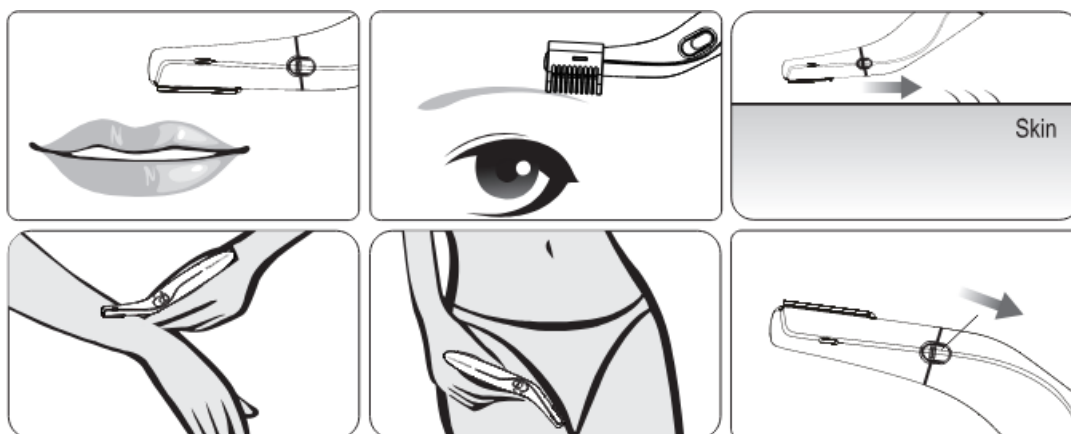

How to clean

1. Use the cleaning brush to remove any hair that has accumulated on the blade.
2. If necessary for cleaning, the blade head may be removed by sliding the latch down away from the tip.
3. Clean the main body with wet/dry cloth or tissue if dirty.
4. This product is not water resistant. Don't wash it with water.

ATTENTION

1. Remove battery if the product will not be used for an extended period.
2. Keep out of reach of children.
3. DO NOT disassemble the main body .

TROUBLE CLEARING

Feature	Fault Cause	Processing Method
Poor trimming effect	The blade was deformed or damaged.	Replace with a new blade.
	Worn blades.	
Does not work	Battery installed incorrectly.	Reinstall battery correctly.
	Low battery.	Install new battery.
Blade loose	The blade head not locked correctly.	Lock the blade head correctly.

12 Month Warranty

Your new product is warrantied to be free from defects in materials and workmanship for the period stated above, from the date of purchase, provided that the product is used in accordance with accompanying recommendations or instructions where provided. This warranty is in addition to your rights under the Australian Consumer Law.

For New Zealand customers, this warranty is in addition to statutory rights observed under New Zealand legislation.

We will provide you with your choice of a refund, repair (where possible) or exchange (availability dependent) for this product if it becomes defective within the warranty period. The business will bear the reasonable expense of claiming the warranty. This warranty will no longer apply where the defect is a result of alteration, accident, misuse, abuse or neglect.

Please retain your receipt as proof of purchase and contact our Customer Service Centre as listed below, for the entity you purchased this product from, for any difficulties with your product. Warranty claims and claims for expense incurred in returning this product can be addressed to the respective

Customer Service Centre.

Our goods come with guarantees that cannot be excluded under the Australian Consumer Law. You are entitled to a replacement or refund for a major failure and compensation for any other reasonably foreseeable loss or damage.

You are also entitled to have the goods repaired or replaced if the goods fail to be of acceptable quality and the failure does not amount to a major failure.

Contact for Kmart purchases	Contact for Target purchases
Kmart Australia Ltd.	Target Australia Pty Ltd
C/- Customer Service Centre	C/- Customer Service Centre
690 Springvale Road, Mulgrave	2 Kendall Street, Williams
Vic 3170	Landing, Vic, 3027
Customer Service: 1800 124 125	Customer Service:
(Australia) or 0800 945 995	1300 753 567
(New Zealand) or via Customer	or via Customer Help at
Help at kmart.com.au	target.com.au/help/contact-us

Documents / Resources

	Anko TB-2052 Mini Eyelash and Brow Set [pdf] Instruction Manual TB-2052, TB-858, TB-2052 Mini Eyelash and Brow Set, TB-2052, Mini Eyelash and Brow Set, Eyelash and Brow Set, Brow Set
---	---

References

- [Kmart.com.au](https://www.kmart.com.au)
- [User Manual](#)

[Manuals+](#), [Privacy Policy](#)

This website is an independent publication and is neither affiliated with nor endorsed by any of the trademark owners. The "Bluetooth®" word mark and logos are registered trademarks owned by Bluetooth SIG, Inc. The "Wi-Fi®" word mark and logos are registered trademarks owned by the Wi-Fi Alliance. Any use of these marks on this website does not imply any affiliation with or endorsement.