

anko

anko Pet Timer Dual
Feeder



anko Pet Timer Dual Feeder Instructions

[Home](#) » [Anko](#) » anko Pet Timer Dual Feeder Instructions 

Contents

- [1 anko Pet Timer Dual Feeder](#)
- [2 PET TIMER DUAL FEEDER](#)
- [3 HOW TO USE](#)
- [4 Documents / Resources](#)
 - [4.1 References](#)
- [5 Related Posts](#)

anko

anko Pet Timer Dual Feeder



Instruction

Pet Timer Dual Feeder

Components

- **Lid:** The cover that opens to reveal the bowls.
- **Dial:** The mechanism used to set the timer.
- **Timer/Dial:** The combined component for setting feeding times.
- **Removable bowls:** The containers where food is placed.

How to Use

1. Align the arrow on the dial with the arrow on the feeder to open the feeder.
2. Fill each bowl with dry or wet food.
3. Close the lids. Set the timers by turning the dial to the number of hours between now and when you want your pet fed. For example, if it's 9 AM and you set one dial to 3 and one to 8, then the corresponding lids will open at 12 PM and 5 PM.

Specifications

Battery Type	1 x AA (not included)
Keycode	43423194

Warnings

- Batteries are to be inserted with the correct polarity (+ and -).
- Do not mix different types of batteries or new and used batteries.
- Non-rechargeable batteries are not to be recharged.
- Rechargeable batteries are only to be charged under adult supervision.
- The supply terminals are not to be short-circuited.
- Remove batteries from the toy when not in use for an extended time or when batteries become exhausted.
- Battery installation by an adult is required.
- Dispose of batteries responsibly. Do not dispose of in fire.

FAQ

1. Q: How do I open the feeder?

A: Align the arrow on the dial with the arrow on the feeder to open it.

2. Q: Can I use wet food in the feeder?

A: Yes, you can fill each bowl with either dry or wet food.

3. Q: How do I set the feeding times?

A: Close the lids and set the timers by turning the dials to the number of hours between now and when you want your pet fed.

4. Q: What type of battery does the feeder use?

A: The feeder uses 1 x AA battery (not included).

5. Q: Can I mix different types of batteries?

A: No, do not mix different types of batteries or new and used batteries.

Pet Timer Dual Feeder

Instruction

PET TIMER DUAL FEEDER

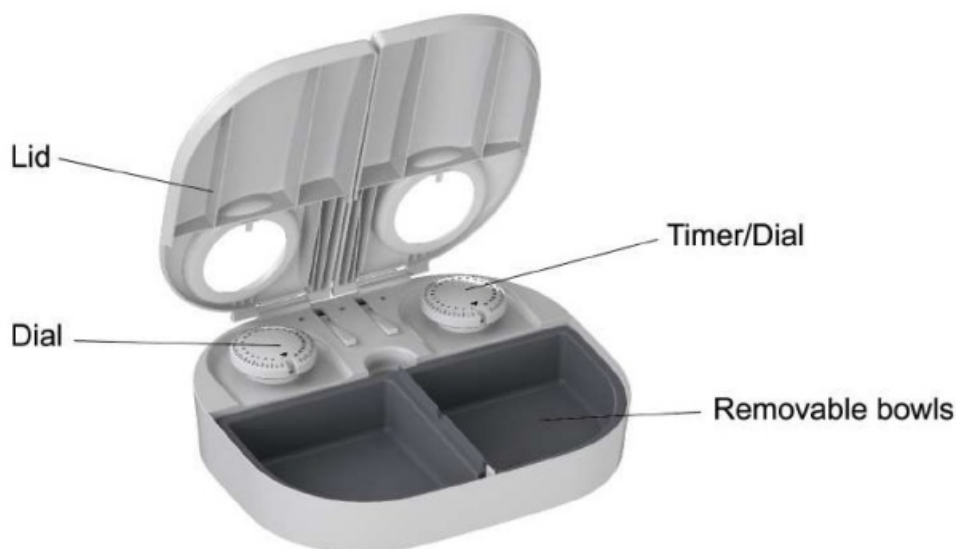

HOW TO USE

1. Align the arrow on the dial with the arrow on the feeder to open the feeder.
2. Fill each bowl with dry or wet food.



3. Close the lids. Set the timers by turning the dial to the number of hours between now and when you want your pet fed. For example, if it's 9 AM and you set one dial to 3 and one to 8, then the corresponding lids will open at 12 PM and 5 PM.



WARNING:

BATTERIES ARE TO BE INSERTED WITH THE CORRECT POLARITY (+ AND -). DO NOT MIX DIFFERENT TYPES OF BATTERIES OR NEW AND USED BATTERIES. NON-RECHARGEABLE BATTERIES ARE NOT TO BE RECHARGED. RECHARGEABLE BATTERIES ARE ONLY TO BE CHARGED UNDER ADULT SUPERVISION. THE SUPPLY TERMINALS ARE NOT TO BE SHORT-CIRCUITED. REMOVE BATTERIES FROM THE TOY WHEN NOT IN USE FOR AN EXTENDED TIME OR WHEN BATTERIES BECOME EXHAUSTED. BATTERY INSTALLATION BY AN ADULT IS REQUIRED. DISPOSE OF BATTERIES RESPONSIBLY. DO NOT DISPOSE OF IN FIRE.

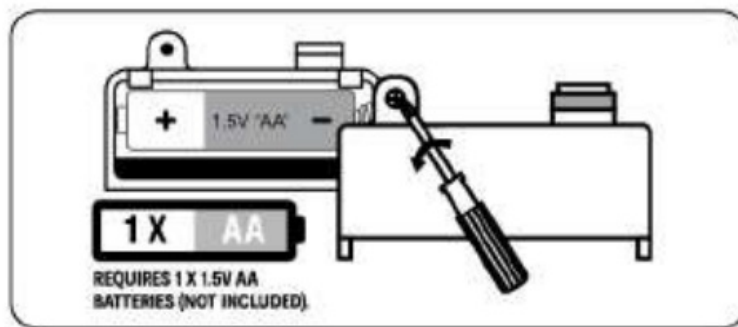

THE PRODUCT MAY VARY SLIGHTLY FROM IMAGE SHOWN. PLEASE KEEP PACKAGING FOR FUTURE REFERENCE. FOR YOUR PET'S SAFETY, INSPECT REGULARLY AND REMOVE IF DAMAGED. KEYCODE: 43423194

Documents / Resources

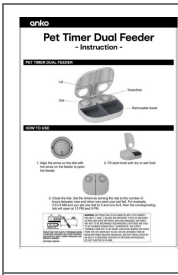

[Orbit Pet Timer Dual Feeder](#) [pdf] Instructions
Pet Timer Dual Feeder, Pet Timer, Dual Feeder, Feeder

References

- [User Manual](#)

Manuals+, Privacy Policy

This website is an independent publication and is neither affiliated with nor endorsed by any of the trademark owners. The "Bluetooth®" word mark and logos are registered trademarks owned by Bluetooth SIG, Inc. The "Wi-Fi®" word mark and logos are registered trademarks owned by the Wi-Fi Alliance. Any use of these marks on this website does not imply any affiliation with or endorsement.