



anko 43131976 Switch 4-in-1 Charging Dock Instruction Manual

[Home](#) » [Anko](#) » anko 43131976 Switch 4-in-1 Charging Dock Instruction Manual 



Instruction manual
Switch 4-in-1 Charging Dock
Keycode: 43131976

Contents

- [1 Safety instructions:](#)
- [2 Package Include:](#)
- [3 Specification:](#)
- [4 Features:](#)
- [5 Charging Instruction:](#)
- [6 Documents / Resources](#)
- [7 Related Posts](#)

Safety instructions:

1. Place the Controller correct direction of the charging stand.
2. Use a soft, dry cloth to clean the product. Do not use solvents or other chemicals.
3. Do not wipe with a chemically-treated cleaning cloth.
4. Do not place the Charging Stand direct in sunlight or a high temperature and humid place.
5. Do not disassemble the charging stand.
6. Do not touch the product with wet hands.

7. Do not throw or drop the product or subject it to strong physical shock.
8. Do not touch the ports or insert any foreign objects into the product.
9. Keep the product out of the reach of small children due to small children may swallow small parts or may wrap the cables around themselves, which may inflict injury or cause an accident or a malfunction.

Package Include:

- 1 x Red color left part of charging dock
- 1 x Black color right part of charging dock
- 2 x Tape
- 1 x User manual

Specification:

Input Voltage: DC 5V/1.5A

USB Output Voltage: DC 5V/500mA

Joy-Pad Output Voltage: DC 5V/250mA*4

Features:

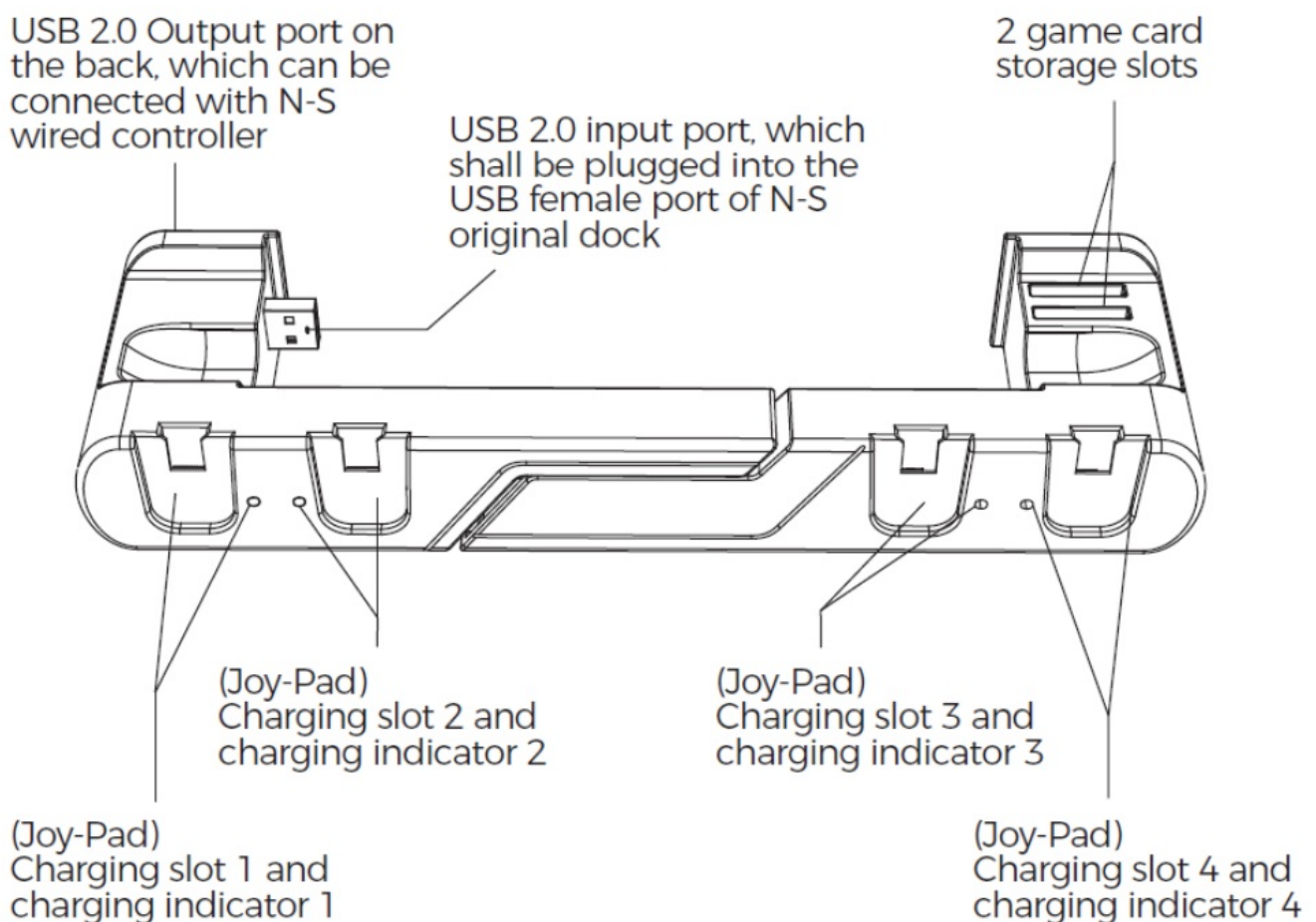

Charging Instruction:

1. Insert the red left part into the original console dock (the product's USB male port should be aligned with the USB female port of the original dock for inserting),

2. Connect the original console USB adapter with the docking. the front two charging indicators will turn green.

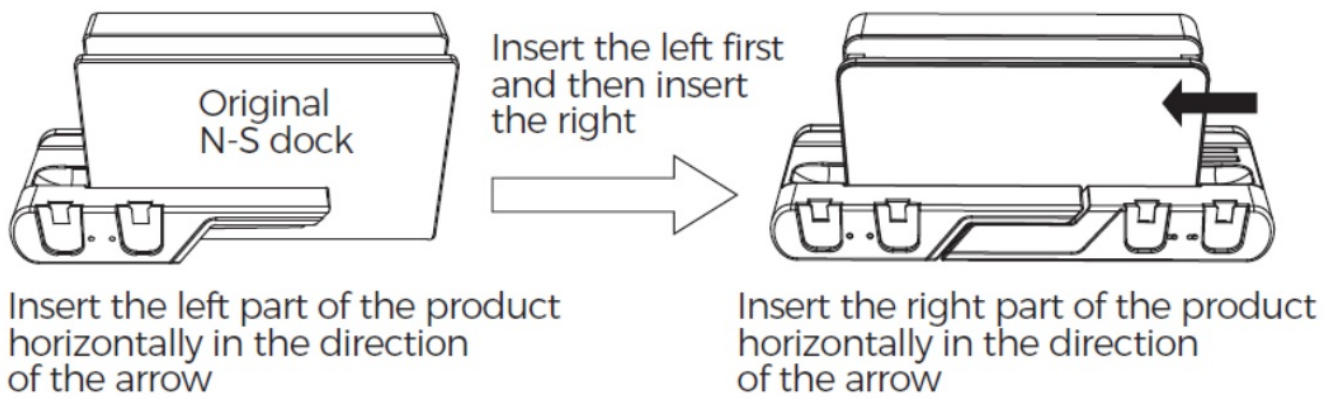

Note: You can stick the tape (included) on the charging dock to keep it with original N-S console dock more stable.

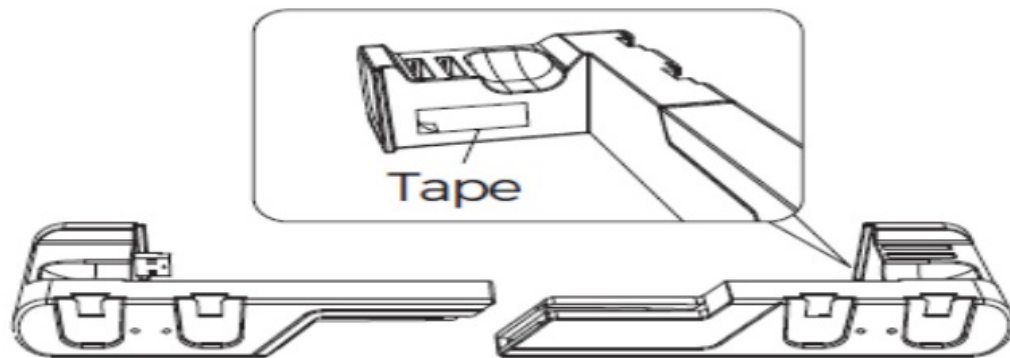

3. You can insert two commonly used game cards into the two slots on the right side

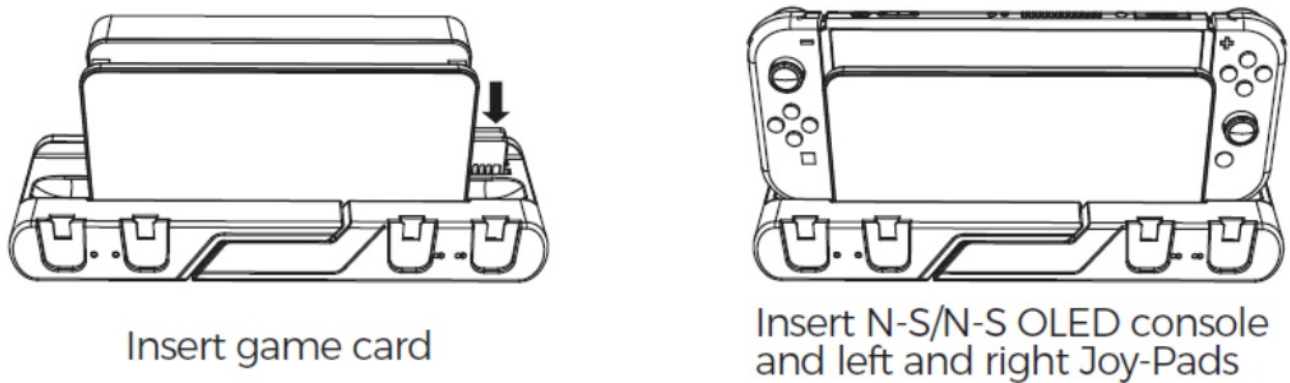

4. Insert Joy-Pads (Not Included) into the front 4 charging slots. When the controller charges, the charging indicator light will turn red. When it is fully charged or pulled out, the indicator light turns green. It can charge four N-S/ N-S OLED Joy-Pads simultaneously.

