



anko 32018 Build Your Own Science Lab With Fan Instruction Manual

[Home](#) » [Anko](#) » anko 32018 Build Your Own Science Lab With Fan Instruction Manual 

anko 32018 Build Your Own Science Lab With Fan Instruction Manual

WARNING: BATTERIES ARE TO BE INSERTED WITH THE CORRECT POLARITY (+ AND -). DO NOT MIX DIFFERENT TYPES OF BATTERIES OR NEW AND USED BATTERIES. NON-RECHARGEABLE BATTERIES ARE NOT TO BE RECHARGED. RECHARGEABLE BATTERIES ARE ONLY TO BE CHARGED BY AN ADULT. RECHARGEABLE BATTERIES ARE TO BE REMOVED FROM THE TOY BEFORE BEING CHARGED. THE SUPPLY TERMINALS ARE NOT TO BE SHORT-CIRCUITED. REMOVE BATTERIES FROM THE TOY WHEN NOT IN USE FOR EXTENDED TIME OR WHEN BATTERIES BECOME EXHAUSTED. BATTERY INSTALLATION BY AN ADULT IS REQUIRED. DISPOSE OF BATTERIES RESPONSIBLY. DO NOT DISPOSE OF IN FIRE.



WARNING: CHOKING HAZARD ! SMALL PARTS, NOT FOR CHILDREN UNDER 3 YEARS.
WARNING: HAIR ENTANGLEMENT MAY RESULT IF THE CHILD'S HEAD IS TOO CLOSE TO THE MOTORISED UNIT OF THIS TOY, ADULT SUPERVISION AND ASSISTANCE IS REQUIRED.
WARNING: FOR SAFETY REASONS, REMOVE ALL TAGS, LABELS AND PLASTIC FASTENERS BEFORE GIVING THIS TOY TO YOUR CHILD.
WARNING: CONTAINS FUNCTIONAL SHARP POINT ON THE LEADS..

To insert batteries please unscrew battery cover with a screw driver. Insert the required batteries in accordance with battery polarity with and ends in the right position and then fix screw on the battery door to close 7 the battery compartment case.

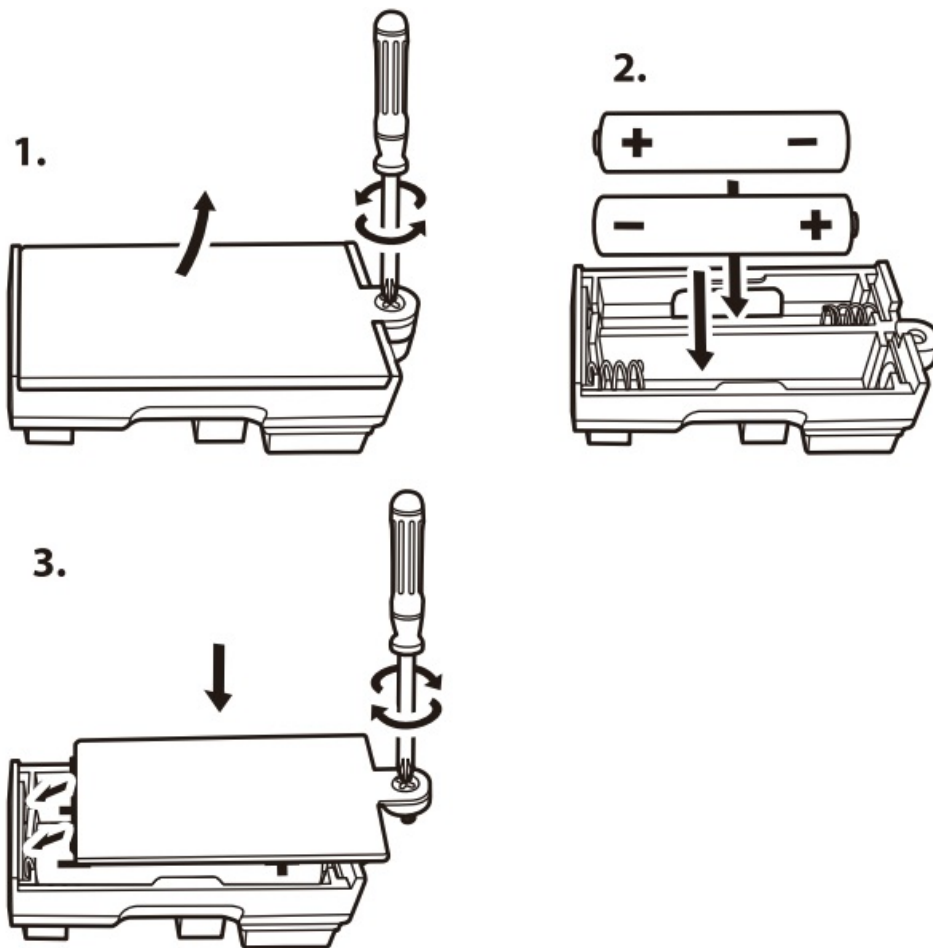

REQUIRES 2 X 1.5V AA BATTERIES NOT INCLUDED)



EXPERIMENTS

1. Rotor (Flying Fan)
2. Simple LED circuit
3. Rotor (Flying Fan) and LED
4. Red and green LED
5. Basic circuit operation of LED
6. Diode and capacitor discharge
7. LED "AND Gate" circuit
8. LED "NOT Gate" circuit (with flying fan for extra excitement)
9. LED "OR Gate" circuit
10. LED "NAND Gate" circuit (with flying fan for extra excitement)
11. LED "NOR Gate" circuit (with flying fan for extra excitement)
12. Time controller
13. Morse code training kit

14. Delay type fan
15. Slow down type fan
16. Microphone triggered fan
17. Alternating LED and fan
18. Adjustable LED
19. Speed adjustable fan

Contents

[1 COMPONENTS IN THIS KIT](#)

[2 Documents / Resources](#)

[2.1 References](#)

COMPONENTS IN THIS KIT

Description

Documents / Resources

	anko 32018 Build Your Own Science Lab With Fan [pdf] Instruction Manual 32018 Build Your Own Science Lab With Fan, 32018, Build Your Own Science Lab With Fan, Yo ur Own Science Lab With Fan, Science Lab With Fan
---	---

References

- [User Manual](#)

[Manuals+. Privacy Policy](#)

This website is an independent publication and is neither affiliated with nor endorsed by any of the trademark owners. The "Bluetooth®" word mark and logos are registered trademarks owned by Bluetooth SIG, Inc. The "Wi-Fi®" word mark and logos are registered trademarks owned by the Wi-Fi Alliance. Any use of these marks on this website does not imply any affiliation with or endorsement.