



ANEX IQ Basic Stroller Owner's Manual

[Home](#) » [anex](#) » ANEX IQ Basic Stroller Owner's Manual 

Contents

- 1 ANEX IQ Basic Stroller
- 2 IQ ALL-IN-ONE
- 3 IQ FRAME
- 4 Frame width adjustment
- 5 Unpacking of the carrycot
- 6 Carrycot's hood adjustment
- 7 Carrycot's cover attachment
- 8 Carrycot's cleaning
- 9 Folding of the frame with seat
- 10 Seat unit's cleaning
- 11 Softgoods assembling
- 12 Buggy's hood adjustment
- 13 Raincover for carrycot/ seat unit
- 14 Documents / Resources
 - 14.1 References
- 15 Related Posts

anex iq

ANEX IQ Basic Stroller



IQ ALL-IN-ONE

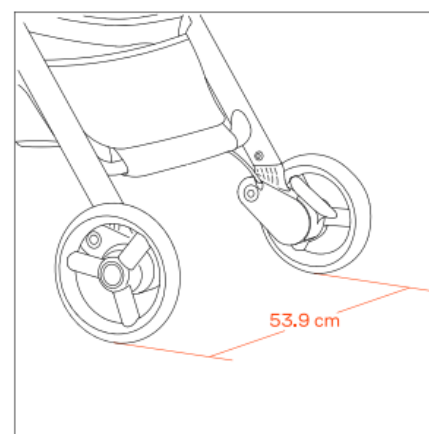
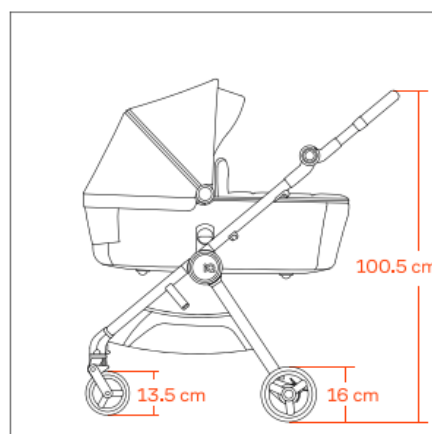
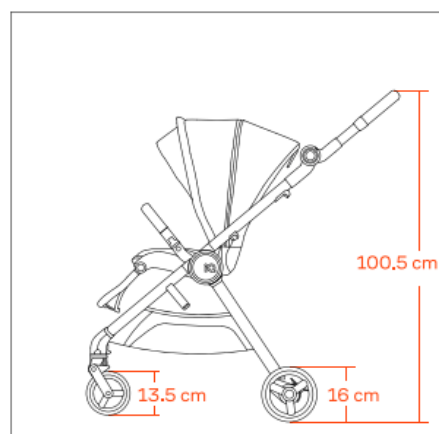
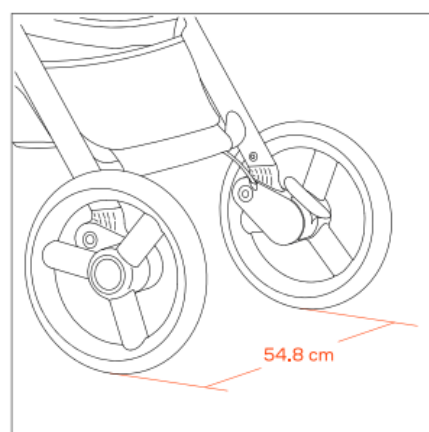
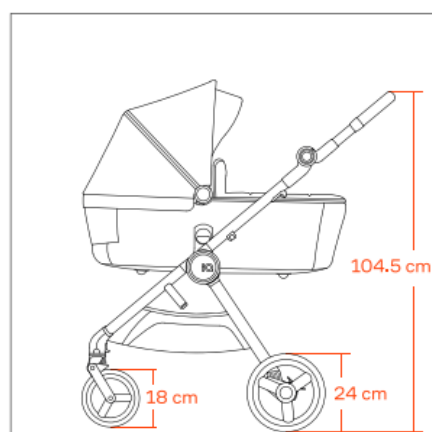
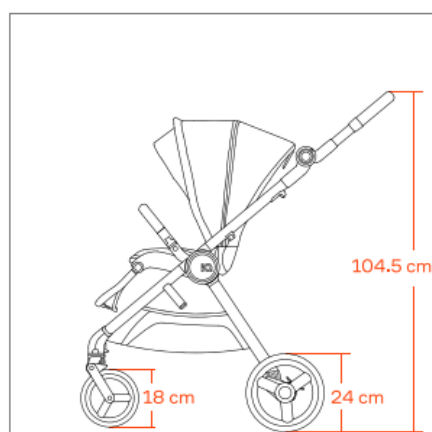

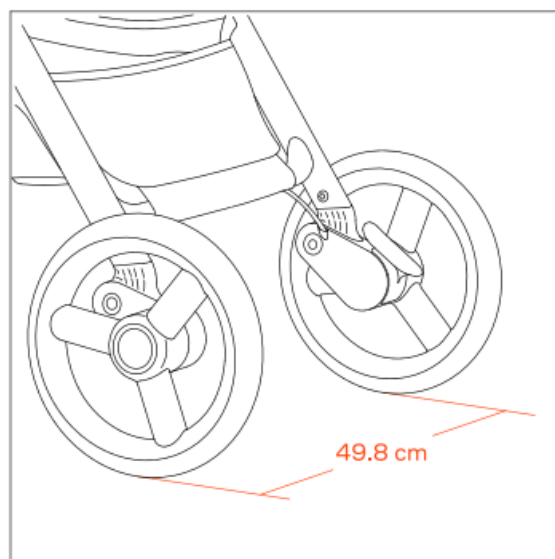
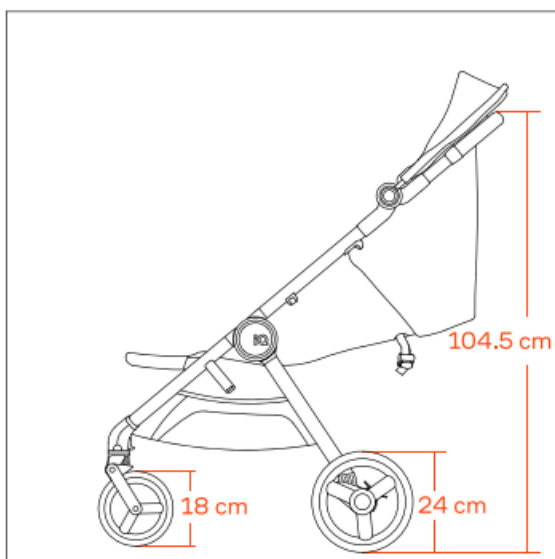
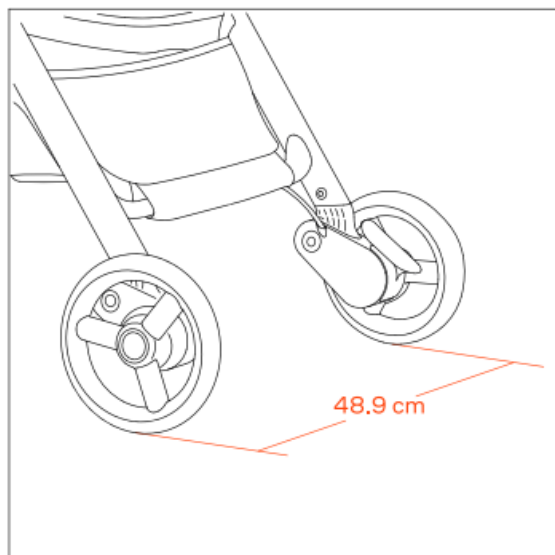
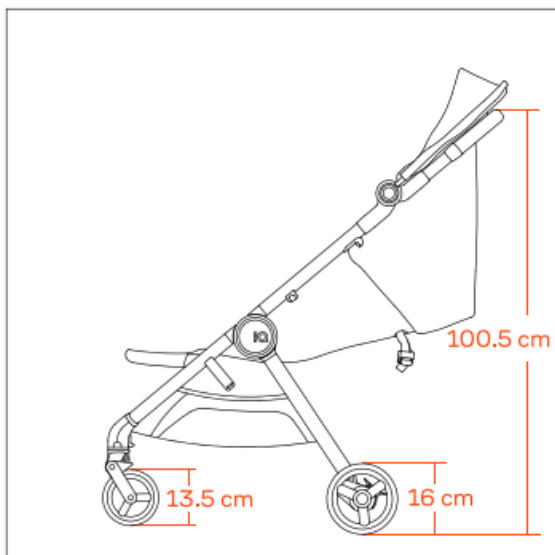

Folding of the frame

IQ FRAME

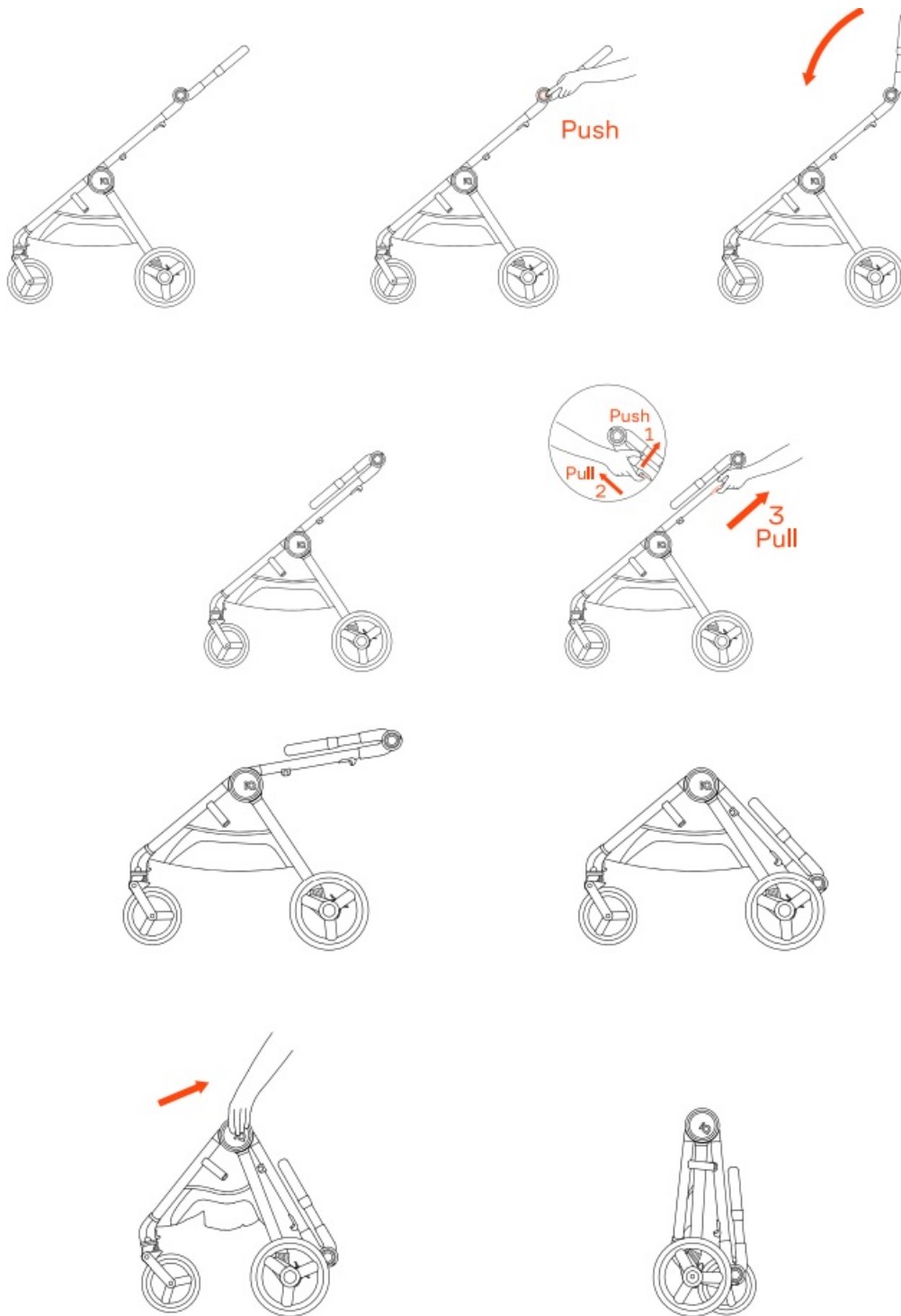

Unfolding of the frame

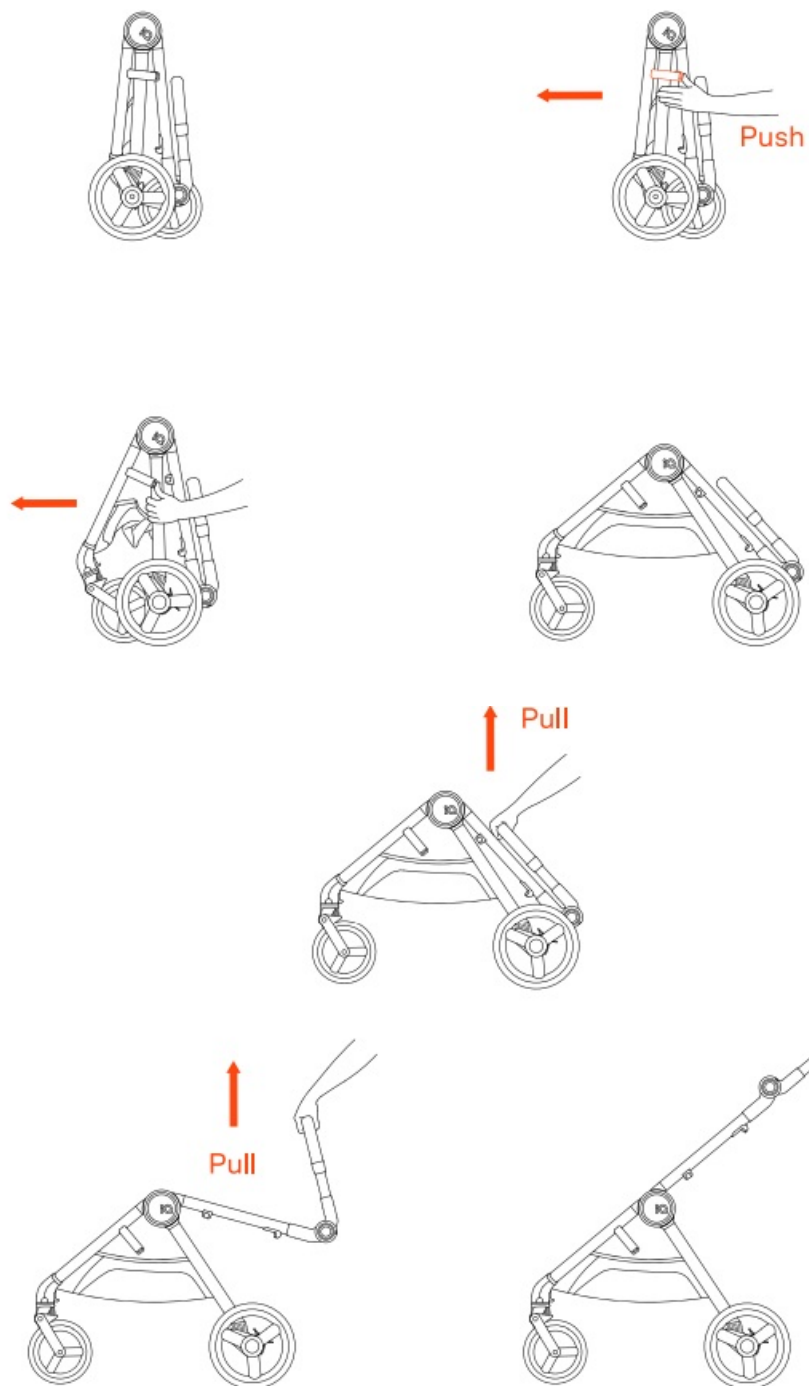

Attaching of the front wheels

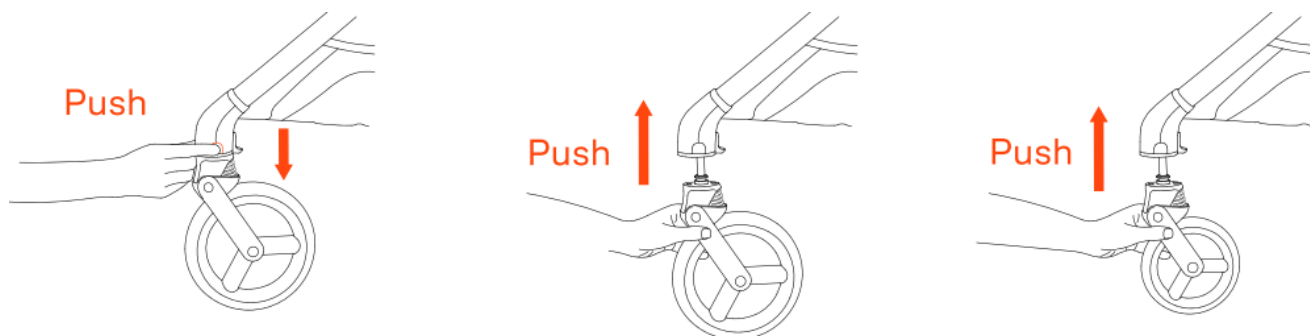

Locking front swivel wheels

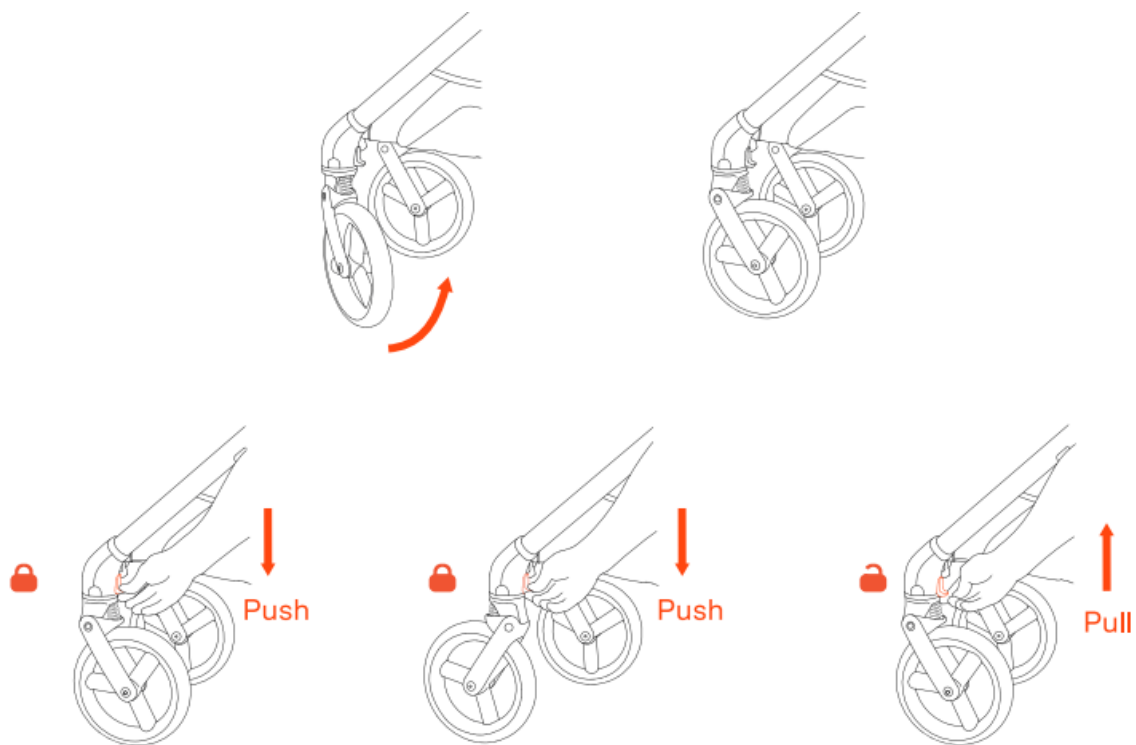

Attaching of the rear wheels

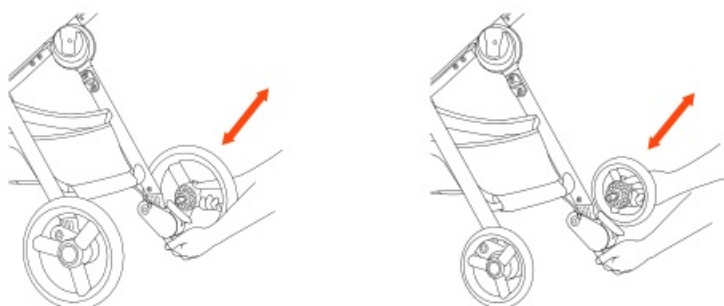
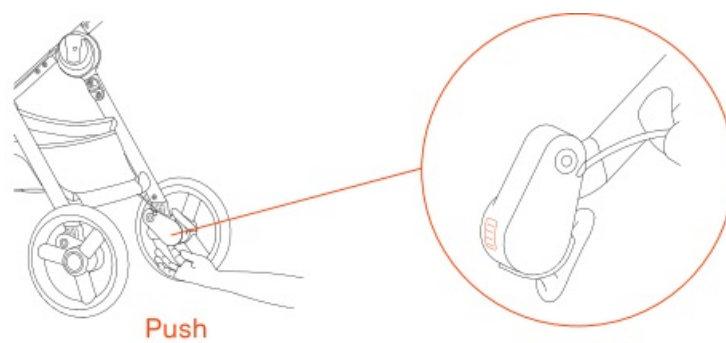

Brakes

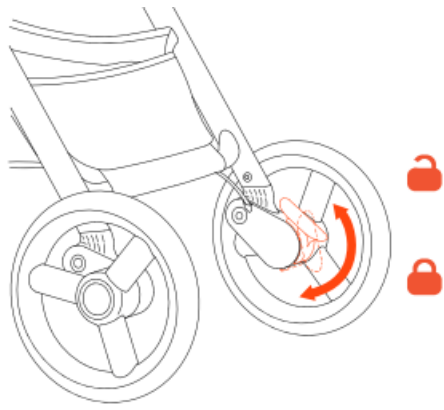

Shock absorption

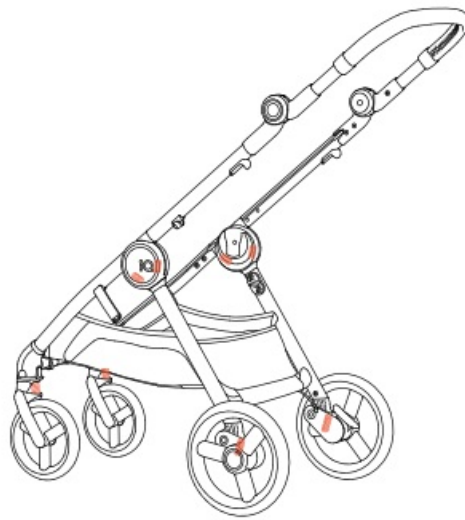

Handle regulation

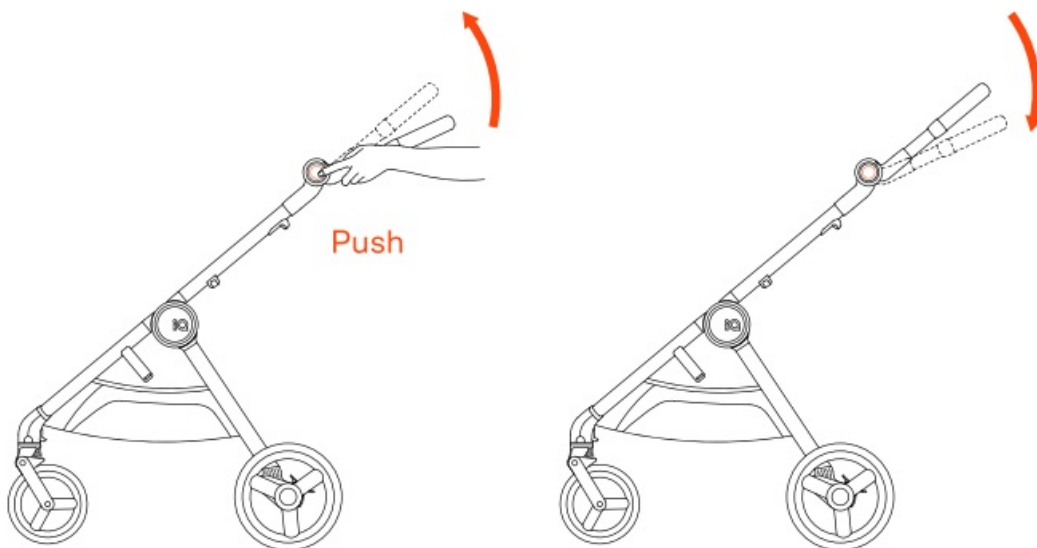

Disconnecting/connecting of the shopping basket

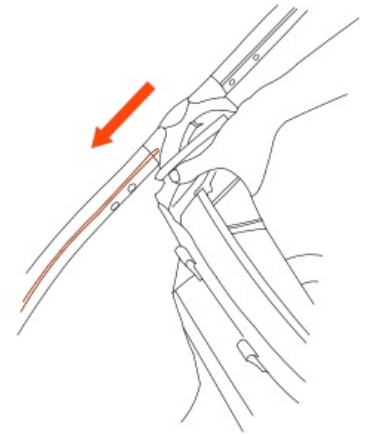
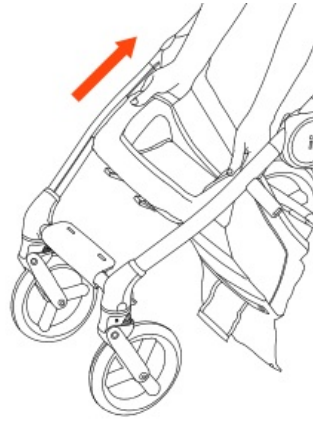
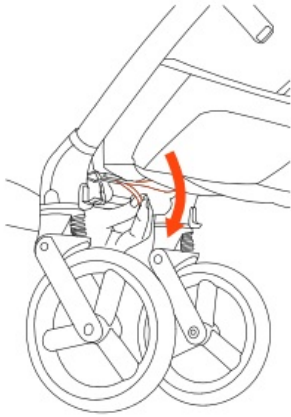
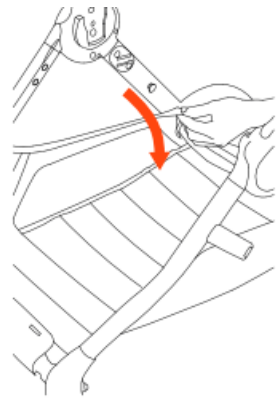
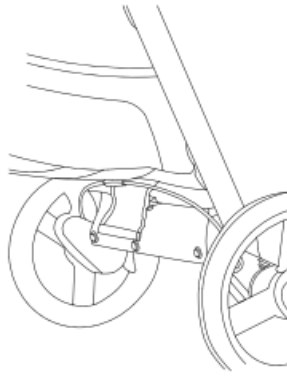
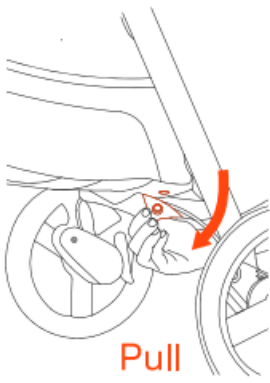

Carry handle

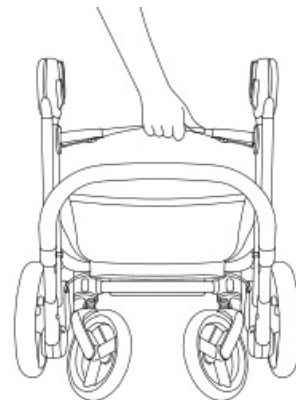
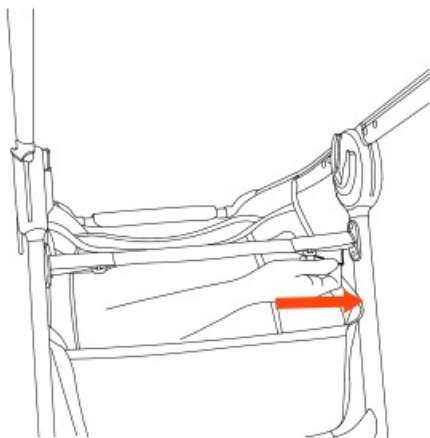
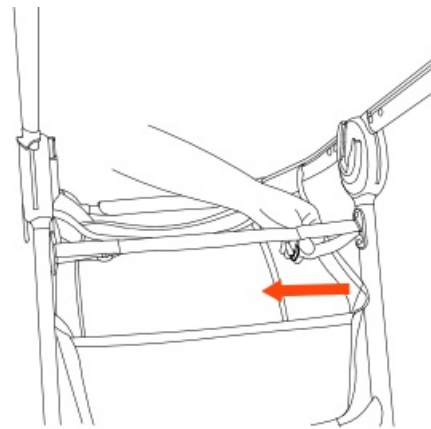
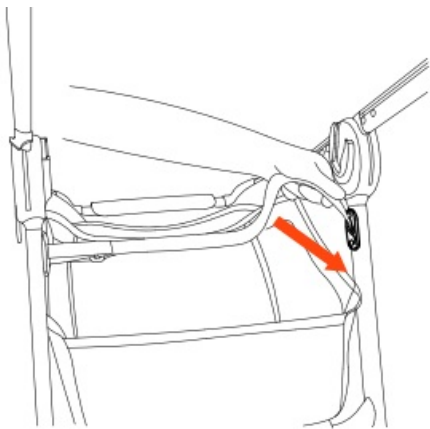

Frame width adjustment

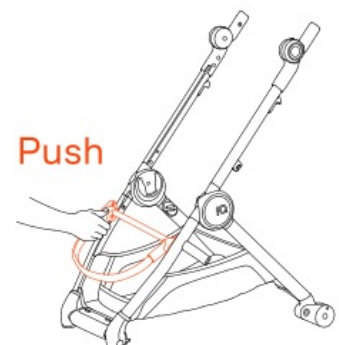
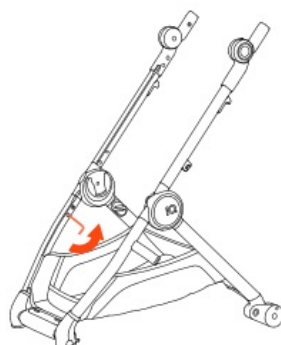
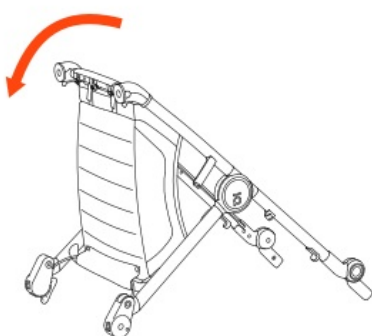
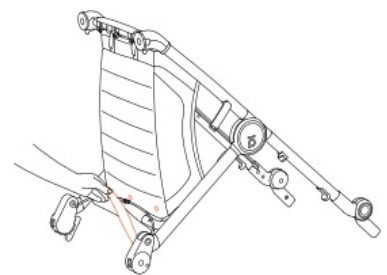
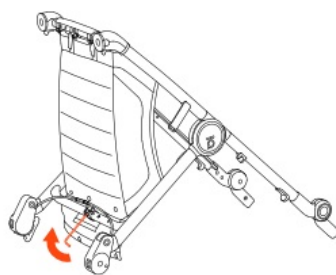
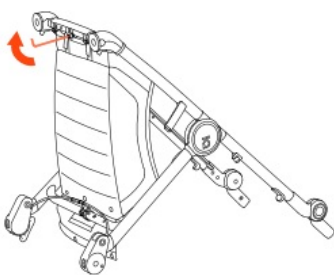
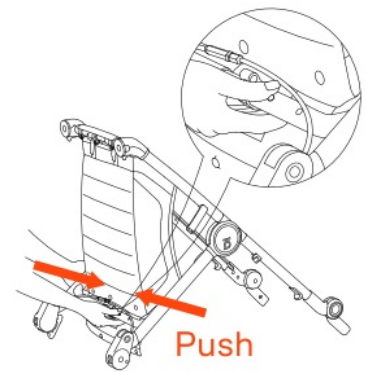
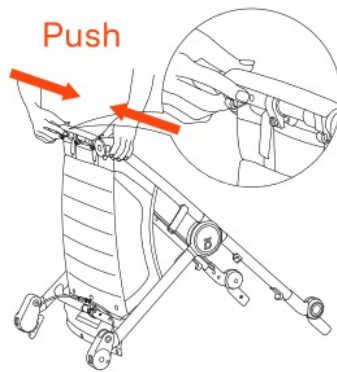
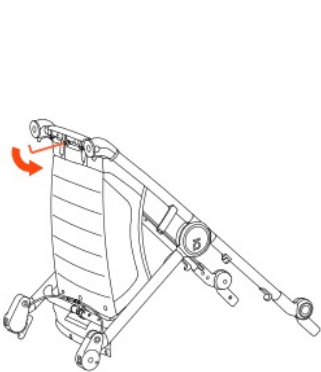
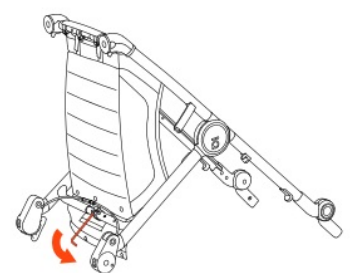
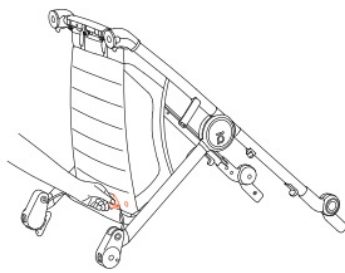
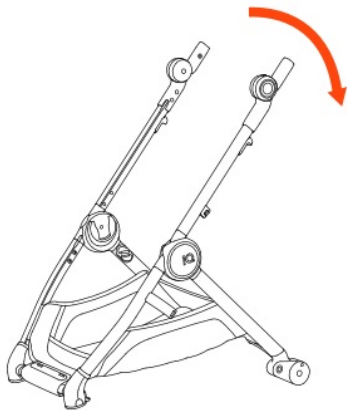
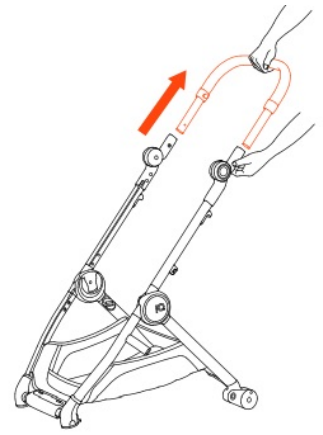
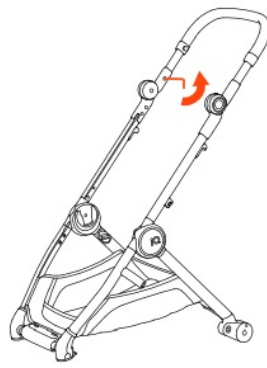
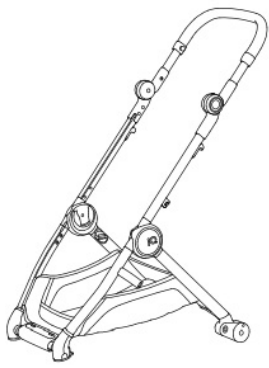

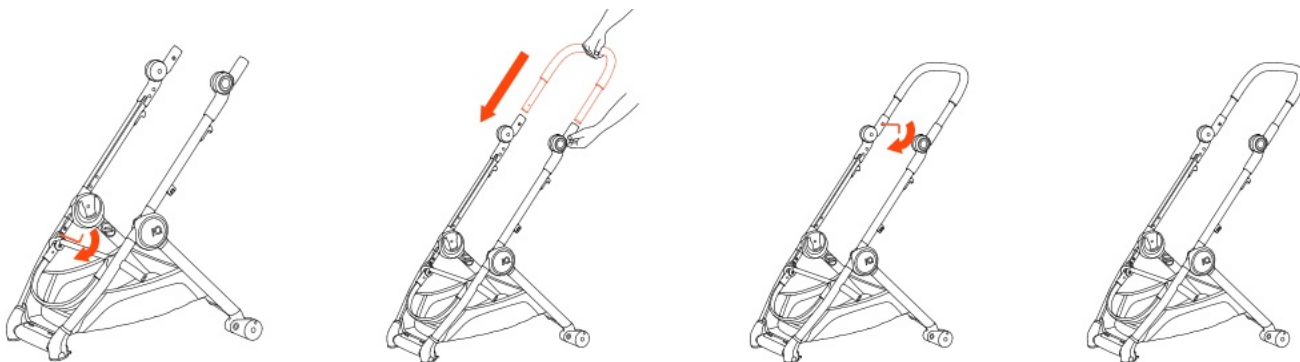

Unpacking of the carrycot

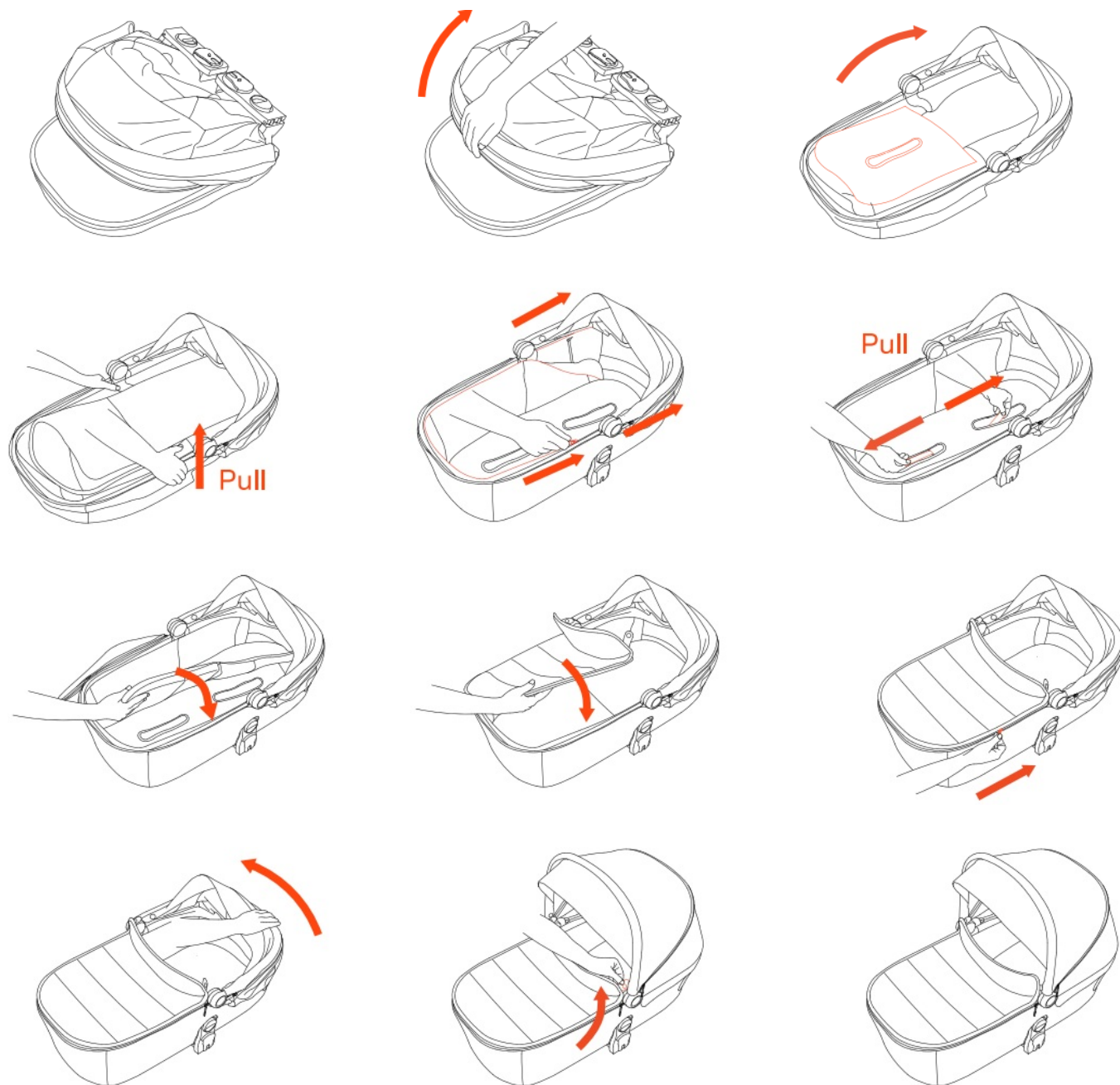

Folding of the carrycot

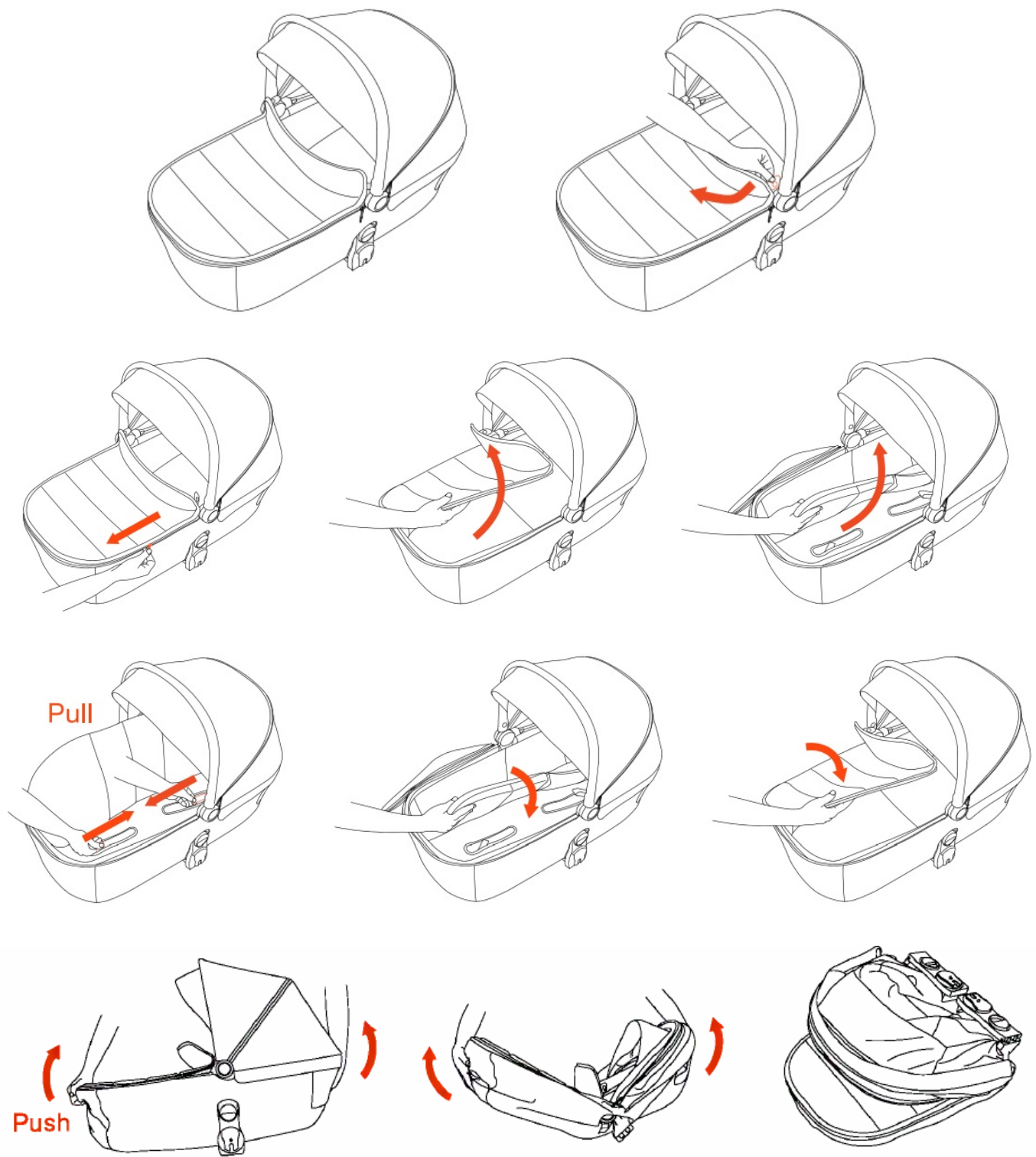

Unfolding of the carrycot

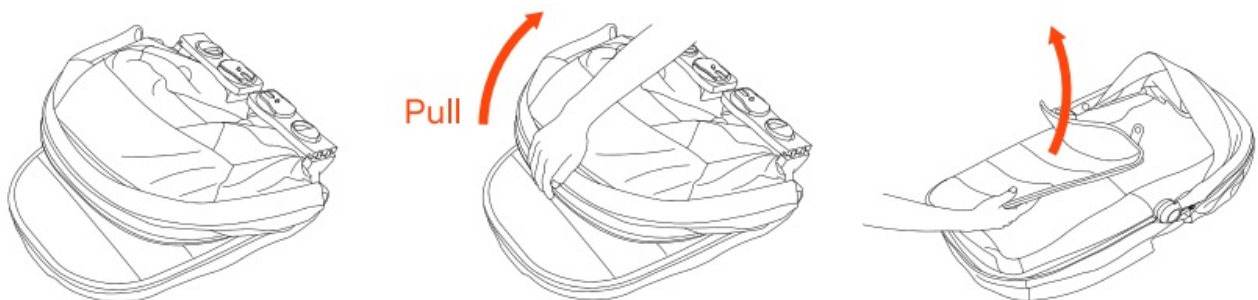

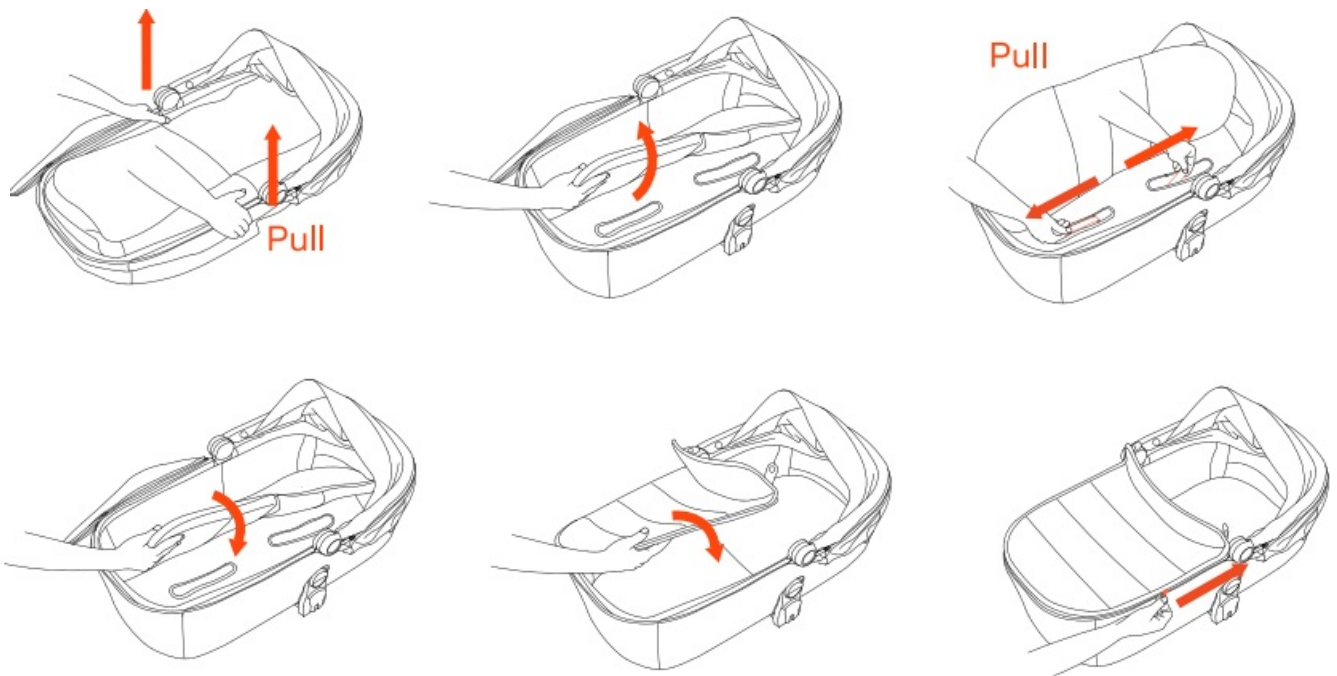

Attachment to the frame

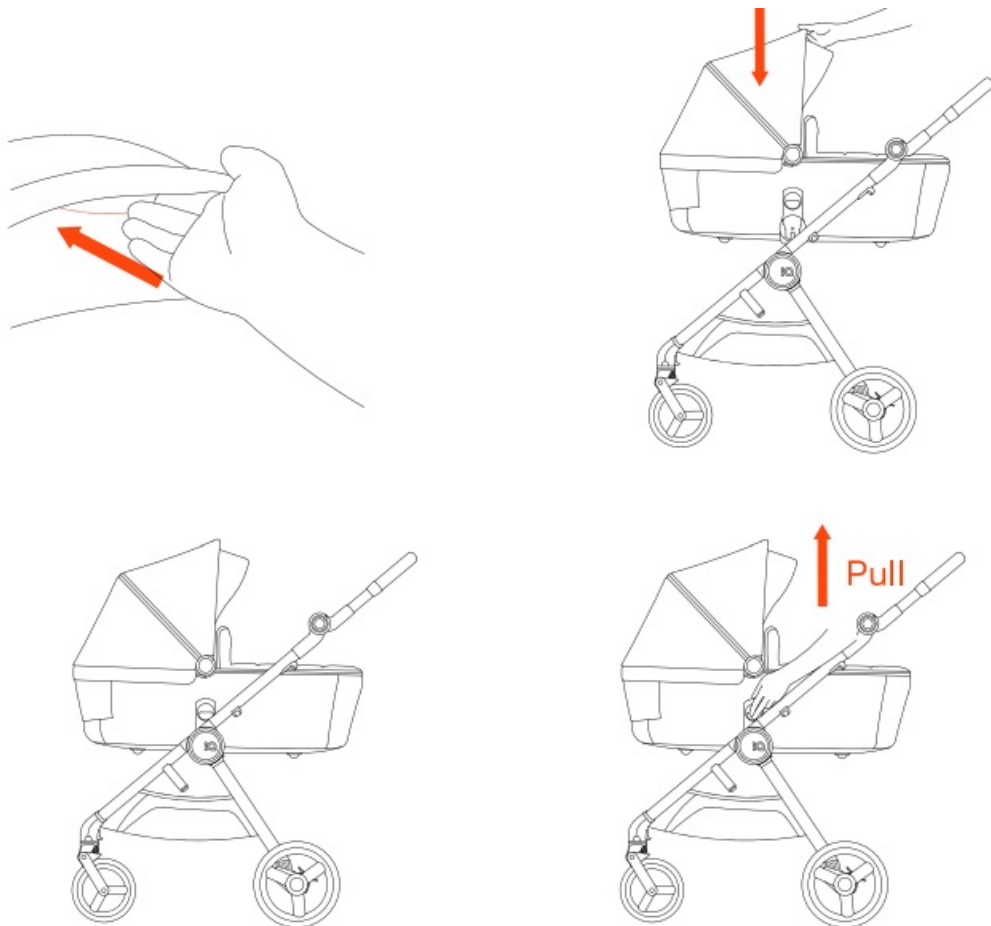

Ventilation

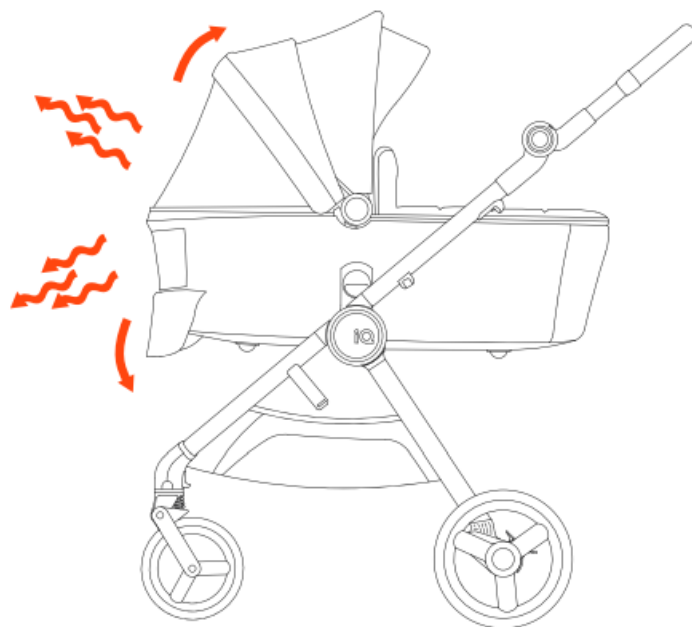

Carrycot's hood adjustment

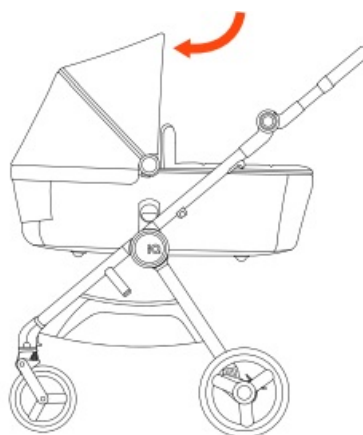
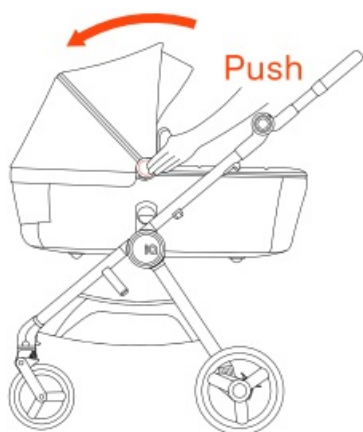

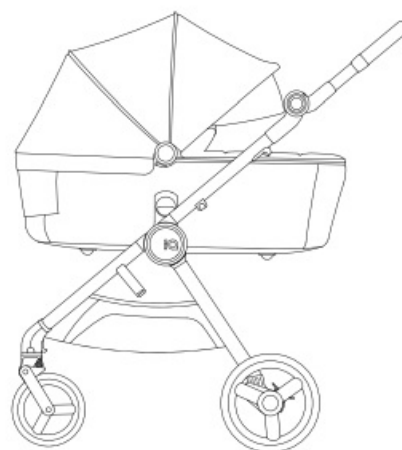
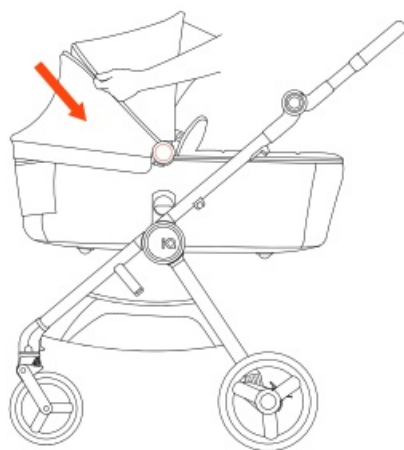

Carrycot's cover attachment

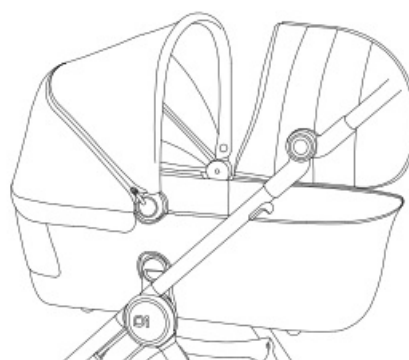
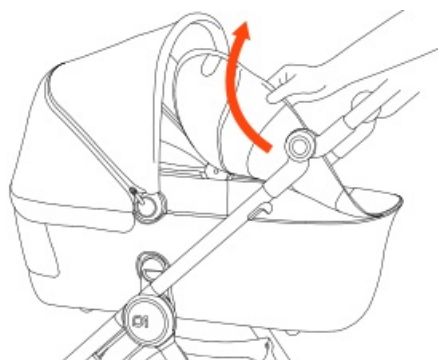
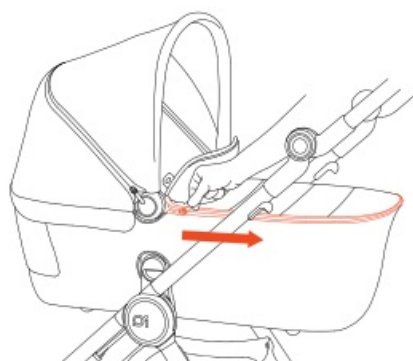
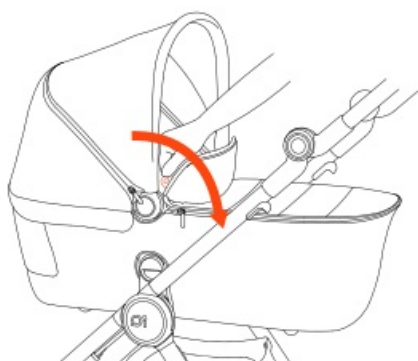

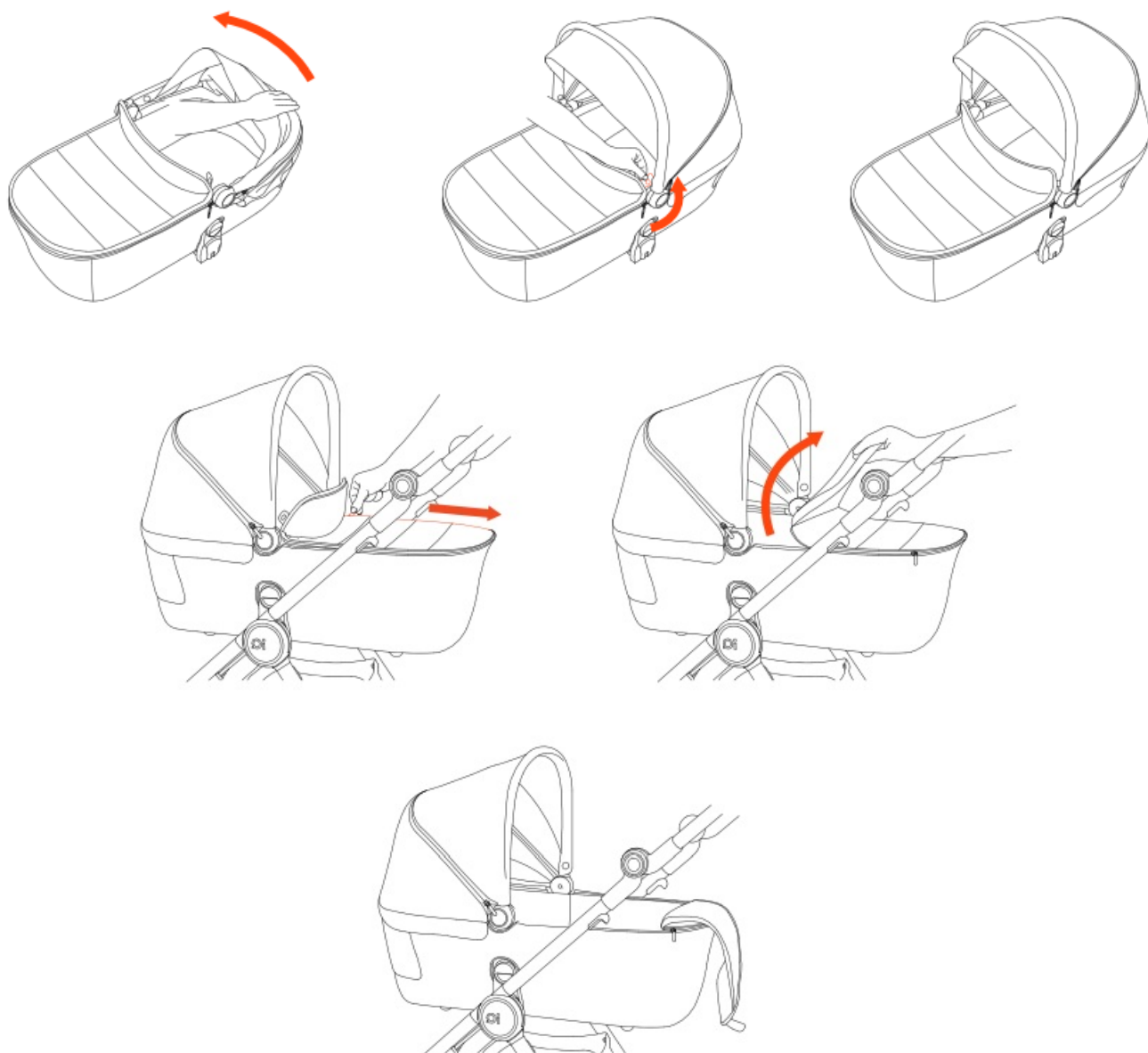

Carrycot's cleaning



⊕

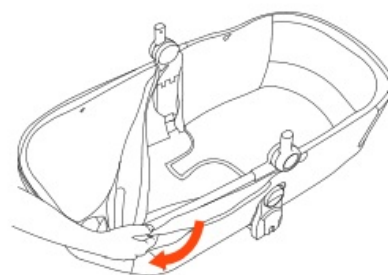
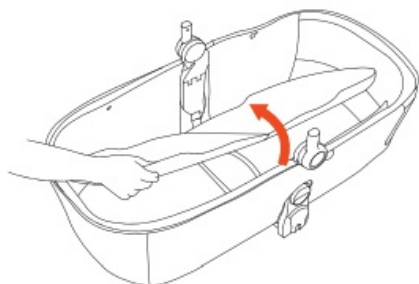
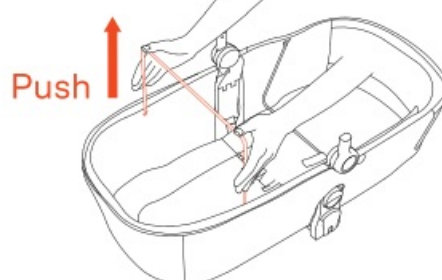
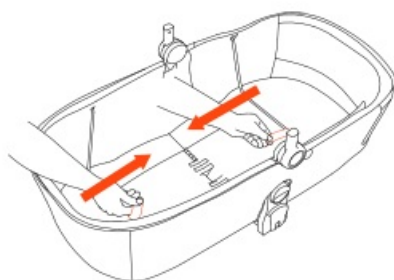
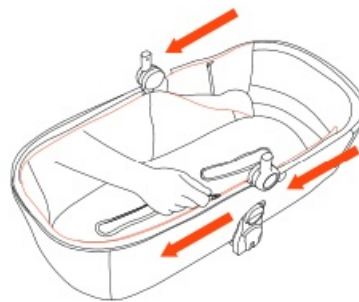
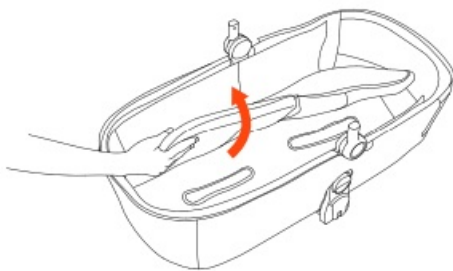
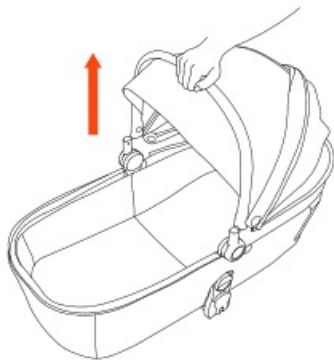

Attachment to the frame IQ SEAT UNIT

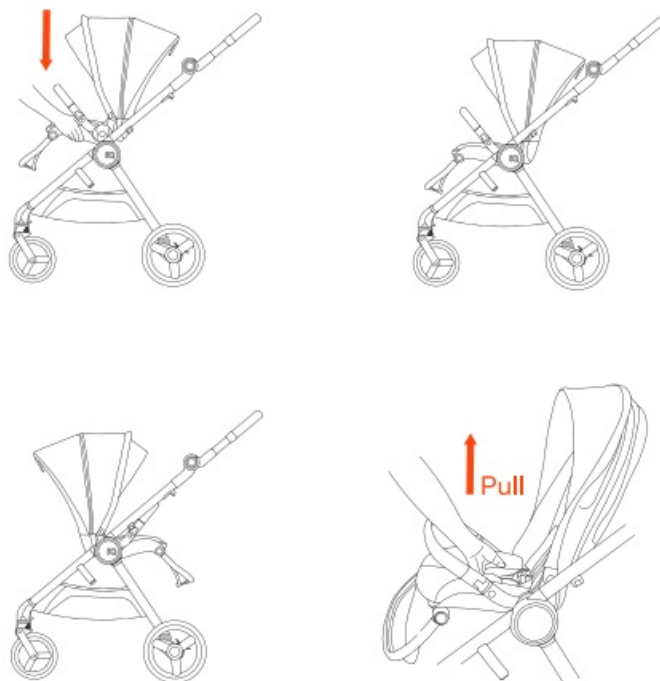

Folding of the frame with seat

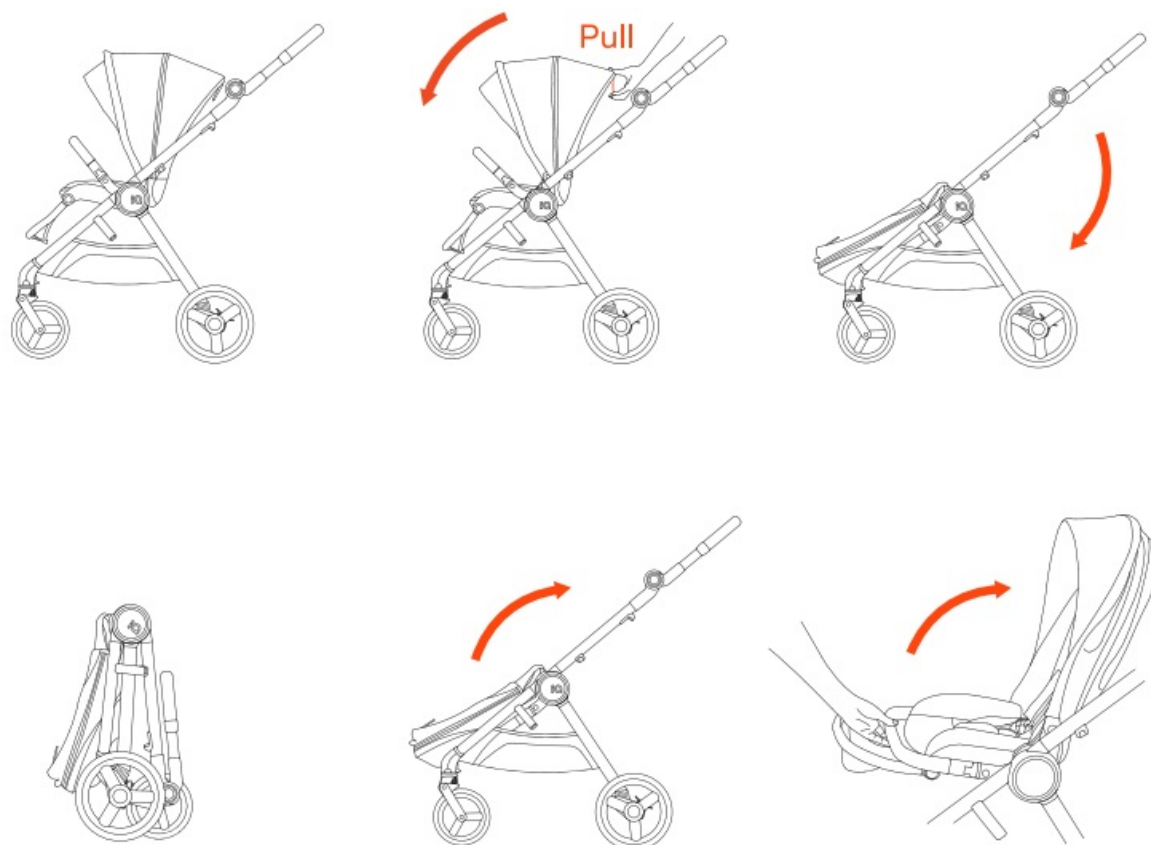

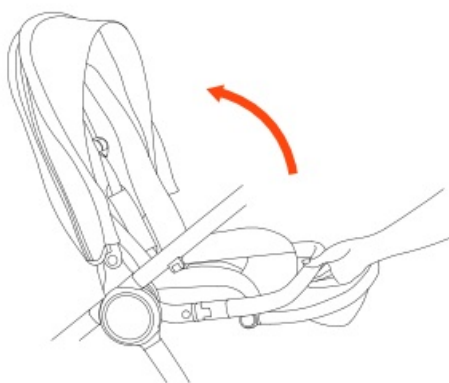
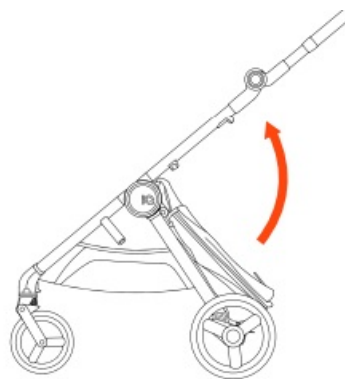
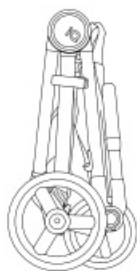
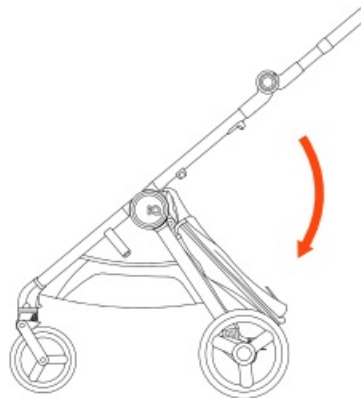
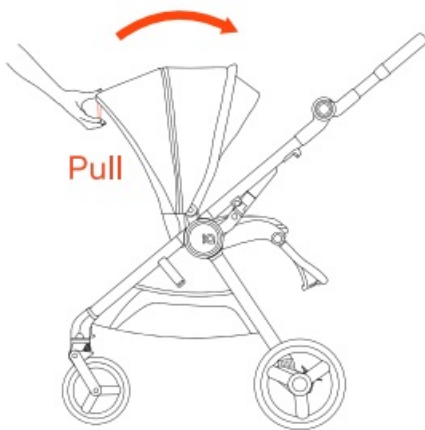

Seat unit's hood adjustment

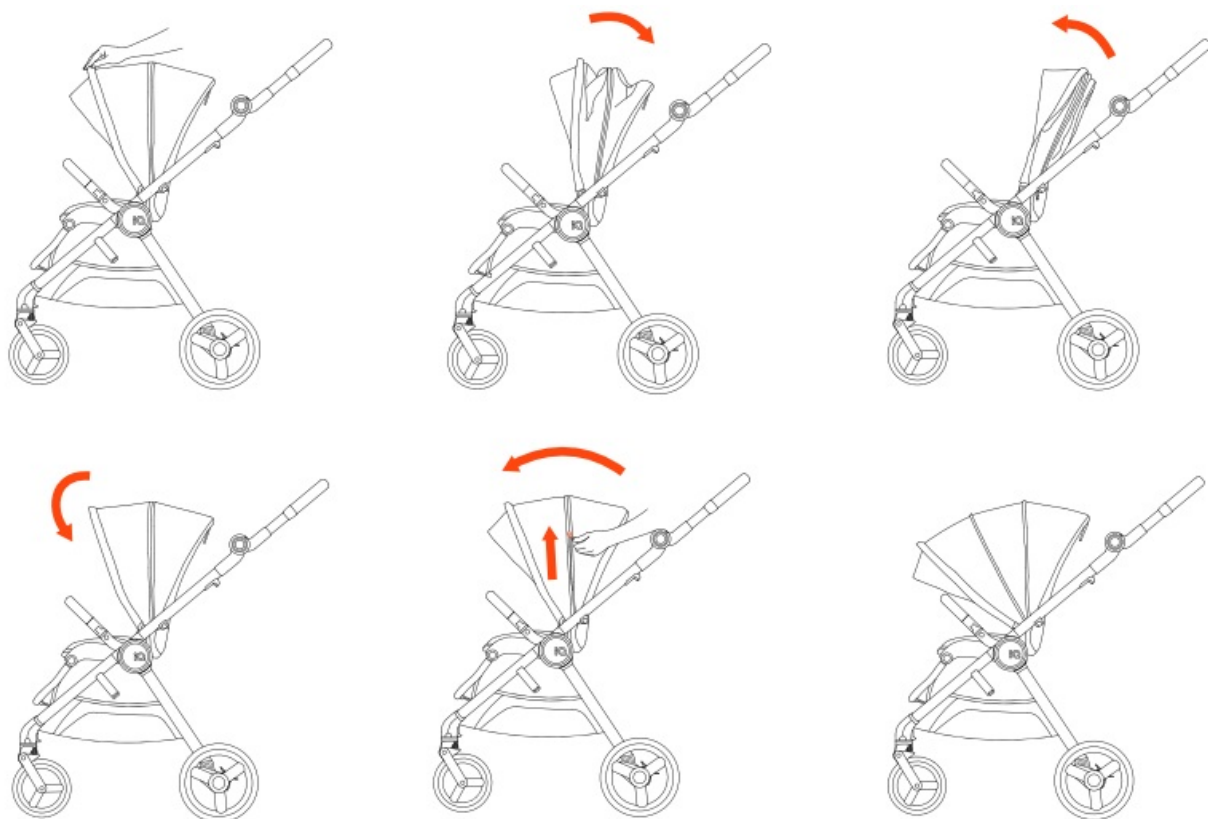

Seat unit's backrest adjustment

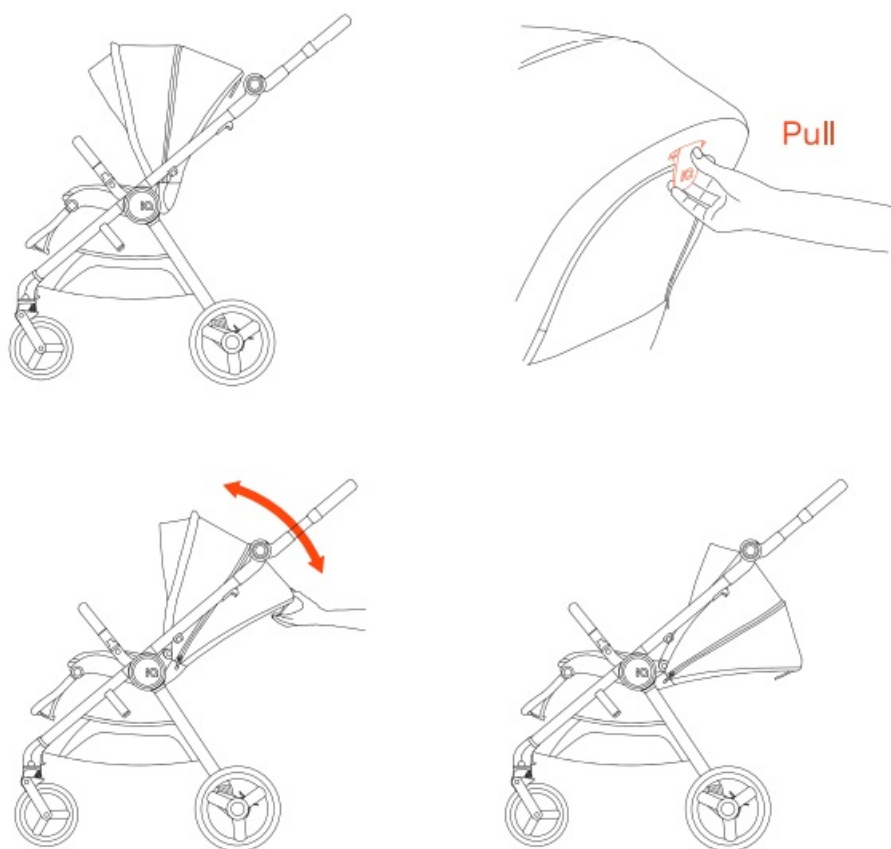

Ventilation of the seat unit's backrest



Footrest adjustment

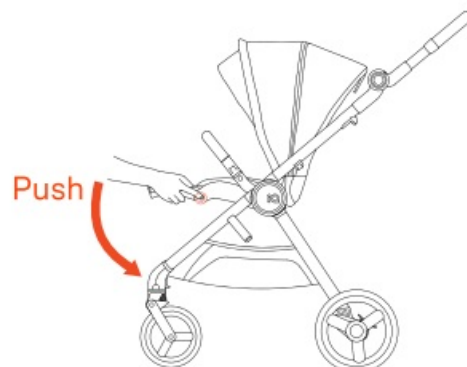
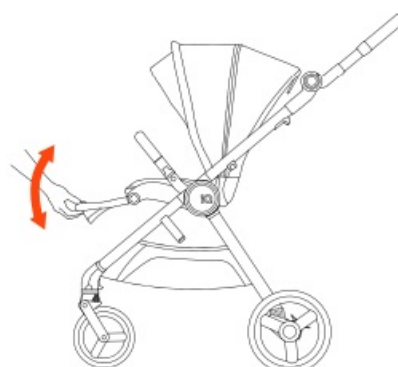

Seat unit's security barrier

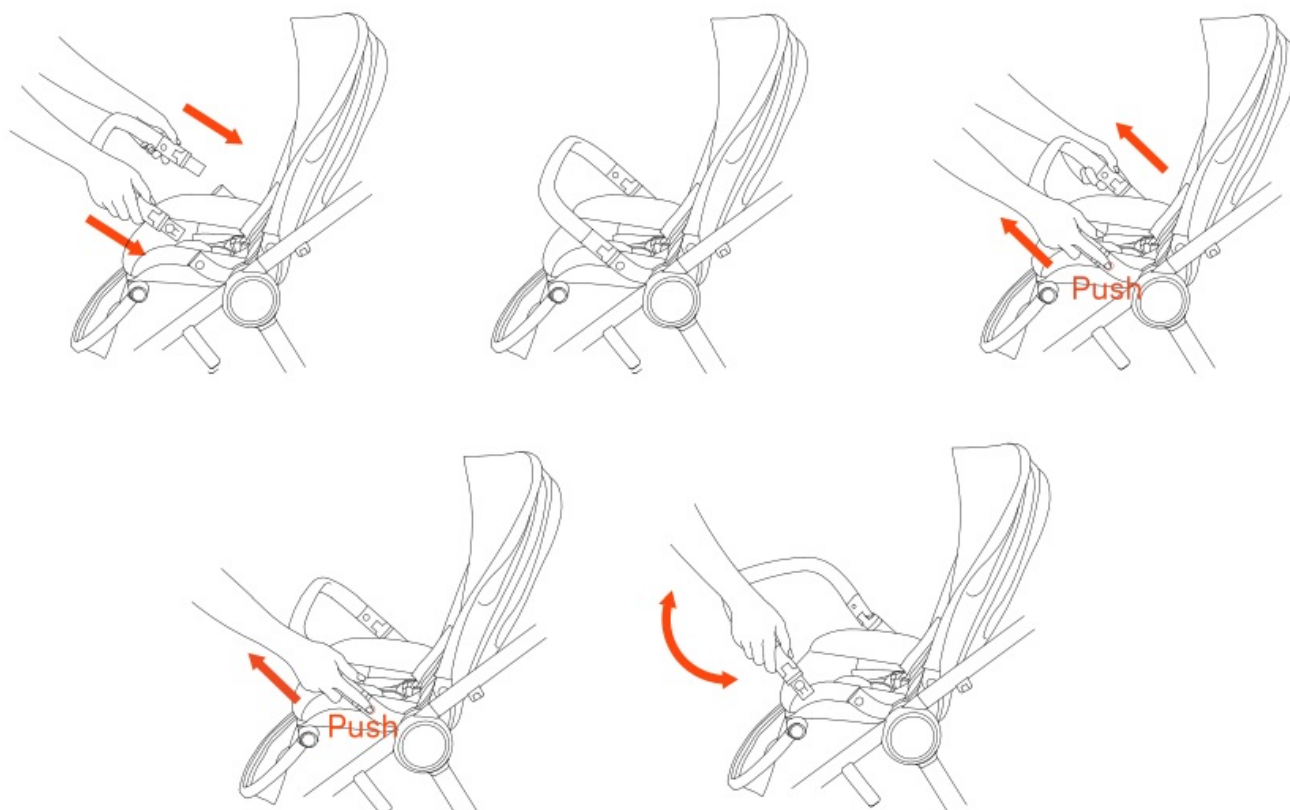

Safety belts buckle

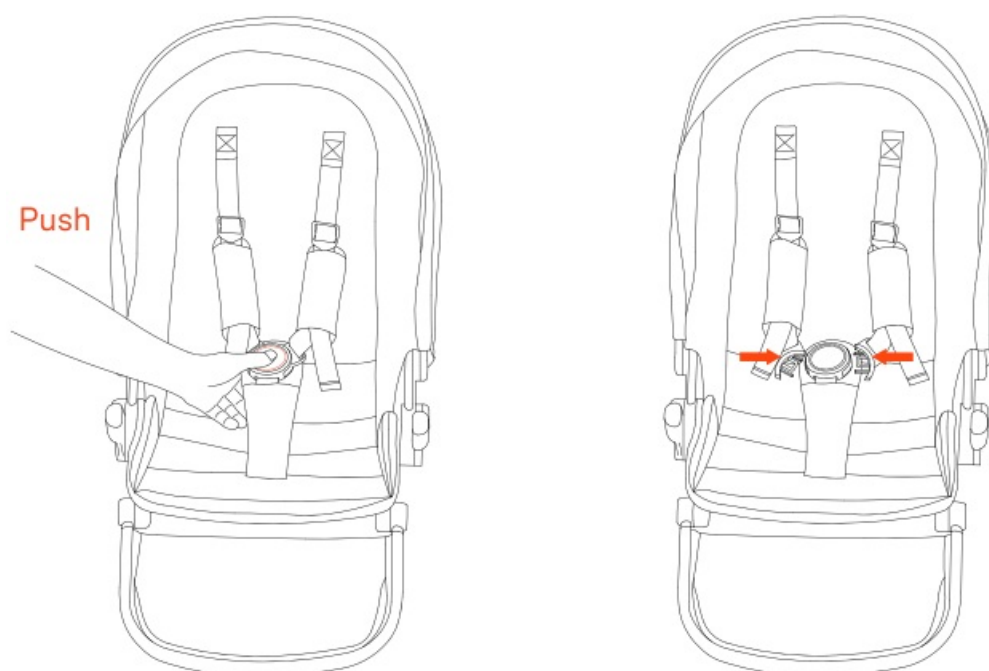

Safety belts adjustment

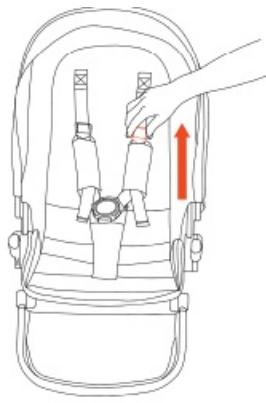

Seat unit's cleaning

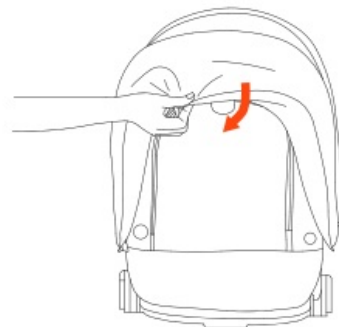
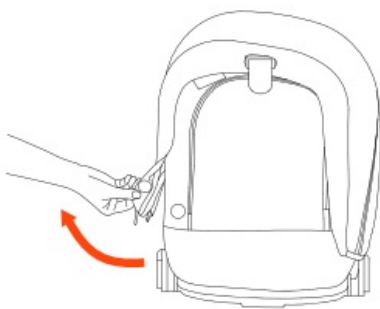
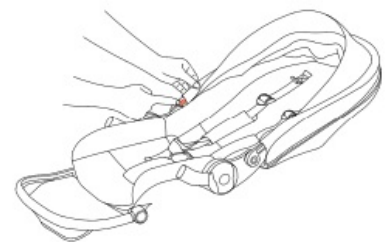
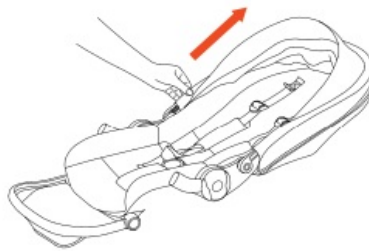
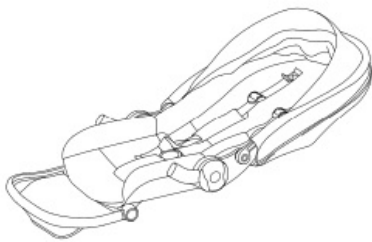

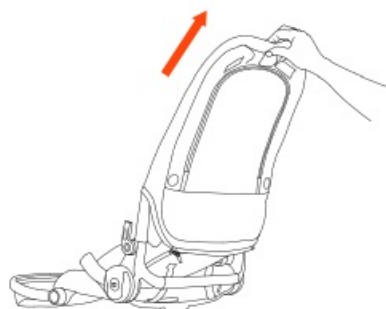
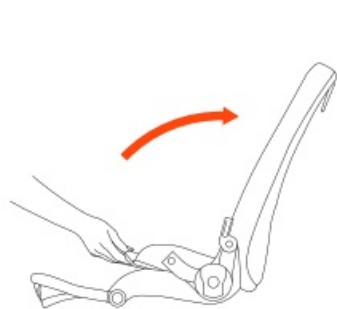
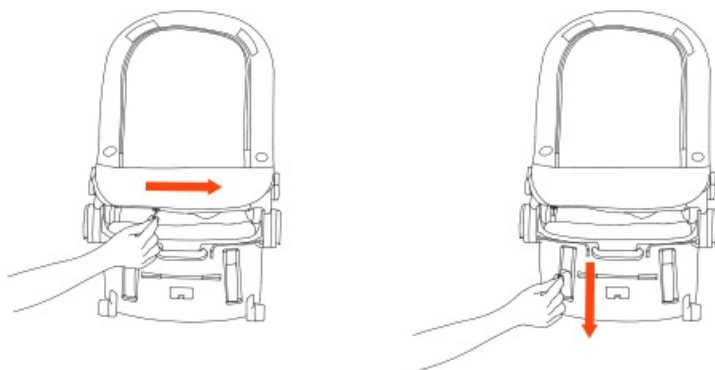

Softgoods assembling

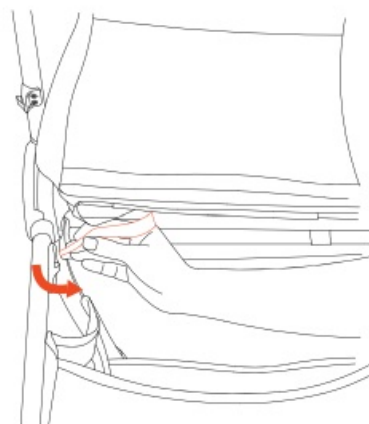
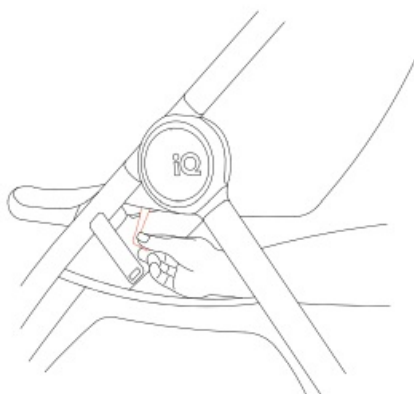
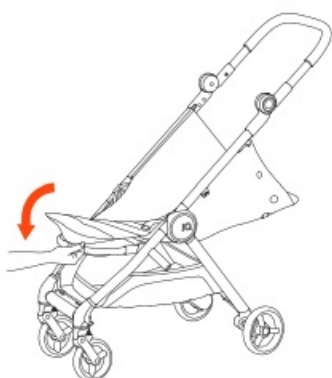
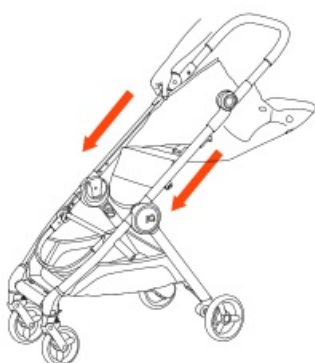
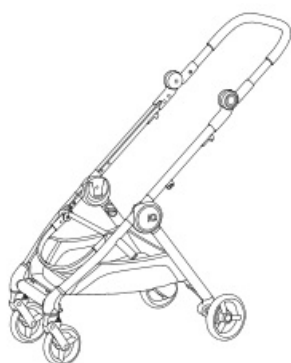

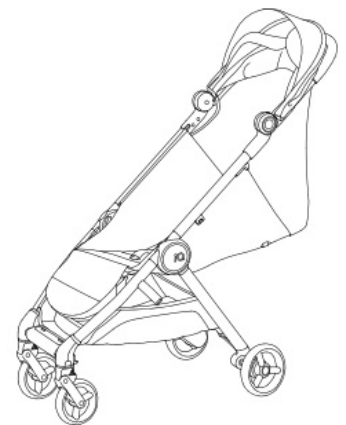
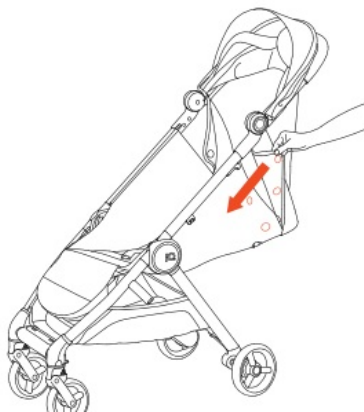
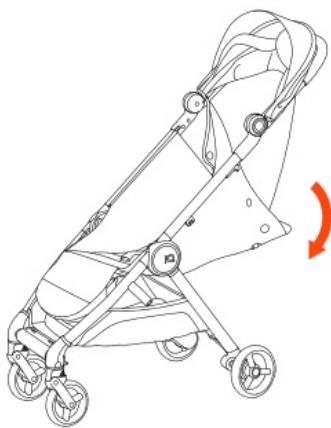
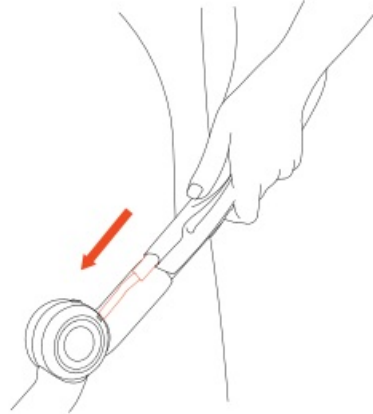
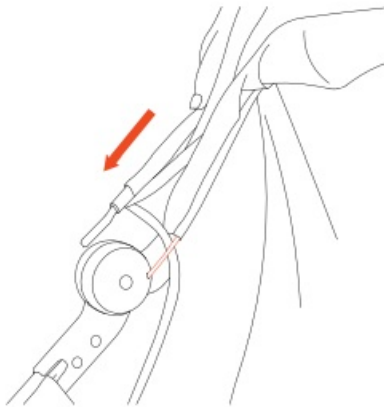
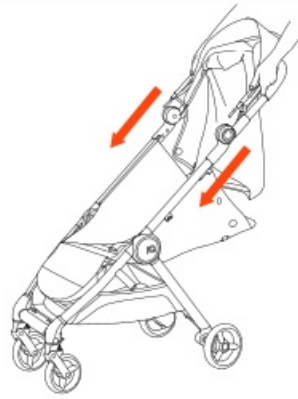
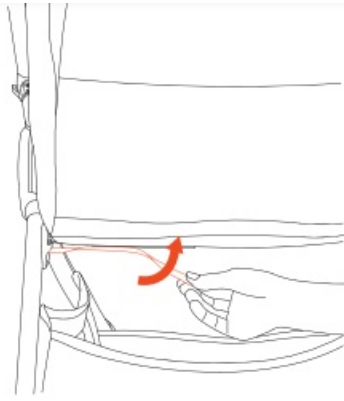

Buggy's hood adjustment

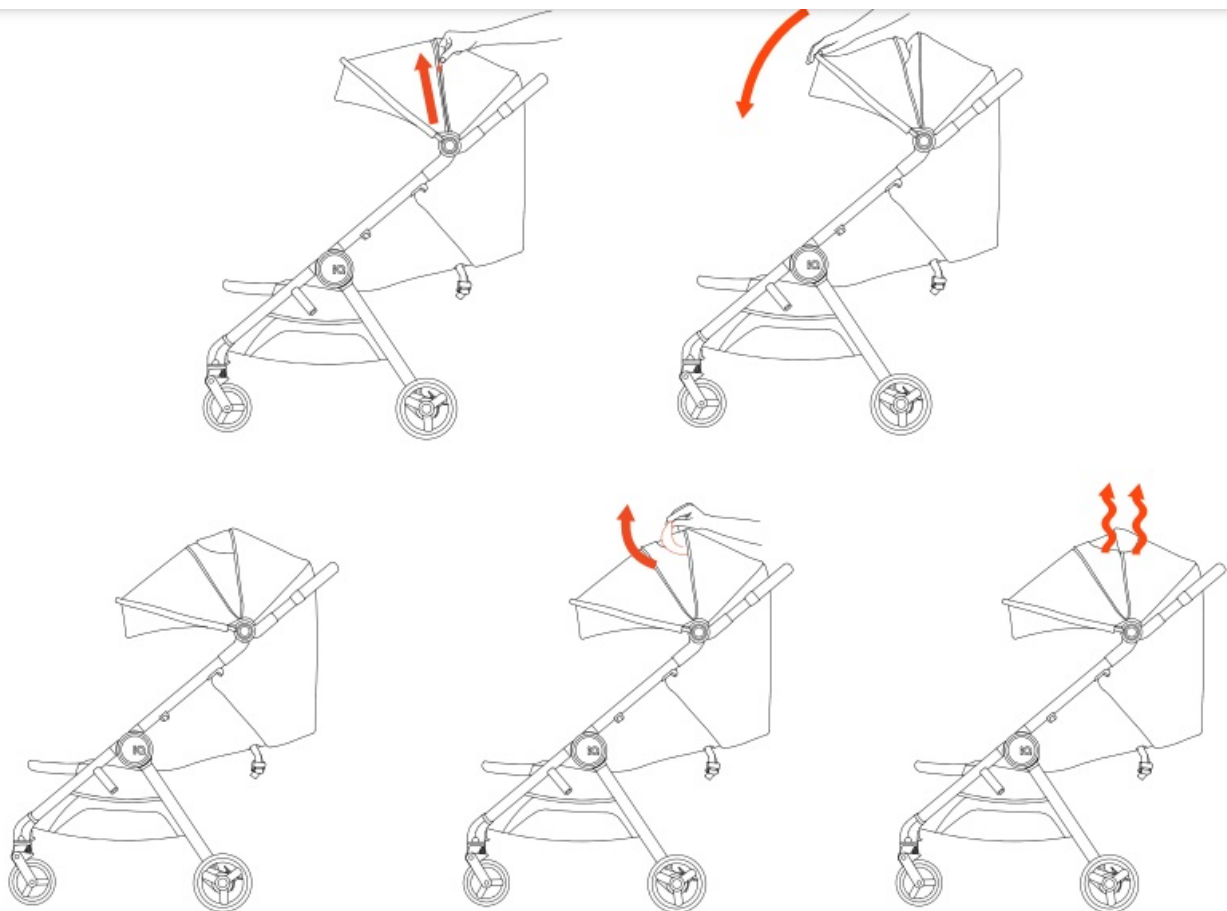
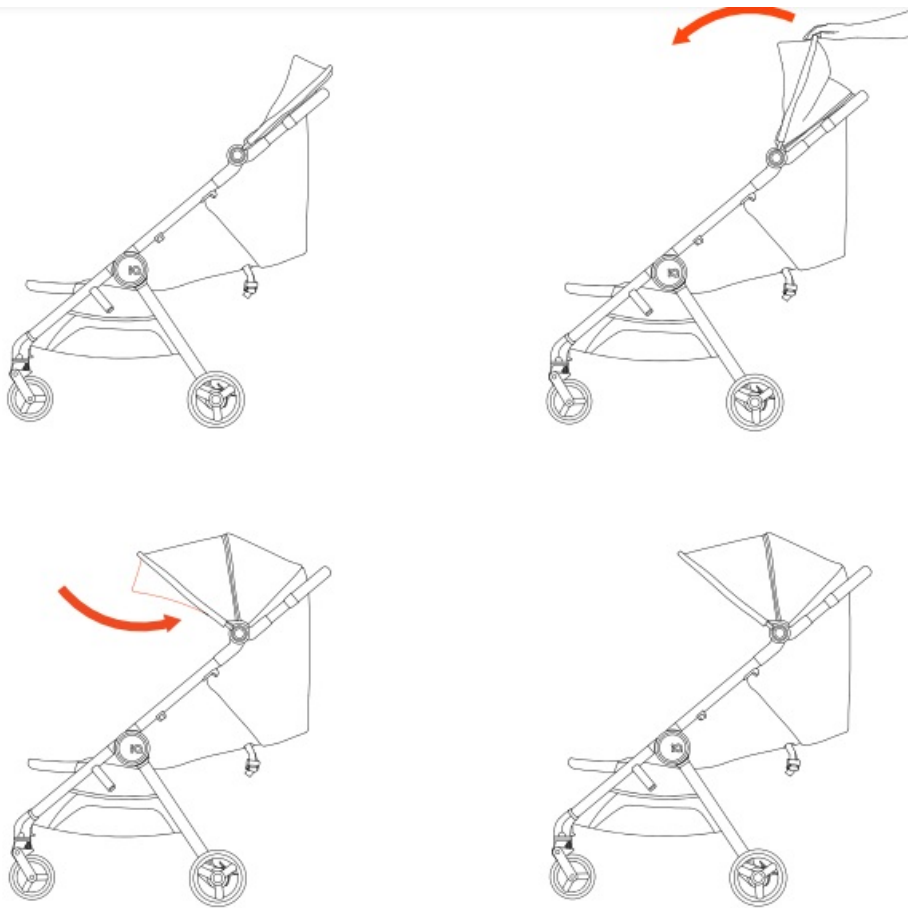

Ventilation of the buggy's backrest



Buggy's backrest adjustment

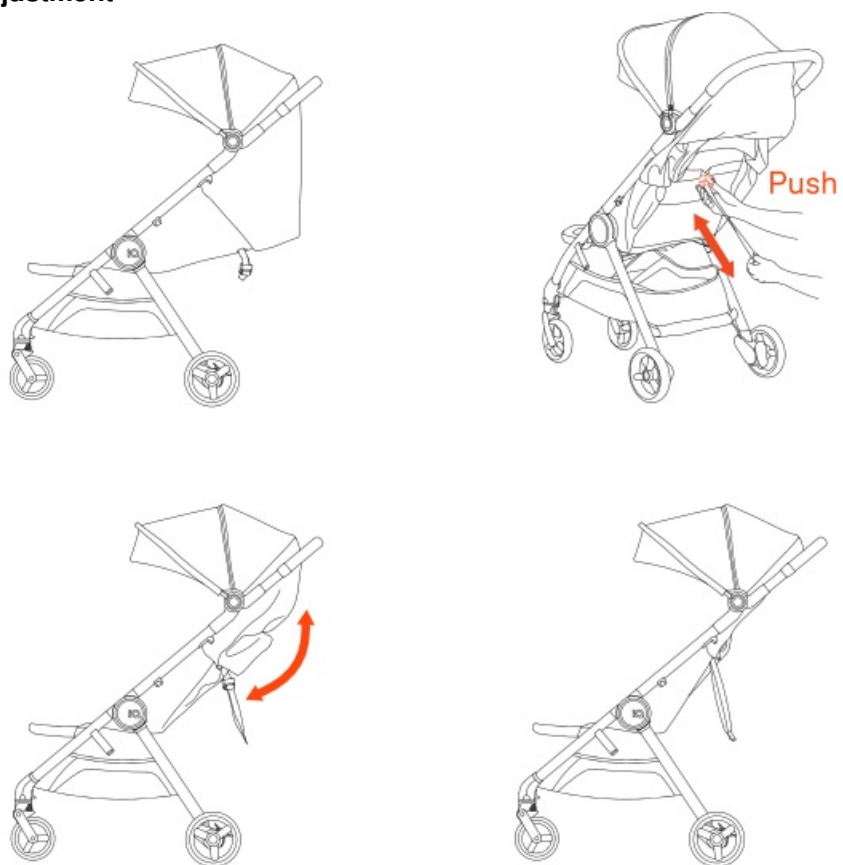

Footrest adjustment



Safety belts buckle

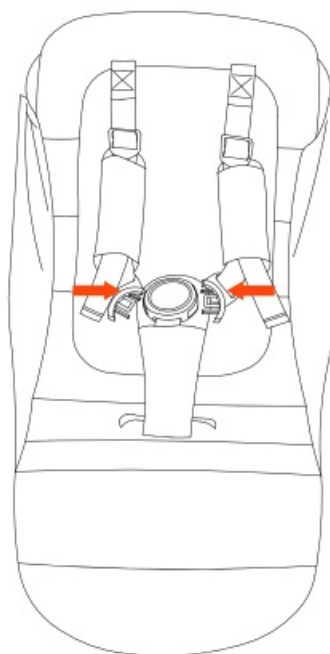
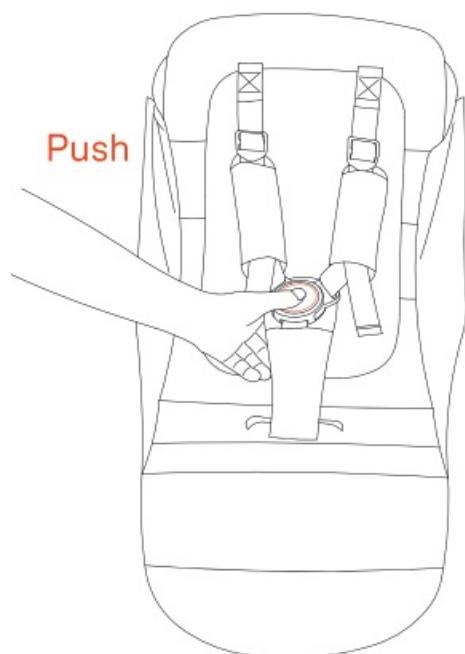

Safety belts adjustment

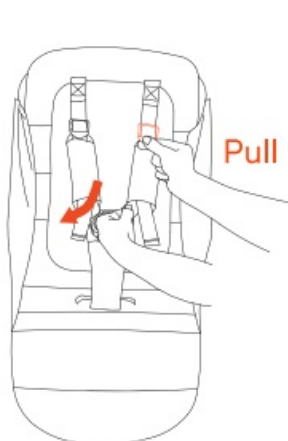
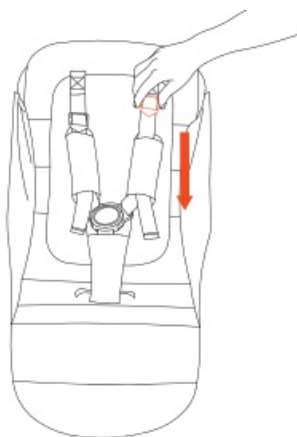
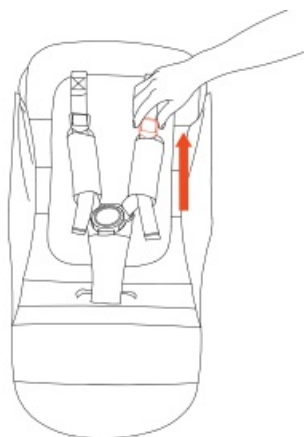

Folding of the frame with buggy

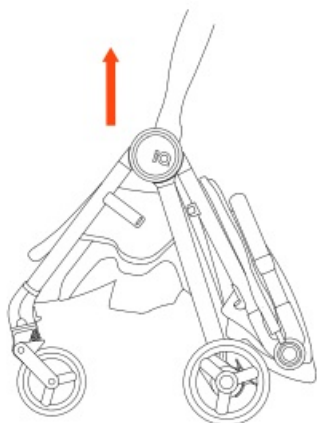
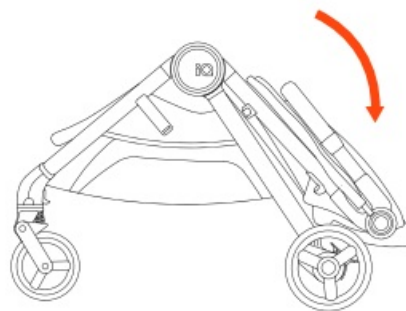
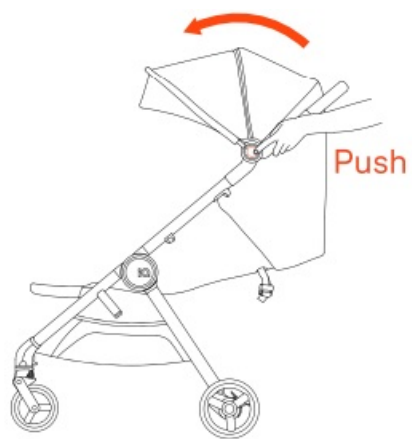

Raincover for carrycot/ seat unit

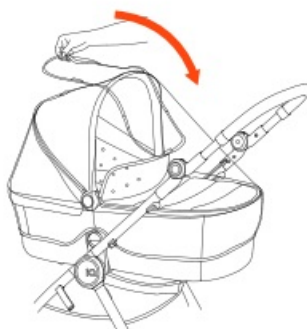
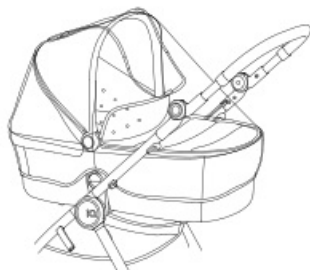
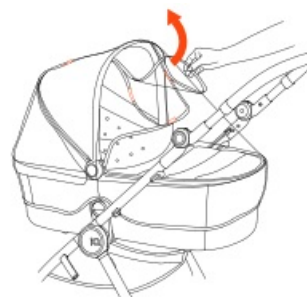
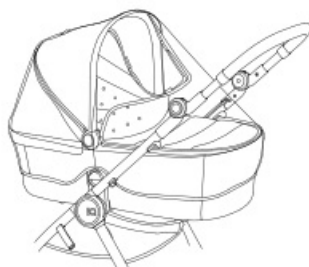
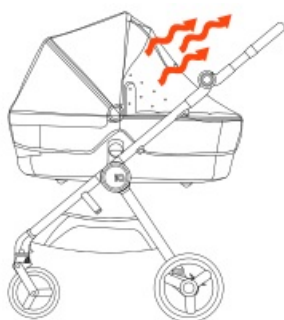



Check for the most recent manuals on our website: anexbaby.com

The information is subject to change without notice. Anex shall not be liable for technical errors or omissions contained in this manual. The purchased product may differ from the product as described in this manual.

AVALEX PTE. LTD.,

8 Eu Tong Sen Street #17-88, Central

Office tower 2, Singapore, 059818

+65 62215096

office@anexbaby.com

Documents / Resources



[ANEX IQ Basic Stroller](#) [pdf] Owner's Manual
IQ Basic Stroller, IQ, Basic Stroller, Stroller

References

- [User Manual](#)

[Manuals+](#), [Privacy Policy](#)

This website is an independent publication and is neither affiliated with nor endorsed by any of the trademark owners. The "Bluetooth®" word mark and logos are registered trademarks owned by Bluetooth SIG, Inc. The "Wi-Fi®" word mark and logos are registered trademarks owned by the Wi-Fi Alliance. Any use of these marks on this website does not imply any affiliation with or endorsement.