

anex iq Basic NT 2 in 1 Pram Plus Lightweight Buggy



anex IQ Basic NT 2 in 1 Pram Plus Lightweight Buggy User Manual

[Home](#) » [anex](#) » anex IQ Basic NT 2 in 1 Pram Plus Lightweight Buggy User Manual 

Contents

- [1 anex IQ Basic NT 2 in 1 Pram Plus Lightweight Buggy](#)
- [2 All-In-One](#)
- [3 Frame](#)
- [4 Carrycot](#)
- [5 Seat unit](#)
- [6 Buggy](#)
- [7 Accessories](#)
- [8 Documents / Resources](#)
 - [8.1 References](#)

anex iq

anex IQ Basic NT 2 in 1 Pram Plus Lightweight Buggy



All-In-One

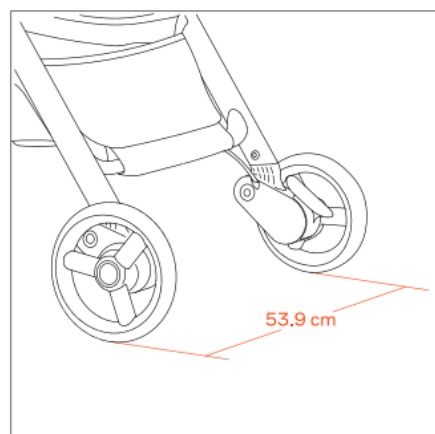
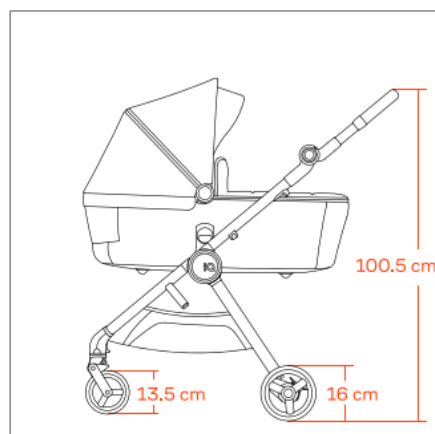
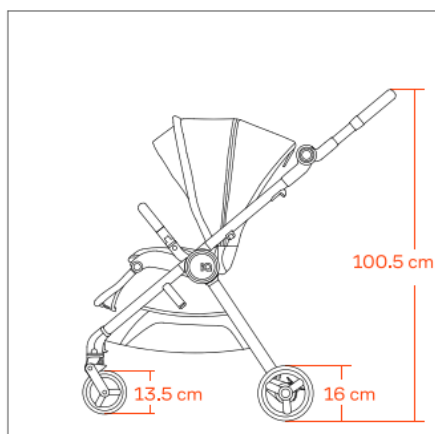
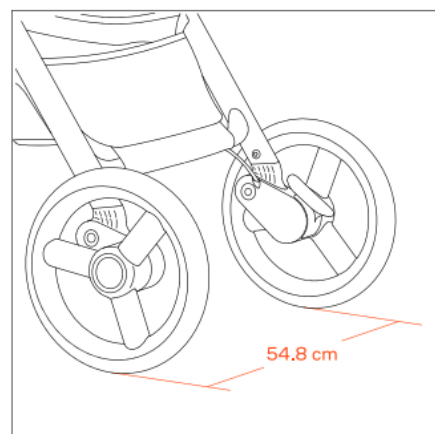
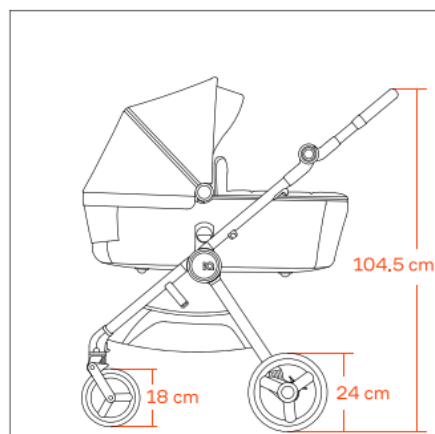
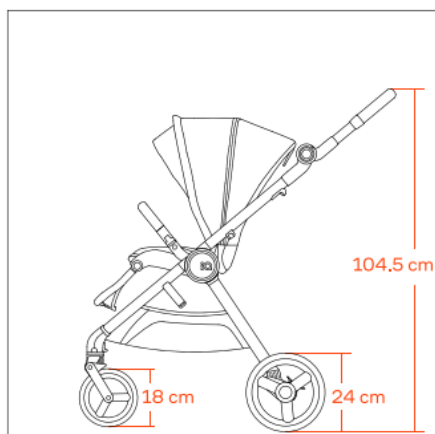

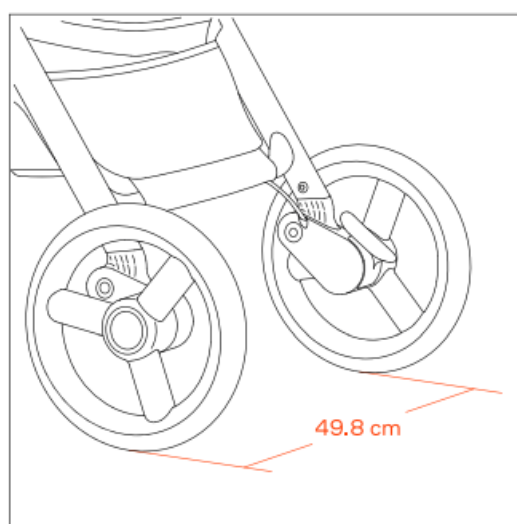
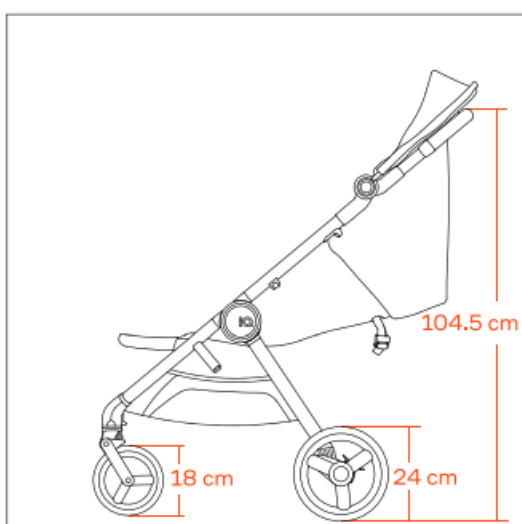
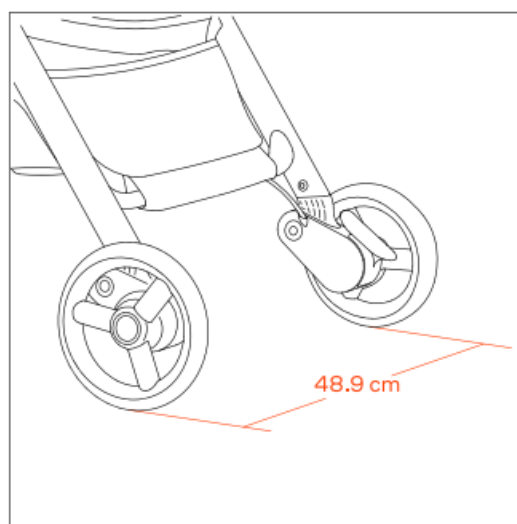
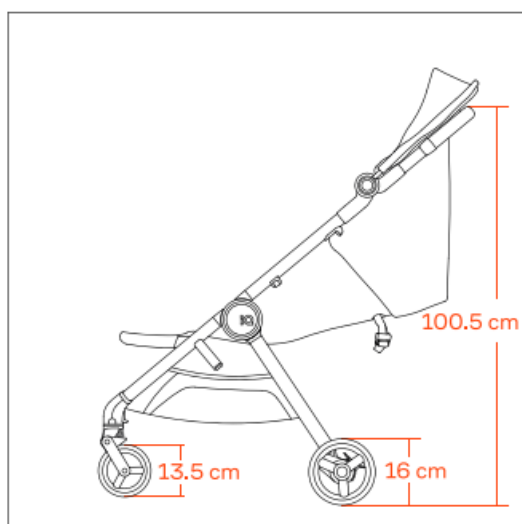

Frame

Folding of the frame

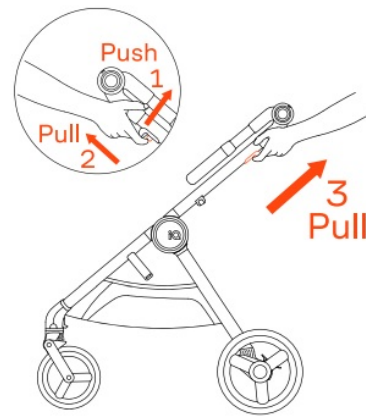
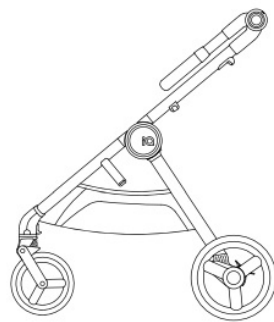
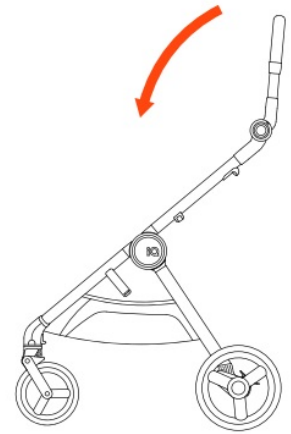
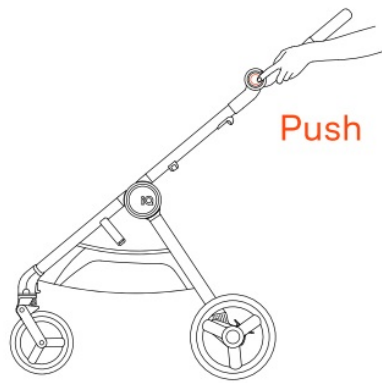
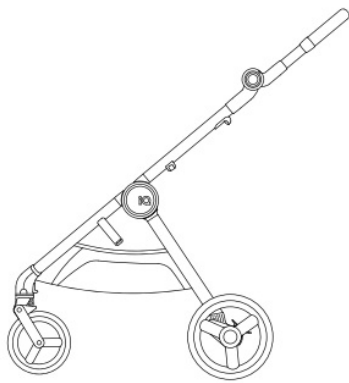

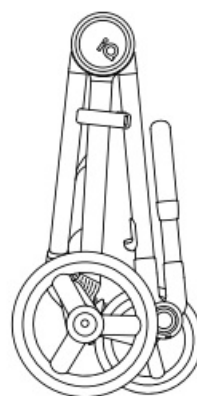
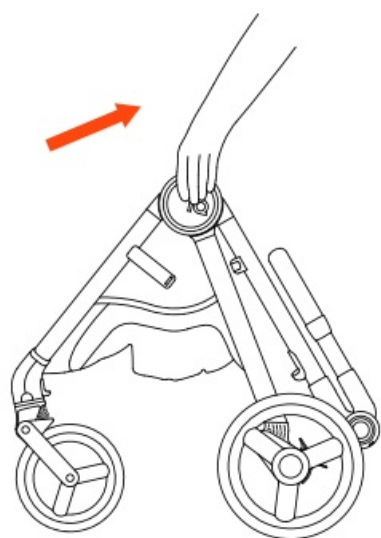
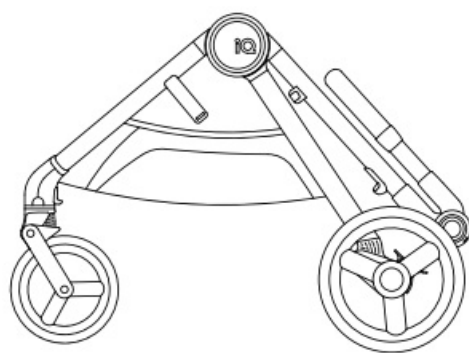
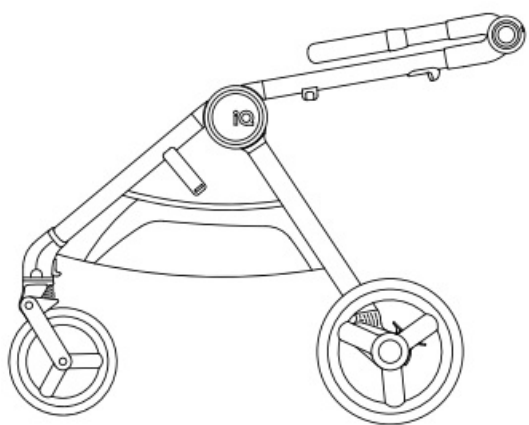

Unfolding of the frame

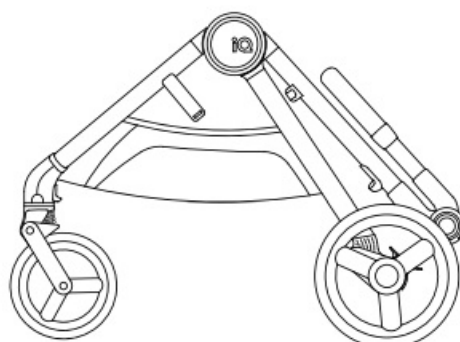
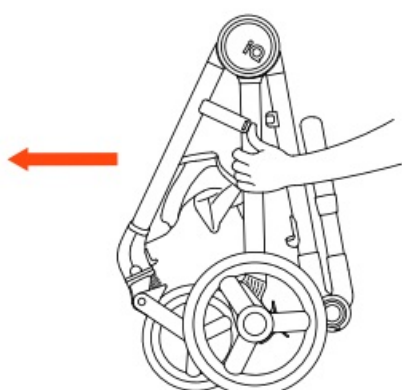
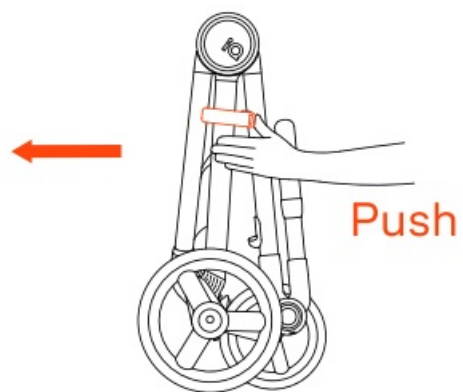
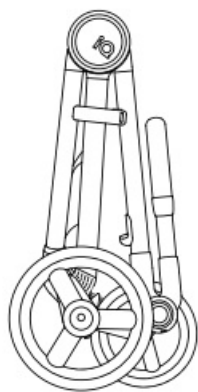

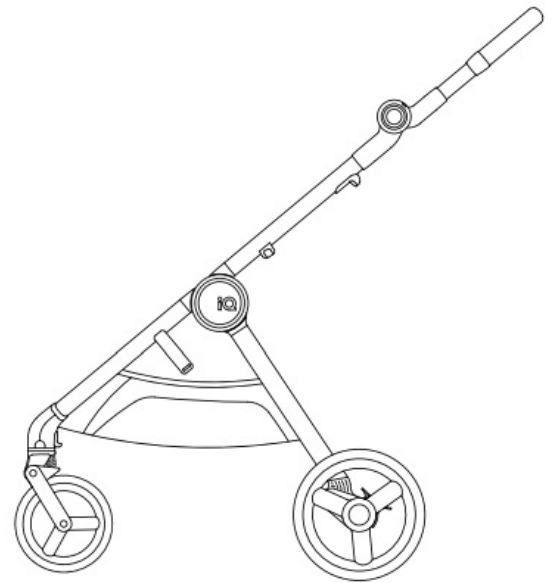
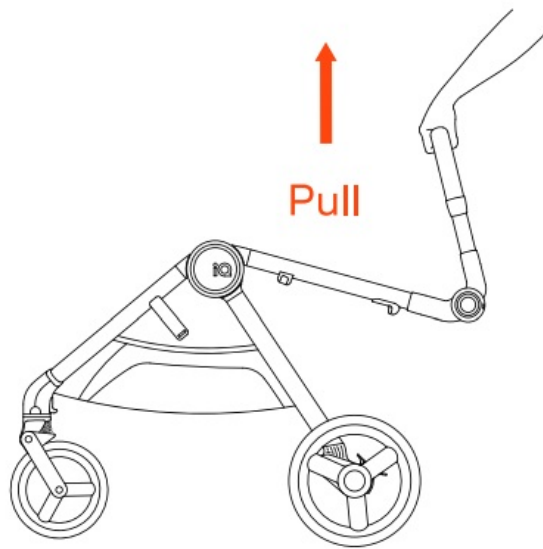
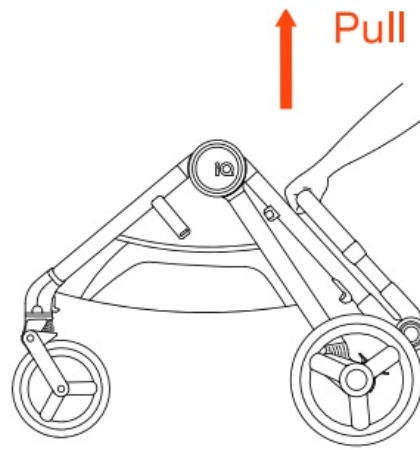

Attaching of the front wheels

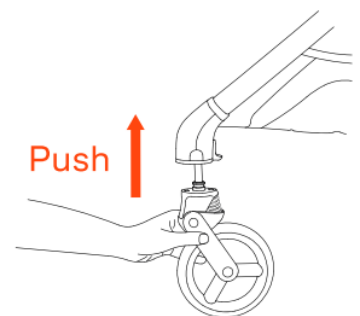
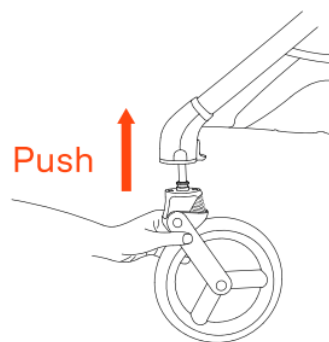
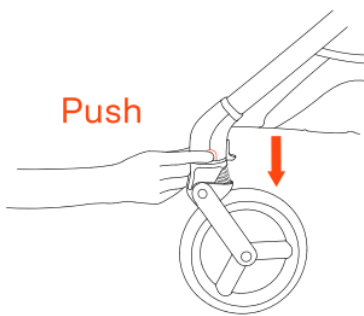

Locking front swivel wheels

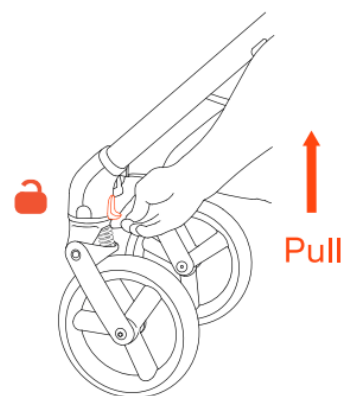
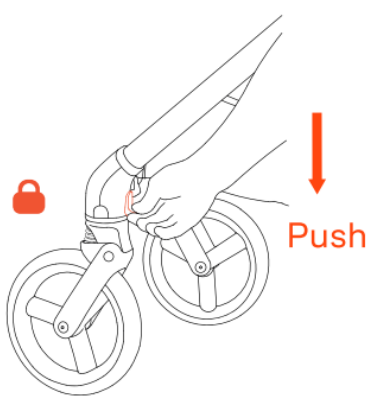
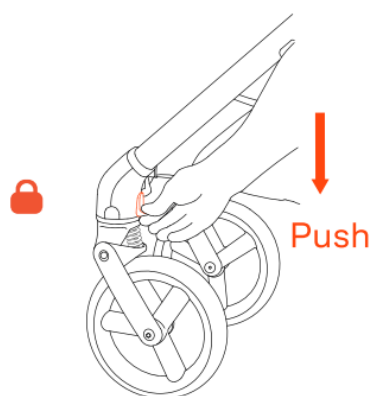
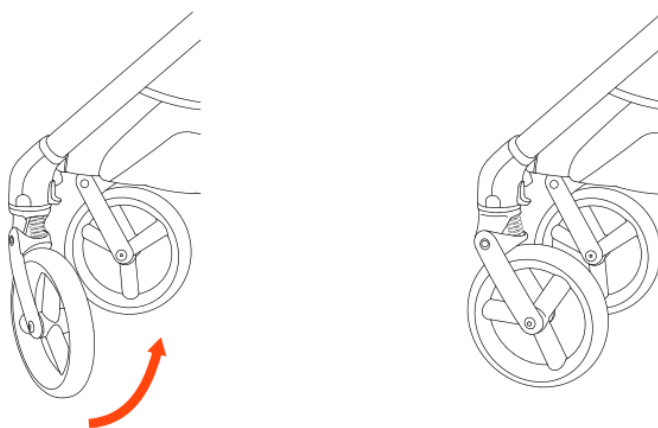

Attaching of the rear wheels

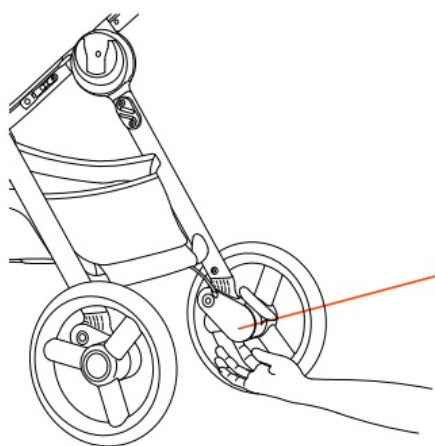

Push

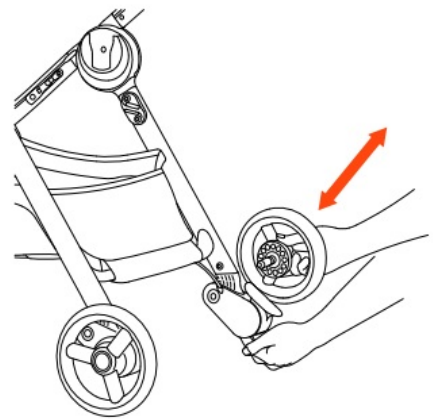
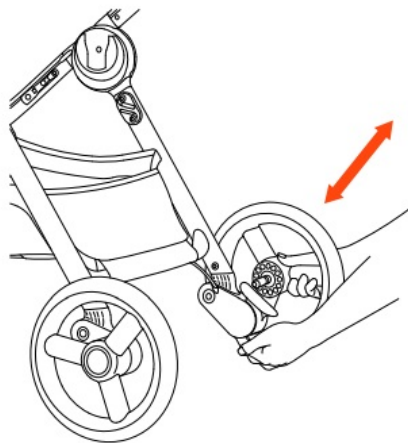
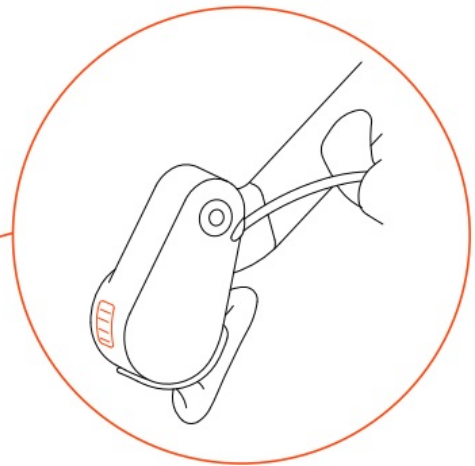

Brakes

Shock absorption

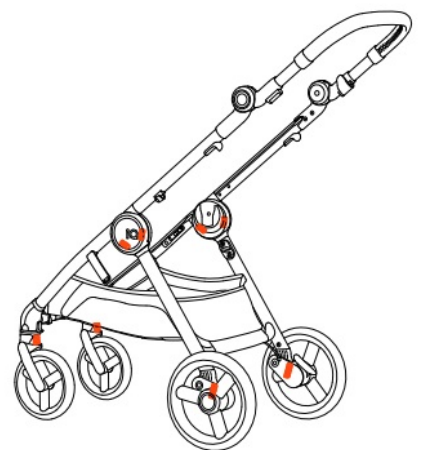
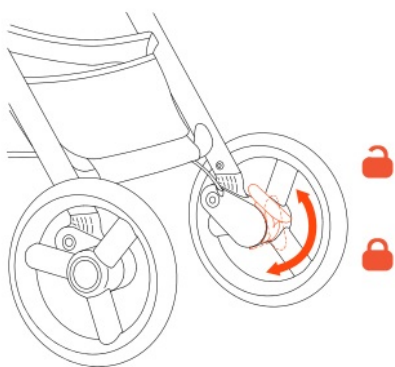

Handle regulation

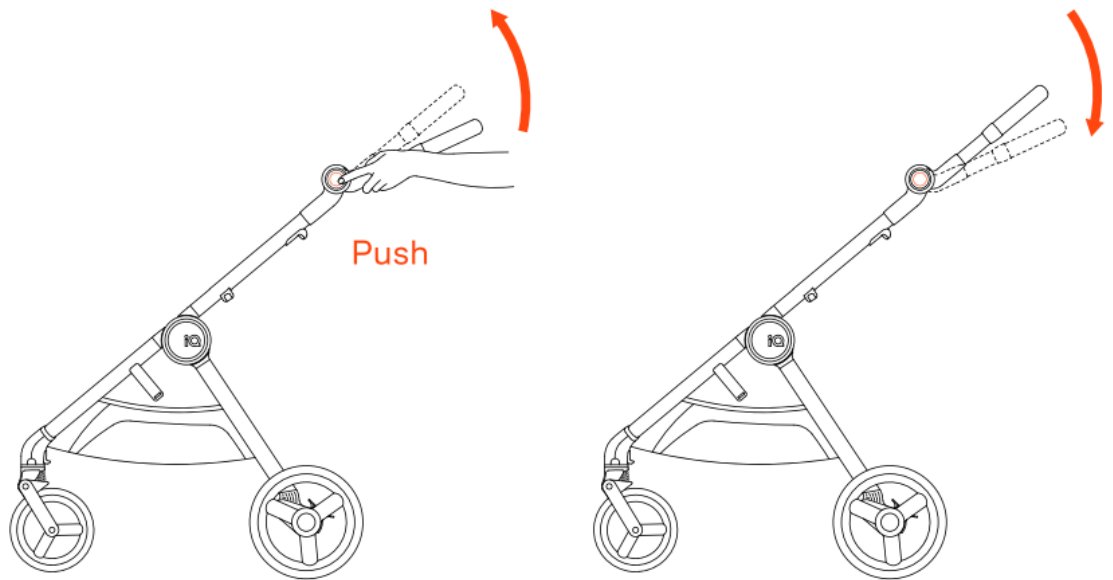

Disconnecting/connecting of the shopping basket

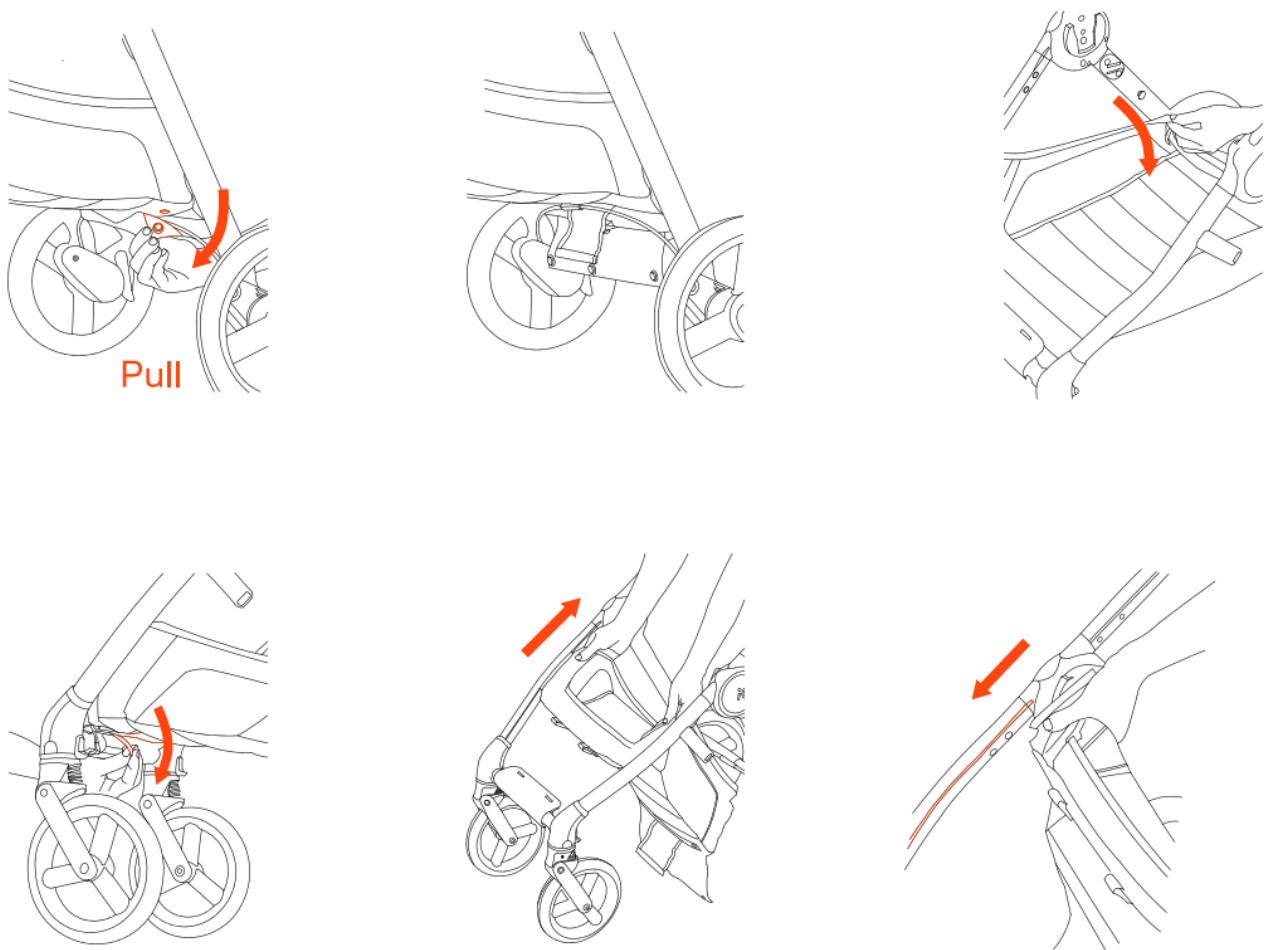

Carry handle

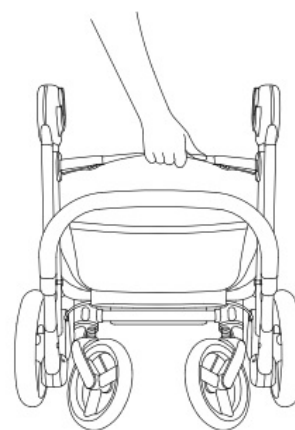
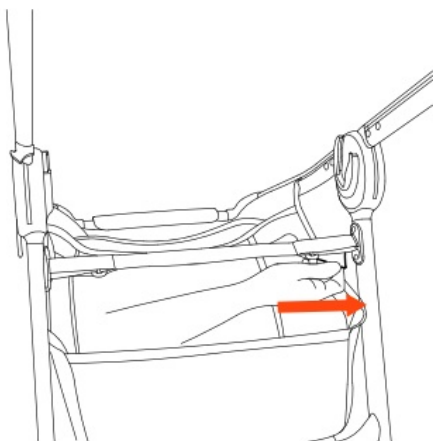
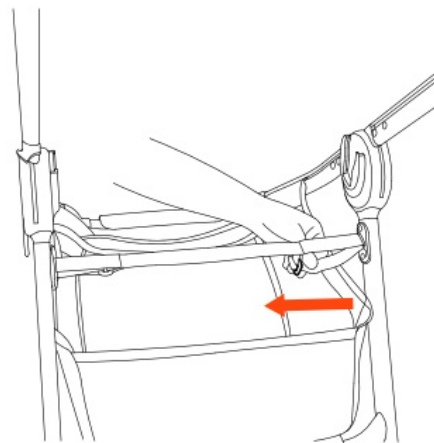
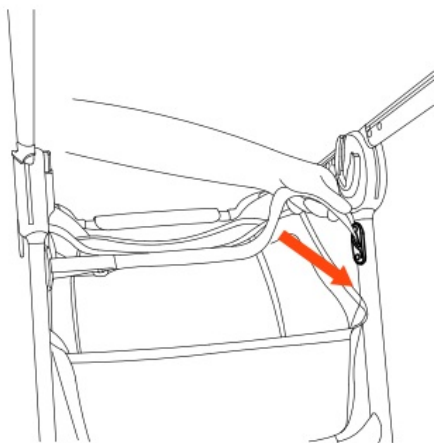

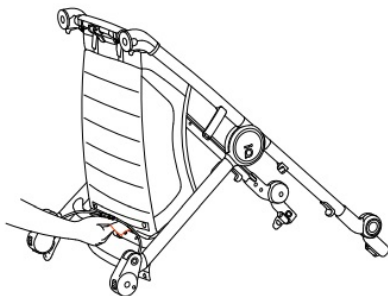
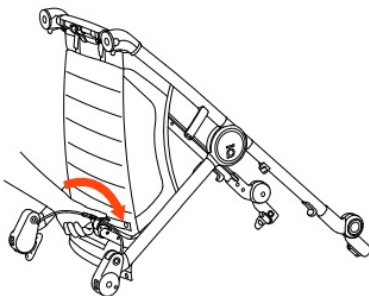
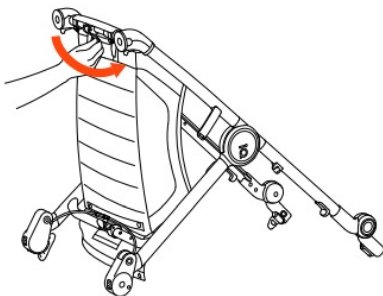
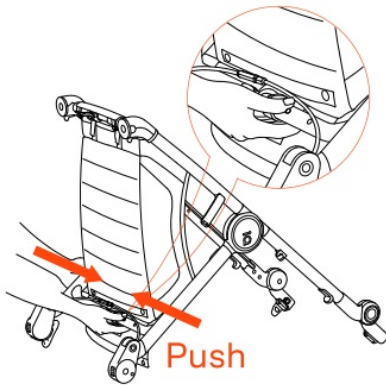
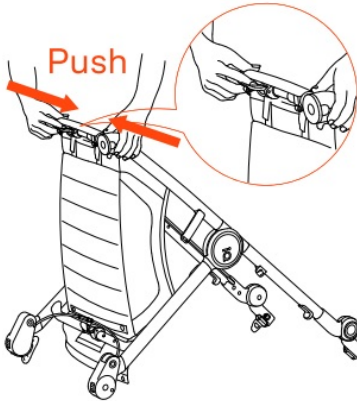
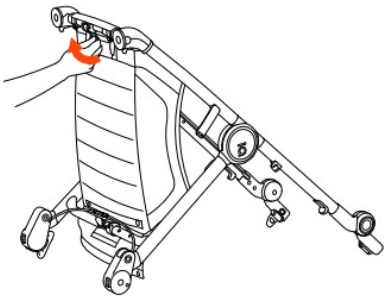
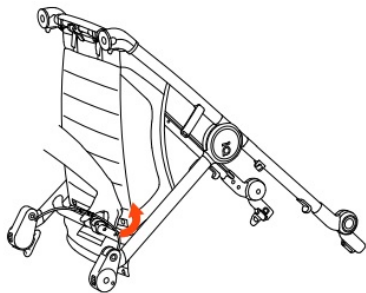
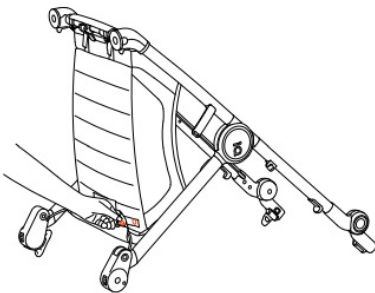
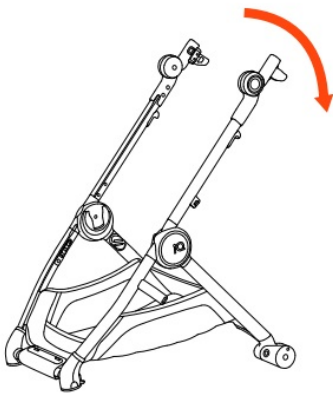
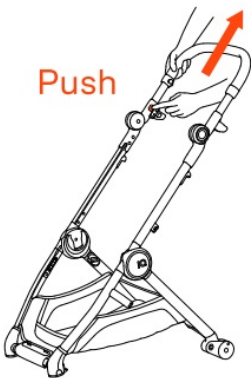
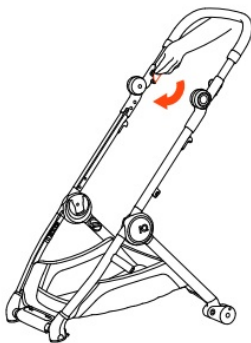
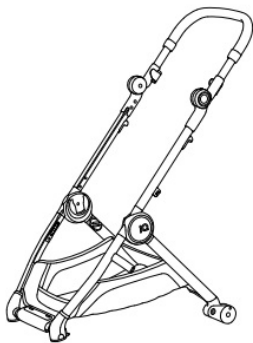

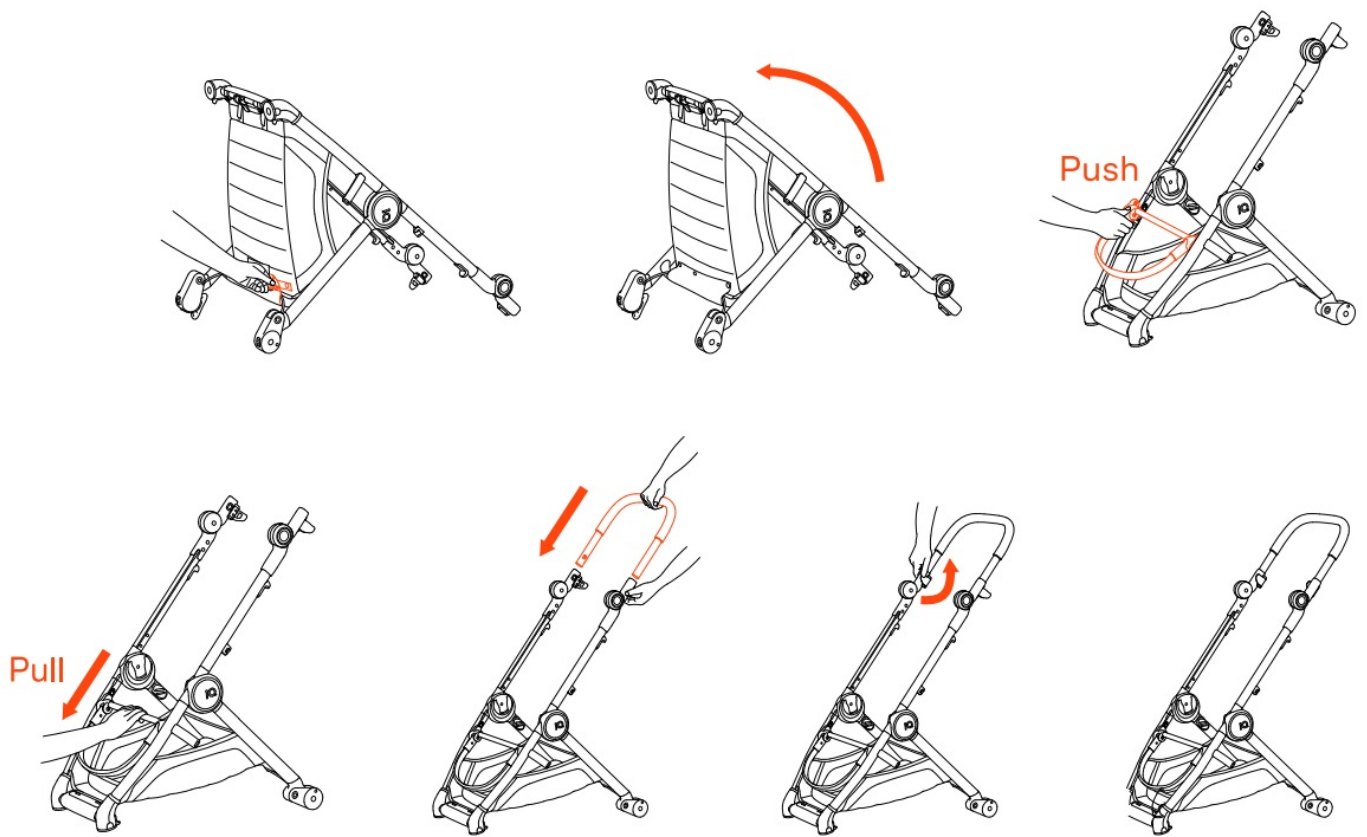

Carrycot

Unpacking of the carrycot

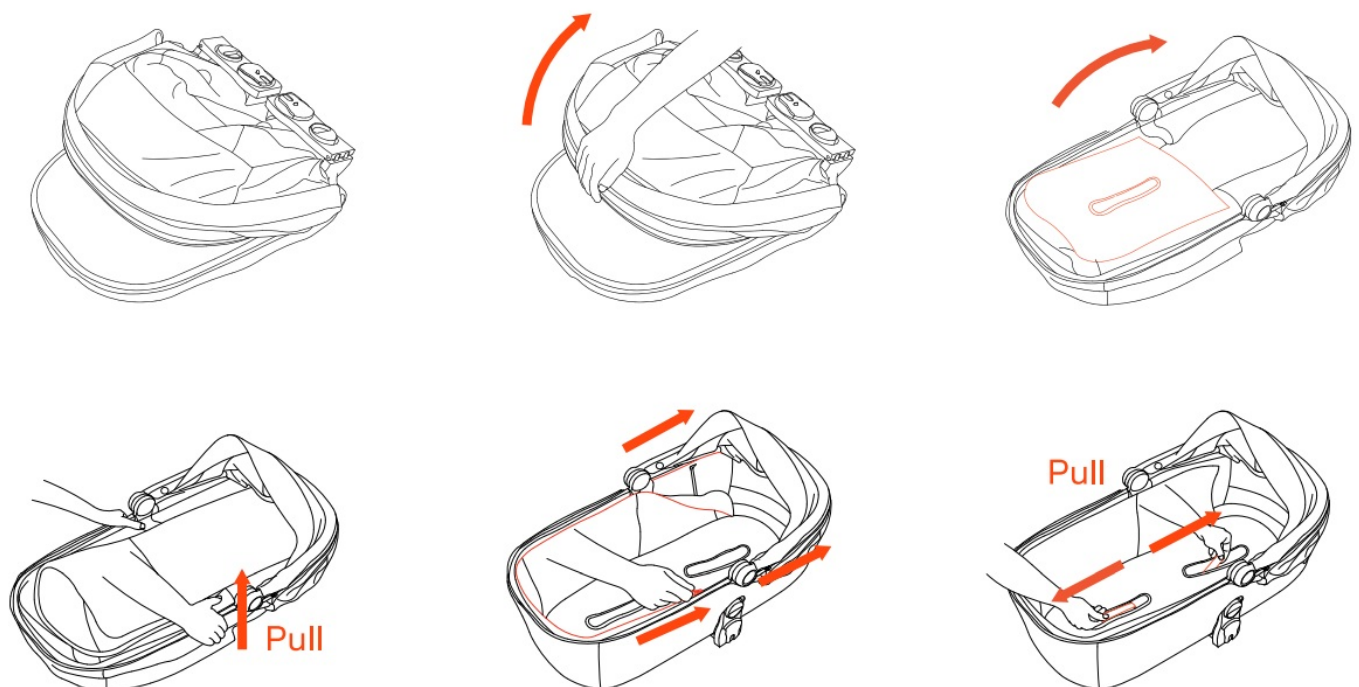

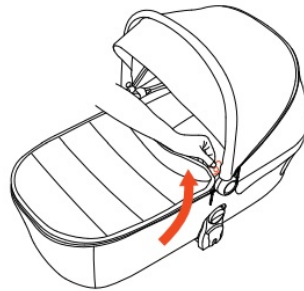
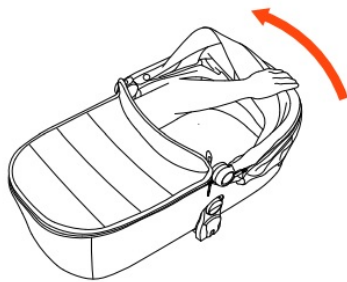
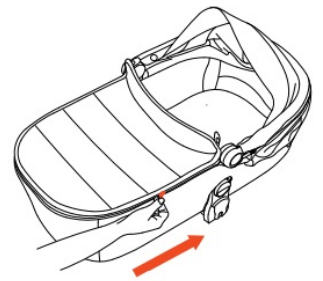
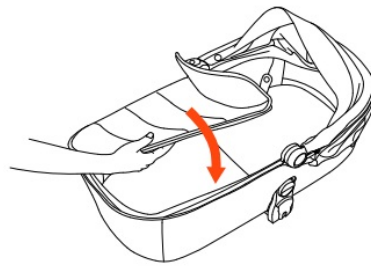
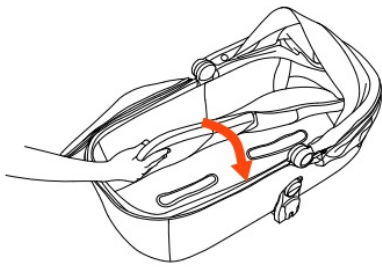

Folding of the carrycot

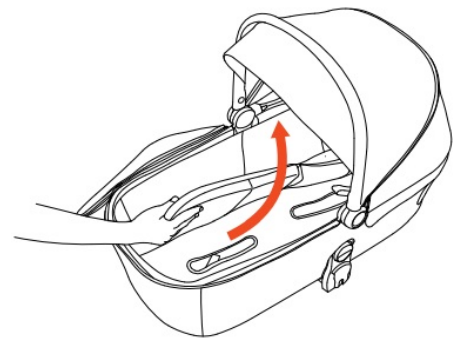
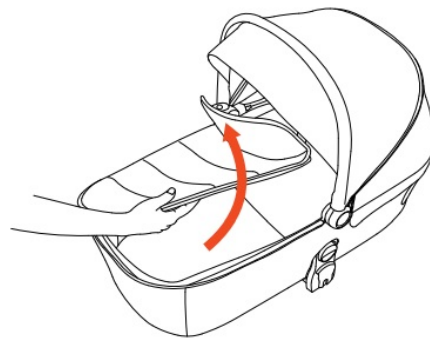
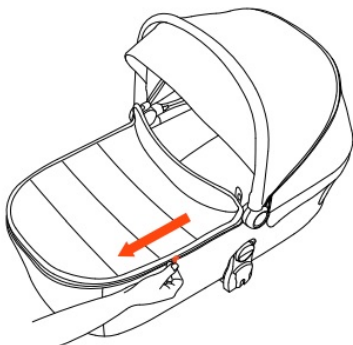
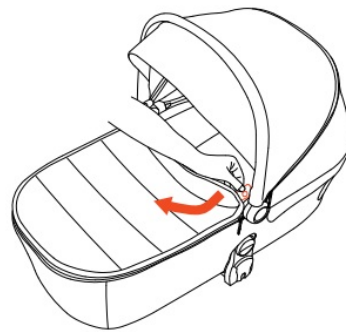

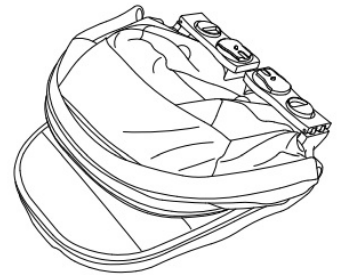
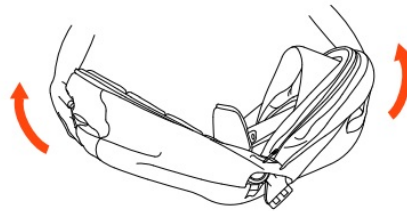
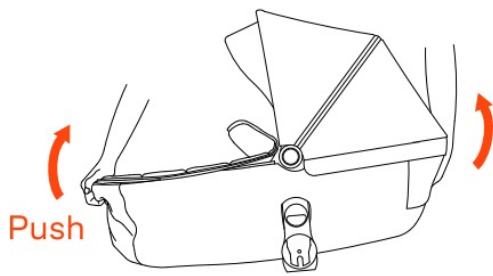
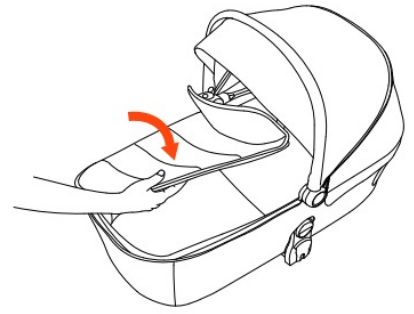
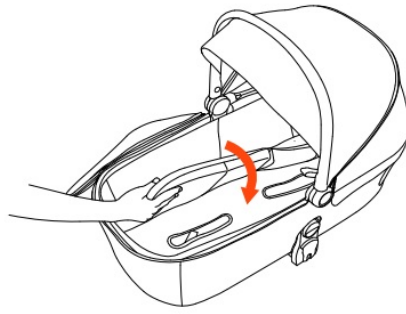
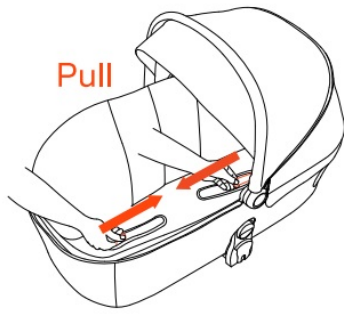

Unfolding of the carrycot

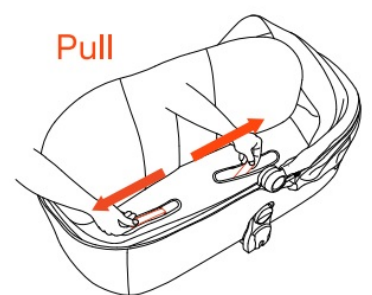
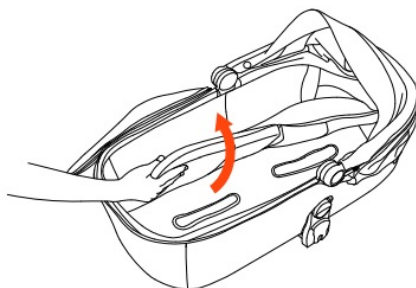
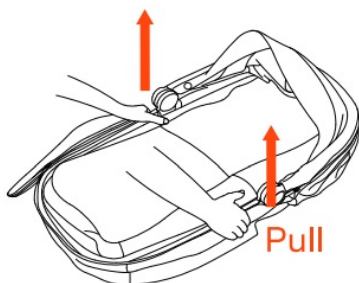
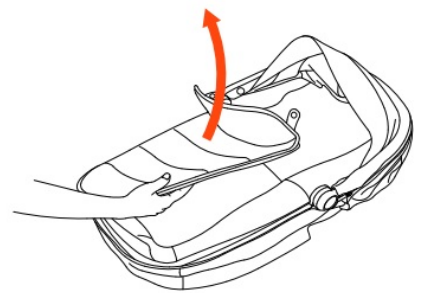
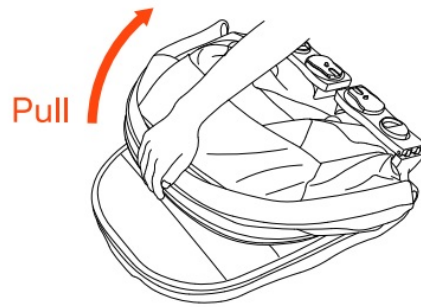
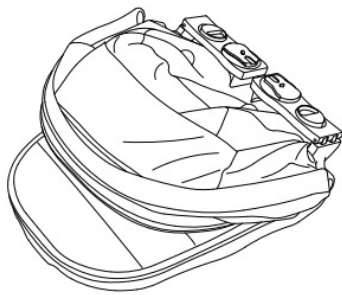

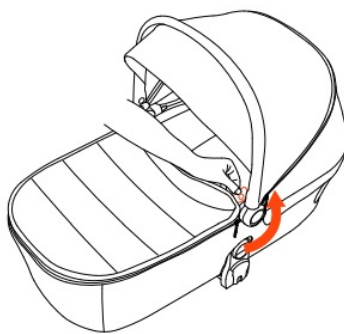
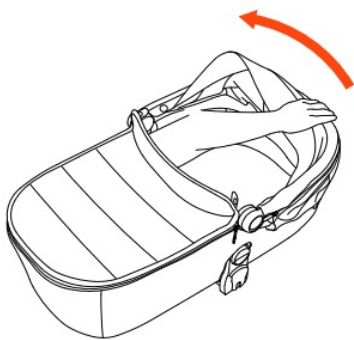
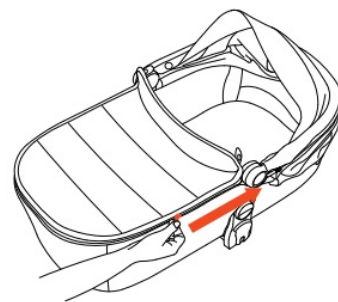
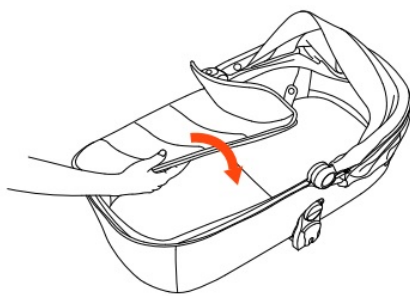
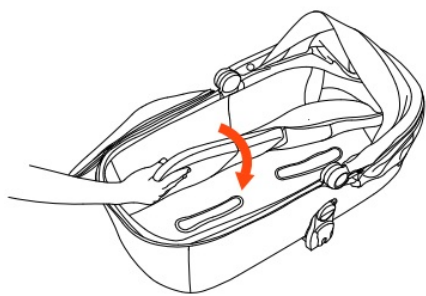

Attachment to the frame

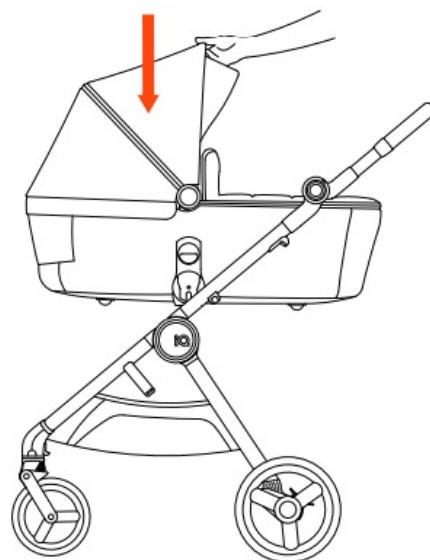
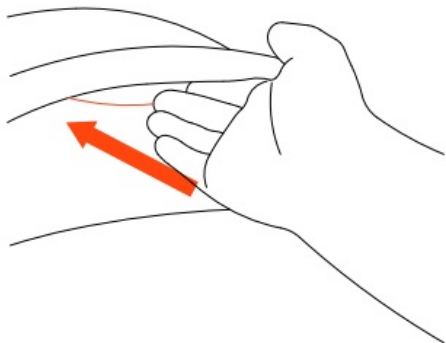

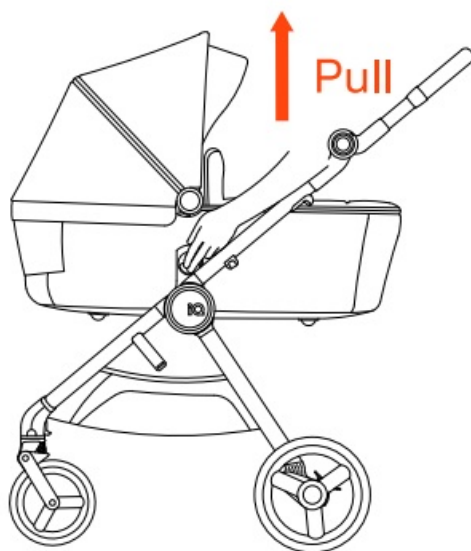
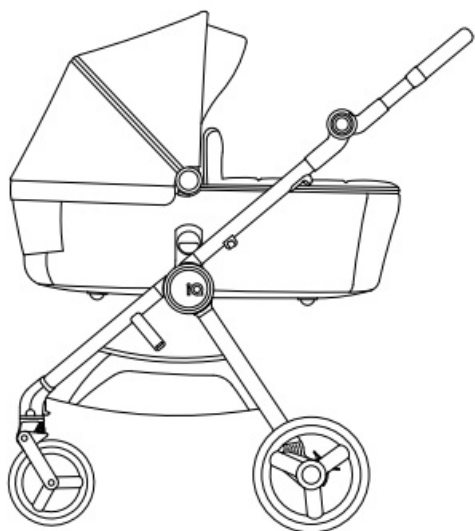

Ventilation

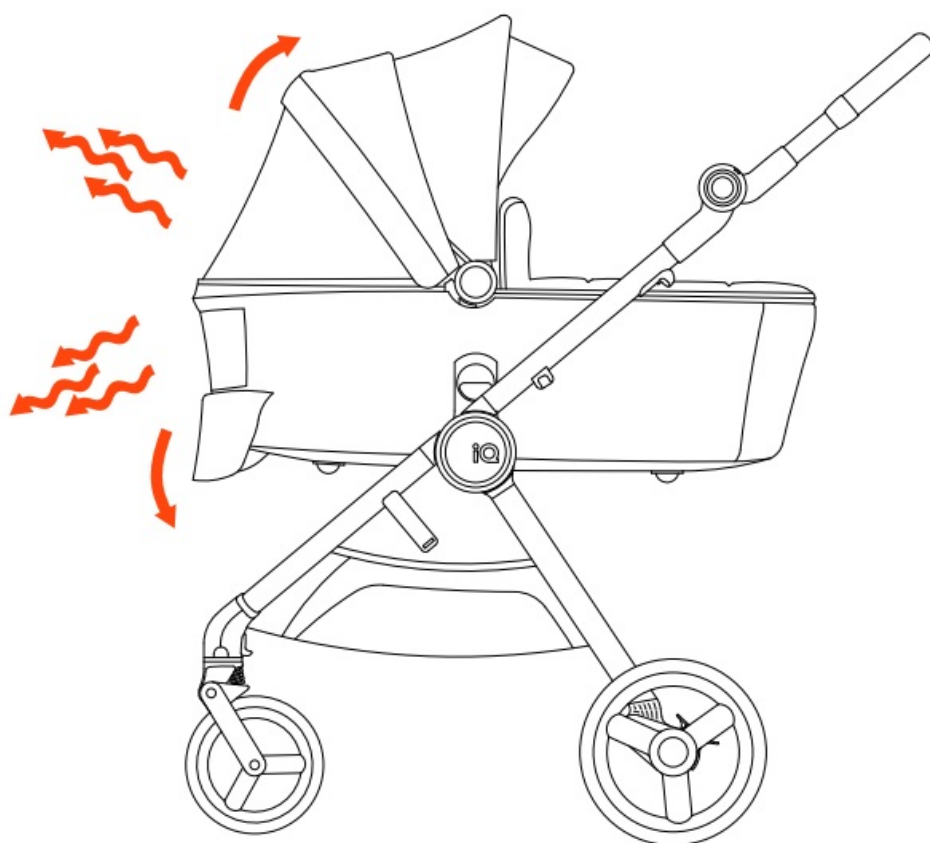

Carrycot's hood adjustment

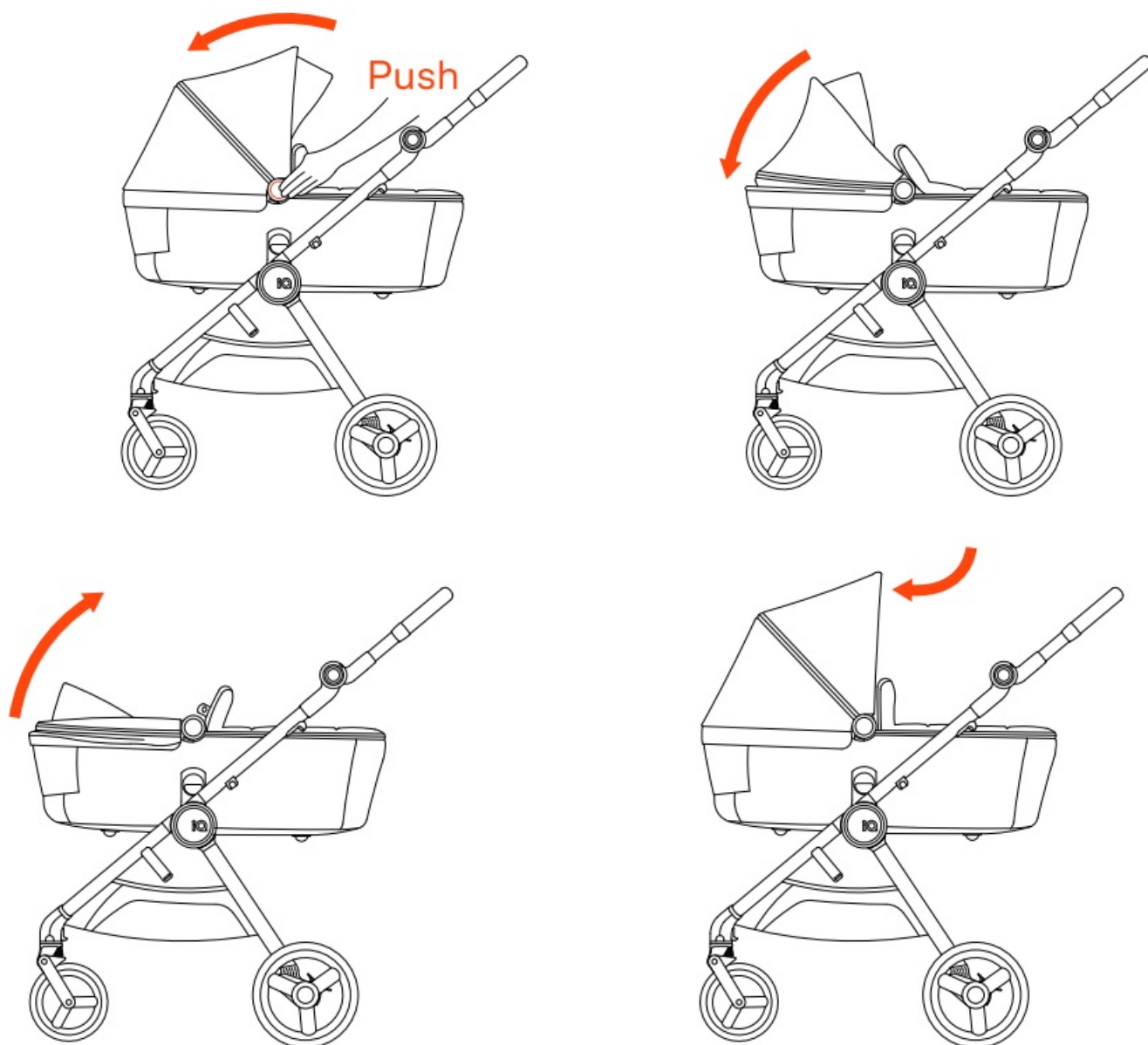

Carrycot's hood adjustment

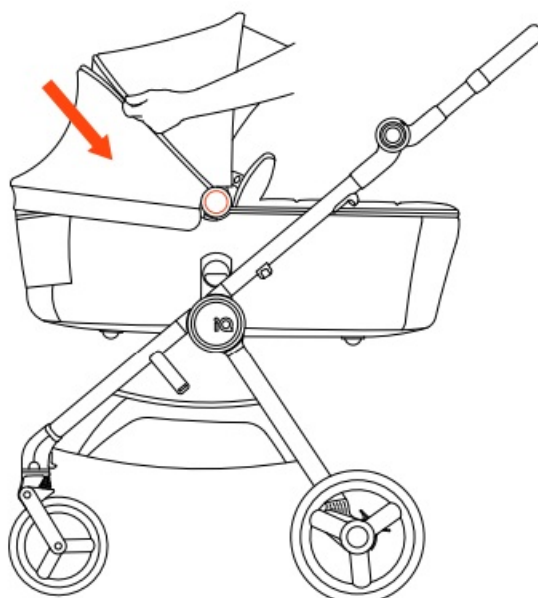

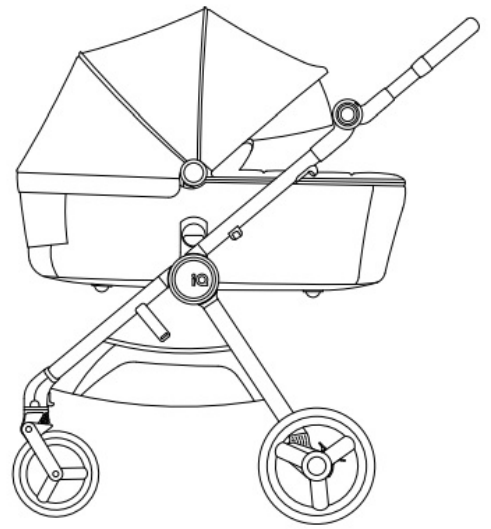
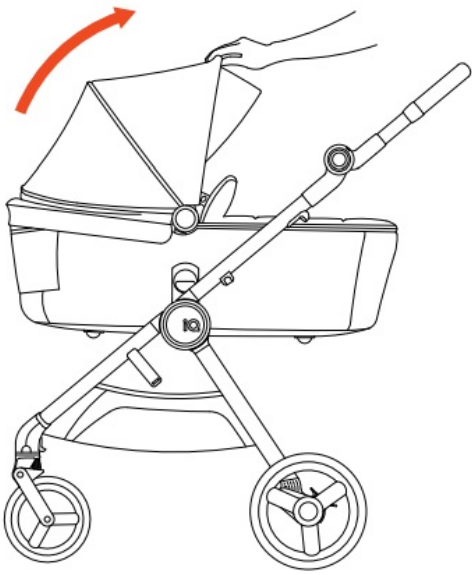

Carrycot's cover attachment

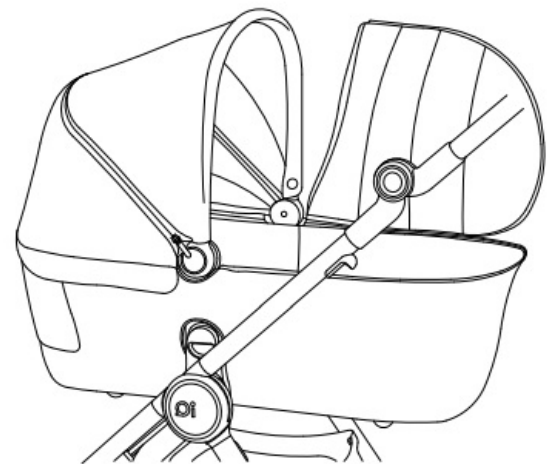
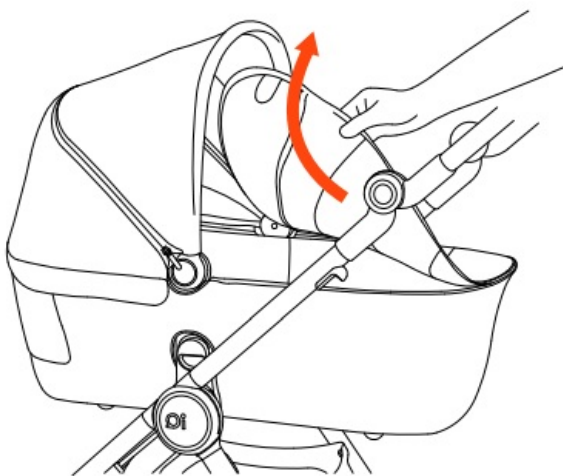
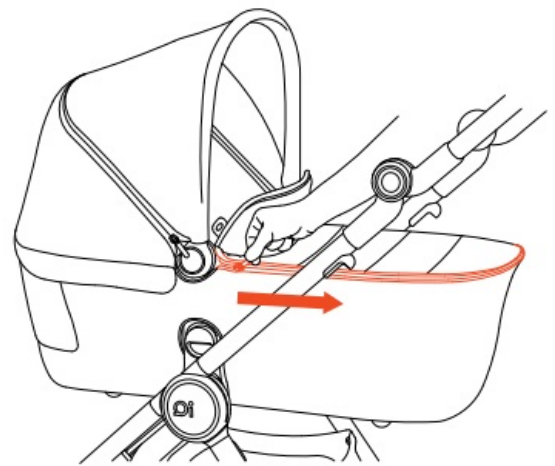
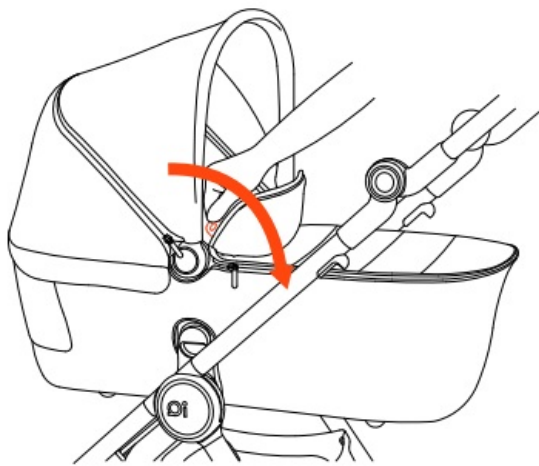

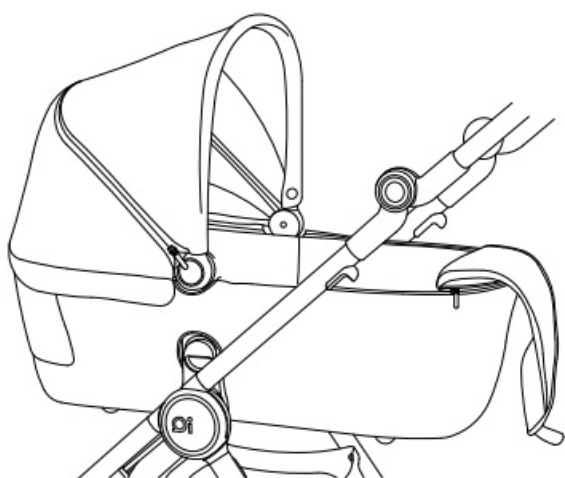
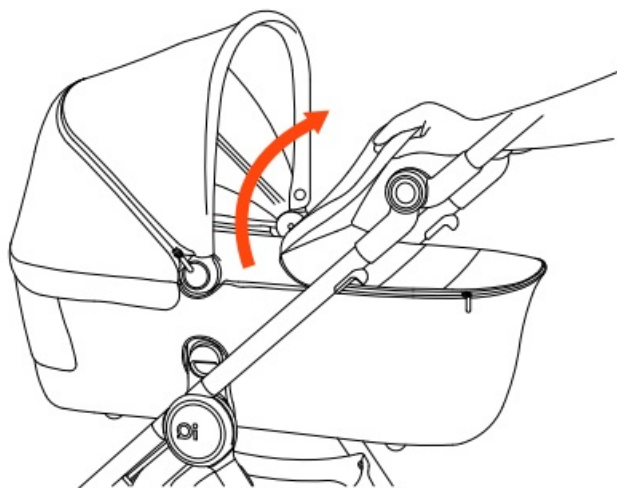
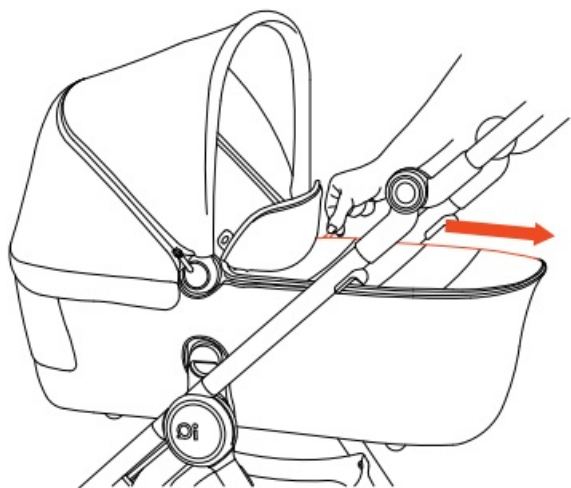

Carrycot's cleaning

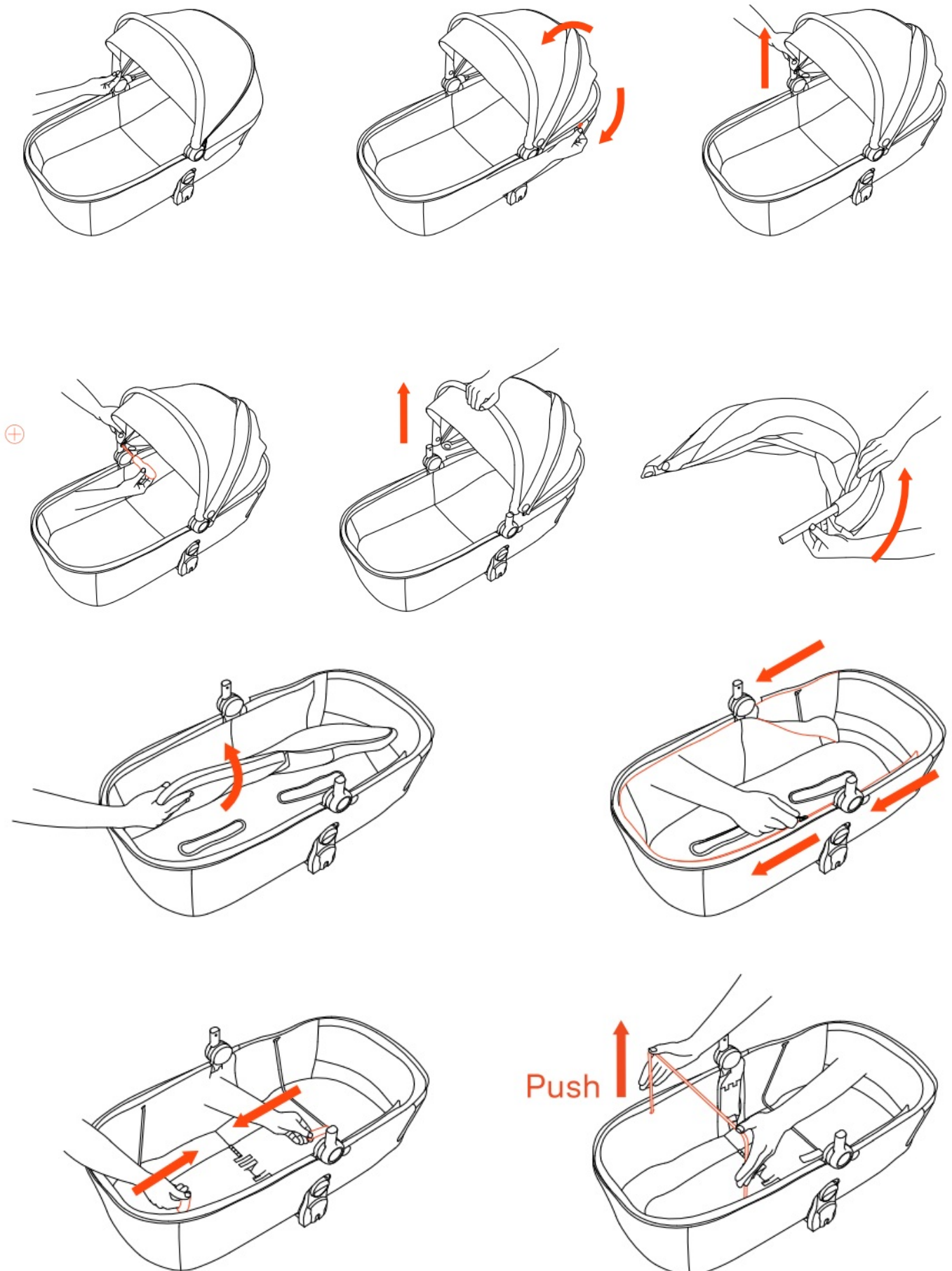

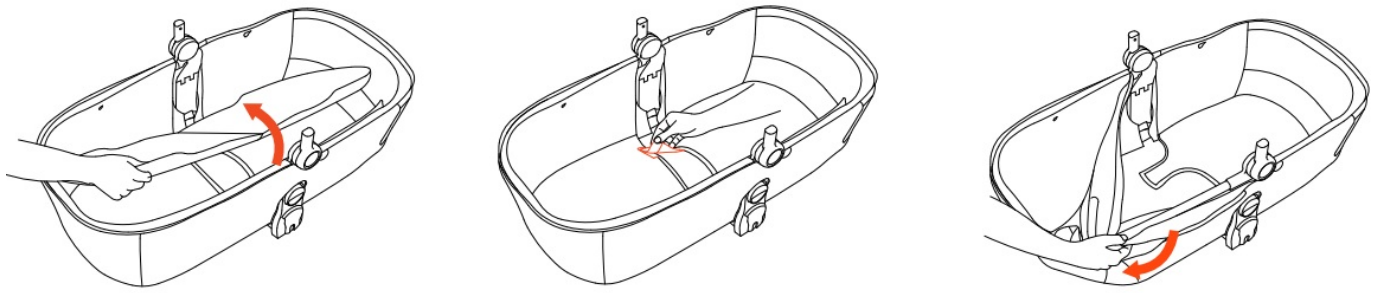

Seat unit

Attachment to the frame

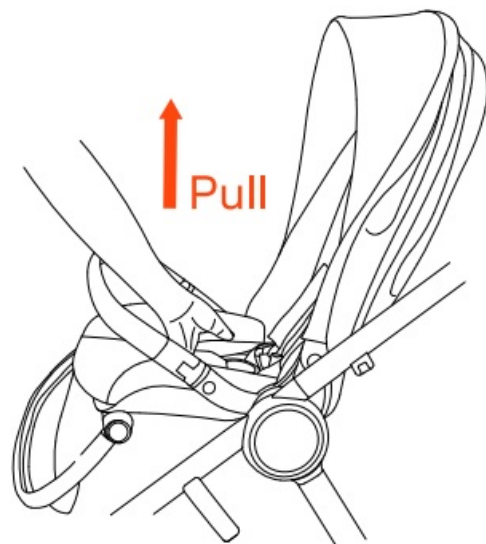
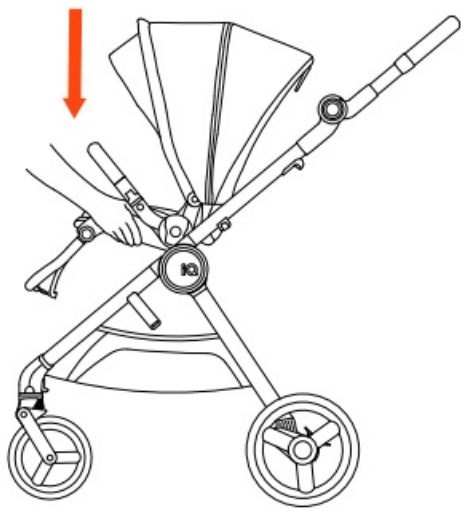

Folding of the frame with seat

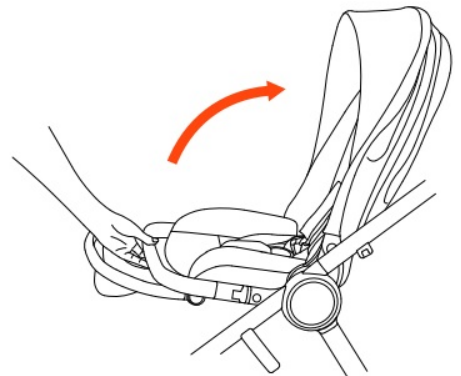
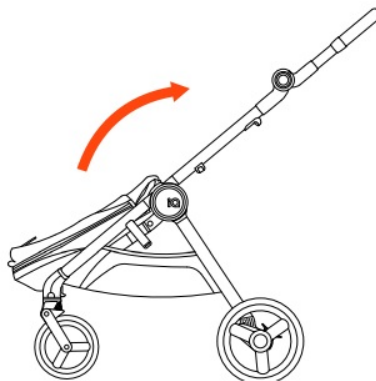
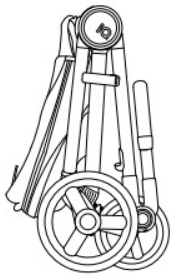
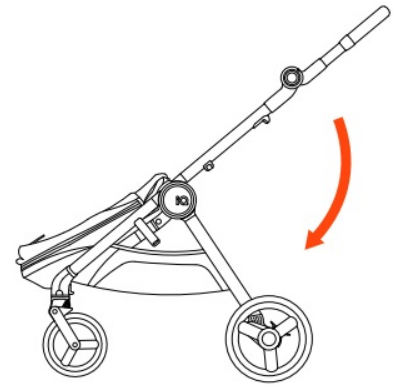
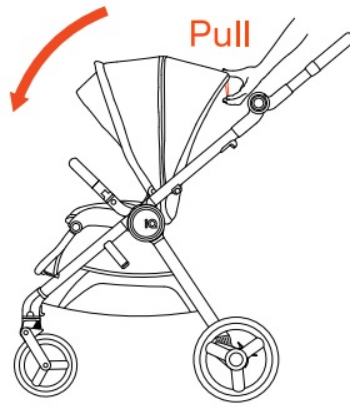

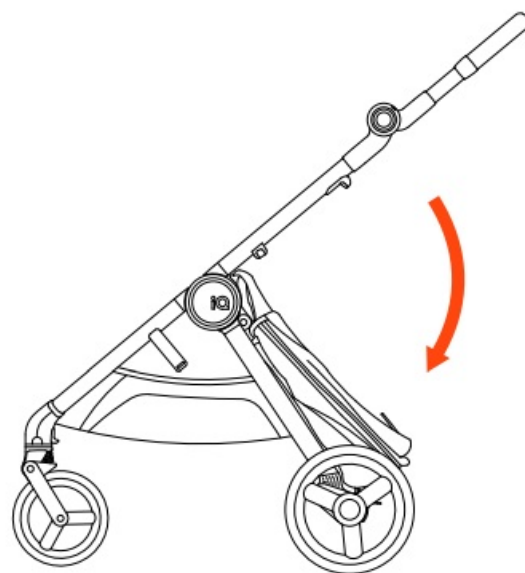
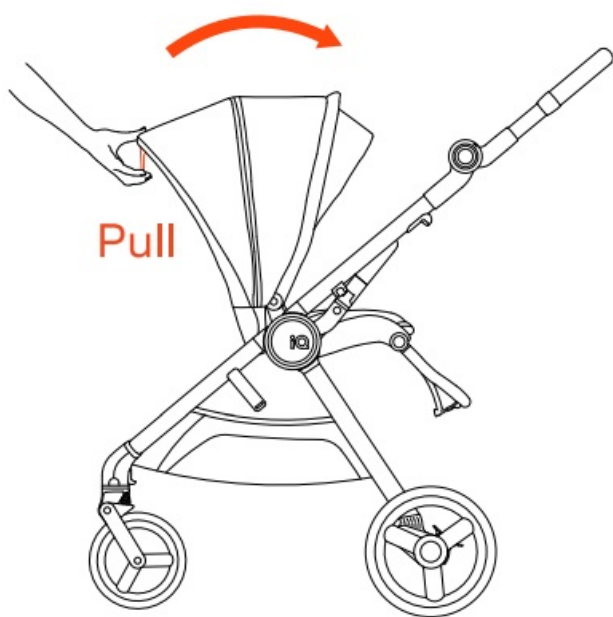
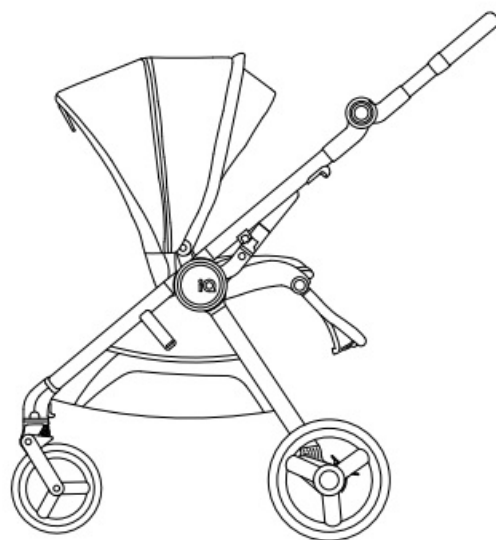
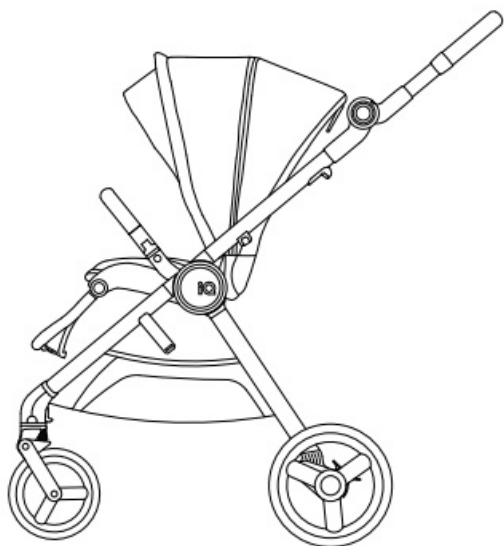

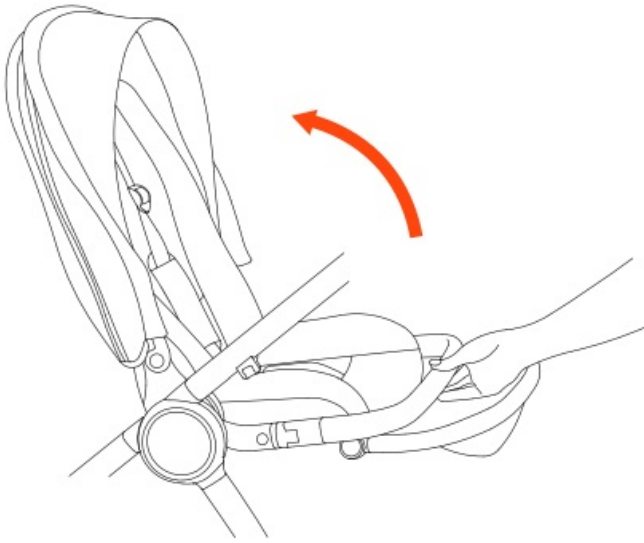
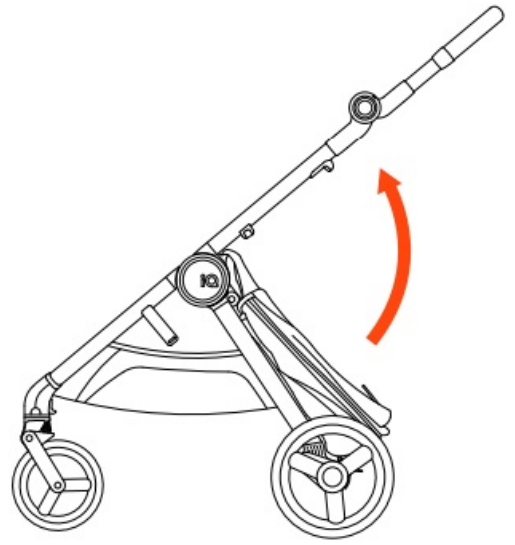
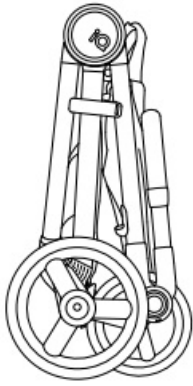

Seat unit's hood adjustment

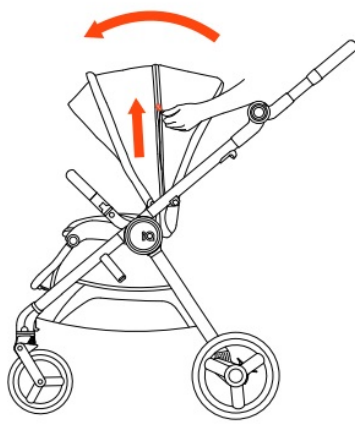
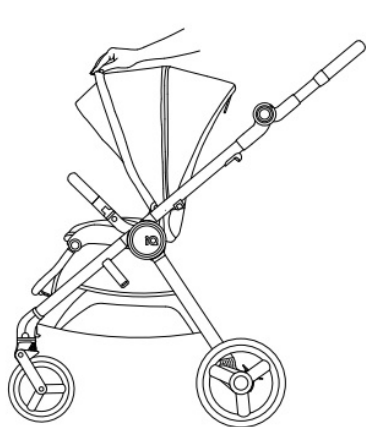

Seat unit's backrest adjustment

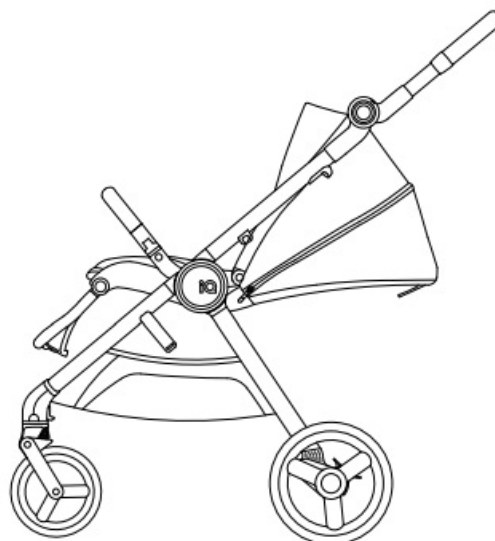
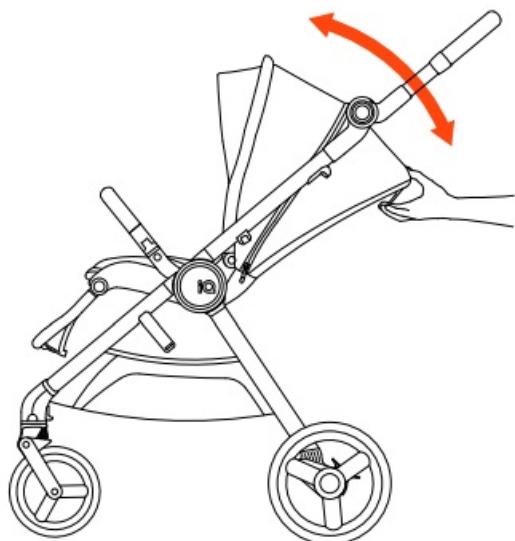
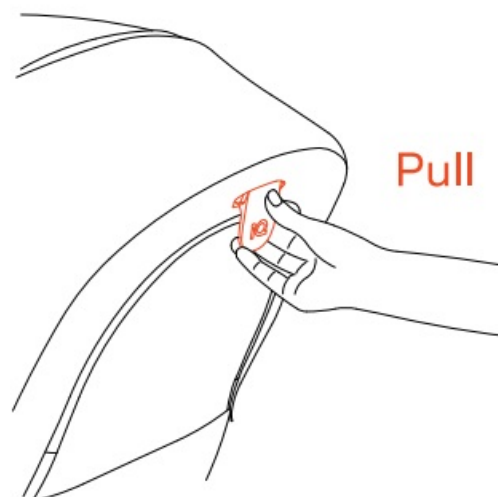

Ventilation of the seat unit's backrest

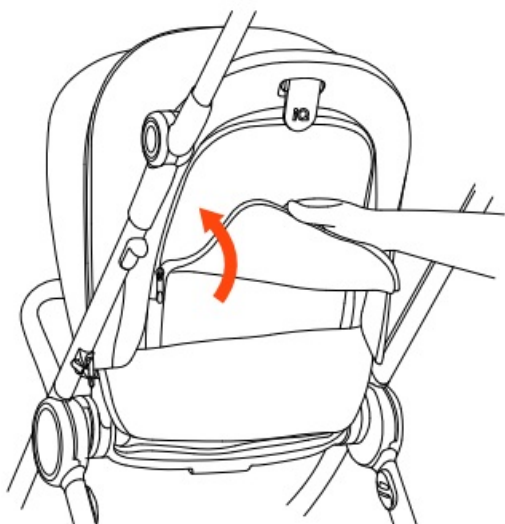
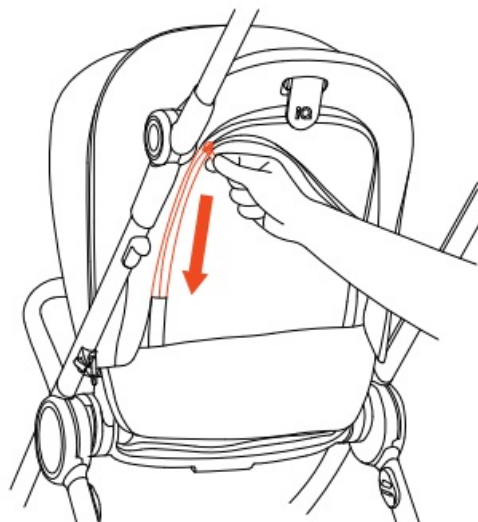

Footrest adjustment

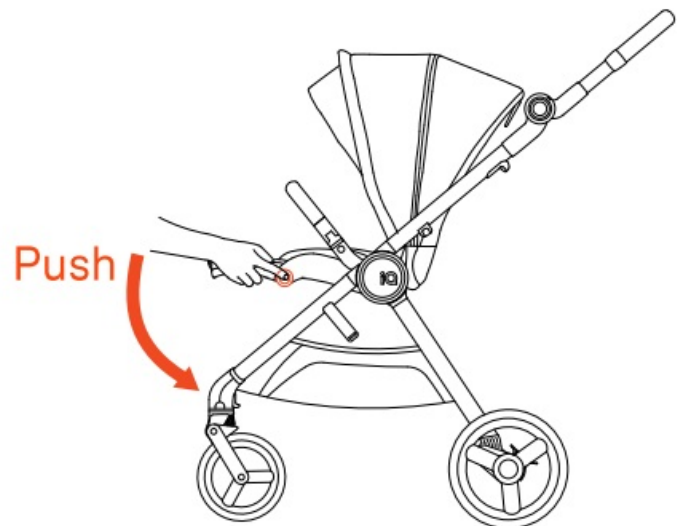
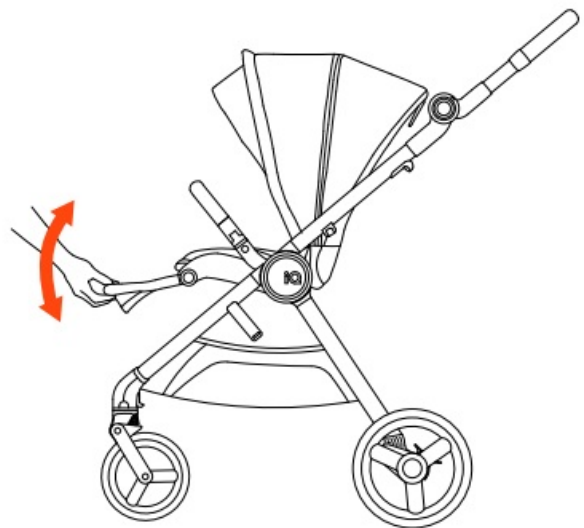

Seat unit's security barrier

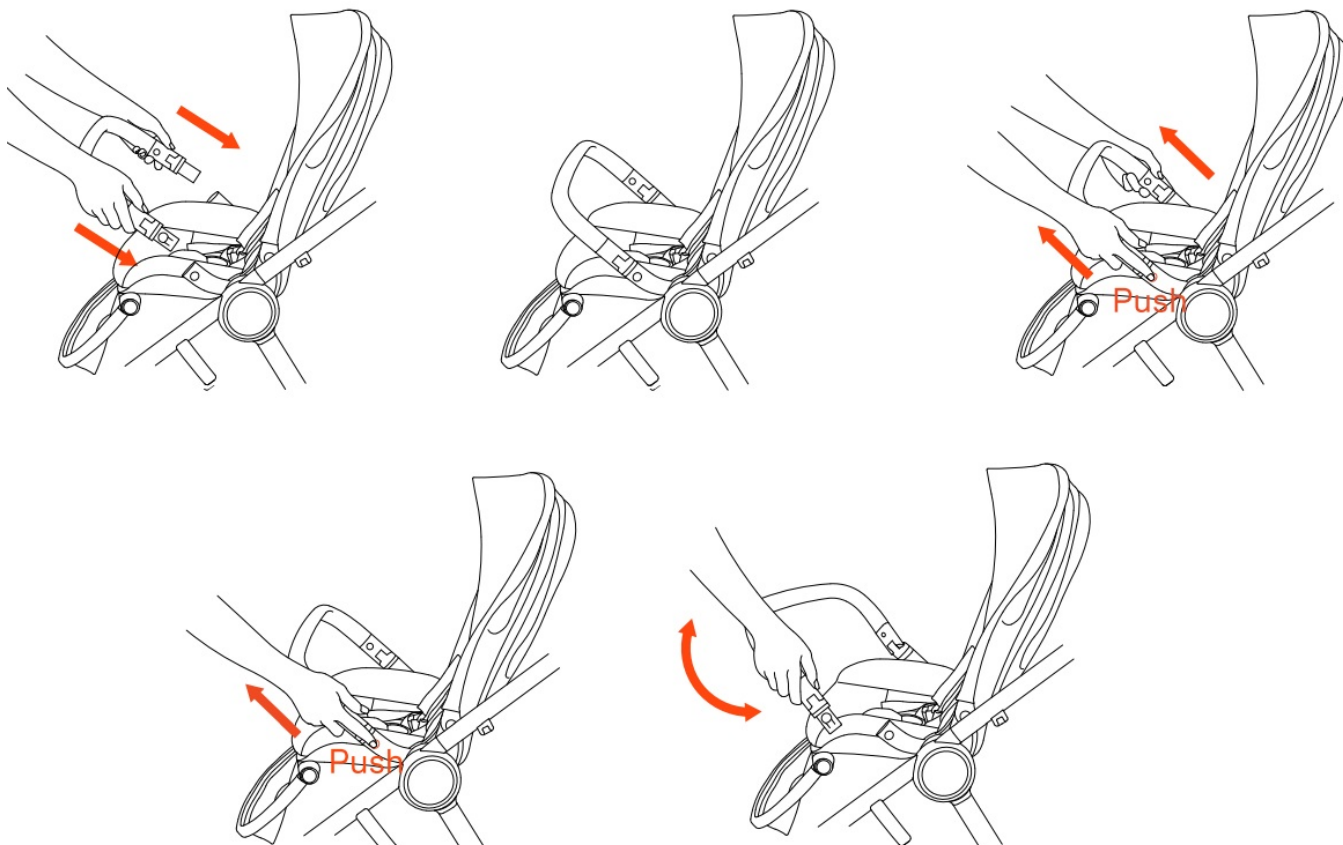

Safety belts buckle

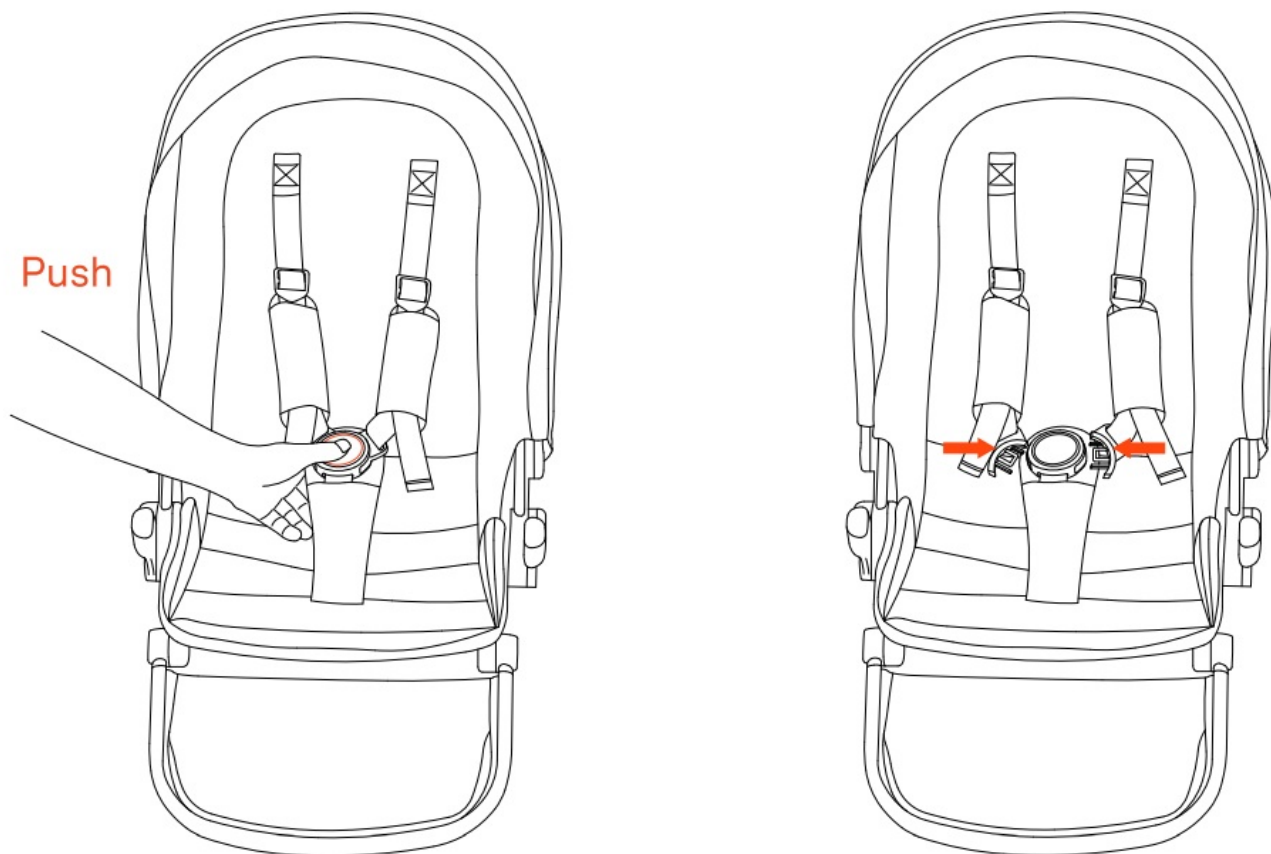

Safety belts adjustment

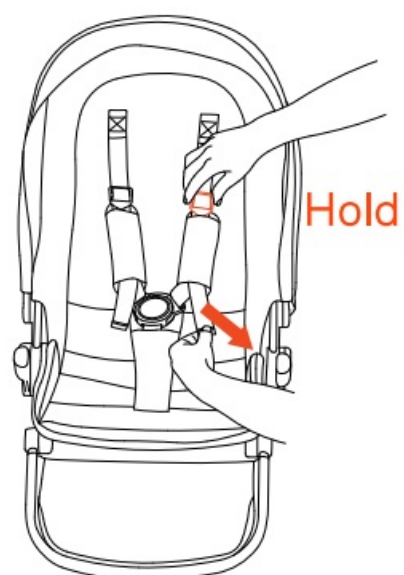
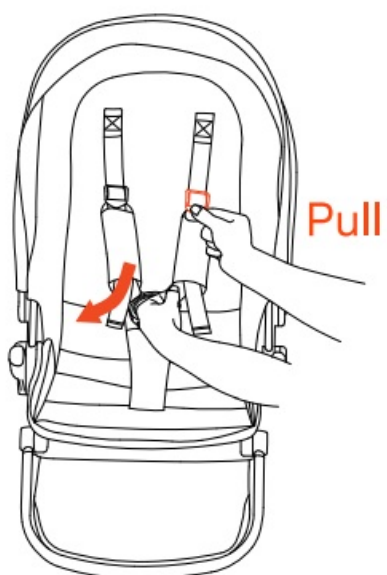
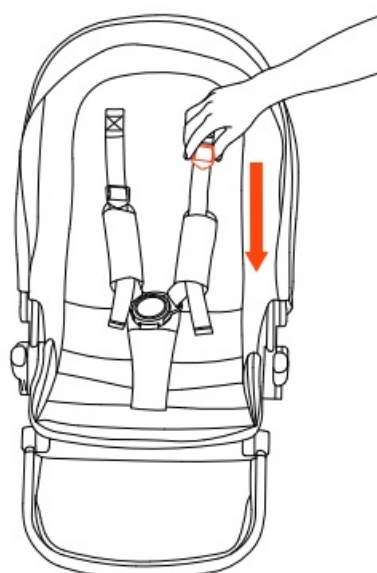
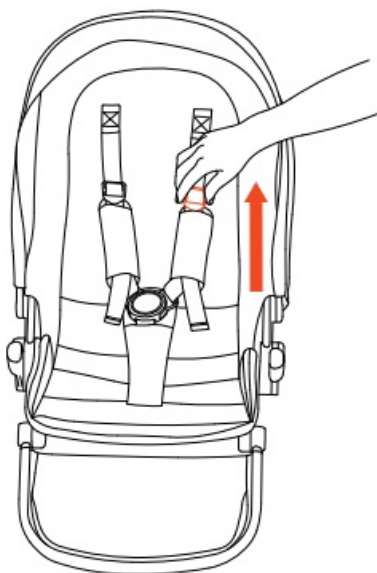

Seat unit's cleaning

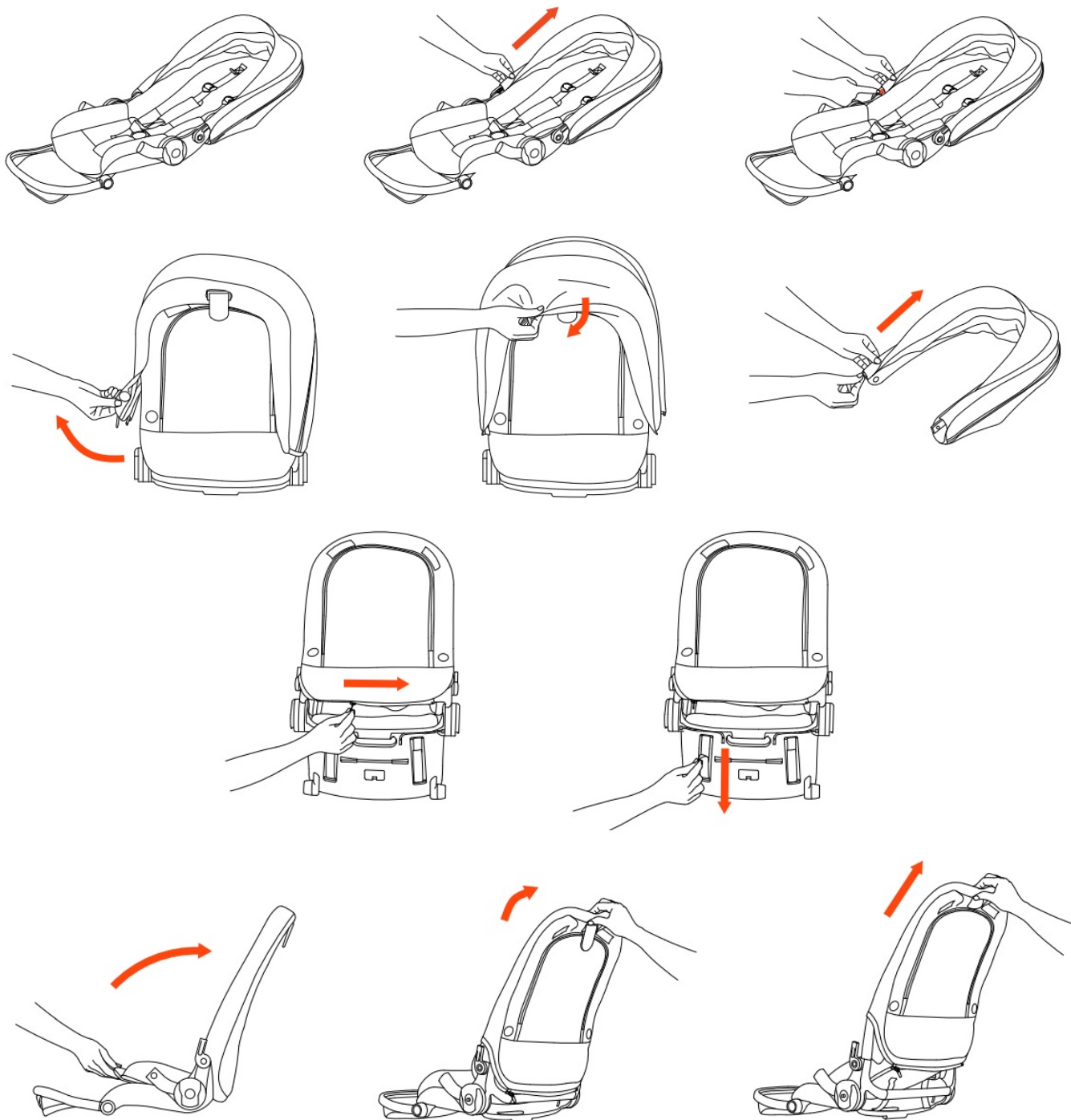

Buggy

Softgoods assembling

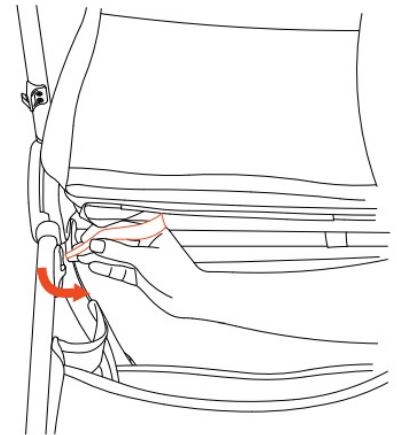
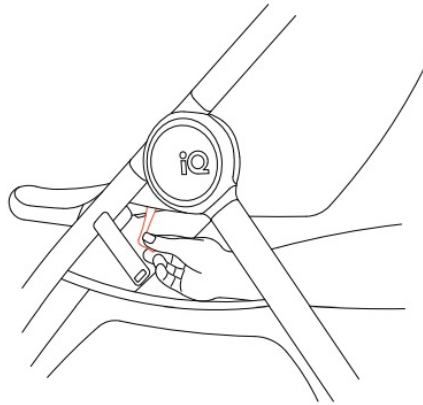
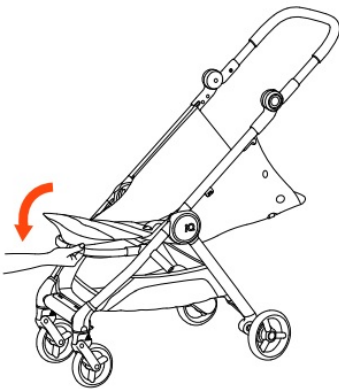
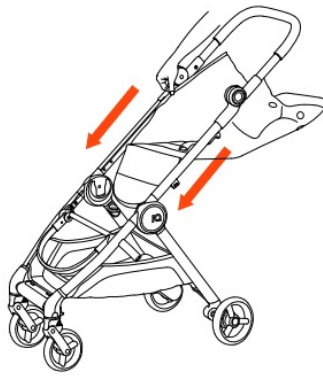
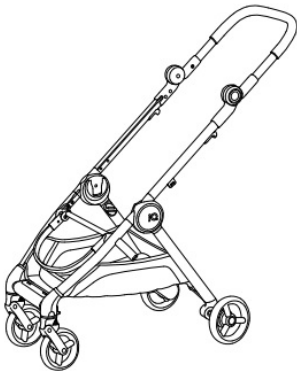

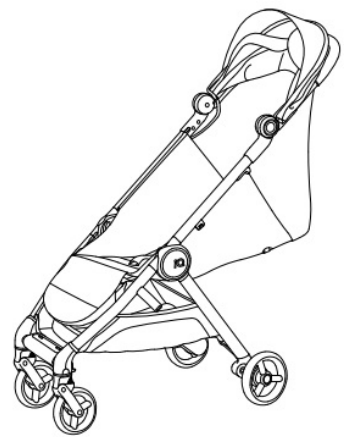
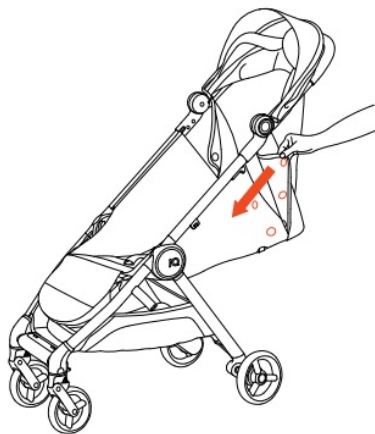
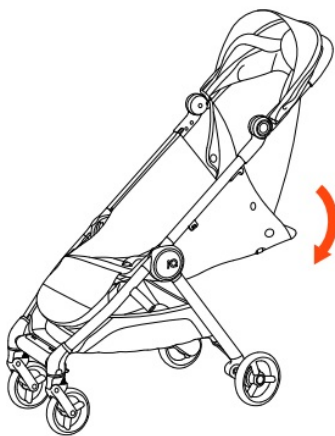
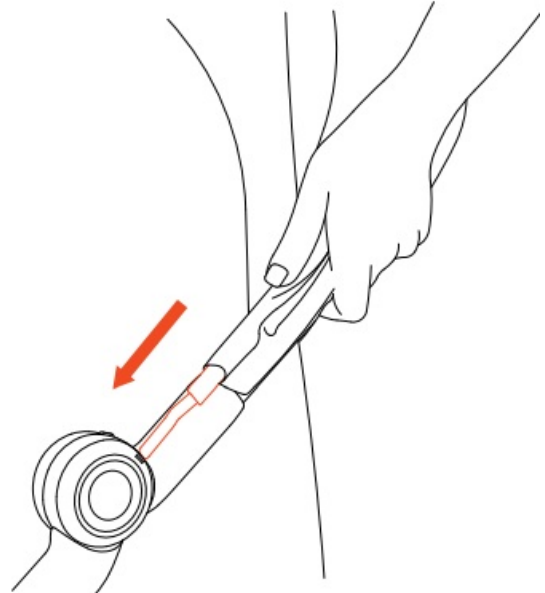
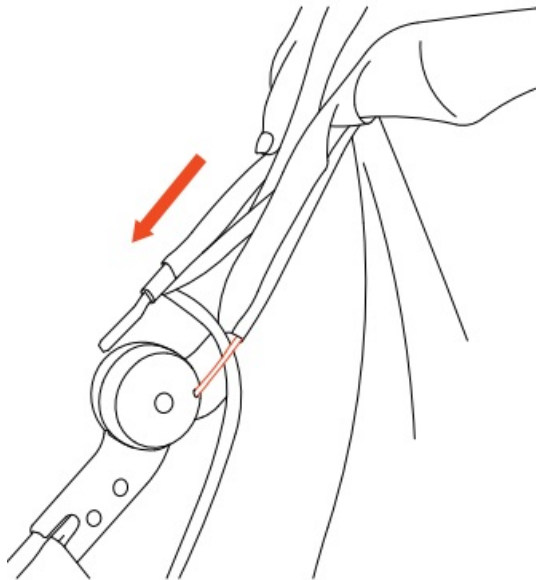
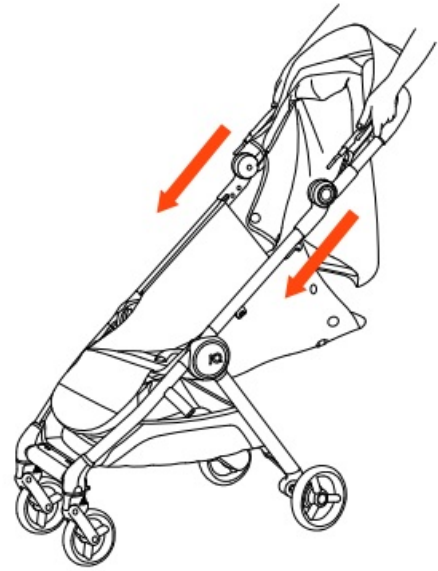
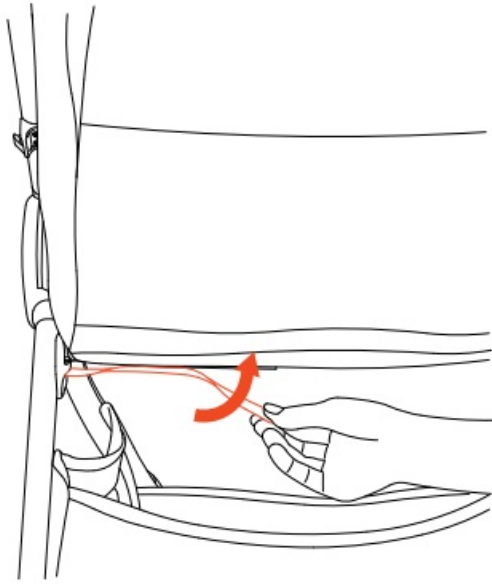

Buggy's hood adjustment

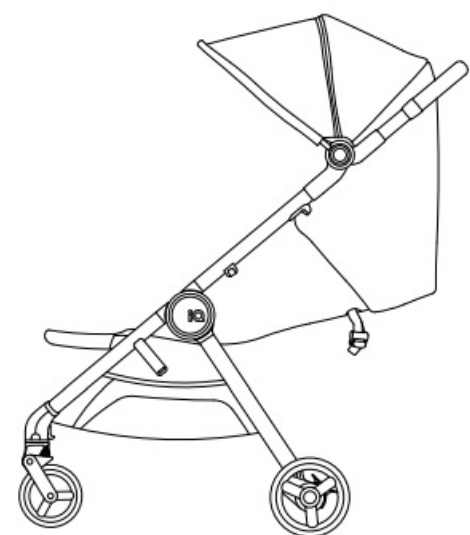
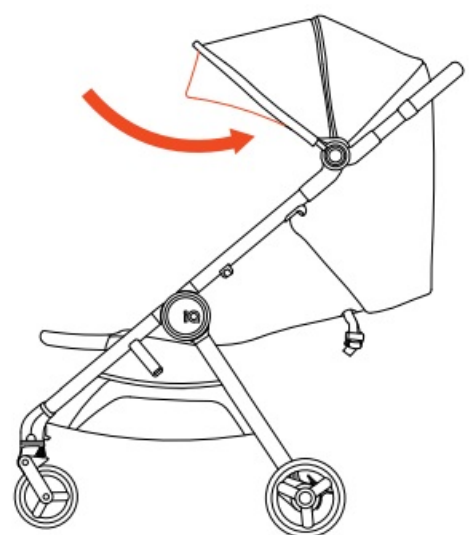
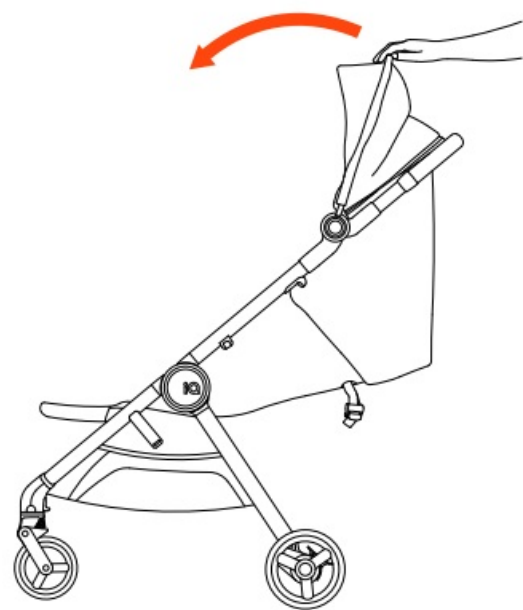
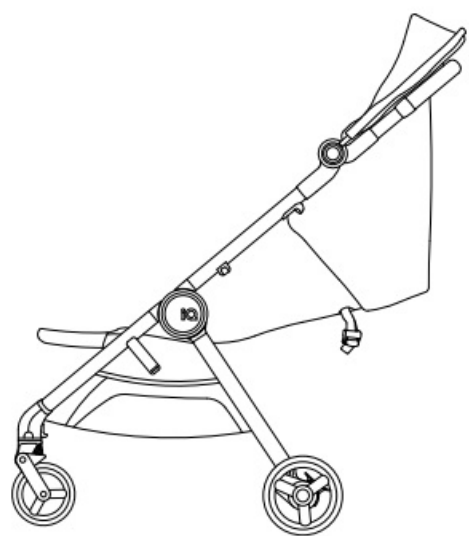

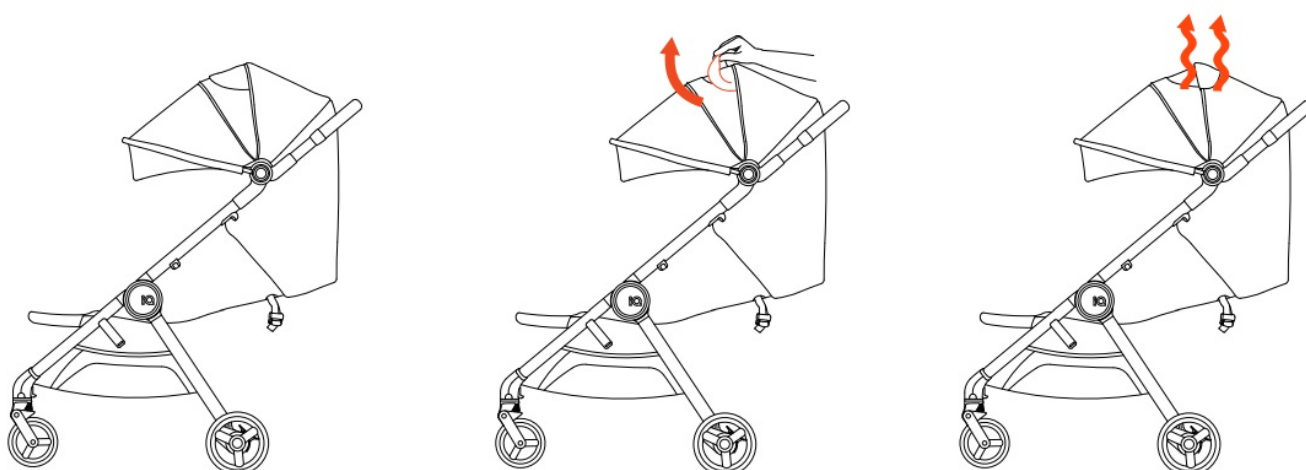
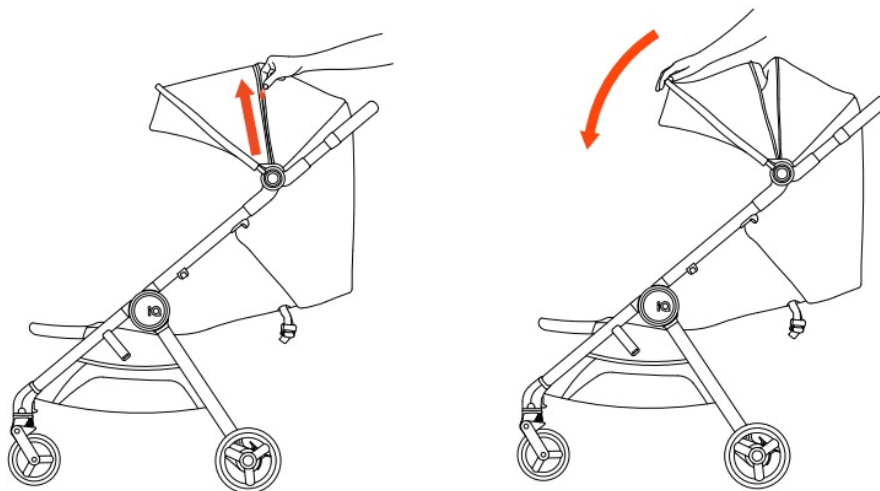

Ventilation of the buggy's backrest



Buggy's backrest adjustment

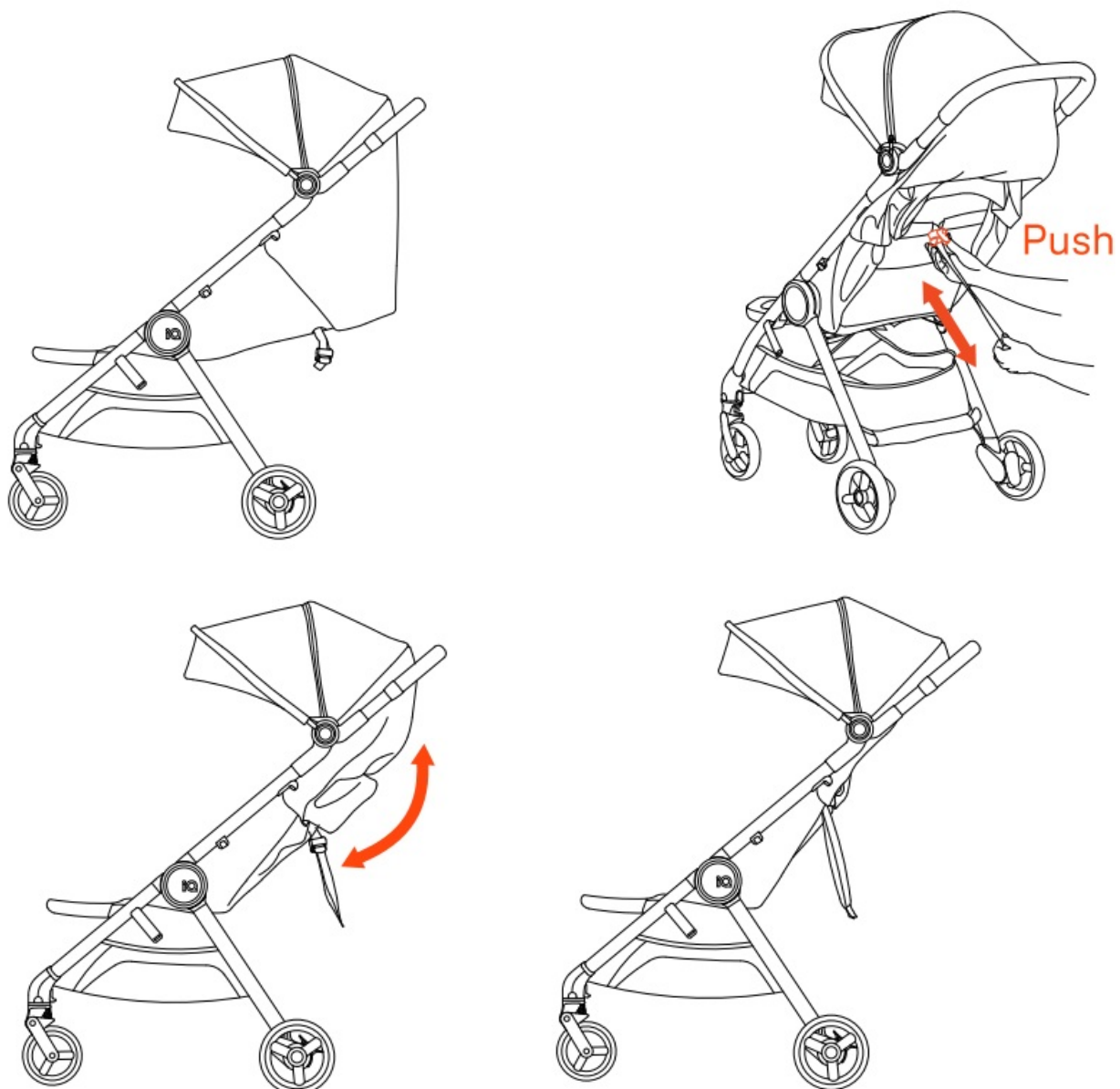

Buggy security barrier

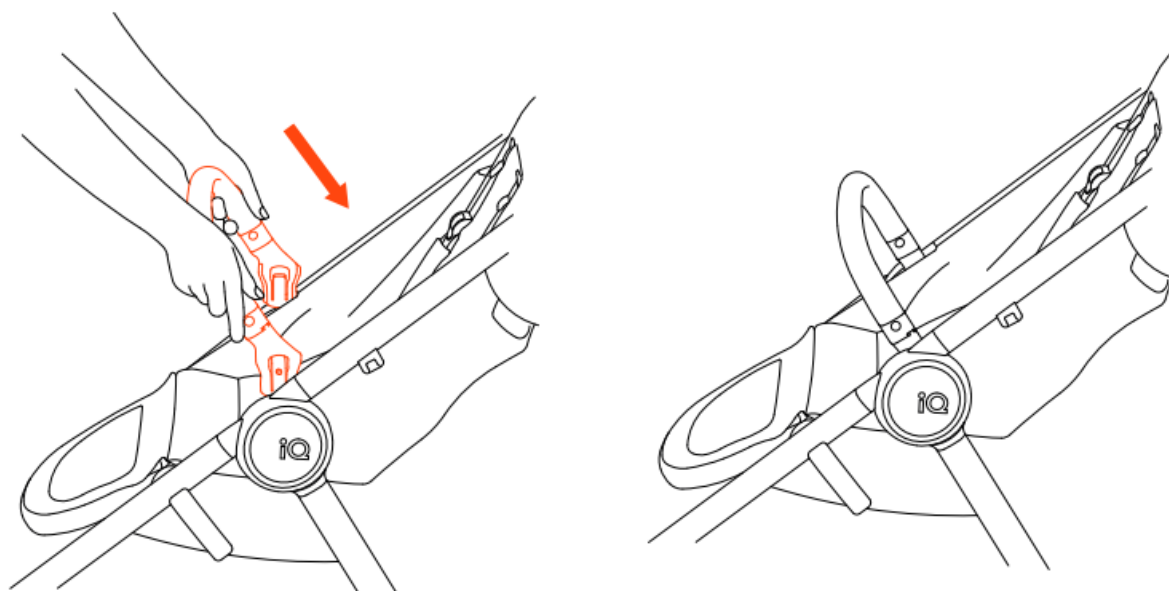

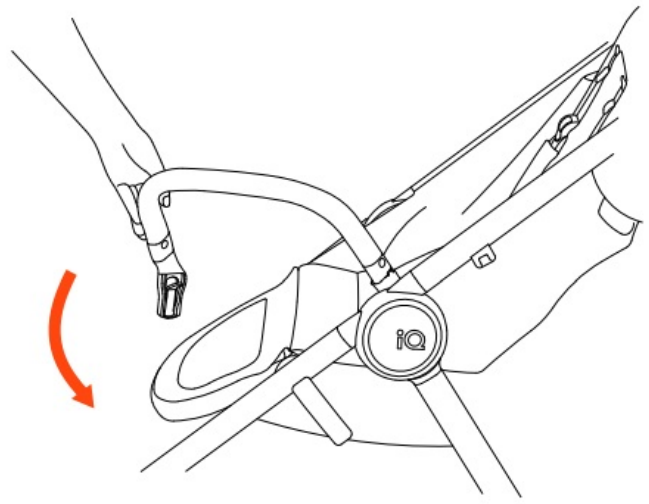
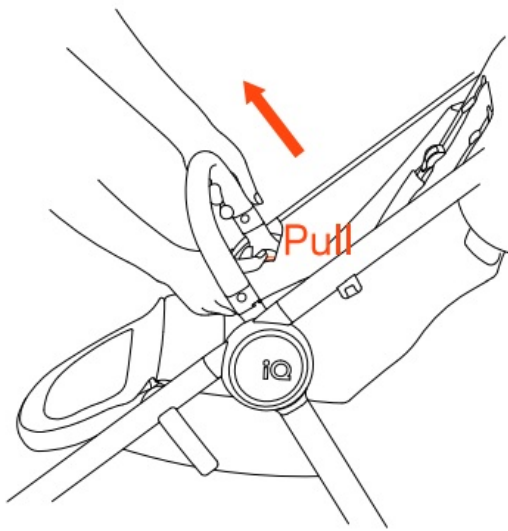

Leg rest adjustment

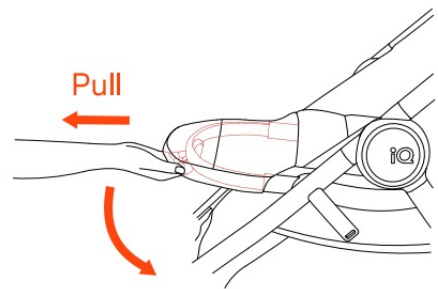
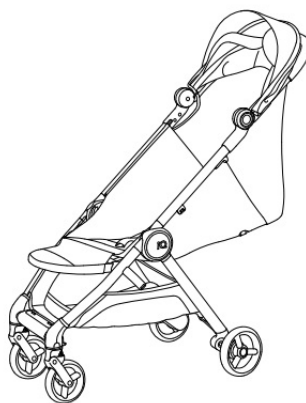
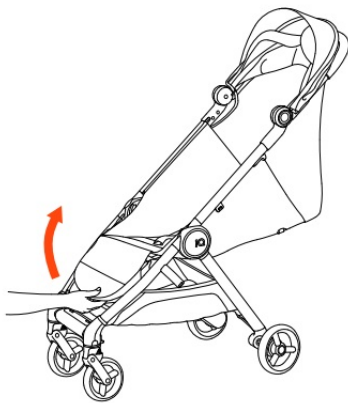

Safety belts buckle

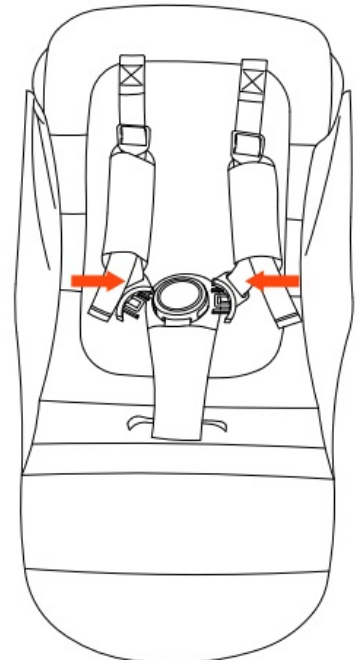
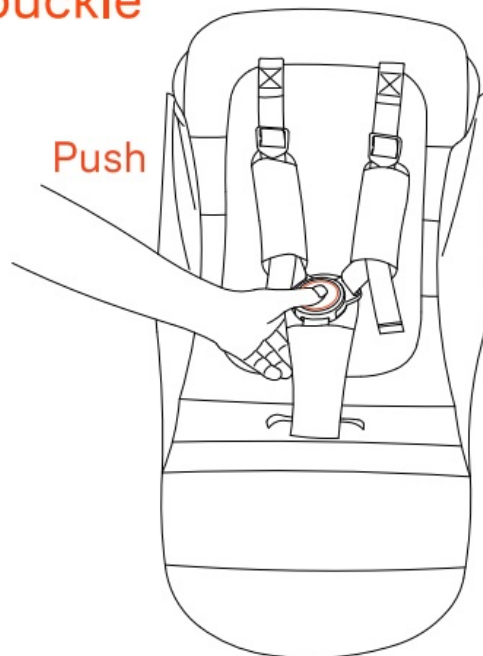

Safety belts adjustment

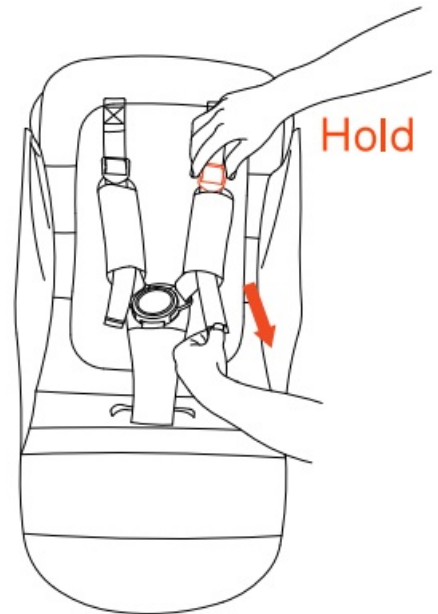
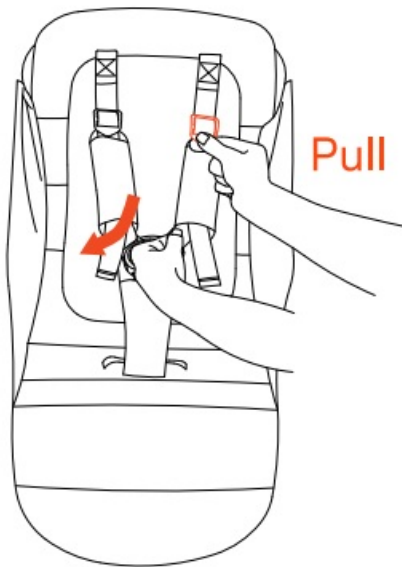
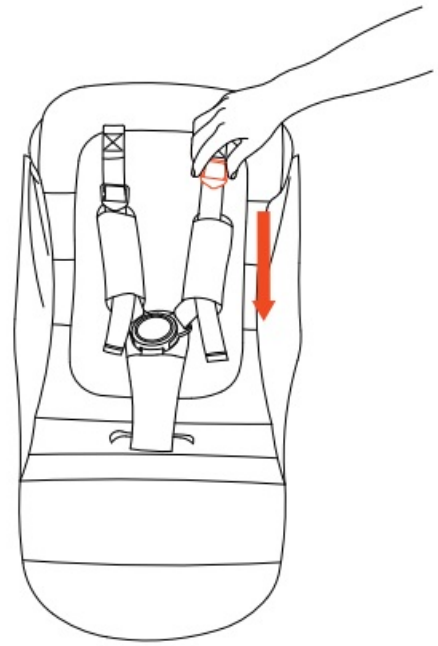
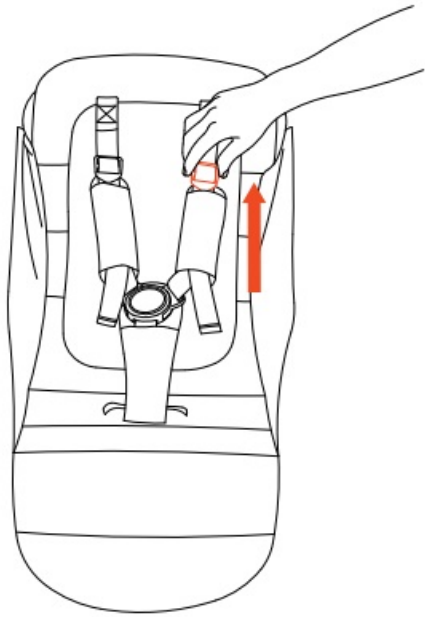

Folding of the frame with buggy

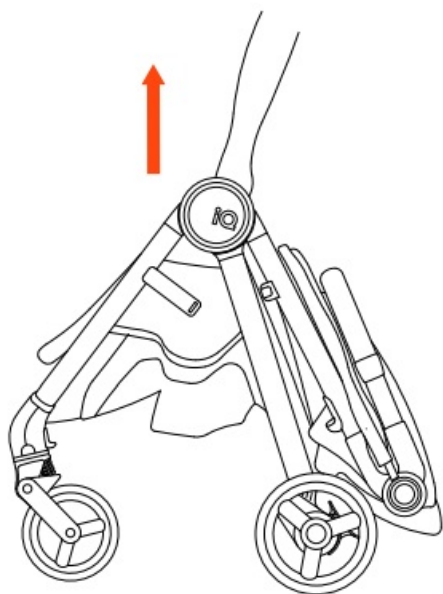
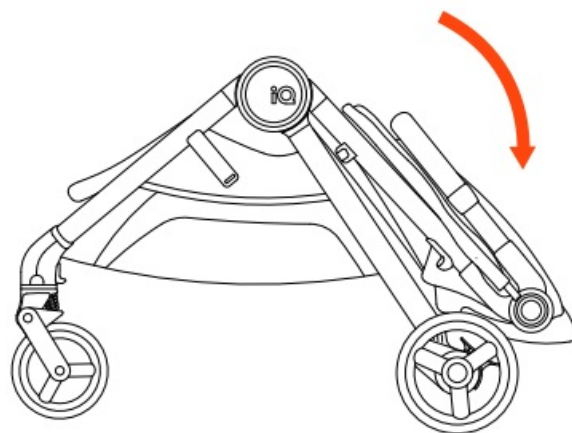
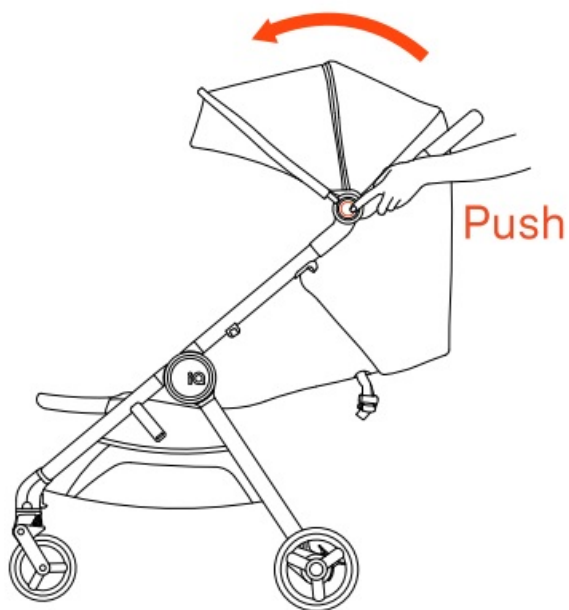

Accessories

Raincover for carrycot/seat unit

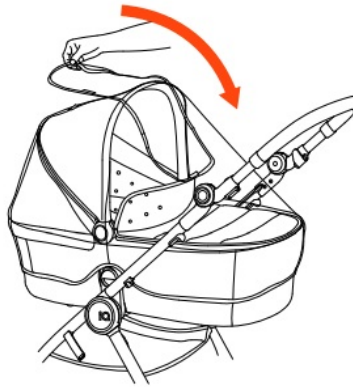
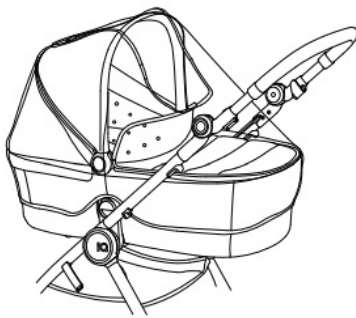
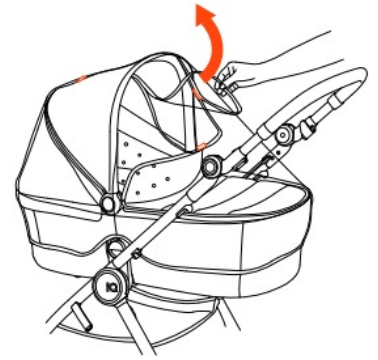
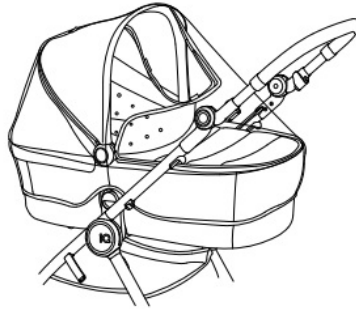
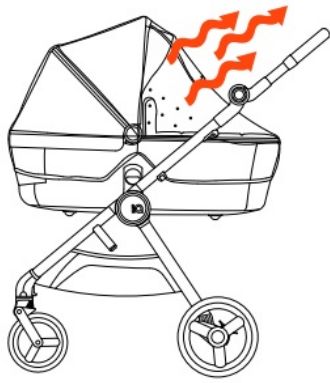



Check for the most recent manuals on our website: anexbaby.com

The information is subject to change without notice. Anex shall not be liable for technical errors or omissions contained in this manual. The purchased product may differ from the product as described in this manual.

AVALEX PTE. LTD.

114 Lavender Street, #08-58/59

CT Hub 2, Singapore 338729

+65 6221 5096

office@anexbaby.com

Documents / Resources



[anex IQ Basic NT 2 in 1 Pram Plus Lightweight Buggy](#) [pdf] User Manual
 IQ Basic NT 2 in 1 Pram Plus Lightweight Buggy, IQ Basic NT, 2 in 1 Pram Plus Lightweight Buggy, Pram Plus Lightweight Buggy, Lightweight Buggy, Buggy

References

- [User Manual](#)

[Manuals+](#), [Privacy Policy](#)

This website is an independent publication and is neither affiliated with nor endorsed by any of the trademark owners. The "Bluetooth®" word mark and logos are registered trademarks owned by Bluetooth SIG, Inc. The "Wi-Fi®" word mark and logos are registered trademarks owned by the Wi-Fi Alliance. Any use of these marks on this website does not imply any affiliation with or endorsement.