



Andreas Stihl Ag Kg SP94 Advance ProCOM Hearing System User Manual

[Home](#) » [Andreas Stihl Ag Kg](#) » Andreas Stihl Ag Kg SP94 Advance ProCOM Hearing System User Manual 

Contents

- [1 Andreas Stihl Ag Kg SP94 Advance ProCOM Hearing System](#)
- [2 ADVANCE ProCOM Manual](#)
- [3 Charging](#)
- [4 Music Operation](#)
- [5 Troubleshooting](#)
- [6 Certification and Safety Approvals FCC Compliance Statement](#)
- [7 Documents / Resources](#)
- [8 Related Posts](#)

STIHL
ProCOM

Andreas Stihl Ag Kg SP94 Advance ProCOM Hearing System



ADVANCE ProCOM Manual

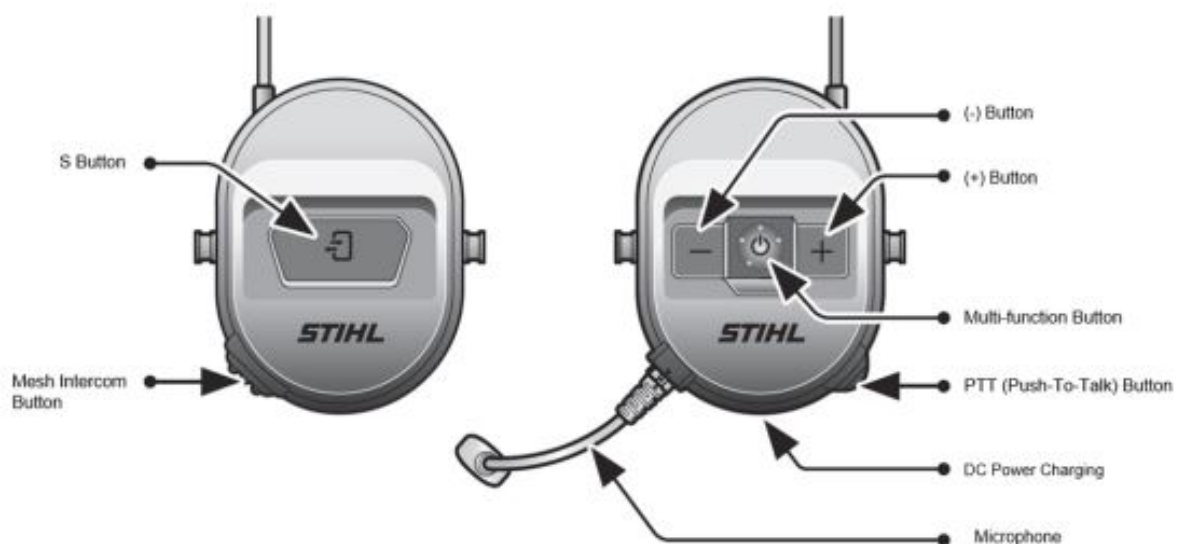

Charging

Orange LED : Charging

Green LED: Fully charged

- **Power On/ Off** : Press and hold the (+) Button and Center Button for 1 second Tap the (+) Button and Center Button.
Volume Adjustment (+) Button – Increase the volume (-) Button – Decrease the volume
- **Battery Check** When the headset power on Blinking in green = High, 70-100%. You will hear the voice notification, “Battery level is high”.
Blinking slowly in yellow = Medium, 30-70%. You will hear the voice notification, “Battery level is medium”.
• Blinking fast in red = Low, 0-30%. You will hear the voice notification, “Battery level is low”.

Music Operation

Play or pause music: Tap the Multi-function Button. Track forward: Tap the Multi-function Button twice.

Mobile Phone Call Making and Answering

Mobile Phone Call Making and Answering

Mesh Intercom

When switching on the headset, the Mesh intercom is automatically activated.

Radio On/ Off

Turn on the FM radio: Press the (+) Button for 2 second. Turn off the FM radio: Press the (+) Button for 2 second.

Radio Seek Stations

Seek up stations: Double tap the Multi-function Button.

Troubleshooting

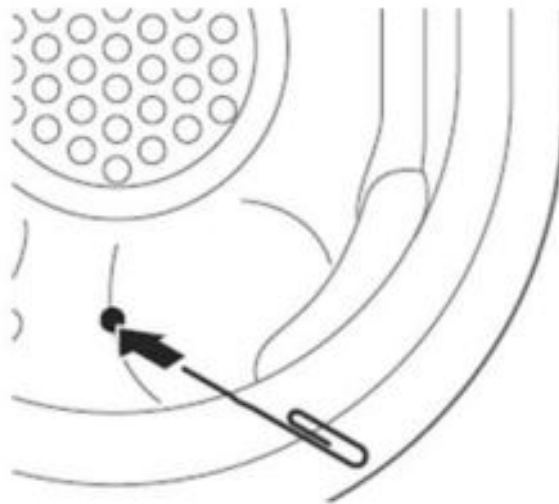

15.1 Fault Reset when the headset is not working properly, you can easily reset the unit:

1. Remove the ear cushion of the right earmuff by sliding your fingers under the inner edge of the ear cushion and firmly pulling it straight out.
2. Remove the sponge.
3. Locate the pinhole reset button inside the right ear cup.
4. Gently insert a paperclip into the hole and tap the Fault Reset Button with light pressure.
5. The headset will shut down.

Certification and Safety Approvals FCC Compliance Statement

This device complies with part 15 of the FCC rules. Operation is subject to the following two conditions:

1. This device may not cause harmful interference, and
2. This device must accept any interference received, including interference that may cause undesired operation.

3. Increase the separation between the equipment and the receiver
4. Connect the equipment into an outlet on a circuit different from that to which the receiver is connected.
5. Consult the dealer or an experienced radio/TV technician for help.

This equipment complies with FCC radiation exposure limits set forth for an uncontrolled environment. End users must follow the specific operating instructions for satisfying RF exposure compliance. The antenna used for this transmitter must not transmit simultaneously with any other antenna or transmitter, except in accordance with FCC multi-transmitter product procedures.

When equipped, the distance between antenna and one's head surface is 31.2mm.

Any changes or modifications to the equipment not expressly approved by the party responsible for compliance could void user's authority to operate the equipment.

Documents / Resources

