

**ANBERNIC**

RG40XXV Retro  
Game Console



# Anbernic RG40XXV Retro Game Console Instruction Manual

[Home](#) » [ANBERNIC](#) » Anbernic RG40XXV Retro Game Console Instruction Manual 

## Contents

- [1 Anbernic RG40XXV Retro Game Console](#)
- [2 Main interface operation](#)
- [3 Game Buttons and Ports](#)
- [4 Common Settings](#)
- [5 Game Settings](#)
- [6 RA Emulator Shortcuts](#)
- [7 Online Play](#)
- [8 Documents / Resources](#)
  - [8.1 References](#)

**ANBERNIC**

**Anbernic RG40XXV Retro Game Console**



## Main interface operation

### Main Interface Menu



#### 1. Game Rooms

After entering, you can choose “Internal Card” or “External Card”.

And select the game platform to play the game.

#### 2. RA Game

After entering, you can choose “Internal Card” or “External Card”.

And select the game platform to play the game.

#### 3. App Center

Including video player, music player, e-book, file manager, expert mode.

#### 4. Favorites

Press the START button in the game center to collect the game, and the game will appear in this section.

#### 5. History

The run game will appear in this section. History can be cleared in settings.

#### 6. Search

Quickly search games from memory cards. The X key deletes the keyword and the Y key confirms the search result.

## 7. Settings

Contains all settings for the RG 40XXV. Including language settings, backlight settings, background settings, etc.

### Game Buttons and Ports

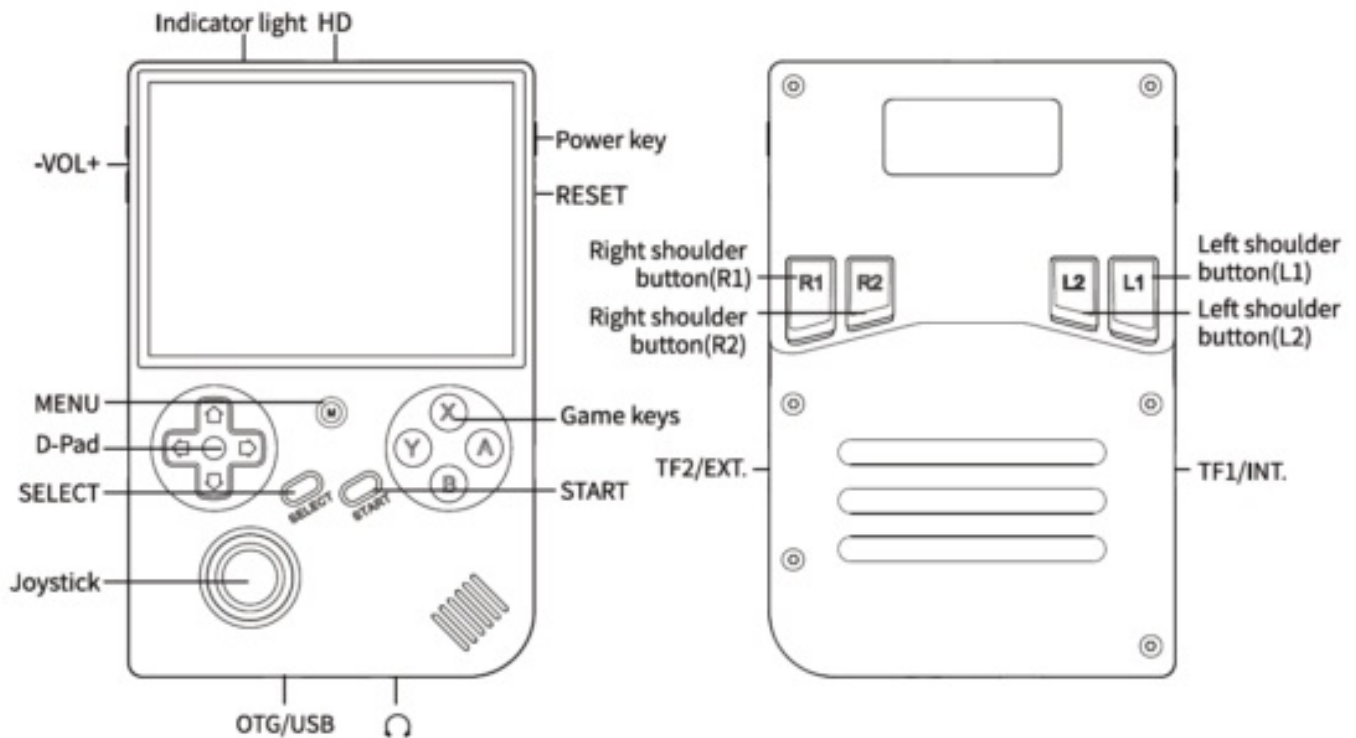

### Game Imports

Insert a FAT32 formatted memory card into the external card slot of the game console, and a new folder for each platform will be created. Just put the game in the folder and select the game in the game rooms.

Supported platforms are: ported games, PSP, PSI, SS, DC, NDS, N64, ARCADE, GBA, GBC, GB, SFC, FC, MAME, MD, GG, PCE, NGPC, SMS, WSC

### Common Settings

- **Language Settings**

Select Settings-> Language Settings in the main interface.

Available languages are: Chinese, English, Japanese, Korean, Russian, French, German, Spanish, Portuguese

- **Backlight Brightness**

Select Settings-> Backlight Brightness in the main interface.

There are 5 levels of backlight brightness.

- **Backlight Time**

Select Settings-> Backlight Time in the main interface.

There are 1 minutes, 2 minutes, 5 minutes, 10 minutes, and always on.

The screen backlight will be turned off after the set time has elapsed.

- **Key Customization**

Button Custom: Select Settings-> Button Custom in the main interface. You can customize the button mapping of the body buttons or the gamepad.

- **Joystick light**

16 million color RGB joystick lighting, support constant light, breath, rainbow, marquee, chasing, gaming and other light effects, support customize the color and adjust the brightness.

## Game Settings

- **Game quality**

divided into high-definition, scan line, fast, dot matrix. Different options will present different screen filter display effects.

- **Game streaming**

First, make sure that the game console and the computer are under the same WIFI. Select Settings-> Moonlight in the main interface.

Enter the IP address of the computer to start pairing. Enter the PIN code to pair successfully and select Connect. During streaming, press menu+START to exit streaming.

- **Bluetooth Settings**

First, select Settings->Bluetooth Settings in the main interface, select Enable Bluetooth, and press the X key to scan for devices in the Search device. Finally, select the controller you want to connect according to the device name.

## Indicator light and charging function

The machine packaging matches SV/1.SA four-line charging data cable. Plug in the charging cable and the machine will start charging.

The status of the device indicators is as follows: Red light on when charging, Green light on when fully charged, Red light twinkling when battery is low.

●Green light	Working
●Red light	Low power
●Yellow light	Charging

## RA Emulator Shortcuts

Menu	Menu
Menu+R2	Fast Forward
Menu+L2	Slow Motion
Menu+RI	Save State
Menu+LI	Load State
Menu+Y	Display Frame Rate
Menu+B	Screenshot
Menu+X	Pause
Menu+START	Quit
Menu+-VOL+	Adjust Brightness
Menu+Left/Right Direction	Select Save State Slot

## Online Play

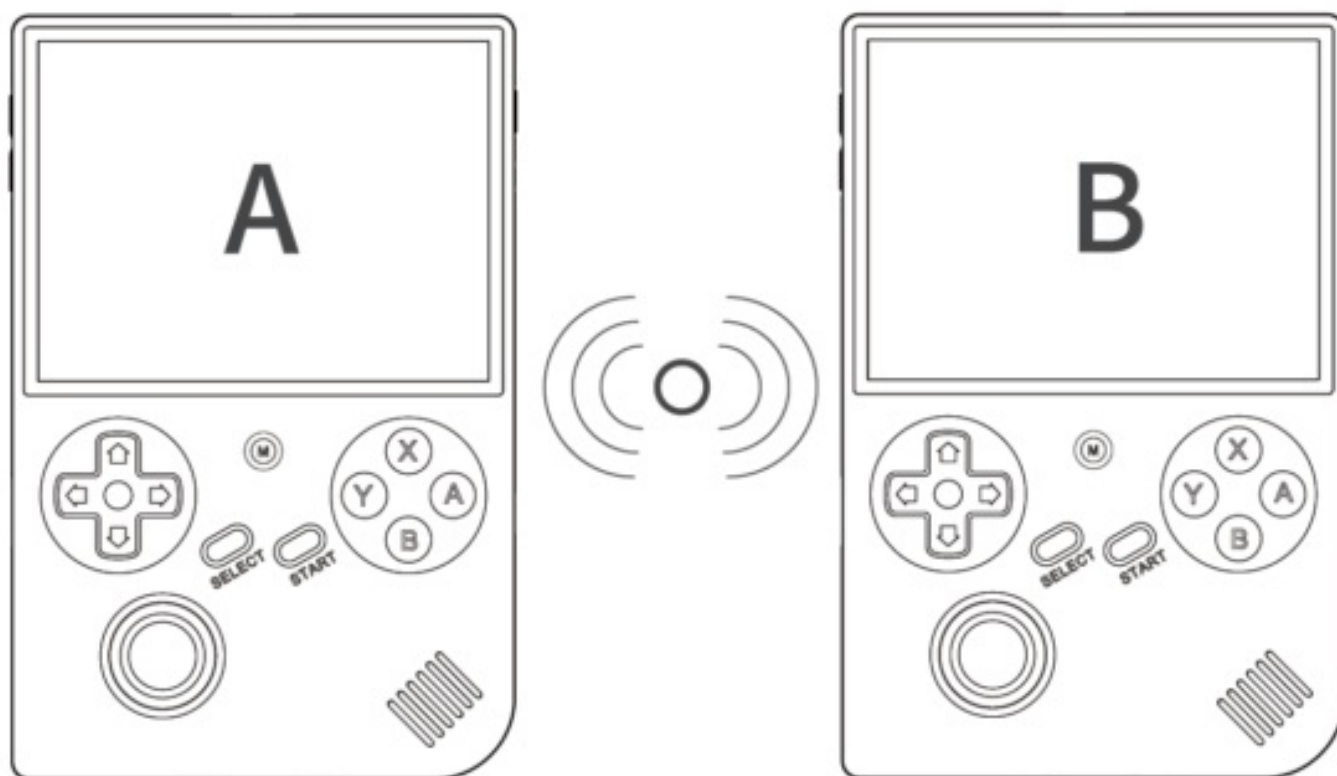

- First, make sure the two consoles are on the same WIFI.
- Note down the IP addresses of the two consoles by going to NETWORK SETTINGS ->IP ADDRESS.  
In the RetroArch, enter the same game and call out the menu through the menu.
- **Set it up with the following steps:**
  - Game console A (host)
    - Select Netplay->Host->Start Netplay Host
- Game console B (slave)

- Select Netplay->Connect to Netplay Host, enter the IP address and press the START button to connect successfully.

<https://win.anbernic.com>

## Documents / Resources

	<p><a href="#">Anbernic RG40XXV Retro Game Console</a> [pdf] Instruction Manual RG40XXV Retro Game Console, RG40XXV, Retro Game Console, Game Console, Console</p>
---	--

## References

- [User Manual](#)

### Manuals+ Privacy Policy

This website is an independent publication and is neither affiliated with nor endorsed by any of the trademark owners. The "Bluetooth®" word mark and logos are registered trademarks owned by Bluetooth SIG, Inc. The "Wi-Fi®" word mark and logos are registered trademarks owned by the Wi-Fi Alliance. Any use of these marks on this website does not imply any affiliation with or endorsement.