



AMYLOIOR Bluetooth Pairing R-Net Advanced Joystick and OMNI 2 User Guide

[Home](#) » [AMYLOIOR](#) » AMYLOIOR Bluetooth Pairing R-Net Advanced Joystick and OMNI 2 User Guide 



Bluetooth Pairing Quick Start Guide R-Net Advanced Joystick and OMNI 2



User Guide

Contents

- 1 [Bluetooth Pairing R-Net Advanced Joystick and OMNI 2](#)
- 2 [Documents / Resources](#)
 - 2.1 [References](#)
- 3 [Related Posts](#)

Bluetooth Pairing R-Net Advanced Joystick and OMNI 2

Steps for pairing either the Advance Joystick or the OMNI 2 with any devices (Android, Apple or PC) :

TURN ON THE BLUETOOTH MODE ON THE JOYSTICK/OMNI 2:



- In the settings menu, select Bluetooth. (To enter the settings menu, press and hold top button: on the left of the screen for the joystick; and on the right of the screen for the OMNI 2).
- Set target device(s) to < On >. ("Mouse" for Android or PC and "iDevice" for Apple products)
- The joystick/OMNI 2 must be switched off and on again.

SET THE JOYSTICK OR OMNI 2 IN DISCOVERY MODE:



- On the joystick/OMNI 2, navigate to the Bluetooth mode by pressing the < mode > button.
- For the joystick: Toggle forward and hold until a beep is heard (about 10 seconds). Then, toggle backward and hold until a beep is heard (about 10 seconds).
- For the OMNI 2: Press the top arrow on the push-button and hold until a beep is heard (about 10 seconds). Then, press the bottom arrow on the push-button and hold until a beep is heard (about 10 seconds).
- The Bluetooth symbol should blink on the top of the screen.
This means that the joystick/OMNI 2 is in discovery mode.

THE DEVICE CAN NOW BE PAIRED WITH THE JOYSTICK OR THE OMNI 2...

For more information on how to pair a device with either the joystick or the OMNI 2, or on the Bluetooth functionality, please refer to the Curtiss-Wright document (Chapter 6) on our website at www.amylior.com.



Phone: +1 450 424-0288

Fax: +1 450 424-7211

info@amysystems.com

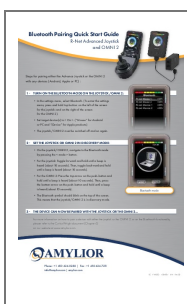

amysystems.com

Documents / Resources



[AMYLIOR Bluetooth Pairing R-Net Advanced Joystick and OMNI 2](#) [pdf] User Guide
Bluetooth Pairing R-Net Advanced Joystick and OMNI 2, Bluetooth Pairing Joystick, R-Net Advanced Joystick, Joystick, OMNI 2, OMNI 2 Joystick

References

-  [Lightweight Power Wheelchairs | ALLTRACK | AMYLOR](#)
-  [Lightweight Power Wheelchairs | ALLTRACK | AMYLOR](#)

Manuals+.