



USER MANUAL

(Part Name : ASUNBM00

Derivated model : ASUNBM01, ASUNBM02, ASUNBM03)

Contents [[hide](#)]

- [1 Description](#)
- [2 Functional Block diagram](#)
- [3 Specification](#)
- [4 Dimension](#)
- [5 FCC warning](#)
- [6 Documents / Resources](#)
 - [6.1 References](#)

Description

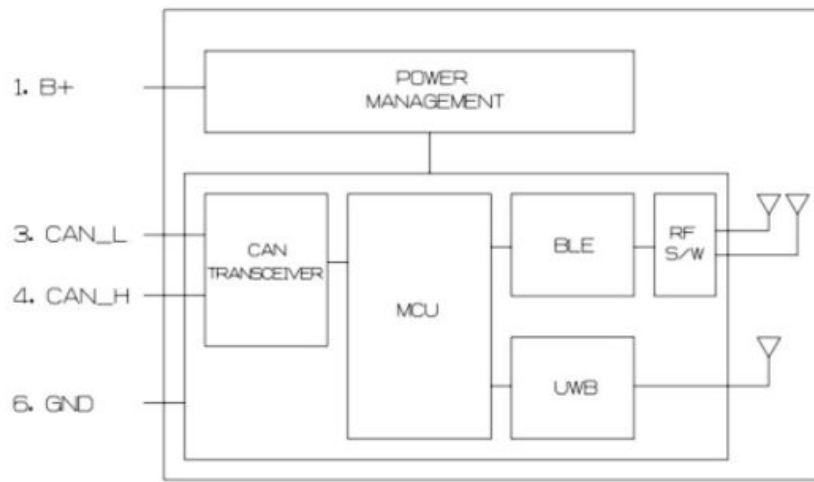

Specification

Rated voltage	DC 12V
Operating Voltage	DC 9V~16V
Operating Temp.	-40°C ~ 95°C
Storage Temp.	-40°C ~ 95°C
Idle Current	2.0mA Max
RF Range	2402 ~ 2480Mhz, 6489.6~7987.2MHz

Dimension

1. ASUNBM00/ASUNBM01

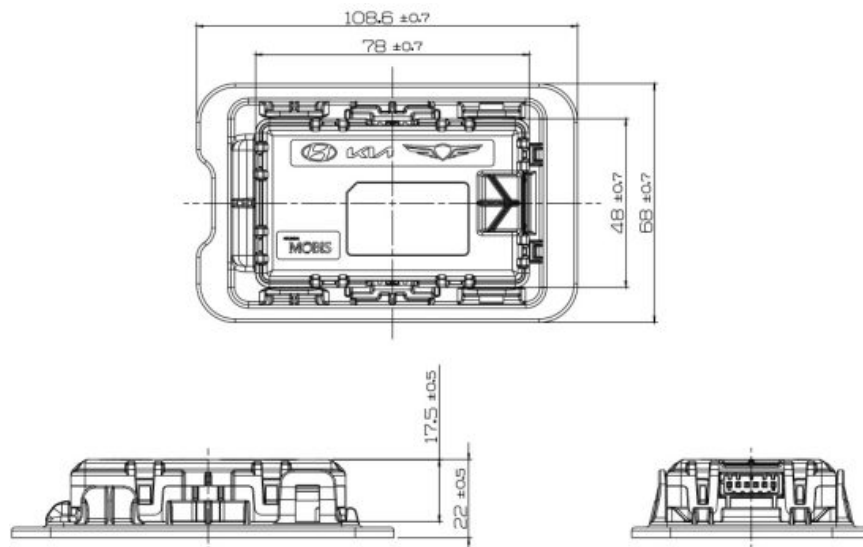

2. ASUNBM02

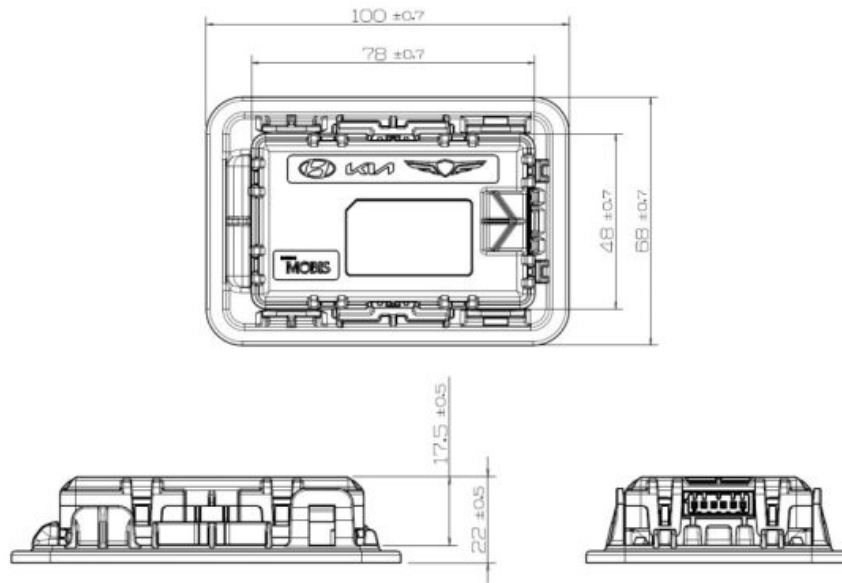

3. ASUNBM03

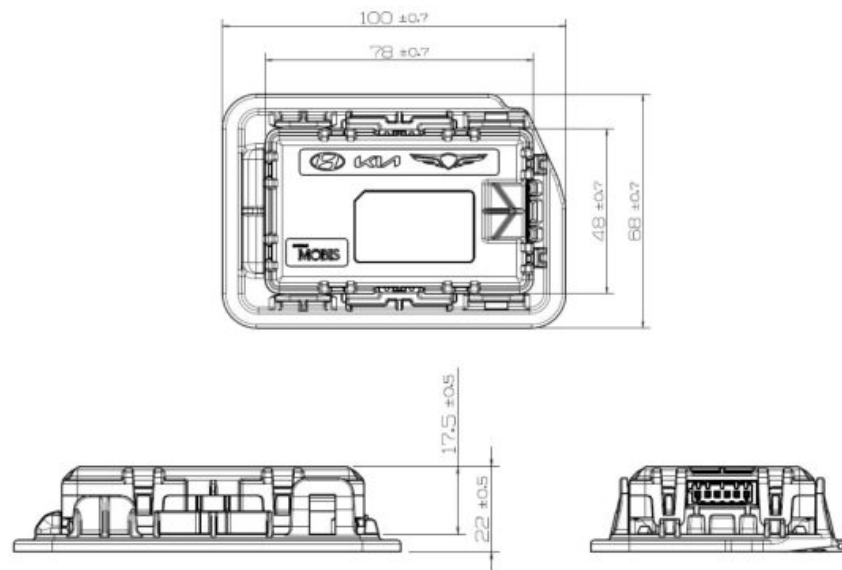

4. PIN MAP

* All products common.

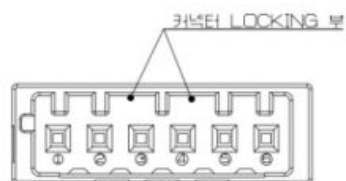

NO.	PIN NAME
1	B+
2	—
3	CAN_L
4	CAN_H
5	—
6	GND

5. Label information

LABEL

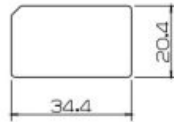

ISOMETRIC VIEW



1) **UNIT ASSY – UWB&BLE MASTER** (Pb)

0000

2) **955E0N1000**



3) ASUNBM00

4) GN7/A.00/1.07

5) 230101M000000001

KC : R-R-Amo-ASUNBM00

FCC ID : 2AS9T-ASUNBM

IC : 27298-ASUNBM

CMIIT ID : 2023DJ4056



E9 10R-06 23604

6) 011-23XXXX

HYUNDAI MOBIS

7) AMOSENSE CO.,LTD.

8) MADE IN VIETNAM

1) **UNIT ASSY – UWB&BLE SLAVE** (Pb)

0000

2) **955F0N1000**



3) ASUNBM01

4) GN7/A.00/1.07

5) 230101M000000001

KC : R-R-Amo-ASUNBM00

FCC ID : 2AS9T-ASUNBM

IC : 27298-ASUNBM

CMIIT ID : 2023DJ4864



E9 10R-06 23604

6) 011-23XXXX

HYUNDAI MOBIS

7) AMOSENSE CO.,LTD.

8) MADE IN VIETNAM

ISOMETRIC VIEW

LABEL

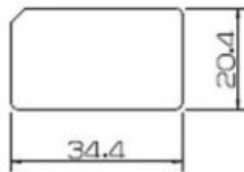

1) **UNIT ASSY – UWB&BLE MASTER** (Pb)

0000

2) **955E0L1600**



3) ASUNBM02

4) DN8FL/1.00/1.00

5) 230101M000000001

KC :

FCC ID :

IC :

CMIIT ID :

E9 XXX-XX XXXXX

6) XXX-XXXXXX

HYUNDAI MOBIS

7) AMOSENSE CO.,LTD.

8) MADE IN VIETNAM



1. Part Name

2 – Customer Part Number

3 – Model name

4 – Customer information

5 – Date of manufacture + serial number

6 – Certification Number

7 – Manufacture

8 – Origin

6. Installation Guide

This product is installed in the headlining position of the car if the user chooses the digital key option when purchasing the vehicle.

FCC warning

This equipment has been tested and found to comply with the limits for a Class B digital device, pursuant to part 15 of the FCC Rules. These limits are designed to provide reasonable protection against harmful interference in a residential installation.

This equipment generates, uses and can radiate radio frequency energy and, if not installed and used in accordance with the instructions, may cause harmful interference to radio communications. However, there is no guarantee that interference will not occur

in a particular installation. If this equipment does cause harmful interference to radio or television reception, which can be determined by turning the equipment off and on, the user is encouraged to try to correct the interference by one or more of the following measures:

- Reorient or relocate the receiving antenna.
- Increase the separation between the equipment and receiver.
- Connect the equipment into an outlet on a circuit different from that to which the receiver is connected.
- Consult the dealer or an experienced radio/TV technician for help

Caution: Any changes or modifications to this device not explicitly approved by manufacturer could void your authority to operate this equipment.

This device complies with part 15 of the FCC Rules. Operation is subject to the following two conditions:

(1) This device may not cause harmful interference, and (2) this device must accept any interference received, including interference that may cause undesired operation.

This equipment complies with FCC radiation exposure limits set forth for an uncontrolled environment.

This equipment should be installed and operated with minimum 20 cm between the radiator and your body.

This transmitter must not be collocated or operating in conjunction with any other antenna or transmitter unless authorized to do so by the FCC.

IC Warning

This device complies with Industry Canada license-exempt RSS standard(s). Operation is subject to the following two conditions : (1) This device may not cause interference; and (2) This device must accept any interference, including interference that may cause undesired operation of the device.

Documents / Resources

USER MANUAL
(Part Name: ASUNBM00)
(Serial Name: ASUNBM00, ASUNBM01, ASUNBM02, ASUNBM03)

CONTENTS

1. Introduction	1
2. General Description	2
3. Specifications	3
4. Installation	4
5. Pre-Install	5
6. LAN Settings	6
7. Initial Setup	7

END OF FILE
© 2017 AMOSENSE

[AMOSENSE ASUNBM0 Series Body Domain Controller \[pdf\]](#) User Manual

ASUNBM00, ASUNBM01, ASUNBM02, ASUNBM03, ASUNBM0 Series Body Domain Controller, ASUNBM0 Series, Body Domain Controller, Domain Controller, Controller

References

- [User Manual](#)

AMOSENSE

AMOSENSE, ASUNBM0 Series, ASUNBM0 Series Body Domain Controller, ASUNBM00, ASUNBM01, ASUNBM02, ASUNBM03, Body Domain Controller, controller, Domain Controller

Leave a comment

Your email address will not be published. Required fields are marked *

Comment *

Name

Email

Website

☐ Save my name, email, and website in this browser for the next time I comment.

Post Comment

Search:

e.g. whirlpool wrf535swhz

Search

[Manuals+](#) | [Upload](#) | [Deep Search](#) | [Privacy Policy](#) | [@manuals.plus](#) | [YouTube](#)

This website is an independent publication and is neither affiliated with nor endorsed by any of the trademark owners. The "Bluetooth®" word mark and logos are registered trademarks owned by Bluetooth SIG, Inc. The "Wi-Fi®" word mark and logos are registered trademarks owned by the Wi-Fi Alliance. Any use of these marks on this website does not imply any affiliation with or endorsement.