



## Contents [ [hide](#) ]

- [1 AMEWI 22701 SC Plus Scale Crawler](#)
- [2 Product Information](#)
- [3 Declaration of conformity](#)
- [4 Safety Instructions](#)
- [5 Connection diagram](#)
- [6 Placement](#)
- [7 The remote control](#)
- [8 Install remote control batteries](#)
- [9 Charging battery](#)
- [10 Gearbox](#)
- [11 Assembly on axles](#)
- [12 Frame](#)
- [13 FAQ](#)
- [14 Documents / Resources](#)
  - [14.1 References](#)

***AMEWI***

**AMEWI 22701 SC Plus Scale Crawler**



## **Specifications**

- Product: Hyper Go SC/SC+ Scale Crawler 1:12
- Versions: 22701 SC (Basic Version), 22702 SC+ (Pro Version)

## **Product Information**

The Hyper Go SC/SC+ Scale Crawler is a remote-controlled model designed for enthusiasts. It comes in two versions, the Basic Version and the Pro Version, offering different features and capabilities.

## **Welcome to AMEWI**

- The Amewi Trade GmbH is an international import- and wholesale company for R/C models, toys and creative items, located in Borcheln near Paderborn, Germany. Our product range includes over 10,000 items. Above all, this includes remote-controlled car, helicopter, boat, and tank models as well as a wide range of accessories and all necessary spare parts. Our sales network includes over 700 specialist dealer and online retailers across Europe.
- When you purchase AMEWI products as an end consumer, you are entering into a contract with the retailer. Please always contact your dealer in warranty cases.

## **Declaration of conformity**

- This product has been manufactured according to actual technical standards. The

product is matching the requirements of the existing European and national guidelines. The Declaration of Conformity has been proofed. AMEWI Trade GmbH declares that this product is matching the basic requirements and remaining regulations of the guideline 2014/53/EU (RED). The declarations and documents are stored at the manufacturer and can be requested and applied there.

<https://amewi.com/Konformitaetserklaerungen> For additional questions to the product and conformity please contact:

- Amewi Trade GmbH Nikolaus-Otto-Str. 18, 33178 Borcheln Germany or website <https://amewi.com>.

## **Safety Instructions**

### **Security and hazard warnings**

- For damage, caused by disregarding of the manual, warranty expires.
- We are not liable for secondary failures, material, or personal damage, caused by in proper usage or disregarding the security notices.
- Based on security and registration (CE) reasons, it is forbidden to modify the product personally. Do not disassemble the product.
- Small parts. Danger of suffocation or risk of injury caused by small parts.
- Suitable for people aged 14+!
- The product is not allowed to get moist or wet. The product is only allowed to be used on flat and clean surfaces. Even a drop down from a small height can cause damage to the product.

### **Battery notice & disposal**

- Batteries / rechargeable batteries do not belong in the hands of children.
- Batteries or rechargeable batteries may only be changed by an adult. Never mix rechargeable batteries with dry batteries. Never mix full batteries with half-empty batteries. Never mix rechargeable batteries of different capacities. Never attempt to charge dry batteries. Ensure correct polarity. Defective rechargeable batteries/batteries must be disposed of properly (hazardous waste). Never carry out the charging process unsupervised. If you have any questions about the charging time, read the operating instructions or contact the manufacturer.

- Read the safety instructions and warnings before using or charging the Li-ion battery.
- Stop using or charging immediately if the battery is leaking, has a temperature of over 70° C or anything else unusual occurs. Always charge and store batteries on a fireproof surface or in a fireproof
- LiPo bag. Only use a qualified and specific Li-Po/Li-Ion charger for Li-Po/Li-Ion batteries or NiMH charger for NiMH batteries. Never charge the battery unattended. Do not charge the battery if the charging process exceeds 4.2 V / cell. Do not charge the battery with a charging current above 2C. Please check and ensure that you are using a qualified charger. An unqualified charger may cause a fire.
- Do not discharge the battery with a current that exceeds the maximum discharge current. Otherwise, this will cause the battery to overheat. This can lead to bursting, fire or explosion.
- Never disassemble, puncture, knock, drop, short-circuit and/or throw the battery into a fire.
- Improper use such as short-circuiting or overcharging can lead to explosions or fire.
- Store the battery in a safe place where infants or children cannot reach it.
- The above indicates the danger of using the battery. The user assumes full responsibility for the result of using the battery. Please be sure to observe our safety instructions which you can find online at <https://amewi.com/downloads/manuals/Akku-Sicherheitshinweise.pdf>



## ■ Disposal

- AMEWI is registered below the Bat-Reg.-No. DE 77735153 and WEEE-Reg.-No. 93834722 at the foundation EAR and recycles all used electronic parts properly. Electric and electronical products are not allowed to put in household garbage. Please dispose the product at the end of the lifetime according to the actual laws. You as a customer are responsible by law for the return of all used batteries, a disposal over the household garbage is forbidden!
- Batteries containing hazardous substances are marked with the alongside symbols, which point to the prohibition of disposal in household garbage.
- Additional notations for the critical heavy metal are Cd=Cadmium, Hg=Quicksilver, Pb=lead {Label is placed on the batteries, for example below the bottom left trash

symbols).



- Based on RoHS labelling the manufacturer confirms, that all limit values were taken care of at the time of manufacturing.



- Batteries labelled with the recycling symbol can be put into used battery collecting tank. (Most supermarkets have) They are not allowed to be put into local household garbage.



- AMEWI Trade GmbH is involved in the dual system for boxing over the company Landbell AG.
- All used boxes are collected from partner companies (waste disposal contractor) at private customers (local household), sorted and properly utilized. The involvement in a Dual Systems helps to save CO<sub>2</sub> Emissions.

## Thank you

Thank you for purchasing the Amewi Model. Please read the instruction manual carefully and keep it for future reference.

## WARNING!

- This remote-controlled model is not a toy. It consists of many small parts and is not suitable for children under 14 years.
- Four 1.5V AA batteries are required for the remote control.
- A 7,4V Lithium battery is used for the model (included).
- Always keep your fingers away from the drive parts and other moving parts to avoid injury.
- The model's motor gets very hot. To avoid burn injuries, allow the motor to cool for 10-15 minutes after use before touching it.

## On inappropriate use

Please do not disassemble or modify the model or accessories like battery or remote-control in any way. Do not use this product improperly or illegally and do not operate it in a manner that could endanger others or yourself.

## Maximum transmitting power data

	2448-2475MHz	Operation Frequency:
	-11,2dBm	<ul style="list-style-type: none"><li>• Maximum Radio Frequency power:</li><li>• Maximum peak power</li></ul>

## Important notes

**Note:** This product is manufactured according to strict performance guidelines and complies with safety standards and requirements. This product is not suitable for children under 14 years of age. The manufacturer is not liable for any injury or accident caused using abnormal parts, excessive wear and tear, improper assembly, or operation. Please operate this product safely and responsibly.

## Precautions

- Please read the following safety information before using the model.
- Please do not use the model in rain, snow, or thunderstorms. If liquid enters the electronics, they may be irreparably damaged.
- Please do not use the model in an environment that you cannot see.
- Signal interference can cause the model to go out of control. Please do not use the model in the following places:
  - Near a radio tower, mobile phone masts or other places phone masts or other places
  - Near crowds or in public places.
  - Near rivers, ponds or lakes.
  - Near electricity pylons or other transmission towers.
- Please do not operate the model if you are tired or unwell, have drunk alcohol or taken drugs – this may cause injury to yourself or others.
- To avoid burns, never touch drive parts and motors during or immediately after use as they can be very hot. Incorrect operation of the transmitter can cause injury to you or

others. Be sure to familiarize yourself with the operation before using the model.

- Check the model and the remote control before use. Check screws to make sure they are tight.
- When you have finished using the model, always switch off the model first and then the remote control. Otherwise, the model may get out of control.
- If the model gets out of range, it may get out of control. Please always stay close to the model with the transmitter.
- Be sure to read thoroughly the manual before you begin.
- Never reverse connection .
- As the product contains small parts, keep it away from small children.
- Do not operate the model on public roads or crowded places.

## Connection diagram

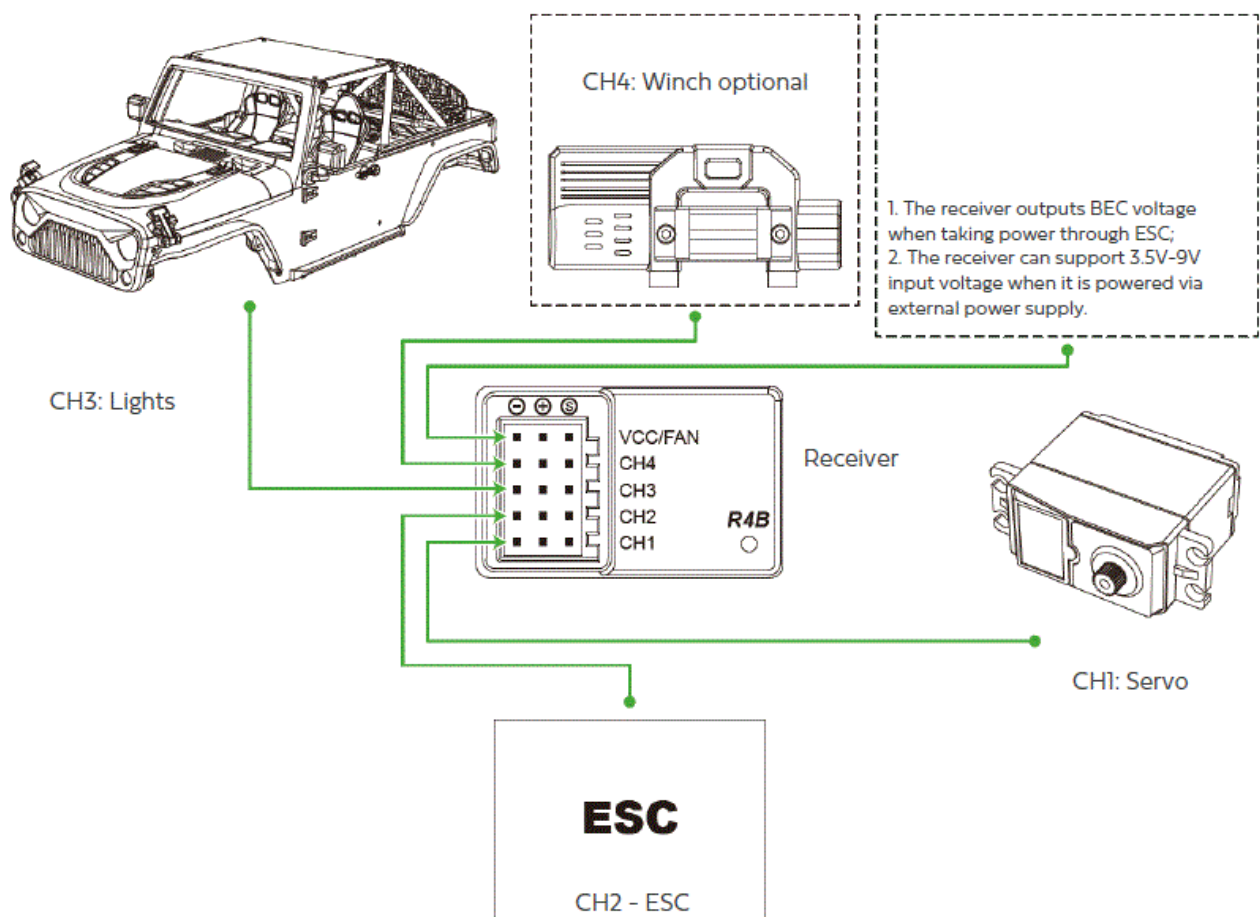

## Placement



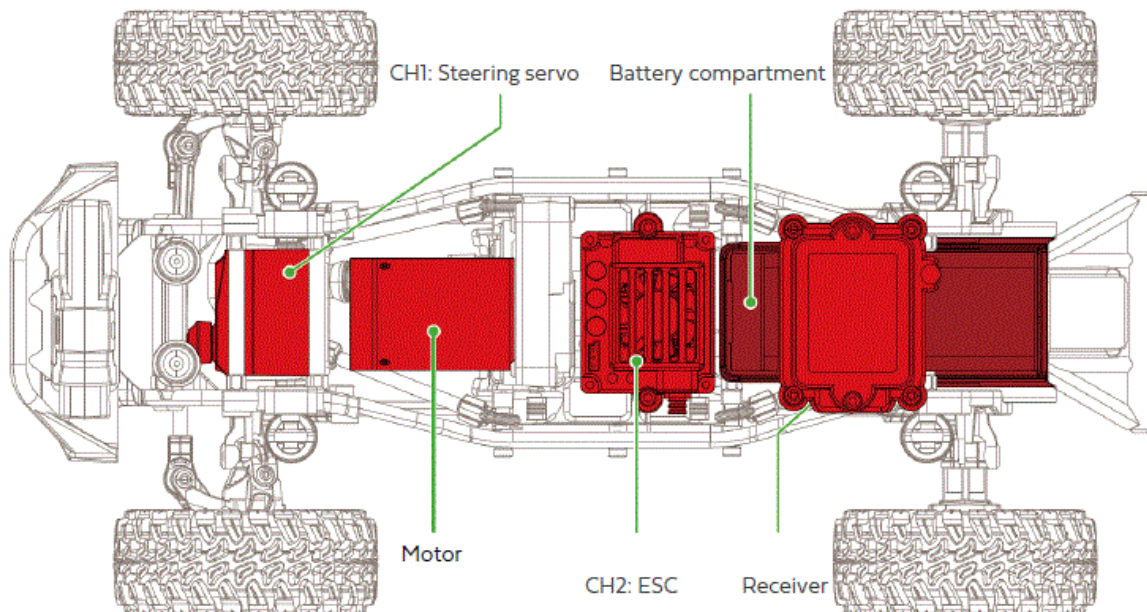

## SC+ sensed ESC & motor

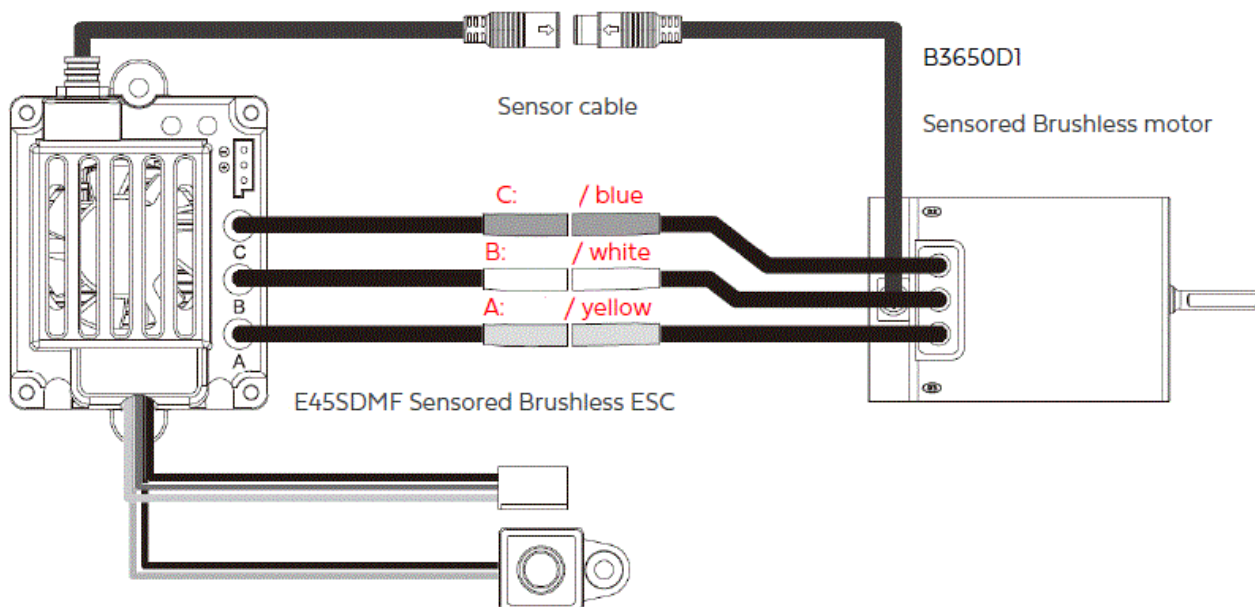

**Warning:** please note that the motor and ESC connecting wire interface need to be consistent. If connected wrongly will result in not working properly.

## Angry Snail App

- Connect the controller to your smartphone to read and set the parameters. Please scan the QR code to download the app.
- The controller can connect to the controller via Bluetooth. Make sure that Bluetooth is activated on your smartphone.



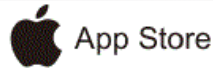

## SC sensorless ESC & motor

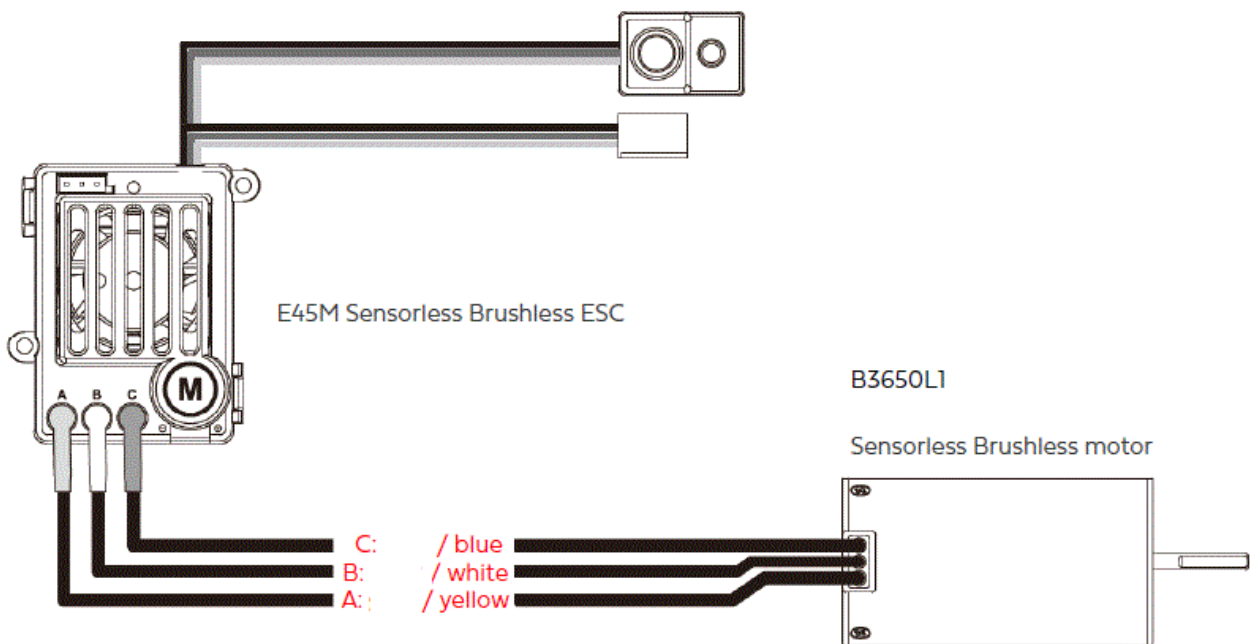

**Warning:** please note that the motor and ESC connecting wire interface need to be consistent. If connected wrongly will result in not working properly.

## SC: Set Throttle range

1. Switch on the remote control. Make sure that the throttle trim is set to 0. D/R, EPA, ATL and other throttle parameters must be set to 100%.
2. Press and hold the set button and switch on the esc. The LED on the esc flashes and the motor makes a “chirp” sound at the same time. Release the set button. The red LED on the esc flashes quickly. The controller is in throttle programming mode.

Keep holding down SET

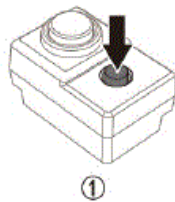

Switch on

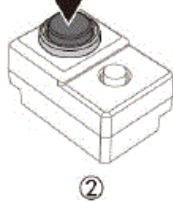

Release the SET button when the led flashes.

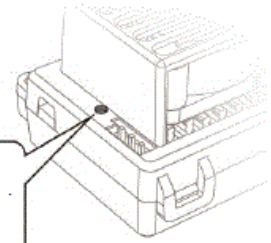

3. Keep the throttle lever in the neutral position and press the SET button once. The red LED goes out and the motor confirms that the neutral position has been saved with a “Di” sound.

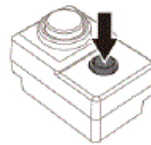
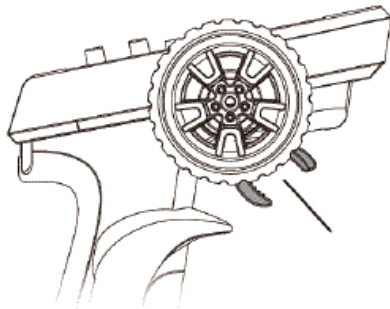

Red LED off

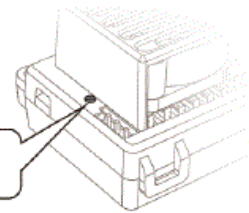

4. Pull the throttle lever back for the maximum forward position. Press the SET button once. The red LED flashes twice and the motor emits two “Di-Di” sounds to indicate that the maximum forward position has been saved.

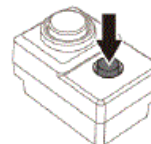
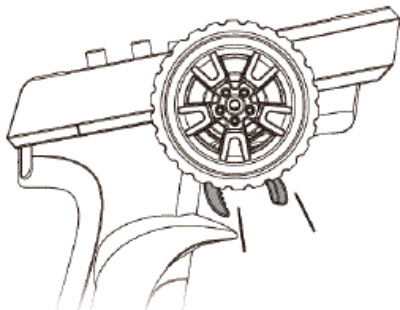

LED blinkt 2x  
Red flashes two times

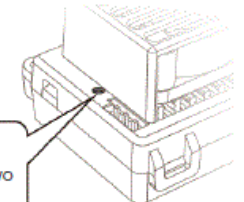

5. Push the throttle lever forward for the maximum backward position. Press the SET button once. The red LED flashes three times and the motor emits three “Di-Di-Di” tones to indicate that the maximum backward position has been saved.

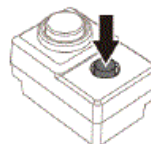
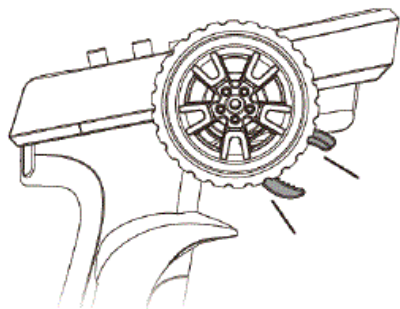

LED blinkt 3x  
Red flashes three times

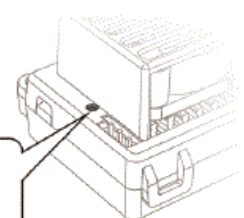

6. Once these steps have been completed, the calibration is complete. As soon as the throttle lever is back in the neutral position, the esc can be used normally.

## SC: Back to initial setting

When the esc is switched on, press and hold the SET button for five seconds. The motor emits a “Di-Di” sound and the LED flashes twice. The throttle range is reset to the initial setting.

## The remote control

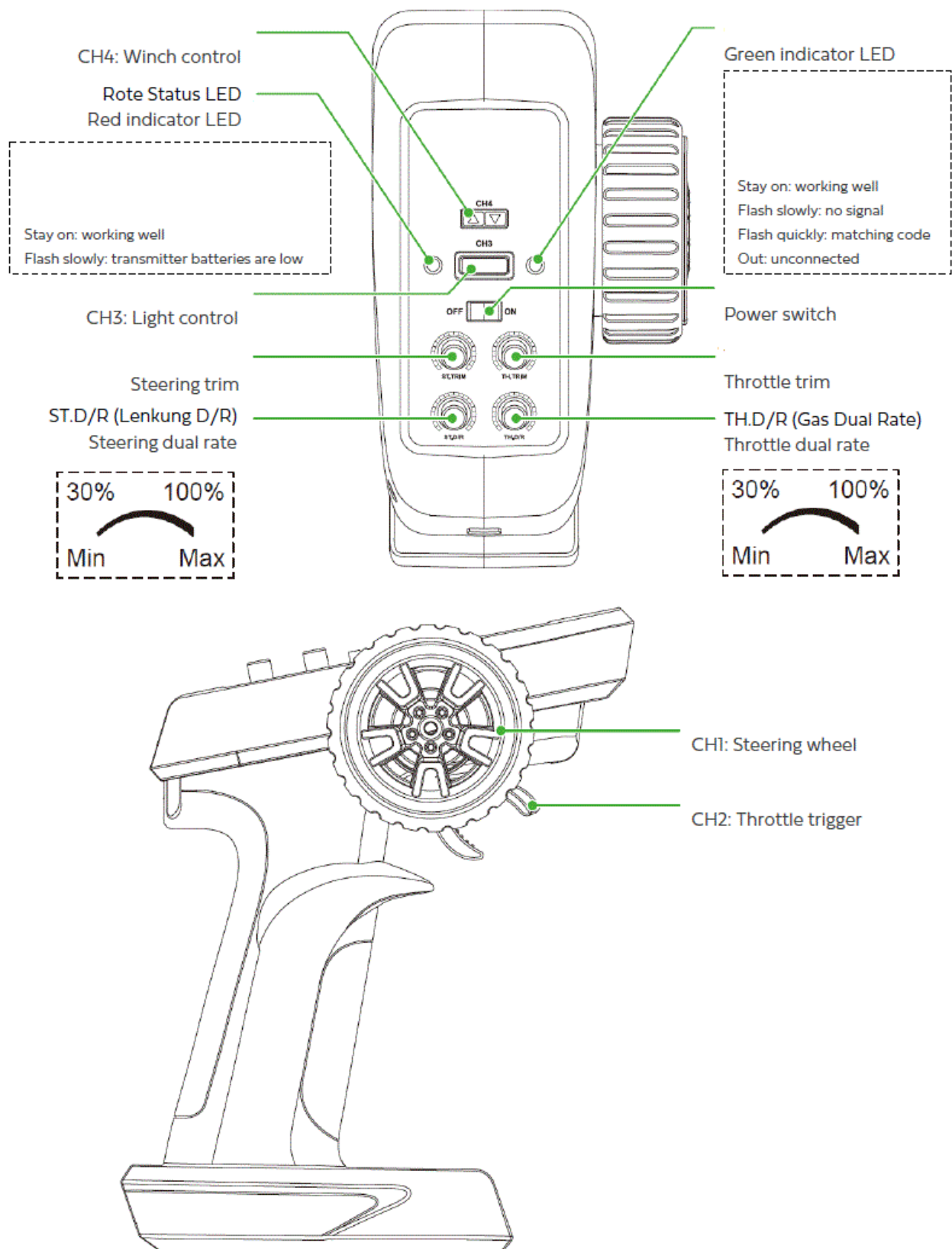

## Install remote control batteries

Open the battery compartment cover and insert two 1.5V AA batteries. Observe the polarity. Close the cover.

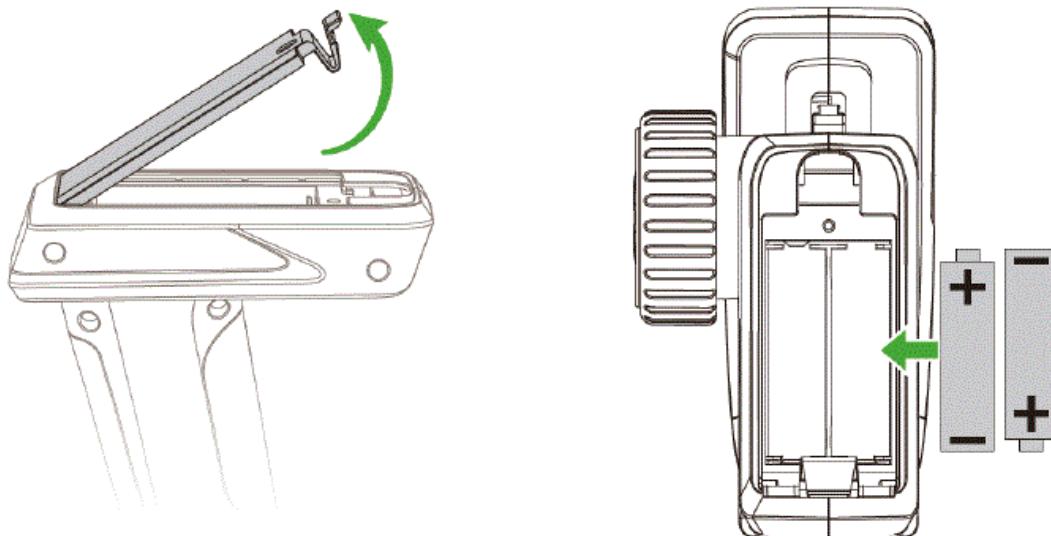

## Switch on

1. Switch on the remote control, the signal LED flashes.
2. Switch on the vehicle, the LED on the ESC flashes.
3. As soon as the LED lights up, the vehicle is ready for use.

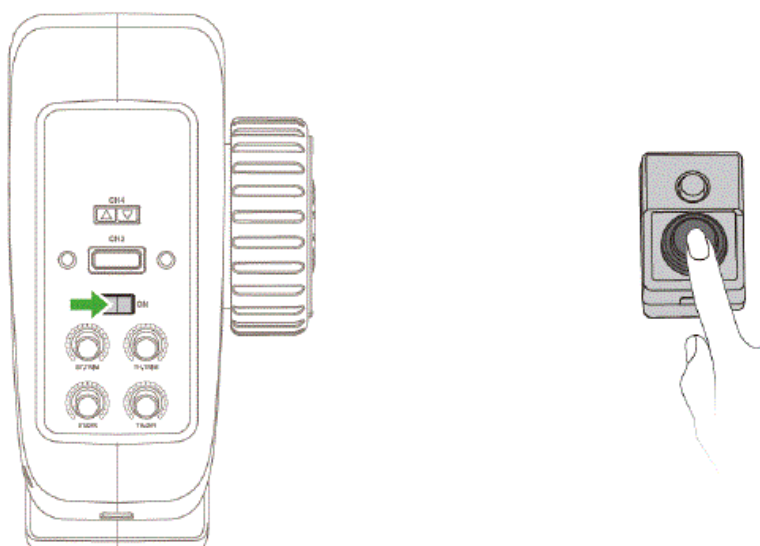

- When switch on the remote control, do not touch the throttle trigger or the steering wheel. Only use these when the transmitter and receiver are connected.
- Always switch on the remote control first and then the car. After use, always switch off the car first and then the remote control.

- During binding, make sure that there is no other car in the vicinity ready to bind.

## Lighting

1. Headlights
2. Blinker Turn signal lamp
3. Brake/Turn signal/Reverse

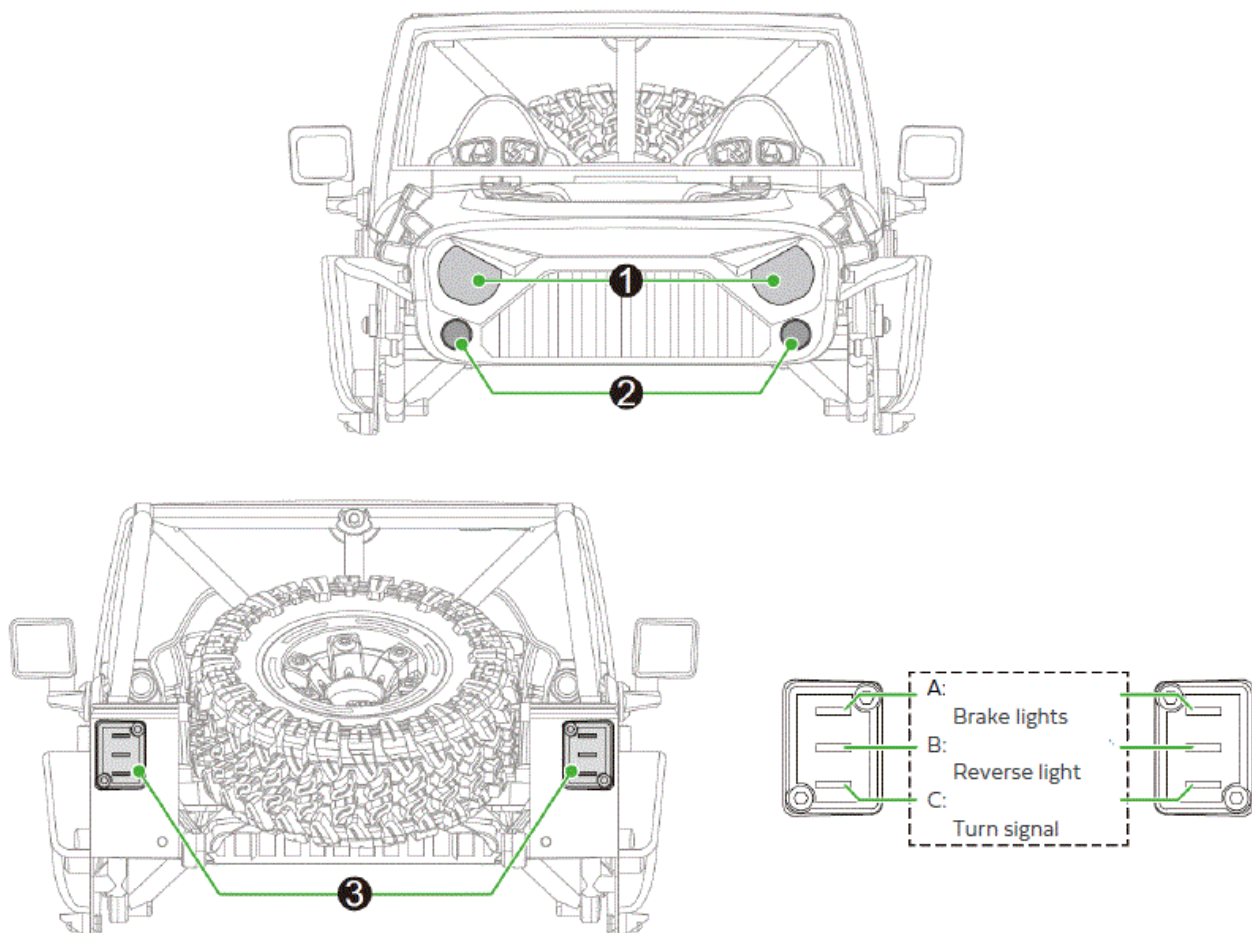

Use the channel 3 (CH3) button to change the light mode.

1. Driving mode: indicators, brake light and reversing light react to the driving functions.
2. Emergency flashing function: all lights flash
3. Light off

## Charging battery

- Connect the USB charging cable to a free USB-A socket on a PC, laptop, USB charger (recommended) or a power bank.
- Connect the battery to the charging cable using the white balance plug.



- The green LED on the USB plug flashes during the charging process.
- As soon as the green LED lights up continuously, the charging process is complete.
- Disconnect the battery from the charging cable as soon as the charging process is complete.

**Important note:** Observe the information on handling batteries and rechargeable batteries in these instructions.

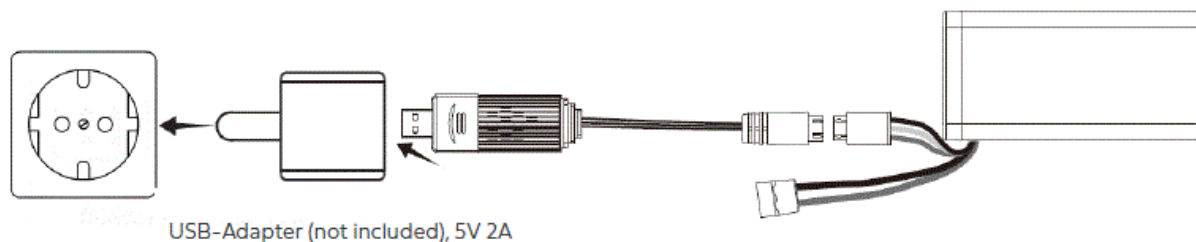

### Winch installation (not included)

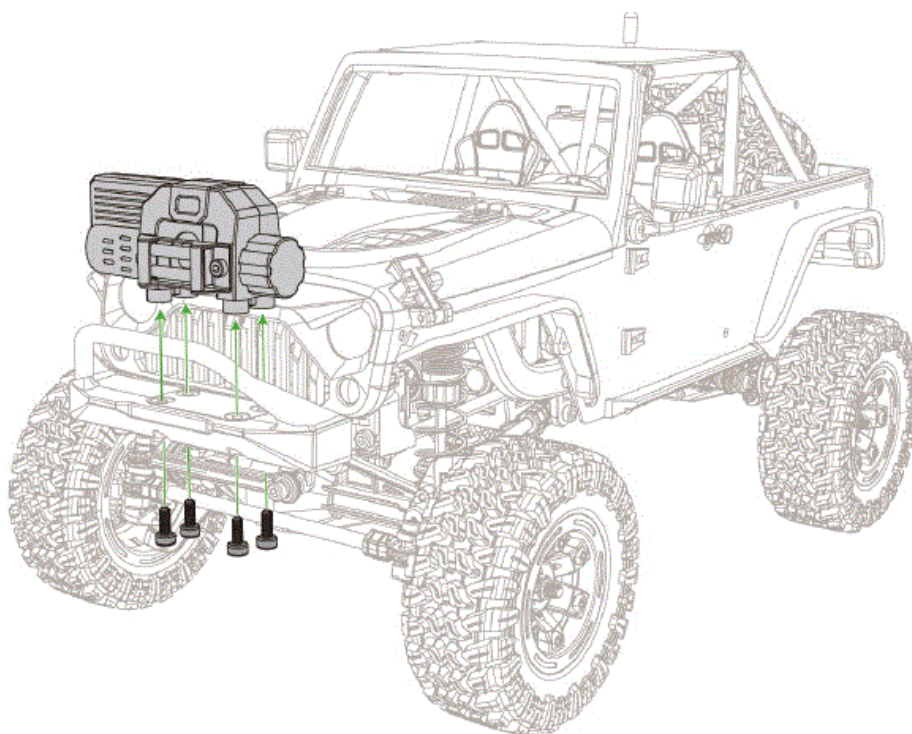

### Open the body

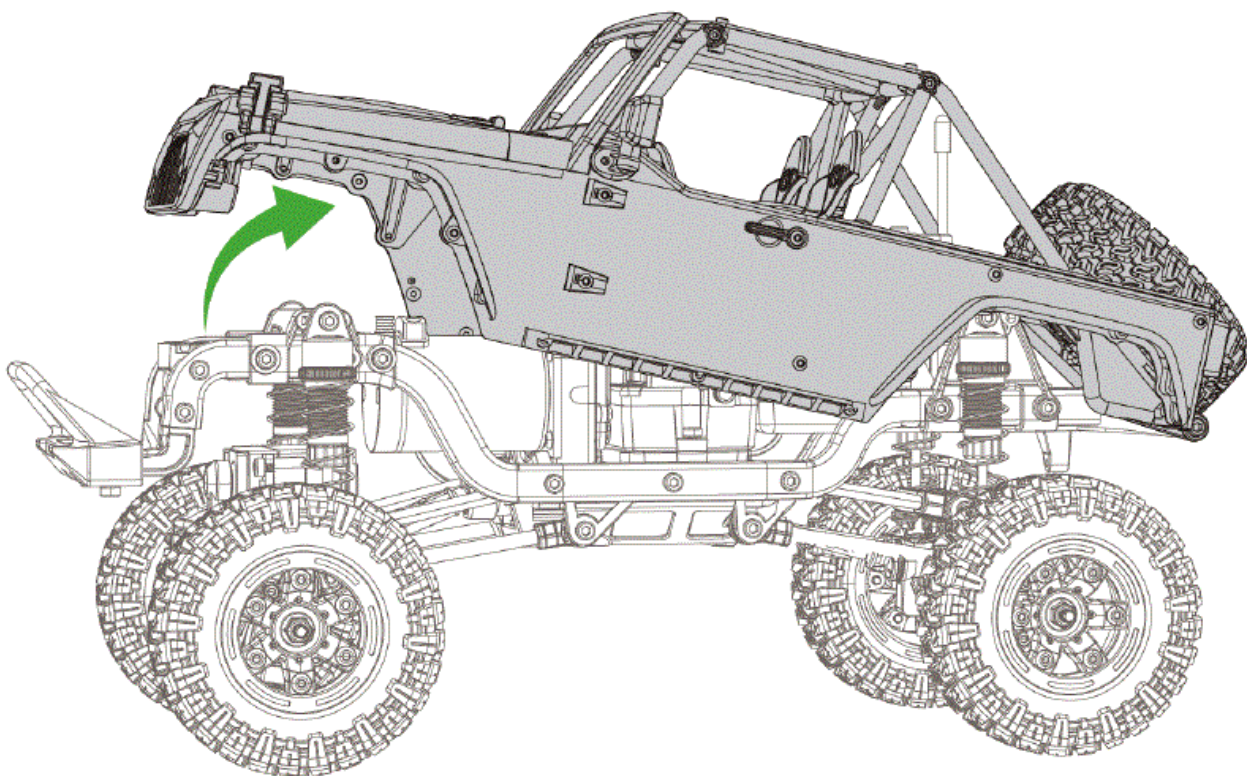

## Gearbox

 3  
HTM3080 Ø3x8mm

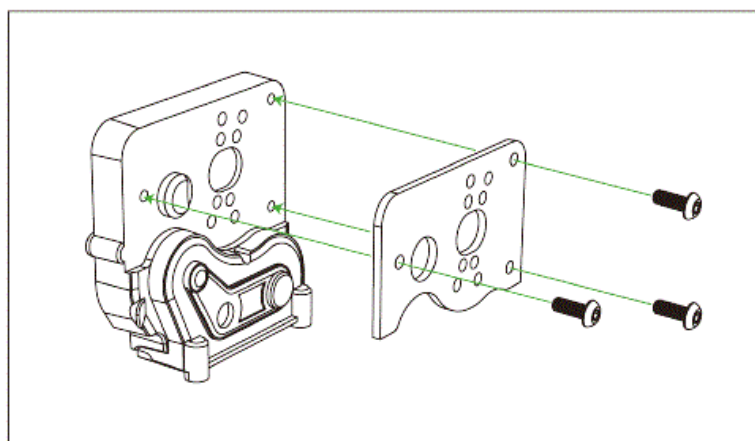



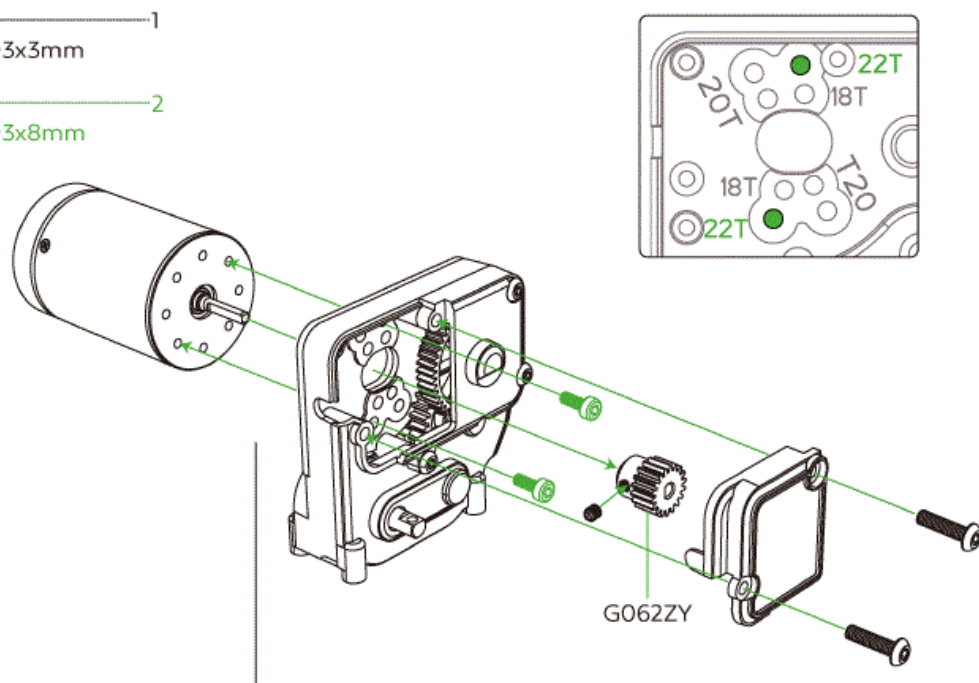
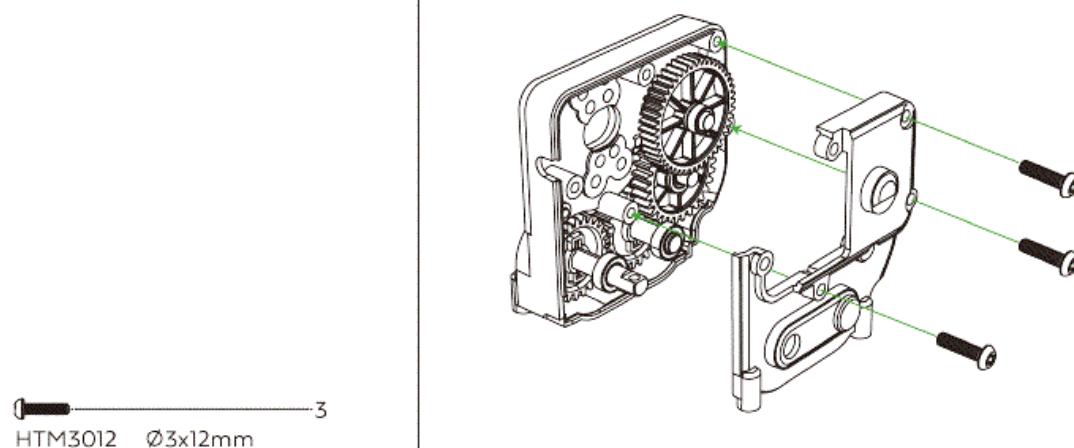
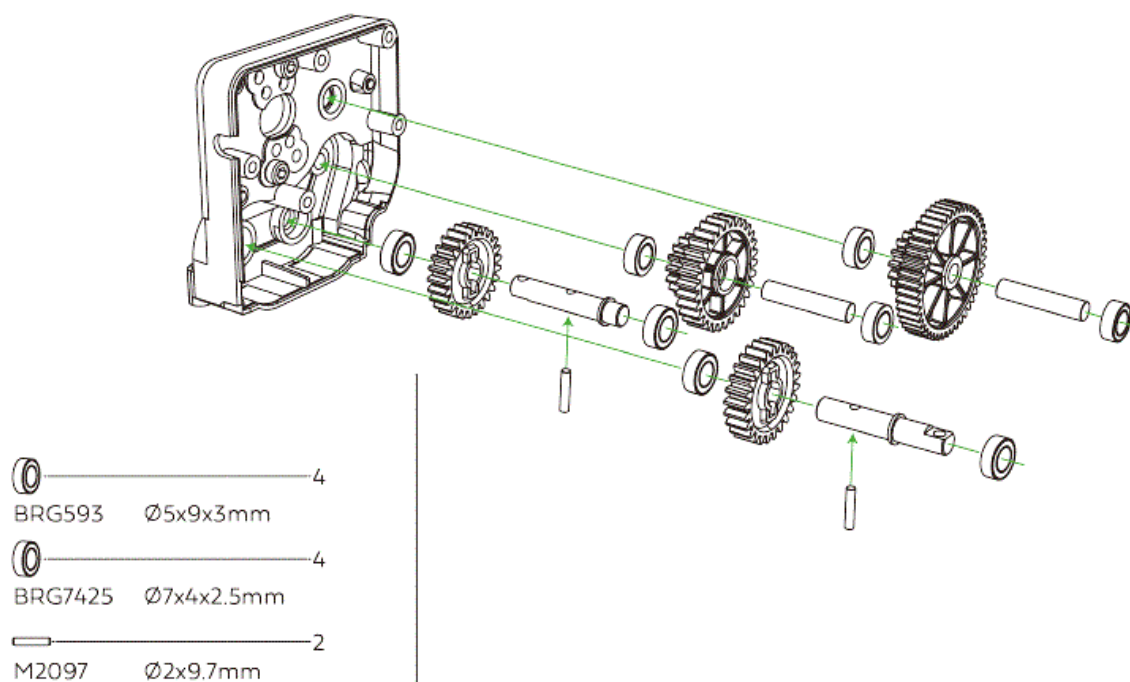

S4092    Ø4x9.2mm

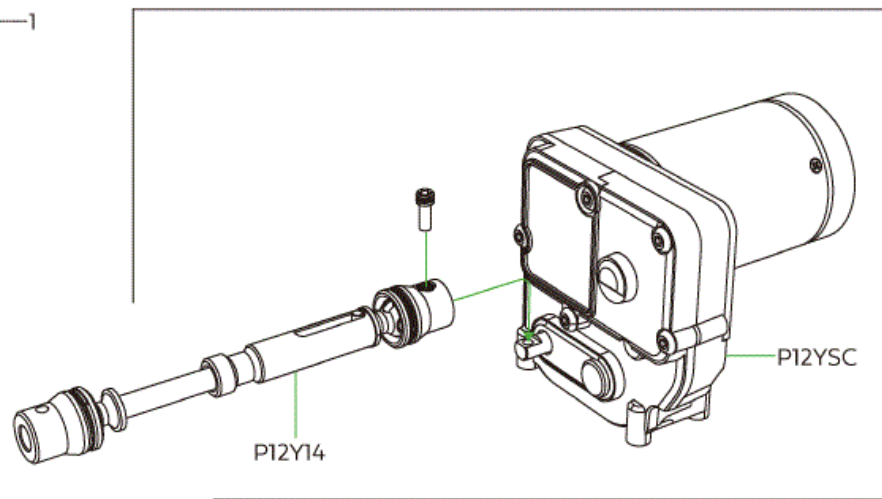

## Front axle

HKM2560    Ø2.5x6mm

R1810    Ø7.9x12.7x4mm

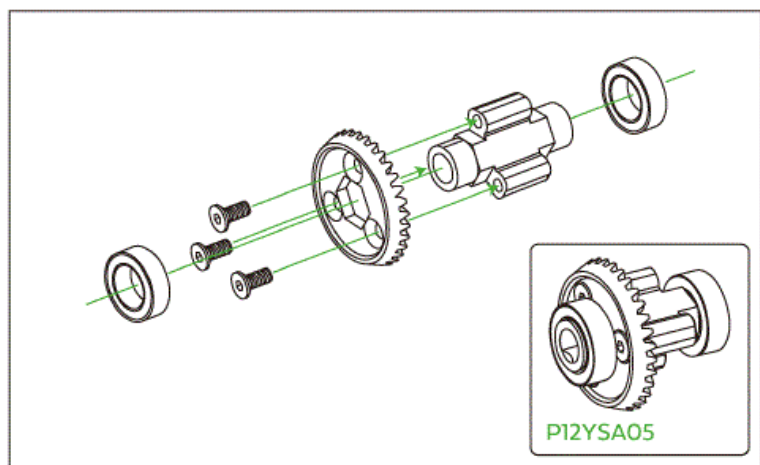

M2097    Ø2x9.7mm

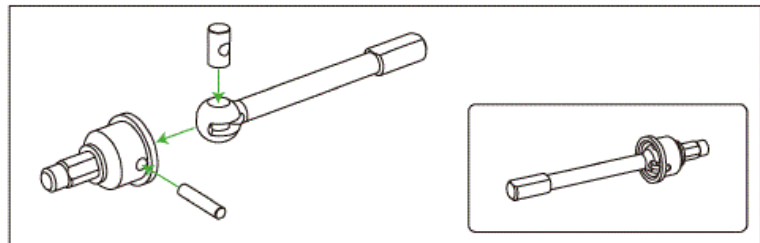

## Rear axle

M2097  $\varnothing 2 \times 9.7 \text{ mm}$

M2097  $\varnothing 2 \times 9.7 \text{ mm}$

HHM2580  $\varnothing 2.5 \times 8 \text{ mm}$

G85653  $\varnothing 8.5 \times 6.45 \times 0.3 \text{ mm}$

M20101  $\varnothing 2 \times 10.1 \text{ mm}$

BRG10154  $\varnothing 10 \times 15 \times 4 \text{ mm}$

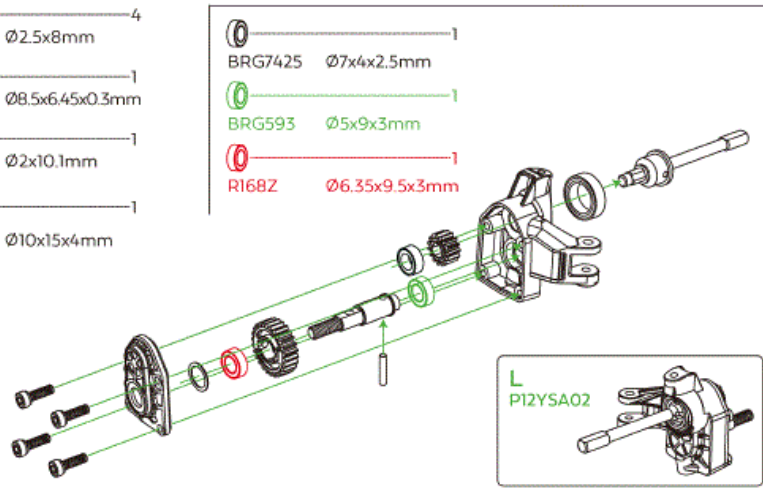
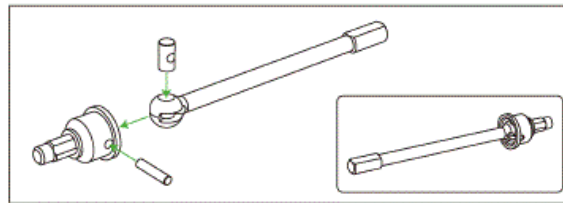
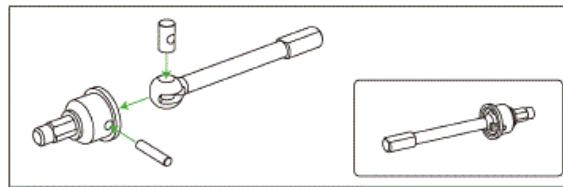

HHM2580  $\varnothing 2.5 \times 8 \text{ mm}$

G85653  $\varnothing 8.5 \times 6.45 \times 0.3 \text{ mm}$

M20101  $\varnothing 2 \times 10.1 \text{ mm}$



BRG10154  $\varnothing 10 \times 15 \times 4 \text{ mm}$

BRG7425  $\varnothing 7 \times 4 \times 2.5 \text{ mm}$



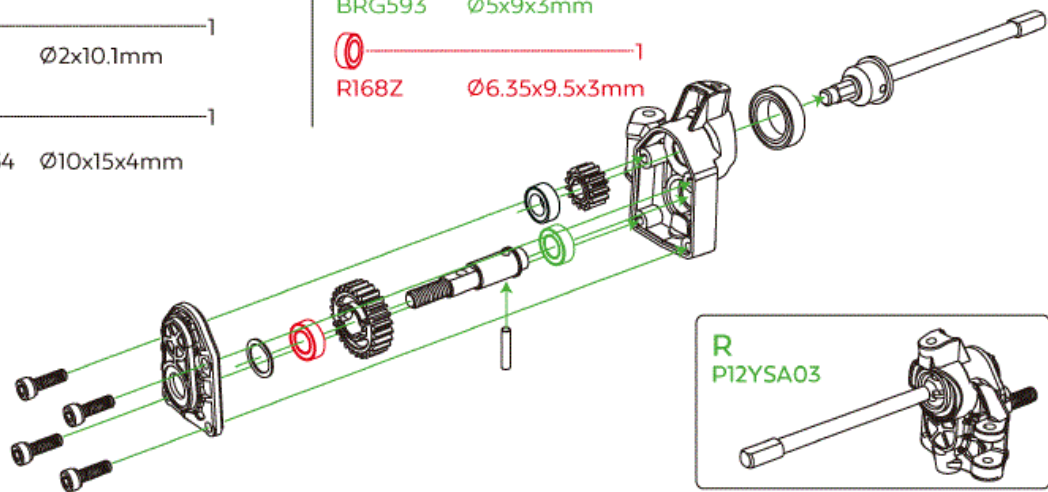

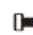
BRG593  $\varnothing 5 \times 9 \times 3 \text{ mm}$

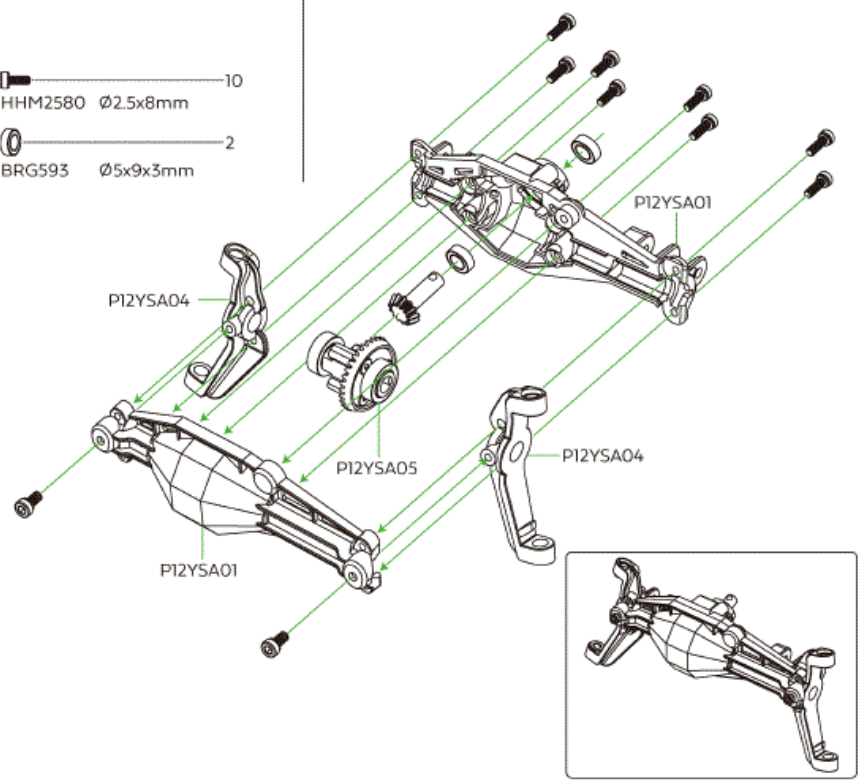

R168Z  $\varnothing 6.35 \times 9.5 \times 3 \text{ mm}$



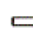

 10  
 HHM2580 Ø2.5x8mm  
 2  
 BRG593 Ø5x9x3mm

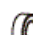

 4  
 HHM2580 Ø2.5x8mm  
 1  
 G85653 Ø8.5x6.45x0.3mm  
 1  
 M20101 Ø2x10.1mm  
 1  
 BRG10154 Ø10x15x4mm

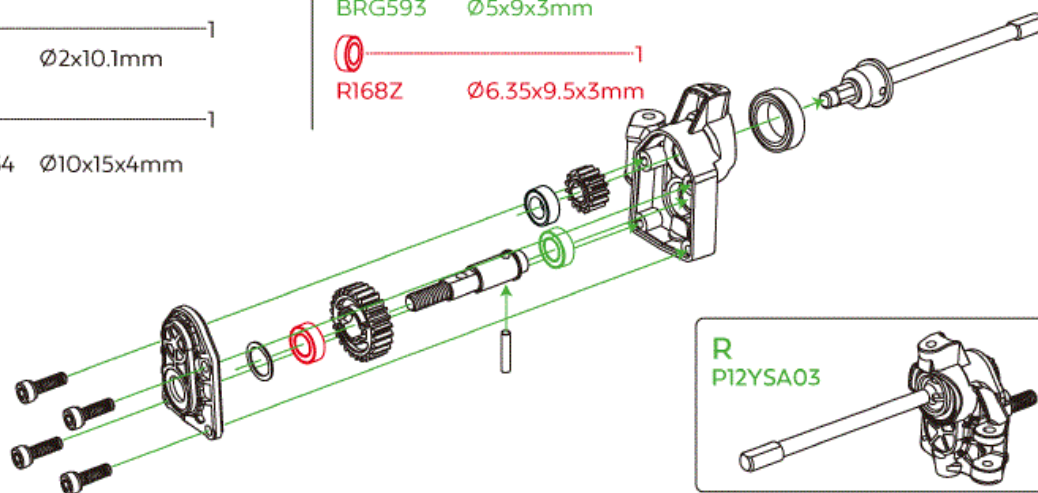
 1  
 BRG7425 Ø7x4x2.5mm  
 1  
 BRG593 Ø5x9x3mm  
 1  
 R168Z Ø6.35x9.5x3mm

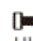

 10  
 HHM2580 Ø2.5x8mm  
 2  
 BRG593 Ø5x9x3mm

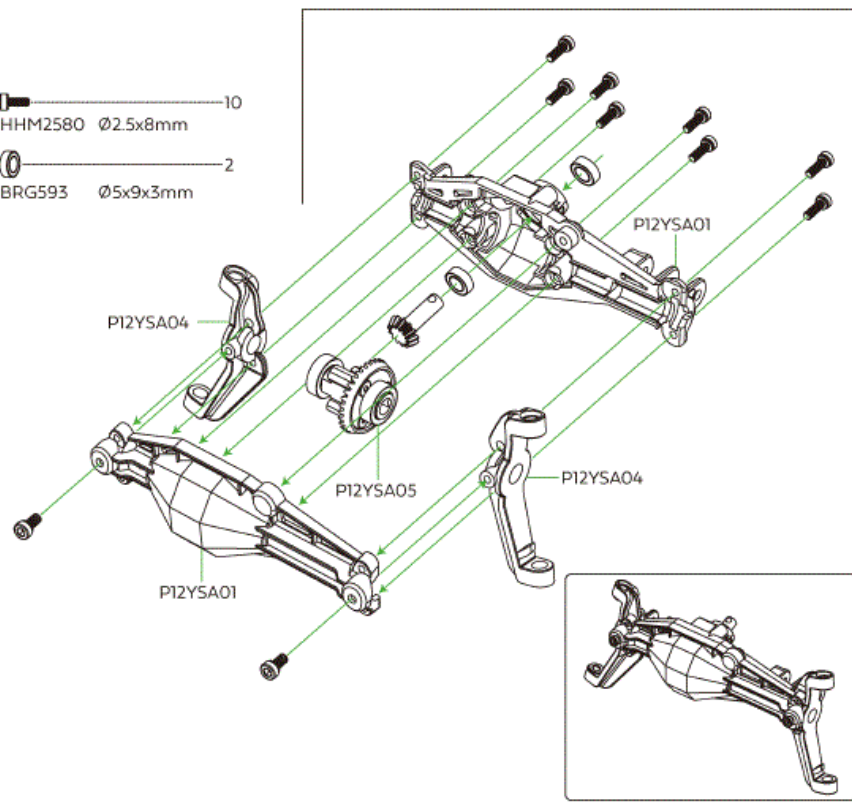

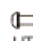
 2  
 HTHM30115 Ø3x11.5mm

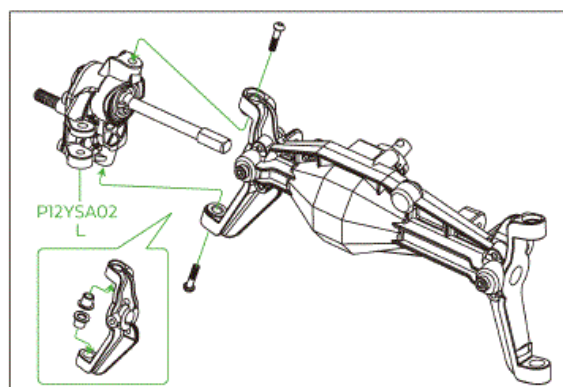

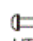

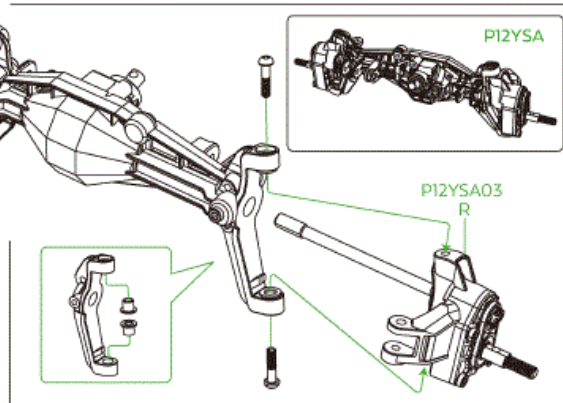

 2  
 HTHM30115 Ø3x11.5mm



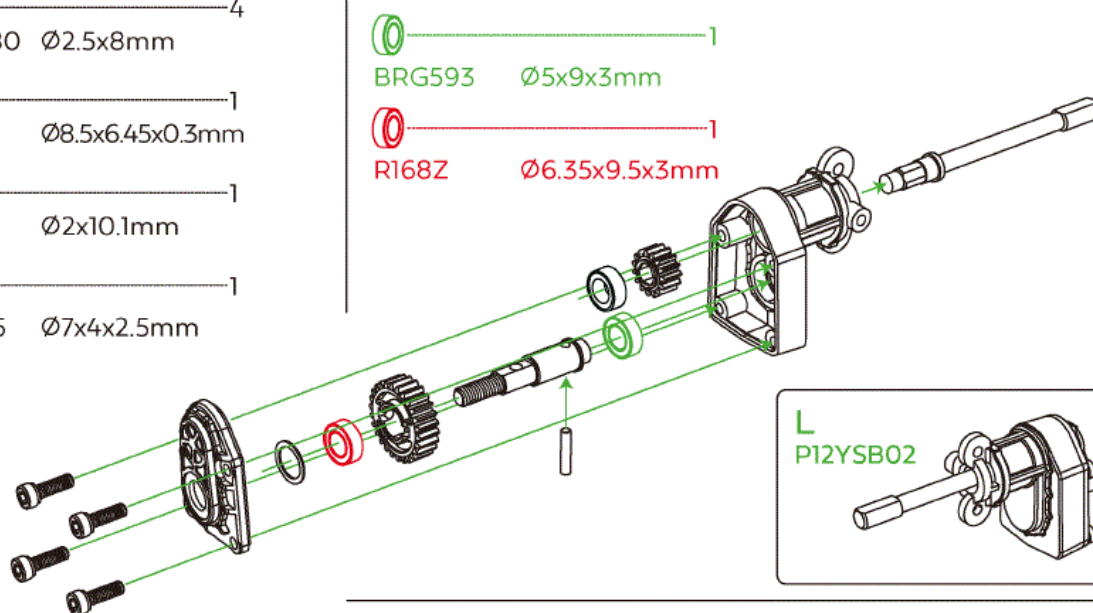

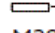

-  4  
HHM2580 Ø2.5x8mm
-  1  
G85653 Ø8.5x6.45x0.3mm
-  1  
M20101 Ø2x10.1mm
-  1  
BRG7425 Ø7x4x2.5mm

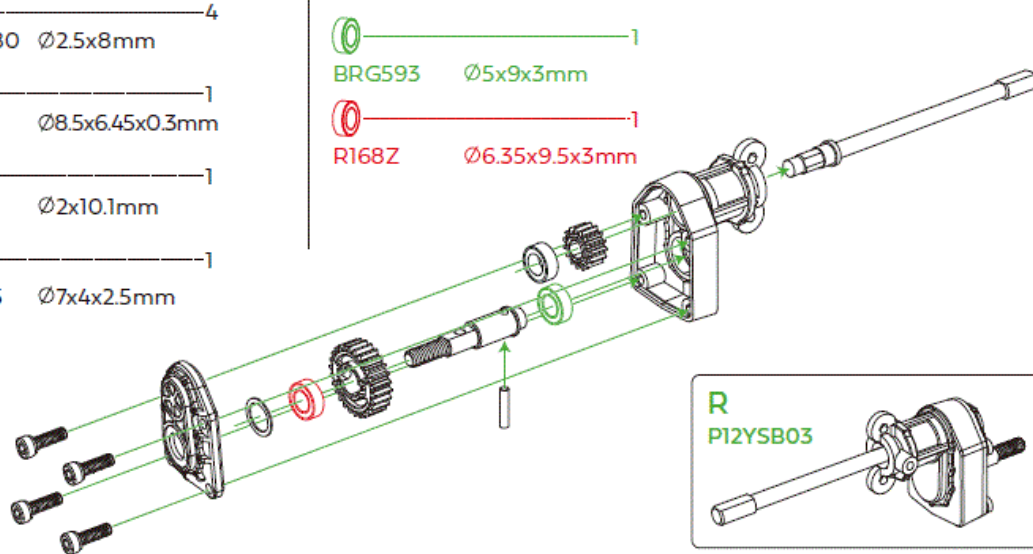

-  4  
HHM2580 Ø2.5x8mm
-  1  
G85653 Ø8.5x6.45x0.3mm
-  1  
M20101 Ø2x10.1mm
-  1  
BRG7425 Ø7x4x2.5mm

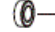

-  10  
HHM2580 Ø2.5x8mm
-  2  
BRG593 Ø5x9x3mm

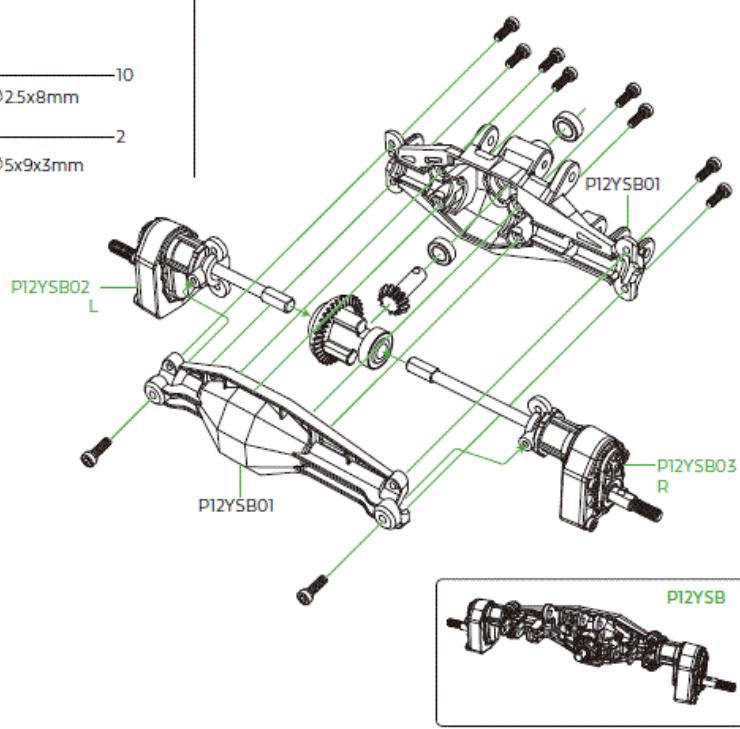

## Assembly on axles

HHM2580 Ø2.5x8mm 2

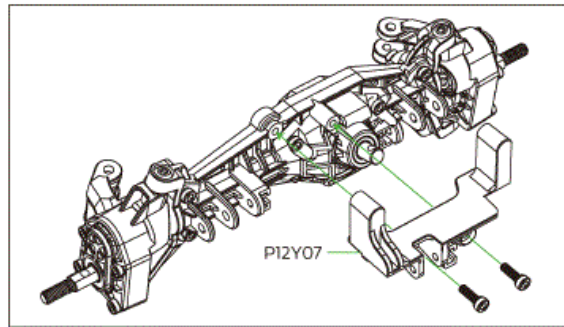

HHM3010 Ø3x10mm 4

HTM3080 Ø3x8mm 1

G80305 Ø8x3x0.5mm 4

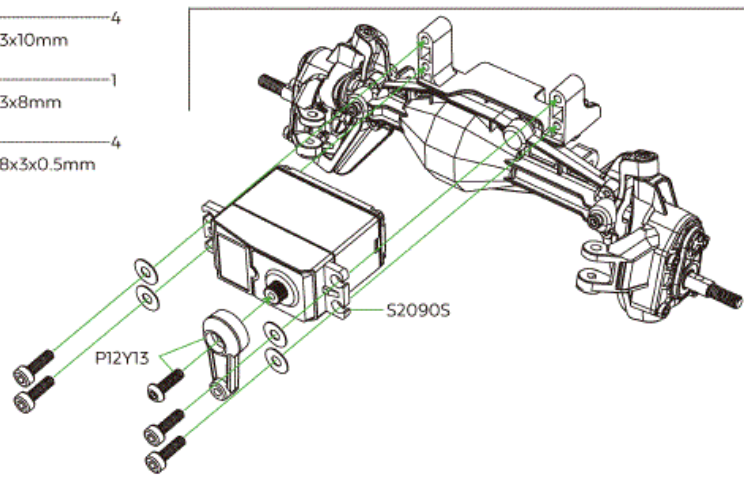

HHM3022 Ø3x22mm 1

HHM3014 Ø3x14mm 2

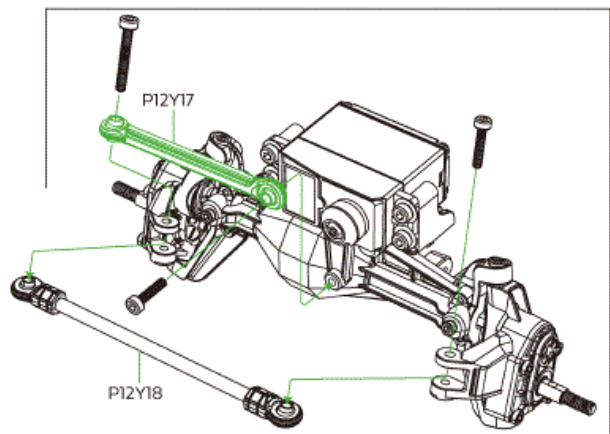

HHM3016 Ø3x16mm 2

NUT30 Ø3mm 1

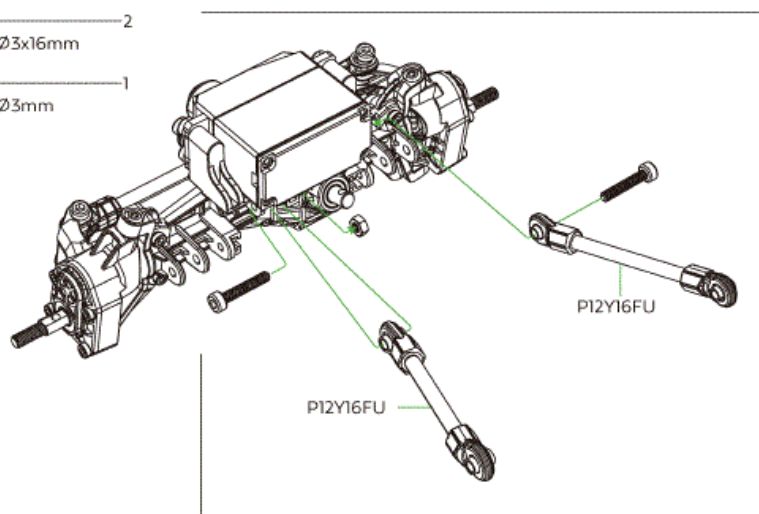

## Frame



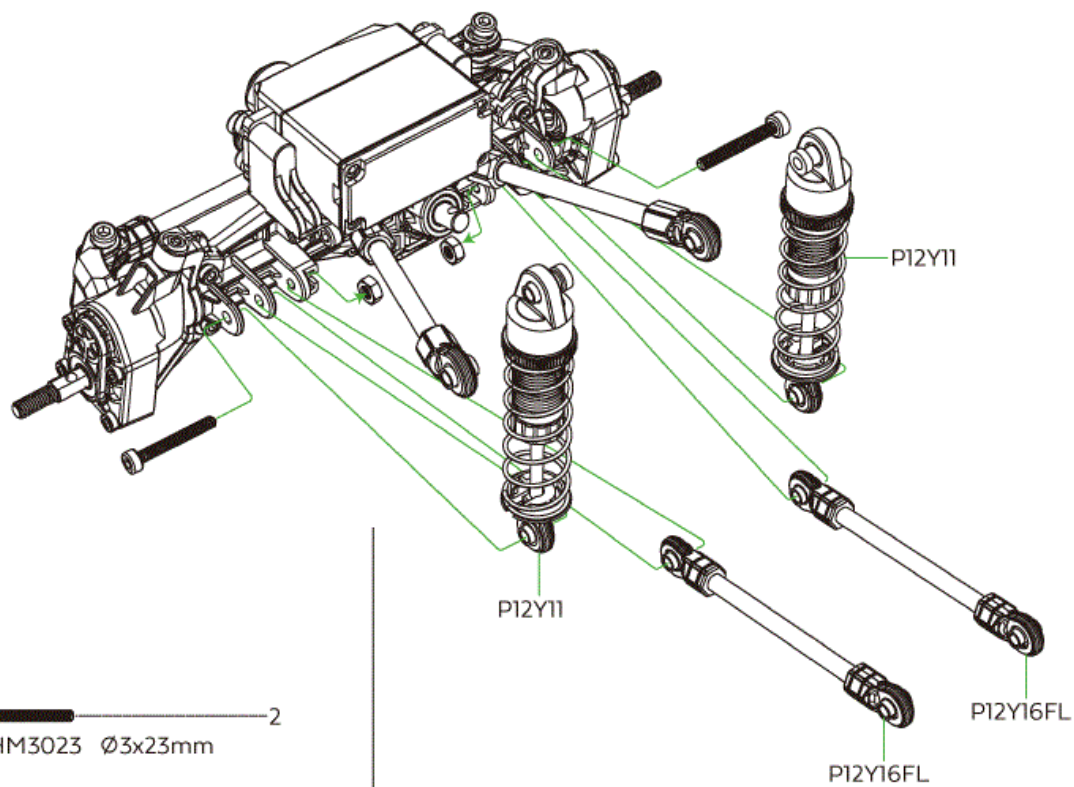

HHM3016 Ø3x16mm 2

NUT30 Ø3mm 2

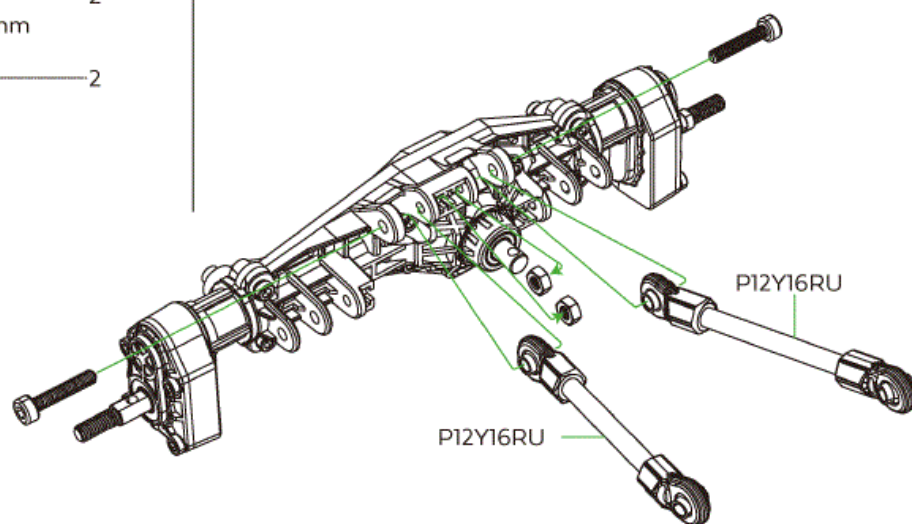

HHM3023 Ø3x23mm 2

NUT30 Ø3mm 2

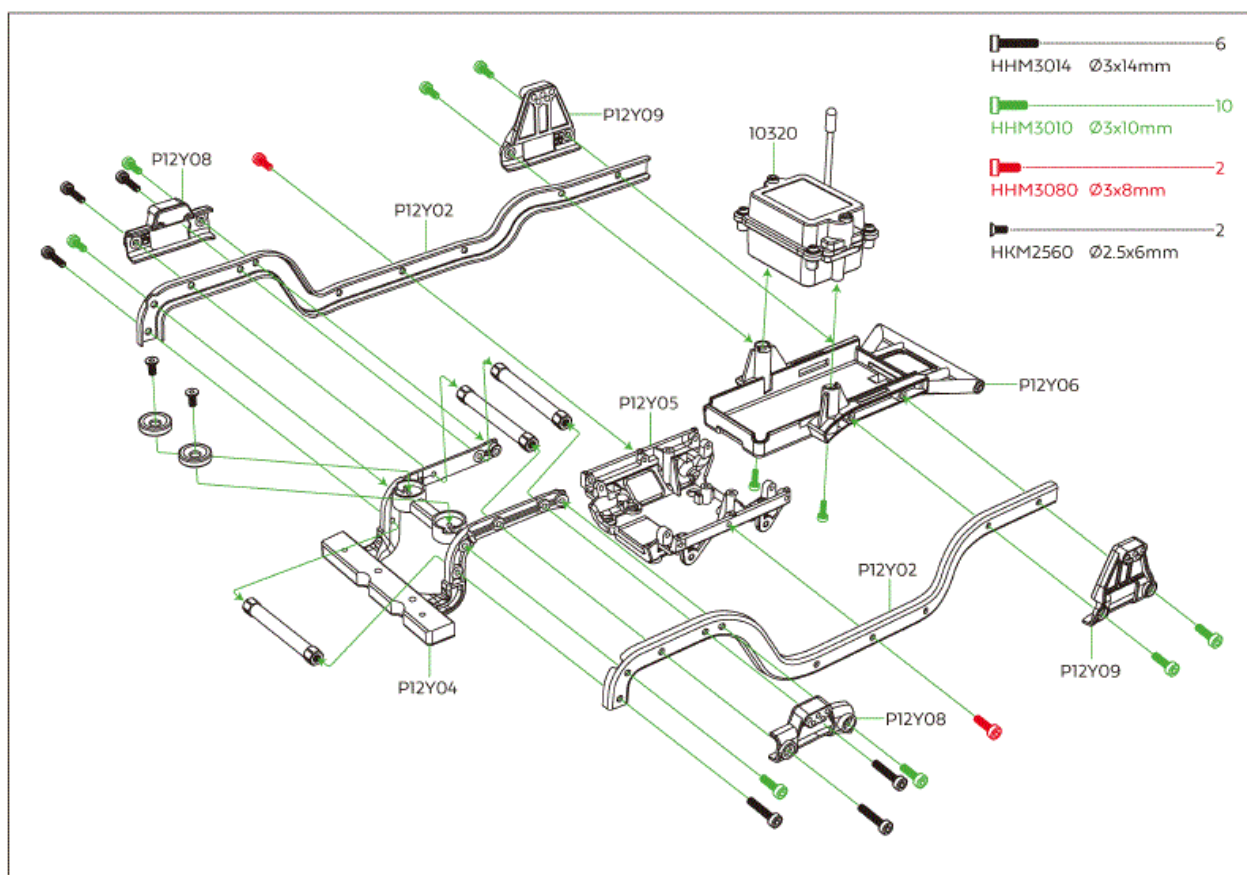
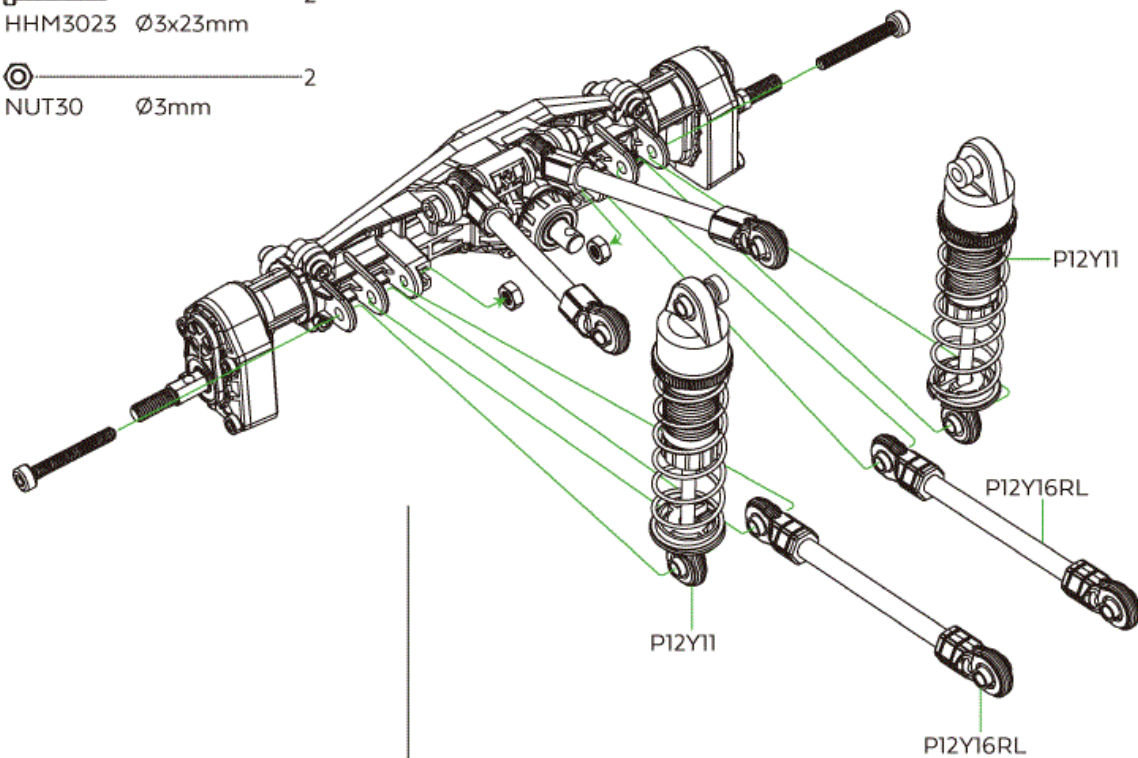

HKM3012 Ø3x12mm 4

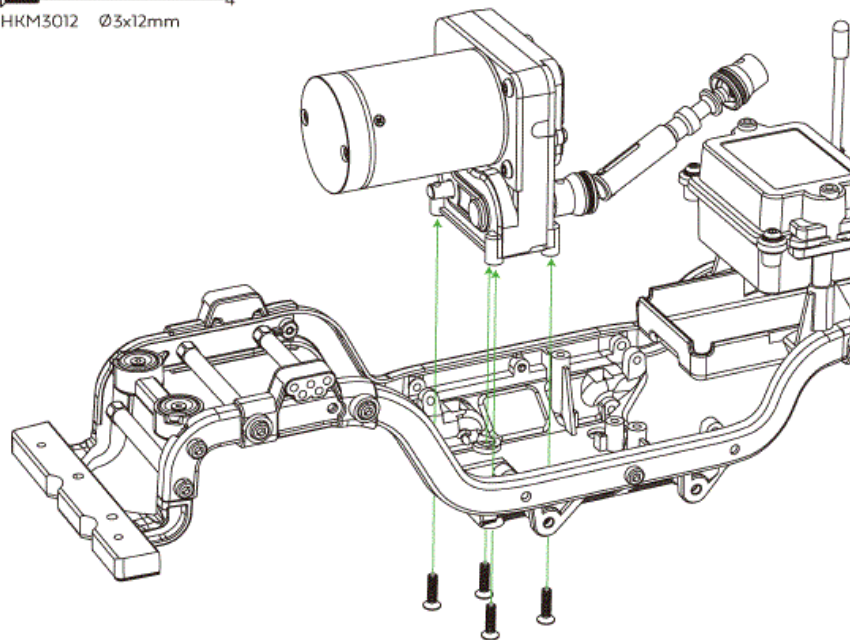

HHM3010 Ø3x10mm 3

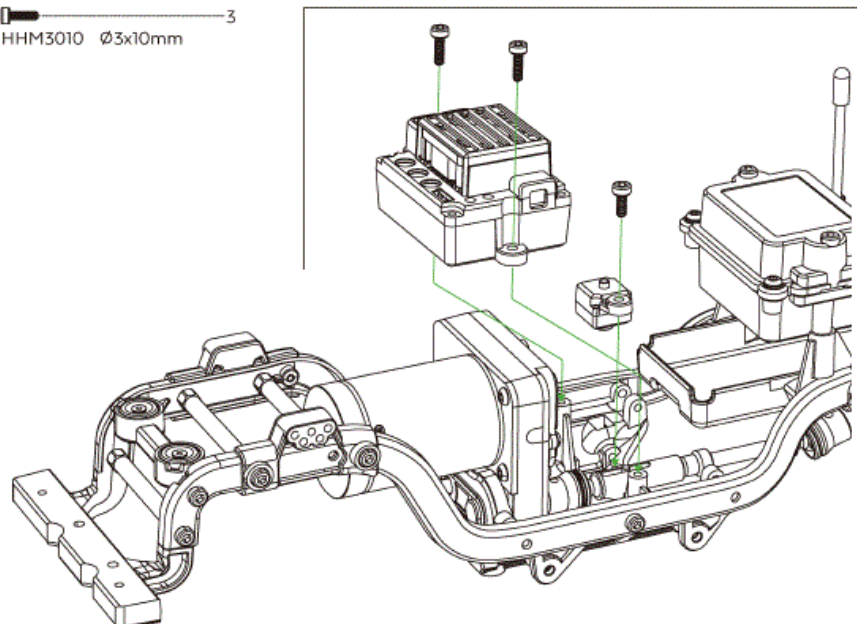

HHM3080 Ø3x8mm 2

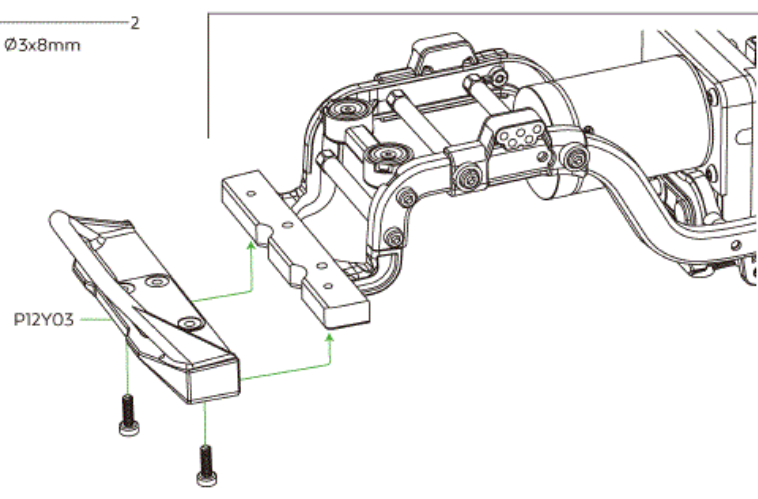

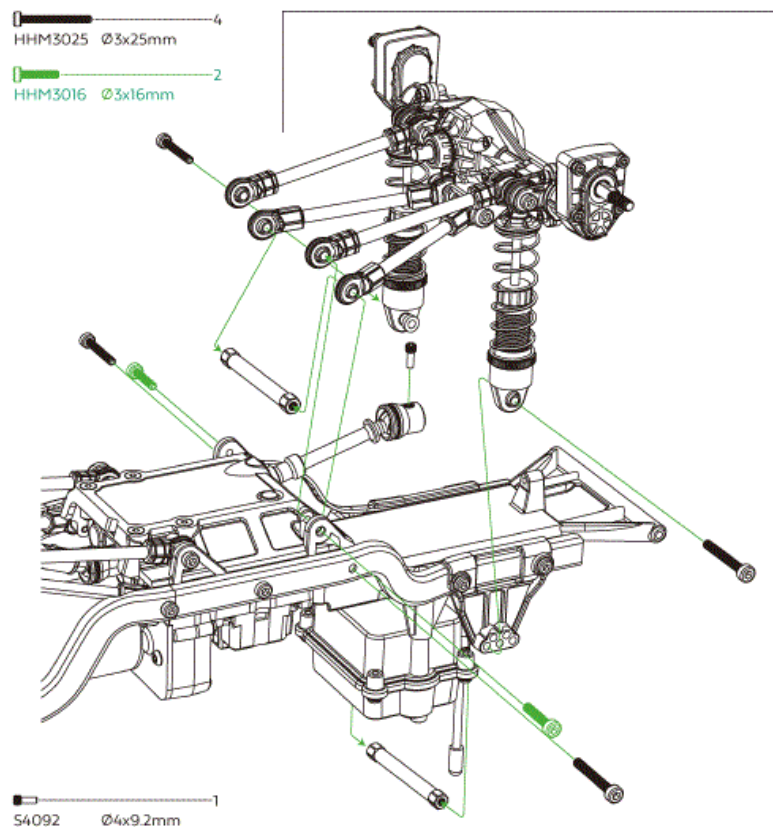
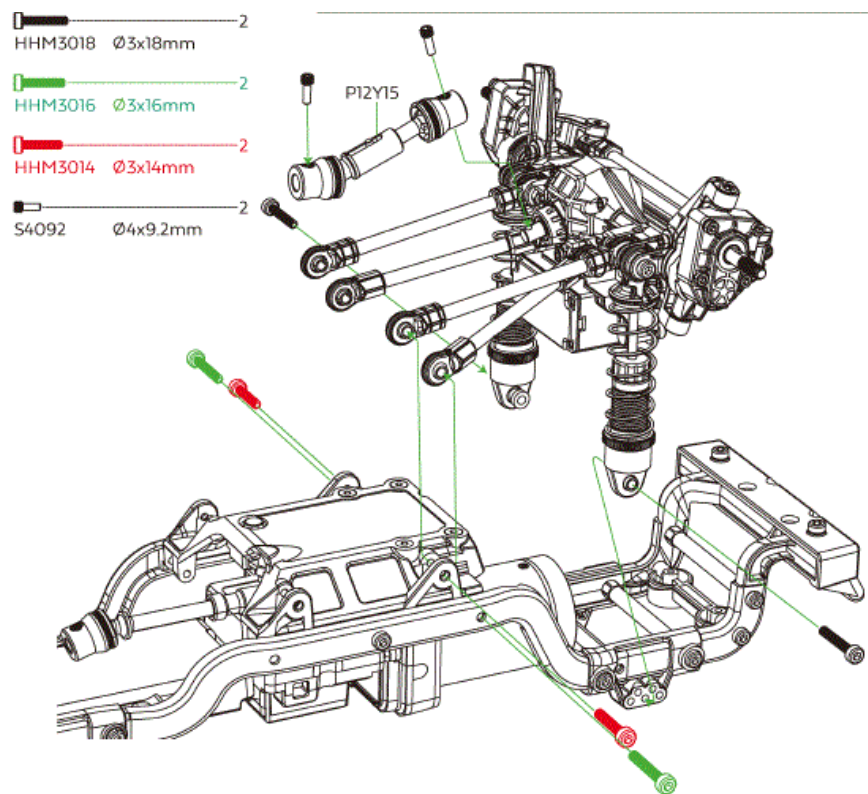



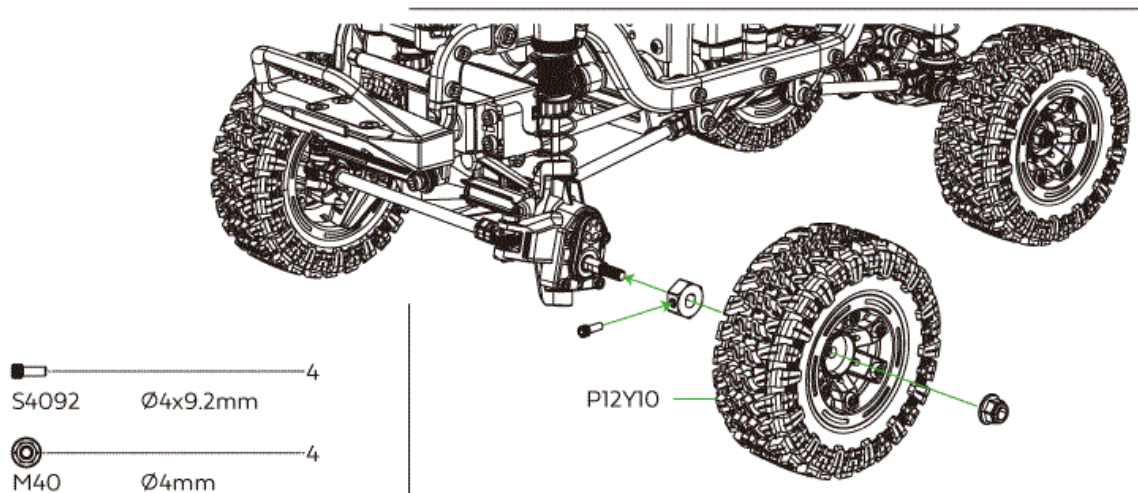

## SCANME



## AMEWI Trade GmbH

- Nikolaus-Otto-Str. 18
- 33178 Borcheln
- Germany
- 9:30 – 12:00 Uhr
- Donnerstag 14:00 – 16:30 Uhr
- **Telephone:** +49 180 5009821 (Festnetz 14Ct/Min., Mobil max. 42Ct/Min.)
- **Support:** <https://amewi.com/Support>

## FAQ

Is the Hyper Go SC/SC+ suitable for children?

o No, the model is not suitable for children under 14 years of age due to small parts and safety concerns.

Can I use different batteries with the model?

o It is recommended to use four 1.5V AA batteries for the remote control and a 7.4V Lithium battery for the model as included.

What should I do if liquid enters the electronics?

o If liquid enters the electronics, they may be irreparably damaged. Avoid using the model in wet conditions.

## Documents / Resources

	<a href="#">AMEWI 22701 SC Plus Scale Crawler [pdf]</a> Instruction Manual 22701 SC, 22702 SC, 22701 SC Plus Scale Crawler, 22701 SC, Plus Scale Crawler, Scale Crawler, Crawler
--	---

## References

- [User Manual](#)

22701 SC, 22701 SC Plus Scale Crawler, 22702 SC, AMEWi, Crawler, Plus Scale Crawler, Scale Crawler

## Leave a comment

Your email address will not be published. Required fields are marked \*

Comment \*

Name

Email

Website

☐ Save my name, email, and website in this browser for the next time I comment.

**Post Comment**

**Search:**

e.g. whirlpool wrf535swhz

**Search**

[Manuals+](#) | [Upload](#) | [Deep Search](#) | [Privacy Policy](#) | [@manuals.plus](#) | [YouTube](#)

This website is an independent publication and is neither affiliated with nor endorsed by any of the trademark owners. The "Bluetooth®" word mark and logos are registered trademarks owned by Bluetooth SIG, Inc. The "Wi-Fi®" word mark and logos are registered trademarks owned by the Wi-Fi Alliance. Any use of these marks on this website does not imply any affiliation with or endorsement.