



## amazonbasics Siedentopf Binocular Compound Microscope User Guide

[Home](#) » [AmazonBasics](#) » amazonbasics Siedentopf Binocular Compound Microscope User Guide 

# amazonbasics

Siedentopf Binocular Compound Microscope  
B07TYT8KQL, B07TZRTB9H

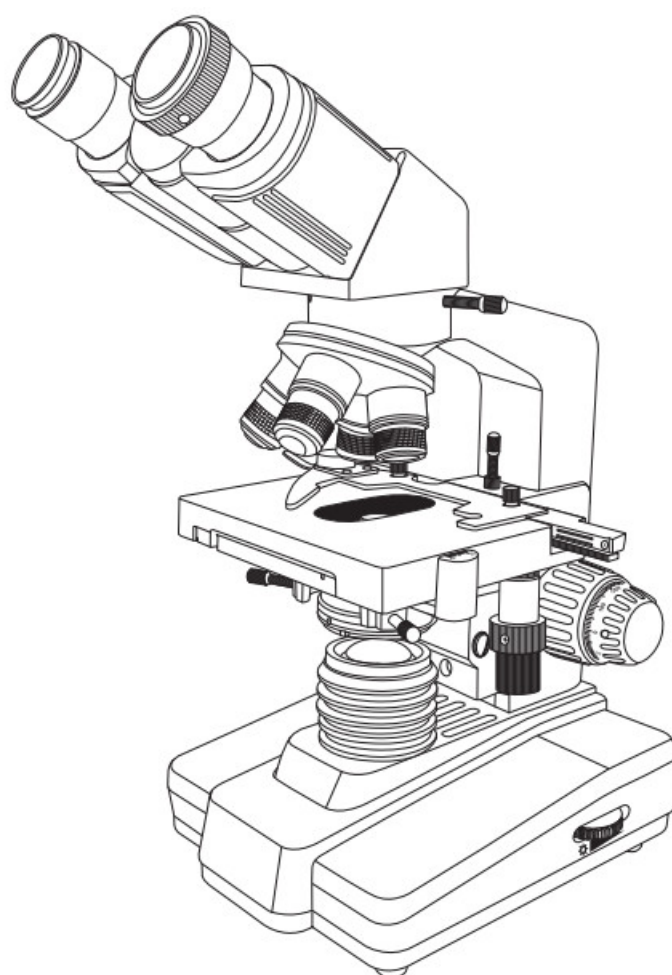

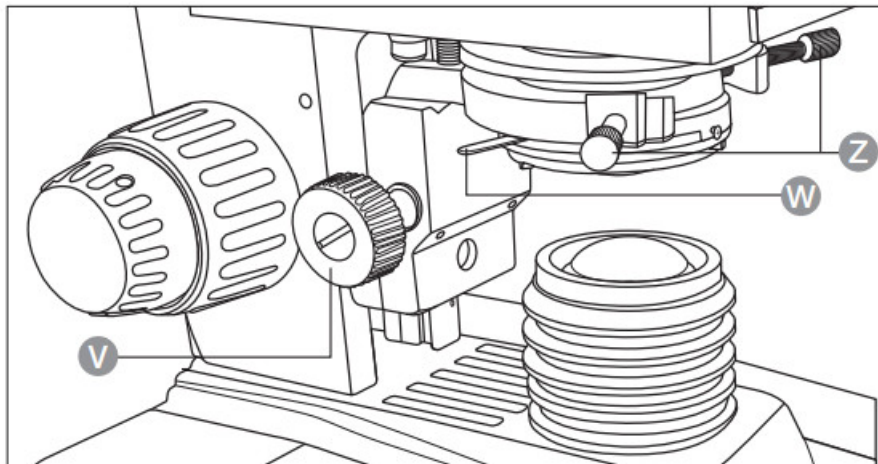
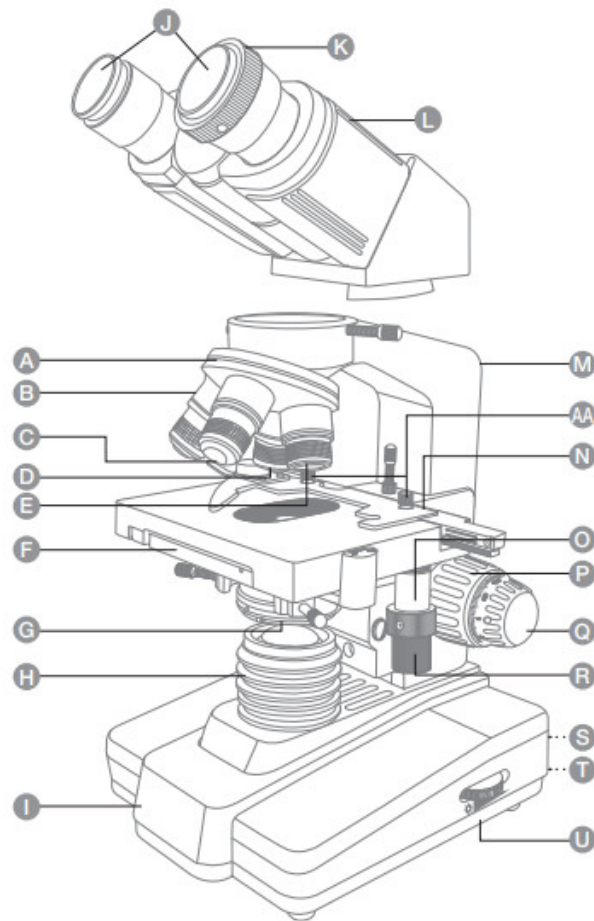

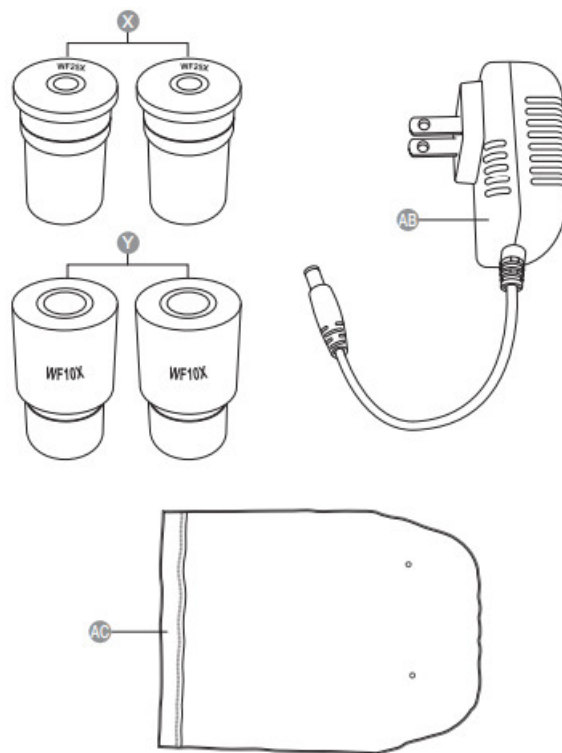

## Contents

- [1 Parts Description](#)
- [2 IMPORTANT SAFEGUARDS](#)
- [3 Symbols Explanation](#)
- [4 Intended Use](#)
- [5 Before First Use](#)
- [6 Assembly](#)
- [7 Operation](#)
- [8 Cleaning and Maintenance](#)
- [9 FCC – Supplier's Declaration of Conformity](#)
- [10 Canada IC Notice](#)
- [11 Specifications](#)
- [12 Feedback and Help](#)
- [13 Documents / Resources](#)
  - [13.1 References](#)
- [14 Related Posts](#)



## Parts Description

A	Nose piece	P	Coarse adjustment knob
B	10x objective lens (yellow)	Q	Fine adjustment knob
C	4x objective lens (red)	R	X-axis translation control
D	40x objective lens (blue)	S	Power socket
E	100x objective lens (white)	T	Power switch
F	Stage	U	Brightness adjustment wheel
G	Condenser	V	Condenser vertical adjustment knob
H	Transmitted light lamp	W	Condenser diaphragm
I	Base	X	25x eyepiece x2
J	Eyepiece cover x2	Y	10x eyepiece x2
K	Diopter adjustment	Z	Condenser adjustment screws
L	Adjustable eyepiece housing	AA	Stage clip locking screws
M	Arm	AB	Adapter
N	Stage clip	AC	Dust cover
O	Y-axis translation control		



## IMPORTANT SAFEGUARDS



Read these instructions carefully and retain them for future use. If this product is passed to a third party, then these instructions must be included.

When using electrical appliances, basic safety precautions should always be followed to reduce the risk of fire, electric shock, and/or injury to persons including the following:



**WARNING** It is prohibited to disassemble the machine.



**WARNING Risk of serious injury!** Dyes are harmful by inhalation, harmful in contact with skin, harmful if swallowed.

**Methylene Blue Dye:** Avoid eye and skin contact. Causes serious eye irritation. Do not swallow. Do not inhale.



**First aid in case of eye contact:** Immediately flush eyes with excess water for 15 minutes, lifting lower and upper eyelids occasionally. Get medical attention if irritation develops.

**First aid in case of skin contact:** Immediately flush skin with excess water for 15 minutes while removing contaminated clothing. Get medical attention if irritation develops.

**First aid in case of ingestion:** Do not induce vomiting without medical advice. Consult a physician if necessary.

**NOTICE** Methylene Blue dye has been classified by the International Agency for Research on Cancer (IARC) as Group 3: Not classifiable as carcinogenic to humans.

**NOTICE** Use the product within the correct ambient conditions to avoid mildewing and damage.

- Keep the work area clean, clear, and away from any food storage. Prepare the slides in a well-lit area and close

to a water supply. Use a solid table with a heat-resistant top.

- Do not allow dyes to come into contact with any part of the body particularly the mouth and eyes.
- Do not eat, drink or smoke in the work area.
- Clean all the accessories and the work area after each use.



Wash hands thoroughly after handling and carrying out experiments.

- A separate tin or bucket should be used for the disposal of specimen samples and dyes. Any wasted solution should be poured directly down a drain, but never into a sink basin.
- Dispose of used specimen samples household trash immediately after use.
- Do not discard any equipment to the fire to avoid violent combustion or explosion.
- If the product has to be moved, carry with one hand holding the product at the arm and another hand supporting it at the base.
- Examine the set regularly for potentially unsafe conditions, such as damaged housing, or parts. In the event of such damage, the set should not be used until it is properly repaired.
- Store the set in its original packaging out of reach of children and animals.

## Symbols Explanation

	This product is classified as protection class II. This means the product is equipped with reinforced or double insulation between the mains supply circuit and the output voltage or the casing. Therefore it does not require a safety connection to electrical earth (ground).
	This product is for indoor use only.
	Direct current (DC).
	Alternating current (AC).
	Health advice for emergencies.
	Wash hands before and after experiments.
	Safety warning. Improper use of the product could result in injury or death.



**Intended Use**

- This product is for private use, homeschooling, school applications and teaching demonstrations. It is not for commercial use.
- This product is intended to be used in dry indoor areas only.
- No liability will be accepted for damages resulting from improper use or non-compliance with these instructions.



### Before First Use

- Check the product for transport damages.



**DANGER Risk of suffocation!** Keep any packaging materials away from children – these materials are a potential source of danger, e.g. suffocation.



### Assembly

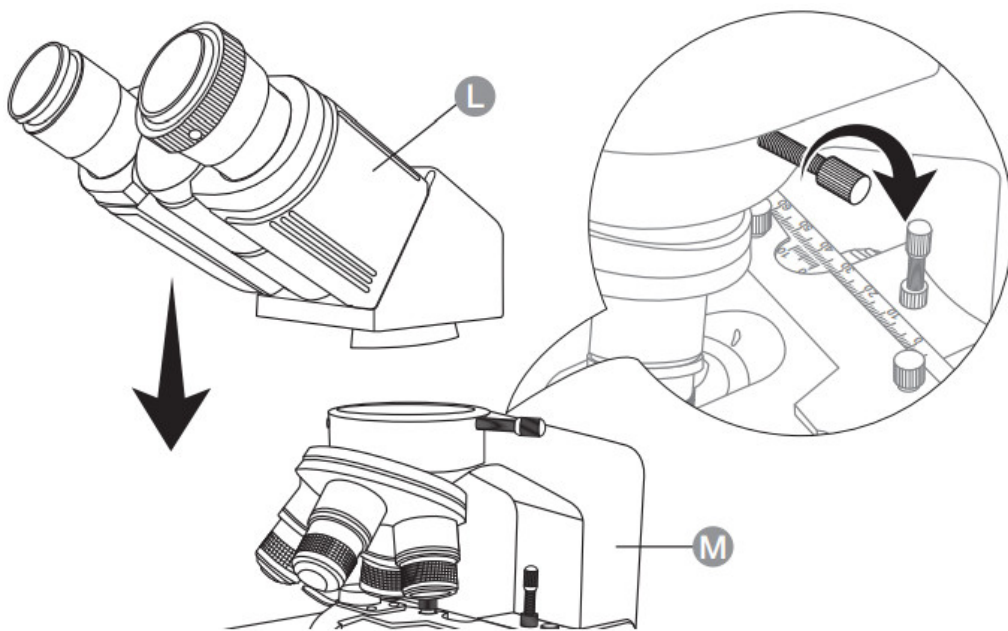

- Remove the cover on the base of the adjustable eyepiece housing (L).
- Remove the cover on the top of the arm (M).
- Connect the two pieces together.
- Fasten the top part using the screw on the arm (M).



## Operation

### Switching on/off

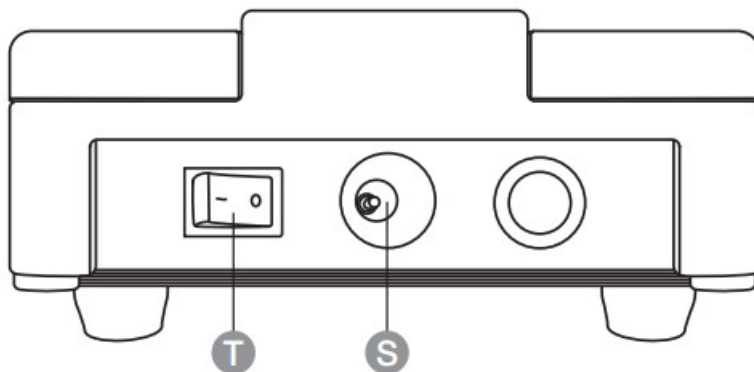

- Connect the adapter (AB) to a power outlet and the other end to the power socket (S). The LED lights up.

**NOTICE** To prevent the bulb in the transmitted light lamp (H) from burning, turn the brightness adjustment wheel (U) setting to the lowest before turning on or off.

- Flip the power switch (T) to “I” to turn on the transmitted light lamp (H).
- Flip the power switch (T) to “O” to turn off.

### Calculating magnification power

Total magnification power is calculated by multiplying the magnification power of the eyepiece and the objective lens.

Eyepiece magnification power	Objective lens magnification power	Total magnification power
10x (Y)	4x (C)	40x
	10x (B)	100x
	40x (D)	400x
	100x (E)	1000x
25x (X)	4x (C)	100x
	10x (B)	250x
	40x (D)	1000x
	100x (E)	2500x





## Observing through the microscope

- Remove the eyepiece covers (J) from the adjustable eyepiece housing (L).
- Place eyepieces (X/Y) into the adjustable eyepiece housing (L).
- Turn the coarse focus knob (P) to adjust the height of the stage (F) to the lowest position.
- Look into the eyepiece (I), adjust the brightness of the illuminator (H) using the brightness adjustment wheel (U).
- Rotate the nose piece (A) to the lowest magnification power setting.

**NOTICE** Start with the lowest magnification power every time a new slide is placed on stage (F). Most observations are made at low magnification power.

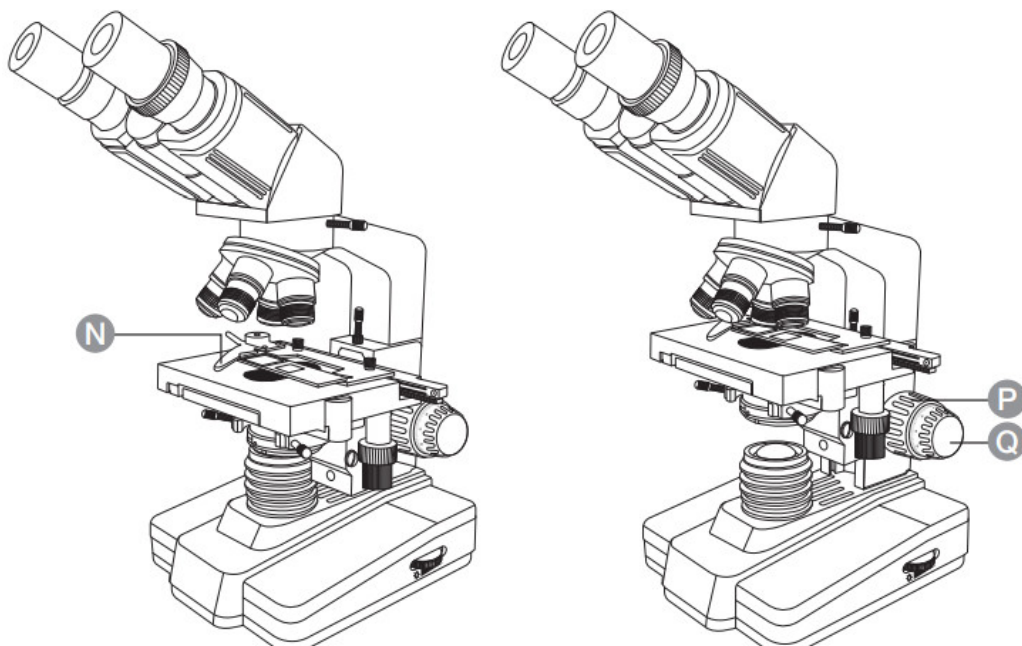

- Loosen the stage locking screws (AA) to insert the slide (not included) onto the stage clip (N).
- Tighten the screws (AA) of the stage clip (N) to secure the slide on the stage (F).
- Without looking into the eyepiece (X/Y), turn the coarse focus knob (P) until the objective lens is close to the slide. The objective lens should not touch the slide.
- Adjust the position of the slide using the X and Y translation controls (O, R).
- Look into the left eyepiece (X/Y), rotate the fine focus knob (Q) slowly until the image is clear. Adjust the position of the slide if needed.



**CAUTION** Risk of electric damage! Never force the adjustment knobs (P), (Q) and, (V) to turn further once the knob is already restrained from turning. It may cause friction and scratch the lenses.

- The condenser (G) is adjusted to focus the light on the specimen. Tinker around with the condenser (G)'s a vertical knob (V), diaphragm (W), and adjustment screws (Z) to achieve the sharpest image.

**NOTICE** The condenser diaphragm (W) gathers the available light and concentrates it to illuminate over the

specimen with uniform intensity.

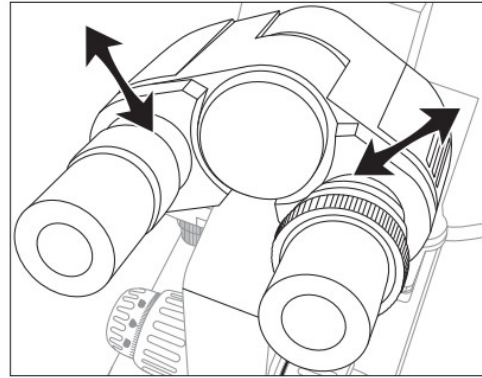
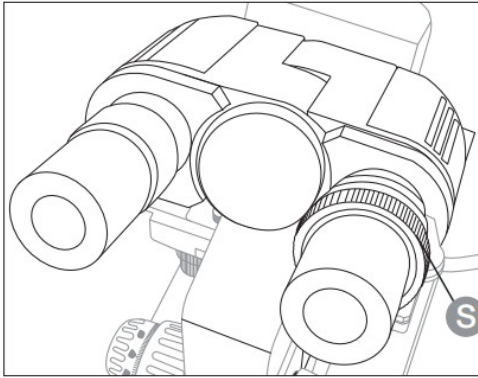

- Look into the right eyepiece (X/Y), rotate the diopter adjustment (K) until the image is clear.
- Look into both eyepieces (X/Y), adjust the distance between the adjustable eyepiece housing (L) until the two images merge into one.
- Rotate the nose piece (A) to the next objective lens, increasing in magnification power. Re-adjust the focus using the fine focus knob (Q) if needed.
- After using the microscope, remove the slide from the stage (F), take off the eyepieces (X/Y), and place the eyepiece covers (J) on.
- Turn to a minimum the adjustment wheel (U).
- Switch off (T) and disconnect the adapter (AB) from the power outlet.
- Clean the work area and dispose of the used specimens.

## Cleaning and Maintenance



**WARNING** Risk of damage! During cleaning do not immerse the product in water or other liquids. Never hold the product under running water.

### Cleaning

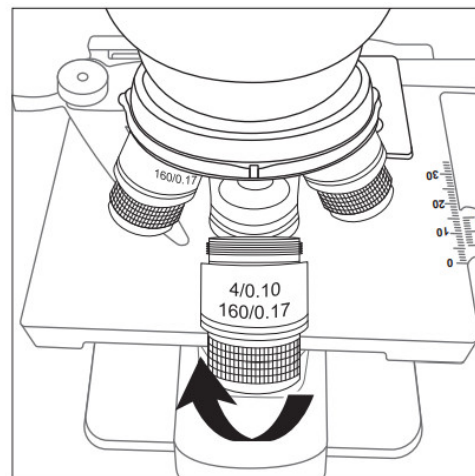
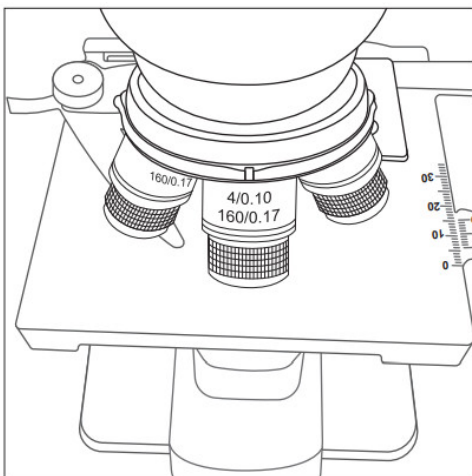

- To clean the lenses (B, C, D, E, X, Y), only use lens cleaning tissues. Do not use cloth, paper or hands. Rotate the objective lenses (B, C, D, E) counter-clockwise to remove them from the nose piece (A).
- To clean the product, wipe with a soft, slightly moist cloth.

- Never use corrosive detergents, wire brushes, abrasive scourers, metal or sharp utensils to clean the product.

## Maintenance

- After each use, place the dust cover (AC) on the microscope. Place the accessories back into their respective plastic bags to prevent dust from collecting.
- Slight greasing or putting oil may be needed for the mechanical moving parts. Apply the appropriate oil discreetly.



## FCC – Supplier's Declaration of Conformity

Unique Identifier	B07TYT8KQL, B07TZRTB9H – Siedentopf Binocular Compound Microscope
Responsible Party	Amazon.com Services, Inc
U.S. Contact Information	410 Terry Ave N. Seattle, WA 98109, United States
Telephone Number	206) 266-1000

## FCC Compliance Statement

1. This device complies with Part 15 of the FCC rules. Operation is subject to the following two conditions:
  - (1) this device may not cause harmful interference, and
  - (2) this device must accept any interference received, including interference that may cause undesired operation.
2. Changes or modifications not expressly approved by the party responsible for compliance could void the user's authority to operate the equipment.

## FCC Interference Statement

This equipment has been tested and found to comply with the limits for a Class B digital device, pursuant to part 15 of the FCC Rules. These limits are designed to provide reasonable protection against harmful interference in a residential installation. This equipment generates, uses and can radiate radio frequency energy and, if not installed and used in accordance with the instructions, may cause harmful interference to radio communications. However, there is no guarantee that interference will not occur in a particular installation. If this equipment does cause harmful interference to radio or television reception, which can be determined by turning the equipment off and on, the user is encouraged to try to correct the interference by one or more of the following measures:

- Reorient or relocate the receiving antenna.
- Increase the separation between the equipment and receiver.
- Connect the equipment into an outlet on a circuit different from that to which the receiver is connected.
- Consult the dealer or an experienced radio / TV technician for help.

## Canada IC Notice

- This Class B digital apparatus complies with Canadian CAN ICES-3(B) / NMB-3(B) standard.



## Specifications

Power input:	100-240 V~, 50/60 Hz, 0.8 A
Adapter output:	5 V , 500 mA
Magnification power range:	40x to 2500x
Working temperature:	-40 to 158 °F (-40 to 70 °C)
R.H. range:	10 to 100%
Net weight:	approx. 24.2 lbs (11 kg)
Dimensions (W x H x D):	approx. 9.45 x 18.9 x 13 in (24 x 48 x 33 cm)



## Feedback and Help

Love it? Hate it? Let us know with a customer review.

AmazonBasics is committed to delivering customer-driven products that live up to your high standards. We encourage you to write a review sharing your experiences with the product.



[amazon.com/review/review-your-purchases#](https://www.amazon.com/review/review-your-purchases#)



[amazon.com/gp/help/customer/contact-us](https://www.amazon.com/gp/help/customer/contact-us)

# amazonbasics

[amazon.com/AmazonBasics](https://www.amazon.com/AmazonBasics)



**MADE IN CHINA**

**V01-08/19**

## Documents / Resources

	<p><a href="#">amazonbasics Siedentopf Binocular Compound Microscope</a> [pdf] User Guide B07TYT8KQL, B07TZRTB9H, Siedentopf Binocular Compound Microscope</p>
---	--

## References

-  [Amazon.com. Spend less. Smile more.](#)
-  [Amazon.com: Amazon Basics](#)

Manuals+.