



# Amazon Echo Show 15 User Guide

[Home](#) » [Amazon](#) » Amazon Echo Show 15 User Guide 

## Contents

- 1 [Amazon Echo Show 15](#)
- 2 [MEET YOUR ECHO SHOW 15](#)
- 3 [BEFORE MOUNTING YOUR DEVICE](#)
- 4 [ALSO IN THE BOX](#)
- 5 [MOUNTING YOUR ECHO SHOW 15 ON YOUR WALL](#)
- 6 [SET UP YOUR ECHO SHOW 15](#)
- 7 [EXPLORE YOUR ECHO SHOW 15](#)
- 8 [THINGS TO TRY WITH ALEXA](#)
- 9 [PRIVACY AND TROUBLESHOOTING](#)
- 10 [DOWNLOAD](#)
- 11 [References](#)
- 12 [Related Posts](#)

## Amazon Echo Show 15



## QUICK START GUIDE

### MEET YOUR ECHO SHOW 15

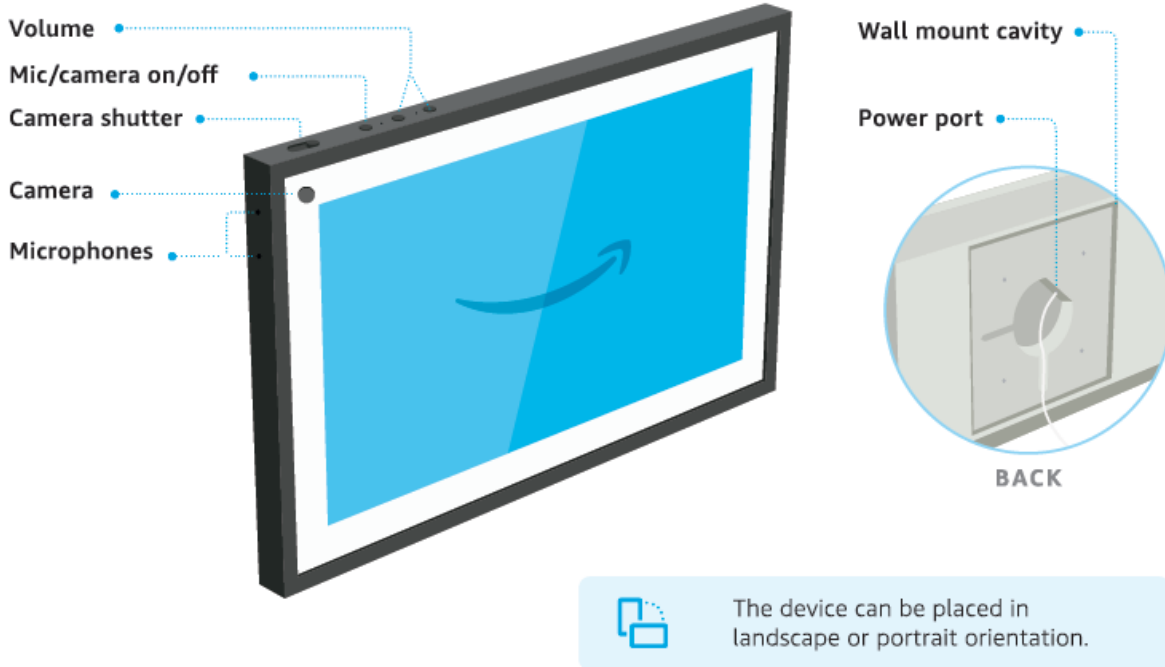





### BEFORE MOUNTING YOUR DEVICE

#### TIPS FOR MOUNTING ON THE WALL

- Consider the height of everyone using the device. We recommend placing the device at eye level.
- Make sure there's enough room to mount the device in both orientations.
- Don't drill holes over studs, electrical wiring, or piping.
- Before mounting, unplug the device from electrical outlet and keep it away from water.

#### TOOLS YOU'LL NEED

-  **Electric drill**
  - 5/16. (or 8 mm)
  - Phillips #2 driver bit
-  Hammer
-  Level or level app
-  Wall-safe tape

### ALSO IN THE BOX



Wall mount



Power adapter



4x Screws



4x Anchors

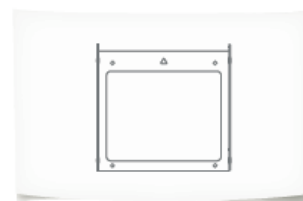

Mounting template  
*sized to the device*  
15.8" x 9.9" (40.2 x 25.2 cm)

Included screws and anchors are recommended for drywall, brick, concrete or tile surfaces

## MOUNTING YOUR ECHO SHOW 15 ON YOUR WALL

### 1. LEVEL AND TAPE TEMPLATE TO THE WALL

- Use the mounting tips and the included mounting template to identify where to mount your device.
- Place the template on the wall in your chosen orientation.
- Use a level or a level app on your phone to level the template.
- Tape the template in place.

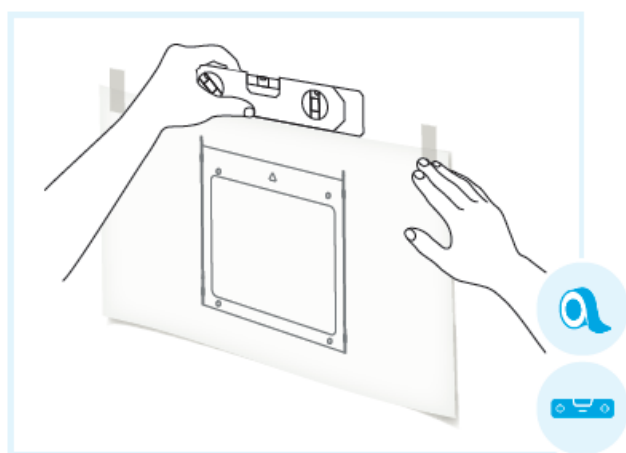

### 2. DRILL HOLES AND INSTALL ANCHORS

- Using an electric drill with a 5/16" (or 8 mm) drill bit, drill through the designated holes in the template. Remove template after drilling holes.
- Slowly hammer each of the 4 anchors into the holes until they are flat against the wall.

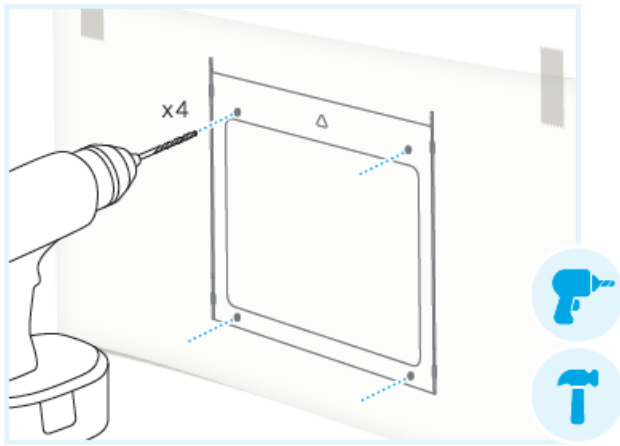

### 3. INSTALL WALL MOUNT

Place the wall mount against the wall, aligning the 4 holes with the installed anchors. With the Phillips driver bit, drive the screws through the wall mount holes until they are flat against the wall mount.

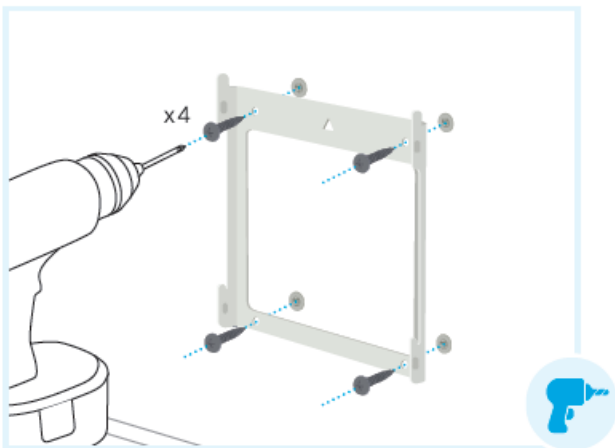

### 4. PLUG SUPPLIED POWER CORD INTO DEVICE

Once the device is mounted on the wall, you won't be able to access its power port. DO NOT plug it into a wall outlet yet.

### 5. SLIDE DEVICE ONTO MOUNT

Place the device flat over the top of the wall mount and slide it down, ensuring that all 4 hooks in the wall mount are engaged with the device. Make sure the device is placed with the camera at the top.

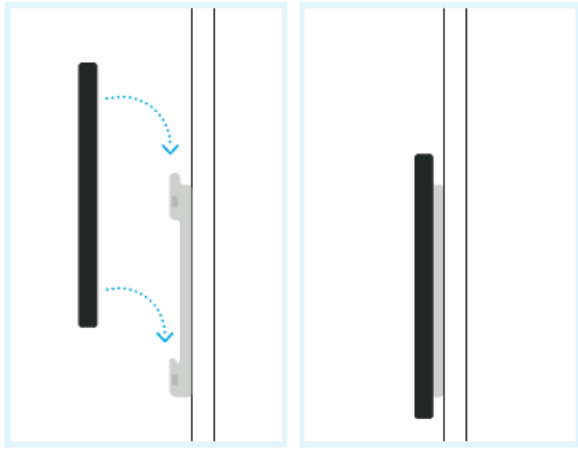

To change the device's orientation, and unhook it from the wag mount and remount it in the other orientation.

## SET UP YOUR ECHO SHOW 15



### 1. HAVE YOUR WIFI AND AMAZON PASSWORDS READY

During setup, you will connect to the internet and sign into your Amazon account.



### 2. PLUG ECHO SHOW 15 INTO A POWER OUTLET

Use the included power adapter. In about a minute, the display will turn on and Alexa will greet you.



### 3. FOLLOW THE ON-SCREEN SETUP

Log in with an existing Amazon account username and password or create a new account



### 4. DOWNLOAD THE LATEST VERSION OF THE AMAZON ALEXA APP

The app helps you get more out of your Echo Show 15. It's where you set up calling and messaging and manage music, lists, settings, and news.

## EXPLORE YOUR ECHO SHOW 15

### TO ACCESS SETTINGS AND SHORTCUTS

Swipe down from the top edge of the screen.



## TO ACCESS YOUR WIDGETS

In landscape orientation, swipe left from the right edge of the screen. In portrait orientation, swipe up from the bottom edge of the screen.

## THINGS TO TRY WITH ALEXA

### Try Asking "What Can You Do"?

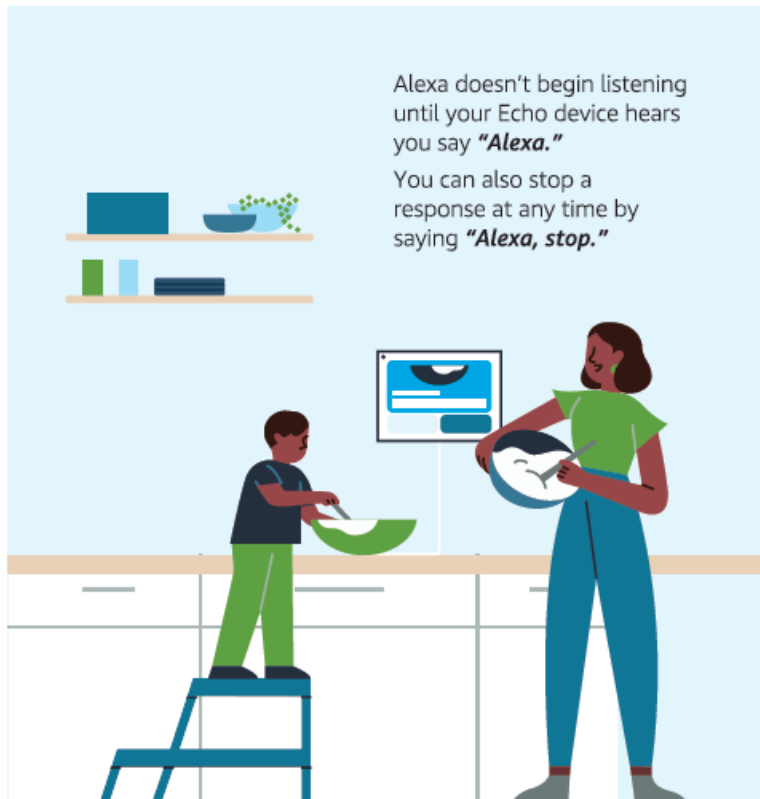

### STAY ORGANIZED

"Alexa, what's on the calendar today?"

"Alexa, add laundry to my to-do list."



### GET COOKING

"Alexa, add milk to my shopping list."

° "Alexa show me dinner recipes."



### WATCH & UNWIND

"Alexa, show me my photos."

° "Alexa, show my photos."



### CONTROL YOUR SMART HOME

"Alexa, show my smart home dashboard."

"Alexa show me the nursery."



## DISCOVER MORE

“Alexa, what widgets can I add?”

“Alexa, add a weather widget”

Discover and learn what Alexa can do at [amazon.com/alexa](https://amazon.com/alexa) or [amazon.ca/meetalexa](https://amazon.ca/meetalexa).

Some features may require customization. In the Alexa app, a separate subscription, or an additional compatible smart home device. You can find more examples and tips in the Alexa app.

## PRIVACY AND TROUBLESHOOTING



### PRIVACY CONTROLS

- Turn the camera and mics off by pressing the microphone and camera on/off button.
- Cover the camera easily with the built-in shutter.
- See when Alexa is recording and sending your request to Amazon's secure cloud via a blue indicator light.



### MANAGE YOUR VOICE HISTORY

You can view, hear, and delete the recordings associated with your account in the Alexa app at any time. To delete your voice recordings, try saying,

“Alexa, delete what I just said.”

“Alexa, delete everything I've ever said.”



### GIVE US YOUR FEEDBACK

Alexa is always getting smarter and adding new skills. To send us feedback about your experiences with Alexa, use the Alexa app, visit [amazon.com/devicesupport](https://amazon.com/devicesupport), or say, “Alexa, I have feedback.”



### TROUBLESHOOTING

For help and troubleshooting, go to Help & Feedback in the Alexa app or visit [amazon.com/devicesupport](https://amazon.com/devicesupport).

---

## DOWNLOAD

Amazon Echo Show 15 Quick Start Guide – [[Download PDF](#)]

---

## References

- [User Manual](#)

[Manuals+](#), [Privacy Policy](#)

This website is an independent publication and is neither affiliated with nor endorsed by any of the trademark owners. The "Bluetooth®" word mark and logos are registered trademarks owned by Bluetooth SIG, Inc. The "Wi-Fi®" word mark and logos are registered trademarks owned by the Wi-Fi Alliance. Any use of these marks on this website does not imply any affiliation with or endorsement.