



Amazon Echo Show 10 (3rd Generation) User Guide

[Home](#) » [Amazon](#) » Amazon Echo Show 10 (3rd Generation) User Guide 

Contents

- [1 Amazon Echo Show 10 \(3rd Generation\)](#)
- [2 Getting to know your Echo Show 10](#)
- [3 Set up your Echo Show 10](#)
- [4 Place your Echo Show 10](#)
- [5 Control the rotating smart screen](#)
- [6 Alexa is designed to protect your privacy](#)
- [7 Explore your Echo Show 10](#)
- [8 Download the Amazon Alexa app](#)
- [9 Give us your feedback](#)
- [10 DOWNLOAD](#)
- [11 Related Posts](#)

Amazon Echo Show 10 (3rd Generation)



QUICK START GUIDE

Getting to know your Echo Show 10

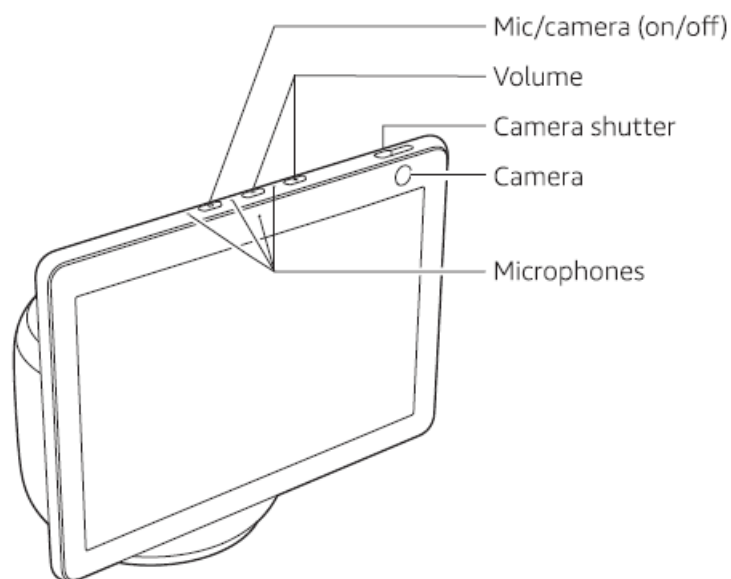

Additional features: built-in smart home hub, rotating smart screen

Set up your Echo Show 10

Slide the included motion footprint template around the body of the device.

Important: This template shows the keep-out space around the device. Always keep this space clear of objects like cups that may get knocked over.

Follow the on-screen instructions to register your Echo Show 10.

During registration, Echo Show 1D will rotate to calibrate and locate its idle position. After calibrating, you may need to adjust the device so that the screen is facing the direction you'll most often see it from.

Place your Echo Show 10

Thoroughly clean and dry the location you've chosen for your Echo Show 10. Then plug the included power adapter into the base of the device and set it in place.

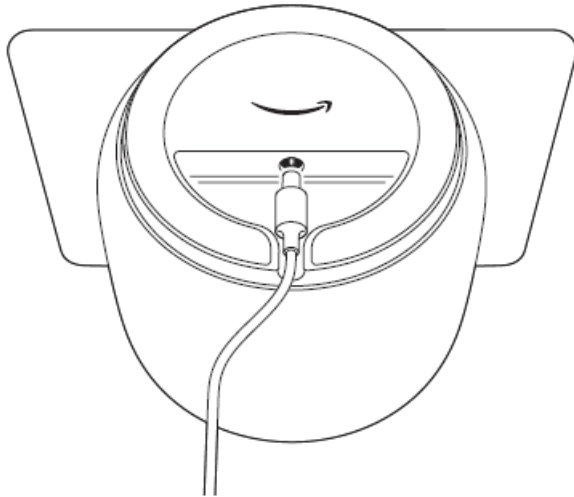

Control the rotating smart screen

You can turn motion on or off in your device's settings, or by asking Alexa. For example, to stop the screen from rotating, simply say, "Alexa, turn off motion."

For help and troubleshooting, go to Help & Feedback in the Alexa app or visit

www.amazon.com/devicesupport.

Alexa is designed to protect your privacy



Wake word and indicators

Alexa doesn't begin listening until your Echo device detects the wake word (for example, "Alexa"). A blue light indicator lets you know when the device is recording your request to stream to Amazon's secure cloud. If you like, you can also enable an audio tone.



Microphone and camera controls

You can electronically disconnect the mics and camera with one press of a button. Slide the built-in shutter to cover the camera.



Voice History

Want to know exactly what Alexa heard? You can view and delete the voice recordings associated with your account in the Alexa app at any time.

Explore your Echo Show 10

To change your settings

Swipe down from the top of the screen, or say, "Alexa, show Settings."

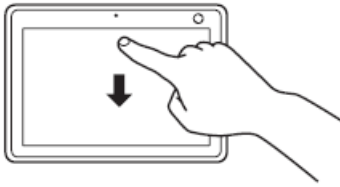

To access your shortcuts

Swipe left from the right side of the screen.

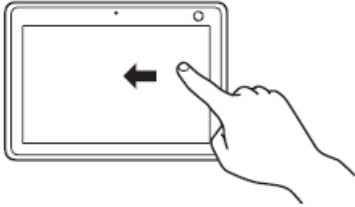

Download the Amazon Alexa app



Installing the Alexa app on your phone or tablet helps you get more out of your Echo Show 10.

It's where you set up calling and messaging, and manage music, lists, settings, and news.

Give us your feedback

Alexa is always getting smarter and adding new skills. To send us feedback about your experiences with Alexa, use the Alexa app, visit www.amazon.com/devicesupport, or simply say, "Alexa, I have feedback."

DOWNLOAD

Amazon Echo Show 10 (3rd Generation) Quick Start Guide – [[Download PDF](#)]
