



Amazon Echo Dot (2nd Generation) User Guide

[Home](#) » [Amazon](#) » Amazon Echo Dot (2nd Generation) User Guide 

Contents

- [1 Amazon Echo Dot \(2nd Generation\)](#)
- [2 Getting to know Echo Dot](#)
- [3 Setup](#)
- [4 Getting started with Echo Dot](#)
- [5 DOWNLOAD](#)
- [6 Related Posts](#)

Amazon Echo Dot (2nd Generation)



USER GUIDE

Getting to know Echo Dot

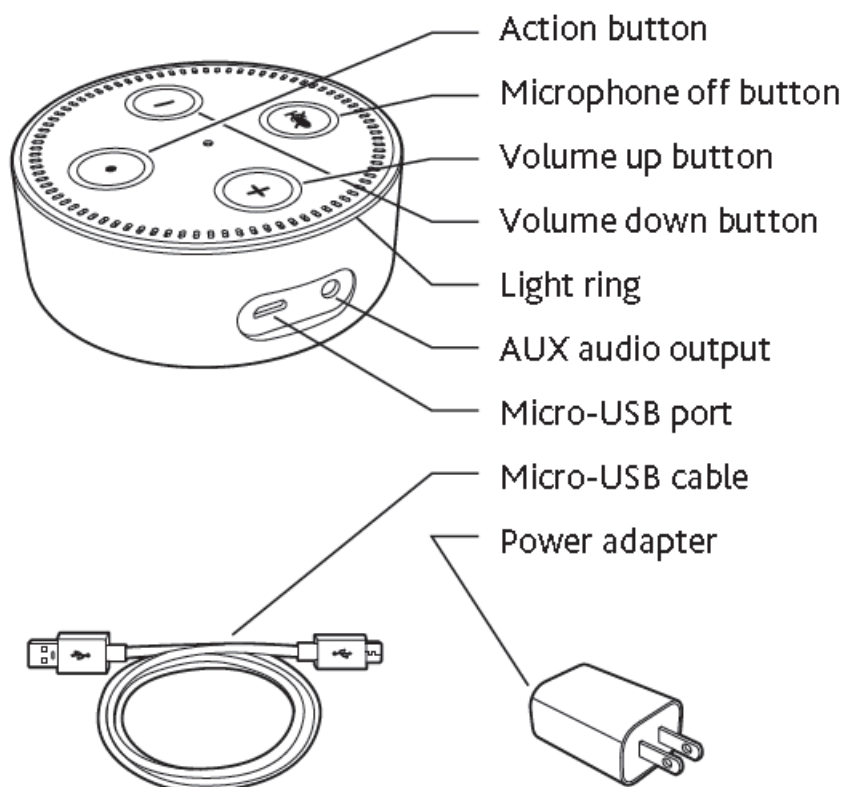

Setup

1. Plug in Echo Dot

Plug the micro-USB cable and 9W adapter into Echo Dot and then into a power outlet. You must use the items

included in the original Echo Dot package for optimal performance. A blue light ring will begin to spin around the top. In about a minute, the light ring will change to orange and Alexa will greet you.

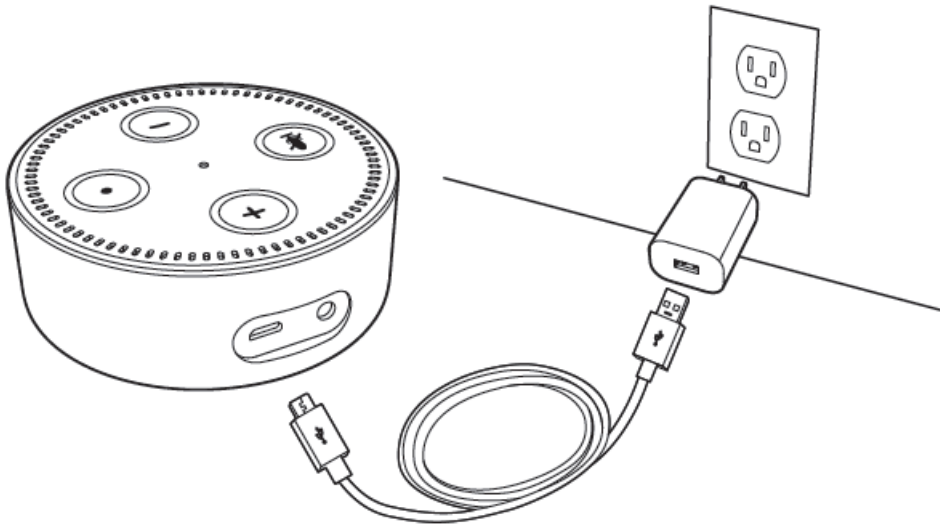

2. Download the Alexa App

Download the free Amazon Alexa app to your phone or tablet. Start the download process in your mobile browser at:

<http://alexa.amazon.com>

If the setup process does not automatically start, go to Settings > Set up a new device. During setup, you will connect Echo Dot to the Internet, so you will need your Wi-Fi password.

3. Connect to your speaker

You can connect your Echo Dot to a speaker using Bluetooth or an AUX cable.

If you are using Bluetooth, place your speaker more than 3 feet from Echo Dot for optimal performance.

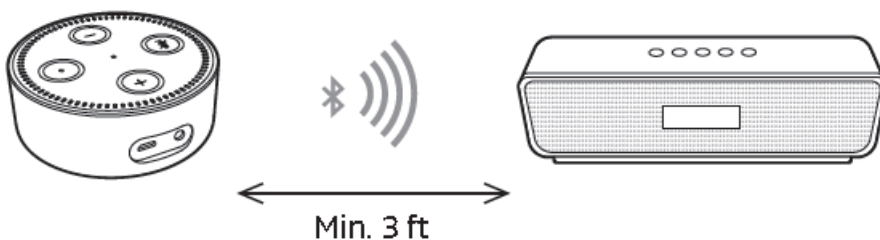

Getting started with Echo Dot

Talking to Echo Dot

To get Echo Dot's attention, simply say "Alexa." See the Things to Try card to help you get started.

Alexa App

The app helps you get more out of your Echo Dot. It's where you manage your lists, news, music, settings, and

see an overview of your requests.

Give us your feedback

Alexa will improve over time, with new features and ways to get things done. We want to hear about your experiences. Use the Alexa App to send us feedback or email **echodot-feedback@amazon.com**.

DOWNLOAD

Amazon Echo Dot (2nd Generation) User Guide – [[Download PDF](#)]

Amazon Echo Dot (2nd Generation) Quick Start Guide International Version – [[Download PDF](#)]
