

**amazon**  
**3rd Generation**  
**Echo Show 8**  
**Inch Smart**  
**Display**



# Amazon 3rd Generation Echo Show 8 Inch Smart Display Instruction Manual

[Home](#) » [Amazon](#) » Amazon 3rd Generation Echo Show 8 Inch Smart Display Instruction Manual 

Contents

1 Amazon 3rd Generation Echo Show 8 Inch Smart Display

2 Specifications

3 FAQs

4 Documents / Resources

4.1 References



## Amazon 3rd Generation Echo Show 8 Inch Smart Display



### Specifications

Feature	Description
Camera	Front-facing camera for video calls and photos.
Microphones	Built-in microphones for voice commands.
Light Bar	Indicates Alexa's status and activity.
Camera Shutter	Physical shutter for privacy control.
Volume Control	Buttons for adjusting volume levels.
Power Port	Connection for power adaptor.

MEET YOUR ECHO SHOW 8



BACK



SET UP YOUR ECHO SHOW 8

 HAVE YOUR WIFI AND AMAZON PASSWORDS READY

- During setup, you will connect to the internet and sign in to your Amazon account.



## **PLUG ECHO SHOW 8 INTO A POWER OUTLET**

- Use the included power adaptor. In about a minute, the display will turn on and Alexa will greet you.



## **FOLLOW THE ON-SCREEN SETUP**

- Log in with an existing Amazon account username and password or create a new account.



## **DOWNLOAD ALEXA APP FROM APP STORE**

- Install the app on your phone or tablet. It's where you set up smart devices, music settings, calling, and manage lists, settings, and news.

## **EXPLORE YOUR ECHO SHOW 8**



## **TO CHANGE YOUR SETTINGS**

- Swipe down from the top edge of the screen.



## **OPTIONAL: SET UP COMPATIBLE SMART HOME DEVICES**

- You can easily connect and control compatible devices with the built-in smart home hub. When ready to get started, open the Alexa app to add your device.

## **PRIVACY AND SUPPORT**



## **PRIVACY CONTROLS**

- Turn the microphones and camera off by pressing the microphones/camera on/off button.
- Cover the camera easily with the built-in shutter.
- See when Alexa is recording and sending your request to Amazon's secure cloud via a blue indicator light.



## **MANAGE YOUR VOICE HISTORY**

- You can view, hear, and delete the voice recordings associated with your account in the Alexa app at any time.



## CUSTOMER SUPPORT

- For help and troubleshooting, go to Help & Feedback in the Alexa app or visit [amazon.com/devicesupport](https://amazon.com/devicesupport)

You have control over your Alexa experience. Explore more at [amazon.com.au/alexaprivacy](https://amazon.com.au/alexaprivacy)

## THINGS TO TRY WITH ALEXA

Start by asking, “Alexa, what can you do?”

You can also stop a response at any time by saying, “Alexa, stop.”

Explore more at [amazon.com.au/meetalexa](https://amazon.com.au/meetalexa)



## KEEP THE FAMILY IN SYNC

- “Alexa, call Dad.”
- Alexa, announce dinner is ready.”
- Alexa, show me my calendar.



## DO MORE WITH ALEXA



## LISTEN, WATCH & UNWIND

- “Alexa, play top hits.”
- “Alexa, play the news.”
- “Alexa, open Prime Video. 11



## CONTROL YOUR

- SMART HOME
- “Alexa, turn on the lamp.”
- “Alexa, show me the front door.”



## MANAGE YOUR DAY

- “Alexa, set a 5-minute timer.”
- “Alexa, start my day.”
- “Alexa, buy toothpaste.”



## GET THE FORECAST

- “Alexa, show me the weather.”
- “Alexa, is it going to rain?”

Some features may require customization in the Alexa app, a separate subscription, or on additional compatible smart home device. Certain skills and services may not be available in all languages. You can find more examples and tips in the Alexa app.



## FAQs

How do I set up my Echo Show 8?

Follow the on-screen setup instructions after plugging in your device and downloading the Alexa app.

Can I control my smart home with Echo Show 8?

Yes, you can connect and control compatible smart home devices using the built-in smart home hub.

How do I manage my privacy settings?

Use the camera shutter and microphone/camera on/off button to control privacy. Manage voice recordings in the Alexa app.

What can I ask Alexa to do?

Alexa can play music, control smart home devices, provide weather forecasts, and much more. Start by asking, "Alexa, what can you do?"

## Documents / Resources

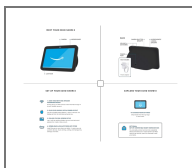

[Amazon 3rd Generation Echo Show 8 Inch Smart Display](#) [pdf] Instruction Manual  
3rd Generation Echo Show 8 Inch Smart Display, 3rd Generation, Echo Show 8 Inch Smart Display, 8 Inch Smart Display, Smart Display

## References

- [User Manual](#)

[Manuals+](#), [Privacy Policy](#)

This website is an independent publication and is neither affiliated with nor endorsed by any of the trademark owners. The "Bluetooth®" word mark and logos are registered trademarks owned by Bluetooth SIG, Inc. The "Wi-Fi®" word mark and logos are registered trademarks owned by the Wi-Fi Alliance. Any use of these marks on this website does not imply any affiliation with or endorsement.