

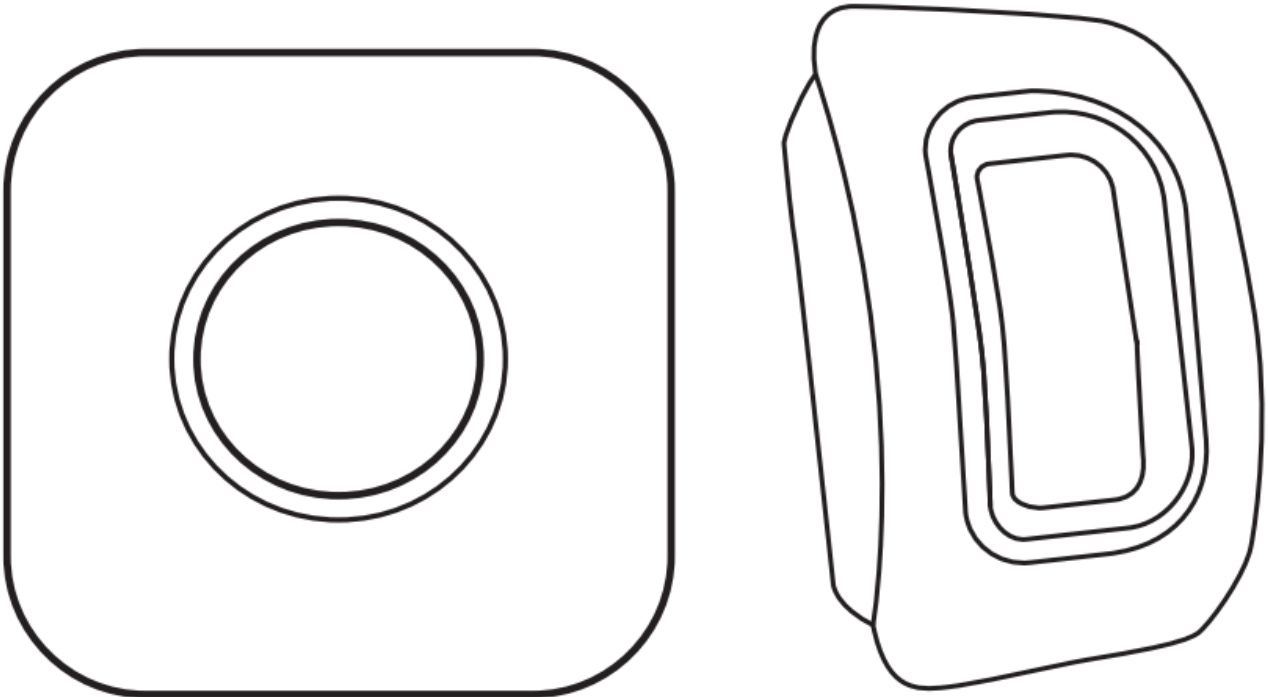

amazon basics SW2 Motion Sensor Alarm Detector User Manual

[Home](#) » [amazon basics](#) » amazon basics SW2 Motion Sensor Alarm Detector User Manual 

amazon basics SW2 Motion Sensor Alarm Detector



Contents

- 1 Thank you
- 2 How does it work
 - 2.1 Applicable Places
 - 2.2 Features
- 3 OVERVIEW
 - 3.1 Structure of receiver
 - 3.2 Structure of Motion Sensor
- 4 BEFORE INSTALLATION
- 5 INSTALLATION OF MOTION SENSOR
 - 5.1 INSTALLING OF MOTION SENSOR
- 6 GETTING STARTED
 - 6.1 POWERING THE INDOOR CHIME RECEIVE
 - 6.2 POWERING THE MOTION SENSOR
 - 6.3 SOUND VOLUME CONTROL
 - 6.4 SETTING RINGTONE FOR A TRANSMITTER
- 7 PAIRING A TRANSMITTER TO THE RECEIVER
- 8 RESET
- 9 TROUBLE SHOOTING
- 10 COMMON PROBLEMS AND SOLUTIONS
- 11 Chimes List
- 12 How to Contact After-sale Service?
- 13 Documents / Resources
 - 13.1 References
- 14 Related Posts

Thank you

for purchasing our product! To ensure proper use and trouble-free operation, please carefully read this user manual first.

How does it work

Infrared motion sensor can detect the temperature change of human and big animals caused by movement .When someone or animal enters the detecting area (5m X 90°) ,motion sensor detect little change with a blue lights alert, then send signal to receiver and receiver will play the ring tone you choose and LED lights on .Expandable series door chime can be added more receivers, sensors and doorbell buttons can be installed easily by users. One doorbell receiver can work with 58 transmitters at most and each transmitter can be set to different or same chime/ring tone.

Applicable Places

For indoor use of shops, houses, offices, factories, hotels, hospitals etc.

Features

- Wireless RF transmission Up to 500 feet (150M)
- Sensor detects motion and triggers the receiver to ring
- Wireless and easily installation
- Sensor detection range up to 16 feet (5M)
- Sensor detection angle up to 60° in vertical and 90° in horizontal

- Time interval between 2 detections is 5 seconds
- 5 Levels adjustable volume from 0db – 110db
- 58 chimes/ringtones
- Radio frequency – 433 MHZ + 2MH
- Voltage of plug-in Receiver – AC100-240V Operated
- Battery type of motion sensor – 2*AAA 1.5V alkaline batteries

OVERVIEW

Structure of receiver

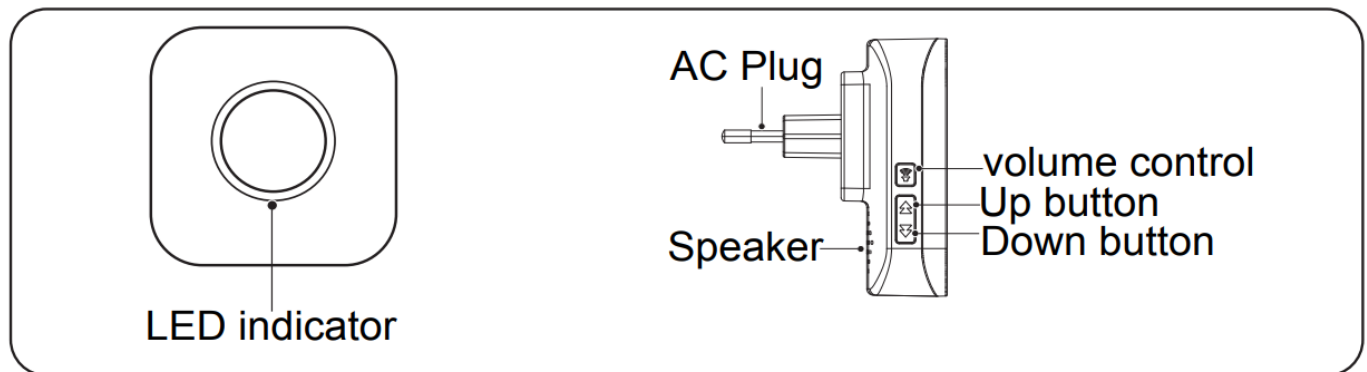

Structure of Motion Sensor

1. D1 (red light) indicates low battery power and batteries should be replaced soon.
2. D2 , D3 , D6 are blue lights . These three LED lights turn on every time motion sensor is triggered when detecting objects.

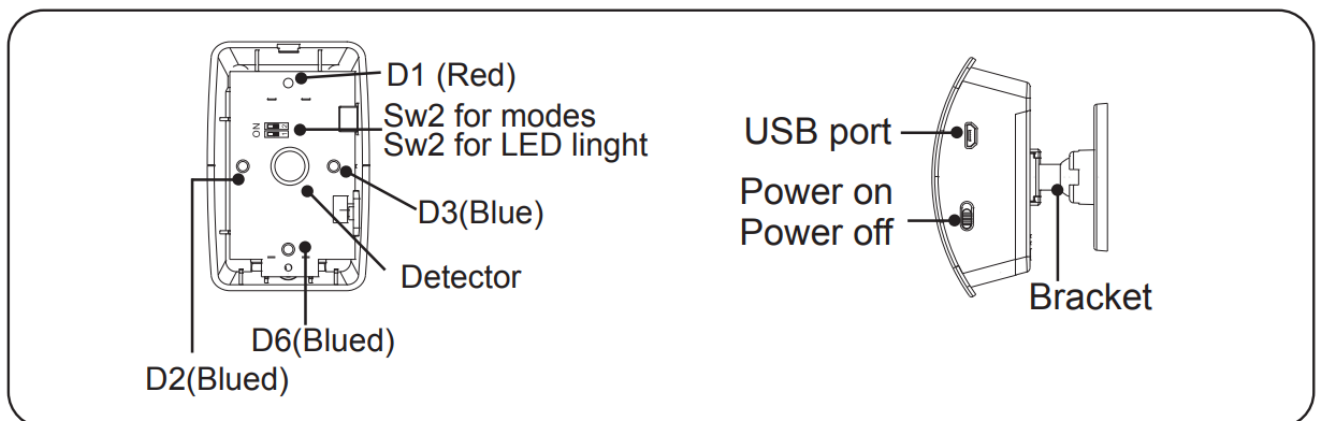

3. Choose sensing modes:

Open the back cover of battery slot and then find the screw downside : use tool to unscrew it , then front cover can be opened and you can find the SW1 SW2.

- a) Switch " SW2 " to the left (at the ON mark) , it detects every 1-2 seconds.
- b) Switch " SW2 " to the right , it detects every 5-8 seconds.
- c) Switch " SW1 " to the left (at the ON mark) , three LED (D2 , D3 , D6) will light up when motion detection is triggered.
- d) Switch " SW1 " to the right , three LED (D2 , D3 , D6) will NOT light up when motion detection is triggered.

BEFORE INSTALLATION

Wall-mounted installation

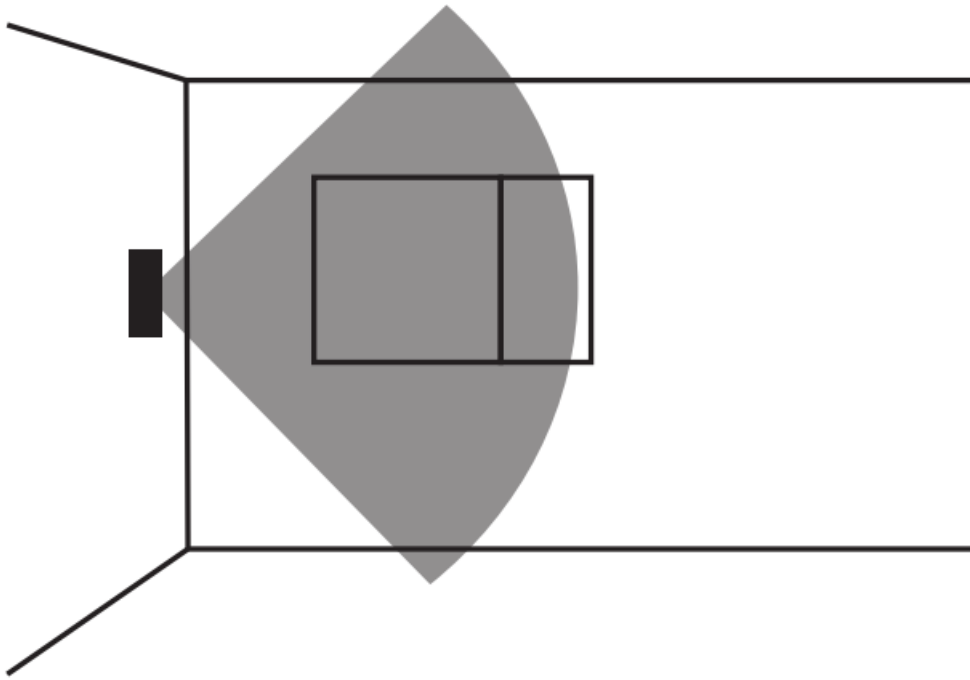

Ceiling-mounted installation

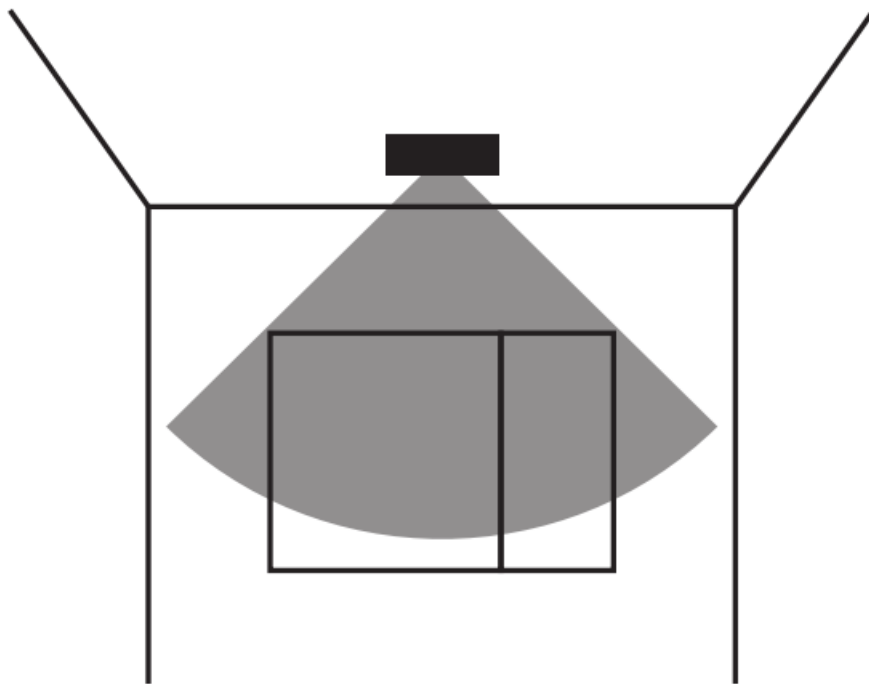

1. Please note that the motion sensor is non- waterproof. We suggest you to install the motion sensor on the inside roof of door in shops and houses. In this way, the detecting area is vertical behind the door (Glass door will isolate the detection), when someone enter the vertical area, it begins detecting and send signal to let receiver know.

F-1

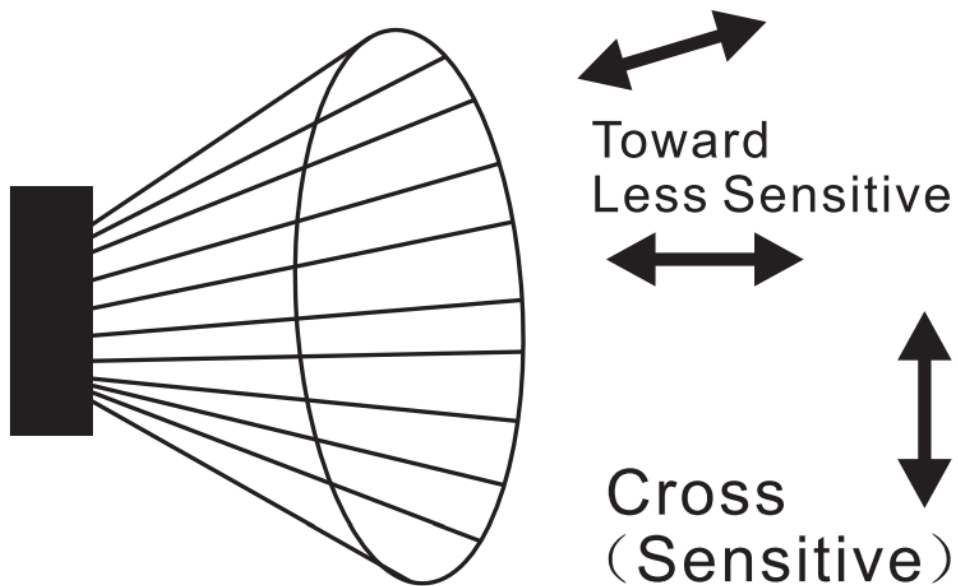

2. The installation height is recommended between 1.9-2.5M for Motion sensor,

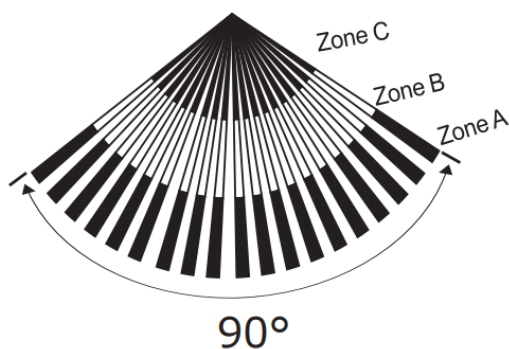

F-2

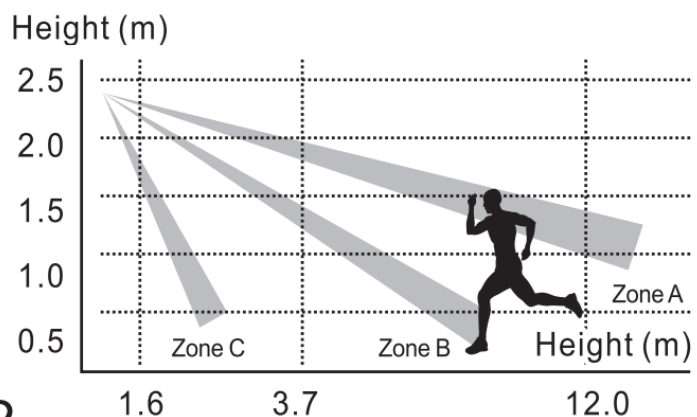

3. The detection time is 5 seconds / time which saves power for the battery and reduces false alarms.
4. The sensor should not be installed on metal doors since it is hard for the signal to transmit.
5. The sensor lens should not be blocked by blockades such as shield , plants or other furniture.
6. The sensor should keep away from air-conditioner , refrigerator , heater , gas burner, or some other heat radiation source , which will affect detection sensitivity and cause false alarm.
7. The sensor should avoid facing window directly , which outdoor air flow or other moving object will cause false alarm

INSTALLATION OF MOTION SENSOR

INSTALLING OF MOTION SENSOR

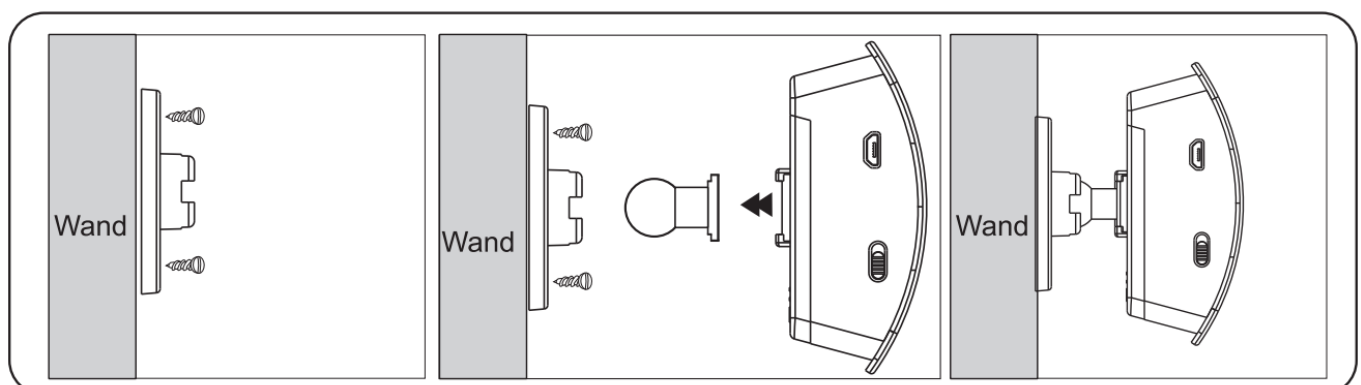

1. First choose the ringtone you like and test whether the operation ranges you choose is proper.
2. Prepare tools needed : an electric drill or hammer, cross screwdriver before installation.
3. Use the drill to drill through the two wall mount holes on the mounting bracket.
4. Firmly insert the ball joint connector and the motion sensor to the mounting bracket, You will hear a snap on sound when it is fully inserted.
5. Adjust the detector angle to make it aim at the area you choose.

GETTING STARTED

POWERING THE INDOOR CHIME RECEIVER

Plug the receiver into the outlet . The receiver will perform better if kept away from other electrical equipment(eg TV , microwave)

POWERING THE MOTION SENSOR



Powering the motion sensor : The motion sensor can be powered by batteries (2XAAA batteries) or with a USB cable.

(note : USB option does not charge the batteries)

SOUND VOLUME CONTROL

Press the volume control button on the receiver to cycle through 5 volume levels.

SETTING RINGTONE FOR A TRANSMITTER

- a) Press the Up Button or Down Button to choose your favorite ringtone from 58 melodies.
- b) Long Press the Volume Button for about 5 seconds (Or short Press the Volume Button and the Down Button together until the receiver “ding” with LED flash.
- c) Wave your hand in front of the Motion Sensor to active it .The new ringtone will be set for the most recently synced transmitter.

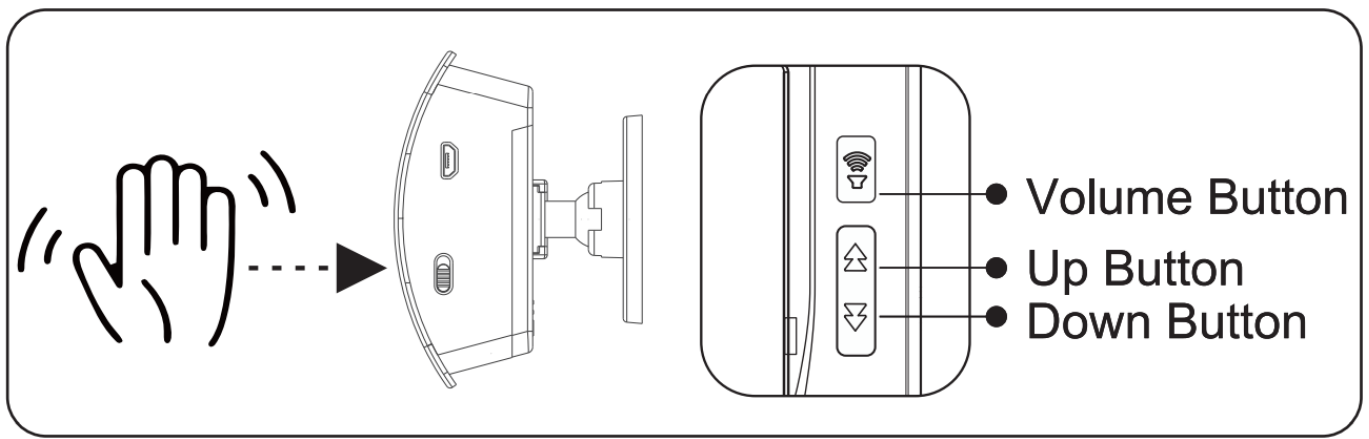

PAIRING A TRANSMITTER TO THE RECEIVER

- a) Select your favourite ringtone before pairing
- b) Long Press the Volume Button for about 5 seconds (Or short Press the Volume Button and the Down Button together until the receiver “ding” with LED flash.
- c) Wave your hand in front of the Motion Sensor to active it.

RESET

Press Down Button for 5 seconds to reset receiver to default. When receiver sounds ‘Ding Dong’ with LED flashing that means the reset was successful. Then you can follow the STEP 5 to pair again.

Please note :

1. Pairing mode will last for 5 seconds only before timing out. Ensure you activate the transmitter during this time or the process will have to start again.
2. Pairing mode will quit automatically after pairing is completed.

TROUBLE SHOOTING

1. The receiver doesn’t sound

- a) If the receiver stop working, firstly please push the button of receivers to test if they can ring with light. If the receivers can work, please test the transmitters. Check the transmitter battery~ Opening the transmitter to replace the battery to test. That’s maybe low battery power.
- b) If there’s no problem for receivers and transmitter by above testing, but they still can not work together, please pair transmitters with receivers one by one. Follow above steps: PAIRING A TRANSMITTER TO THE RECEIVER(a)-(c).
- c) The receiver could be out of range from the transmitter.
- d) The receiver may not have been paired with the transmitter.
- e) If there’s no problem for receivers and transmitter by above testing, but they still can not work together, please pair transmitters with receivers one by one. Follow above steps: PAIRING A TRANSMITTER TO THE RECEIVER(a)-(c).

2. Operating range reduced

- a) Metal structures, including PVC door frames can reduce the range of the product.
- b) Avoid mounting the push or chime on or metal structures.

- c) Other equipment can cause radio interference that affects your doorbell.
- d) Lots of walls and ceilings between the transmitter and receiver will reduce the range.
- e) Weak batteries will reduce the range.

3. Receiver rings randomly

The frequency must be being interfere by other receiver from the same supplier. You just need to clear the code of the receiver, and pair it with transmitter again for a new code, follow the steps: RESET ,and PAIRING A TRANSMITTER TO THE RECEIVER(a)-(c).

If the receivers or transmitters can not work by above testing, please contact our customers service.

COMMON PROBLEMS AND SOLUTIONS

1. Alerts went off randomly when no one was around.

Reason: There may be random movement of animals, high density FR, heat radiation, or strong air flow in the detection range of sensor. Solution: Change install location.

2. Receiver sometimes doesn't ring when someone passing by.

Reason 1:

The movement of passerby may not be detected.

To avoid constant alerting and ringing if a motion trigger occurs, there's a 5-second time interval between 2 defections. If someone passes through the detection range quickly during the time interval, then the movement can't be detected.

Solution 1:

Please install the motion at height of 1.9-2.5 meters to cover maximal detection area.

Reason 2: The movement was detected but working range between receiver and sensor is shorter than before due to low power status of motion sensor.

Solution 2: Please change battery for motion sensor.

Chimes List

1. Ding-dong. Ding-dong
2. Ding-dong. Ding-dong
3. Ding-dong. Ding-dong
4. Ding-dong. Ding-dong
5. Corsica Doorbell
6. Ding-dong
7. Ding-dong
8. Ding-dong
9. Ding-dong Chime
10. Ding-dong
11. Ding-dong
12. Ding-dong Chime
13. Alarm Sound Effect
14. Barking
15. Hello Welcome
16. Horn sound

17. Brake sound
18. Westminster Chimes
19. Westminster Chimes
20. Westminster Chimes
21. Westminster Chimes
22. Big ben electronic doorbell
23. Marimba
24. Alerting Ringtone
25. Smooth alert ringtone
26. Marimba Ringtone
27. Flute sound doorbell
28. Harp Ringtone
29. Guitar rhythm
30. Electric piano
31. Starry night
32. Marimba
33. Alerting Ringtone
34. Electric Ringtone
35. Alerting Ringtone
36. Piano rhythm
37. Butterfly Dream
38. Dance beat
39. Twilight Sms Tone
40. Classical organ
41. Joy to the world
42. Super Ringtone
43. Let It Snow
44. Fast Car
45. Dingdong merrily on high
46. Jingle bells
47. Waltz of the flowers
48. For Alice
49. The William tell overture
50. The cuckoo waltzes
51. Going home
52. Victory
53. Happy birthday
54. Fantasia Impromptu
55. Yesterday Once More
56. Eva's Polk
57. Russe Dance
58. Souvenirs Defiance

How to Contact After-sale Service?

If you have any product using question, please do not hesitate to contact us through your order, our 24-hour email standby!

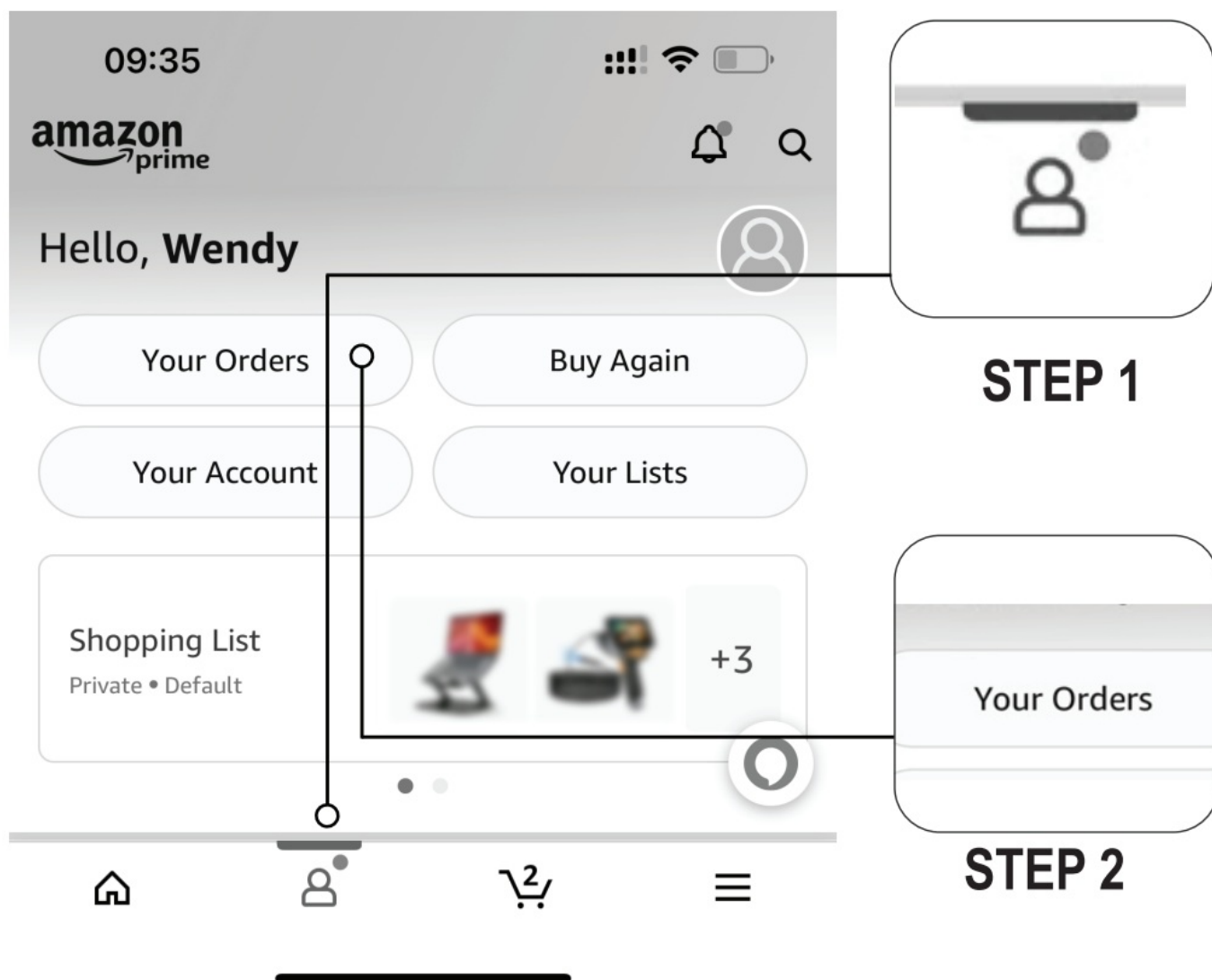

Need help with your item?

- Contact seller
- Return items
Eligible through August 5, 2022
- Request refund

Contact seller

STEP 3

How's your item?

- Write a product review



Thank you for reading!



Documents / Resources

[amazon basics SW2 Motion Sensor Alarm Detector](#) [pdf] User Manual
SW2 Motion Sensor Alarm Detector, SW2, Motion Sensor Alarm Detector, Sensor Alarm Detect
or, Alarm Detector, Detector

References

- [User Manual](#)