

## **amazon basics BO9GDH3DF4 Speed Oscillating Tower Fan with Mechanical Control User Manual**

[Home](#) » [amazon basics](#) » amazon basics BO9GDH3DF4 Speed Oscillating Tower Fan with Mechanical Control User Manual 

**amazon basics BO9GDH3DF4 Speed Oscillating Tower Fan with Mechanical Control**

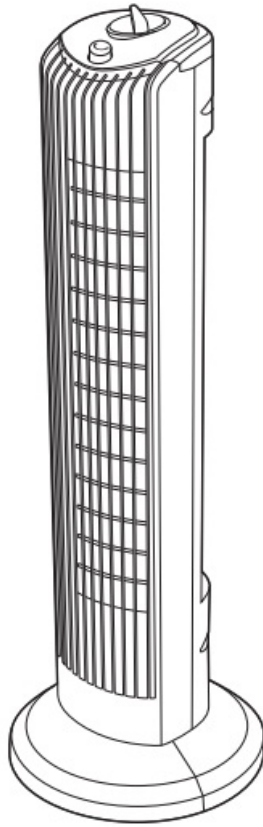

## Contents

- 1 IMPORTANT SAFETY INSTRUCTIONS**
- 2 Appliance Description**
- 3 Intended Use**
- 4 Before First Use**
- 5 Assembly**
  - 5.1 Assembling the base
  - 5.2 Attaching the base to the tower fan
- 6 Operation**
  - 6.1 Switching on/off
  - 6.2 Turning the swing mode on/off
- 7 User Servicing Instructions**
  - 7.1 Fuse replacement
- 8 Cleaning and Maintenance**
  - 8.1 Cleaning
  - 8.2 Storage
  - 8.3 Maintenance
- 9 Frequently Asked Questions**
- 10 Specifications**
- 11 Feedback and Help**
- 12 Documents / Resources**
  - 12.1 References
- 13 Related Posts**

## IMPORTANT SAFETY INSTRUCTIONS

Read these instructions carefully and retain them for future use. If this appliance is passed to a third party, then these instructions must be included.

When using electrical appliances, basic safety precautions should always be followed to reduce the risk of fire,

electric shock, and/or injury to persons including the following:

## **WARNING**

### **Risk of injury!**

Avoid contacting moving parts. Wait until all components have completely stopped before touching them.

## **WARNING**

### **Risk of fire and electric shock!**

Do not use this fan with any solid-state speed control device

- This appliance is not intended for use by persons (including children) with reduced physical, sensory or mental capabilities, or lack of experience and knowledge, unless they have been given supervision or instruction concerning use of the appliance by a person responsible for their safety.
- Children should be supervised to ensure that they do not play with the appliance.
- Before connecting the appliance to the power supply, check that the power supply voltage and current rating corresponds with the power supply details shown on the appliance's rating label.
- Do not insert fingers or foreign objects in any opening of the appliance and do not obstruct the air vents.
- Do not operate any fan with a damaged cord or plug. Discard fan or return to an authorized service facility for examination and/or repair.
- Do not run the power cord under carpeting.  
Do not cover the power cord with throw rugs, runners, or similar coverings. Do not route the power cord under furniture or appliances.
- Arrange power cord away from traffic area and where it will not be tripped over.
- Place the appliance on a flat, stable surface.
- Due to its height, it can easily tip over.
- Do not use the appliance if it has fallen. It may be damaged internally.
- Never use the appliance with a damaged safety guard.
- Do not place any clothes or curtains on the appliance as they could be sucked into the fan during operation and damage the appliance.
- During use, keep hands, hair, clothing and utensils away from the safety guard to avoid injuries and damage of the appliance.
- Unplug or disconnect the appliance from the power supply before servicing.
- This appliance has a polarized plug (one blade is wider than the other). To reduce the risk of electric shock, this plug is intended to fit in a polarized outlet only one way. If the plug does not fit fully in the outlet, reverse the plug. If it still does not fit, contact a qualified electrician.
- Do not attempt to defeat this safety feature.

**For US only:**

## **CAUTION**

### **Risk of fire!**

Do not replace attachment plug. Contains a safety device (fuse, AFCI, LCDI) that should not be removed. Discard appliance if the attachment plug is damaged.

- This appliance employs overload protection (fuse). A blown fuse indicates an overload or short-circuit situation. If the fuse blows, unplug the appliance from the outlet. Replace the fuse according to the instructions in this manual (follow appliance marking for proper fuse rating) and check the appliance. If the replacement fuse blows, a short-circuit may be present and the appliance should be discarded or returned to an authorized service facility for examination and/or repair.
- Always unplug this appliance before installing or replacing fuses.

## READ AND SAVE THESE INSTRUCTIONS

### Appliance Description

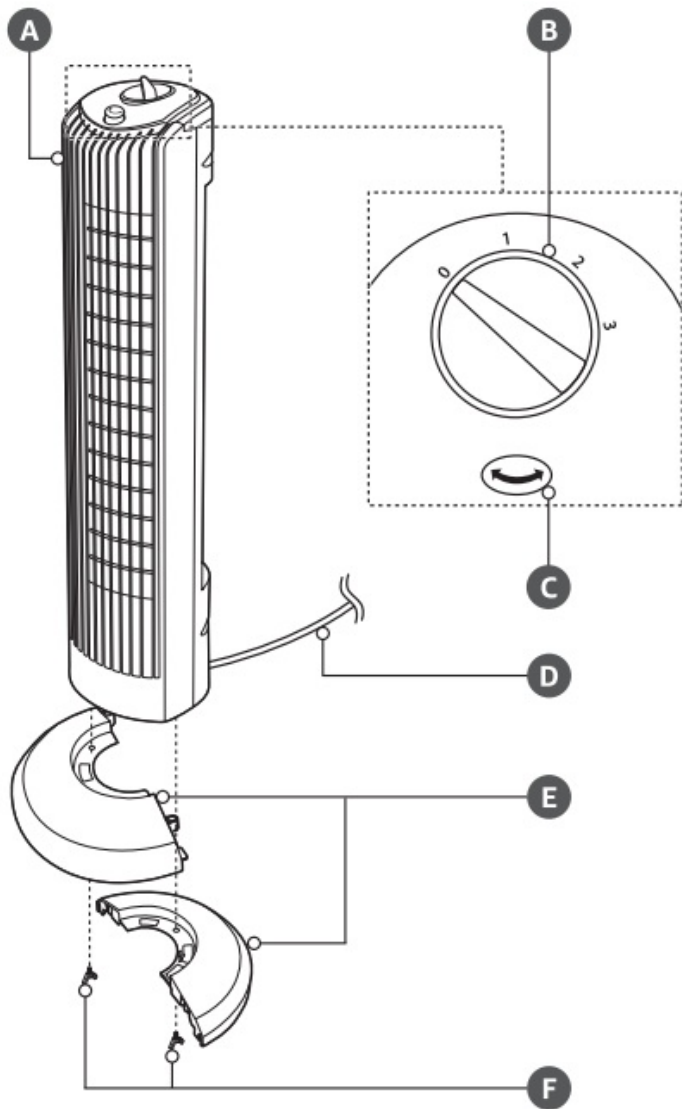

1. **A** Tower fan
2. **B** Control dial
3. **C** button (swing mode)
4. **D** Power cord with power plug
5. **E** Base (2 parts)
6. **F** Fixing screw (2 x)

### Intended Use

- This appliance is intended for household use only. It is not intended for commercial use.
- This appliance is intended to be used in dry indoor areas only.
- No liability will be accepted for damages resulting from improper use or non-compliance with these instructions.

## Before First Use

### **⚠ DANGER**

#### **Risk of suffocation!**

Keep any packaging materials away from children and pets – these materials are a potential source of danger, e.g. suffocation .

- Remove all the packing materials.
- Remove and review all components before use.
- Check the appliance for transport damages.
- Before connecting the appliance to the power supply, check that the power supply voltage and current rating corresponds with the power supply details shown on the appliance rating label.

## Assembly

### **Assembling the base**

- The base (E) is delivered in 2 parts. One part includes 4 pins. The second part includes 4 cutouts to go over the pins (**Fig. 1** ).
- Push the cutouts in the base (E) over the tabs on the base (**Fig. 1** ).

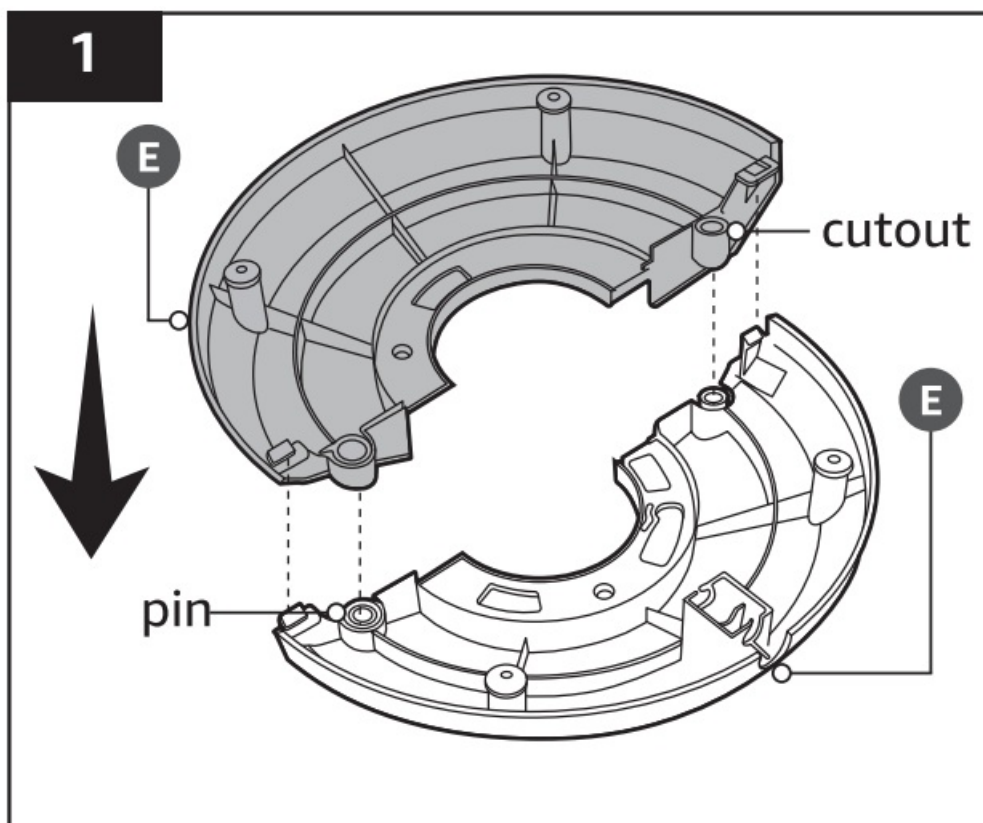

### **Attaching the base to the tower fan**

1. Remove the 2 fixing screws (F) from the screw holes in the base (E).
2. Slide the power cord (D) through the central hole in the base (E).
3. Press the base (E) down onto the bottom side of the tower fan (A) so that the notches on the base go over the tabs on the bottom side of the tower fan (**Fig. 2**).

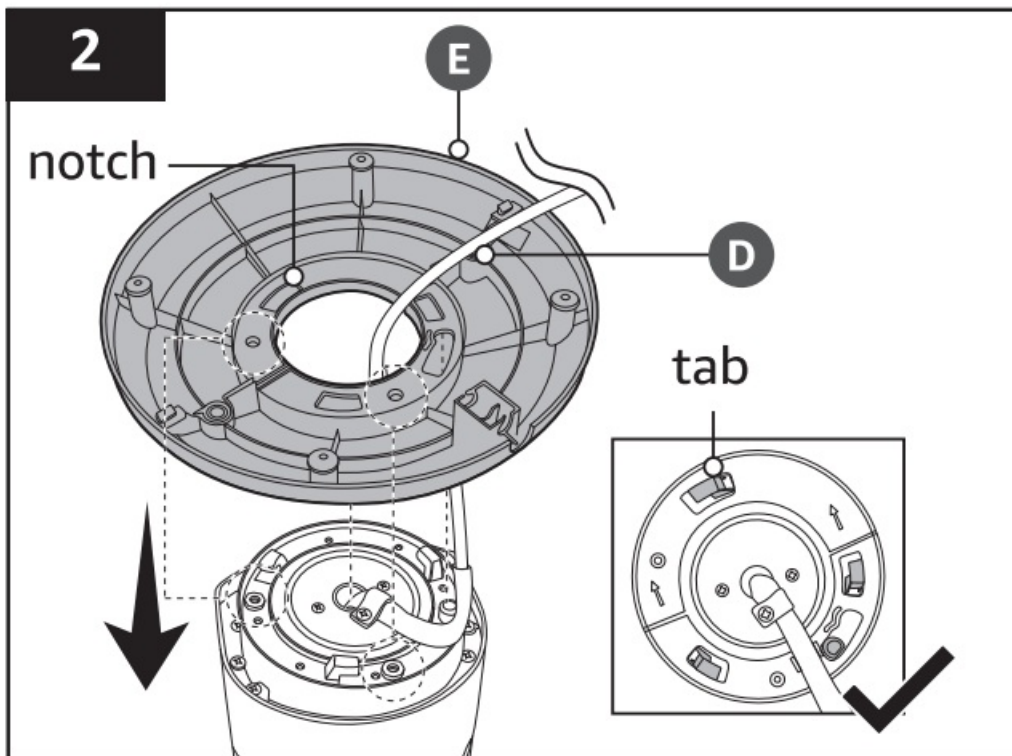

4. Turn the base (E) in a clockwise direction until the tabs lock in place. Do this in such a way that the screw holes in the base (E) are visible through the holes in the stand (**Fig. 3**).

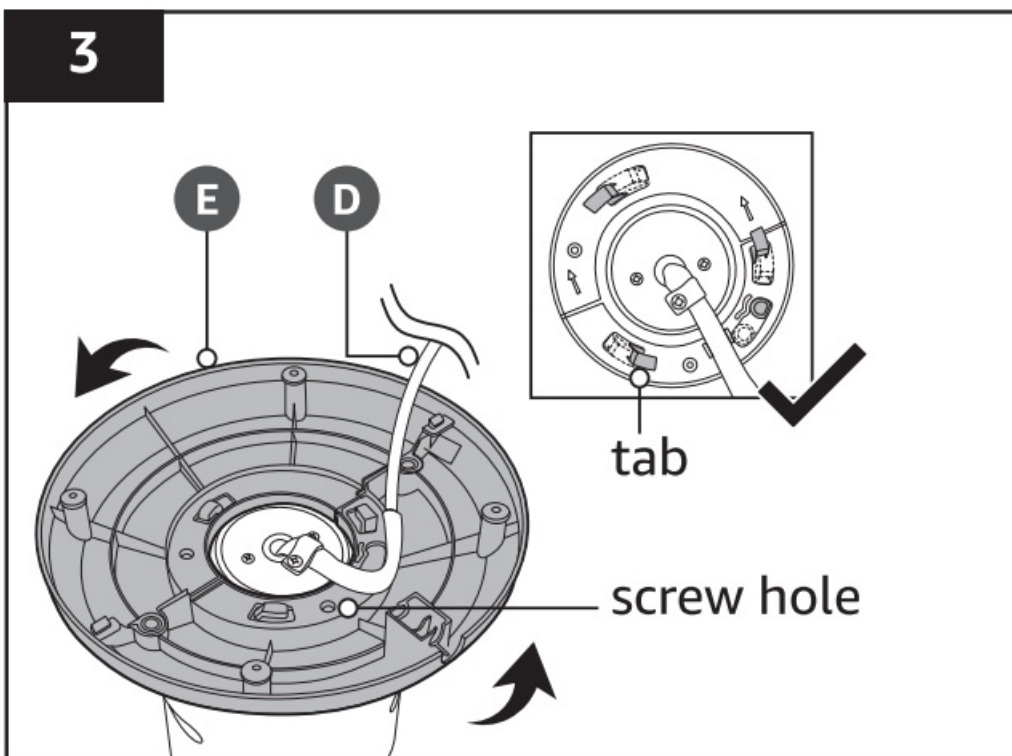

4. Insert the fixing screws (F) through the holes in the base (E) into the screw holes in the base. Turn in a clockwise direction until fully tightened.
5. Align the power cord (D) with the cord notch on the base (E).
6. Press the power cord (D) into the clamps on the cord notch (**Fig. 4**).

4

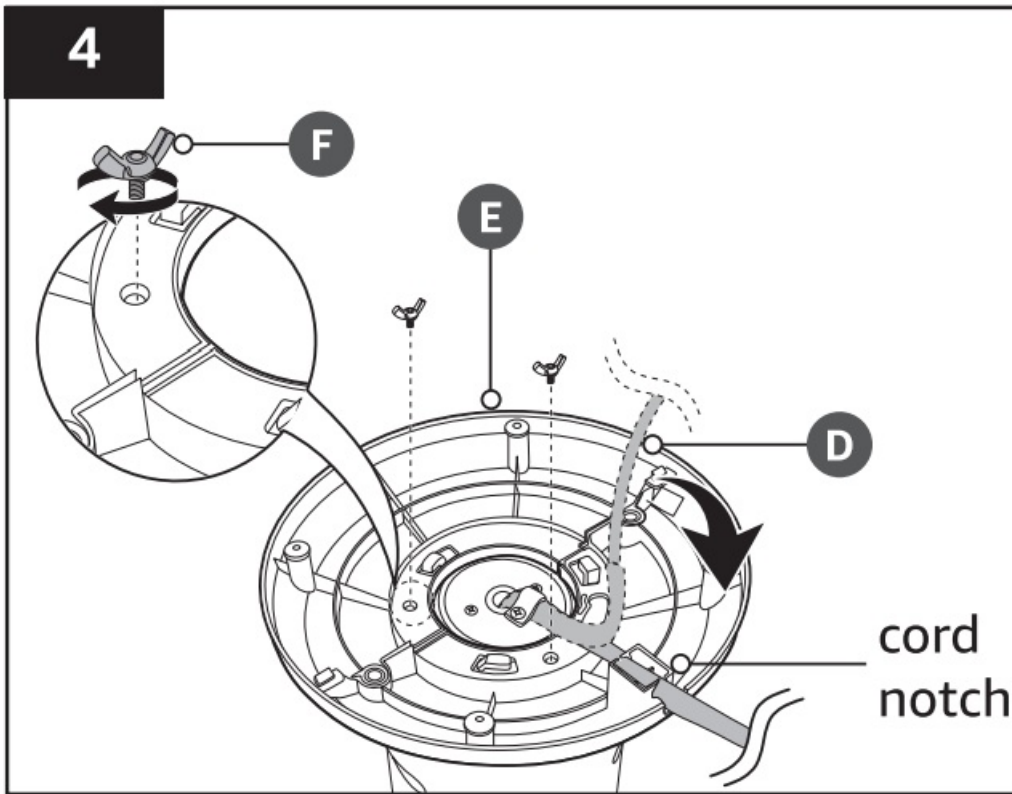



## Operation

- Place the appliance on a flat, stable surface.
- Connect the power plug (D) to a suitable socket outlet.

## Switching on/off

- To switch the appliance on, set the control dial (B) to 1 (low speed), 2 (medium speed) or 3 (high speed).
- To switch the appliance off, set the control dial (B) to 0.

## Turning the swing mode on/off

- Press  (C) to switch the swing mode on.
- Press  (C) again to switch the swing mode off.

## User Servicing Instructions

### Fuse replacement

#### **NOTICE**

The appliance requires a 5 A, 125 V fuse.

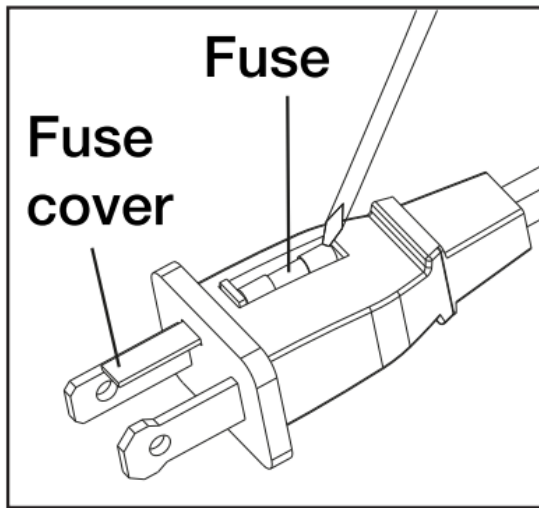

1. Grasp plug and remove from the receptacle or other outlet device. Do not unplug by pulling on cord.
2. Slide open fuse access cover on top of attachment plug towards blades.
3. Remove fuse carefully by using a small screwdriver to pry the fuse out of the compartment by the metal ends of the fuse.
4. Risk of fire. Replace only with 5 A, 125 V fuse.
5. Slide closed the fuse access cover on top of the attachment plug.

## Cleaning and Maintenance

### **⚠ WARNING**

#### **Risk of electric shock!**

- To prevent electric shock, unplug the appliance before cleaning.
- During cleaning, do not immerse the appliance in water or other liquids. Never hold the appliance under running water.

#### **Cleaning**

- To clean, wipe with a soft, slightly moist cloth.
- Regularly remove dust and dirt from the guards using a vacuum cleaner.
- Never use corrosive detergents, wire brushes, abrasive scourers, metal or sharp utensils to clean the appliance.

#### **Storage**

Store the appliance in its original packaging in a dry area. Keep away from children and pets.

#### **Maintenance**

Any other servicing than mentioned in this manual should be performed by a professional repair center.

## Frequently Asked Questions

Problem	Solution
The appliance does not switch on.	<ul style="list-style-type: none"> <li>• Check if the power plug (D) is connected to the socket outlet.</li> <li>• Use voltage tester to verify if the socket outlet is powered.</li> <li>• Replace the fuse in the power plug (D).</li> </ul>
The appliance has fallen.	Do not use the appliance if it has fallen. It may be damaged internally. If the appliance has fallen, send it to a professional repair center.
Fuse in the plug is blown.	Use a flat screwdriver to open the fuse compartment cover. Remove the fuse and replace with the same type. Refit the cover.
The appliance vibrates during operation.	Place the appliance on a stable, level surface.

## Specifications

Model number	B09GDH3DF4
Rated voltage	120VAC, 60 Hz
Power consumption	35W
Protection class	II

## Feedback and Help

We would love to hear your feedback. To ensure we are providing the best customer experience possible, please consider writing a customer review.

Scan QR Code below with your phone camera or QR reader:



If you need help with your Amazon Basics appliance, please use the website or number below.

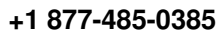

**amazon basics**

The image shows the front cover of a user manual for an Amazon Basics tower fan. On the left side, there is a small, detailed illustration of the fan, which is a tall, white, cylindrical tower fan with a mesh grille. Below the illustration, there is a small block of text in English, French, and German, followed by a barcode and the page number '13'. The main part of the cover is white with a blue header bar at the top. The header bar contains the 'amazon basics' logo on the left and a small yellow icon on the right. The title of the manual, 'amazon basics BO9GDH3DF4 Speed Oscillating Tower Fan with Mechanical Control', is written in blue text across the top. Below the title, the words 'User Manual' are written in a larger, black font. The bottom half of the cover features the product name 'BO9GDH3DF4 Speed Oscillating Tower Fan with Mechanical Control' in a large, black font, followed by a list of alternative names for the product in a smaller font: 'Oscillating Tower Fan with Mechanical Control', 'Tower Fan with Mechanical Control', and 'Fan with Mechanical Control'.

- User Manual