

amazon basics B0BLGY6TZZ Storage Cube Shelf Organizer 9 Cubes



# amazon basics B0BLGY6TZZ Storage Cube Shelf Organizer 9 Cubes Instruction Manual

[Home](#) » [amazon basics](#) » amazon basics B0BLGY6TZZ Storage Cube Shelf Organizer 9 Cubes Instruction Manual 

## Contents

- 1 [amazon basics B0BLGY6TZZ Storage Cube Shelf Organizer 9 Cubes](#)
- 2 [Tools Needed](#)
- 3 [Delivery Content](#)
- 4 [Before First Use](#)
- 5 [Cleaning and Maintenance](#)
- 6 [Maintenance](#)
- 7 [Specifications](#)
- 8 [Assembly](#)
- 9 [Documents / Resources](#)
  - 9.1 [References](#)



amazon basics B0BLGY6TZZ Storage Cube Shelf Organizer 9 Cubes



## Tools Needed

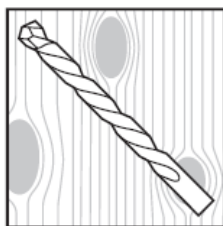
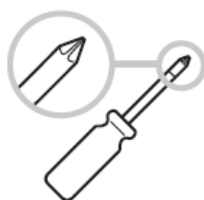
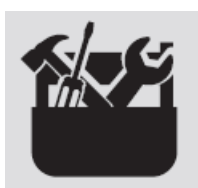

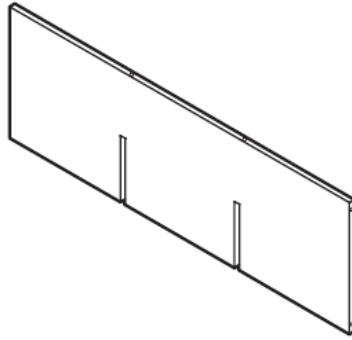

**A (x 4)**

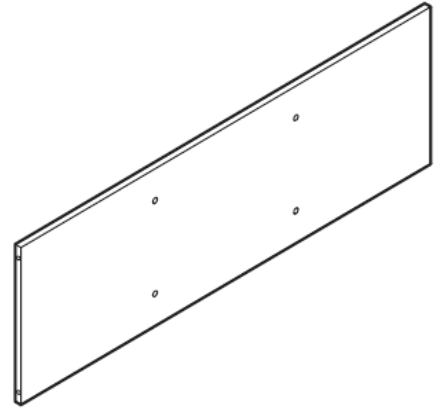

**B (x 2)**

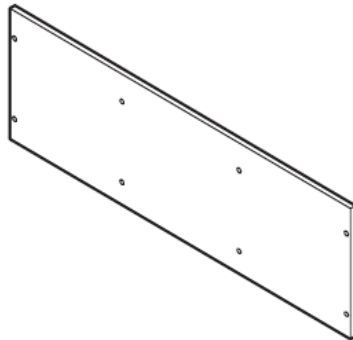

**C (x 2)**

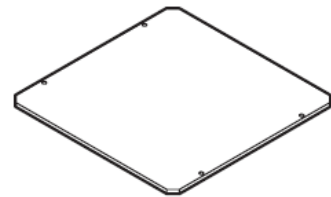

**D (x 5)**



**E (x 24)**



**F (x 24)**



**G (x 20)**

0.125 x 0.63" (M3 x 16 mm)



**H (x 24)**

0.125 x 0.98" (M3 x 25 mm)



**I1 (x 1)**



**I2 (x 2)**

8 x 5/8" (M4 x 15 mm)

**I (x 1)**

## Delivery Content

### Important Safeguards

Read these instructions carefully and retain them for future use. If this product is passed to a third party, then

these instructions must be included. When using the product, basic safety precautions should always be followed to reduce the risk of injury including the following:

**DANGER** Risk of injury or death! Serious or fatal crushing injuries can occur from

**WARNING** Risk of injury! is small parts, sharp edges and sharp points. Do not climb or use the product as a step ladder. The unstable weight may cause the product to tip over.

**CAUTION** Risk of injury! The product can tip over. Do not let children climb on or play with the product.

- For domestic and office use only.
- Keep children and pets away while assembling the product.
- Always use the product on a firm, level ground.
- Do not use this prproductny parts are missing, damaged, On
- Do not over-tighten the fasteners.
- Belty – one of the products for wear and tear.
- Stop using the product at the rst sign of damage or if parts become
- Do not set TVs or other heavy objects on top of this product.
- Do not overload the concept downed or this product can hold a maximum weight of 15 lbs (6.8 kg) with a maximum total load of 99 lbs (45 kg).
- This product should be assembled and maintained only by an adult.
- Load bottom shelves first. Put the heaviest items on the bottom
- Assemble the product in a spacious area, preferably on a carpet, near the place where the product is to be located.
- Fix the product to the wall before using the anti-tip kit (1) before putting items on the shelves.

## Before First Use

- DANGER Risk of suffocation!
- Keep any packaging materials away from children and pets – these materials are a potential source of bange, c.a suffocation.
- Remove all the packing materials.
- Remove and review all components before assembly.
- Check the product for transport damages.

## Cleaning and Maintenance

### Cleaning

- To clean the product, wipe with a soft, slightly damp cloth.
- Never use corrosive detergents, wire brushes, abrasive scourers, or metal or sharp utensils to clean the product.
- Do regular brushing or vacuuming to remove dirt and prevent dust round-up

### Maintenance

Check the components regularly to make sure all screws and

**Disposal**

Dispose of the product according to local regulations. If in doubt, consult your local authorities

**Specifications**

Model	PB-0659E, PB-0659W
Net weight	approx. 43.87 lbs (19.9 kg)
Cube dimensions (W x H x D)	approx. 11.3 x 11.3 x 11.3" (28.8 x 28.8 x 28.8 cm)
Product dimensions (W x H x D)	approx. 35.9 x 35.9 x 11.7" (91.2 x 91.2 x 29.7 cm)
Max. load per cube	15 lbs (6.8 kg)
Max. total load	99 lbs (45 kg)

**Feedback and Help**

We would love to hear your feedback. To ensure we are providing the best customer experience possible, please consider writing a customer review.

Scan the QR Code below with your phone camera or QR reader:



If you need help with bet Amazon Basics product, please use [amazon.com/gp/help/customer/contact-us](https://amazon.com/gp/help/customer/contact-us) +1 877-485-0385

**Assembly**

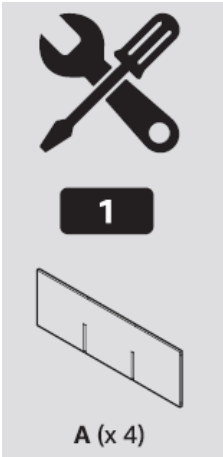

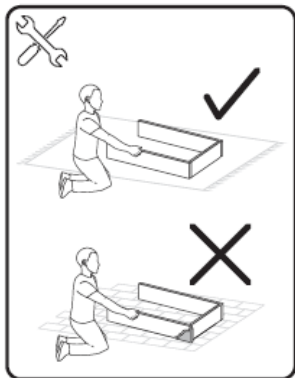

A

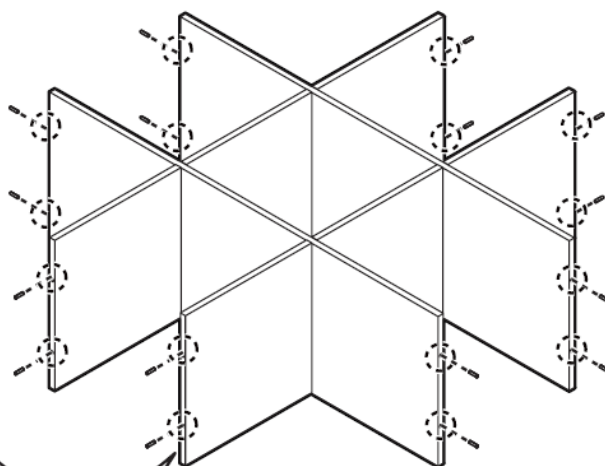
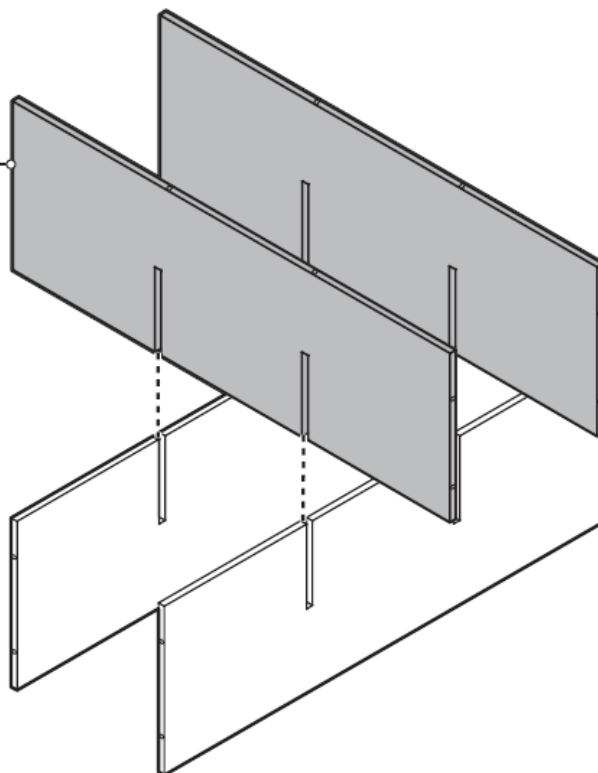

x16

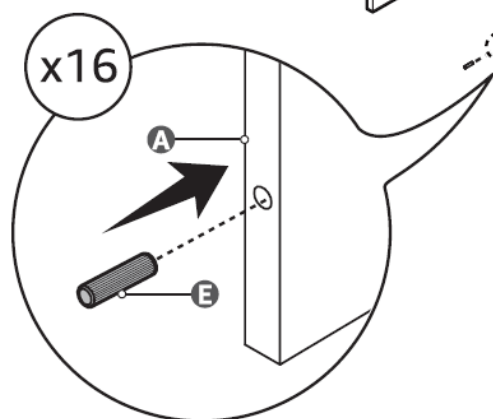

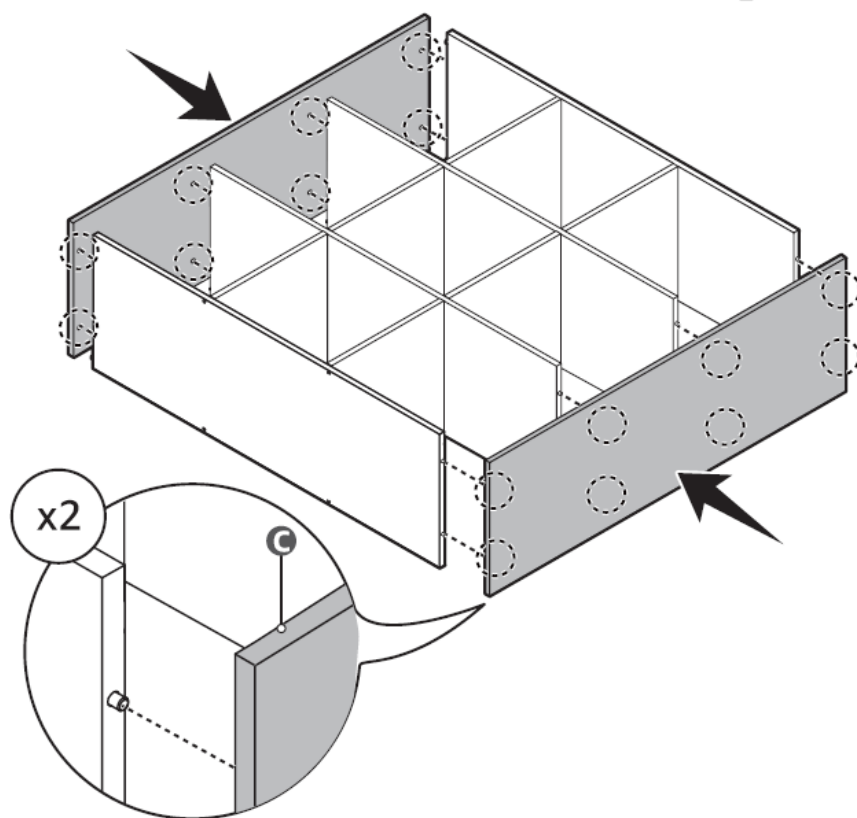
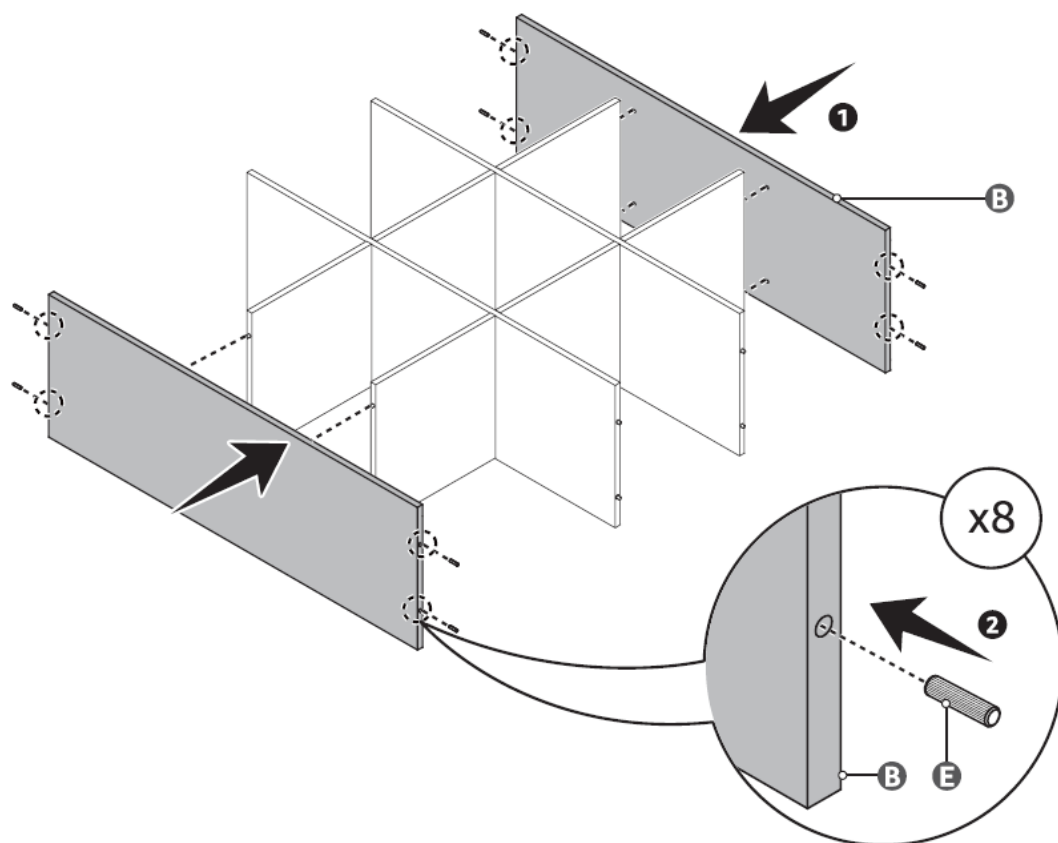



H (x 24)

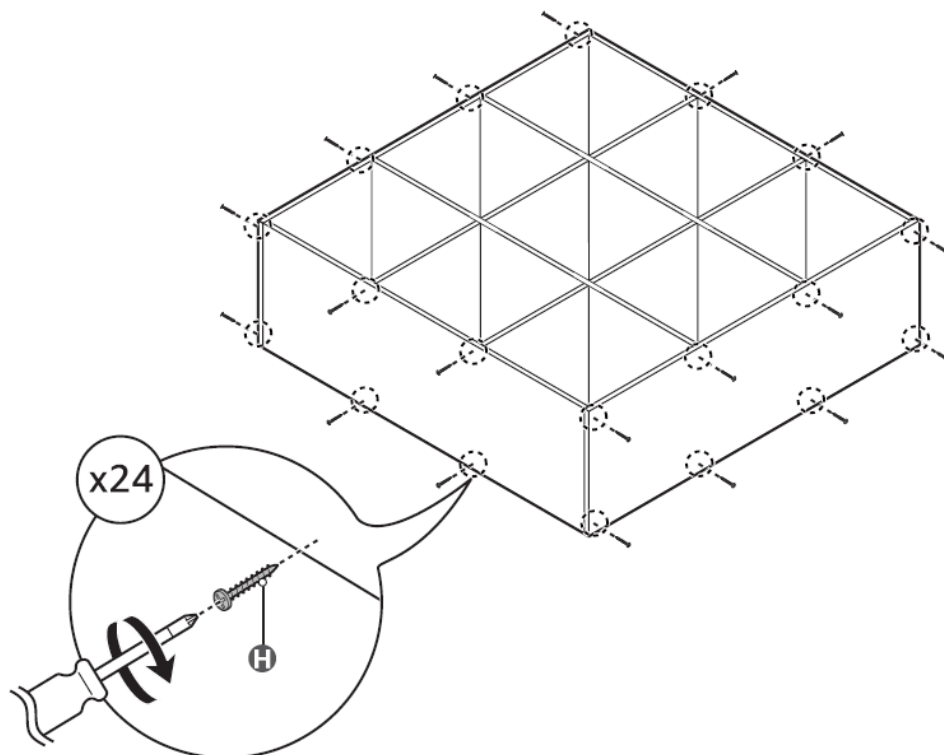

Install panels D flush to the edges of panels B and C.

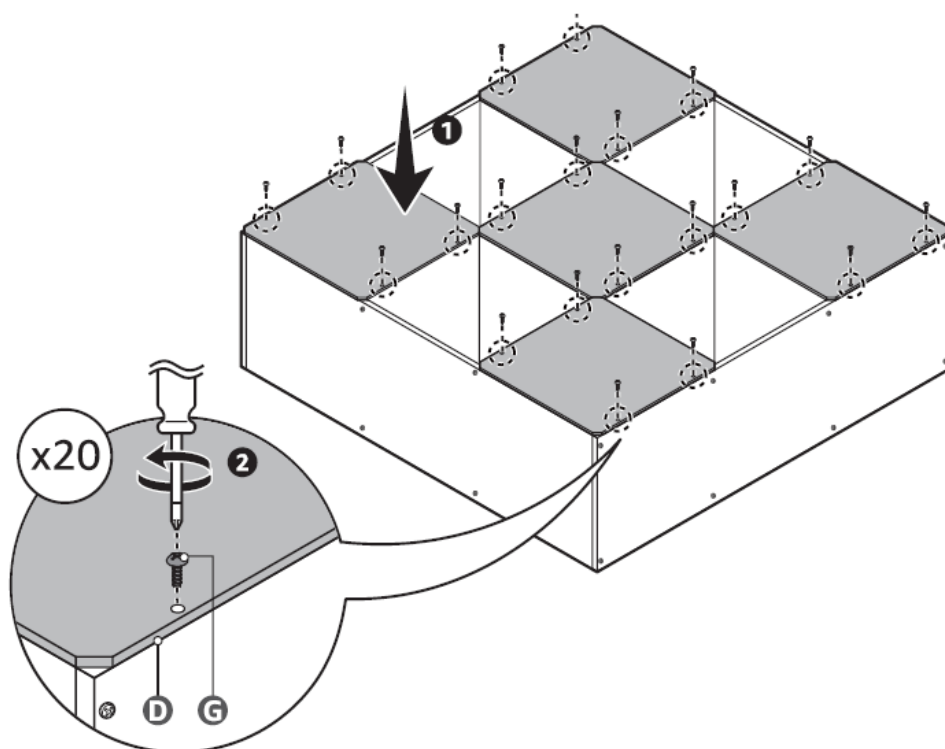



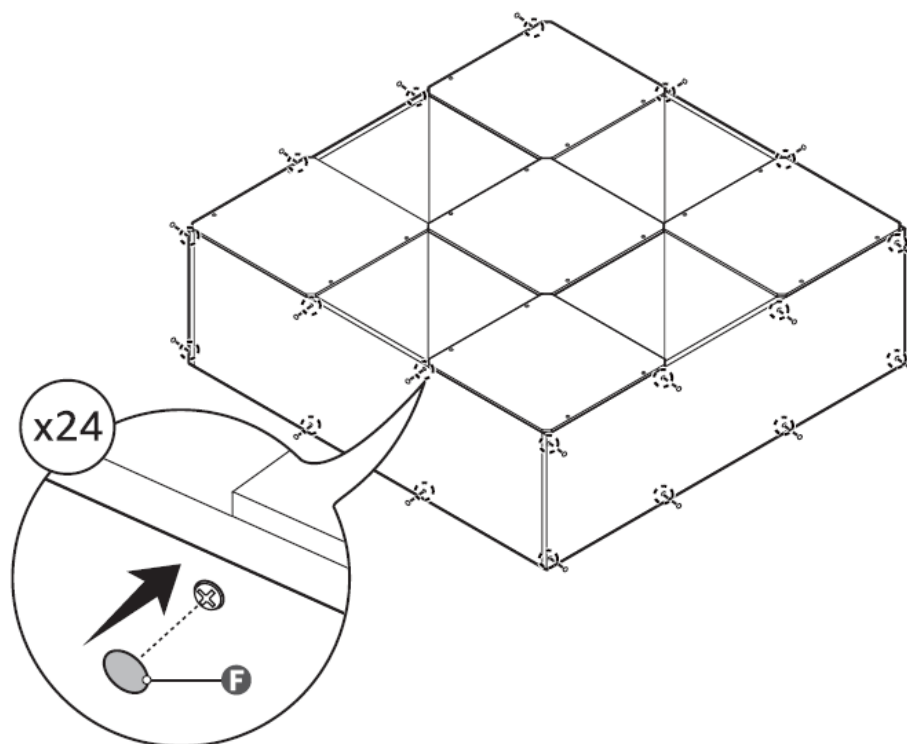

Fix anti-tip kit to drywall

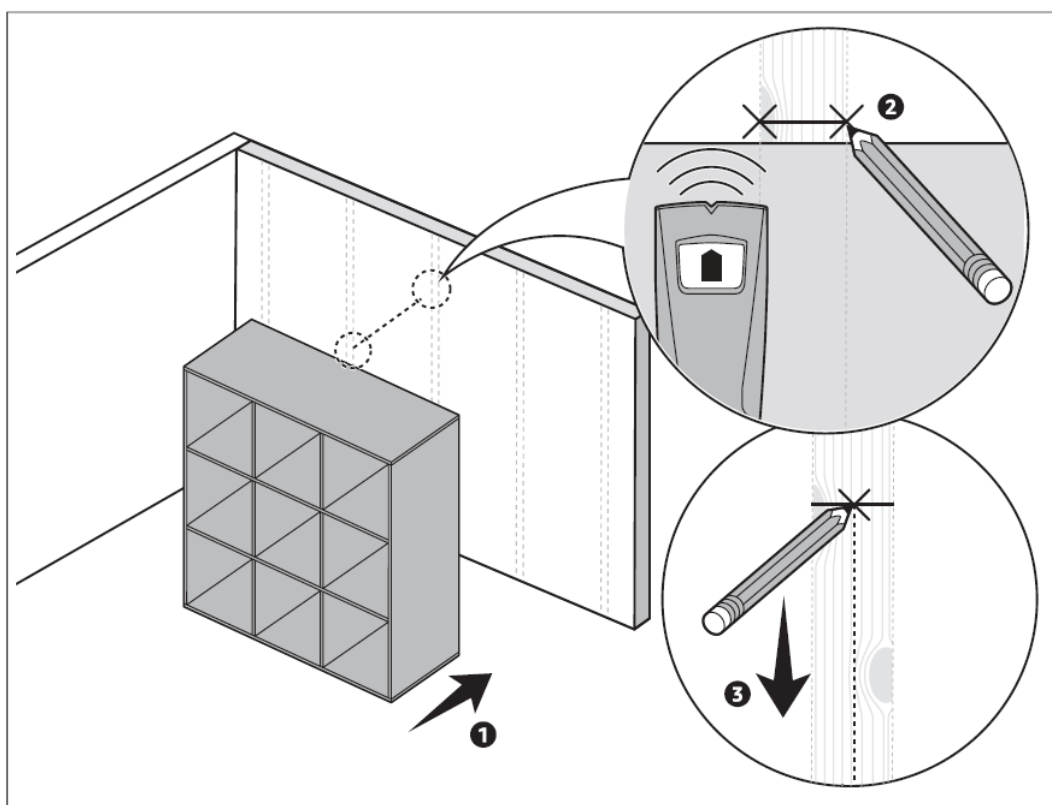

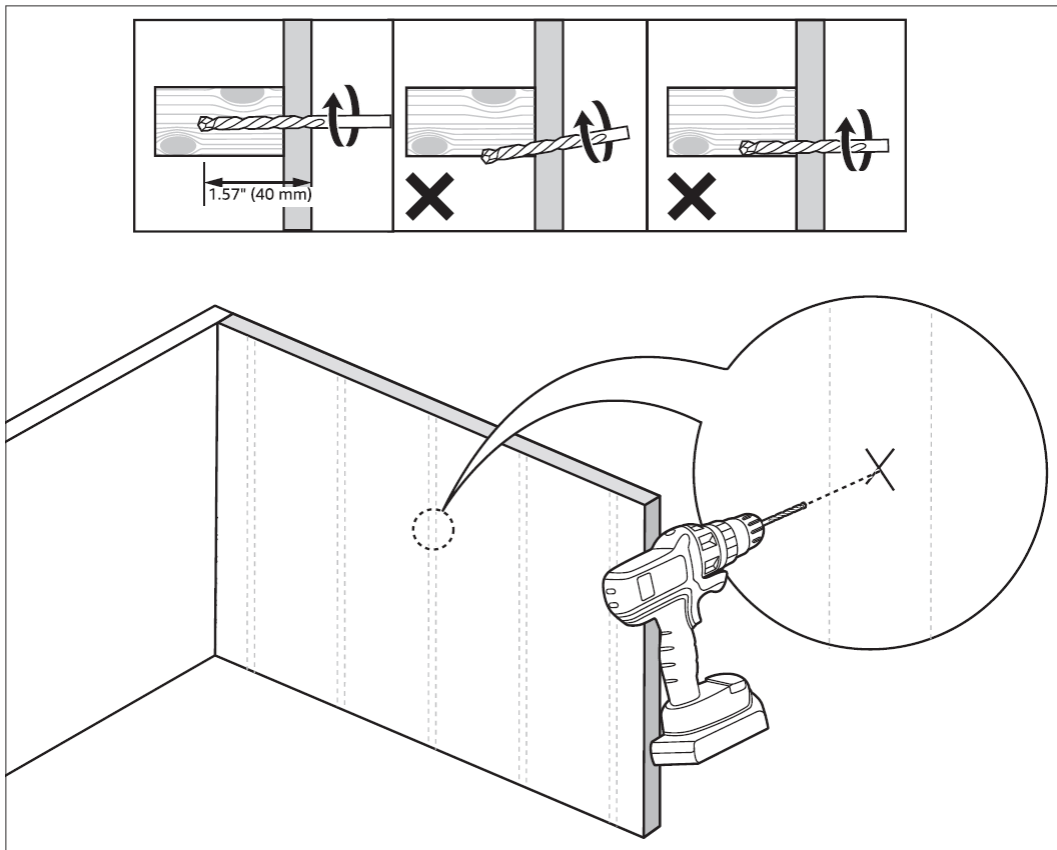
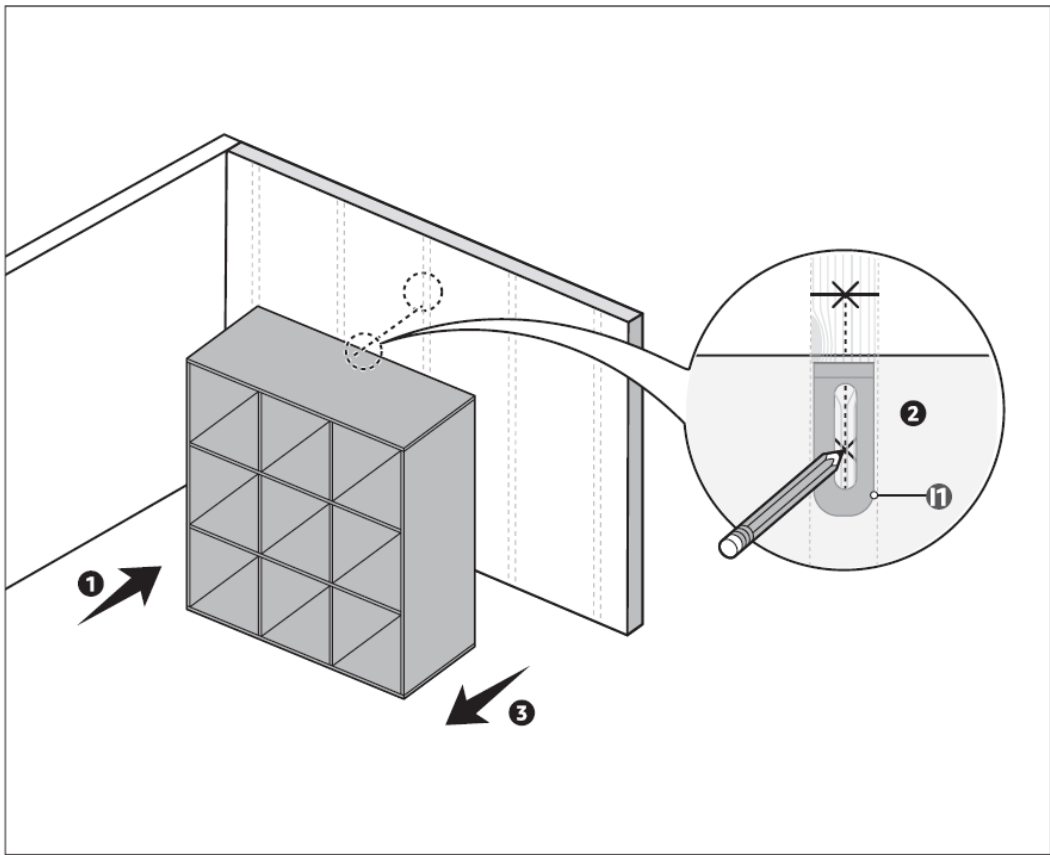

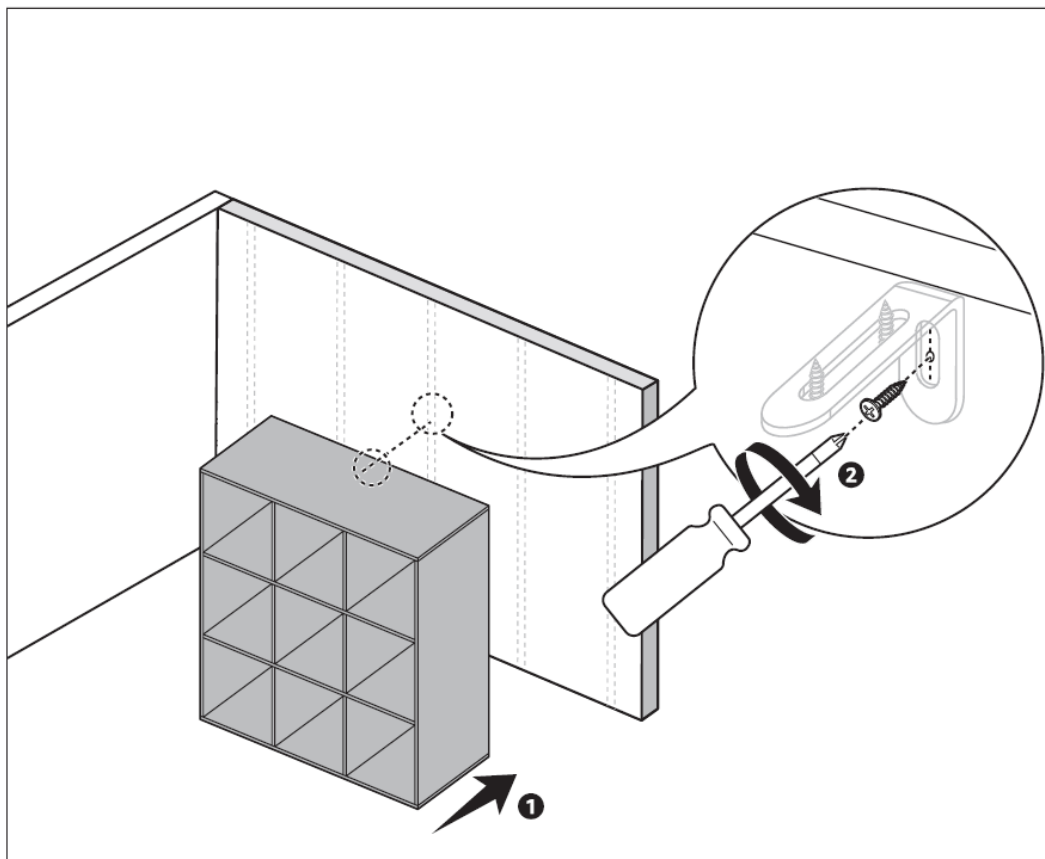

**Fix anti-tip kit to concrete wall**

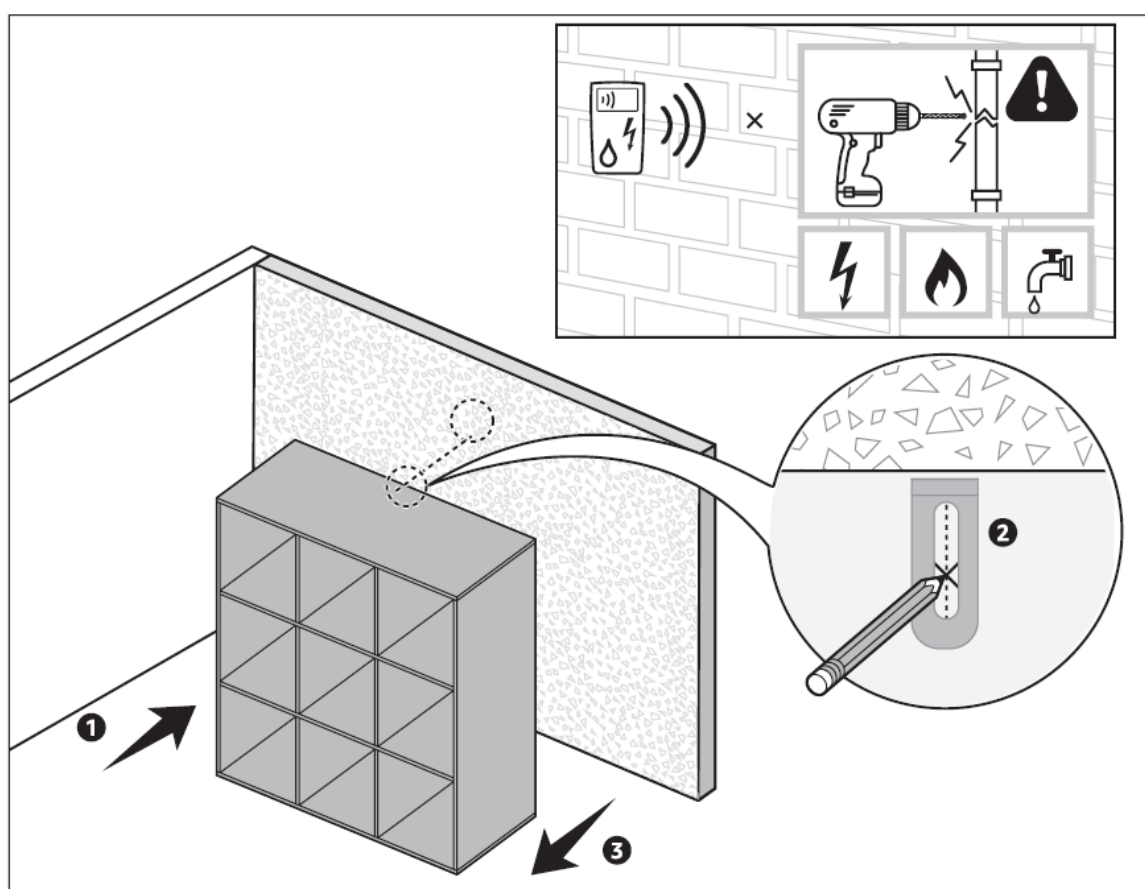

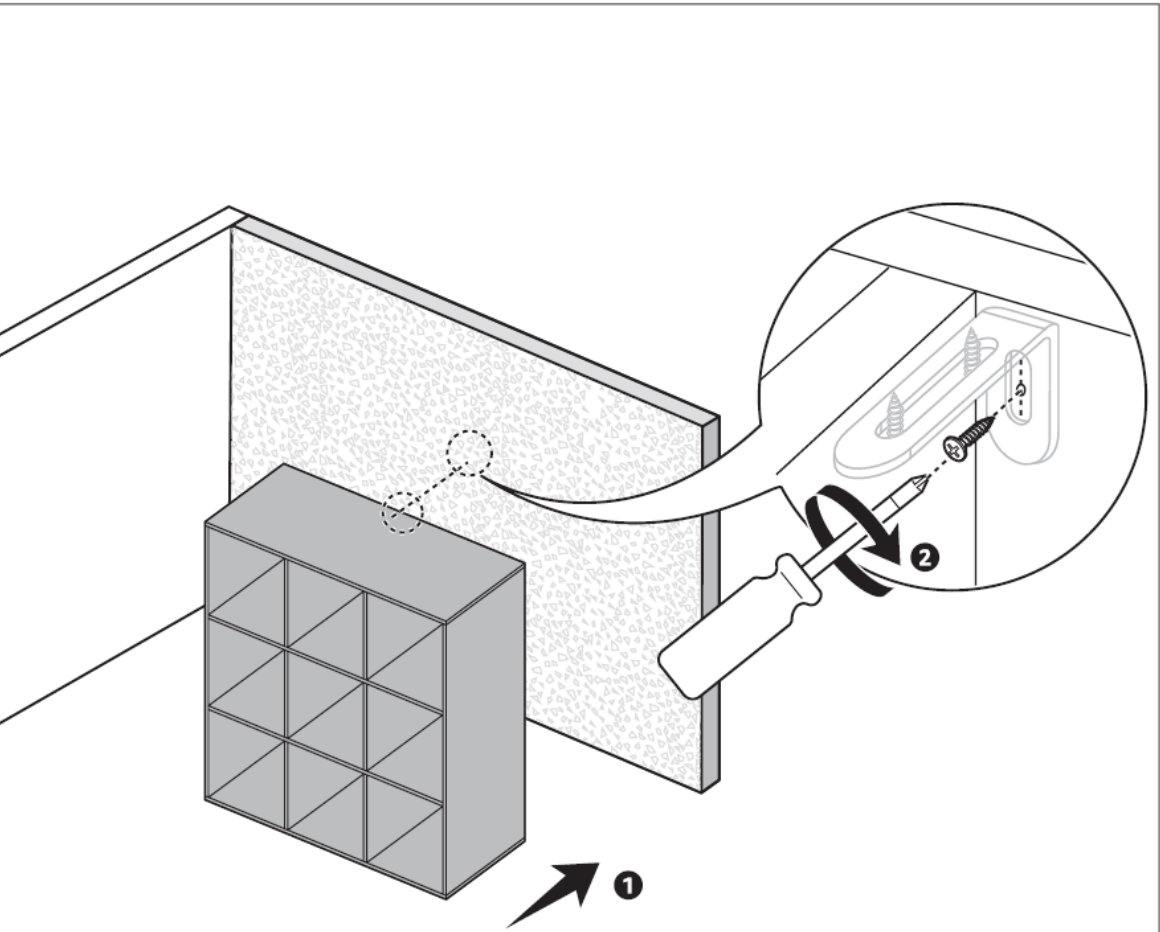
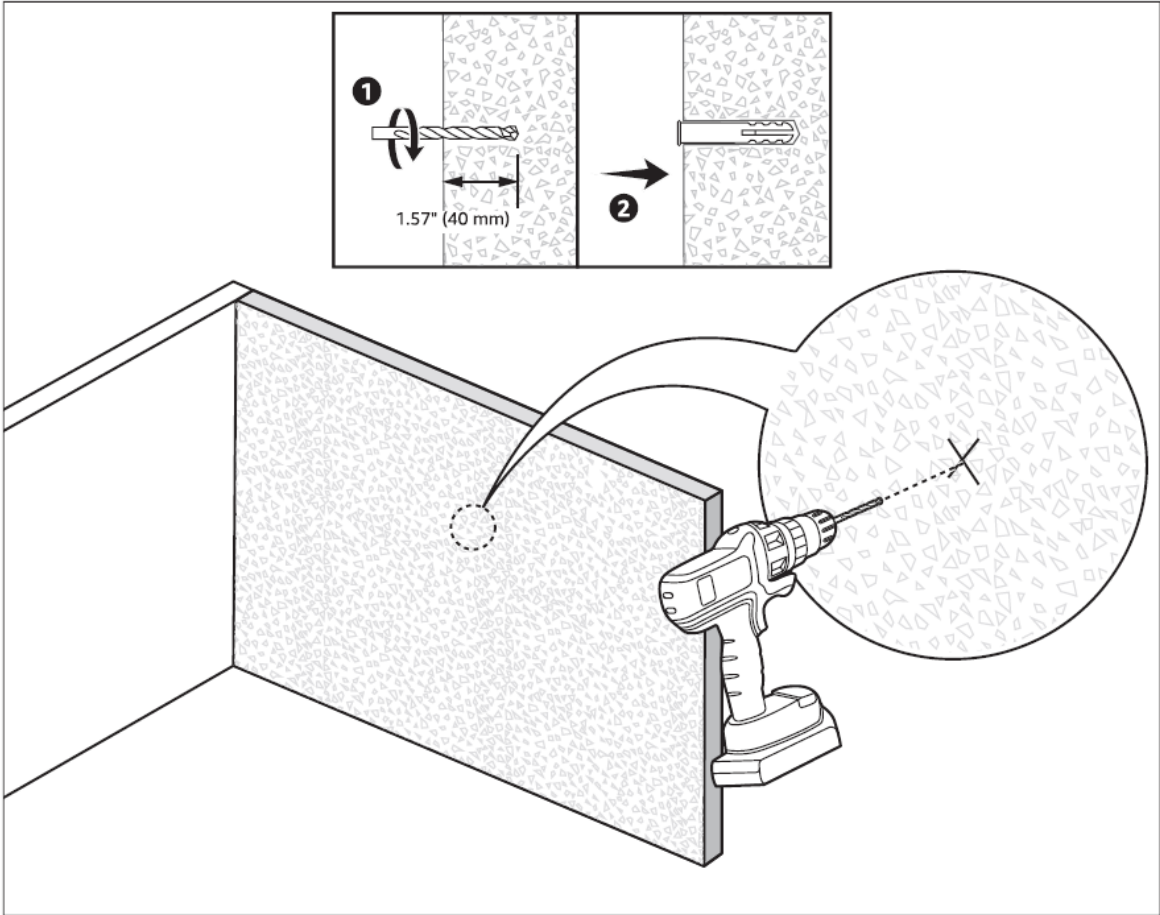

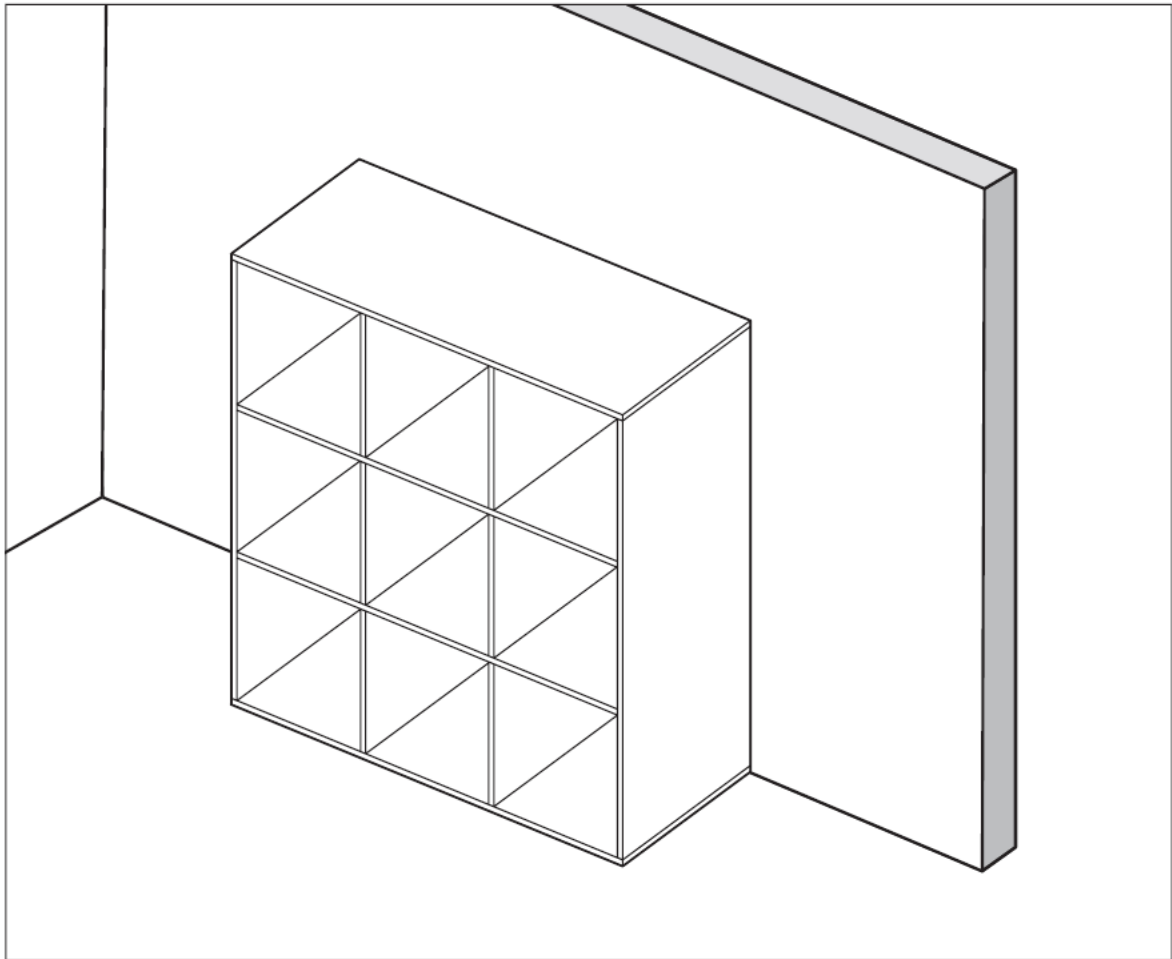

## Documents / Resources

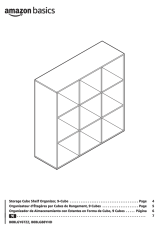
	<p><a href="#">amazon basics B0BLGY6TZZ Storage Cube Shelf Organizer 9 Cubes</a> [pdf] Instruction Manual</p> <p>B0BLGY6TZZ Storage Cube Shelf Organizer 9 Cubes, B0BLGY6TZZ, Storage Cube Shelf Organizer 9 Cubes, Cube Shelf Organizer 9 Cubes, Shelf Organizer 9 Cubes, Organizer 9 Cubes</p>
---	--

## References

- [User Manual](#)

[Manuals+.](#) [Privacy Policy](#)

This website is an independent publication and is neither affiliated with nor endorsed by any of the trademark owners. The "Bluetooth®" word mark and logos are registered trademarks owned by Bluetooth SIG, Inc. The "Wi-Fi®" word mark and logos are registered trademarks owned by the Wi-Fi Alliance. Any use of these marks on this website does not imply any affiliation with or endorsement.