

amazon basics B09V8KVL6B Hose Reel Cart 30 M



# amazon basics B09V8KVL6B Hose Reel Cart 30 M Instruction Manual

[Home](#) » [amazon basics](#) » amazon basics B09V8KVL6B Hose Reel Cart 30 M Instruction Manual 

## Contents

- [1 amazon basics B09V8KVL6B Hose Reel Cart 30 M](#)
- [2 Important Safety Instructions](#)
- [3 Before First Use](#)
- [4 Product Description](#)
- [5 Adjusting the handle/supporting leg](#)
- [6 Connecting to the water supply](#)
- [7 Use](#)
- [8 Cleaning and Maintenance](#)
- [9 Frequently Asked Questions](#)
- [10 Disposal](#)
- [11 Specifications](#)
- [12 Feedback and Help](#)
- [13 Documents / Resources](#)
  - [13.1 References](#)

**amazon basics**

amazon basics B09V8KVL6B Hose Reel Cart 30 M



## Important Safety Instructions

- Read these instructions carefully and retain them for future use. If this product is passed to a third party, then these instructions must be included. When using the product, basic safety precautions should always be followed to reduce the risk of injury including the following:

### **WARNING** Risk of electric shock!

Do not aim the water jet at electrical appliances, equipment or outdoor power sockets.

- **CAUTION** Risk of injury! Do not aim the water jet at persons or animals.
- **CAUTION** Risk of damage to the water inlet! Use the inlet hose included only. Do not use other solid or rigid piping.
- Keep the work area clean and dry. Damp work areas can result in injury.
- Keep children away from the work area. Do not allow children to handle this product.
- Do not modify this product, and do not use this product for a purpose for which it was not intended.
- Before using this product, carefully check that it operates properly and performs its intended function. Check for damaged parts and any other conditions that may affect the operation. Replace damaged or worn parts immediately.
- Do not overreach. Keep proper footing and balance at all times to prevent tripping, falling, or back injury, etc.
- Do not use the product when tired or under the influence of drugs, alcohol, or medication. A moment of inattention while operating this product may result in a personal injury.
- Ensure that the product is properly assembled and installed before connecting input and output hoses.
- Before each use, check that the hose is not obstructed in any way. During use, stay aware of the state of the hose to prevent it from getting kinks, being run over or blocked by other gardening equipment or objects. Water pressure build up inside the hose can cause damage and injury. Make sure the incoming water pressure does not exceed the rated operating pressure of the product.
- Do not use hoses different from those for which the product is intended. See the “Specifications” chapter.

- Do not leave water running through the product unsupervised.
- Do not expose the product to freezing temperatures with water remaining in the unit.
- Turn the water off after each use.
- The product is not suitable for supplying drinking water. Ensure that no water from the inlet hose gets into the drinking water supply by fitting a non-return valve or a pipe interrupter between the tap and the hose inlet.
- This product is intended for private use only.

## Before First Use

**DANGER** Risk of suffocation!

Keep any packaging materials away from children and pets – these materials are a potential source of danger, e.g. suffocation.

- Remove all the packing materials.
- Remove and review all components before starting assembly.
- Check the product for transport damages.

## Product Description

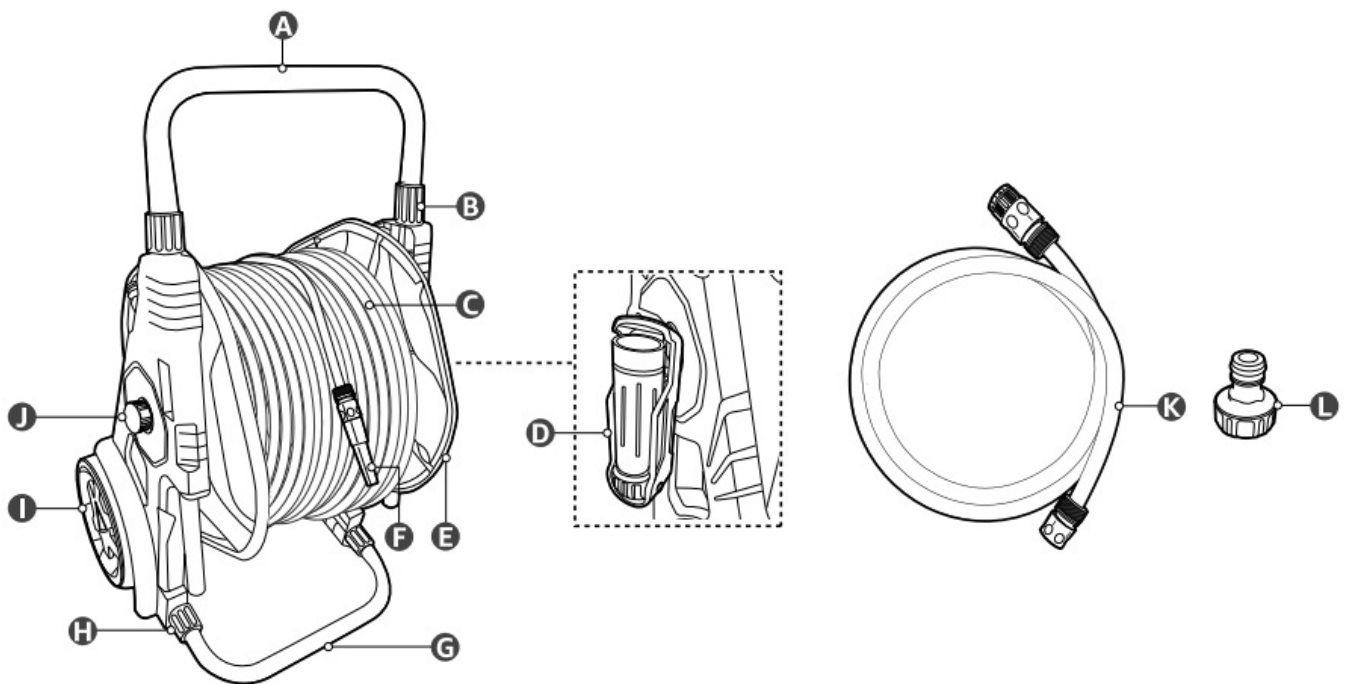

- A Handle
- B Locking sleeve (handle)
- C Supply hose
- D Crank handle
- E Hose reel
- F Nozzle
- G Supporting leg
- H Locking sleeve (support leg)
- I Wheels

- J Water inlet (with cover cap)
- K Inlet hose (one end with quick connector; one end with quick connector and adapter set (012.7 mm, 019 mm))
- L Water inlet adapter

## Adjusting the handle/supporting leg

1. To adjust the height of the handle (A), unscrew the locking sleeves in an anti-clockwise direction (Fig. 1 ).
2. Lift the handle (A) or push it down as desired, applying the same amount of pressure on both sides of the handle (A).
3. After adjustment, securely fasten the locking sleeves in a clockwise direction.
4. To adjust the length of the supporting leg (G), unscrew the locking sleeves in an anti-clockwise direction (Fig. 2).
5. Push the supporting leg (G) inward or outward as desired, applying the same amount of pressure on both sides of the supporting leg (G)).
6. After adjustment, securely fasten the locking sleeves in the clockwise direction.

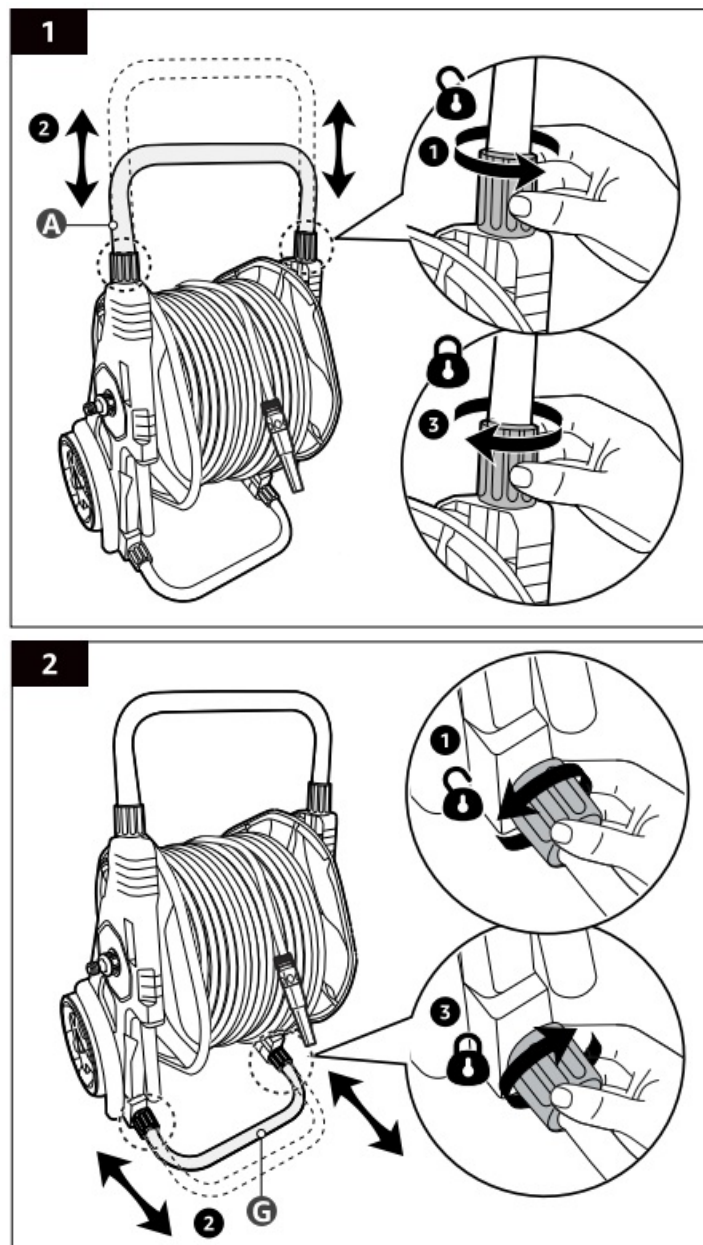

## Connecting to the water supply

**CAUTION** Risk of damage!

The supply line pressure must not exceed the maximum working pressure of the product.

1. Locate the end of the inlet hose (K) with a quick connector and adapter. Pull the sleeve on the quick connector to detach the adapter set (Fig. 3).

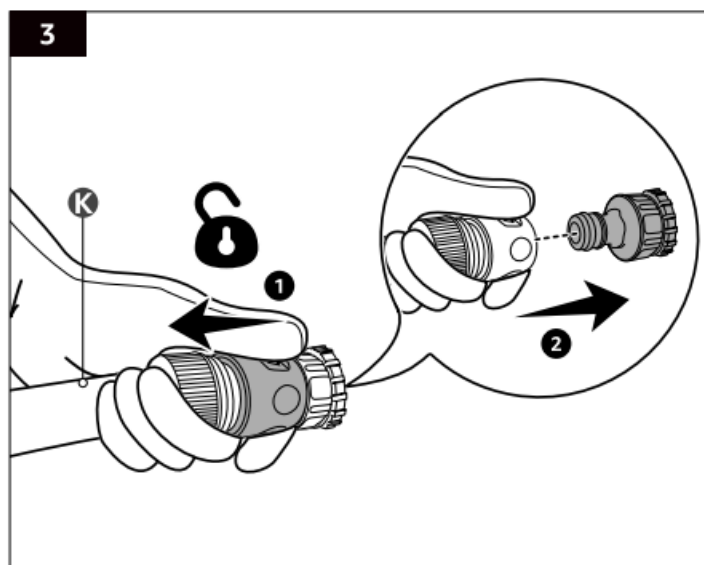

2. Separate the adapter set by turning the bottom sleeve anticlockwise (Fig. 4).

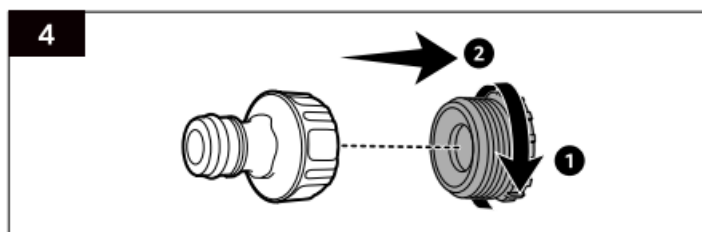

3. Install the adapter parts onto a suitable water tap.

- For a 12.7 mm water tap, attach first the 12.7 mm adapter and then the 19 mm adapter to the water tap (Fig. 5).

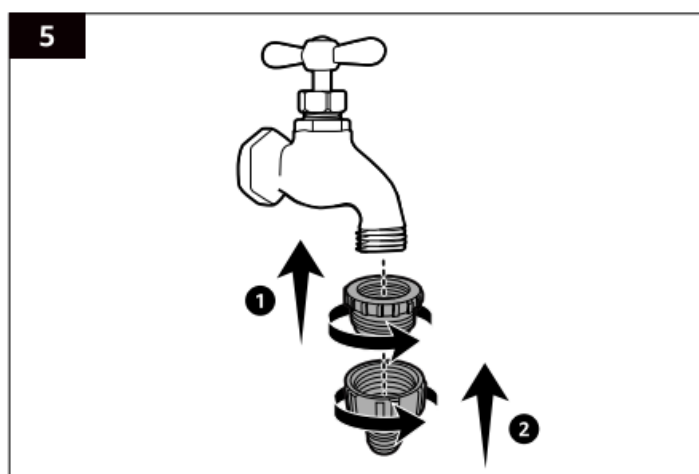

- For a 19 mm water tap, attach only the 19 mm adapter to the water tap (Fig. 6).

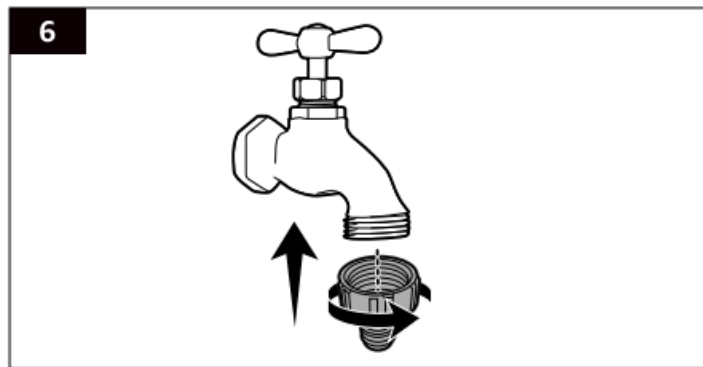

4. Unscrew the cover cap from the water inlet (J). Install the water inlet adapter (L) onto the water inlet (J) (Fig. 7).

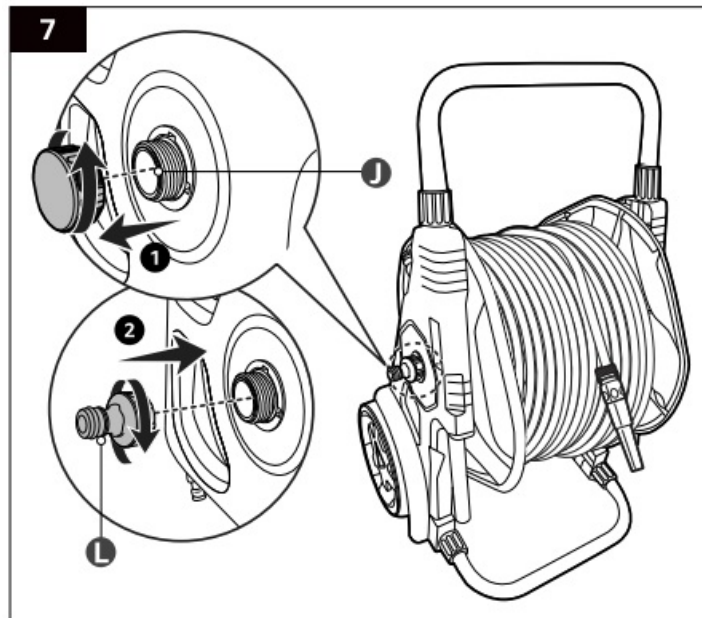

5. Connect one end of the inlet hose (K) to the adapter on the tap, and connect the other end to the water inlet adapter (L) on the water inlet (J) (Fig. 8).

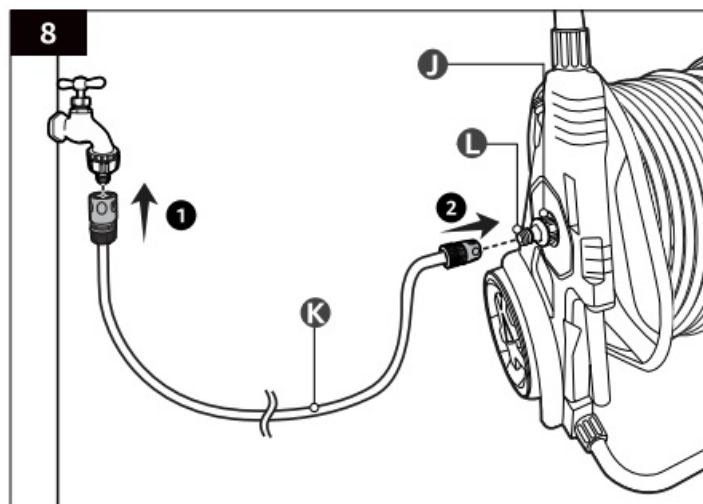

## Use

### Caution Risk of damage

Avoid folding or pressing on the inlet hose (K) or supply hose (C) while water is running, which can cause high water pressure in the hoses (C/ K) and can damage the product.

- **To extend:** hold the nozzle (F) and slowly pull the supply hose (K) out.

- **To spray:** adjust the spray pattern by turning the tip of the nozzle (F) (Fig. 9). Turn it anti-clockwise for a cone spray, or turn clockwise for a concentrated stream.

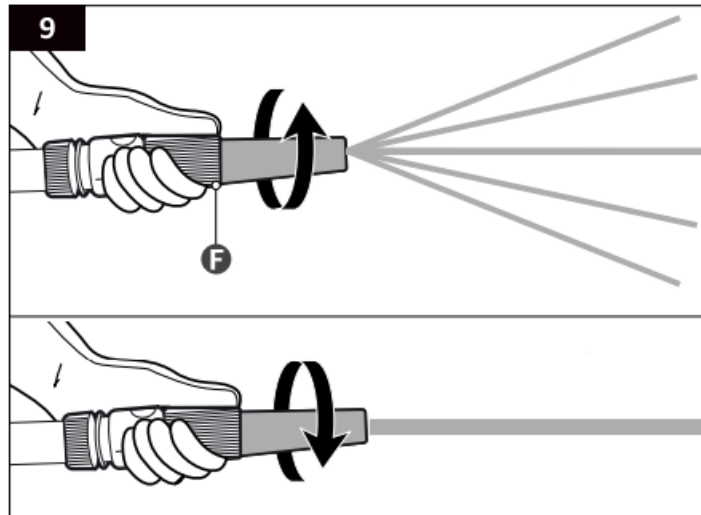

- To wind: unfold the crank handle (D) (Fig. 10) and turn it anticlockwise to roll up the supply hose (C).

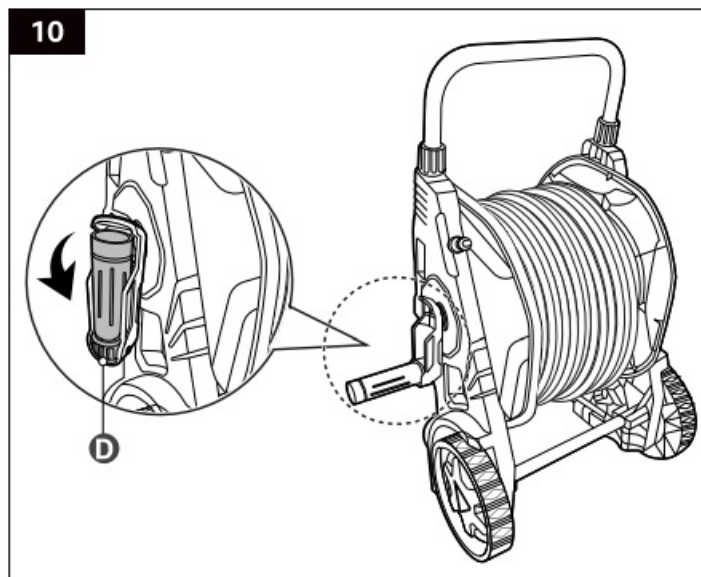

- After winding up the supply hose (C), press the release button and fold the crank handle (D) (Fig. 11).

**CAUTION** Risk of injury!

- Use caution when folding the crank handle (D) to avoid pinching the fingers.

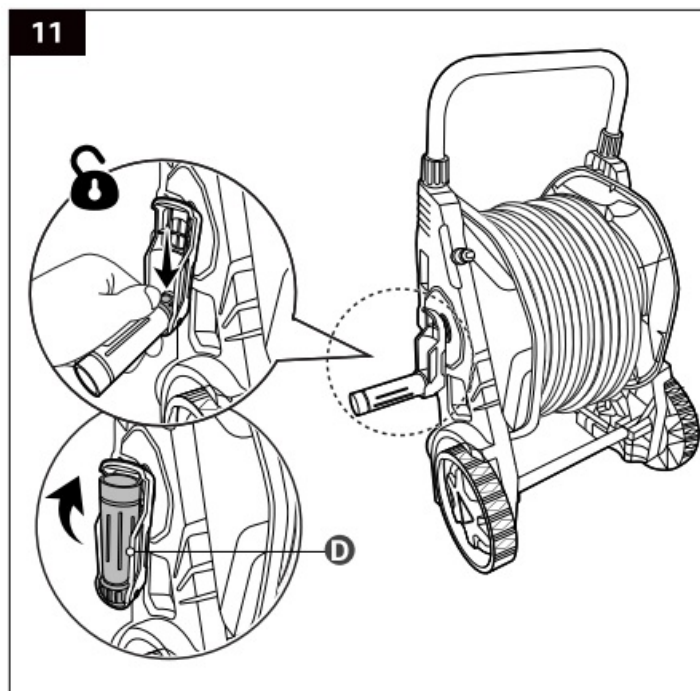

## Cleaning and Maintenance

### Cleaning

- To clean the product, wipe with a soft, slightly damp cloth.
- Wash and rinse the hoses (C/ K) to remove any soil or heavy dirt after use. Use a plastic brush for stubborn dirt if needed. Let the hoses (C/ K) air dry.
- Pull the sleeve on the quick connector of the supply hose (C) to detach the nozzle (F) (Fig. 12). To unclog the nozzle (F), insert a needle (not included) into the nozzle opening and move it back and forth.

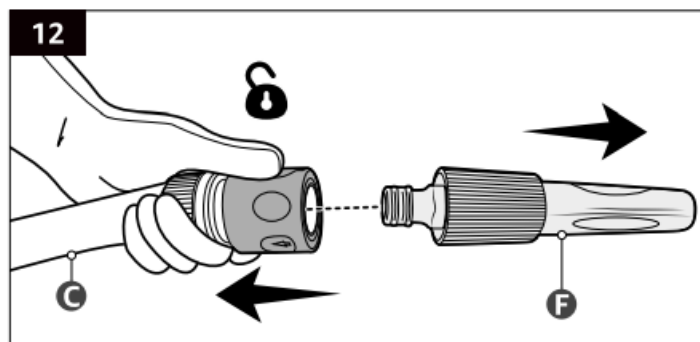

- Never use corrosive detergents, wire brushes, abrasive scourers, or metal or sharp utensils to clean the product.

### Storage

- Drain all water from the hoses (C/ K).
- Store the product and its accessories in a frost-free area. Do not store the product in an area with ambient temperature below 0° C.

### Maintenance

- Regularly check that all the components and fasteners are tightened.



- Use soap and water when checking the connections for leakage.
- Store the product in a cool and dry place away from children and pets, ideally in its original packaging.
- Avoid any vibrations and shocks.

## Frequently Asked Questions

Problem	Solution
Water leaks on the quick connectors.	<ul style="list-style-type: none"> <li>▶ Water pressure too high. Do not exceed the maximum pressure rating of the hose reel.</li> <li>▶ As a temporary solution, apply plumber's tape (not included) on all threaded connections.</li> </ul>
The product does not spray properly.	<ul style="list-style-type: none"> <li>▶ Clean and unclog the nozzle.</li> <li>▶ Apply silicone lubricant on the O-rings on the quick connectors and on the water adapters.</li> </ul>

## Disposal

Dispose of the product according to local regulations. If in doubt, consult your local authorities.

## Specifications

Model number	B09V8KVL6B (JC761)
Maximum operating pressure	8 Bar
Hose working temperature	0 to 55 °C
Length of the supply hose length	30 m
Length of the inlet hose	2 m
Inlet hose diameter	11.5 mm (inner), 15.8 mm (outer)
Tap connection	12.7 mm and 19 mm
Net weight	approx. 6.45 kg
Dimensions (W x H x D)	approx. 47.5 x 84 x 39 cm

## Importer Information

	<b>For EU</b>
Postal:	Amazon EU S.à r.l., 38 avenue John F. Kennedy, L-1855 Luxembourg
Business Reg.:	134248
	<b>For UK</b>
Postal:	Amazon EU SARL, UK Branch, 1 Principal Place, Worship St, London EC2A 2FA, United Kingdom
Business Reg.:	BR017427

## Feedback and Help

We would love to hear your feedback. To ensure we are providing the best customer experience possible, please consider writing a customer review.

- [amazon.co.uk/review/review-your-purchases#](https://amazon.co.uk/review/review-your-purchases#)

If you need help with your Amazon Basics product, please use the website or number below.

- [amazon.co.uk/gp/help/customer/contact-us](https://amazon.co.uk/gp/help/customer/contact-us)
- [amazon.com/AmazonBasics](https://amazon.com/AmazonBasics)

## Documents / Resources

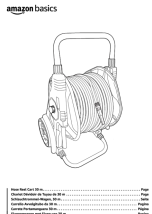
	<p><a href="#">amazon basics B09V8KVL6B Hose Reel Cart 30 M</a> [pdf] Instruction Manual B09V8KVL6B Hose Reel Cart 30 M, B09V8KVL6B, Hose Reel Cart 30 M, Reel Cart 30 M, Cart 30 M</p>
---	---

## References

- [User Manual](#)

[Manuals+](#), [Privacy Policy](#)

This website is an independent publication and is neither affiliated with nor endorsed by any of the trademark owners. The "Bluetooth®" word mark and logos are registered trademarks owned by Bluetooth SIG, Inc. The "Wi-Fi®" word mark and logos are registered trademarks owned by the Wi-Fi Alliance. Any use of these marks on this website does not imply any affiliation with or endorsement.