



amazon basics B09NS4RVQ9 Cordless 2 in 1 Vacuum Cleaner Instruction Manual

[Home](#) » [amazon basics](#) » amazon basics B09NS4RVQ9 Cordless 2 in 1 Vacuum Cleaner Instruction Manual 

Contents

- [1 amazon basics B09NS4RVQ9 Cordless 2 in 1 Vacuum Cleaner](#)
- [2 Product Information](#)
- [3 Product Usage Instructions](#)
- [4 Important Safety Instructions](#)
- [5 Specifications](#)
- [6 Appliance Description](#)
- [7 Before First Use](#)
- [8 Charging the Appliance](#)
- [9 Operation](#)
- [10 Mounting the Wall Bracket](#)
- [11 Cleaning and Maintenance](#)
- [12 Frequently Asked Questions](#)
- [13 Documents / Resources](#)
 - [13.1 References](#)
- [14 Related Posts](#)



amazon basics B09NS4RVQ9 Cordless 2 in 1 Vacuum Cleaner



Product Information

Product Name	2 in 1 Cordless Vacuum Cleaner
Model Numbers	B09NS4RVQ9, B09NS53XPN

Product Usage Instructions

Safety Instructions

- Read these instructions carefully and retain them for future use. If this appliance is passed to a third party, then these instructions must be included.
- When using electrical appliances, basic safety precautions should always be followed to reduce the risk of fire, electric shock, and/or injury to persons including the following:
- Risk of electric shock! For the purposes of recharging the battery, only use the detachable supply unit (i.e. battery charger model: MC2508B-V) provided with this appliance.
- When not in use for extended periods, disconnect the battery charger from the power supply.
- The motor and motorized cleaning head are not replaceable.

Battery Warnings

Risk of explosion! Risk of explosion if the battery is replaced by an incorrect type.

Symbols Explanation

This symbol stands for United Kingdom Conformity Assessed. With the UKCA-marking, the manufacturer confirms that this product complies with applicable regulations and standards within Great Britain.

Intended Use

No specific information provided in the manual.

Specifications

Model Number	B09NS4RVQ9 (V18P01CP25EU)	B09NS53XPN (V18P01CP25EU-BLDC)
Rated Voltage	25.2 V	25.2 V
Rated Power	150 W	350 W
Battery Type / Capacity	Li-ion, 2000 mAh	Li-ion, 2000 mAh
Charging Time	4 to 6 hours	4 to 6 hours
Operating Time	15 minutes (on Normal setting); 40 minutes (on Slow setting)	8 minutes (on high setting 3); 25 (on medium setting 2); 55 minutes (on low setting 1)
Dust Cup Capacity	0.7 L	0.7 L
Vacuum Power	9 kPa	20 kPa
Filtration Efficiency	95 %	95 %
Protection Class	III	III
Net Weight	approx. 2.6 kg	approx. 2.6 kg
Dimensions (W x H x D)	approx. 25.3 x 109 x 22.3 cm	approx. 25.3 x 109 x 22.3 cm

Battery Charger

Model Number	MC2508B-V
Input	100-240 V~, 50-60 Hz, 0.8 A
Output	25 V 0.8 A; 20 W
Protection Class	II

Motorsied Cleaning Head

Model Number	EBT03F
Rated Power	25.2 V 10 W

Appliance Description

- A – Handle
- B – Charging socket

- C – Power button (on/off)
- D – Suction power control button
- E – Suction power indicator
- F – Battery level indicator
- G – Motor unit
- H – Dust cup release button
- I – HEPA Filter
- J – Dust cup
- K – Suction tube
- L – Crevice nozzle
- M – Extendable dusting brush
- N – Motorised cleaning head (with roller brush)
- O – LED front lights
- P – Wall bracket
- Q – Screw, x3
- R – Wall plug, x3
- S – Battery charger (with interchangeable EU plug)

For UK, the importer information is as follows:

- Postal: Amazon EU SARL, UK Branch, 1 Principal Place, Worship St, London EC2A 2FA, United Kingdom
- Business Reg.: BR017427

Important Safety Instructions

- Read these instructions carefully and retain them for future use. If this appliance is passed to a third party, then these instructions must be included.
- When using electrical appliances, basic safety precautions should always be followed to reduce the risk of fire, electric shock, and/or injury to persons including the following:
- **WARNING** Risk of electric shock!
 - For the purposes of recharging the battery, only use the detachable supply unit (i.e. battery charger model: MC2508B-V) provided with this appliance.
- This appliance can be used by children aged from 8 years and above and persons with reduced physical, sensory or mental capabilities or lack of experience and knowledge if they have been given supervision or instruction concerning use of the appliance in a safe way and understand the hazards involved. Children shall not play with the appliance. Cleaning and user maintenance shall not be made by children without supervision.
- Children should be supervised to ensure that they do not play with the appliance.
- The plug must be removed from the socket-outlet before cleaning or maintaining the appliance.
- The appliance is only to be used with the power supply unit (i.e. battery charger model: MC2508B-V) provided with the appliance.
- The appliance must only be supplied at safety extra low voltage corresponding to the marking on the appliance.
- The supply cord cannot be replaced. If the cord is damaged the battery charger should be scrapped.
- Never use the appliance without the dust cup and filters installed. This could damage the motor and shorten

the appliance's lifespan.

- Never use any of the nozzle or brushes on people, animals or plants.
- Do not vacuum up anything which has been burning or smoking such as cigarettes, ashes or matches.
- Do not vacuum up any water, liquid or damp dirt.
- Do not vacuum up any inflammable or combustible liquids or gases and do not vacuum in areas where such substances are stored.
- Keep body parts and clothing away from any openings or moving parts of the appliance.
- Switch off the appliance before attaching, removing and cleaning the accessories.
- Use only authorized accessories and replacement parts.
- Use extra care when vacuuming on stairs.
- Do not charge the appliance outdoors.
- Do not charge or store the appliance near heat sources.
- Unplug the battery charger when not in use for extended periods.
- The LED front lights of the motorized cleaning head are not replaceable.

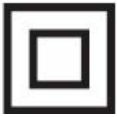

- This battery charger is classified as protection class II. This means the battery charger is equipped with reinforced or double insulation between the mains supply circuit and the output voltage or the casing. Therefore it does not require a safety connection to an electrical earth (ground).

Battery Warnings

CAUTION Risk of explosion!

Risk of explosion if the battery is replaced by an incorrect type.

- This appliance contains battery that is only replaceable by skilled persons.
- Before disposal, the battery must be removed from the appliance. Contact qualified professional.
- Do not leave the battery charging for a prolonged period of time when the appliance is not in use.
- Do not charge the battery overnight.
- If the appliance appears to be bulging or shows other undesirable phenomena (e.g. excess noise), stop using the appliance immediately.
- Do not cover the appliance while charging the battery. Charge the appliance in a well-ventilated environment.
- When in long term storage, charge the battery to its 70 % capacity once every 3 months to avoid shortening its life.
- Batteries produce heat when charging and discharging. If the appliance becomes too hot to touch, switch the appliance off and unplug immediately.
- If the battery leaks, avoid contact with skin and eyes. Rinse affected areas immediately with plenty of clean water, then consult a doctor.

Symbols Explanation



- This symbol stands for "Conformity Europeans", which declares "Conformity with EU directives, regulations and applicable standards". With the CE-marking, the manufacturer confirms that this product

complies with applicable European directives and regulation.



- This symbol stands for “United Kingdom Conformity Assessed”. With the UKCA- marking, the manufacturer confirms that this product complies with applicable regulations and standards within Great Britain.

Intended Use

- This appliance is intended for dry vacuuming only. It is suitable for hard floors, carpets, furniture and similar surfaces.
- This appliance is intended for household use only.
- This appliance is intended to be used in dry indoor areas only.

Specifications

Appliance

- **Model number:**
 - B09NS4RVQ9 (V18P01CP25EU)
 - B09NS53XPN (V18P01CP25EU-BLDC)
- **Rated voltage**
 - 25.2 V
 - 25.2 V
- **Rated power**
 - 150 W
 - 350 W
- **Battery type / capacity**
 - Li-ion, 2000 mAh
 - Li-ion, 2000 mAh
- **Charging time**
 - 4 to 6 hours
 - 4 to 6 hours
- **Operating time**
 - 15 minutes (on Normal setting);
 - 40 minutes (on Slow setting)
 - 4 to 6 hours
 - 8 minutes (on high setting 3);
 - 25 (on medium setting 2);
 - 55 minutes (on low setting 1)
- **Dust cup capacity**
 - 0.7 L
 - 0.7 L
- **Vacuum power**

- 9 kPa
- 20 kPa
- **Filtration efficiency**
 - 95 %
 - 95 %
- **Protection class III : III**
- **Net weight**
 - approx.2.6 kg
 - approx. 2.6 kg
- **Dimensions (W x H x D)**
 - approx. 25.3 x 109 x 22.3 cm
 - approx. 25.3 x 109 x 22.3 cm

Battery charger

- **Model** number MC2508B-V
- **Input** 100-240 V~, 50-60 Hz, 0.8 A
- **Output**
 - 25 V 0.8 A; 20 W
 - 29 V 0.8 A; 23.2 W
- **Protection class II**

Motorised cleaning head

- Model number EBT03F
- Rated power 25.2 V 10 W

Importer Information

- **For UK**
 - Postal: Amazon EU SARL, UK Branch, 1 Principal Place, Worship St, London EC2A 2FA, United Kingdom
 - Business Reg.: BR017427

Appliance Description

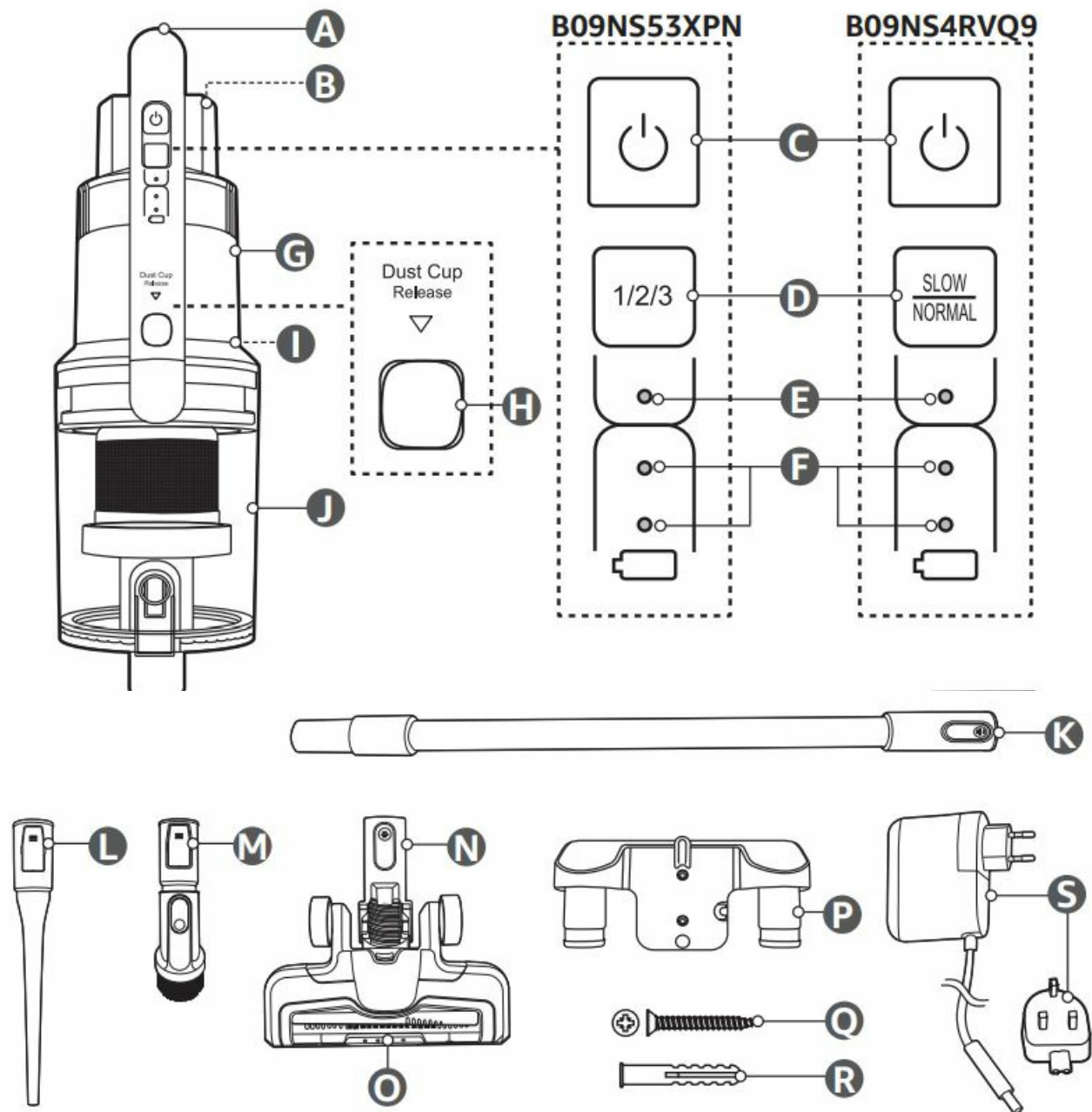

- A Handle
- B Charging socket
- C button  (on/off)
- D Suction power control button
- E Suction power indicator
- F Battery level indicator
- G Motor unit
- H Dust cup release button
- I HEPA Filter
- J Dust cup
- K Suction tube
- L Crevice nozzle
- M Extendable dusting brush
- N Motorised cleaning head (with roller brush)
- O LED front lights

- P Wall bracket
- Q Screw, x3
- R Wall plug, x3
- S Battery charger (with interchangeable EU and UK plug)

Before First Use

DANGER Risk of suffocation!

Keep any packaging materials away from children and pets – these materials are a potential source of danger, e.g. suffocation.

- Remove all the packing materials.
- Remove and review all components before use.
- Check the appliance for transport damages.
- Before charging, check that the power supply voltage and current rating correspond with the power supply details shown on the rating labels on the appliance and battery charger.
- Fully charge the appliance before using for the first time to activate maximum power in the battery.

Charging the Appliance

NOTICE

- Fully charge the appliance before using it for the first time. It takes about 4 to 6 hours to fully charge the appliance.
- Charge the appliance when the suction power is noticeably weaker and when the lower battery level indicator (F) flashes.

1. Slide the suitable plug onto the battery charger (S) (Fig. 1).

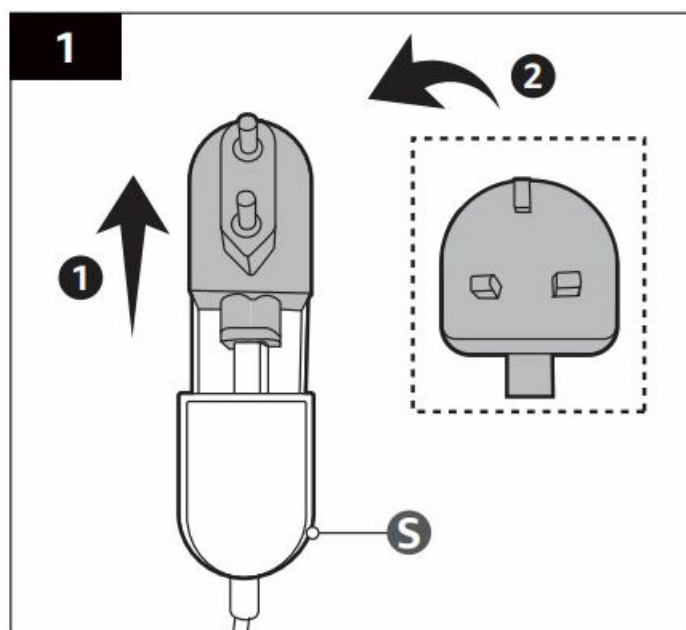

2. Connect the cable of the battery charger (S) to the charging socket (B) (Fig. 2).

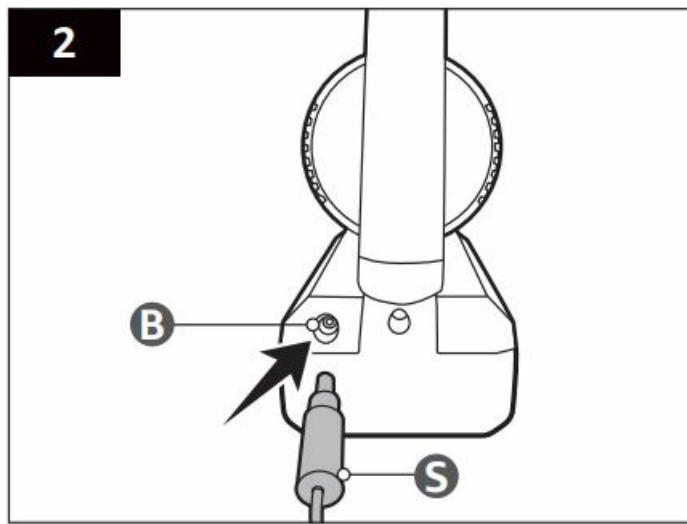

3. Connect the plug of the battery charger (S) to a suitable socket-outlet. The battery level indicators (F) keep flashing until charging has finished.
4. Allow 4 to 6 hours to fully charge the appliance completely until the battery level indicators (F) go off.
5. Disconnect the battery charger (S) from the charging socket (B) and from the socket-outlet.

Operation

Accessories function

Suction tube (K)

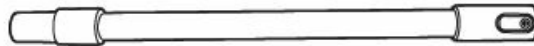

- Suitable for floor cleaning and hard-to-reach areas.
- Assemble the suction tube (K) between the motor unit (G) and the desired brush or nozzle (L/ M/ N).
- It is not recommended to use the suction tube (K) for cleaning carpeted stairs, upholstery or car seats.

Crevice nozzle (L)



- Suitable for cleaning in folds, crevices or corners.
- Suitable for hard-to-reach areas, such as behind furniture and between and under car seats.

Extendable dusting brush (M)



- Suitable for cleaning window blinds, shelves, upholstery and wooden surfaces.
- Press the unlock button and pull to extend (Fig. 3), if needed.

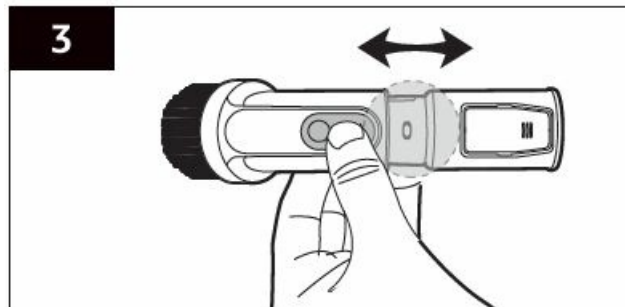

Motorised cleaning head (N)

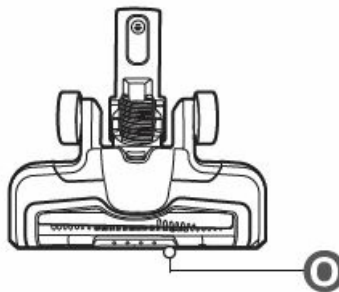

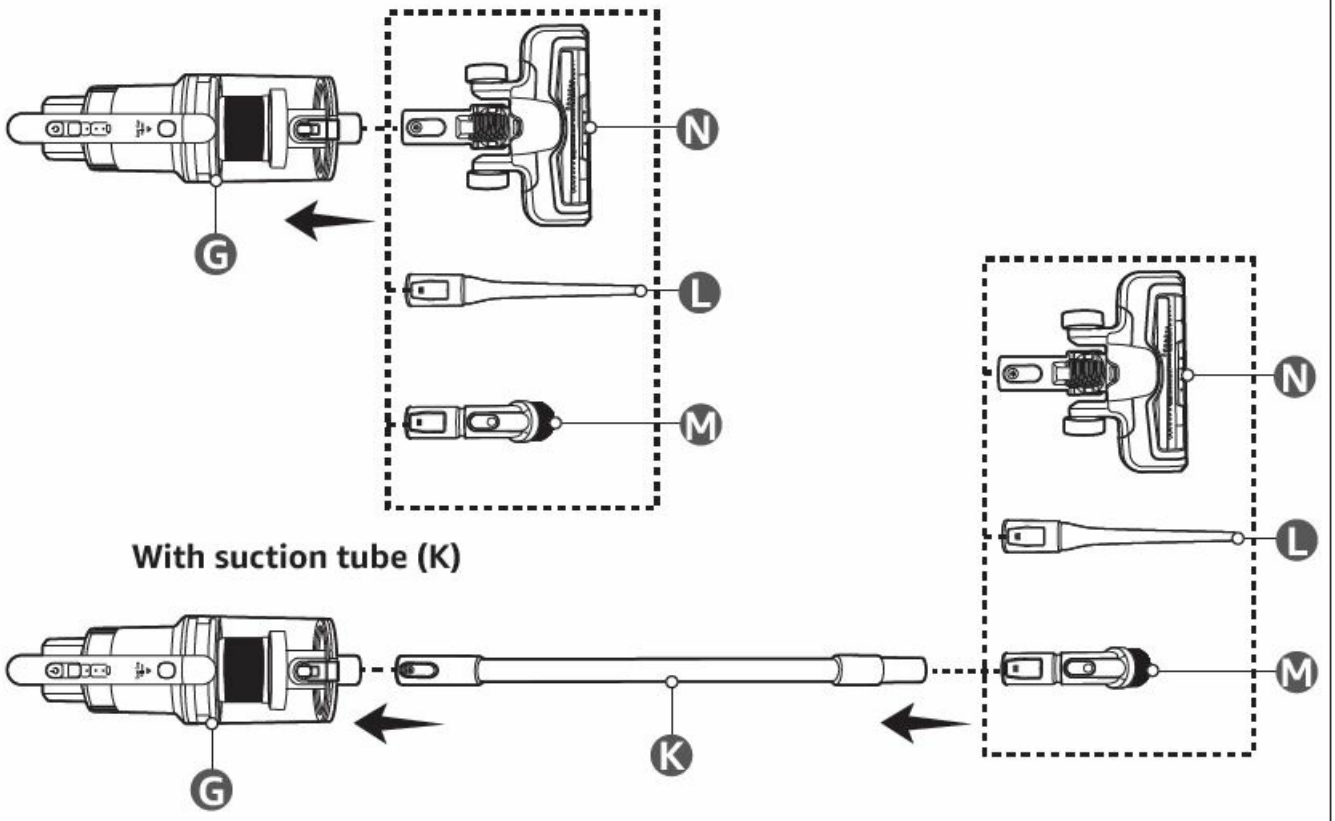

- Suitable for all normal cleaning of carpets, rugs and hard flooring.
- The motorised cleaning head (N) is equipped with LED front lights (O) for additional light on the working surface.
- When using the motorised cleaning head (N), do not use it at head height

NOTICE The appliance can be used with or without suction tube (K). Attach the crevice nozzle (L), extendable dusting brush (M) or motorised cleaning head (N) to the motor unit (G). Attach the suction tube (K) in between when needed (Fig. 4).

4**Without suction tube (K)****Detaching accessories**

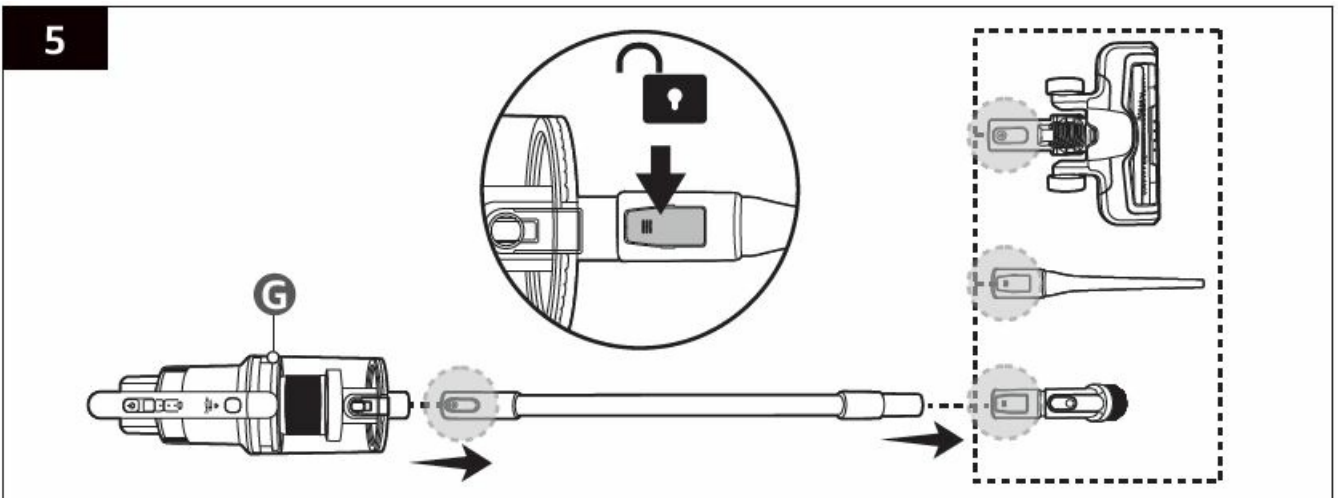
NOTICE Press the release button on the parts and pull to detach them from the motor unit (G) (Fig. 5).

5**Switching on/off**

1. Press the  button (C) to switch the appliance on.
2. Press the suction power control button (D) to select the desired suction power.
3. After use, press the  button (C) to switch the appliance off.

Model	B09NS4RVQ9	
Setting	SLOW	NORMAL
Suction power Indicator (E)	Off	On

Model	B09NS53XPN		
Setting	1 (Low)	2 (Medium)	3 (High)
Suction power Indicator (E)	Off	Lights up white	Lights up blue

Mounting the Wall Bracket

NOTICE

- This wall bracket (P) should be mounted only by an adult. If in doubt, consult a professional.
- Before mounting, determine the suitable mounting location. The wall bracket (P) must be fixed to a wooden or masonry/concrete wall using fasteners that are appropriate for the mounting surface. Do not install on drywalls, wall boards or thin plywood. The mounting surface must be capable of supporting the weight of the appliance and its accessories.
- Do not drill into any pipes or power lines beneath the surface during mounting holes preparation. Use voltage/metal detector before drilling any holes to eliminate any such potential risks.
- Do not hang anything other than the appliance and its accessories on the wall bracket (P).
- Mount the wall bracket on a suitable location near a suitable socket-outlet for charging the appliance.

1. Mark the positions of the screw holes at the desired height (Fig. 6).

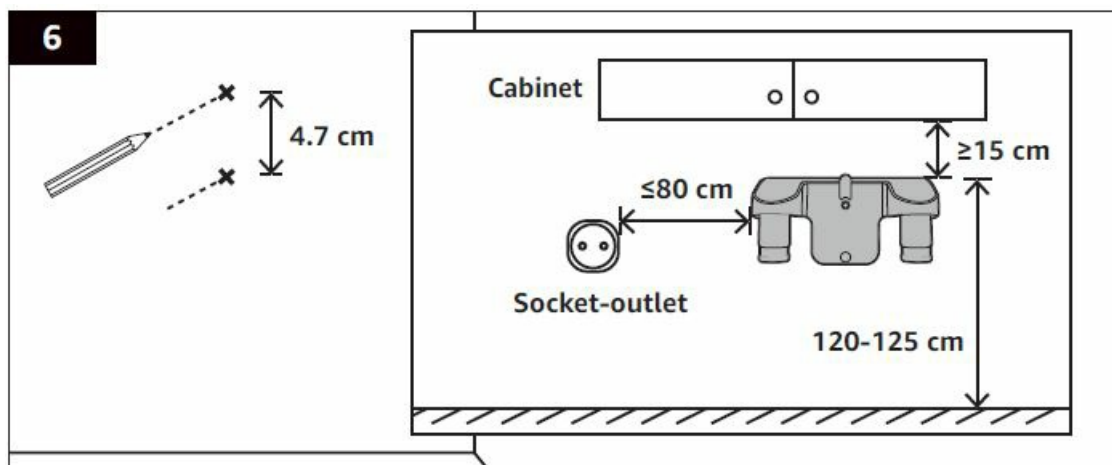

2. Drill the holes. Insert the wall plugs (R) for concrete walls (Fig. 7).

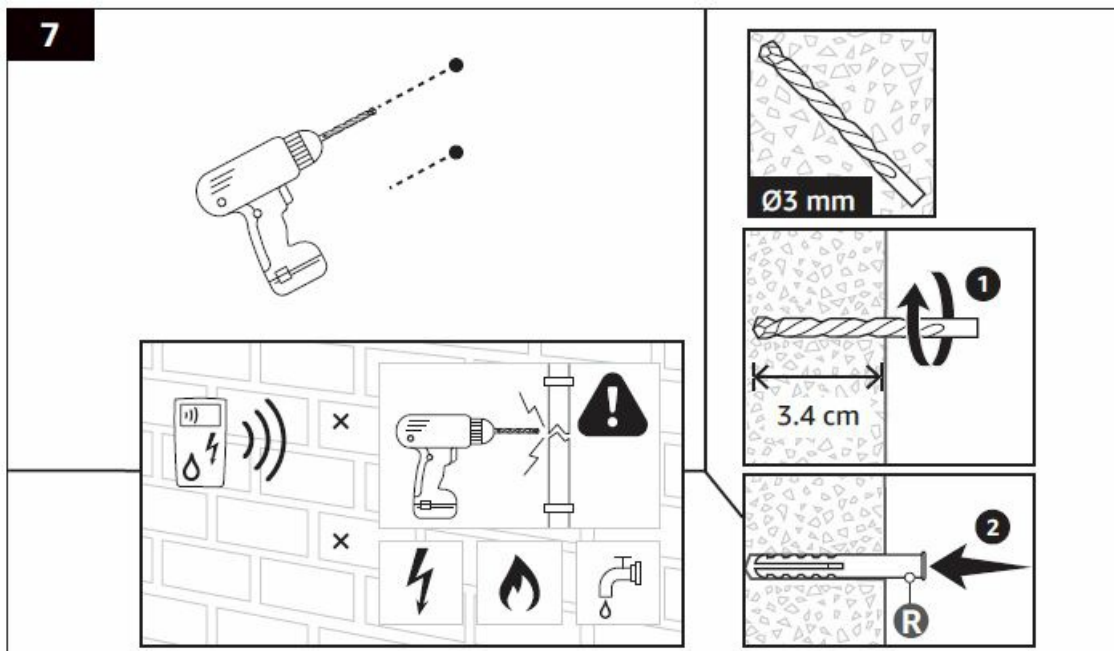

3. Mount the wall bracket (P) on the wall with the 2 screws (Q) using a screwdriver (not included) (Fig. 8).
4. Click the crevice nozzle (L) and extendable dusting brush (M) into place on the wall bracket (P) (Fig. 9). To take out the part, press the release button and pull downwards.

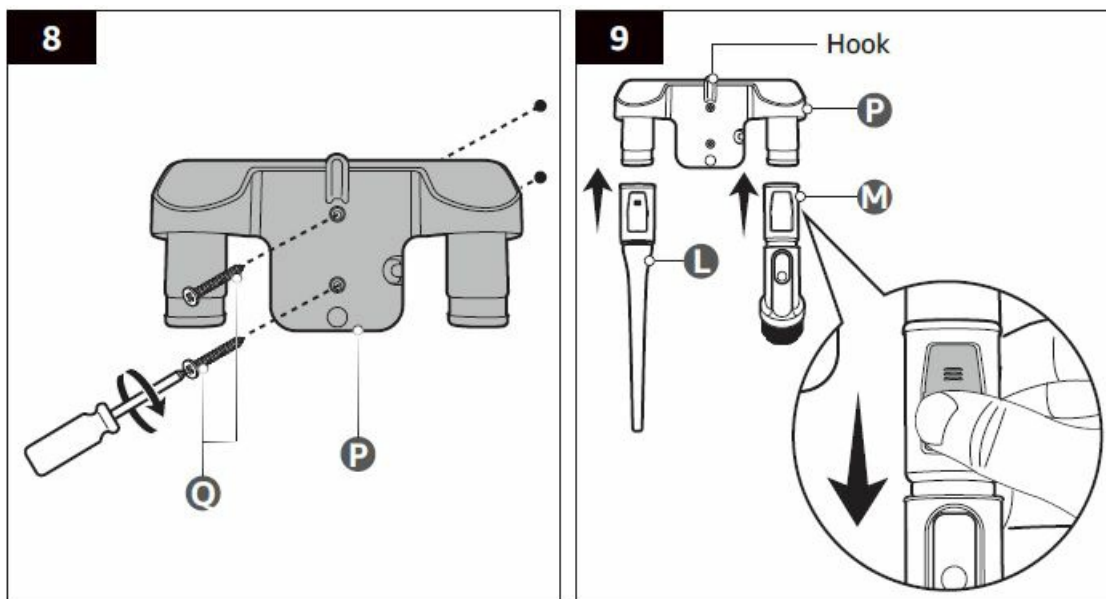

5. Hang the motor unit (G) with the suction tube (K) and motorised cleaning head (N) on the hook.

Cleaning and Maintenance

WARNING Risk of electric shock!

- To prevent electric shock, unplug the appliance before cleaning.
- During cleaning do not immerse the appliance in water or other liquids. Never hold the appliance under running water.

Cleaning

- To clean the appliance, wipe with a soft, slightly damp cloth.

- Wipe the appliance dry after cleaning.
- Never use corrosive detergents, wire brushes, abrasive scourers, metal or sharp utensils to clean the appliance.

Emptying the dust cup

NOTICE: Empty the dust cup (J) when the amount of dust has reached the MAX marking.

1. Press the dust cup release button (H) to detach the dust cup (J) from the motor unit (G) (Fig. 10).

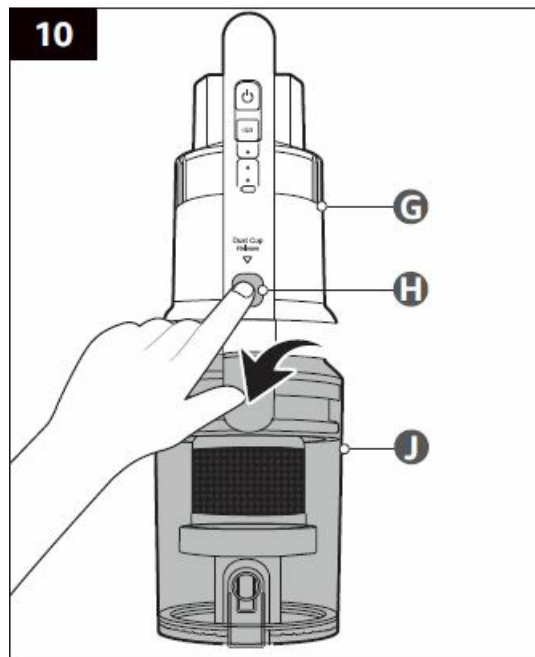

2. Hover the dust cup (J) on top of a trash bin. Press the unlock button to dispose of the contents in the dust cup (J) (Fig. 11).

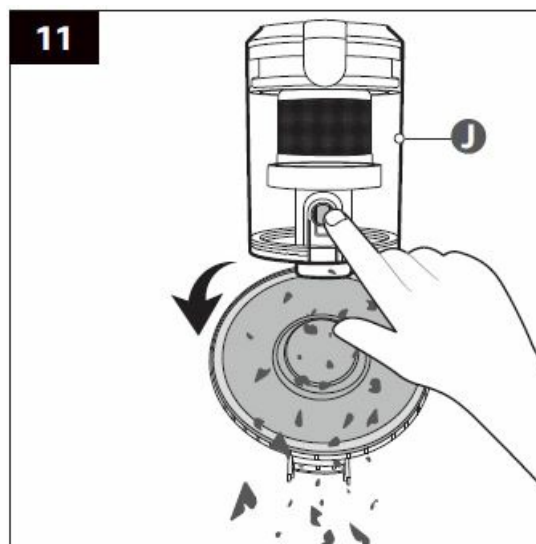

3. Close the cover of the dust cup (J). Refit the dust cup (J) to the motor unit (G).

Cleaning the dust cup

NOTICE: Empty the dust cup (J) before cleaning it.

1. Disassemble the filter parts from the dust cup (J) (Fig. 12).

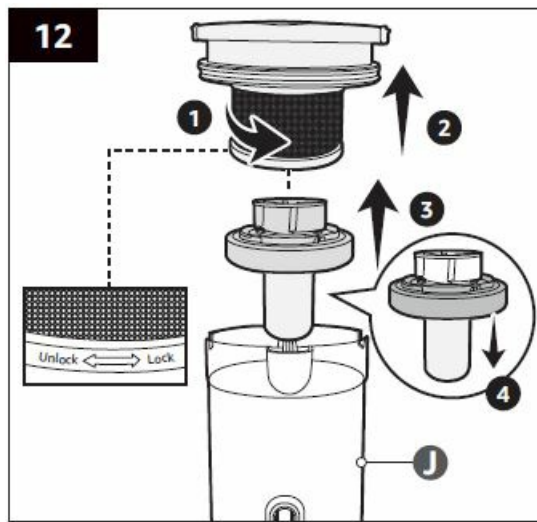

2. Clean the filter parts and the dust cup (J) using water and mild detergent.
3. Dry the parts thoroughly before reassembling and refitting to the motor unit (G).

Cleaning the HEPA filter

1. Press the dust cup release button (H) to detach the dust cup (J) from the motor unit (G) (Step 1, Fig. 13).
2. Remove the HEPA filter (I) on top of the dust cup (J) (Step 2, Fig. 13).

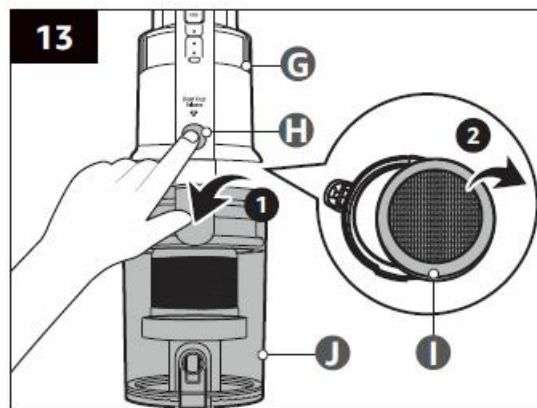

3. Tap the HEPA filter (I) gently to remove any excess dust and debris.
4. Rinse the HEPA filter (I) with cold water. 5. Leave the HEPA filter (I) to dry completely for a minimum of 24 hours. Refit the HEPA filter (I) afterwards.

NOTICE: Replace the HEPA filter (I) every 3 months or when it is heavily soiled. Replace only with the compatible filter model stated in the following table.

Cleaning the motorised cleaning head

NOTICE: Regularly check the brush roll of the motorised cleaning head (N) for stubborn soiling such as trapped hair and thread. Clean the inside of the motorised cleaning head (N) when needed.

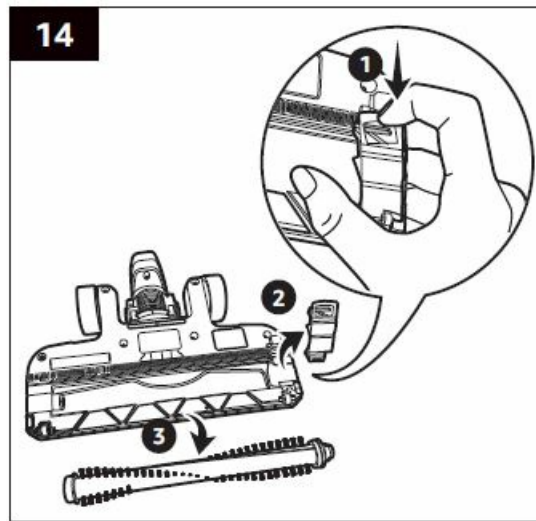

1. Remove the locking guard from the motorised cleaning head (N) by pressing the locking tab down (Step 1, Fig. 14).
2. Take the brush roll out (Step 2, Fig. 14) and remove any threads, hair or debris tangled around the bristles with a brush.
3. Refit the brush roll and the locking guard properly afterwards.

Storage

Store the appliance on the wall bracket (P) and charge when needed. Keep away from children and pets.

Maintenance

Any other servicing than mentioned in this manual should be performed by a professional repair centre.

Replacement parts

NOTICE

- Use only authorized accessories and replacement parts.
- Replacement parts can be requested from Amazon customer service. Go to “Orders” -> find the order with this product -> click “Get product support” -> click “Call me”. Then, follow the on-screen instructions.
- The terminology used on Amazon website may differ based on the languages used in the region.

Parts: Part code

- **Dust cup**
 - B09NS53XPN: 12175000A37286
 - B09NS4RVQ9: 12175000A37291
- **HEPA filter**
 - B09NS53XPN: 12475000006248
 - B09NS4RVQ9: 12475000A00541
- **Air outlet sponge** 12475000006328
- **Charging base assembly** 12175000082993
- **Battery charger** 17475000A07727, 17475000012230, 16075000A64974

- **Motorised cleaning head** 12175000A27386, 16075000A64976
- **Suction tube** 12975000011822
- **Crevice nozzle** 12175000077578
- **Extendable dusting brush** 12175000077577

Frequently Asked Questions

Problem: Solution

- **The appliance does not switch on.**
 - » Charge the appliance with the supplied battery charger (S).
 - » Disconnect the appliance from the battery charger (S).
- **The appliance switches off suddenly.**
 - The appliance overheats. Clear blockages from any of the accessories (K/ L/ M/ N) and clean dust cup (J) and filter (I). Allow the appliance to cool down for at least 30 minutes before switching it on.
- **Suction power becomes weak.**
 - Empty and clean the dust cup (J).
 - Clean the HEPA filter (I).
 - Clear blockages from any of the accessories (K/ L/ M/ N).
- **Motorised cleaning head (N) does not rotate.**
 - Check the motorised cleaning head (N) for debris and clean it properly.
- **Motor unit (G) is abnormally noisy.**
 - Switch the appliance off and check for blockages.
 - Empty and clean the dust cup (J).
 - Clean the HEPA filter (I).
- **Dust comes out from the motor unit (G).**
 - Clean the HEPA filter (I).
 - Fit the HEPA filter (I) properly on top of the dust cup (J).

Disposal (for Europe only)

- The Waste Electrical and Electronic Equipment (WEEE) laws aim to minimise the impact of electrical and electronic goods on the environment and human health, by increasing re-use and recycling and by reducing the amount of WEEE going to landfill.
- The symbol on this product or its packaging signifies that this product must be disposed separately from ordinary household wastes at its end of life.
- Be aware that this is your responsibility to dispose of electronic equipment at recycling centres in order to conserve natural resources.
- Each country should have its collection centres for electrical and electronic equipment recycling.
- For information about your recycling drop off area, please contact your related electrical and electronic equipment waste management authority, your local city office, or your household waste disposal service.

Battery Disposal

Contact an authorised service center to remove the battery before disposal of the appliance:

1. Remove the battery from the appliance
2. Insulate the metal contacts with adhesive tape to prevent short circuits.

Do not dispose of used batteries with your household waste. Take them to an appropriate disposal/collection site.

Feedback and Help

- We would love to hear your feedback. To ensure we are providing the best customer experience possible, please consider writing a customer review.
 - [amazon.co.uk/review/review-your-purchases#](https://www.amazon.co.uk/review/review-your-purchases#)
- If you need help with your Amazon Basics product, please use the website or number below.
 - [amazon.co.uk/gp/help/customer/contact-us](https://www.amazon.co.uk/gp/help/customer/contact-us)

Documents / Resources

	<p>amazon basics B09NS4RVQ9 Cordless 2 in 1 Vacuum Cleaner [pdf] Instruction Manual B09NS4RVQ9 Cordless 2 in 1 Vacuum Cleaner, B09NS4RVQ9, Cordless 2 in 1 Vacuum Cleaner, 2 in 1 Vacuum Cleaner, Vacuum Cleaner, Cleaner</p>
--	---

References

- [a Amazon Sign In](#)
- [a Amazon Sign In](#)
- [a Amazon.com: Amazon Basics](#)
- [a Amazon.de: Low Prices in Electronics, Books, Sports Equipment & more](#)
- [a Amazon Anmelden](#)
- [a Amazon Sign In](#)
- [a Connexion Amazon](#)
- [a Connexion Amazon](#)
- [a Inloggen bij Amazon](#)
- [a Inloggen bij Amazon](#)