



amazon basics B09JWTLJK4 Fixed Flat TV Wall Mount Instruction Manual

[Home](#) » [amazon basics](#) » amazon basics B09JWTLJK4 Fixed Flat TV Wall Mount Instruction Manual 

Contents

- [1 amazon basics B09JWTLJK4 Fixed Flat TV Wall Mount](#)
- [2 Tools Needed](#)
- [3 Delivery Content](#)
- [4 Important Safety Instructions](#)
- [5 Installation](#)
- [6 Before Assembly](#)
- [7 Specifications](#)
- [8 Fasteners guide](#)
- [9 Documents / Resources](#)
 - [9.1 References](#)
- [10 Related Posts](#)



amazon basics B09JWTLJK4 Fixed Flat TV Wall Mount



Scan the QR Code and scroll through the images to find an assembly or how-to video.



Tools Needed

Voltage detector



Stud finder

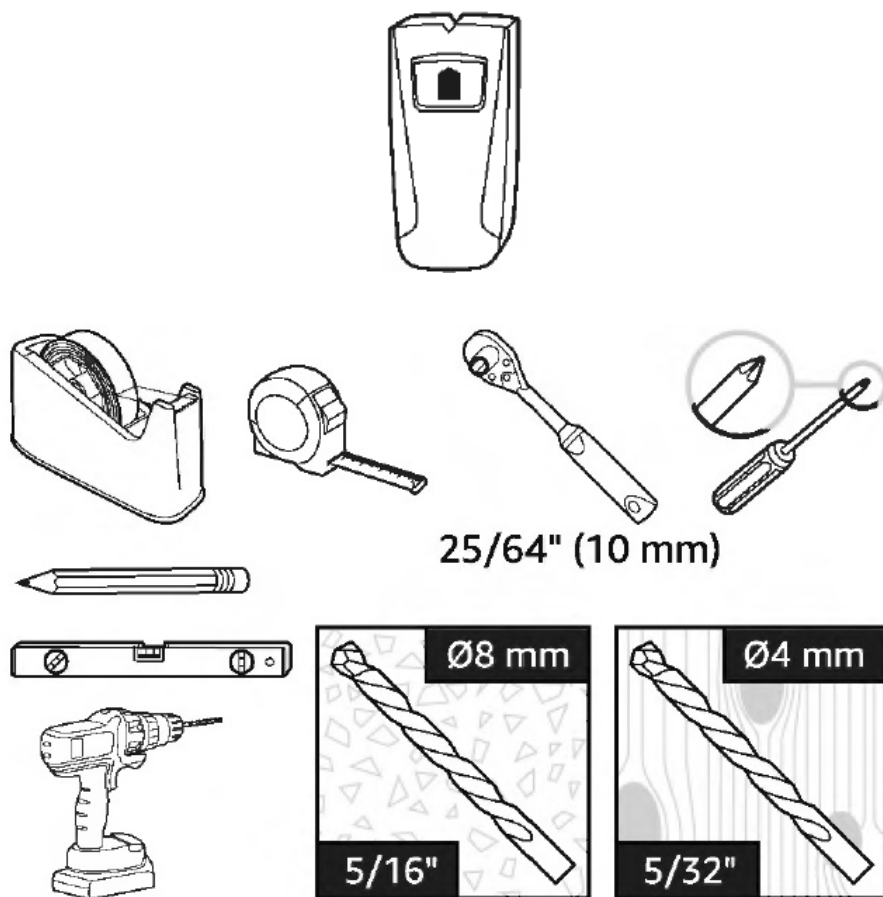

Delivery Content

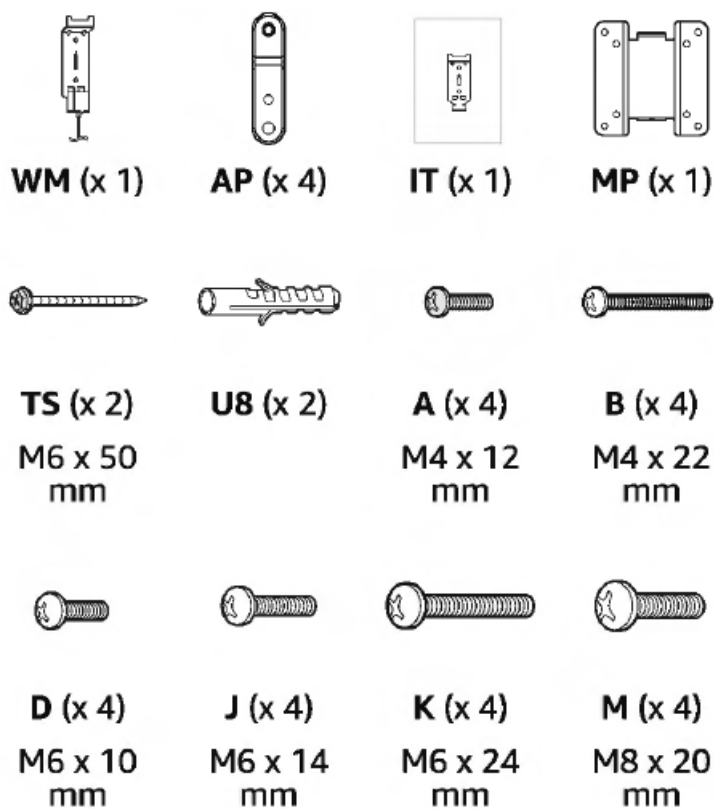



N (x 4)
M8 x 30
mm



Q (x 4)
M4/M6/M8



R (x 4)
M4



S (x 4)
M6/M8

Important Safety Instructions

Read these instructions carefully and retain them for future use. If this product is passed to a third party, then these instructions must be included.

When using the product, basic safety precautions should always be followed to reduce the risk of injury including the following: , l jffJlii [I] a Risk of injury and/or **CAUTION**

Risk of injury and/or property damage!

- Do not exceed the maximum weight indicated. This wall mount is intended for use only with the maximum weights indicated. Use with products heavier than the maximum weights indicated may result in collapse of the wall mount and the attached TV, causing possible injury and/or property damage.
- The product is suitable only for TVs with VESA hole patterns.
<40 lbs (18.2 kg)
- The product is intended for TVs up to 40 lbs (18.2 kg) of weight and display size of 12" – 40". If your TV weighs more, this wall mount is NOT compatible.
- This product is for indoor private household use only and therefore should not be used in public places like restaurants or hotels.
- Be cautious when opening/closing (folding/unfolding) the product. Keep hands away from the folding mechanisms to prevent fingers from being trapped and pinched.
- Keep children and pets away while installing the product. This product contains small parts that could be a choking hazard if swallowed.
- Do not use this product if any parts are missing, damaged, or worn.
- Do not over-tighten the fasteners.
- Regularly examine the product for wear and tear. Stop using the product at first sign of damage or if parts become detached.
- Always support the TV with your hands when making adjustments. Make sure to tighten fasteners and other connections well, but do not overtighten them.
- Never use an electric power tool to tighten fasteners .
- The string of the bracket must be out of reach of children and pets. Do not cut, but hide away after installation.

Installation

- For additional illustrated mounting /assembly/ installation steps, ? refer to the end of the written instructions.
- This product should be installed by 2 adults. If in doubt, consult a professional.
- Refer to the instruction manual provided with the TV you are going to install on this product. It includes additional information for mounting, ventilation and suitable mounting locations. Compare the technical data and requirements to make sure that this product is suitable for the TV.
- Before mounting, determine the suitable mounting location. The product must be fixed to a wooden or

masonry/concrete wall using fasteners that are appropriate for the mounting surface. Do not install on drywalls, wall boards or thin plywood. The mounting surface must be capable of supporting at least 4 times the weight of the product and the TV.

- The maximum wall covering thickness, such as gypsum drywall, lath, plastic, etc. should not be greater than 0.63" (16 mm) for wood stud walls or 0.4" (10 mm) for masonry walls.
- **For wood stud walls:**
 - This product is designed to be mounted to Grade No.2 wood stud 2" x 4" (51 mm x 102 mm), at minimum: 1.5" x 3.5" (38 mm x 89 mm).
- **For concrete walls:** The bracket must be installed into a solid concrete wall. Make sure the concrete wall is suited for Standard Test Method for Compression Strength of Cylindrical Concrete Specimens, ASTM C39, or equivalent.
- Do not drill into any pipes or power lines beneath the surface during mounting holes preparation. Use voltage/metal detector before drilling any holes to eliminate any such potential risks.
- Do not modify the structure of this product in any way.
- If the product is to be attached to any structure other than specified in this user manual, only a licensed professional contractor/installer should perform this installation. The mounting surface must support, at minimum, 4 times the combined weight of the mounting bracket and the TV. It is the responsibility and liability of the installer to ensure the suitability of the supporting structure.
- Never install onto furniture! This can lead to instability resulting in personal injuries and/or property damage.

NOTICE: The product is made to fit various TVs with different dimensions. Not all fasteners delivered are needed for installation of the product.

Before Assembly

DANGER

Risk of suffocation!

- Keep any packaging materials away from children and pets – these materials are a potential source of danger, e.g. suffocation. materials are a potential source of danger, e.g. suffocation.
- Remove all the packing materials.
- Remove and review all components before starting assembly.
- Check the product for transport damages.

Disposal

- Dispose of the product according to local regulations. If in doubt, consult your local authorities.

Specifications

- Display size 12" • 40" (30.5 • 101.6 cm)
- Max. load 40 lbs (18.2 kg)
- Mounting pattern 2.9" x 2.9" (75 x 75 mm) 3.9" x 3.9" (100 x 100 mm) 7.9" x 3.9" (200 x 100 mm) 7.9" x 7.9" (200 x 200 mm)
- Profile 0.7" (17.8 mm)

- Net weight 1.21 lbs (0.55 kg)
- Product dimensions (W x HxD) 8.8" X 8.8" X 0.7" (22.3 x 22.3 x 1.7 cm)

Wall Type

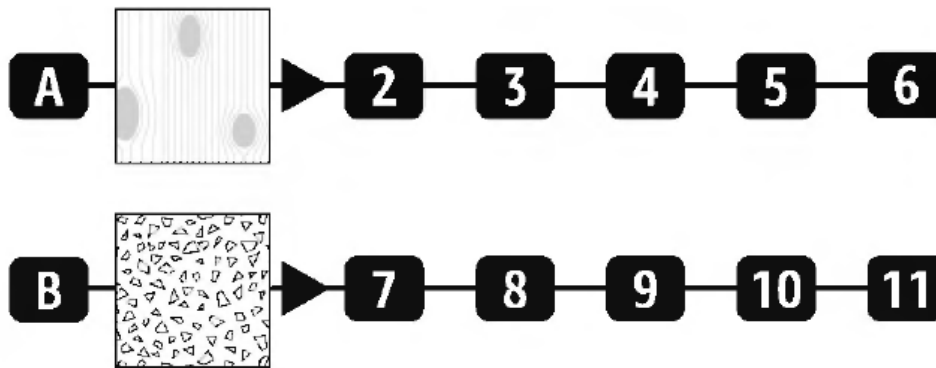

Drywall with wooden studs or wooden wall: Drywall should have maximum 0.63" (16 mm) thickness, wood stud size at least 1.5 x 3.50" (38 x 89 mm). Start drywall installation from 2.

Concrete/masonry wall: Concrete wall should have at least 8" (203 mm) thickness, size of each concrete block is at least 7.99 x 7.99 x 15.98" (203 x 203 x 406 mm). Start concrete installation from 7.

If the wall does not meet the above specifications, do not install the product, contact a professional for assistance.

Drywall Installation

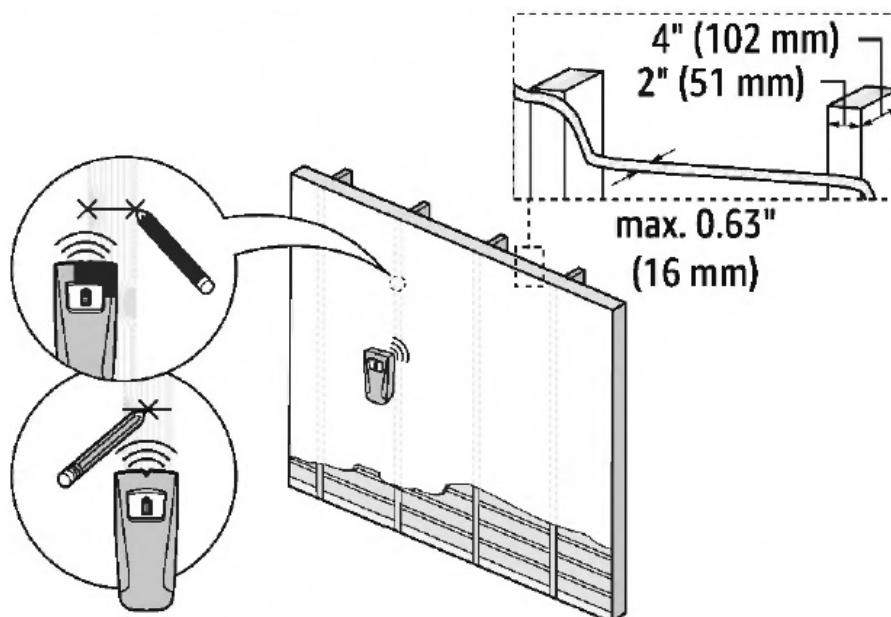

Locate the wood stud with stud finder: Use a stud finder to locate the stud. Mark the stud to find its middle point. The stud must be capable of supporting 4 times the combined weight of the product and the TV.

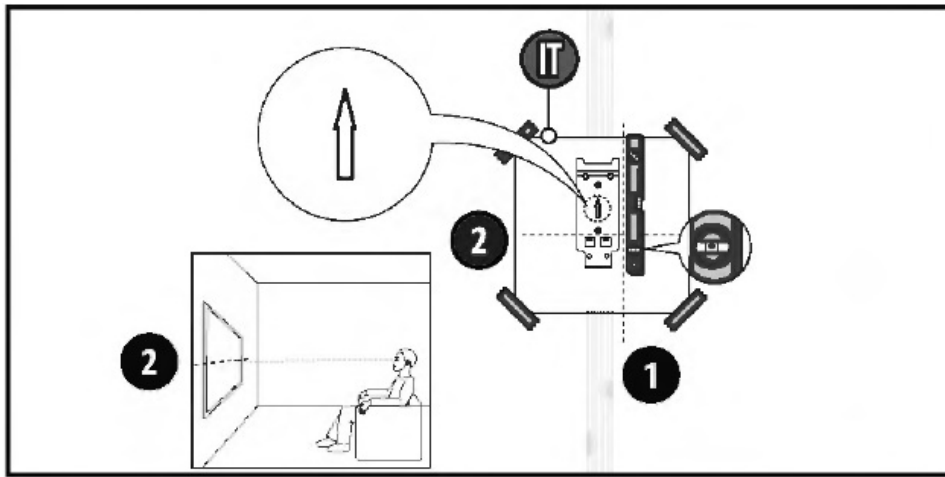

Place drilling template: Select the desired installation height and tape the drilling template (IT) on the wall aligning it with the markings of the studs. Check that the TV Center Line (2) on the template is at eye level to the location where you would be sitting. Place a spirit level on the Check Level line (1) of the drilling template (IT) to ensure that it is in a straight line.

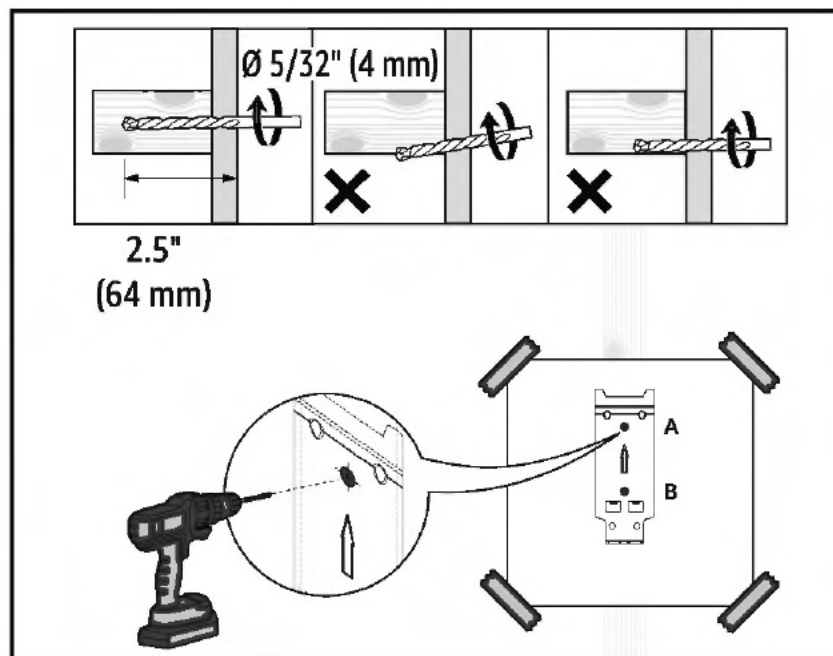

Drill holes: Drill 2.5" (64 mm) deep holes through the 2 locations (A and B) as marked on the template (IT) using a 5/32" (4 mm) drill bit. Remove the drilling template (IT) after drilling.

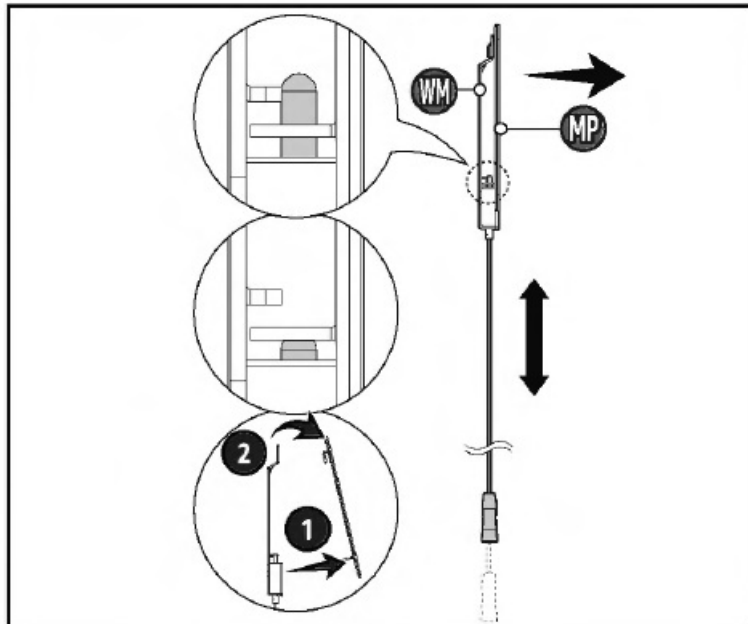

Remove mounting plate: Pull the string of the wall bracket (WM) downwards and remove the mounting plate (MP).

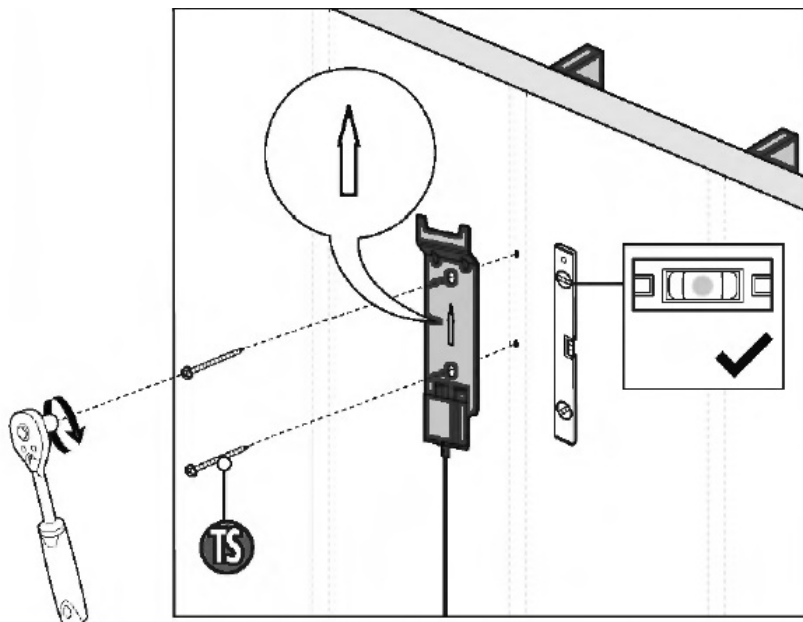

Attach wall bracket: Hold the wall bracket with the arrow pointing upwards. Half-way, tighten the wall bracket into each of the holes using the screws (TS). Using a spirit level, check that the wall bracket is aligned horizontally then fully tighten the screws. After this step, proceed to 11

Concrete Installation.

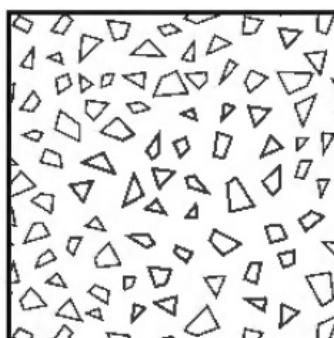

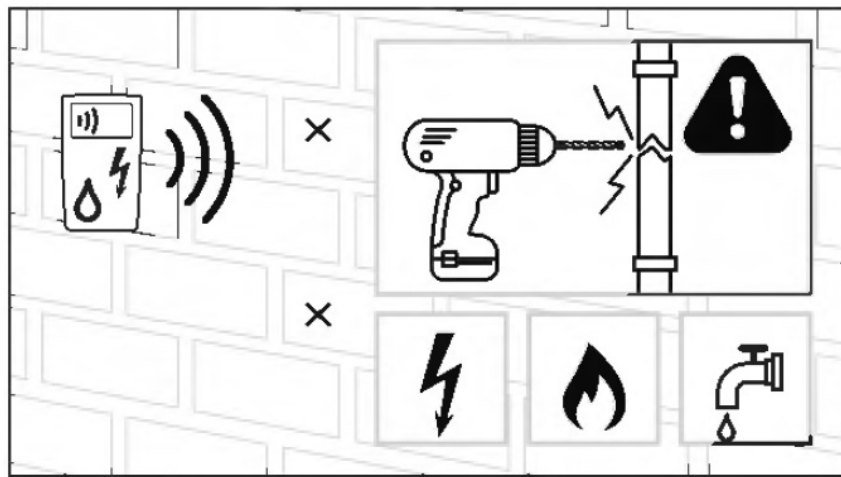

Select installation position: Select suitable mounting position. Do not drill into any pipes or power lines beneath the surface during mounting holes preparation. Use voltage/metal detector before drilling any holes to eliminate any such potential risks. The concrete wall must be capable of supporting 4 times the combined weight of the product and the TV.

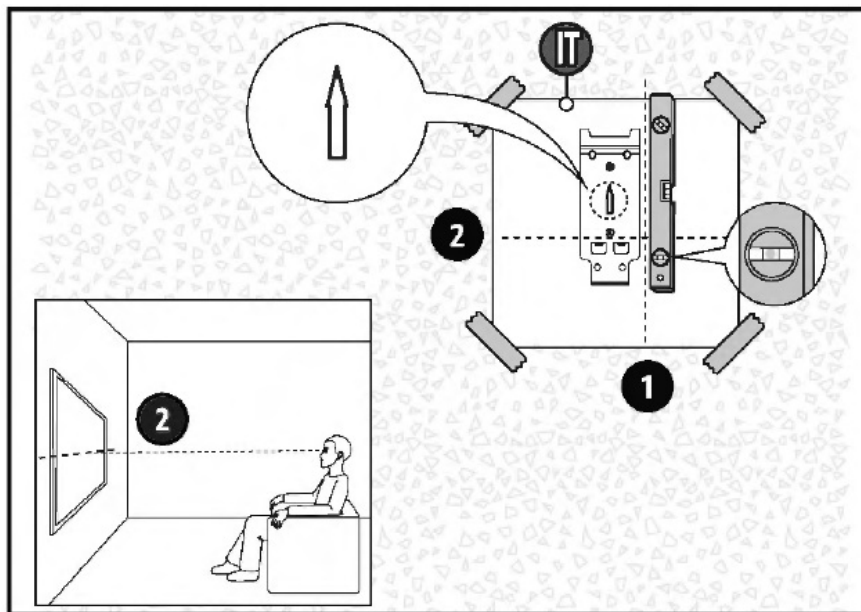

Place drilling template: Select the desired installation height and tape the drilling template (IT) on the wall. Check that the TV Center Line (2) on the template is at eye level to the location where you would be sitting. Place a spirit level on the Check Level line (1) of the drilling template (IT) to ensure that it is in a straight line.

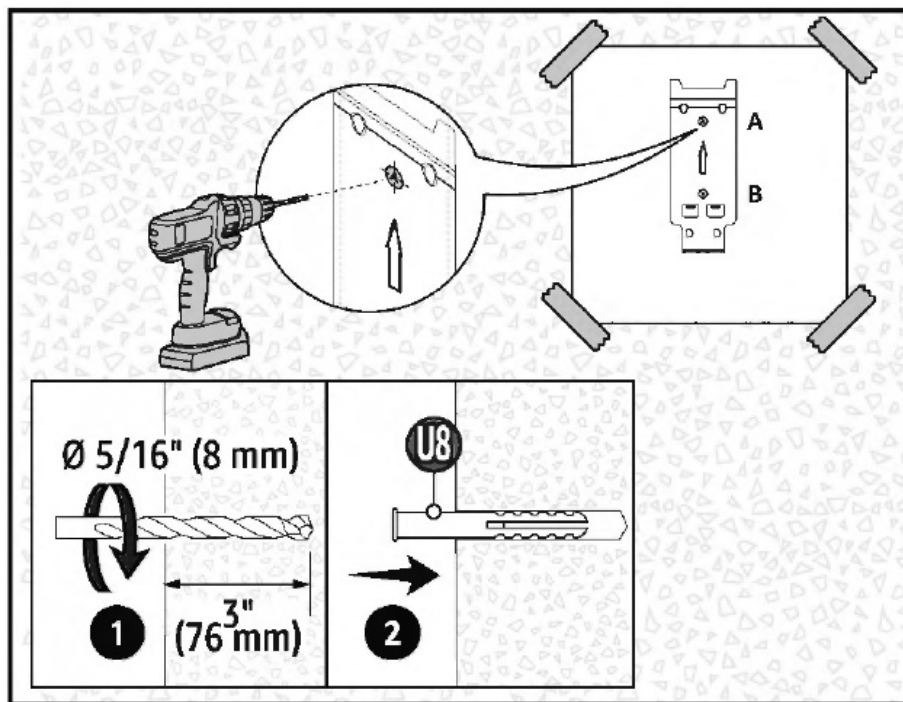

Drill holes: Drill 3" (76 mm) deep holes through the 2 locations (A and B) as marked on the template (IT) using a 5/16" (8 mm) drill bit. Remove the drilling template (IT) after drilling. Then insert the wall plugs (US) into the drilled holes

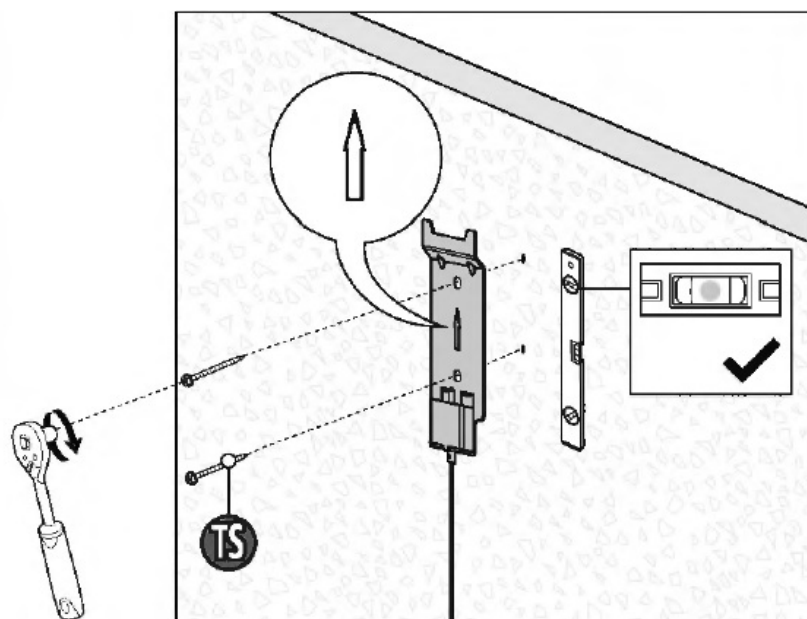

Repeat 5

Attach wall bracket: Hold the wall bracket with the arrow pointing upwards. Half-way, tighten the wall bracket into each of the holes using the screws (TS). Using a spirit level, check that the wall bracket is aligned horizontally then fully tighten the screws

Identify mounting pattern

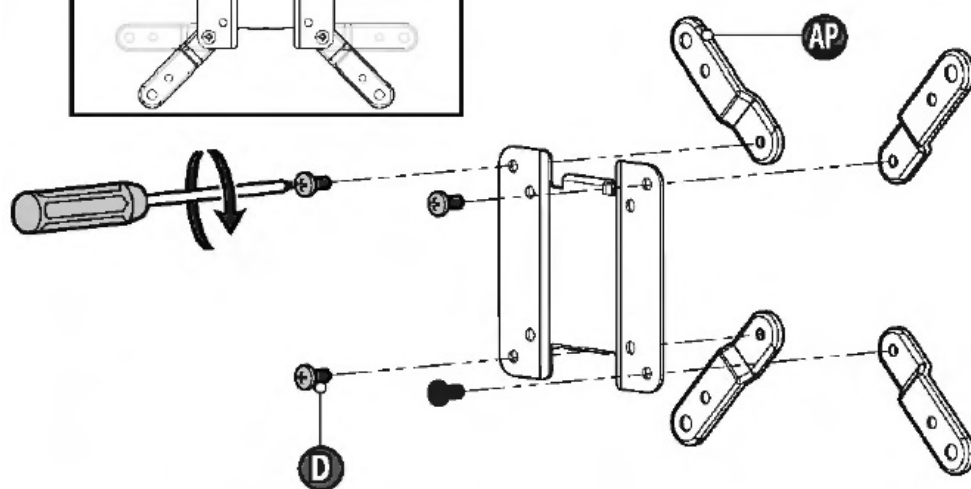
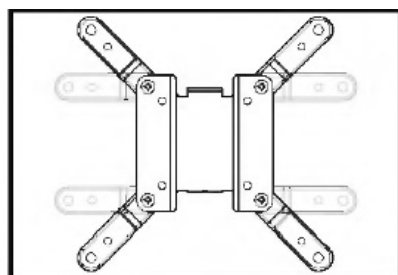
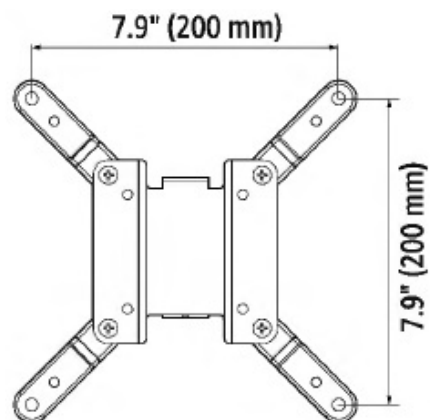
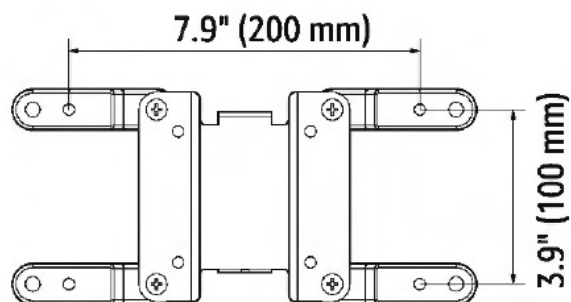
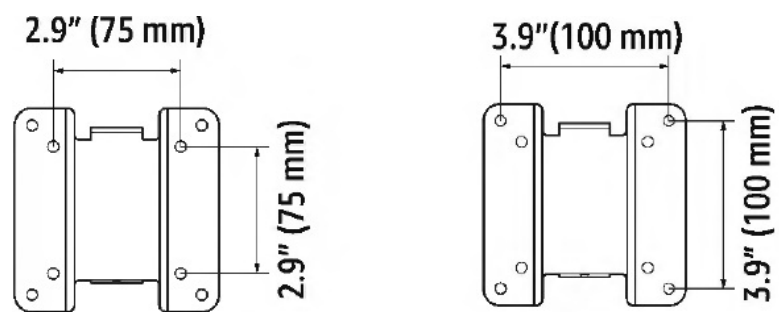

Attach the mount arms (AP) to the mounting plate as required using the screws (D).

Fasteners guide

Screw diameter



Screw length

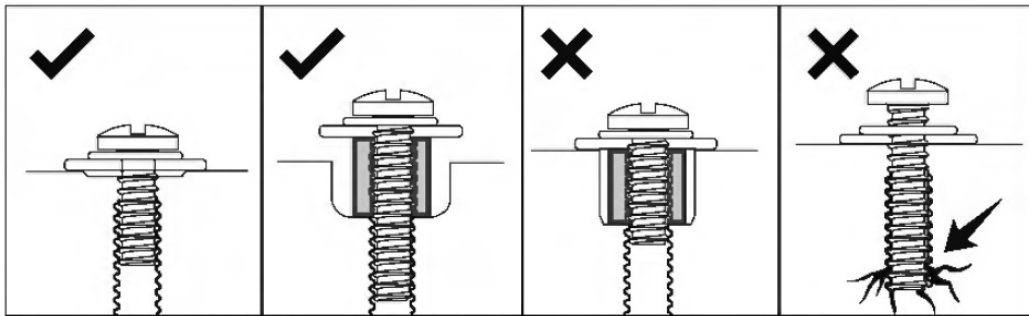

Spacers guide

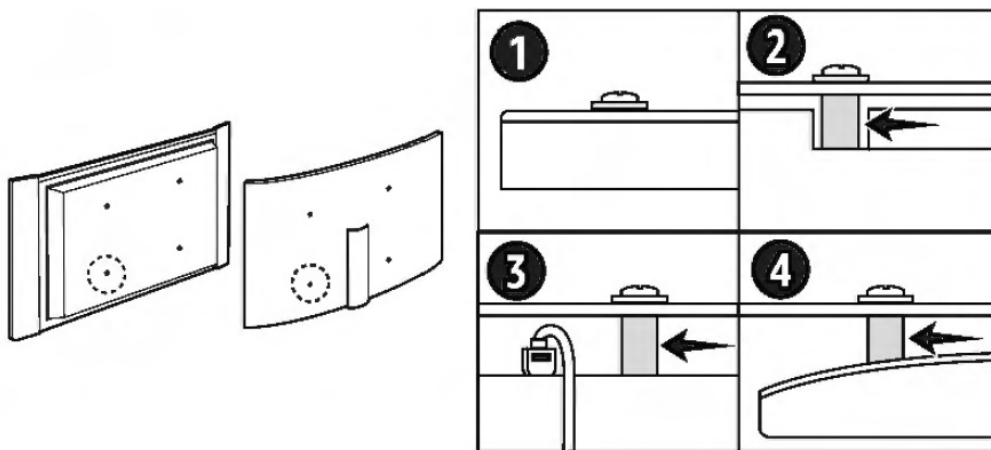

To accommodate various TV models, the product comes with spacers with different diameters and thicknesses. Take into account that the inner diameter of the spacer should match the fastener used. The spacer type is determined by TV's enclosure type and its mounting holes.

1. Flat TVs with no obstructions: do not need spacers
2. TVs with inset mounting holes, (3) TVs with cables sockets protruding outwards, (4) TVs with curved backs: need spacers to provide enough clearing for the mounting plate

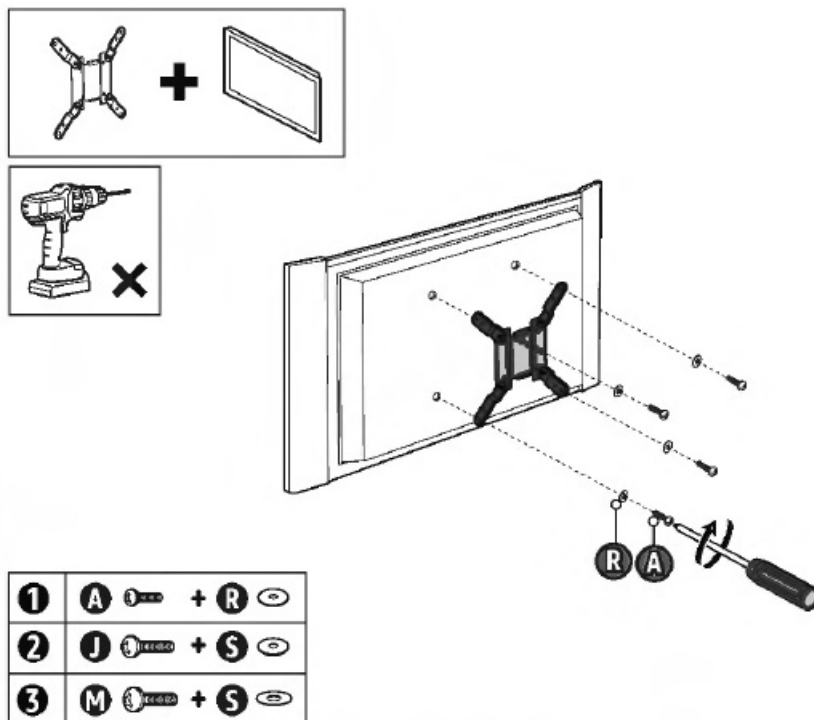

Choose the screws (mount arms with flat TV): Test the depth and diameter of TV's mounting holes using screws A, J and M (sizes M4, MG and MB). Do not force any of the screws in. If there is resistance, stop immediately and try a screw with a smaller diameter. Find the suitable screws (A/J/M) and pair it with the corresponding washers (R/S). Do a test fit of all 4 holes before fully fastening the mounting plate to the TV. Proceed to 19.

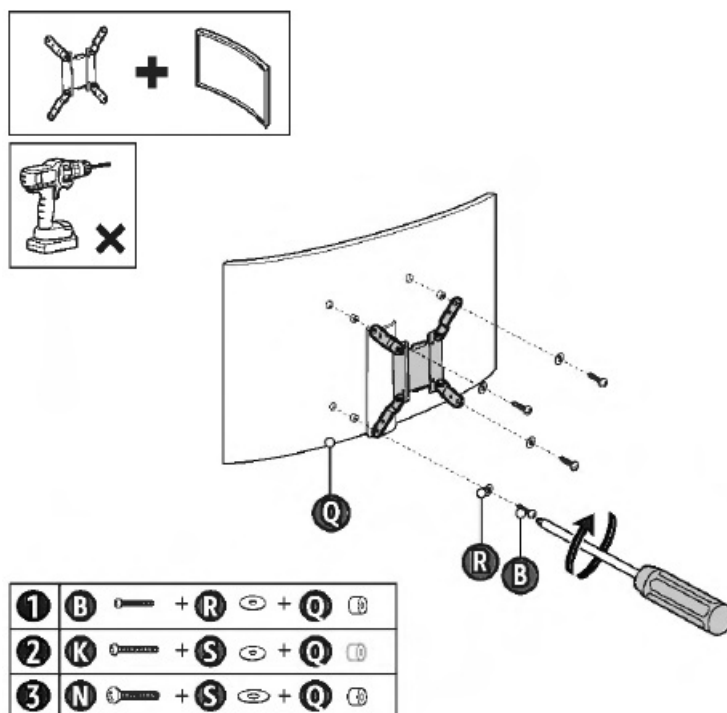

Install spacers (curved TV): The goal of this step is to level the back of the curved TV into a flat surface. Test the depth and diameter of TV's mounting holes using screws B, K and N (sizes M4, MG and MS). Do not force any of the screws in. If there is resistance, stop immediately and try a screw with a smaller diameter. Then test the suitable screws with the corresponding washers (R/S) and spacers (Q) to find the suitable combination. Do a test fit of all 4 holes before fully fastening the mounting plate to the TV. Proceed to 19.

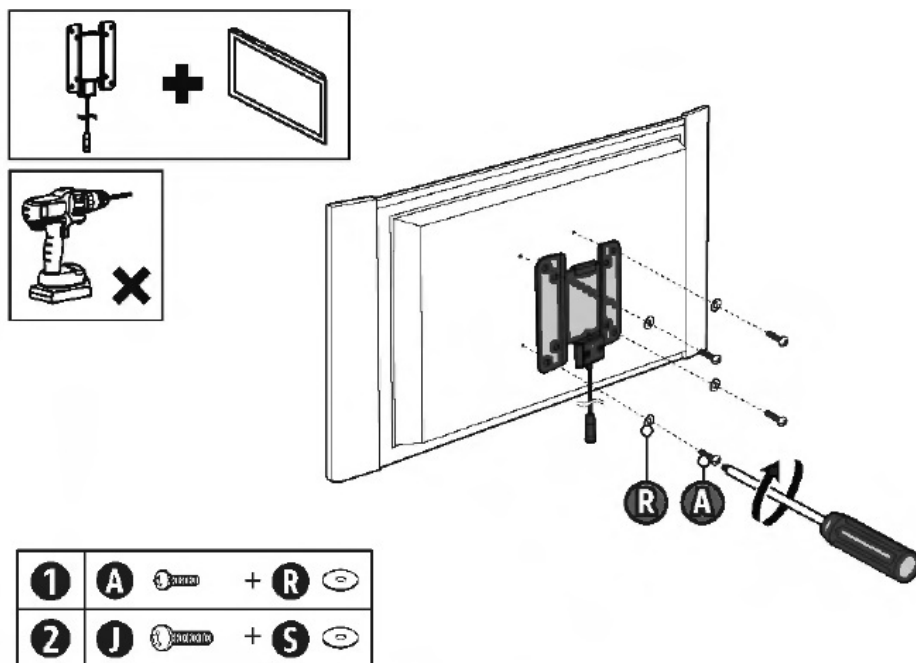

Install spacers (flat TV): Test the depth and diameter of TV's mounting holes using screws A and J (sizes M4 and MG). Do not force any of the screws in. If there is resistance, stop immediately and try a screw with a smaller diameter. Find the suitable screws (A/J) and pair it with the corresponding washers (R/S). Do a test fit of all 4 holes before fully fastening the mounting plate to the TV. Proceed to 19.

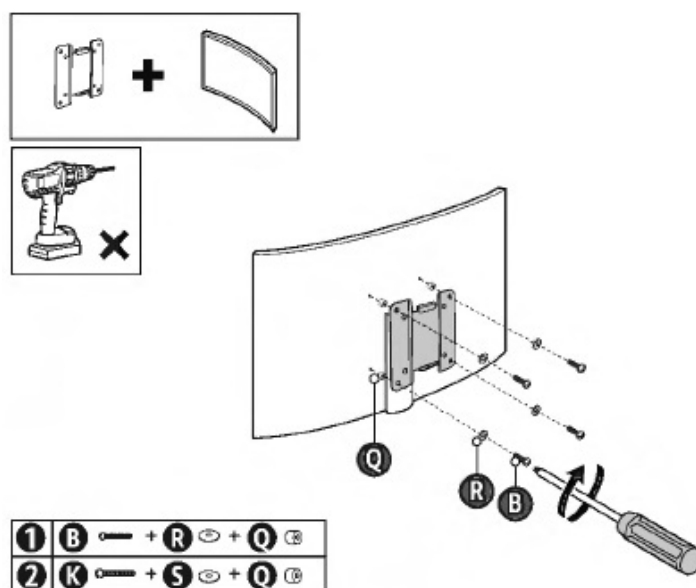

Install spacers (curved TV): The goal of this step is to level the back of the curved TV into a flat surface. Test the depth and diameter of TV's mounting holes using screws B and K (sizes M4 and MG). Do not force any of the screws in. If there is resistance, stop immediately and try a screw with a smaller diameter. Then test the suitable screws with the corresponding washers (R/S) and spacers (Q) to find the suitable combination. Do a test fit of all 4 holes before fully fastening the mounting plate to the TV.

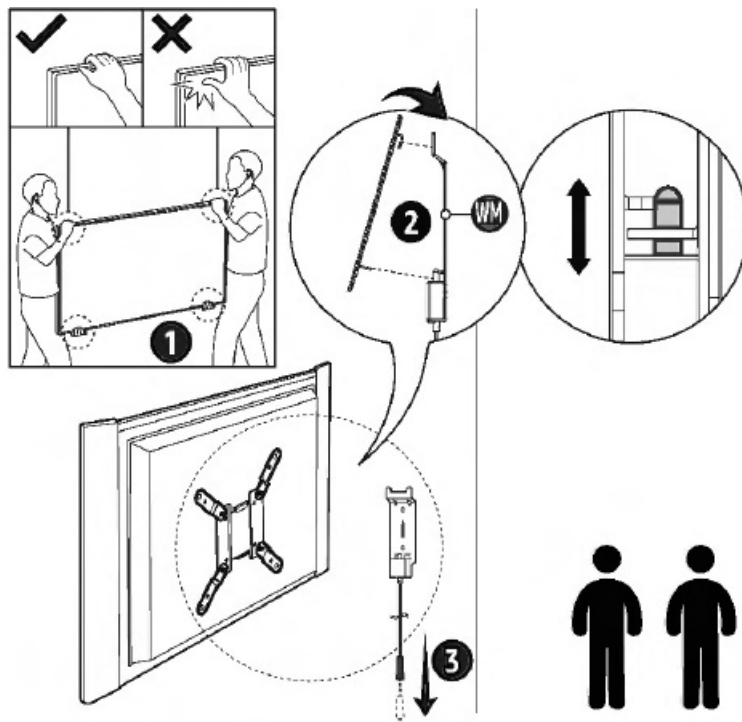

Mount the TV to the mounting bracket: With 1 adult on either side of the TV, lift the TV to hook the mounting plate onto the wall bracket (WM). Pull the string downwards to lock the mounting plate then release the string. The string of the bracket must be out of reach of children and pets. Do not cut, but hide away after installation

[amazon.com/AmazonBasics](https://www.amazon.com/AmazonBasics)

MADE IN CHINA

Documents / Resources

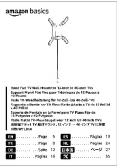
	<p>amazon basics B09JWTLJK4 Fixed Flat TV Wall Mount [pdf] Instruction Manual B09JWTLJK4, B09JWTLJK4 Fixed Flat TV Wall Mount, Fixed Flat TV Wall Mount, Flat TV Wall Mount, TV Wall Mount, Wall Mount, Mount</p>
---	---

References

- [User Manual](#)