



amazon basics B08SJNHWV6 Rotary Pencil Sharpener Instruction Manual

[Home](#) » [amazon basics](#) » amazon basics B08SJNHWV6 Rotary Pencil Sharpener Instruction Manual 

Contents

- [1 amazon basics B08SJNHWV6 Rotary Pencil Sharpener](#)
- [2 Important Safeguards](#)
- [3 Mounting the product](#)
- [4 Usage](#)
- [5 Sharpening a pencil](#)
- [6 Documents / Resources](#)
 - [6.1 References](#)
- [7 Related Posts](#)



amazon basics B08SJNHWV6 Rotary Pencil Sharpener



Important Safeguards

Risk of suffocation!

- Keep any packaging materials away from children and pets – these materials are a potential source of danger, e.g. suffocation.

Risk of injury

- Do not put fingers into the holes of the product.

Risk of cuts

- Do not allow children to disassemble the blade unit.
- Read these instructions carefully and retain them for future use. If this product is passed to a third party, then these instructions must be included.
- Always use the product on a flat, level surface. Use the desk clamp to mount the product on a desk if needed.
- This product is intended for sharpening standard wooden pencils of 0.27 – 0.31" (6.9 – 8 mm) in diameter. Other writing utensils, such as chalk, crayons or oil pastels may damage the product.
- This product is intended for use in households, schools, offices and similar environments.

Mounting the product

1. Place the product near the edge of a desk of 0.2 – 1.2" (5 – 30 mm) in thickness.
2. Insert the desk clamp (J) into the clamp hole (D). Turn the nut counter-clockwise to secure the product in place (Fig. 1).

Usage

- **NOTICE** | When the desk clamp (J) is not used, always keep one hand pressing on the product.

Sharpening a pencil

1. Push the hole cover (F) down. Insert a pencil into the lower hole (G) (Fig. 3).
2. Rotate the pencil clockwise to start sharpening.
3. Take the pencil out and refit the hole cover (F).

Cleaning

- To clean the product, wipe with a soft, slightly damp cloth.
- Empty the shaving bin (E) regularly, and rinse it under clear water when needed. Wipe dry before refitting it to the product.
- Disassemble the blade unit (B) by turning the nut clockwise (Fig. 4). Clean the blade unit (B) regularly using a small brush. To remove broken pencil tip stuck inside, use a toothpick (Fig. 5).

Disposal

.Dispose of the product according to local regulations. If in doubt, consult your local authorities

- Clutch button
- Blade unit
- Crank handle,
- Clamp hole
- Shaving bin
- Shaving bin
- Lower hole
- Upper hole
- Front plate
- Desk clamp

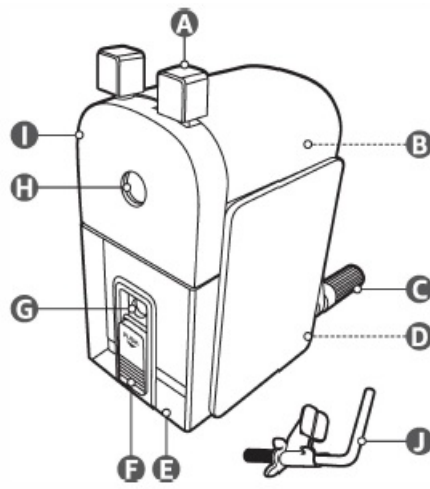

Mount the product to a desk

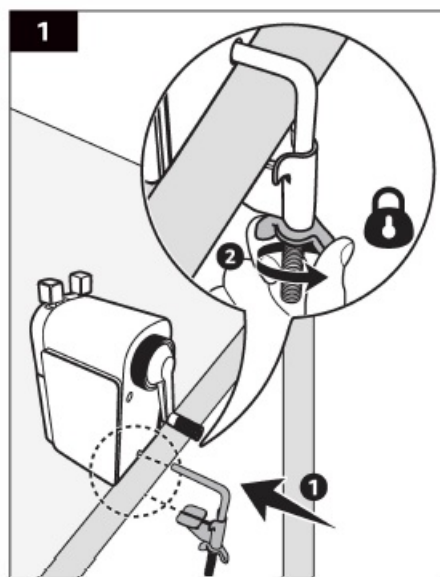

Sharpening a pencil using the upper hole

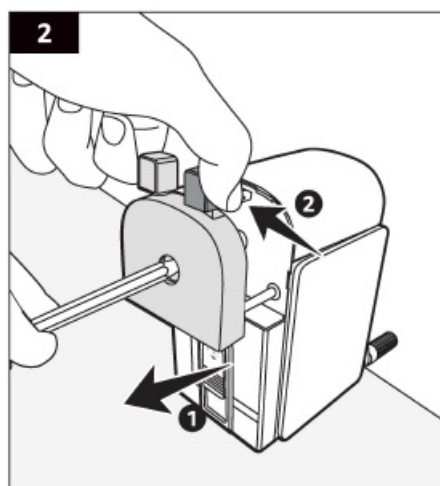

Sharpening a colored pencil using the lower hole

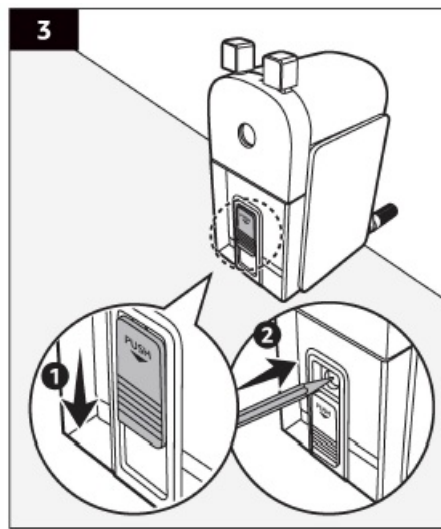

Disassembling the blade unit

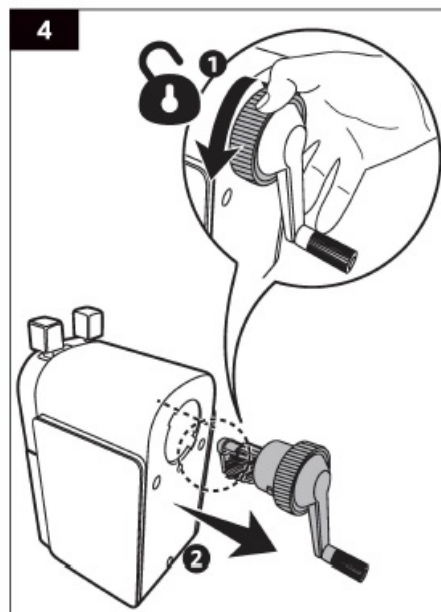

Remove broken pencil tip

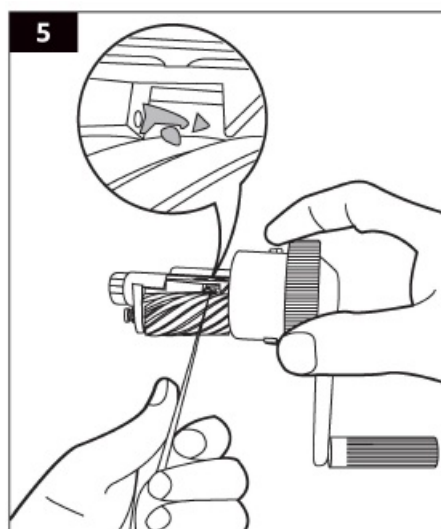

Documents / Resources

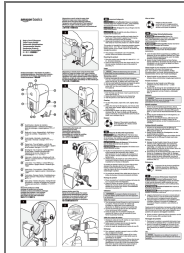

[amazon basics B08SJNHWV6 Rotary Pencil Sharpener](#) [pdf] Instruction Manual
B08SJNHWV6, B08SJNHWV6 Rotary Pencil Sharpener, Rotary Pencil Sharpener, Pencil Shar
pener, Sharpener

References

- [User Manual](#)