



## amazon basics B08PG4SKQ Window Vacuum Cleaner Set User Manual

[Home](#) » [amazon basics](#) » amazon basics B08PG4SKQ Window Vacuum Cleaner Set User Manual 

amazon basics B08PG4SKQ Window Vacuum Cleaner Set User Manual



## Contents

### 1 IMPORTANT SAFETY INSTRUCTIONS

#### 2 Battery Warning

#### 3 Intended Use

#### 4 Appliance Description

#### 5 Before First Use

#### 6 Assembly

#### 7 Operation

#### 8 Troubleshooting

#### 9 Disposal

#### 10 Battery Disposal

#### 11 Specifications

#### 12 Feedback and Help

#### 13 FCC-Supplier's Declaration of Conformity

#### 14 Canada IC Notice

#### 15 Documents / Resources

##### 15.1 References

## IMPORTANT SAFETY INSTRUCTIONS

When using an electrical appliance, basic precautions should always be followed, including the following:

### READ ALL INSTRUCTIONS BEFORE USING THIS APPLIANCE



#### WARNING

- Read all safety warning and instructions.  
Failure to follow the warnings and instructions may result in electric shock; fire and/or serious injury.
- Household use only.
- To reduce the risk of electric shock – Use indoors only.
- The appliance is only to be used with the AC adapter (PS1006-05GHIB100) provided with the appliance.
- This appliance can be used by children aged from 8 years and above and persons with reduced physical, sensory or mental capabilities or lack of experience and knowledge if they have been given supervision or instruction concerning use of the appliance in a safe way and understand the hazards involved. Children shall not play with the appliance. Cleaning and user maintenance shall not be made by children without supervision.
- The appliance must only be supplied at safety extra low voltage corresponding to the marking on the appliance.
- Do not immerse in water for cleaning.
- The plug must be removed from the outlet, before cleaning or maintaining the appliance.



#### WARNING

### To reduce the risk of fire, electric shock, or injury:

- Do not leave the appliance/AC adapter when plugged in. Unplug from outlet when not in use and before

servicing.

- Do not allow to be used as a toy. Close attention is necessary when used by or near children.
- Use only as described in this manual. Use only manufacturer's recommended attachments.
- Do not use with damaged AC adapter, cord or plug. If appliance is not working as it should, has been dropped, damaged, left outdoors, or dropped into water, return it to a service center.
- Do not pull or carry by the cord, use the cord as a handle, close the door on the cord, or pull the cord around sharp edges or corners. Do not run appliance over the cord. Keep the cord away from heated surfaces.
- Do not unplug by pulling on the cord. To unplug, pull the plug, not the cord.



## **WARNING**

### **To reduce the risk of fire, electric shock, or injury:**

- Do not handle the AC adapter, the plug or the appliance with wet hands.
- Do not put any object into the openings. Do not use with any opening blocked; keep free of dust, lint, hair, and anything that may reduce air flow.
- Keep hair, loose clothing, fingers, and all parts of the body away from openings and moving parts.
- Take extra care when cleaning on stairs.
- Do not use to vacuum up flammable or combustible liquids, such as gasoline, or use in areas where they may be present.
- Do not vacuum up anything that is burning or smoking, such as cigarettes, matches or hot ashes.
- Do not use without water tank in place.

## **Battery Warning**

### **CAYTION** Risk of explosion!

- Do not leave the appliance and therefore the built-in battery in an extremely high temperature surrounding environment that can result in an explosion of the battery.
- Disposal of the appliance into fire or a hot oven, or mechanically crushing or cutting can result in an explosion of the battery.
- Do not subject the appliance and therefore the built-in battery to extremely low air pressure that may result in an explosion of the battery.
- Before disposal, the battery must be removed from the appliance. Contact qualified professional.
- The appliance must be disconnected from the AC adapter before removing the battery.
- **WARNING:** For the purposes of recharging the battery, only use the detachable AC adapter provided with this appliance.
- This appliance contains batteries which are non-replaceable.
- Do not leave the battery charging for a prolonged period of time when the appliance is not in use.
- Do not charge the battery overnight.
- If the appliance appears to be bulging or shows other deformations or problems (e.g. excess noise), stop using the appliance immediately.
- Do not cover the appliance while charging the battery.

Charge the appliance in a well-ventilated environment.

- When in long term storage, charge the battery to its 70 % capacity once every 3 months to avoid shortening its life.
- Batteries produce heat when charging and discharging. If the appliance becomes too hot to touch, switch the appliance off and unplug immediately.
- If the battery leaks, avoid contact with skin and eyes. Rinse affected areas immediately with plenty of clean water, then consult a doctor.
- Batteries produce heat when charging and discharging:
  - If the appliance becomes too hot to touch during use, switch off the appliance stop using it immediately.
  - If the appliance becomes hot during charging, unplug it immediately.
- Recharge only with the AC adapter specified by the ' manufacturer. An adapter the s suitable for one type of appliance may create a risk of fire when used with another type of appliance.
- Do not use an appliance that 's damaged or modified.  
Damaged or modified appliances (batteries) may exhibit ' unpredictable behavior resulting in fire, explosion or risk of injury.
- Do not expose the appliance (battery) to fire or excessive ' temperature. Exposure to fire or temperature above 265°F ' (130°C) may cause explosion.
- Servicing to be performed by a qualified repair person using ' only identical replacement parts. This will ensure that the safety of the appliance is maintained.
- Do not attempt to modify or repair the appliance or battery.

## **Intended Use**

- This appliance is intended for simultaneously squeegeeing and vacuuming water from smooth surfaces such as windows, tiles, mirrors and shower screens
- This appliance is not intended for vacuuming larger quantities of water from horizontal surfaces.
- This appliance is not intended for vacuuming flammable or combustible liquids, such as gasoline, or to be used in areas where they may be present.
- This appliance is intended for household use only.
- This appliance is intended to be used in dry indoor areas only.
- No liability will be accepted for damages resulting from improper use or non-compliance with these instructions.

## **Appliance Description**

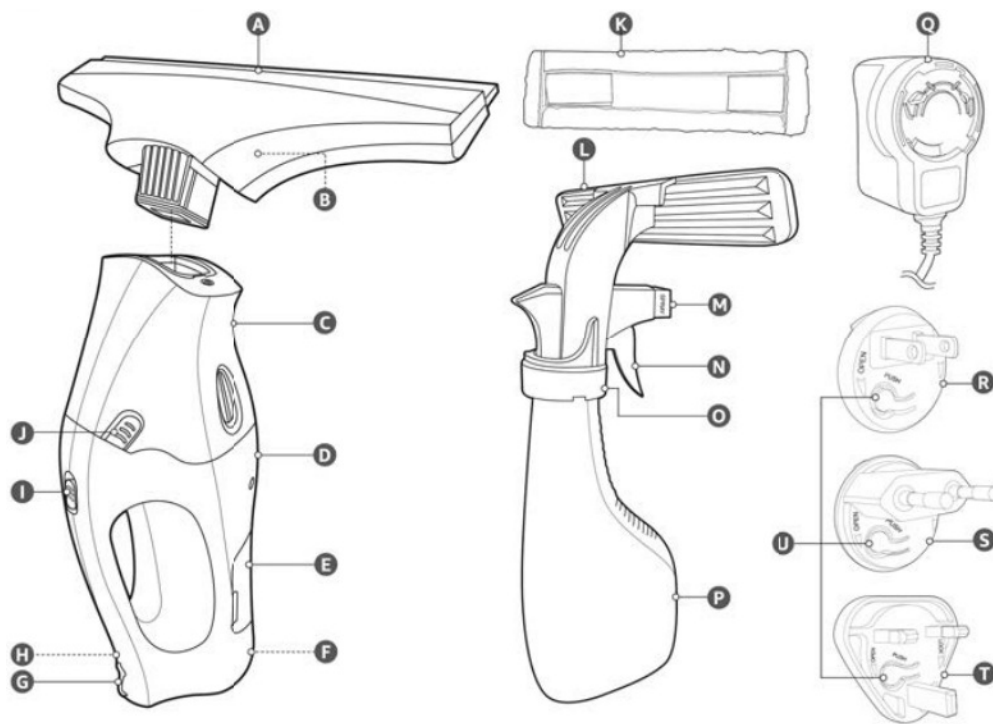

- A Suction nozzle
- B Suction nozzle release button
- C Suction head
- D Motor unit
- E Water tank
- F Water tank release button
- G Charging port (with stopper)
- H Indicator light
- I On/off switch
- J Suction head release button
- K Cleaning pad
- L Wiper
- M Spray nozzle
- N Trigger
- O Spray bottle cap?
- P Spray bottle
- Q AC adapter
- R US/JP plug
- S EU plug
- T UK plug
- T Plug release button

## Before First Use



**DANGER** Risk of suffocation!

Keep any packaging materials away from children and pets – these materials are a potential source of danger,

e.g. suffocation.

- Remove all the packing materials.
- Remove and review all components before use.
- Check the appliance for transport damages.

## Assembly

1. Push the suction nozzle (A) onto the suction head (C) (**Fig. 1**).



2. Open the hook and loop closure on the cleaning pad (K).

Slide one side of the wiper (L) into the closed loop on the cleaning pad (K).

Then slide the other side of the wiper (L) into the open hook and loop closure of the cleaning pad(K) (**Fig. 2**).

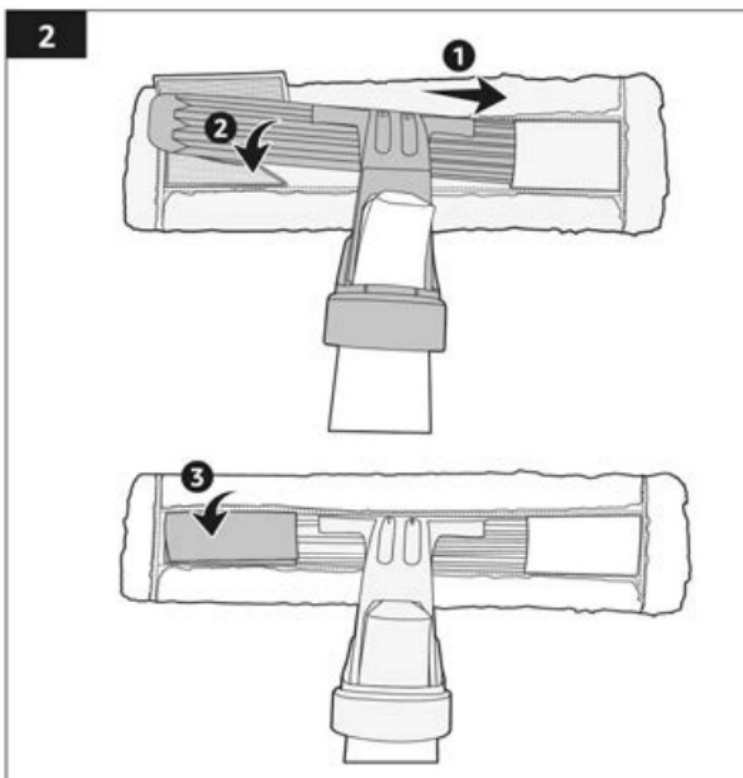

Close the hook and loop closure on the cleaning pad (K).

## Operation

### Charging the appliance

#### NOTICE

- Fully charge the appliance before using it for the first time, which take about 3.5 hours.
- Charge the appliance when the suction power is noticeably weaker and the indicator light (H) flashes red.
- The appliance has a built-in thermal protection. If the appliance halts its charging, this may be due to the battery temperature reaching approximately 158°F (70°C). Wait for the appliance's battery temperature to become normal to continue charging.

1. Attach the plug (R/S/T) to the AC adapter (Q). Rotate the plug (R/S/T) clockwise to lock it in place **(Fig. 3)**.

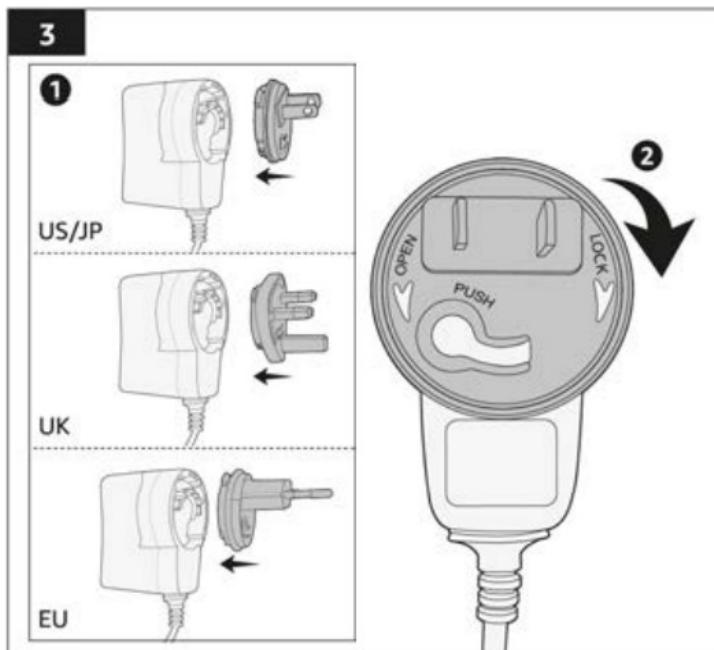

**NOTICE** To detach the plug (R/S/T) from the AC adapter (Q), press the plug release button (U) and rotate the plug (R/S/T) counterclockwise.

2. Connect the AC adapter (Q) to the charging port (G) on the motor unit (D) and then to the outlet **(Fig. 4)**.

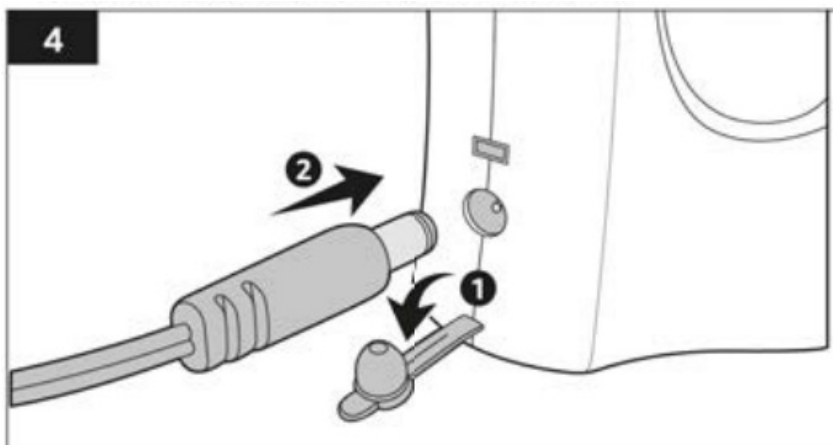

3. The indicator light (H) keeps flashing until charging has finished. Once the appliance is fully charged, the indicator light (H) remains solid until unplugged. The charging cycle takes around 2.5-3.5 hours.

### witching on/off

1. To switch the appliance on, set the on/off switch (1) to ON position. The indicator light (H) lights up.
2. To switch the appliance off, set the on/off switch (1) to OFF position. The indicator light (H) goes off.

### Using the appliance

1. Unscrew the spray bottle cap (O) from the spray bottle (P).
2. Fill the spray bottle (P) with fresh, clean water.

**NOTICE** | For window cleaning, add window cleaning detergents to remove tough dirt and grime accumulated on the surfaces.

3. Refit the spray bottle cap (O). Set the spray nozzle (M) to SPRAY for fine water mist or to STREAM for water jet (**Fig. 5**).

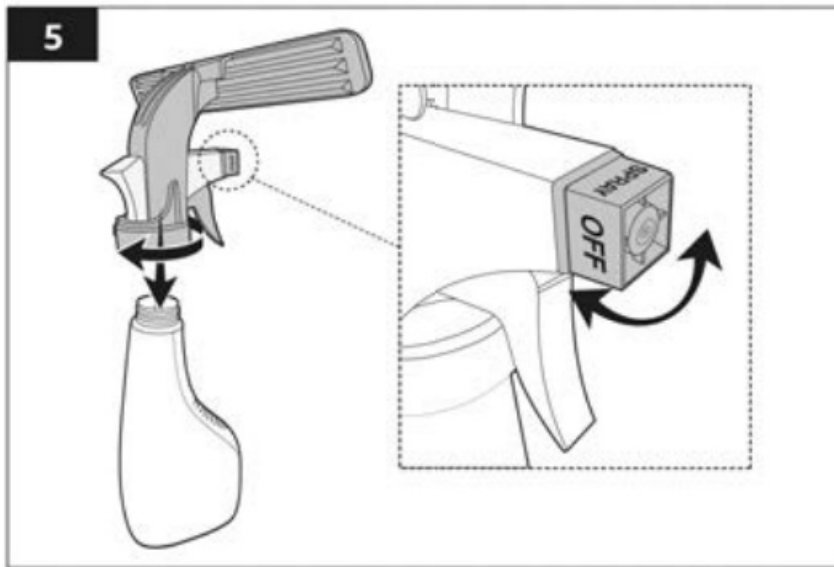

4. Spray the solution onto the surface to be cleaned by squeezing the trigger (N). Wipe over the sprayed area with the cleaning pad (K) (**Fig. 6**).

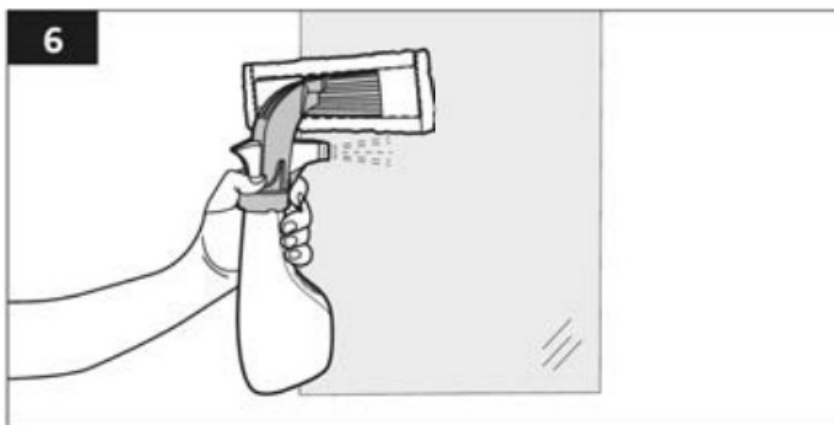

5. Switch the appliance on.
6. Move the appliance slowly from top to bottom on the surface using the suction nozzle (A). The suction nozzle (A) vacuums up any moisture. The vacuumed moisture is deposited into the water tank (E) (**Fig. 7**).



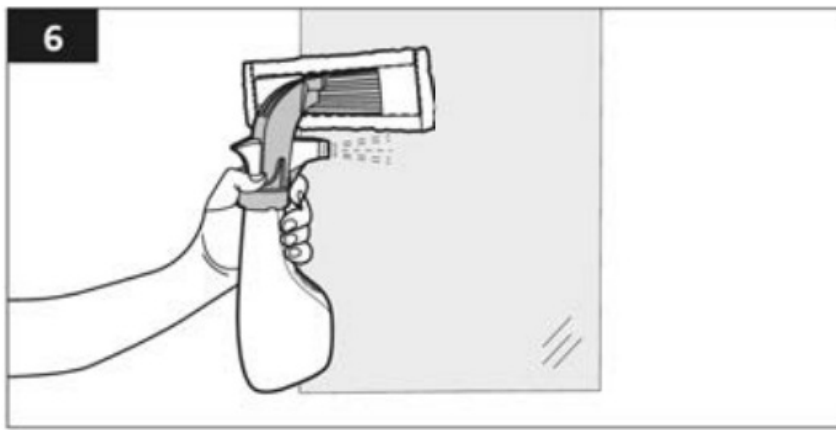

## Cleaning

### Suction nozzle, suction head and motor unit

1. Press the suction head release buttons (J) and remove the suction head (C) from the motor unit (D) **(Fig. 8)**.

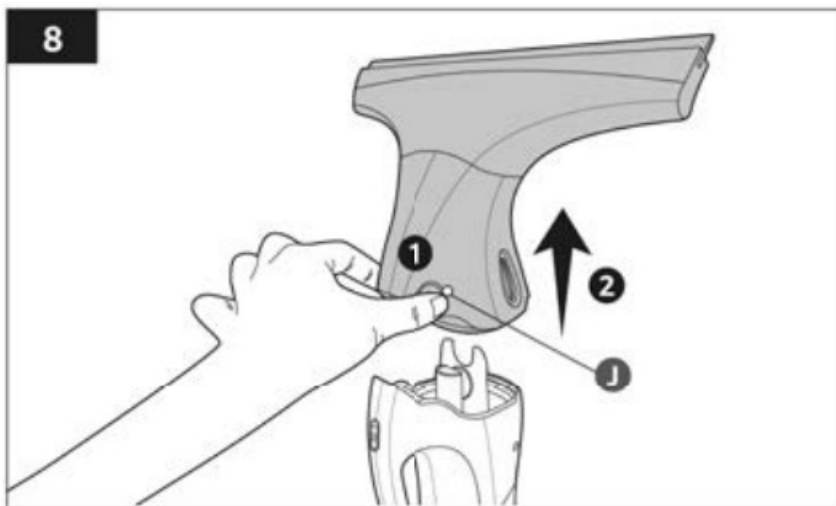

2. Press the suction nozzle release button (B) and remove the suction nozzle (A) from the suction head (C) **(Fig. 9)**.

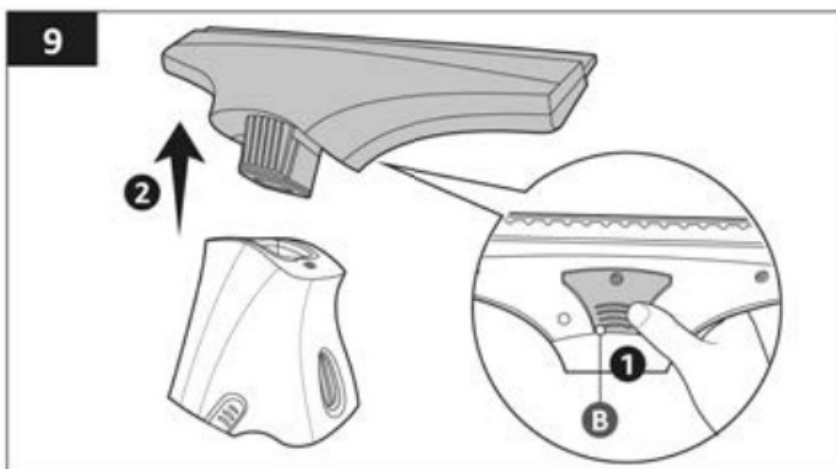

3. Wipe all parts with a soft, slightly damp cloth.

### Water tank, spray bottle and wiper

1. Press the water tank release button (F) and remove the water tank (E) from the motor unit (D) **(Fig. 10)**.

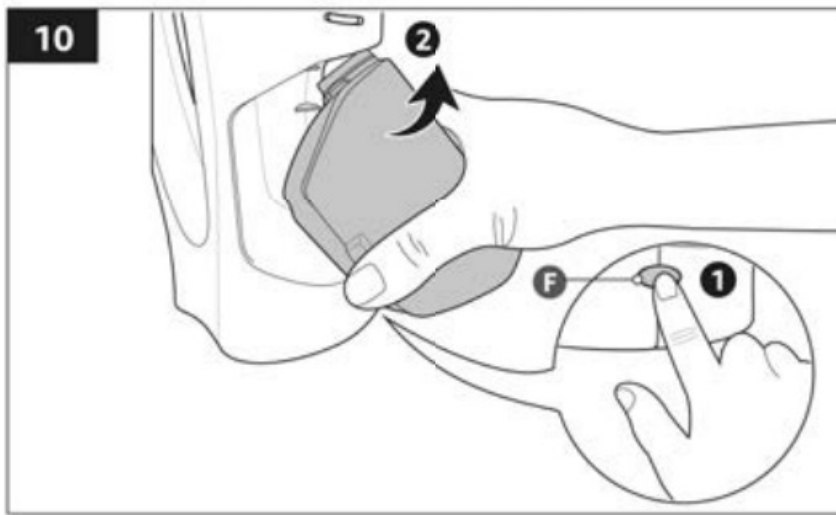

2. Rinse the parts in water and add mild detergent if needed.

- Wipe the appliance dry after cleaning.
- Never use corrosive detergents, wire brushes, abrasive scourers, metal or sharp utensils to clean the appliance.

### Cleaning pad

- For detail on how to clean the cleaning pad (K), refer to care label attached to the cleaning pad (K).
- The cleaning pad (K) can be washed in a washing machine at 140°F (60°C). Do not tumble dry, iron, bleach or dry clean.

### Storage

- Store the appliance in its original packaging in a dry area. Keep away from children and pets.

### Maintenance

- Any other servicing than mentioned in this manual should be performed by a professional repair center.

### Troubleshooting

Problem	Solution
The appliance does not switch on.	Charge the appliance with the supplied AC adapter <b>(P)</b> .
Streaks keep appearing during cleaning.	Clean the suction nozzle <b>(A)</b> . Add less cleaning detergent in the spray bottle <b>(O)</b> .
The spray bottle <b>(O)</b> does not work.	Refill the spray bottle <b>(O)</b> . Set the spray nozzle (M) to SPRAY or STREAM.

### Disposal

### NITICE

Remove the battery before disposal of the product.

The Waste Electrical and Electronic Equipment (WEEE) Directive aims to minimize the impact of electrical and electronic goods on the environment, by increasing re-use and recycling and by reducing the amount of WEEE going to landfill. The symbol on this product or its packaging signifies that this product must be disposed separately from ordinary household wastes at its end of life. Be aware that this is your responsibility to dispose of electronic equipment at recycling centers in order to conserve natural resources. Each country should have its collection centers for electrical and electronic equipment recycling. For information about your recycling drop off area, please contact your related electrical and electronic equipment waste management authority, your local city office, or your household waste disposal service.

## Battery Disposal

Contact an authorized service center to remove the battery before disposal of the appliance:

1. Unscrew all seven screws on the housing.
2. Open the housing. Cut the cables.
3. Remove the battery located at the back of the charging port.

Do not dispose of used batteries with your household waste. Take them to an appropriate disposal/collection site.

**To learn more about recycling batteries, visit:**

[call2recycle.org/what-can-i-recycle](http://call2recycle.org/what-can-i-recycle)

## Specifications

### Appliance

Model number	AEU-VK-9015M
Rated voltage	5V
Battery type/voltage	Lithium ion battery; 3.7V, 2200 mAh
Power consumption	12 W
IP rating	IPX4 (protected against water splashes from all sides)
Protection class	Class III
Operating time (on full charge)	45 minutes
Charging time (from empty)	approx. 3.5 hours

### AC adapter

Manufacturer's name or trade mark, commercial registration number and address	Powertron Electronics Corp. 6F, No. 115, Lide Street, Zhonghe Dist., New Taipei City 235, Taiwan
Model number	PS1006-050HIB100
Input voltage	100-240 V~
Input AC frequency	50-60 Hz
Protection class	Class II
Output voltage	5.0 V
Output current	1.0 A
Output power	max. 5.0 W
Average active efficiency	min. 73.6%
No-load power consumption	0.1 W

## Feedback and Help

We would love to hear your feedback. To ensure we are providing the best customer experience possible, please consider writing a customer review.

Scan QR Code below with your phone camera or QR reader:



UK: [amazon.co.uk/review/w/review-your-purchases#](https://www.amazon.co.uk/review/w/review-your-purchases#)

If you need help with your Amazon Basics product, please use the website or number below.



US: [amazon.com/gp/help/customer/contact-us](https://www.amazon.com/gp/help/customer/contact-us)

UK: [amazon.co.uk/gp/help/customer/contact-us](https://www.amazon.co.uk/gp/help/customer/contact-us)



[ +1877-485-0385 (US Phone Number)

## FCC-Supplier's Declaration of Conformity

Unique Identifier	B08PG48SKQ-Window Vacuum Cleaner Set
Responsible Party	Amazon.com Services LLC.
U.S. Contact Information	410 Terry Ave N. Seattle, WA 98109 USA
Telephone Number	(206 266-1000

## FCC Compliance Statement

1. This device complies with Part 15 of the FCC Rules. Operation is subject to the following two conditions:
  1. this device may not cause harmful interference, and
  2. this device must accept any interference received, including interference that may cause undesired operation.
2. Changes or modifications not expressly approved by the party responsible for compliance could void the user's authority to operate the equipment.

## FCC Interference Statement:

This equipment has been tested and found to comply with the limits for a Class B digital device, pursuant to part 15 of the FCC Rules. These limits are designed to provide reasonable protection against harmful interference in a residential installation. This equipment generates, uses and can radiate radio frequency energy and, if not installed and used in accordance with the instructions, may cause harmful interference to radio communications. However, there is no guarantee that interference will not occur in a particular installation.

If this equipment does cause harmful interference to radio or television reception, which can be determined by turning the equipment off and on, the user is encouraged to try to correct the interference by one or more of the following measures:

- Reorient or relocate the receiving antenna.
- Increase the separation between the equipment and receiver.
- Connect the equipment into an outlet on a circuit different from that to which the receiver is connected.
- Consult the dealer or an experienced radio / TV technician for help.

## Canada IC Notice

This Class B digital apparatus complies with Canadian CAN ICES-003(B) / NMB-003(B) standard.

[amazon.com/AmazonBasics](https://www.amazon.com/AmazonBasics)

MADE IN CHINA  
 FABRIQUE EN CHINE  
 HERGESTELLT IN CHINA  
 PRODOTTO IN CINA  
 HECHO EN CHINA  
 GEMAAKT IN CHINA  
 V01-07/22

amazon basics

## Documents / Resources

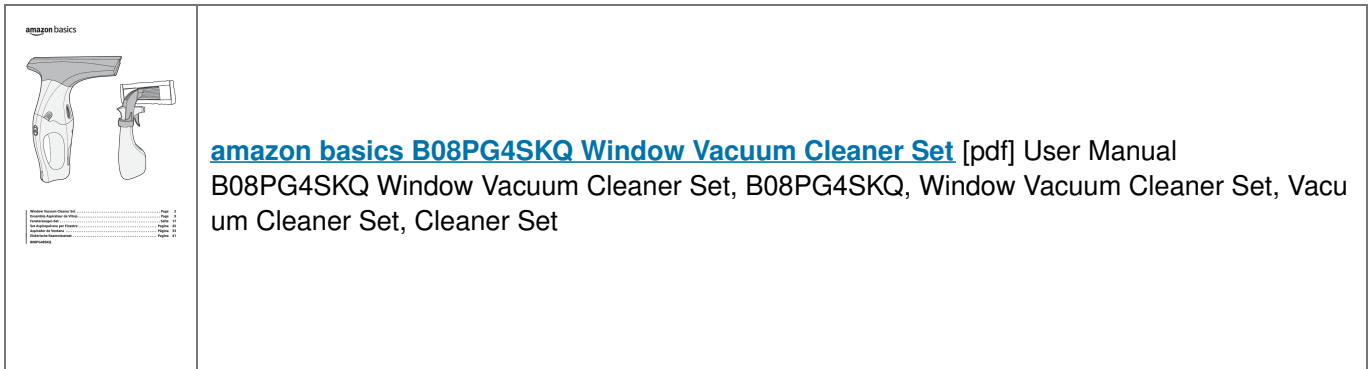

## References

- User Manual