



## amazon basics B08J4N3FXJ Electronic Keypad Entry Lever Door Lock Instruction Manual

[Home](#) » [amazon basics](#) » amazon basics B08J4N3FXJ Electronic Keypad Entry Lever Door Lock Instruction Manual 

amazon basics B08J4N3FXJ Electronic Keypad Entry Lever Door Lock Instruction Manual



## Contents

- [1 Important Safeguards](#)
- [2 Before First Use](#)
- [3 Operation](#)
  - [3.1 Inserting batteries](#)
  - [3.2 Indicator signals and lights](#)
  - [3.3 Programming](#)
- [4 Cleaning and Maintenance](#)
- [5 Troubleshooting](#)
- [6 FCC – Supplier's Declaration of Conformity](#)
  - [6.1 FCC Compliance Statement](#)
  - [6.2 FCC Interference Statement](#)
- [7 Canada IC Notice](#)
- [8 Battery Disposal](#)
- [9 Specifications](#)
- [10 Feedback and Help](#)
- [11 Documents / Resources](#)
- [12 Related Posts](#)

## Important Safeguards

Read these instructions carefully and retain them for future use. If this product is passed to a third party, then these instructions must be included.

- Prevent unauthorized entry. The electronic lock is pre-programmed with default user code and programming code. After installation and setup, change the codes.
- Store the codes in a safe place and change them from time to time.
- Make sure that no unauthorized person has the access to the codes.
- Do not use excessive force or sharp objects to push the buttons on the keypad.
- Close the door completely when going outside. The manufacturer does not assume the responsibility for any harm caused by engagement of the lock on an improperly closed door.
- No lock can provide complete security by itself. This product may be defeated by forcible or technical means, or evaded by entry elsewhere on the property. No lock can substitute for caution, awareness of your environment, and common sense. The builder's hardware is available in multiple performance grades to suit the application. In order to enhance security and reduce risk, consult a qualified locksmith or other security professionals

## Before First Use

- Remove all the packing materials.
- Remove and review all components before use.
- Check the product for transport damages.

## Operation

### Inserting batteries

### NOTICE

- Always use alkaline batteries. Insert batteries correctly with regard to polarity (+ and -) marked on the battery and the product.
- Exhausted batteries should be immediately removed from product and properly disposed.
- Insert the batteries after the product has been installed on the door.
- The programming code and user code will be stored after replacing batteries.

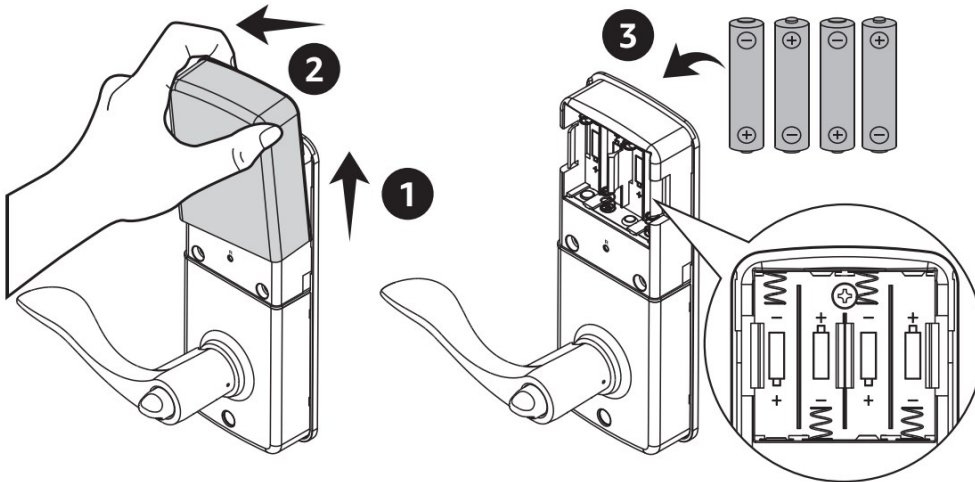

1. Push the battery compartment cover (N) upwards, then pull it out.
2. Insert four AA batteries into the battery compartment.
3. Slide the battery compartment cover (N) back onto the interior assembly (K).

#### Indicator signals and lights

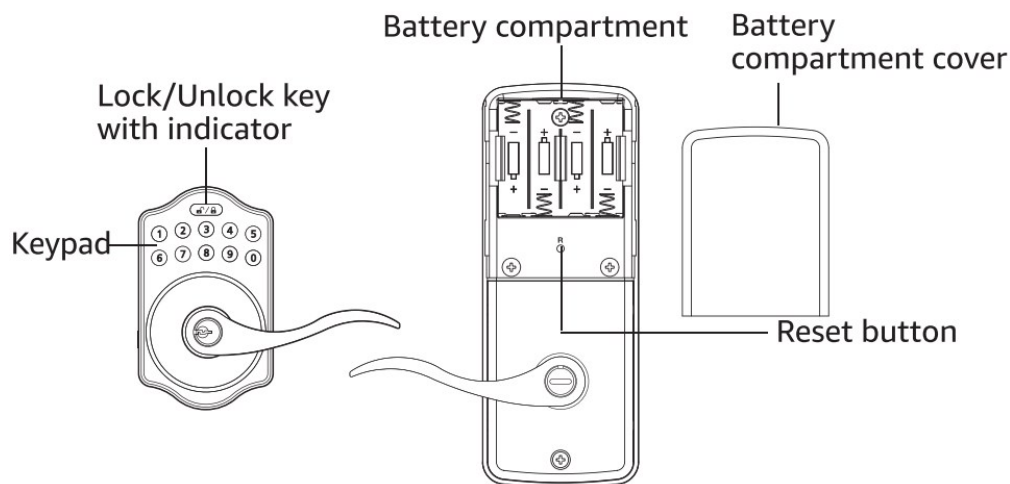

Description	Signal	Light
Successful operation	1x Beep	1x Green flash
Successful programming	2x Long beep	2x Green flash
Operation error/Incorrect code input	3x Beep	3x Red flash
Incorrect code input 5 times	5x Beep	5x Red flash
Low battery power	10x Beep	10x Red flash
Default settings restored	3x Long beep	3x Orange flash
In programming mode	————	3x Orange slow flash

## Programming

### NOTICE

Programming and assigning new codes is only possible when the lock is unlocked and the door is open.

### NOTICE

In this chapter, PC refers to programming code; and UC refers to user code.

## Changing Programming Code

### NOTICE

- The default programming code (PC) is 0000. Change the code with 4-10 digits in length.
- The programming code and user code cannot be identical.
- The lock will temporarily freeze for 45 seconds if unauthorized codes code has been entered more than 5 times.



## Adding New User Code

### NOTICE

- The default user code (UC) is 1234. Change the code with 4-10 digits in length. Up to 10 sets of user codes can be saved.
- The programming code and user code cannot be identical.
- The lock will temporarily freeze for 45 seconds if unauthorized codes code has been entered more than 5 times.



## Deleting an Existing User Code

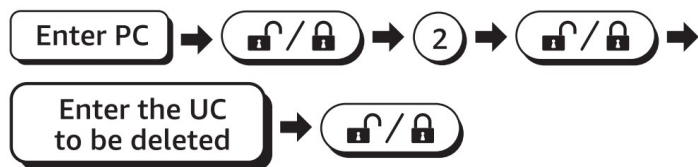

### Deleting All User Codes at Once

#### NOTICE

When all user codes are deleted, the lock can only be operated with the keys. Auto-lock or keypad functions are disabled until a new user code is set.



### Activating/Deactivating Auto-Lock

#### NOTICE

After the auto-lock function is activated, the lock locks automatically after being unlocked for 30 seconds.



### Setting Auto-Lock Time Delay

#### NOTICE

The default auto-lock time delay is set to 30 seconds. Set the time delay between 10 and 99 seconds.

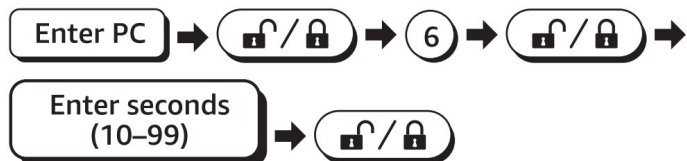

### Muting/Unmuting Signal Sounds

#### NOTICE

When the signal sound is muted, the indicator lights are still active.



### Enabling/Disabling All User Codes

#### NOTICE

When all user codes are disabled, the lock can only be operated with the keys. Auto-lock or keypad functions are disabled.



### Creating a One-Time User Code

#### NOTICE

The one-time user code can only be used once and will expire automatically.

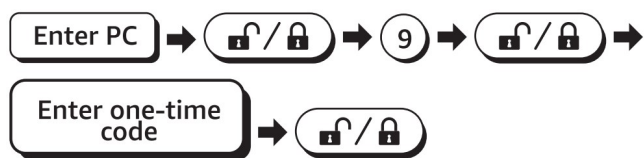

## Restoring Default Settings

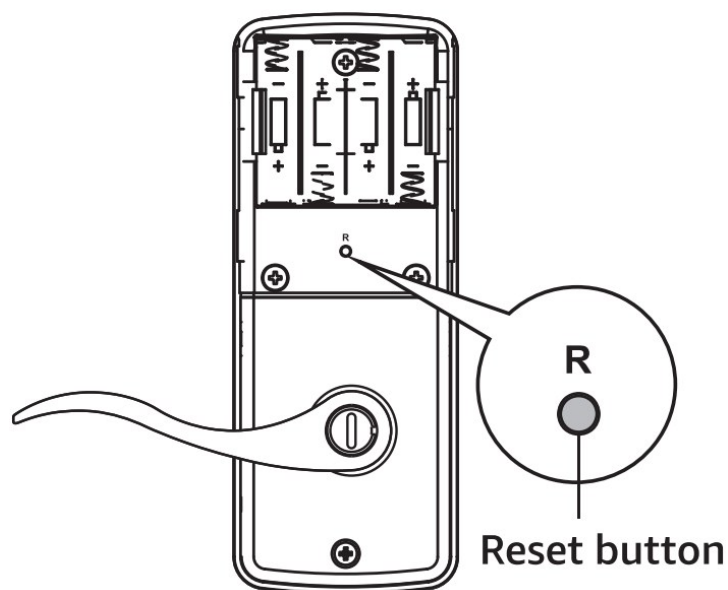

### NOTICE

Using a pointed object, press and hold the reset button for 5 seconds. The lock emits 3 long beeps and all the settings are restored to the original factory settings.

## Cleaning and Maintenance

- To clean the product, wipe with a soft, slightly moist cloth.
- Regularly check that all the components and fasteners are tightened.
- Never use corrosive detergents, wire brushes, abrasive scourers, metal or sharp utensils to clean the product.

## Troubleshooting

Problem	Solution
The latch does not retract easily when rotating the turn piece or using the key. The electronic lock does not function.	<ul style="list-style-type: none"> <li>• Ensure the position of the strike plate on the door frame is aligned with the position of the latch.</li> <li>• Check the connection of the cables. The colored edges of the connectors must be aligned.</li> <li>• Ensure the batteries are new and installed correctly.</li> </ul>
The indicator light flashes red 3 times when determining the door handing.	<ul style="list-style-type: none"> <li>• Ensure the door is open and unlocked.</li> <li>• Use new set of batteries.</li> <li>• Reset the product to default factory settings and determine the door handing again.</li> </ul>
The door cannot be locked with the electronic lock.	<ul style="list-style-type: none"> <li>• Ensure the electronic lock is programmed with at least one user code. See chapter “Adding new user code”</li> <li>• Ensure the user codes are not disabled. See chapter “Enabling/Disabling all user codes”.</li> </ul>
Door jammed while attempting to lock.	<ul style="list-style-type: none"> <li>• Manually re-lock door. If needed, reposition the strike plate.</li> </ul>
Upon pressing any of the keys, all keys light up blue and the lock does not function.	<ul style="list-style-type: none"> <li>• 5 incorrect user codes entered within one minute. The lock is temporarily locked for 45 seconds. Re-enter the user code after 45 seconds.</li> </ul>

## FCC – Supplier’s Declaration of Conformity

### Unique Identifier

B08J4N3FXJ – Electronic Keypad Entry Lever Door Lock – Satin Nickel

B08J4HRBDV – Electronic Keypad Entry Lever Door Lock – Oil Rubbed

### Bronze

B08J4J73WJ – Electronic Keypad Entry Lever Door Lock – Matte Black

### Responsible Party

[Amazon.com](https://www.amazon.com) Services LLC.

### U.S. Contact Information

410 Terry Ave N. Seattle, WA 98109 USA

### Telephone Number

(206) 266-1000

## FCC Compliance Statement

1. This device complies with Part 15 of the FCC Rules. Operation is subject to the following two conditions:
  1. this device may not cause harmful interference, and
  2. this device must accept any interference received, including interference that may cause undesired operation.
2. Changes or modifications not expressly approved by the party responsible for compliance could void the user's authority to operate the equipment.

## FCC Interference Statement

This equipment has been tested and found to comply with the limits for a Class B digital device, pursuant to part 15 of the FCC Rules. These limits are designed to provide reasonable protection against harmful interference in a residential installation. This equipment generates, uses and can radiate radio frequency energy and, if not installed and used in accordance with the instructions, may cause harmful interference to radio communications. However, there is no guarantee that interference will not occur in a particular installation. If this equipment does cause harmful interference to radio or television reception, which can be determined by turning the equipment off and on, the user is encouraged to try to correct the interference by one or more of the following measures:

- Reorient or relocate the receiving antenna.  
Increase the separation between the equipment and receiver.
- Connect the equipment into an outlet on a circuit different from that to which the receiver is connected.
- Consult the dealer or an experienced radio/TV technician for help

## Canada IC Notice

- This Class B digital apparatus complies with Canadian CAN ICES-003(B) / NMB-003(B) standard.

## Battery Disposal



Do not dispose of used batteries with your household waste. Take them to an appropriate disposal/collection site.



To learn more about recycling batteries, visit: [call2recycle.org/what-can-i-recycle](https://call2recycle.org/what-can-i-recycle)

## Specifications

- **Voltage/battery:**  
6 V, 4x 1.5 V AA
- **Battery life:**  
Up to 1 year with 4x AA Alkaline batteries
- **Door thickness:**  
1-3/8-1-3/4" (35-45 mm)
- **Backset:**

2-3/8" (60 mm)/2-3/4" (70 mm)

- **Latch bolt:**

Zinc alloy latch bolt, full 1/2" (12.7 mm) throw

- **Cylinder and keys:**

Kwikset keyway, 2 keys

## Feedback and Help

We would love to hear your feedback. To ensure we are providing the best customer experience possible, please consider writing a customer review.

Scan QR Code below with your phone camera or QR reader:



If you need help with your AmazonBasics product, please use the website or number below.







[amazon.com/gp/help/customer/contact-us](https://amazon.com/gp/help/customer/contact-us)



+1 877-485-0385

# amazon basics

## Documents / Resources

  <p><b>Safety and Use Manual</b> Manuel de Sécurité et d'Utilisation Manual de uso y Seguridad 安全と取扱いマニュアル</p> <p>Electronic Keypad Entry Lever Door Lock Service de Poignée à Levier pour Poignée d'Entrée avec Clavier Servicio de Puerto con Manija y Cerradura Electrónica de Acero 電子キーパッド入力レバードアロック B08J4N3FXJ, B08J4N3FXJ, B08J4N3FXJ</p>	<p><a href="#">amazon basics B08J4N3FXJ Electronic Keypad Entry Lever Door Lock</a> [pdf] Instruction Manual</p> <p>C140X, B08J4N3FXJ, B08J4N3FXJ Electronic Keypad Entry Lever Door Lock, Electronic Keypad Entry Lever Door Lock, Keypad Entry Lever Door Lock, Entry Lever Door Lock, Lever Door Lock, Door Lock, Lock</p>
  <p><b>Installation Manual</b> Manuel d'Installation Manual de Instalación 取付マニュアル</p> <p>Electronic Keypad Entry Lever Door Lock Service de Poignée à Levier pour Poignée d'Entrée avec Clavier Servicio de Puerto con Manija y Cerradura Electrónica de Acero 電子キーパッド入力レバードアロック B08J4N3FXJ, B08J4N3FXJ, B08J4N3FXJ</p> <p>Scan the QR Code or visit the page for more information or to request a replacement or to return the product or to contact customer support</p> <p>Escaneie o código QR ou visite a página para obter mais informações ou solicitar um substituto ou devolver o produto ou entrar em contato com o suporte ao cliente</p> 	<p><a href="#">amazon basics B08J4N3FXJ Electronic Keypad Entry Lever Door Lock</a> [pdf] Installation Guide</p> <p>B08J4N3FXJ, B08J4N3FXJ Electronic Keypad Entry Lever Door Lock, Electronic Keypad Entry Lever Door Lock, Keypad Entry Lever Door Lock, Entry Lever Door Lock, Lever Door Lock, Door Lock, Lock</p>