



amazon basics B086N8NXHR Combo Binding Machine Instruction Manual

[Home](#) » [amazon basics](#) » amazon basics B086N8NXHR Combo Binding Machine Instruction Manual 

amazon basics

**B086N8NXHR Combo
Binding Machine
Instruction Manual**



Contents

1 IMPORTANT SAFEGUARDS

2 Intended Use

3 product Description

4 Before First Use

5 Operation

6 Adjustments

7 Cleaning and Maintenance

8 Troubleshooting

9 Importer Information

10 Feedback and Help

11 Documents / Resources

11.1 References

IMPORTANT SAFEGUARDS



Read these instructions carefully and retain them for future use. If this product is passed to a third party, then these instructions must be included.

When using the product, basic safety precautions should always be followed to reduce the risk of injury including the following:



CAUTION Risk of injury!

Do not insert foreign objects such as pens, fingers, or wires into this product.

- This product is not a toy. Keep the product away from children.
- Use this product only on a firm, level surface.
- Handle with care when operating around the comb plate.

Intended Use

- This product is intended for punching and binding paper.
- This product is intended for private use only. It is not intended for commercial use.
- This product is intended to be used in dry indoor areas only.
- No liability will be accepted for damages resulting from improper use or non-compliance with these instructions.

product Description

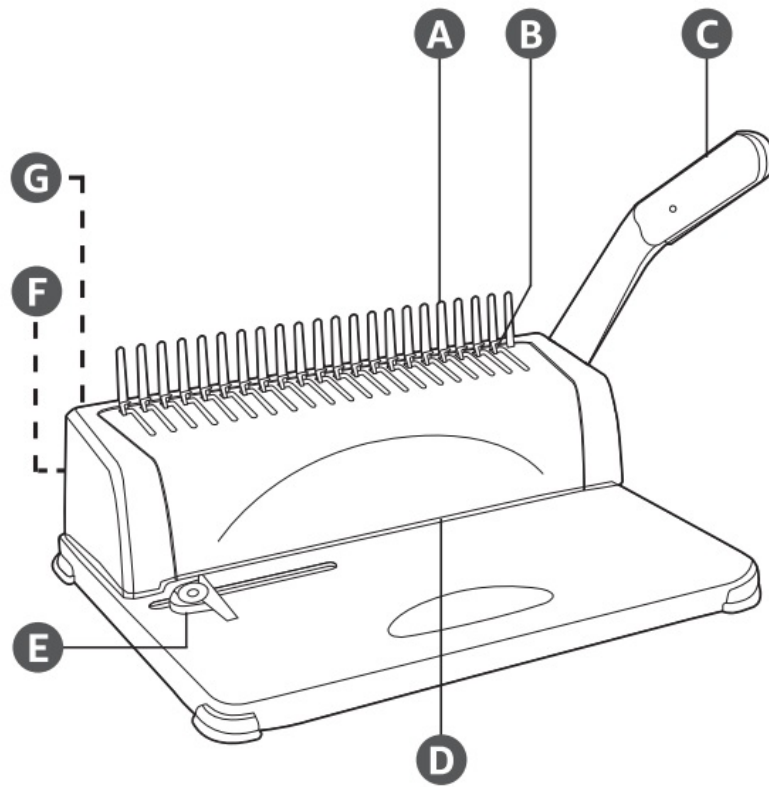

- A. Comb plate
- B. Ring puller plate
- C. Lever
- D. Paper slot
- E. Alignment block
- F. Margin depth selector
- G. Waste paper drawer

Before First Use

⚠ DANGER Risk of suffocation!

Keep any packaging materials away from children – these materials are a potential source of danger, e.g. suffocation.

- Check the product for transport damages.
- Remove all the packing materials.

4.1 Attaching lever

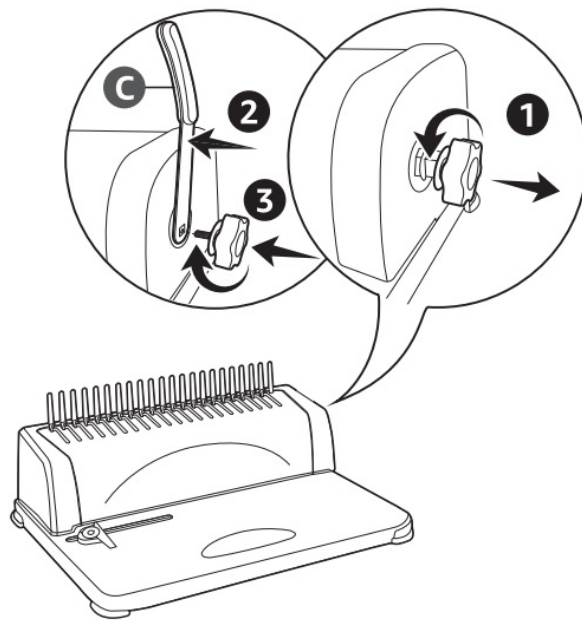

1. Remove screw and washer from the main unit.
2. Attach the lever (C).
3. Reinstall washer and screw.

Operation

NOTICE

- Before punching the original papers, test the settings with scrap paper.
- For punching, the maximum number of pages is 12.

Adjustments

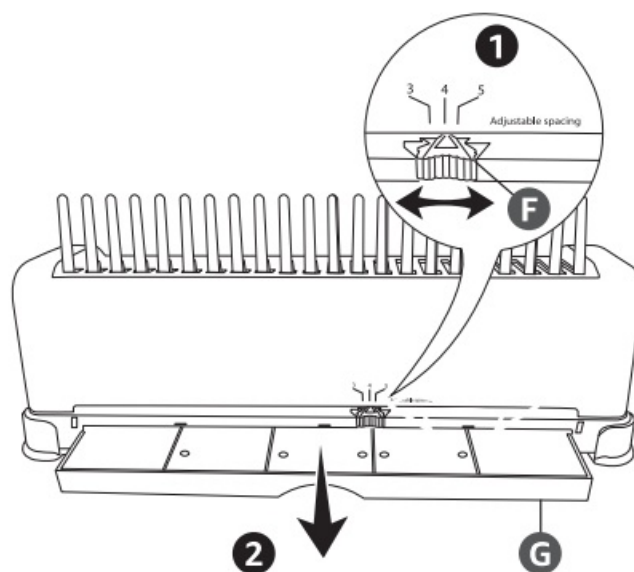

6.1 Margin depth

Set the margin depth of the punch holes (3-5 mm) with the margin depth selector (F) on the backside of the product.

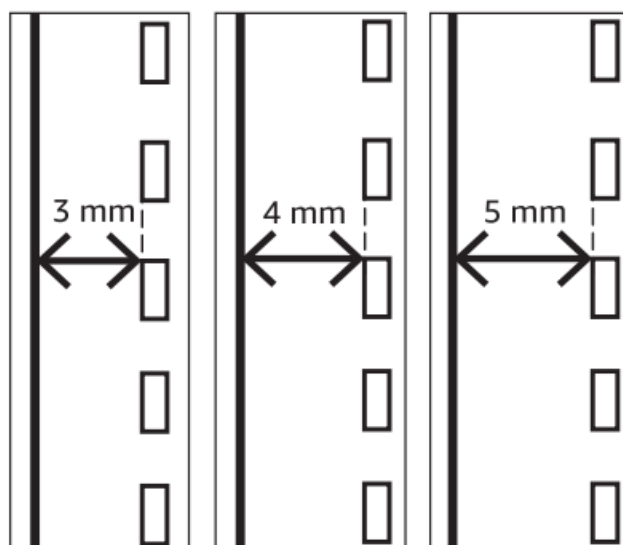

6.2 Empty waste paper bin

Pull out the waste paper drawer (G) on the backside of the product to empty the collected waste paper.

Cleaning and Maintenance

7.1 Cleaning

- To clean the product, wipe with a soft, slightly moist cloth.
- Never use corrosive detergents, wire brushes, abrasive scourers, metal or sharp utensils to clean the product.

7.2 Maintenance

- Check the components regularly to make sure all screws and bolts are tightened.
- Store in a cool and dry place away from children and pets, ideally in original packaging.

Troubleshooting

Problem	Solution
<ul style="list-style-type: none"> • It is hard to push the lever (C) down when punching. • Incomplete paper punching 	Punch max. 12 pages of paper at a time.
The margin depth is varying.	Align all paper with the alignment block (E) and within each stack. Clear the paper slot (D) from remaining paper parts.

Importer Information

	For UK
Postal:	Amazon EU SARL, UK Branch, 1 Principal Place, Worship St, London EC2A 2FA, United Kingdom
Business Reg.:	BR017427

	For EU
Postal:	Amazon EU S.ar.l., 38 avenue John F. Kennedy, L-1855 Luxembourg
Business Reg.:	134248

Feedback and Help

We would love to hear your feedback. To ensure we are providing the best customer experience possible, please consider writing a customer review.

Scan QR Code below with your phone camera or QR reader:

us:



https://www.amazon.com/review/review-your-purchases/listing/?ref=HPB_UM_CR



uk: [amazon.co.uk/review/review-your-purchases#](https://www.amazon.co.uk/review/review-your-purchases#)

If you need help with your Amazon Basics product, please use the website or number below.



US: [amazon.com/gp/help/customer/contact-us](https://www.amazon.com/gp/help/customer/contact-us)

UK: [amazon.co.uk/gp/help/customer/contact-us](https://www.amazon.co.uk/gp/help/customer/contact-us)



+1877-485-0385 (US Phone Number)

1



2

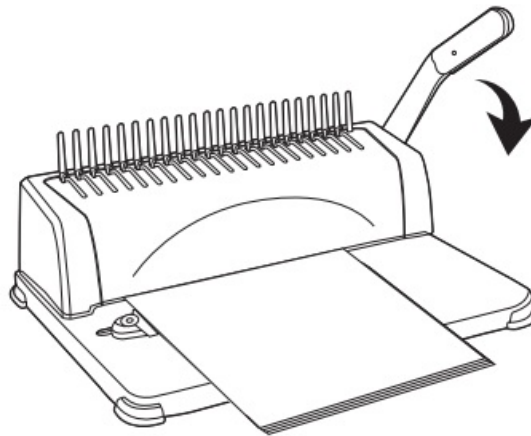

3

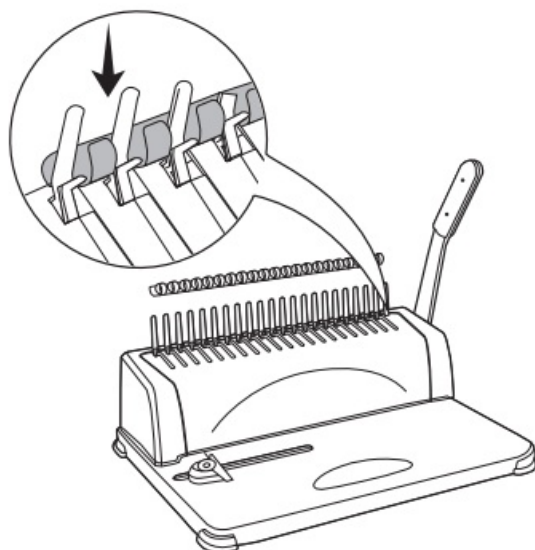

4

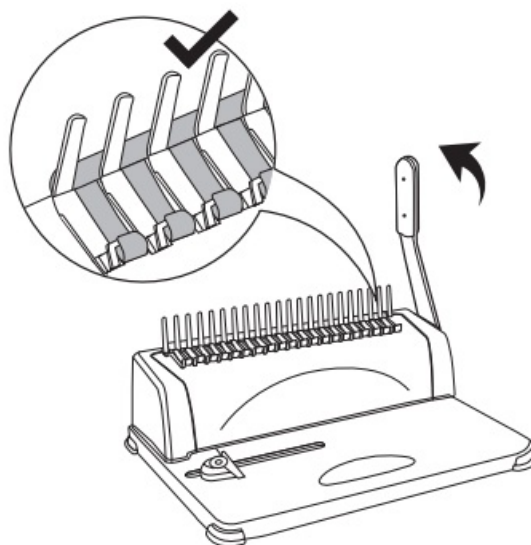

A line drawing of a spiral-bound notebook. A callout circle provides a magnified view of the spiral binding, showing the metal or plastic coils and the way the paper is inserted into them. An arrow in the callout points to the right, indicating the direction of insertion.

A line drawing of a spiral-bound notebook. A circular inset provides a magnified view of the spiral binding mechanism, showing the metal or plastic coils and the way they are attached to the paper. A curved arrow indicates the direction of the spiral.

V03-11/23

amazon basics

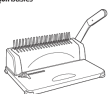

Comb Binding Machine
Machine à Releer par Polys
Kombiendbindemaschine
Ritapicci e Pettini
Encadernadora Combinada
Kombibindemaschine
Hindemixia grabindlerova
Bindingsmaschine
コムバインディングマシン
cym baipin dīng māsīn
BAGNARDEN

EN	Page	2	PL	Strona	20
FR	Page	5	FR	Seite	23
DE	Seite	8	DE	Seite	28
IT	Pagina	11	IT	Seite	44
ES	Página	14	ES		29

[amazon basics B086N8NXHR Combo Binding Machine](#) [pdf] Instruction Manual
B086N8NXHR Combo Binding Machine, B086N8NXHR, Combo Binding Machine, Binding Machine

References

- [User Manual](#)

[Manuals+](#), [Privacy Policy](#)

This website is an independent publication and is neither affiliated with nor endorsed by any of the trademark owners. The "Bluetooth®" word mark and logos are registered trademarks owned by Bluetooth SIG, Inc. The "Wi-Fi®" word mark and logos are registered trademarks owned by the Wi-Fi Alliance. Any use of these marks on this website does not imply any affiliation with or endorsement.