



amazon basics B07T2C9BTT 3 Speed Oscillating Portable 3 In 1 Air Cooler Instruction Manual

[Home](#) » [amazon basics](#) » amazon basics B07T2C9BTT 3 Speed Oscillating Portable 3 In 1 Air Cooler Instruction Manual 

Contents

- [1 amazon basics B07T2C9BTT 3 Speed Oscillating Portable 3 In 1 Air Cooler](#)
- [2 Overview](#)
- [3 Cleaning and Maintenance](#)
- [4 Troubleshooting](#)
- [5 Specifications](#)
- [6 Documents / Resources](#)
 - [6.1 References](#)
- [7 Related Posts](#)



amazon basics B07T2C9BTT 3 Speed Oscillating Portable 3 In 1 Air Cooler

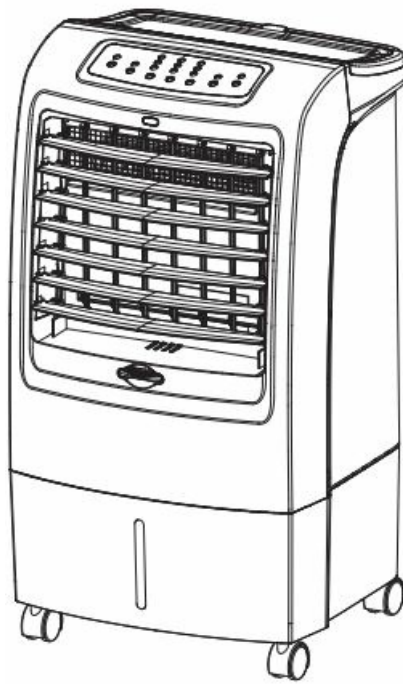

Overview



A (x 1)



B (x 2)



C (x 2)



D (x 1)



E (x 2)

IMPORTANT SAFEGUARDS

Read these instructions carefully and retain them for future use. If this product is passed to a third party, then these instructions must be included. When using electrical appliances, basic safety precautions should always be followed to reduce the risk of fire, electric shock, and/or injury to persons including the following:

- This appliance can be used by children aged from 8 years and above and persons with reduced physical, sensory or mental capabilities or lack of experience and knowledge if they have been given supervision or instruction concerning use of the appliance in a safe way and understand the hazards involved. Children shall not play with the appliance. Cleaning and user maintenance shall not be made by children without supervision.
- If the supply cord is damaged, it must be replaced by the manufacturer, its service agent or similarly qualified persons in order to avoid a hazard.
- Do not use this appliance in the immediate surroundings of a bath, a shower or a swimming pool.
- Connect the power plug to an easily reachable socket outlet so that in case of an emergency the appliance can be unplugged immediately. Pull the power plug out of the socket outlet to completely disconnect the appliance from the voltage.
- Do not insert any objects through the air inlet or outlet.
- Before connecting the appliance to the power supply, check that the power supply voltage and current rating corresponds with the power supply details shown on the appliance rating label.
- The appliance must be kept at least 0.5 meters away from walls, furniture and curtains to prevent it from overheating due to poor ventilation.

WARNING Risk of electric shock! During cleaning or operation, do not immerse the electrical parts of the appliance in water or other liquids. Never hold the appliance under running water.

- Disconnect the power plug from the socket outlet when not in use and before cleaning.
- Do not use the appliance when no one is at home. If you are away, switch the appliance off and remove the power plug from the socket outlet.
- Do not use this appliance in environments with flammable and explosive gases.

Caution Risk of electric shock! Do not operate the product with

- Unplug the appliance during filling and cleaning.
- Do not use the cool packs if they are damaged.
- Do not store the cool packs at high temperatures.

Battery Warnings

- Always insert batteries correctly with regard to polarity(+ and-) marked on the battery and the product.
- Exhausted batteries should be immediately removed from the product and properly disposed of.
- Keep batteries out of the reach of children.
- Do not dispose of batteries in fire.
- Remove batteries from the product if it is not to be used for an extended period of time unless it is for emergency purposes.
- If the battery leaks avoid contact with skin and eyes. Rinse affected areas immediately with plenty of clean water, then consult a doctor.
- Keep the button cell batteries away from children. Risk of ingestion and suffocation!

Intended Use

- This product is intended for air ventilation and humidification of indoor areas.
- This product is intended for household use only. It is not intended for commercial use.
- This product is intended to be used in dry indoor areas only.
- No liability will be accepted for damages resulting from improper use or non-compliance with these instructions.

Before First Use

- Check the product for transport damages.

Danger Risk of suffocation! Keep any packaging materials away from children – these materials are a potential source of danger, e.g. suffocation.

- Place the product on a stable and level surface.

Operation

- There may be a trace of odor during the first few minutes of initial use. This is normal and will quickly disappear.
- Do not cover the product during operation.

Inserting/Replacing the battery

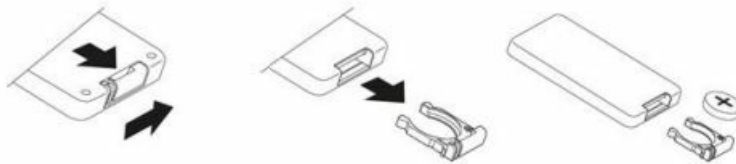

- Open the battery compartment by pulling out the battery receptacle (located at the back of the remote control (D)).
- Remove the used battery, if present.
- Insert a button cell (type CR2032) into the battery receptacle.
The + polarity marking has to point upwards.
- Slide the battery receptacle back into the battery compartment.

Foot-Wheel Installation

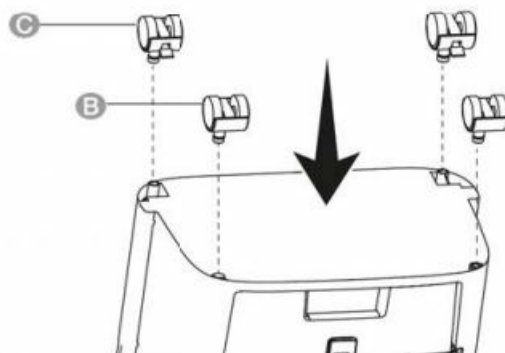

Filling the water tank

- Carefully remove the honeycomb filter on the back side of the product (Detail 1).
- Open the water-filling lid on the top of the product (Detail 2).
- Fill the bottom water tank with water (Detail 3).
- The water level must be above the MIN mark and below the MAX mark.
- The water level markings are located at the tank window on the front side of the product.
- Put the honeycomb filter back in position. Make sure that the magnet on the upper part of the honeycomb frame has contact with the product.
- With the honeycomb filter in place, you can still add water through the top water tank (Detail 4).

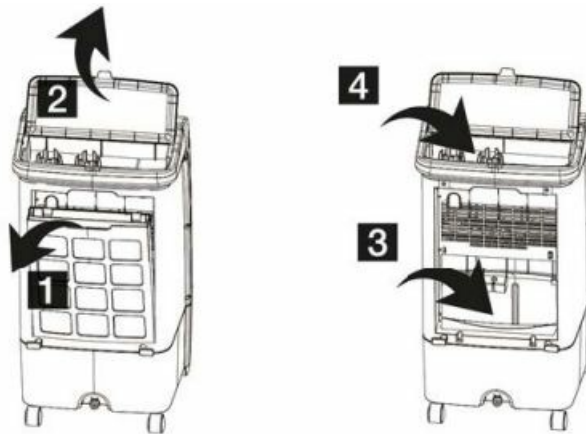

- **WARNING Risk of electric shock!** To prevent electric shock, unplug the product before filling the water tank.
- **NOTICE** For an extra cooling effect of the EVA./COOLER function, add ice cubes to the top water tank.
- **NOTICE** The air cooler only operates when the honeycomb filter is properly installed.
- **NOTICE** The EVA./COOLER function is not available when the water level is below the MIN mark.
- **Caution Risk of product damage!** Do not add any fragrances or aromatic oils to the water tanks.

Using the cool packs

- Put the cool packs (E) in the freezer for 8 hours.
- Place the frozen cool packs into the bottom water tank.

Function overview

- Plug the product to a suitable socket outlet.
- Use the control panel or the remote control (D) to select the product functions.
- The function buttons on the remote control are identical to the function buttons on the control panel.

Controls

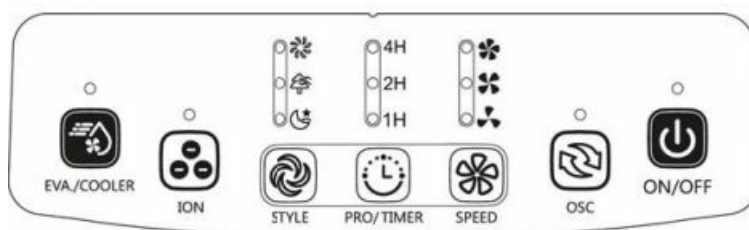

Button	Name	Function
	ON/OFF	Press to switch the product on/off.
	OSC	Ventilation oscillating horizontally.
	STYLE	Press to select the cooling style. Normal Natural Sleep (Constant) (Varying breeze) (Lighter varying breeze)
	SPEED	Press to select the fan speed. : Low fan speed. : Medium fan speed. : High fan speed.
	PRO/TIMER	Press to select the timer function. A: Product is on (stop operation after 1-7 hours). B: Product is off (start operation after 1-7 hours). Press again = cancel. The selected timer indicator lights are on when a timer is set.
	ION	Press to select the air purification function.
	EVA./COOLER	Press to activate/deactivate the evaporation function (humidifying function). Note: This function is not available when the water level is below the MIN mark.

- **NOTICE** When the water level is below the MIN mark, the water pump stops running. 3 audio signals sound and the EVA./COOLER button indicator light is flashing. Fill the water tank to continue operation.
- **NOTICE** Adjust the position of the louvers by hand.

Cleaning and Maintenance

- **A WARNING Risk of electric shock!** To prevent electric shock, unplug the product before cleaning.
- **A WARNING Risk of electric shock!** During cleaning, do not immerse the electrical parts of the product in water or other liquids. Never hold the product under running water.

Cleaning

- Wipe the product with a soft, slightly moist cloth.
- Dry the product after cleaning.
- Never use corrosive detergents, wire brushes, abrasive scourers, or metal or sharp utensils to clean the product.
- Clean the dry honeycomb filter with a vacuum cleaner.

- To clean the small front filter, remove it from the drawer and shake off the collected dust.
- Decalcify the bottom water tank regularly and before storage: Add 500 ml of vinegar and 1000 ml of water to the tank, and swish it around so that it covers the bottom and sides of the bottom tank. Let it sit for at least 1 hour. The vinegar acts as a natural cleanser that loosens buildup from the bottom of the water tank. Rinse the tank thoroughly.

Storage

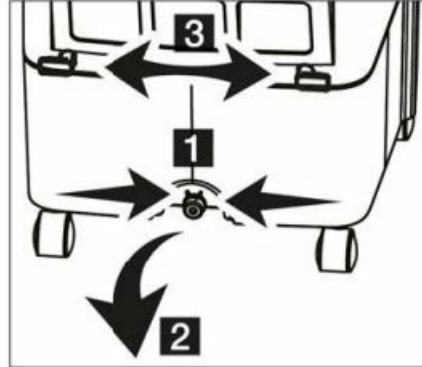

- Remove the plug of the water tank outlet on the back side of the product (Detail 1).
- Release the remaining water from the tank (Detail 2).
- Wipe both water tanks dry.
- Wind the supply cord onto the storage hooks on the back side of the product (Detail 3).
- Store the product in a safe, dry location.
- Use the original (or appropriately sized) box to protect the appliance from dust.

Troubleshooting

Problem	Solution
The product does not switch on.	<ul style="list-style-type: none"> • Check if the power plug is connected to the socket-outlet. Check if the socket-outlet works. • Check if the honeycomb filter is properly installed.
The evaporation function (EVA./COOLER) is not working.	<ul style="list-style-type: none"> • Check if the water level is above the MIN mark.

UK Plug Replacement

A WARNING Read these safety instructions thoroughly before connecting this product to the mains supply. Before switching on, make sure that the voltage of your electricity supply is the same as that indicated on the rating plate. This product is designed to operate on 220-240 V-. Connecting it to any other power source may cause damage. This product may be fitted with a non-rewireable plug. If it is necessary to change the fuse in the plug, the fuse cover must be refitted. If the fuse cover becomes lost or damaged, the plug must not be used until a suitable replacement is obtained. If the plug has to be changed because it is not suitable for your socket, or due to damage, it should be cut off and a replacement fitted, following the wiring instructions shown below. The old plug must be disposed of safely, as insertion into a 13 A socket could cause an electric hazard. The wires in the power cable of this product are colored in accordance with the following code:

- A. Green/Yellow = Earth
- B. Blue = Neutral

- C. Brown = Live

The product is protected by a 3 A approved (BS 1362) fuse. If the colors of the wires in the power cable of this product do not correspond with the markings on the terminals of your plug, proceed as follows. The wire which is colored Green/Yellow must be connected to the terminal which is marked E or by the earth symbol @ or colored Green or Green/Yellow. The wire which is colored Blue must be connected to the terminal which is marked N or colored Black. The wire which is colored Brown must be connected to the terminal which is marked L or colored Red.

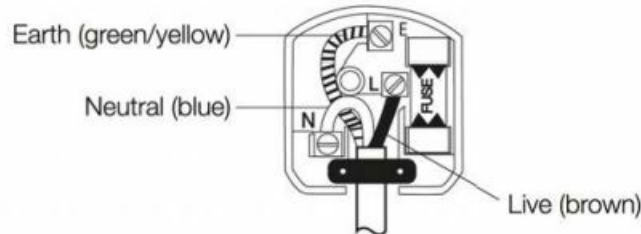

The outer sheath of the cable should be firmly held by the clamp

Disposal

The Waste Electrical and Electronic Equipment (WEEE) Directive aims to minimise the impact of electrical and electronic goods on the environment, by increasing reuse and recycling and by reducing the amount of WEEE going to landfill. The symbol on this product or its packaging signifies that this product must be disposed of separately from ordinary household wastes at its end of life. Be aware that this is your responsibility to dispose of electronic equipment at recycling centers in order to conserve natural resources. Each country should have its collection centers for electrical and electronic equipment recycling. For information about your recycling drop-off area, please contact your related electrical and electronic equipment waste management authority, your local city office, or your house hold waste disposal service.

Cool Pack Disposal

Do not dispose of the cool packs with your household waste.

Battery Disposal

Do not dispose of used batteries with your household waste. Take them to an appropriate disposal/collection site.

Specifications

Rated power:	220-240 V~, 50 Hz
Power consumption:	60 W
Protection class:	Class II
Humidifying capacity per 1h:	1.5 L
Water level maximum:	9 L
Water level minimum:	3.5 L
Net weight:	approx. 8.8 kg
Dimensions (W x H x D):	approx. 38.5 x 70 x 39 cm
Remote control voltage / battery type:	3 V  , 1 x 3 V CR2032

Description	Symbol	Value	Unit
Maximum fan flow rate	F	6.81	m ³ /min
Fan power input	P	57.5	W
Service value	SV	0.12	(m ³ /min)/W
Standby power consumption	P _{SB}	0.18	W
Fan sound power level	L _{WA}	61.48	dB(A)
Maximum air velocity	C	4.41	metres/sec
Seasonal electricity consumption	Q	18.6	kWh/a
Measurement standard for service value	IEC 60879:1986 (corr. 1992)		
Contact details for obtaining more information	Amazon EU S.à.r.l., 5 Rue Plaetis, L - 2338 Luxembourg https://www.amazon.co.uk		

Feedback and Help

Love it? Hate it? Let us know with a customer review. AmazonBasics is committed to delivering customer-driven products that live up to your high standards. We encourage you to write a review sharing your experiences with the product.

- [amazon.co.uk/review/review-your-purchases](https://www.amazon.co.uk/review/review-your-purchases)
- [amazon.co.uk/gp/help/customer/contact-us](https://www.amazon.co.uk/gp/help/customer/contact-us)

Documents / Resources

 <p><small>Amazon Basics B07T2C9BTT 3 Speed Oscillating Portable 3 In 1 Air Cooler. Amazon Basics is a registered trademark of Amazon.com, Inc. or its affiliates. All other trademarks are the property of their respective owners. © 2017 Amazon.com, Inc. or its affiliates. B07T2C9BTT, B07T2C9BTT</small></p>	<p>amazon basics B07T2C9BTT 3 Speed Oscillating Portable 3 In 1 Air Cooler [pdf] Instruction Manual</p> <p>B07T2C9BTT 3 Speed Oscillating Portable 3 In 1 Air Cooler, B07T2C9BTT, 3 Speed Oscillating Portable 3 In 1 Air Cooler, Oscillating Portable 3 In 1 Air Cooler, Portable 3 In 1 Air Cooler, Air Cooler, Cooler</p>
---	--

References

- [User Manual](#)