

amazon basics B07R3FXLLQ 18 Sheet Cross Cut Paper CD and Credit Card Shredder User Manual

[Home](#) » [amazon basics](#) » amazon basics B07R3FXLLQ 18 Sheet Cross Cut Paper CD and Credit Card Shredder User Manual 

Contents

- 1 [amazon basics B07R3FXLLQ 18 Sheet Cross Cut Paper CD and Credit Card Shredder](#)
- 2 [Contents](#)
- 3 [IMPORTANT SAFETY INSTRUCTIONS](#)
- 4 [Symbols Explanation](#)
- 5 [Assembly](#)
- 6 [Product Placement](#)
- 7 [Operation](#)
- 8 [Status Indicators](#)
- 9 [Cleaning and Maintenance](#)
- 10 [Cleaning](#)
- 11 [Maintenance](#)
- 12 [Troubleshooting](#)
- 13 [FCC – Supplier's Declaration of Conformity](#)
- 14 [Specifications](#)
- 15 [Warranty Information](#)
- 16 [Documents / Resources](#)
 - 16.1 [References](#)



amazon basics B07R3FXLLQ 18 Sheet Cross Cut Paper CD and Credit Card Shredder

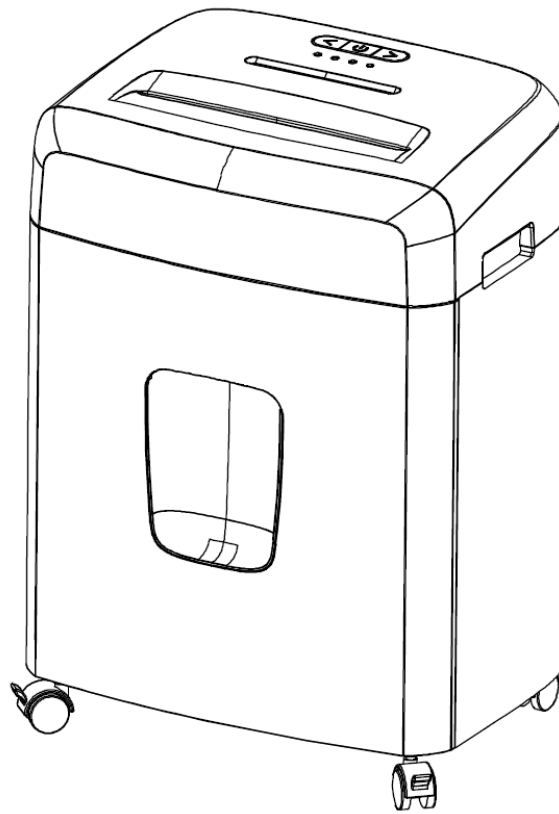

Contents

Before getting started, ensure the package contains the following components:

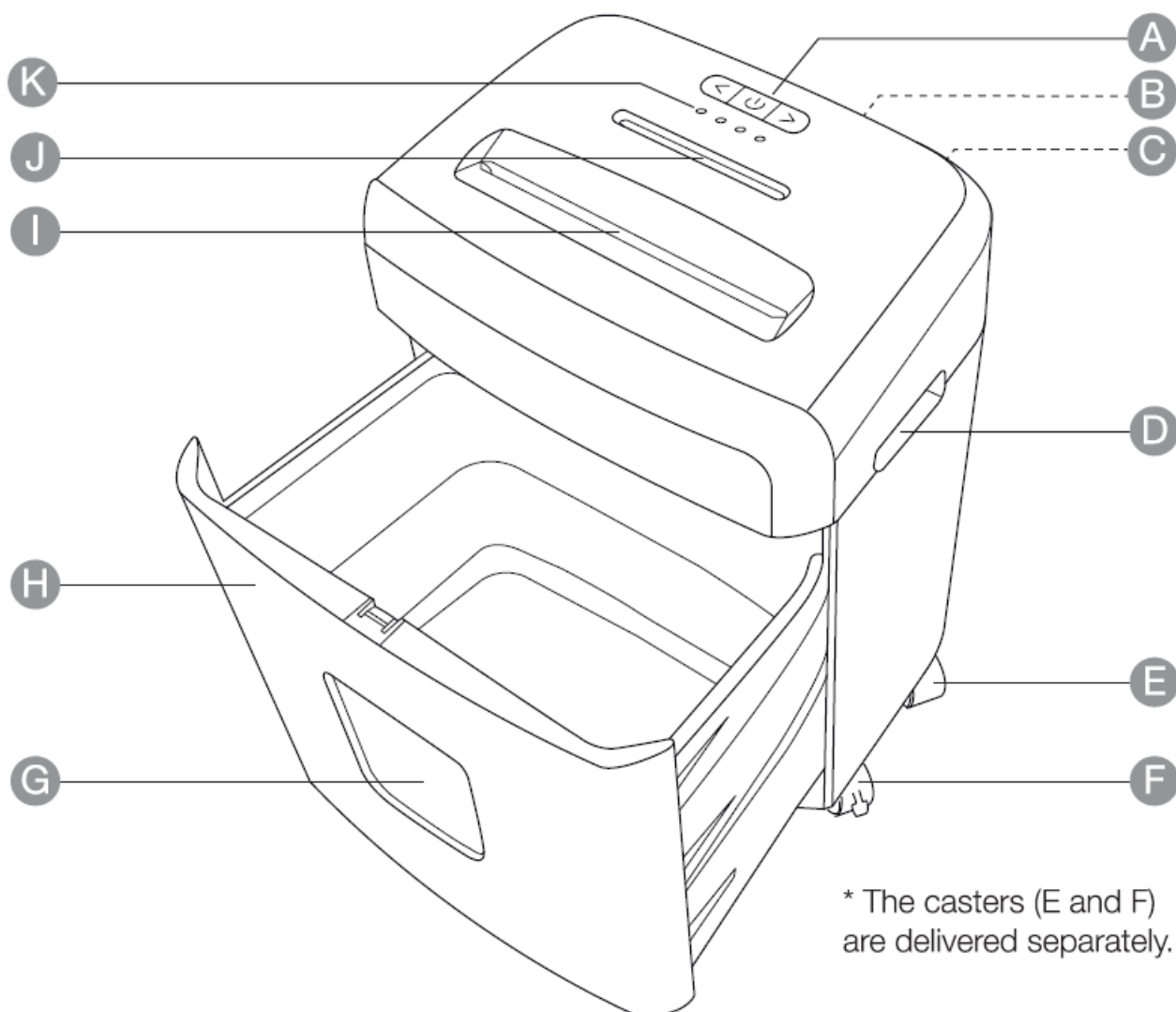

- A Control panel
- B Ventilation opening
- C On/off switch (1/0)
- D Carrying handle (both sides)
- E Casters without brake (x2)
- F Casters with brake (x2)
- G Window
- H Paper bin
- I Paper/card feed slot
- J CD feed slot
- K Status indicators

IMPORTANT SAFETY INSTRUCTIONS

Read these instructions carefully and retain them for future use. If this product is passed to a third party, then these instructions must be included.

When using electrical appliances, basic safety precautions should always be followed to reduce the risk of fire, electric shock, and/or injury to persons including the following:

- Danger of electric shock! Do not attempt to repair the product yourself. In case of malfunction, repairs are to be

conducted by qualified personnel only.

- Risk of fire! Never use any petroleum-based or flammable oils or lubricants in or around the product as some oils can combust, causing serious injury.
- Risk of injury! Do not hold CD with finger through the centre ring while feeding into the shredder.
- Risk of injury! The product has very sharp exposed cutters on the underside. Never touch the underside of the shredding mechanism.
- Always switch the product off and unplug the power supply cord from the socket-outlet when not in use, before cleaning, moving, or emptying the paper bin.
- Never dispose of flammable chemicals or materials that have come into contact with flammable chemicals (for example, nail polish, acetone and gasoline) in the paper bin.
- The ventilation should not be impeded by covering the ventilation openings with items, such as newspapers, tablecloths, curtains, etc.
- Never shred large paper clips, window or insulated envelopes, continuous forms, newsprint, bound pages (for example: notepads, checkbooks, magazines, etc.), transparencies, laminated documents, cardboard, any items with adhesives, hard materials or plastic (except plastic credit cards and CDs).
- Connect the power plug to an easily reachable electrical outlet so that in case of an emergency the appliance can be unplugged immediately.
- Empty the bin regularly. Overfilled bin might lead to jams.
- The product shall not be exposed to dripping or splashing and no objects filled with liquids, such as vases, shall be placed on the product.
- Regularly check the power plug and power supply cord for damage. If the power supply cord is damaged, it must be replaced by the manufacturer, its service agent or similarly qualified persons in order to avoid a hazard.
- Never try to clean or clear the shredder cutters.
- Never shred beyond the specified sheet capacity. This may result in product damage.

Symbols Explanation



WARNING: Read and understand all instructions before using this product. Save these instructions for later use, and follow all warnings and instructions marked on the product.



Read the instructions before use.



Avoid touching the document/media feed opening with the hands.



Product is not intended for use by children (product is not a toy).



Keep aerosol products away.



Avoid clothing touching the document/media feed opening.



Avoid hair touching the document/media feed opening.



Use shredder oil only.

This product is classified as protection class II. This means the product is equipped with reinforced or double

insulation between the mains supply circuit and the output voltage or the casing. Therefore it does not require a safety connection to an electrical earth (ground).

For indoor use only.

Alternating current (AC).

Intended Use

- This product is intended for shredding paper, CDs, plastic credit cards and similar materials only. Do not shred greeting cards with sound chips or batteries.
- This product is intended for household use only. It is not intended for commercial use.
- This product is intended to be used in dry indoor areas only.
- No liability will be accepted for damages resulting from improper use or noncompliance with these instructions.

Before First Use

- Check for transport damages.
- Before connecting the product to the power supply, check that the power supply voltage and current rating corresponds with the power supply details shown on the product rating label.

Risk of suffocation! Keep any packaging materials away from children – these materials are a potential source of danger, e.g. suffocation.

Assembly

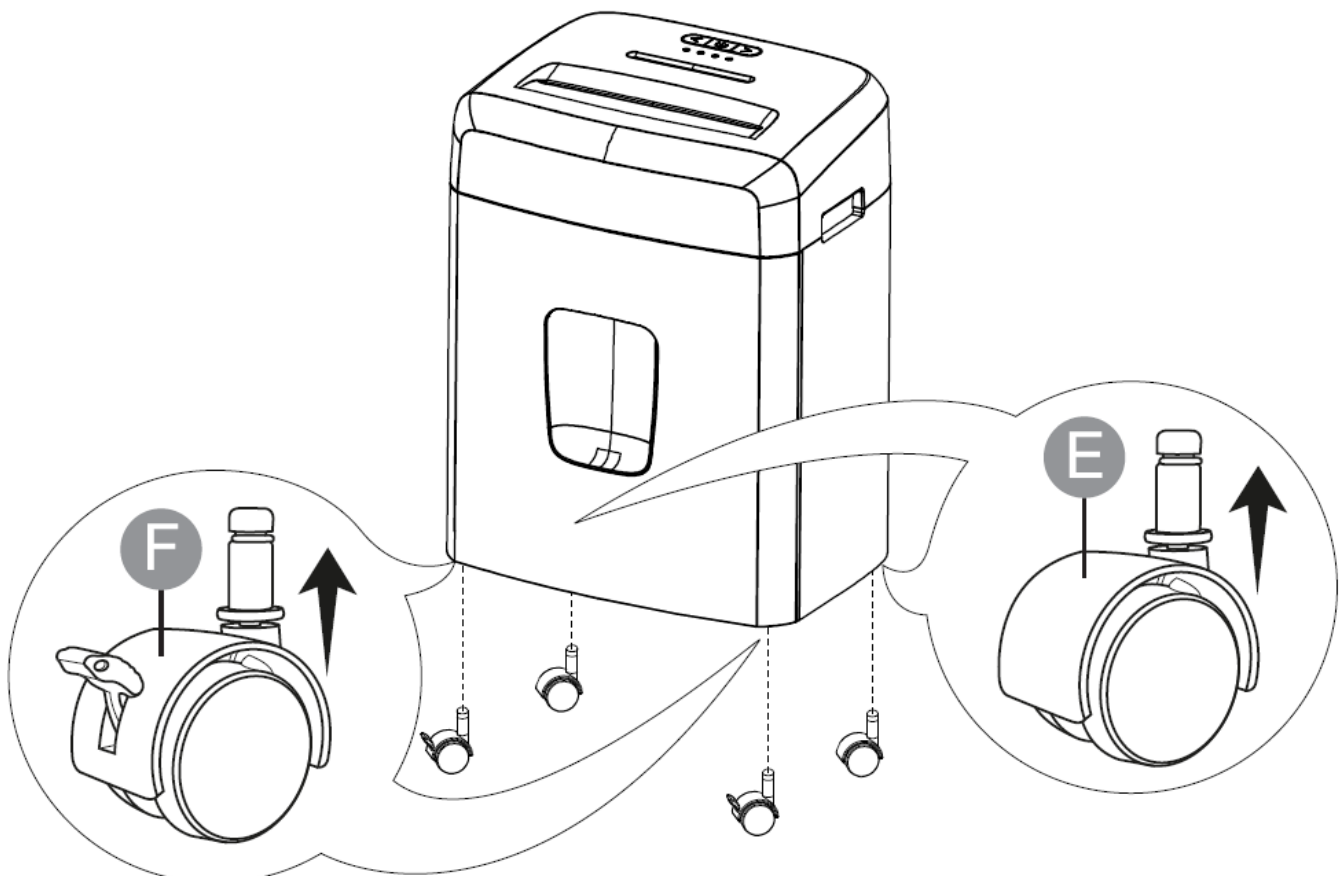

NOTICE The casters with the brakes (F) must be assembled at the front.

Product Placement

NOTICE For proper ventilation, a minimum distance of 5 cm must be maintained behind the product.

- Move the product to the desired position.
- Connect the product to the socket-outlet.
- Activate the brakes by pushing them down.

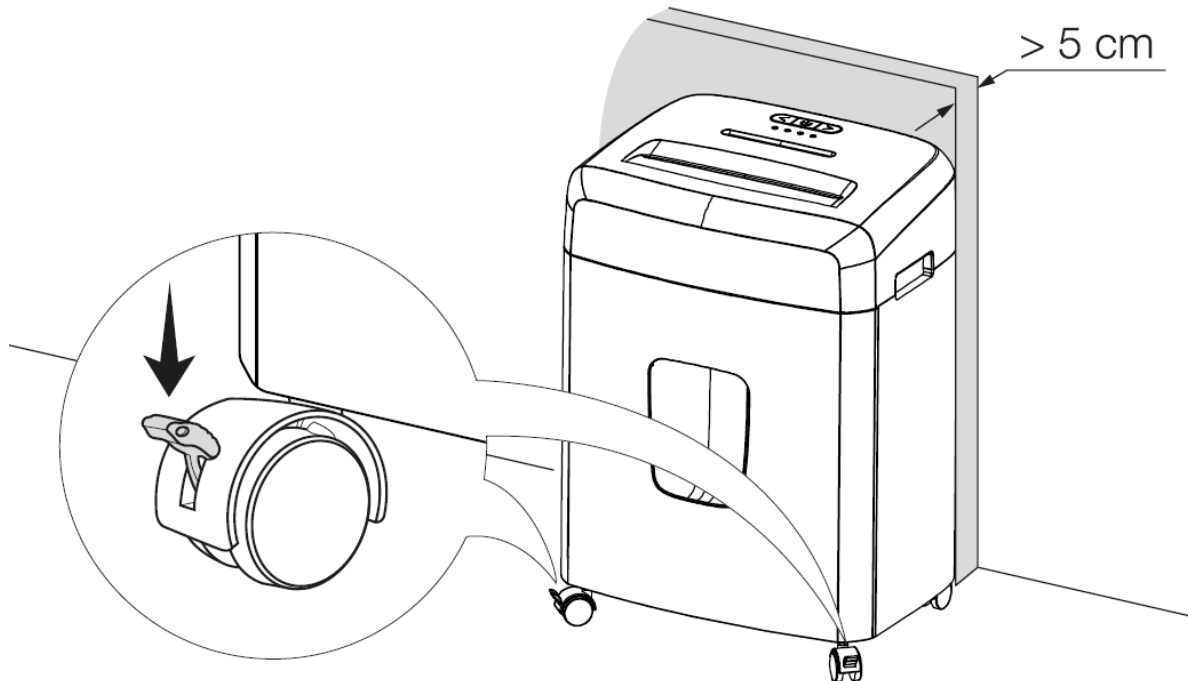

Operation

Switching on/off

- Switching on: Set the on/off switch (C) to I.
- Switching off: Set the on/off switch (C) to 0.

NOTICE Shredder runs briefly after each pass to clear entry. Continuous operation beyond 30 minutes triggers a 10-minute cool down period.

Control panel

- **AUTO:** While in “AUTO” mode, the motor does not start running until paper, CD or card is inserted into the feed slot. Always feed the paper in as straight as possible. When the paper, CD or card has passed through, the motor stops automatically.
When the “AUTO” mode is activated, the button lights up blue. To deactivate the “AUTO” mode, press again.
- **Reverse:** In an unlikely event of a paper jam, the reverse setting can be used to help clear the cutters of material that did not pass through. Before clearing a jam by using the reverse function, empty the paper bin (H).
- **Forward:** The forward setting can also be used to help clear the cutters in the event of a paper jam. It also

allows to manually activate the shredding mode.

Paper/ credit card feed slot

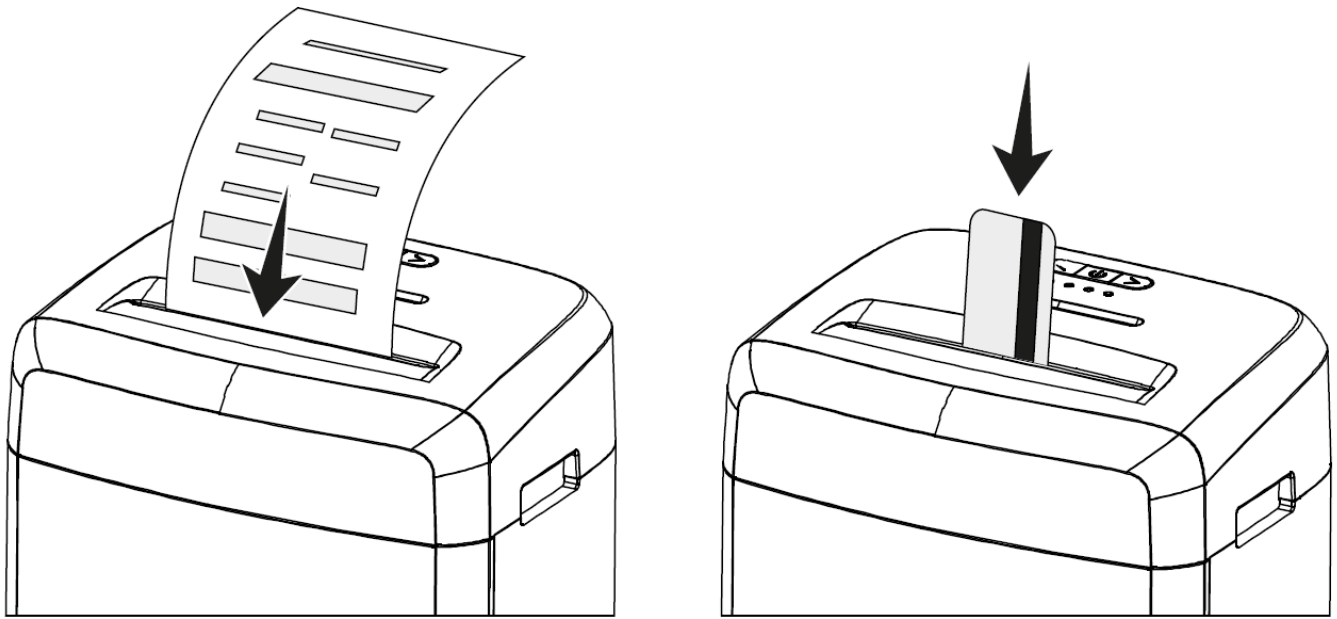

- Do not exceed the sheet count per pass (18 sheets max.). Insert paper as straight as possible into paper/card feed slot (I) and release.
- Insert one card at a time into the middle of the paper/card feed slot (I).

NOTICE

- Always switch off and unplug the product when not in use.
- One folded sheet of paper equates to 2 sheets of paper. Heavier paper, humidity or a supply voltage lower than the rated voltage may reduce shredding capacity.
- This product can shred staples and small paper clips. It is recommended that you remove paper clips whenever possible to extend the lifespan of the product.
- Only shred credit cards by feeding them vertically into the middle of the slot, releasing when shredding begins. Never feed in more than one credit card at a time.

CD feed slot

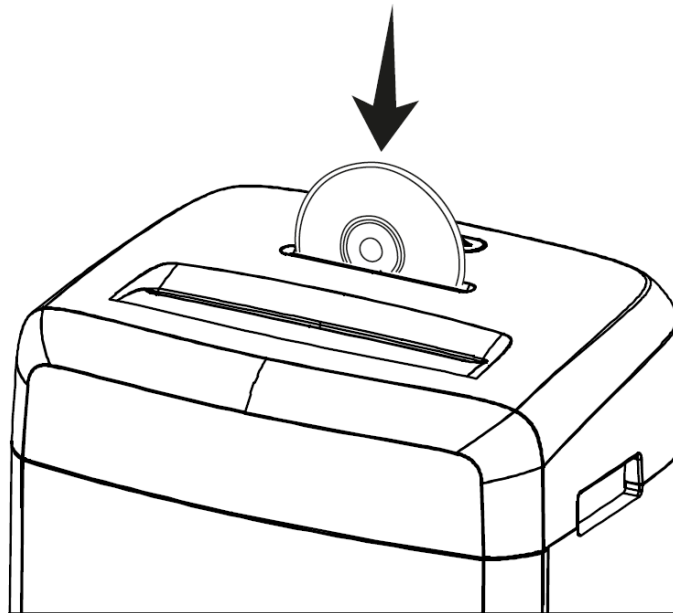

CAUTION Risk of injury! Do not hold CD with finger through the centre ring while feeding into the shredder.

- Never feed in more than one CD at a time.
- Hold a CD by its edge, feed in one at a time and release when shredding begins.

Status Indicators

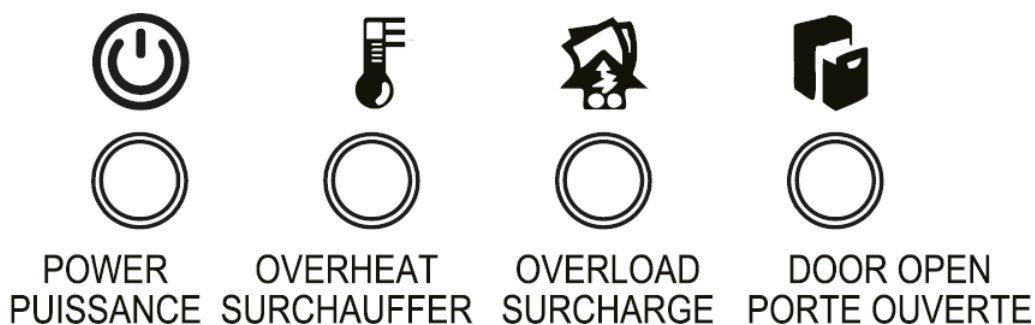

- **POWER:** This indicator goes on when the on/off switch (C) is set to I.
- **OVERHEAT:** This indicator goes on when the product has exceeded its maximum operating temperature and stopped. If this happens, stop using the product but do not switch it off. This allows the fan to accelerate the cooling process. Wait for 10 minutes or longer to cool down before resuming normal operation.
- **OVERLOAD:** This indicator goes on when too much paper has been inserted into a feed slot. The product goes into a "Reverse" mode automatically to withdraw the paper. Pull out manually the batch of paper and reduce the number of sheets.
- **DOOR OPEN:** This indicator goes on when the paper bin (H) is not installed properly. Remove, empty and install the paper bin (H) correctly in place. This product features a safety power cut-off and does not operate if the paper bin (H) is not in place.

Cleaning and Maintenance

WARNING

- Risk of electric shock! To prevent electric shock, unplug before cleaning.
- Risk of electric shock! During cleaning, do not immerse the electrical parts of the product in water or other liquids. Never hold the product under running water.
- Risk of fire or explosion! Do not spray or keep any aerosol products in or around the product.

Cleaning

- To clean, wipe with a soft, slightly moist cloth.
- Dry the product after cleaning.
- Never use corrosive detergents, wire brushes, abrasive scourers, metal or sharp utensils to clean the product.

Maintenance

NOTICE If not oiled, this product may experience diminished shredding capacity, intrusive noise when shredding and could ultimately stop operating. To avoid these problems, we recommend to oil the shredder once a month. Use a dedicated shredder oil only (not provided).

Oiling procedure

- Press the button to switch off the “AUTO” mode. The blue indicator goes off.
- Drizzle some oil on a few sheets of paper and feed those pages through the paper /card feed slot (1).
- Activate the reverse mode for 3-5 seconds.

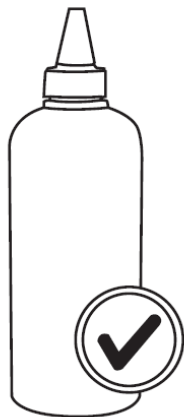

Shredder oil



⚠ WARNING Risk of explosion!

Do not use aerosol/pressurized products.

Troubleshooting

Problem	Possible cause	Solution
The product does not work.	The product is not switched on.	Set the on/off switch (C) to I.
	Motor overheated due to extended operation longer than 30 minutes.	Stop using the product but do not switch it off. This allows the fan to accelerate the cooling process. Wait for 10 minutes or longer to cool down before resuming normal operation.
	Paper bin (H) is not in place.	Remove, empty and install the paper bin (H) correctly in place. This product features a safety power cut-off and does not operate if paper bin (H) is not in place.
	Sensor was not activated.	The sensor of the product is located near the centre of the feed slot. Feed directly into the centre area to activate the motor (especially applies to smaller pieces of paper or credit cards).
The motor is constantly operating while in "AUTO" mode.	The sensor(s) is dirty.	Deactivate the "AUTO" mode. Clean the sensors of both feed slots with a dry cotton swab. The sensors are located near the centre of the feed slot.
The product runs in "Reverse" mode but not in "AUTO" or "Forward" mode.	The feed slot is jammed.	Deactivate the "AUTO" mode. Activate the "Reverse" mode to eject the paper. Spread and loosen the paper with a thicker piece of paper. Activate the "Forward" mode to shred the paper again. For situations where "Reverse" mode does not help, loosen the jammed paper with shredder oil. Drizzle some oil into the feed slot where the paper is jammed. Let it soak for about 30 minutes and repeat the procedure.

Polarized Plug

This appliance has a polarized plug (one blade is wider than the other). To reduce the risk of electric shock, this plug will fit outlet only one way. If the plug does not fit fully in the outlet, reverse the plug. If it still does not fit, contact a qualified electrician. Do not modify the plug in any way.

FCC – Supplier's Declaration of Conformity

Unique Identifier	B07R3FXLLQ – 18-Sheet Cross-Cut Paper, CD, and Credit Card Shredder
Responsible Party	Amazon.com Services, Inc
U.S. Contact Information	410 Terry Ave N. Seattle, WA 98109, United States
Telephone Number	(206) 266-1000

FCC Compliance Statement

1. This device complies with Part 15 of the FCC rules. Operation is subject to the following two conditions: (1) this device may not cause harmful interference, and (2) this device must accept any interference received, including interference that may cause undesired operation.
2. Changes or modifications not expressly approved by the party responsible for compliance could void the user's authority to operate the equipment.

FCC Interference Statement

This equipment has been tested and found to comply with the limits for a Class B digital device, pursuant to part 15 of the FCC Rules. These limits are designed to provide reasonable protection against harmful interference in a residential installation. This equipment generates, uses and can radiate radio frequency energy and, if not installed and used in accordance with the instructions, may cause harmful interference to radio communications. However, there is no guarantee that interference will not occur in a particular installation. If this equipment does cause harmful interference to radio or television reception, which can be determined by turning the equipment off and on, the user is encouraged to try to correct the interference by one or more of the following measures:

- Reorient or relocate the receiving antenna.
- Increase the separation between the equipment and receiver.
- Connect the equipment into an outlet on a circuit different from that to which the receiver is connected.
- Consult the dealer or an experienced radio/TV technician for help.

Canada IC Notice

This Class B digital apparatus complies with Canadian CAN ICES-3(B) / NMB-3(B) standard.

Specifications

Model number:	C218-A
Rated voltage/ frequency:	120 V~, 60 Hz, 5.0 A
Rated power consumption:	500 W
Noise emission:	65 dB
Power @standby mode:	0.49 W
Paper capacity:	18 sheets of 20 lb (75 g/m ²) paper *
Paper shredder slot:	approx. 0.16 x 1.37" (4 x 35 mm) pieces
Credit card capacity:	1 at a time
CD capacity:	1 at a time
Paper bin volume:	approx. 6 gal (23 l)

*One folded sheet of paper equates to 2 sheets of paper.

Warranty Information

To obtain a copy of the warranty for this product: [amazon.com/AmazonBasics/Warranty](https://www.amazon.com/AmazonBasics/Warranty)

+1-066-216-1012

Feedback and Help

Love it? Hate it? Let us know with a customer review.

AmazonBasics is committed to delivering customer-driven products that live up to your high standards. We encourage you to write a review sharing your experiences with the product.

- [amazon.com/review/review-your-purchases#](https://www.amazon.com/review/review-your-purchases#)
- [amazon.com/gp/help/customer/contact-us](https://www.amazon.com/gp/help/customer/contact-us)

Documents / Resources

	<p>amazon basics B07R3FXLLQ 18 Sheet Cross Cut Paper CD and Credit Card Shredder [pdf] User Manual</p> <p>B07R3FXLLQ 18 Sheet Cross Cut Paper CD and Credit Card Shredder, B07R3FXLLQ, 18 Sheet Cross Cut Paper CD and Credit Card Shredder, Paper CD and Credit Card Shredder, Credit Card Shredder</p>
---	--

References

- [User Manual](#)