



## amazon basics B07L9F39DV 3 Tier Metal Rolling Cart Instruction Manual

[Home](#) » [amazon basics](#) » amazon basics B07L9F39DV 3 Tier Metal Rolling Cart Instruction Manual 

# amazon basics

B07L9F39DV 3 Tier Metal Rolling Cart  
Instruction Manual



**3-Tier Metal Rolling Cart**

## Contents

- [1 Tools Needed](#)
- [2 IMPORTANT SAFEGUARDS](#)
- [3 Before First Use](#)
- [4 Cleaning and Maintenance](#)
- [5 Specifications](#)
- [6 Feedback and Help](#)
- [7 Assembly](#)
- [8 Documents / Resources](#)
- [9 Related Posts](#)

## Tools Needed

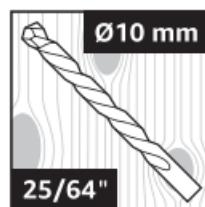
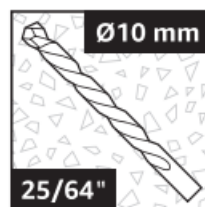
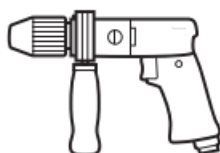
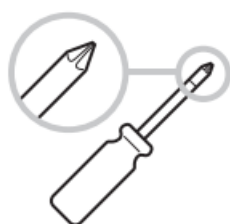

petivery Content

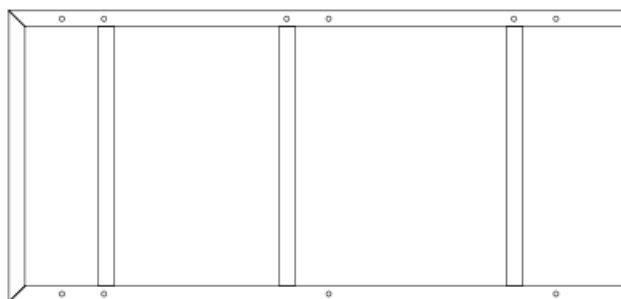

**A (x 2)**

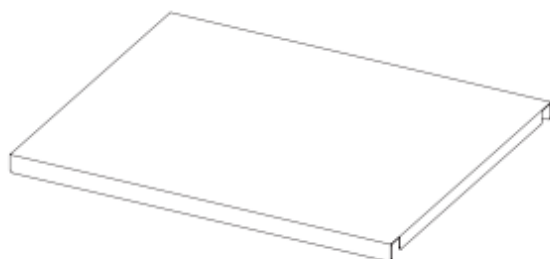

**B (x 3)**



**C (x 9)**



**D (x 2)**



**E (x 2)**



**F (x 18)**



**G1 (x 1)**



**G2 (x 1)**



**G3 (x 1)**



**G4 (x 1)**



**G5 (x 1)**

## IMPORTANT SAFEGUARDS



Read these instructions carefully and retain them for future use. If this product is passed to a third party, then these instructions must be included.

When using the product, basic safety precautions should always be followed to reduce the risk of injury including the following:

- Do not let children climb on or play with the product.
- This product must be assembled by competent adults.
- Always use on a firm level ground.
- Do not sit or hang on the product.
- Check to ensure that all components and fixings of this product are secure, do not use if you have any doubts

about its fitness for purpose.

- To avoid scratching the floor, assemble the product on a soft surface such as a carpet.
- Load the product evenly and place the heaviest items on the lowest platform.

## Before First Use

Check for transport damages.

 **DANGER** Risk of suffocation! Keep any packaging materials away from children these materials are a potential source of danger, e.g. suffocation.

## Cleaning and Maintenance

### 3.1 Cleaning

- To clean, wipe with a soft, slightly moist cloth.
- Never use corrosive detergents, wire brushes, abrasive scourers, metal or sharp utensils to clean the product.

### 3.2 Maintenance

- Check the components regularly to make sure all screws and bolts are tightened.
- Store in a cool and dry place away from children and pets, ideally in original packaging.
- Avoid any vibrations and shocks.

## Specifications

Dimensions (W x H x D):	approx. 48.5 x 75 x 35 cm (19 x 29.5 x 13.8 in)
Loading capacity:	approx. 7.1 kg (15.7 lbs)
Net weight:	approx. 9 kg (20 bs) per platform approx. 27 kg (60 bs) in total

### 4.1 Importer Information

#### For EU

Postal:	Amazon EU S.a r.l, 38 avenue John F. Kennedy, L-1855 Luxembourg
Business Reg.:	134248

#### For UK

Postal:	Amazon EU SARL, UK Branch, 1 Principal Place, Worship St, London EC2A 2FA, United Kingdom
Business Reg.:	BR017427

## Feedback and Help

We would love to hear your feedback. To ensure we are providing the best customer experience possible, please consider writing a customer review.

Scan QR Code below with your phone camera or QR reader:

us:



[https://www.amazon.com/review/review-your-purchases/listing/?ref=HPB\\_UM\\_CR](https://www.amazon.com/review/review-your-purchases/listing/?ref=HPB_UM_CR)



uk: [amazon.co.uk/review/review-your-purchases#](https://www.amazon.co.uk/review/review-your-purchases#)

If you need help with your Amazon Basics product, please use the website or number below.



US: [amazon.com/gp/help/customer/contact-us](https://www.amazon.com/gp/help/customer/contact-us)

UK: [amazon.co.uk/gp/help/customer/contact-us](https://www.amazon.co.uk/gp/help/customer/contact-us)



[ +1877-485-0385 (US Phone Number)



**Assembly**

**Attention:** Do not tighten the screws until you have completed setup assembly.

**1**



**A (x 2)**



**C (x 9)**



**F (x 18)**

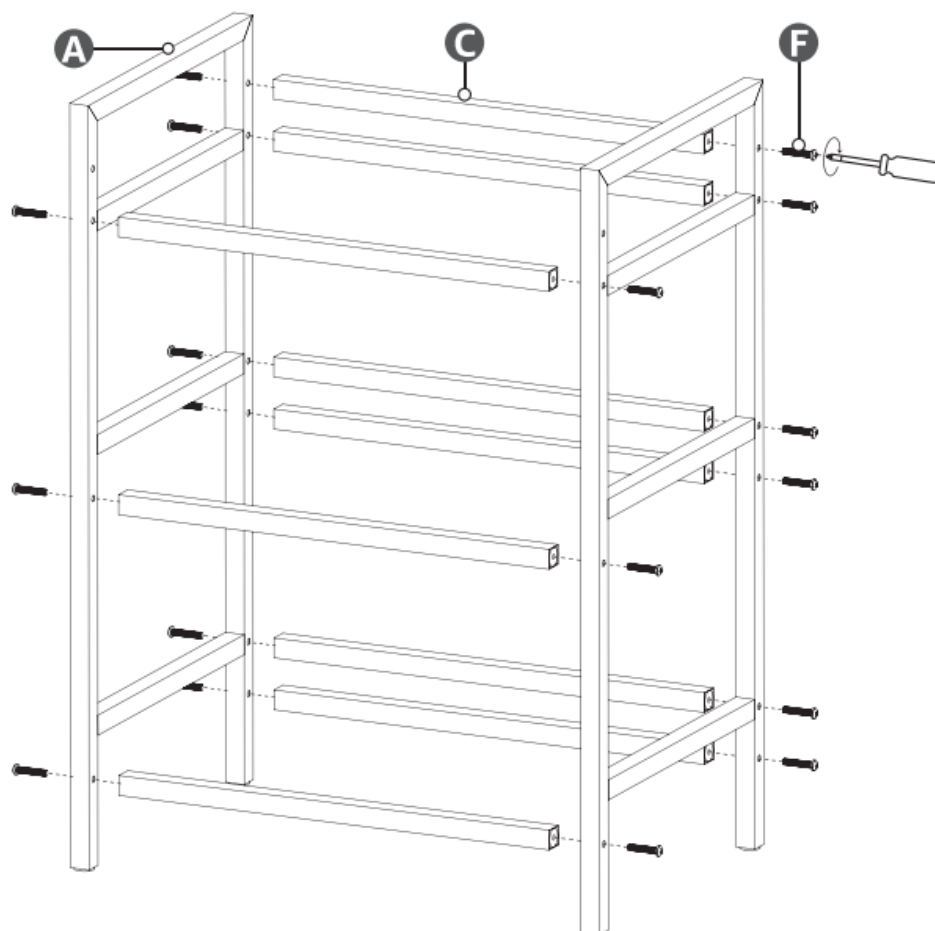

**2**

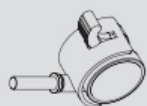

**D (x 2)**

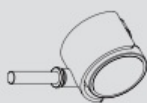

**E (x 2)**

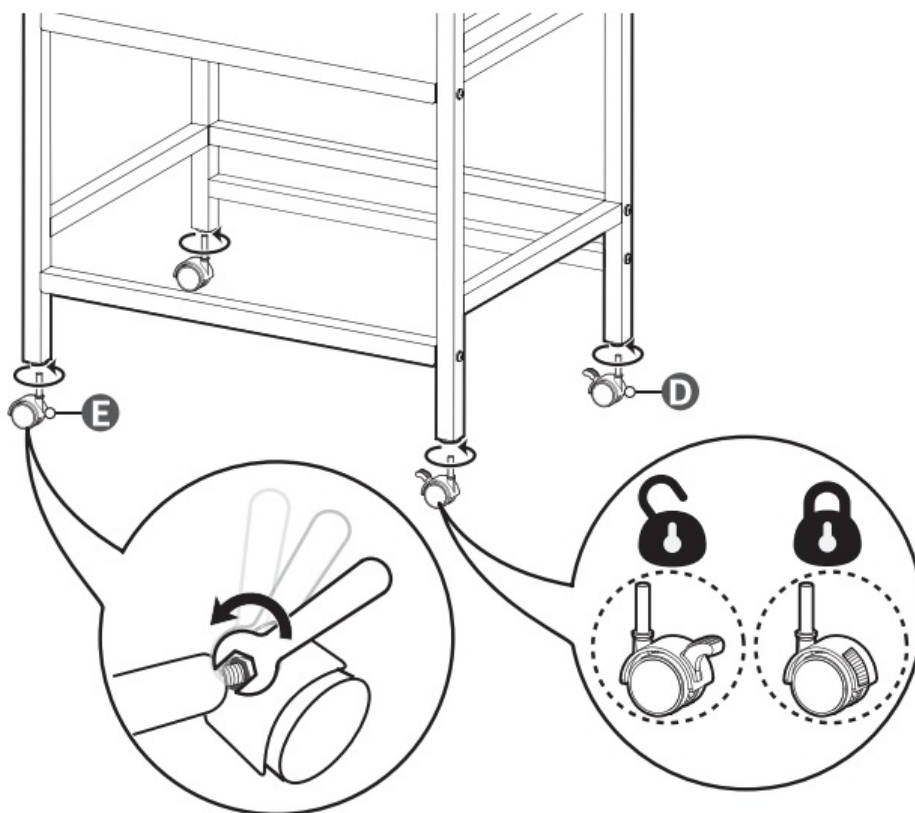

**3**



**B (x 3)**

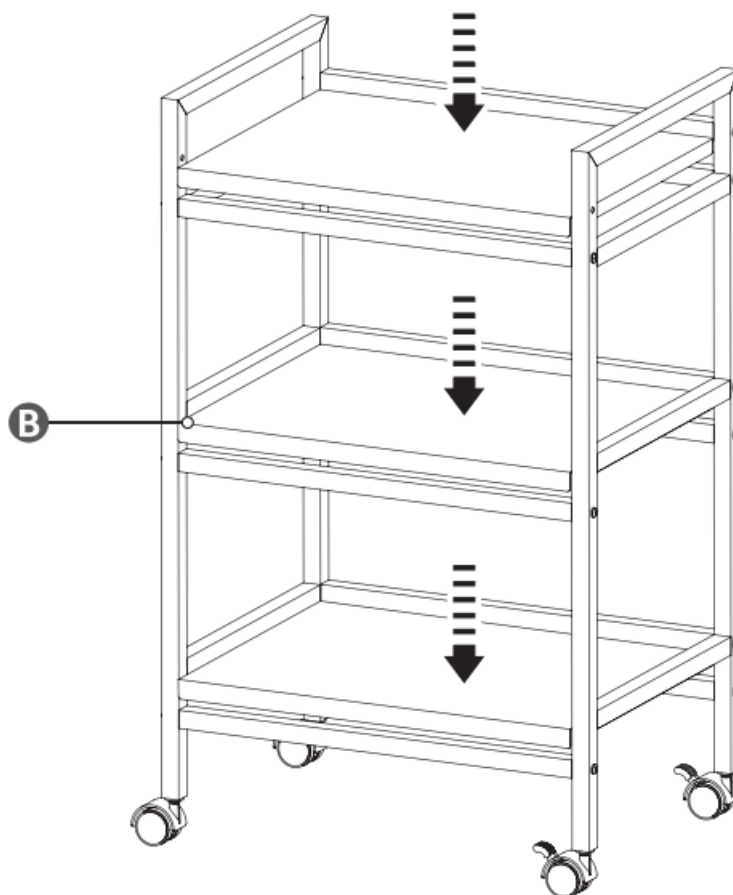

**Concrete/plasterboard wall**

**4A**

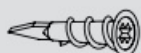

**G3 (x 1)**

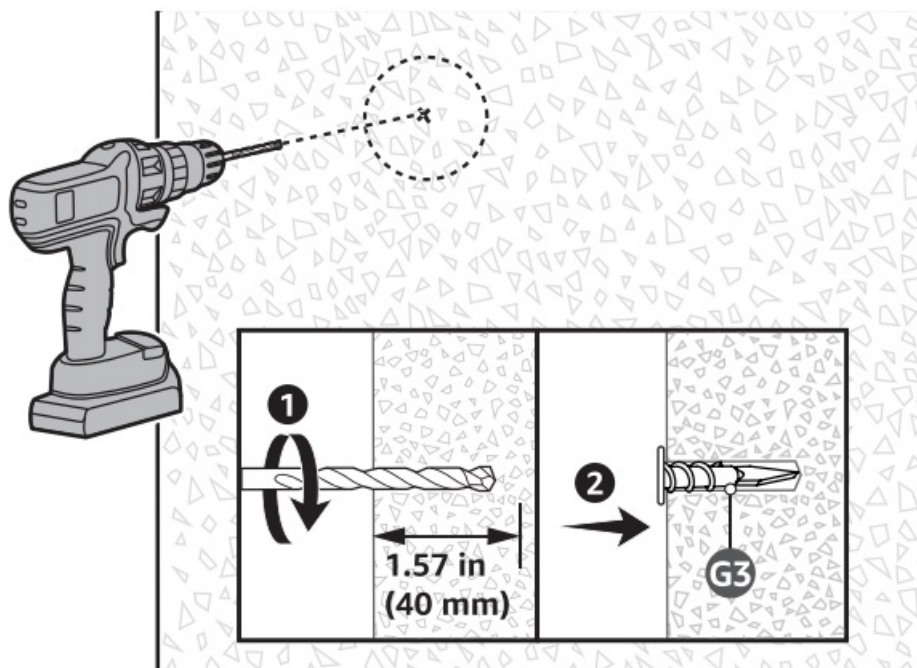



**4B**



**G1 (x 1)**



**G2 (x 1)**



**G4 (x 1)**

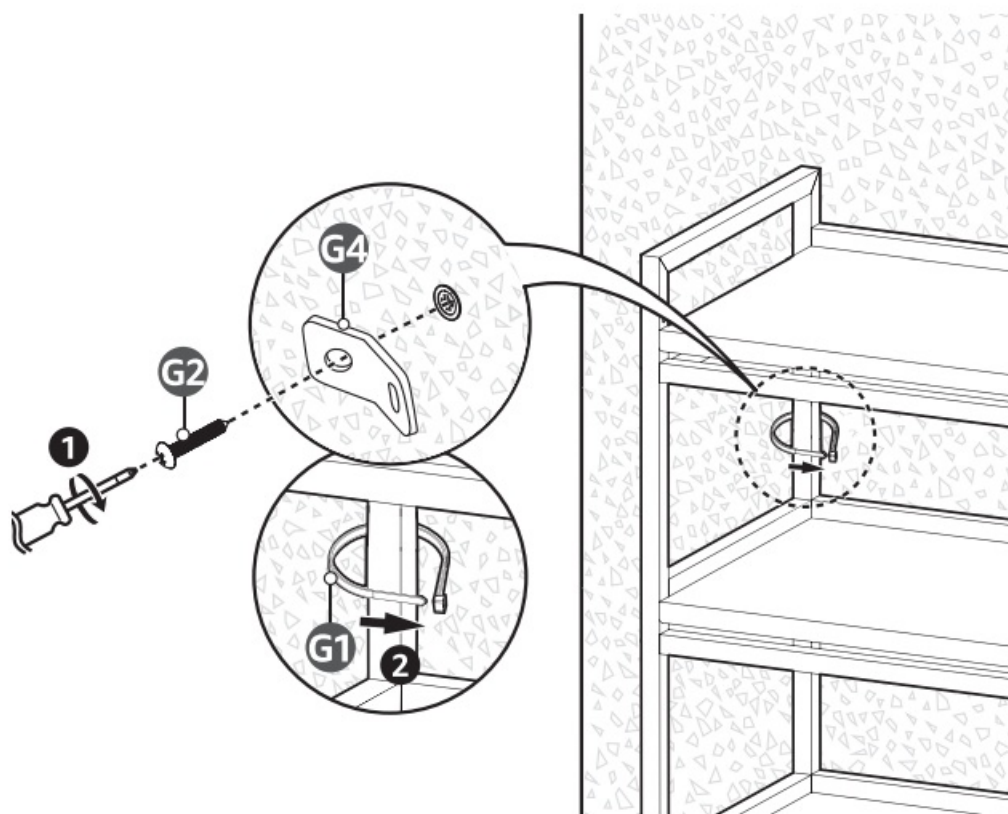

## Wooden Wall

**5**



**G1 (x 1)**



**G5 (x 1)**



**G4 (x 1)**

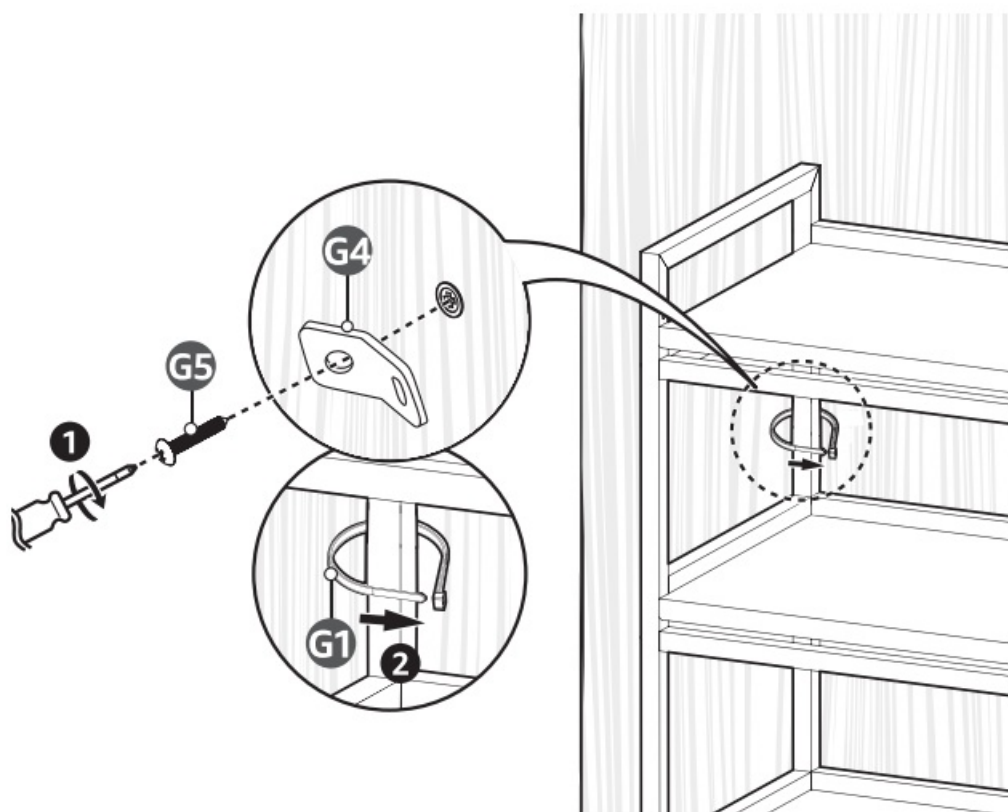

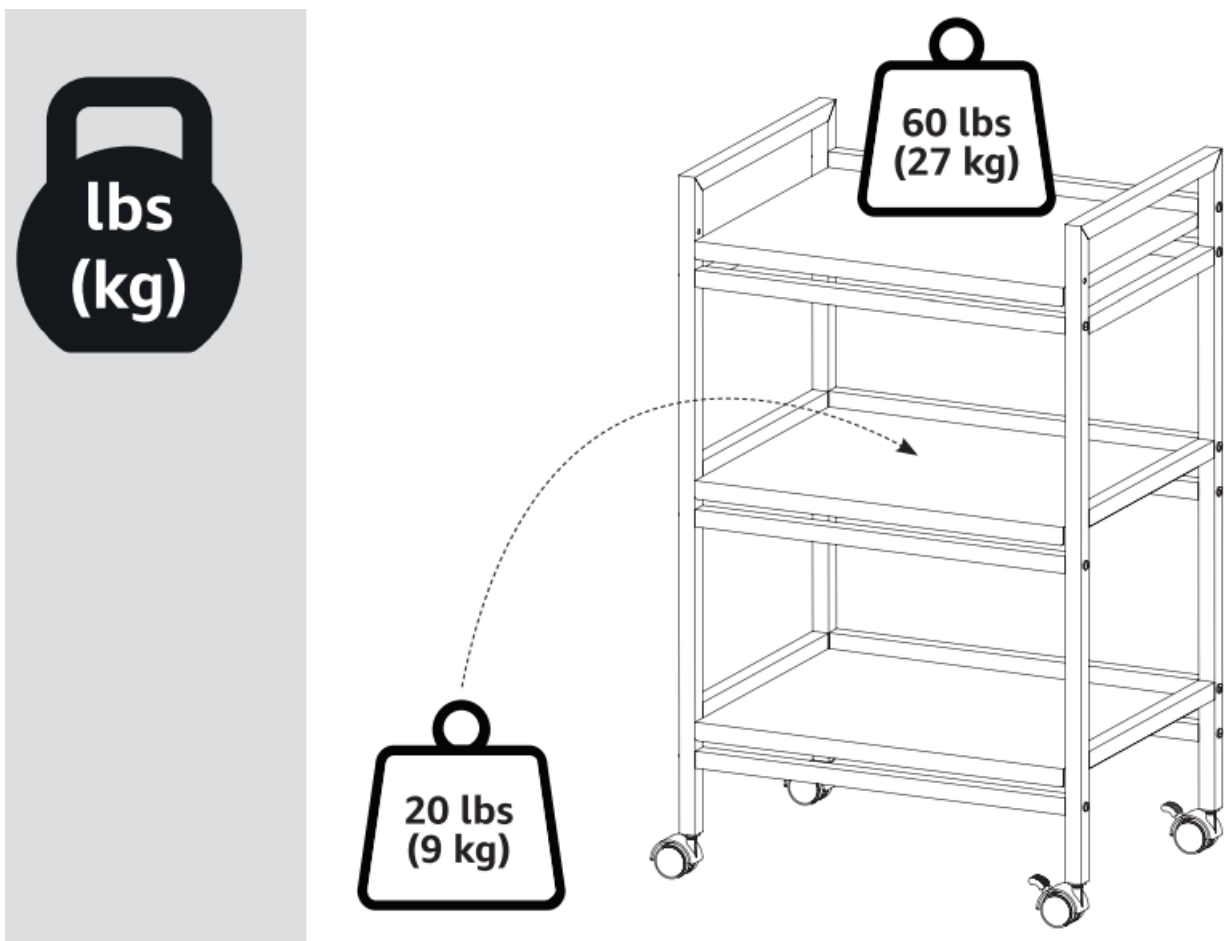

**amazon basics**

[amazon.com/AmazonBasics](https://amazon.com/AmazonBasics)

MADE IN CHINA

V06-07/23

---

**Documents / Resources**

