



## amazon basics B07L9BVBCJ 2 Tier Stackable Shelf Instruction Manual

[Home](#) » [amazon basics](#) » amazon basics B07L9BVBCJ 2 Tier Stackable Shelf Instruction Manual 

### Contents

- [1 amazon basics B07L9BVBCJ 2 Tier Stackable Shelf](#)
- [2 IMPORTANT SAFEGUARDS](#)
- [3 Before First Use](#)
- [4 Cleaning and Maintenance](#)
- [5 Specifications](#)
- [6 Contents](#)
- [7 Installation Instructions](#)
- [8 Contact](#)
- [9 Documents / Resources](#)
  - [9.1 References](#)



amazon basics B07L9BVBCJ 2 Tier Stackable Shelf



## **IMPORTANT SAFEGUARDS**

Read these instructions carefully and retain them for future use. If this product is passed to a third party, then these instructions must be included.

When using the product, basic safety precautions should always be followed to reduce the risk of injury including the following:

- Do not let children climb on or play with the product.
- This product must be assembled by competent adults.
- Always use on a firm, level ground.
- Do not sit or hang on the product.
- Check to ensure that all components and fixings of this product are secure, do not use it if you have any doubts about its fitness for purpose.
- To avoid scratching the floor, assemble the shelving unit on a soft surface such as a carpet.

## **Before First Use**

- Check for transport damages
- For assembly of two sets of this product into a 4-Tier shelf, refer to the section "Assembly (2 sets)".
- A DaNGER Risk of suffocation! Keep any packaging materials away from children these materials are a potential source of danger, e.g. suffocation.

## **Cleaning and Maintenance**

### **Cleaning**

- To clean, wipe with a soft, slightly moist cloth.

- Never use corrosive detergents, wire brushes, abrasive scourers, or metal or sharp utensils to clean the product.



## **Maintenance**

- Store the colanders race away from moisture, dust, and oil or tightened packaging.
- Avoid any vibrations and shocks.

## **Specifications**

- **Dimensions (W x H x D):** approx. 23.2 x 22 x 13.4 in (59 x 56 x 34 cm)
- **Net weight:** approx. 8.7 lbs (3,93 kg)
- **Loading capacity (whole unit):** approx. 400 lbs (181,6 kg)
- **Loading capacity (each shelf):** approx. 200 lbs (90,8 kg)

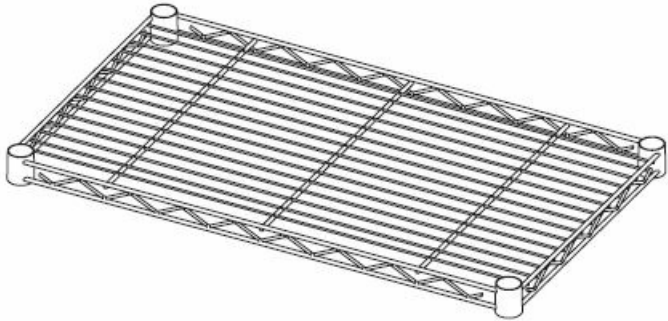
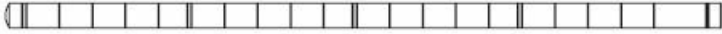
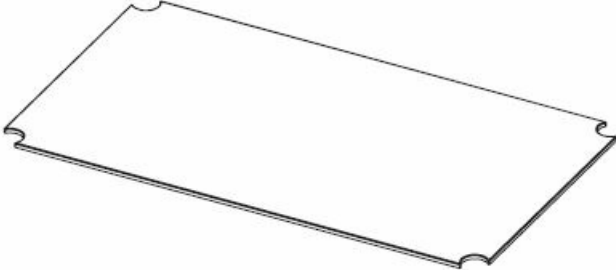
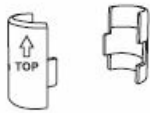
## **Contents**

A		x2
B		x4
C		x1
D		x8 +1
E		x2

## Installation Instructions

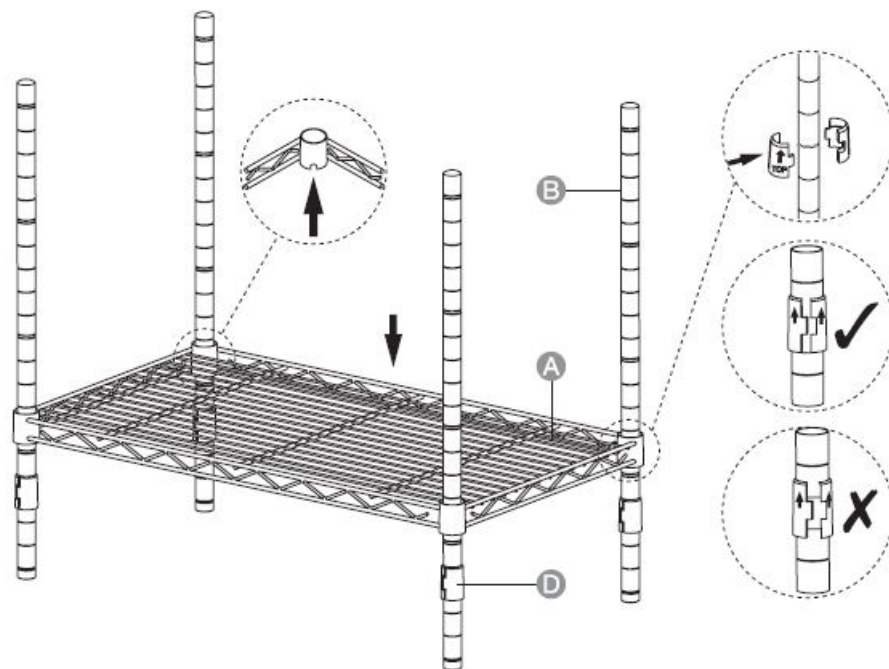

2:

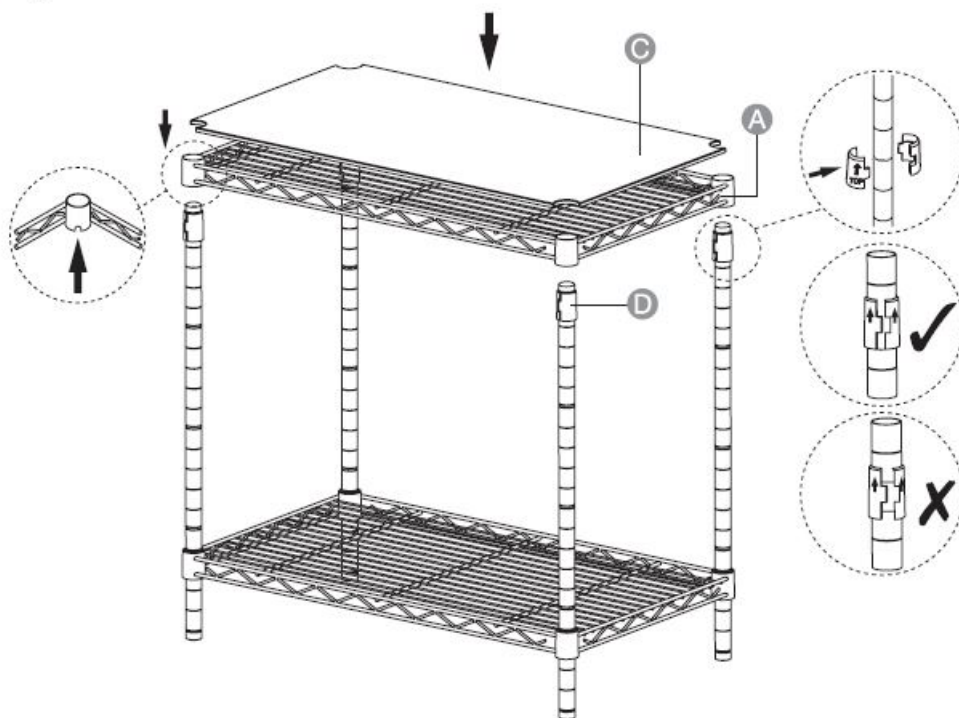

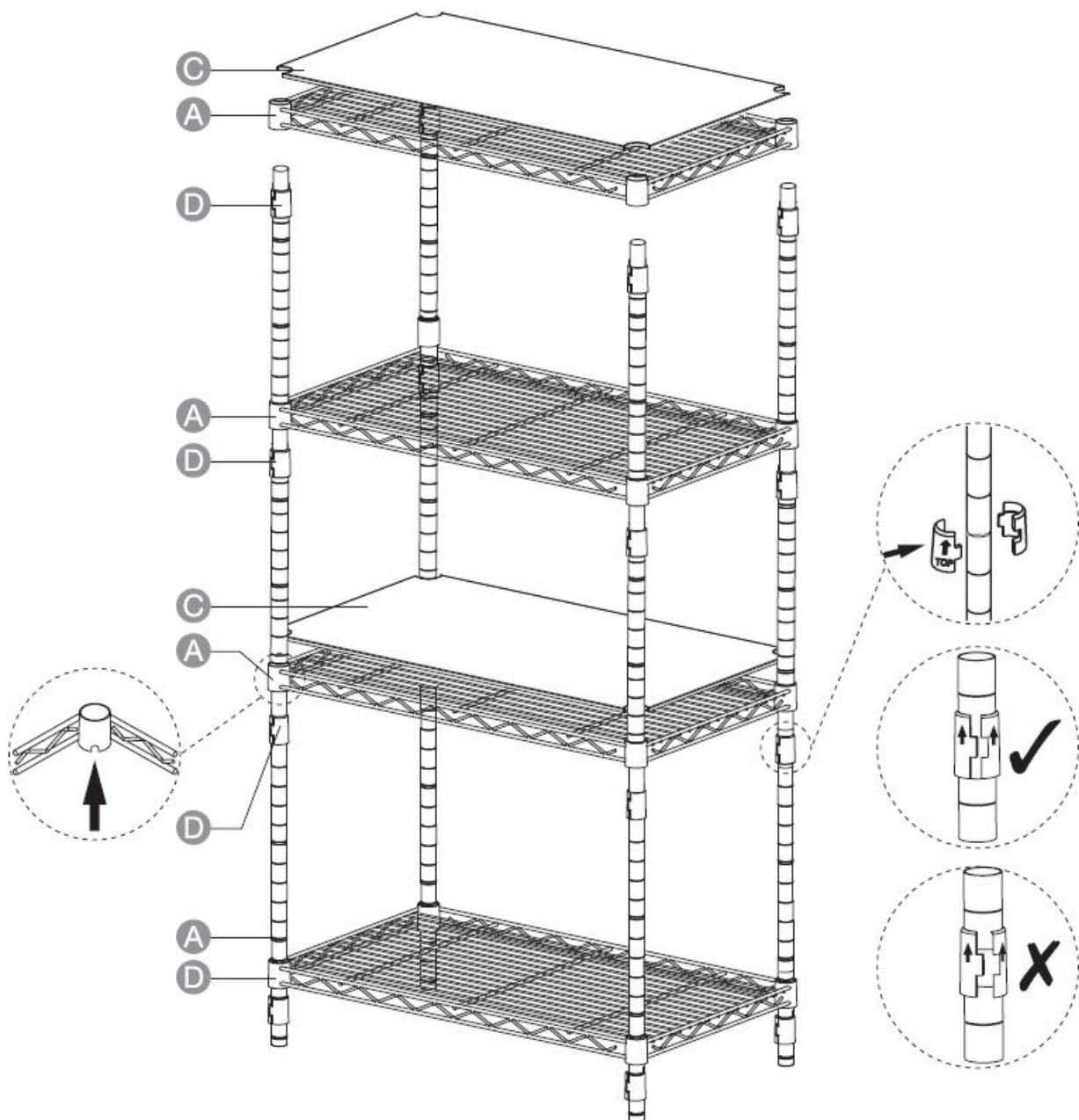
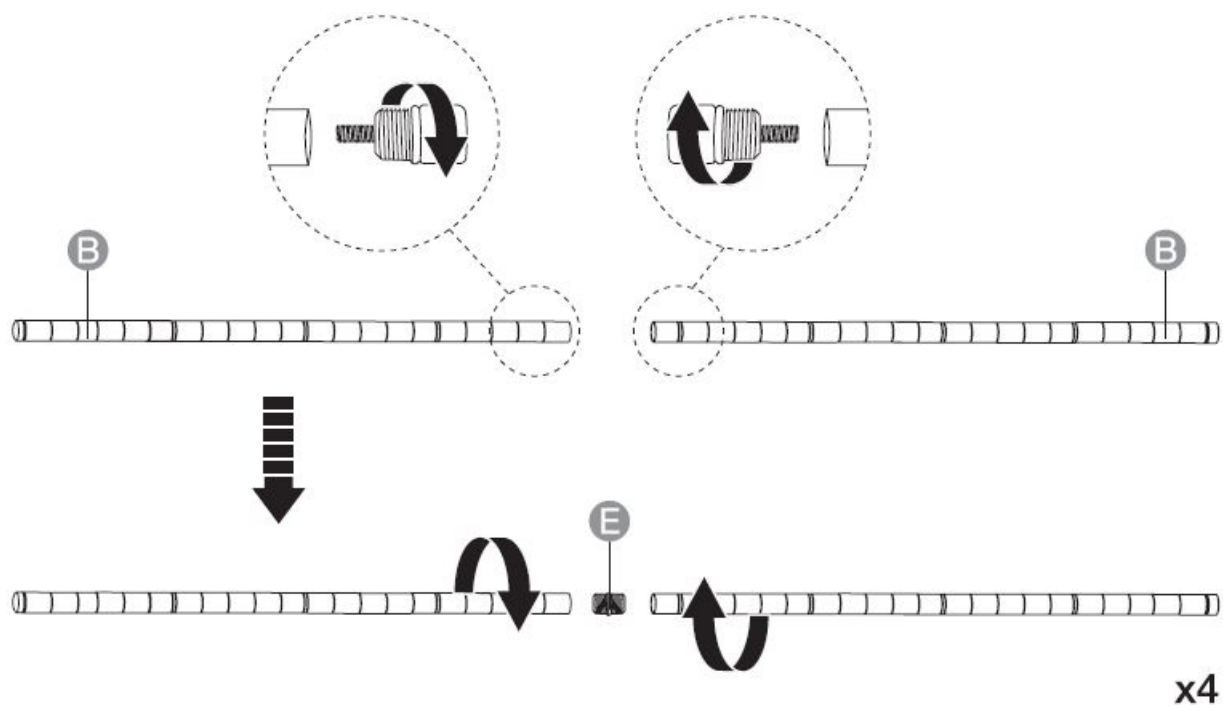

## Feedback and Help

Love it? Hate it? Let us know with a customer review.

AmazonBasics is committed to delivering customer-driven products that live up to your high standards. We encourage you to write a review sharing your experiences with the product.

- US: [amazon.com/review/review-your-purchases#](https://amazon.com/review/review-your-purchases#).
  - UK: [amazon.co.uk/review/review-your-purchases#](https://amazon.co.uk/review/review-your-purchases#).
  - US: [amazon.com/gp/help/customer/contact-us](https://amazon.com/gp/help/customer/contact-us).
  - UK: [amazon.co.uk/gp/help/customer/contact-us](https://amazon.co.uk/gp/help/customer/contact-us).
  - [amazon.com/AmazonBasics](https://amazon.com/AmazonBasics).
- 

## Documents / Resources

 <p>amazon basics</p> <p>2 Tier Stackable Shelf Dimensions: 18.5" x 11.5" x 11.5" Weight Capacity: 150 lbs Material: Steel Color: Black B07L9BVBCJ</p>	<p><a href="#">amazon basics B07L9BVBCJ 2 Tier Stackable Shelf</a> [pdf] Instruction Manual B07L9BVBCJ 2 Tier Stackable Shelf, B07L9BVBCJ, 2 Tier Stackable Shelf, Tier Stackable Shelf, Stackable Shelf, Shelf</p>
---	---

## References

- [a Amazon.com: Amazon Basics](#)
- [a Amazon Sign In](#)
- [a Amazon Sign In](#)
- [a Amazon Sign In](#)
- [a Amazon Iniciar sesión](#)
- [a Amazon Iniciar sesión](#)
- [a Amazon Sign-In](#)
- [a Amazon Sign-In](#)
- [a Amazon.de](#)
- [a Amazon.es](#)
- [a Connexion Amazon](#)
- [a Connexion Amazon](#)
- [a Amazon Accedi](#)
- [a Amazon Accedi](#)
- [a Amazon.co.jp](#)
- [a Inloggen bij Amazon](#)
- [a Amazon Inloggning](#)
- [a Amazon.co.jp](#)
- [User Manual](#)

