

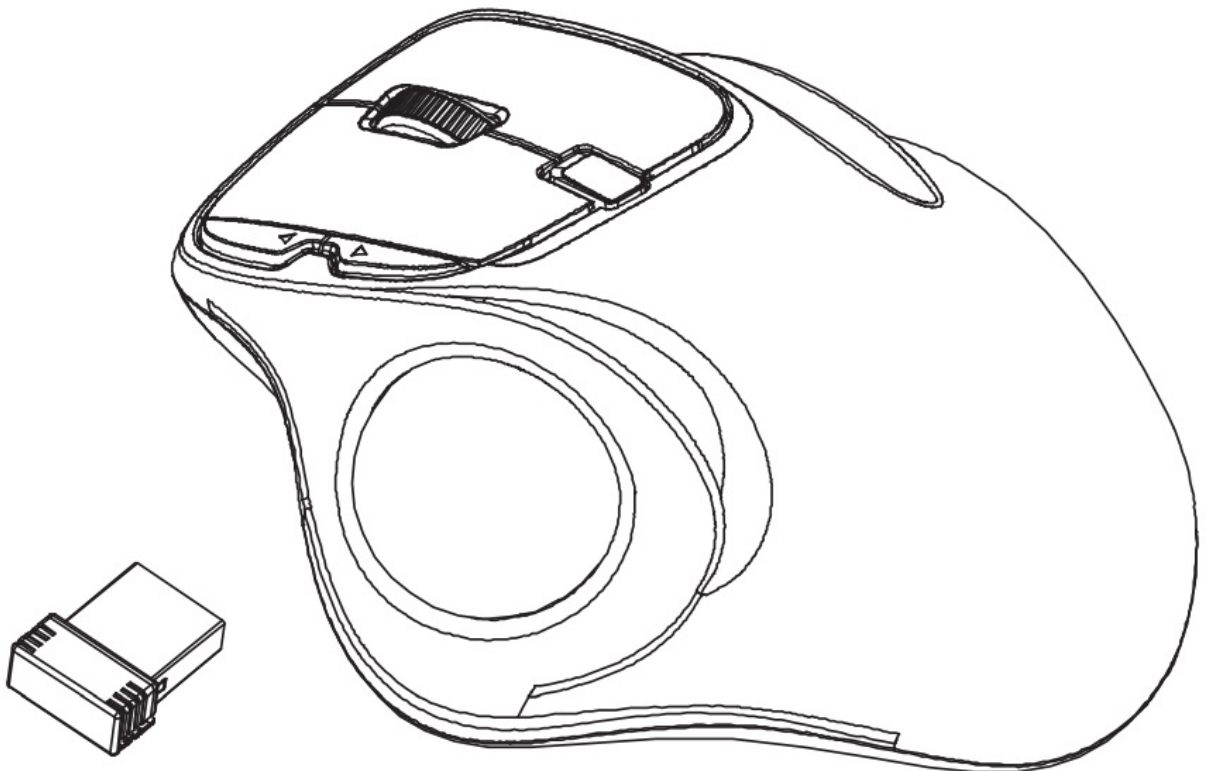

amazon basics B07G28NF3L Wireless Trackball Mouse Instruction Manual

[Home](#) » [amazon basics](#) » amazon basics B07G28NF3L Wireless Trackball Mouse Instruction Manual 

amazon basics B07G28NF3L Wireless Trackball Mouse



Contents

- 1 Contents
- 2 IMPORTANT SAFEGUARDS
- 3 Setup
- 4 Pairing
- 5 Operation
- 6 Cleaning and Maintenance
- 7 FCC- Supplier's Declaration of Conformity
- 8 Canada IC Notice
- 9 Simplified EU Declaration of Conformity
- 10 Disposal
- 11 Battery Disposal
- 12 Specifications
- 13 Warranty Information
- 14 Feedback and Help
- 15 Customers Support
- 16 Documents / Resources
 - 16.1 References
- 17 Related Posts

Contents

Before getting started, ensure the package contains the following components:

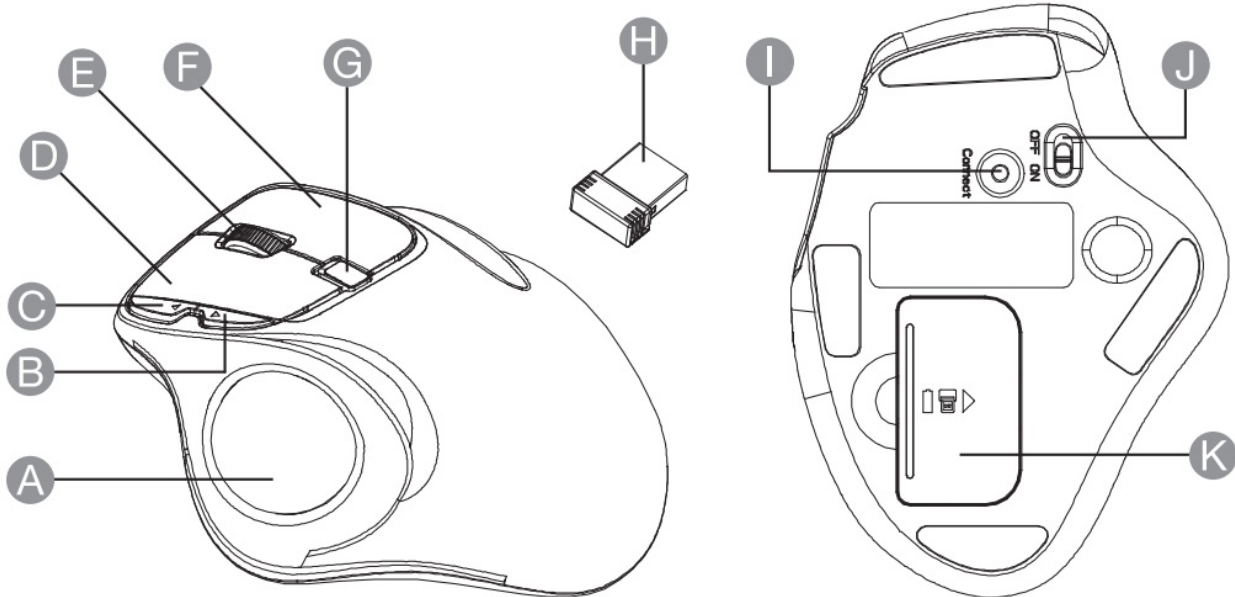

- A. Track ball
- B. Backward
- C. Forward
- D. Left button
- E. Scroll wheel
- F. Right button
- G. DPI button / LED indicator
- H. Nano receiver
- I. Connect button
- J. ON/OFF switch
- K. Battery cover

IMPORTANT SAFEGUARDS



Read these instructions carefully and retain them for future use. If this product is passed to a third party, then these instructions must be included.

When using electrical appliances, basic safety precautions should always be followed to reduce the risk of fire, electric shock, and/ or injury to persons including the following:

- Read all instructions.
- Only use this product for its intended use .

Battery Warnings

- Exhausted batteries should be immediately removed from product and properly disposed.
- Keep batteries out of the reach of children.
- Do not dispose of batteries in fire.
- Remove battery from product if it is not to be used for an extended period of time unless it is for emergency purposes.
- If the battery leaks avoid contact with skin and eyes. Rinse affected areas immediately with plenty of clean water, then consult a doctor.

Before First Use

- Check for transport damages.



Risk of suffocation! Keep any packaging materials away from children – these materials are a potential source of danger, e.g. suffocation.

Setup

Installing the Battery

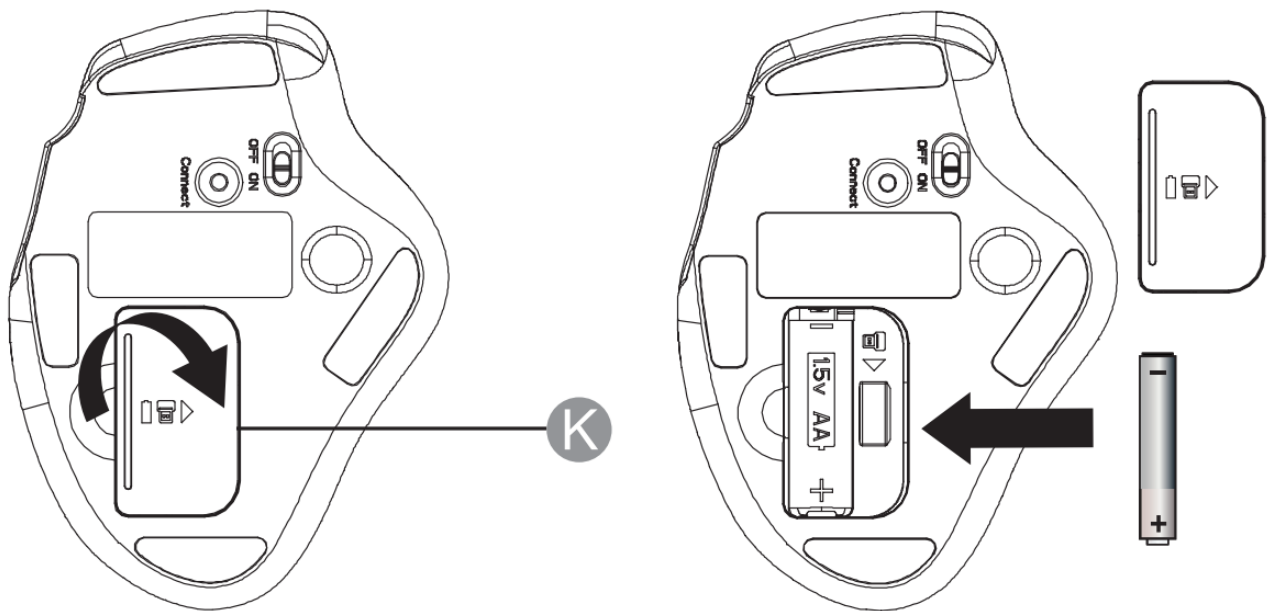

- Remove the battery cover (K).
- Insert the battery correctly with regard to polarity(+ and-) marked on the battery and the product.
- Place the cover back over the battery compartment.

NOTICE

Replace the battery, when the LED indicator (G) blinks for 10 seconds.

Pairing

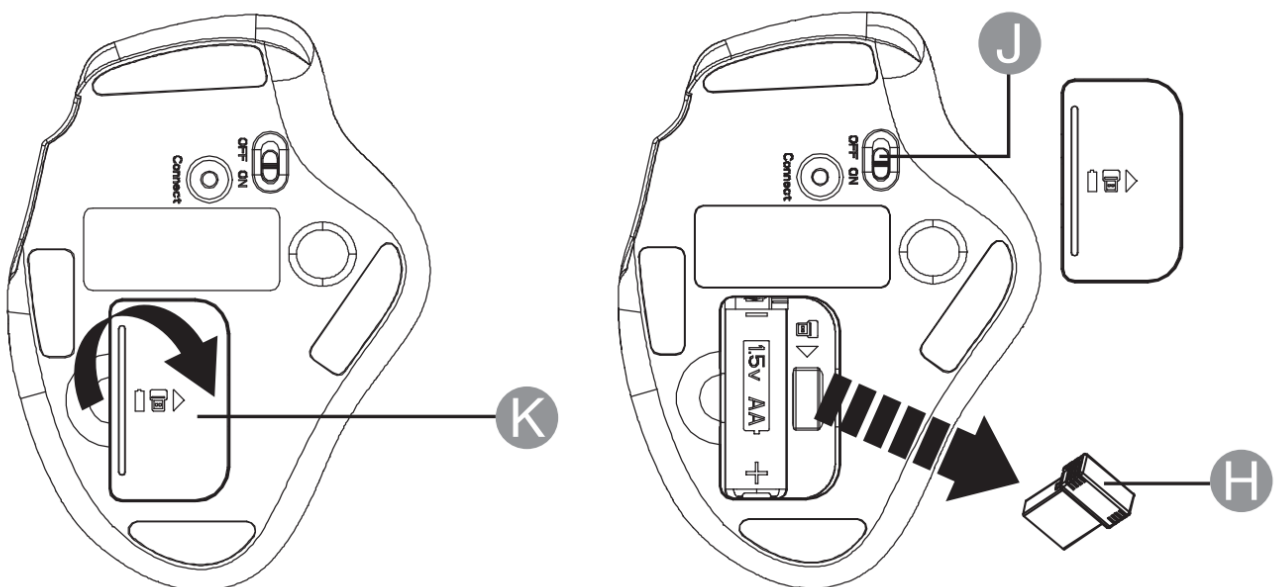

- Remove the battery cover (K) and take the nano receiver (H) out.
- Plug the nano receiver into the USB port on your computer.
- Set the ON/OFF switch (J) on the bottom side of the mouse to ON.
- The LED indicator (G) flashes steadily when the product is in pairing mode and stops blinking when it is successfully paired with the receiver.

NOTICE

The receiver has an auto pairing function. If the connection between the mouse and the receiver fails or is interrupted, proceed as follows:

- Remove the nano receiver from the computer's USB port and plug it back in. Press the Connect button (I) at the bottom of the mouse.
- If the product does not work after 10 seconds, pair it again.

Operation

Track ball (A)

- Spin the trackball to move the cursor on the computer screen.

DPI button / LED indicator (G)

- The LED indicator blinks steadily:
The mouse is pairing. The LED indicator turns off after pairing successfully.
- The LED indicator flashes for 10 seconds: Low battery warning.
- The LED indicator also indicates the DPI setting in use. There are 3 different settings:

Blink 1: 600 DPI

Blink 2: 800 DPI

Blink 3: 1000 DPI

The default setting is 800 DPI . Press the DPI button to switch between the settings. In order to save power, the LED switches off after 10 seconds.

Forward button (C)

- Press this button to view the next page in your Internet browser.

Backward button (B)

- Press this button to view the previous page in your Internet browser.

Forward button (C)

- Press this button to view the next page in your Internet browser.

Backward button (B)

- Press this button to view the previous page in your Internet browser.

Left button (D)

- Left click function according to your computer system settings.

Right button (F)

- Right click function according to your computer system settings.

Scroll wheel (E)

- Rotate the scroll wheel to scroll up/down on the computer screen.

Connect button (I)

- Press this button to pair the mouse with the receiver (H).

ON/OFF switch (J)

- Use the ON/OFF switch to switch the mouse on and off.

Cleaning and Maintenance

NOTICE

Switch the product off before cleaning.

NOTICE

Do not immerse the electrical parts of the product in water or other liquids. Never hold the product under running water.

Cleaning

- Clean the battery contacts and also those of the product prior to battery installation.
- To clean, wipe with a soft, slightly moist cloth.
- Dry the product after cleaning.
- Never use corrosive detergents, wire brushes, abrasive scourers, metal or sharp utensils to clean the product.

Maintenance

- Store in a cool and dry place away from children and pets, ideally in original packaging .
- Avoid any vibrations and shocks.

FCC- Supplier's Declaration of Conformity

Unique Identifier	B07G28NF3L Wireless Trackball Mouse
Responsible Party	Amazon.com Services, Inc
U.S. Contact Information	410 Terry Ave N. Seattle, WA 98109, United States
Telephone Number	(206) 266-1000

FCC Compliance Statement

1. This device complies with Part 15 of the FCC rules. Operation is subject to the following two conditions:
 1. this device may not cause harmful interference, and
 2. this device must accept any interference received, including interference that may cause undesired operation.
2. Changes or modifications not expressly approved by the party responsible for compliance could void the user's authority to operate the equipment.

FCC Interference Statement

This equipment has been tested and found to comply with the limits for a Class B digital device, pursuant to part 15 of the

FCC Rules. These limits are designed to provide reasonable protection against harmful interference in a residential installation.

This equipment generates, uses and can radiate radio frequency energy and, if not installed and used in accordance with the instructions, may cause harmful interference to radio communications. However, there is no guarantee that interference will not occur in a particular installation. If this equipment does cause harmful interference to radio or television reception, which can be determined by turning the equipment off and on, the user is encouraged to try to correct the interference by one or more of the following measures:

- Reorient or relocate the receiving antenna.
- Increase the separation between the equipment and receiver.
- Connect the equipment into an outlet on a circuit different from that to which the receiver is connected.
- Consult the dealer or an experienced radio/TV technician for help.

Canada IC Notice

- This device complies with Industry Canada license-exempt RSS standard(s). Operation is subject to the following two conditions:
 1. this device may not cause interference, and
 2. this device must accept any interference, including interference that may cause undesired operation of the device.
- This Class B digital apparatus complies with Canadian CAN ICES-3(B) / NMB-3(B) standard.

Simplified EU Declaration of Conformity

- Hereby, Amazon EU sarl declares that the radio equipment type B07G28NF3L is in compliance with Directive 2014/53/EU.
- The full text of the EU declaration of conformity is available at the following internet address:
https://www.amazon.co.uk/amazon_private_brand_EU_compliance

Disposal



■ The Waste Electrical and Electronic Equipment (WEEE) Directive aims to minimise the impact of electrical and electronic goods on the environment, by increasing re-use and recycling and by reducing the amount of WEEE going to landfill. The symbol on this product or its packaging signifies that this product must be disposed separately from ordinary household wastes at its end of life. Be aware that this is your responsibility to dispose of electronic equipment at recycling centers in order to conserve natural resources. Each country should have its collection centers for electrical and electronic equipment recycling. For information about your recycling drop off area, please contact your related electrical and electronic equipment waste management authority, your local city office, or your household waste disposal service.

Battery Disposal



Do not dispose of used batteries with your household waste. Take them to an appropriate disposal/collection site.

Specifications

Voltage/battery type: 1 x 1.5 V AA

Transmission power: 1mW

Frequency band: 2.4 GHz

OS compatibility: Windows 7 /8/10

Product dimensions (W X H X D): approx. 3.94 x 1.85 x 5.31 in {100 x 47 x 135 mm}

Product net weight: approx. 4.02 oz (114 g)

Warranty Information

To obtain a copy of the warranty for this product:



US: amazon.com/AmazonBasics/Warranty

UK: amazon.co.uk/basics-warranty



US: +1-866-216-1072

UK: +44 (0) 800-279-7234

Feedback and Help

Love it? Hate it? Let us know with a customer review.

AmazonBasics is committed to delivering customer-driven products that live up to your high standards. We encourage you to write a review sharing your experiences with the product.



US: [amazon.com/review/review-your-purchases#](https://www.amazon.com/review/review-your-purchases#)

UK: [amazon.co.uk/review/review-your-purchases#](https://www.amazon.co.uk/review/review-your-purchases#)



US: [amazon.com/gp/help/customer/contact-us](https://www.amazon.com/gp/help/customer/contact-us)

UK: [amazon.co.uk/gp/help/customer/contact-us](https://www.amazon.co.uk/gp/help/customer/contact-us)

Customers Support

[amazon.com/AmazonBasics](https://www.amazon.com/AmazonBasics)

amazon basics

Documents / Resources

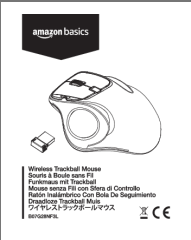
	<p>amazon basics B07G28NF3L Wireless Trackball Mouse [pdf] Instruction Manual B07G28NF3L Wireless Trackball Mouse, B07G28NF3L, Wireless Trackball Mouse, Trackball Mouse, Mouse</p>
-------------------------------------------------------------------------------------	---------------------------------------------------------------------------------------------------------------------------------------------------------------------------------------------------------

References

- [User Manual](#)