



Amazon Basics B079YQPNJS Full Size Wireless Keyboard and Mouse Combo User Guide

[Home](#) » [amazon basics](#) » Amazon Basics B079YQPNJS Full Size Wireless Keyboard and Mouse Combo User Guide 

Amazon Basics B079YQPNJS Full Size Wireless Keyboard and Mouse Combo User Guide



Contents

- 1 [Contents Mouse](#)
- 2 [Contents – Keyboard:](#)
- 3 [IMPORTANT SAFEGUARDS](#)
- 4 [Battery Warnings](#)
- 5 [Setup](#)
- 6 [Pairing](#)
- 7 [FCC Compliance Statement](#)
- 8 [Canada IC Notice](#)
- 9 [Simplified EU Declaration of Conformity](#)
- 10 [Simplified UK Declaration of Conformity](#)
- 11 [Disposal](#)
- 12 [Battery Disposal](#)
- 13 [Specifications](#)
- 14 [Feedback and Help](#)
- 15 [Documents / Resources](#)
- 16 [Related Posts](#)

Contents Mouse

Before getting started, ensure the package contains the following components:

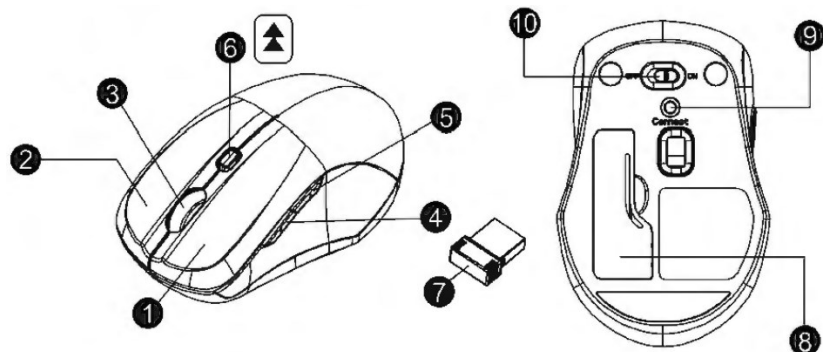

1. Left button
2. Right button
3. Scrolling wheel
4. Forward
5. Backward
6. Hyper scrolling key
7. Nano receiver
8. Battery cover
9. Connect button
10. **ON/OFF** switch

Forward / Backward

Press this button to view the next or previous page in your Internet browser.

Hyper Scrolling Key

- **Normal scrolling (default)** – LED off
- **Hyper scrolling** — LED on and off after 10 seconds

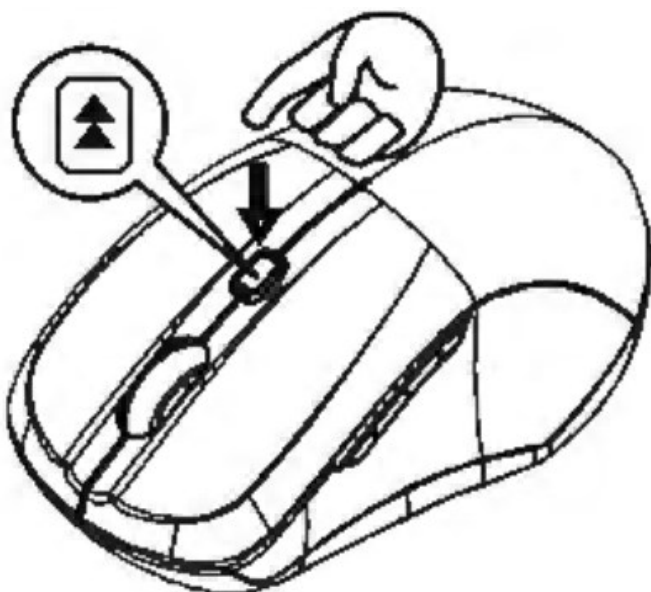





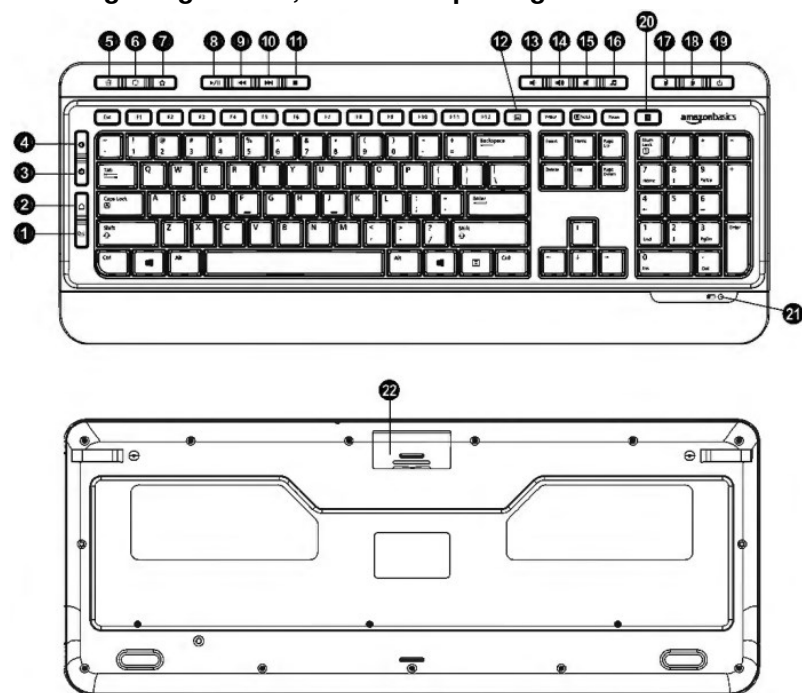





Contents – Keyboard:

Before getting started, ensure the package contains the following components:



1		E-mail	Start the default e-mail client
2		Homepage	Start the default web browser and load the home web page
3		Forward	Forward to the next page on the used browser application
4		Back	Back to the last page on the used browser application
5		Search	Search particular web sites
6		Refresh	Refresh the current web page in browser
7		Favorites	Open favorites of the used browser application
8		Play/Pause	Switch between playing and pausing media
9		Previous	Switch to the previous media track

10		Next	Switch to the next media track
11		Stop	Stop playing the media in the media player
12		My Computer	Open My Computer
13		Volume down	Decrease the computer's sound volume.
14		Volume up	Increase the computer's sound volume.
15		Mute	Mute (turn off) the computer's sound
16		Media select	Turn on the Media player application
17		Sleep	Put computer into Sleep (stand by) mode
18		Wake up	Wake up computer (when in Sleep mode)
19		Power	Shut PC off
20		Calculator	Start Microsoft calculator
21		LED indicator	Low battery and pairing indicator
22		Battery cover	

IMPORTANT SAFEGUARDS



Read these instructions carefully and retain them for future use. If this product is passed to a third party, then these instructions must be included.

When using electrical appliances, basic safety precautions should always be followed to reduce the risk

of fire, electric shock, and/ or injury to persons including the following:

- Do not look directly at the LED light (bottom of the mouse).
- Keep any packaging materials away from children — these materials are a potential source of danger, e.g. suffocation. Only use this product for its intended use.
- Never use this product if damaged.
- Do not insert any foreign objects into the inside of the casing.
- Protect the product from extreme temperatures, hot surfaces, open flames, direct sunlight, water, high humidity, moisture, strong jolts, flammable gases, vapours and solvents.

Battery Warnings

- Keep batteries out of the reach of children. In particular, keep batteries which are considered swallowable out of the reach of children. In case of ingestion of a cell of battery seek medical assistance promptly. Swallowing batteries can cause chemical burns, perforation of soft tissue, and in severe cases can cause death. They need to be removed immediately if swallowed.
- Do not allow children to replace batteries without adult supervision.
- Always insert batteries correctly with regard to polarity (+ and -) marked on the battery and the equipment. When batteries are inserted in reverse they might be short-circuited or charged. This can cause overheating, leakage, venting, rupture, explosion, fire and personal injury.
- Do not short-circuit batteries. When the positive (+) and negative (-) terminals of a battery are in electrical contact with each other, the battery becomes short-circuited. For example loose batteries in a pocket with keys or coins, can be shortcircuited. This can result in venting, leakage, explosion, fire and personal injury.
- Do not charge batteries. Attempting to charge a nonrechargeable (primary) battery can cause internal gas and/or heat generation resulting in leakage, venting, explosion, fire and personal injury.
- Do not force discharge batteries. When batteries are force discharged by means of an external power source the voltage of the battery will be forced below its design capability and gases will be generated inside the battery. This can result in leakage, venting, explosion, fire and personal injury.
- Do not mix new and used batteries or batteries of different types or brands. When replacing batteries, replace all of them at the same time with new batteries of the same brand and type. When batteries of different brand or type are used together or new and used batteries are used together, some batteries might be over-discharged / force discharged due to a difference of voltage or capacity. This can result in leakage, venting, explosion, fire and personal injury.
- Exhausted batteries should be immediately removed from equipment and properly disposed of. When discharged batteries are kept in the equipment for a long time electrolyte leakage can occur causing damage to the equipment and/or personal injury.
- Do not heat batteries. When a battery is exposed to heat, leakage, venting, explosion or fire can occur and cause personal injury.
- Do not weld or solder directly to batteries. The heat from welding or soldering directly to a battery can cause leakage, venting, explosion or fire, and can cause personal injury.
- Do not dismantle batteries. When a battery is dismantled or taken apart, contact with the components can be harmful and can cause personal injury or fire.
- Do not deform batteries. Batteries should not be crushed, punctured, or otherwise mutilated. Such abuse can cause leakage, venting, explosion or fire and can cause personal injury.

- Do not dispose of batteries in fire. When batteries are disposed of in fire, the heat build-up can cause explosion and/ or fire and personal injury. Do not incinerate batteries except for approved disposal in a controlled incinerator.
- Always select the correct size and grade of battery most suitable for the intended use. Information provided with the equipment to assist correct battery selection should be retained for reference.
- Clean the battery contacts and those of the equipment prior to battery installation.
- Remove batteries from equipment which is not to be used for an extended period of time.

Setup

Installing the Batteries

NOTE

- Always purchase the correct size and grade of battery most suitable for the intended use.
- Clean the battery contacts and also those of the device prior to battery installation.
- Ensure the batteries are installed correctly with regard to polarity (+ and -).
- Remove batteries from equipment that is not to be used for an extended period of time. Remove used batteries promptly.

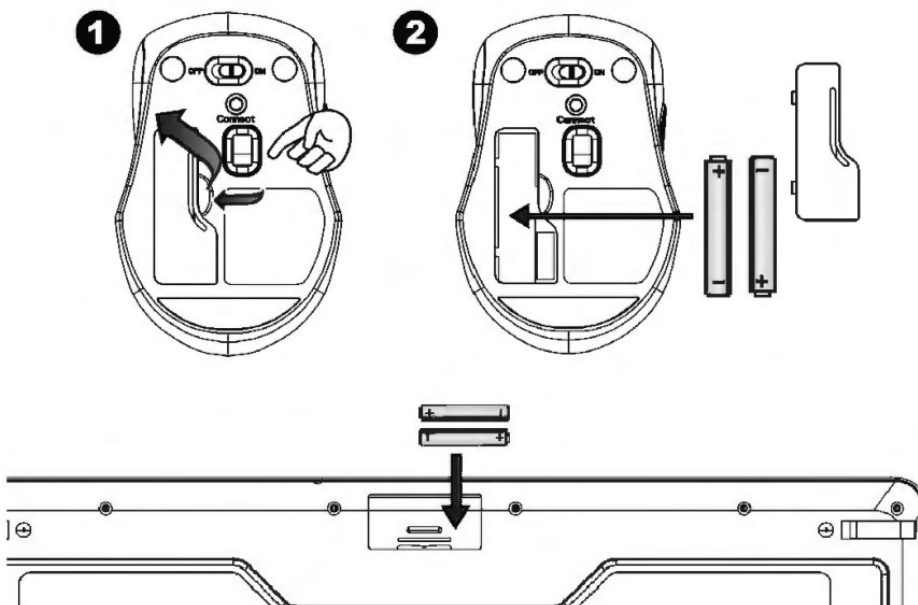

- Remove the battery cover.
- Insert the batteries correctly with regard to polarity (+ and -) marked on the battery and the product.
- Place the cover back over the battery compartment.
- Set the ON/OFF switch on the bottom side of the mouse to ON.

Pairing

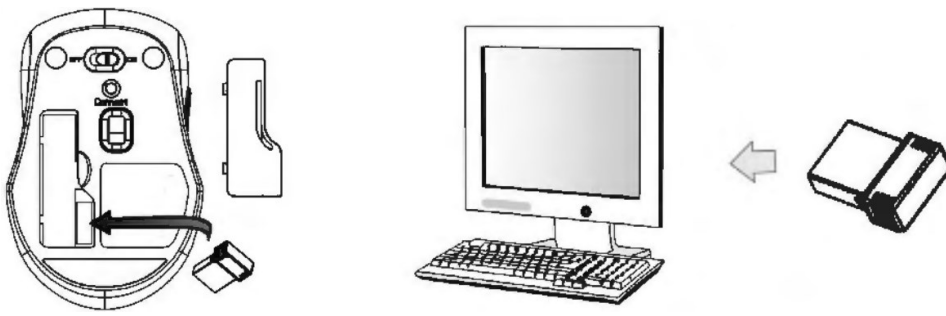

- Remove the battery cover of the mouse, and take the nano receiver out,
- Plug the nano receiver into a USB port of your computer.

Note

The receiver has an auto pairing function. If the connection between the mouse and/or keyboard and the receiver fails or is interrupted, proceed as follows:

- Remove the nano receiver from the computer's USB port and plug it back in. Press the Connect button at the bottom of the mouse. Then, press the "ESC" and "K" button on the keyboard.
- If the mouse or keyboard does not work after 10 seconds, pair them again.

LED blinks 3 times

Indicates the mouse is pairing. The LED turns off after pairing successfully.

LED blinks for 10 seconds

Low battery warning

LED indicator

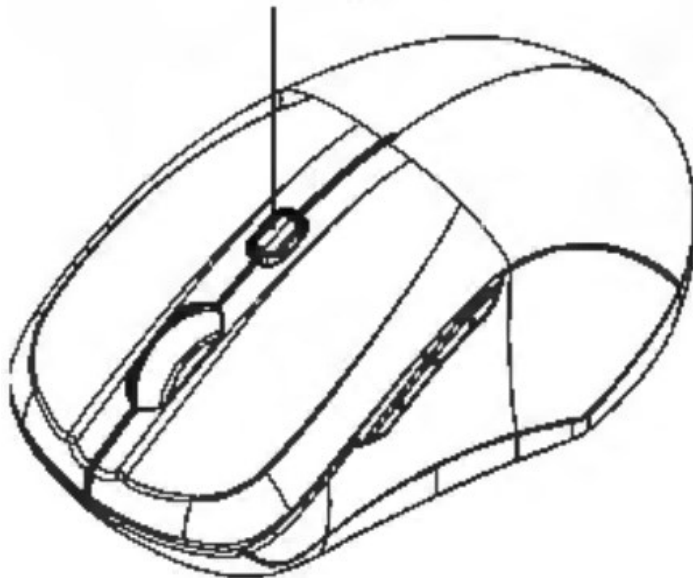

LED is on for 10 seconds

Power ON

LED blinking

Indicates the keyboard is pairing. The LED turns off after pairing successfully.

LED blinks for 10 seconds

Low battery warning

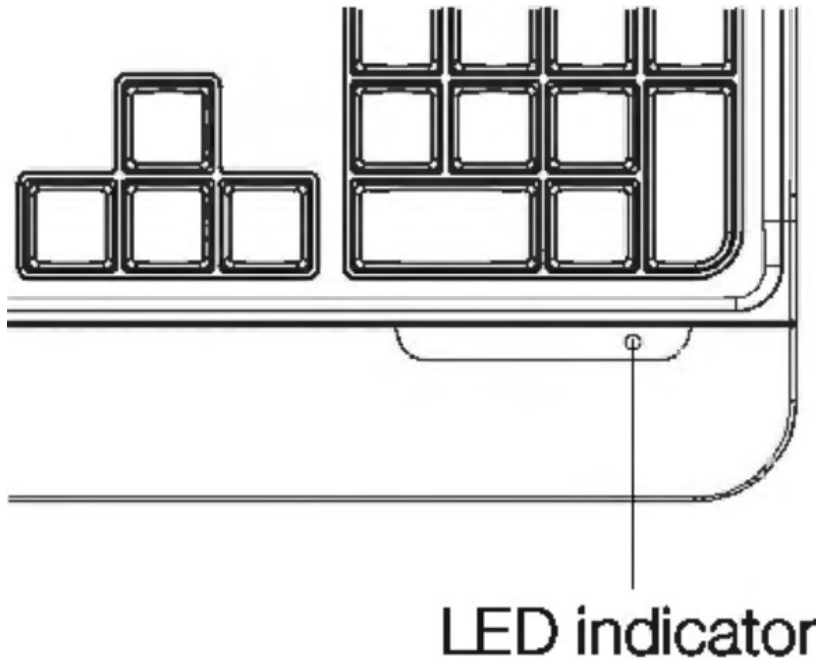

FCC Compliance Statement

1. **This device complies with Part 15 of the FCC rules. Operation is subject to the following two conditions:**
 1. this device may not cause harmful interference, and
 2. this device must accept any interference received, including interference that may cause undesired operation.
2. Changes or modifications not expressly approved by the party responsible for compliance could void the user's authority to operate the equipment.

FCC Interference Statement

This equipment has been tested and found to comply with the limits for a Class B digital device, pursuant to part 15 of the FCC Rules. These limits are designed to provide reasonable protection against harmful interference in a residential installation. This equipment generates, uses and can radiate radio frequency energy and, if not installed and used in accordance with the instructions, may cause harmful interference to radio communications. However, there is no guarantee that interference will not occur in a particular installation. If this equipment does cause harmful interference to radio or television reception, which can be determined by turning the equipment off and on, the user is encouraged to try to correct the interference by one or more of the following measures:

- Reorient or relocate the receiving antenna.
- Increase the separation between the equipment and receiver.
- Connect the equipment into an outlet on a circuit different from that to which the receiver is connected.
- Consult the dealer or an experienced radio/TV technician for help.

Canada IC Notice

- **This device complies with Industry Canada license-exempt RSS standard(s). Operation is subject to**

the following two conditions:

1. this device may not cause interference, and
 2. this device must accept any interference, including interference that may cause undesired operation of the device.
- This Class B digital apparatus complies with Canadian CAN ICES-003(B) / NMB-003(B) standard.

Simplified EU Declaration of Conformity

- Hereby, Amazon EU Sarl declares that the radio equipment type BO79YQPNJS, BO7B6L1GY2, BO7BELJLQW, BO7BBKK6LG, BO7BEDNYJM, BO7BELFYWG is in compliance with Directive 2014/53/EU.
- The full text of the EU declaration of conformity is available at the following internet address:
https://www.amazon.co.uk/amazon_private_brand_EU_compliance

Simplified UK Declaration of Conformity

Hereby, Amazon EU SARL, UK Branch declares that the radio equipment type BO79YQPNJS, BO7B6L1GY2, BO7BELJLQW, BO7B6KK6LG, BO7BEDNYJM, BO7BELFYWG is in compliance with The Radio Equipment Regulations 2017. The full text of the UK declaration of conformity is available at the following internet address:

https://www.amazon.co.uk/amazon_private_brand_EU_compliance

Disposal



The Waste Electrical and Electronic Equipment (**WEEE**) Directive aims to minimise the impact of electrical and electronic goods on the environment, by increasing re-use and recycling and by reducing the amount of WEEE going to landfill. The symbol on this product or its packaging signifies that this product must be disposed separately from ordinary household wastes at its end of life. Be aware that this is your responsibility to dispose of electronic equipment at recycling centers in order to conserve natural resources. Each country should have its collection centers for electrical and electronic equipment recycling. For information about your recycling drop off area, please contact your related electrical and electronic equipment waste management authority, your local city office, or your household waste disposal service.

Battery Disposal



Do not dispose of used batteries with your household waste. Take them to an appropriate disposal/collection site.

Specifications

Model	Type
BO79YQPNJS	US Layout (QWERTY)
BO7B6L1GY2	DE Layout (QWERTZ)
BO7BELILQW	ES Layout (QWERTY)
BO7B6KKELG	FR Layout (AZERTY)
BO7BEDNYJM	IT Layout (QWERTY)
BO7BELFYWG	UK Layout (QWERTY)

Feedback and Help

Love it? Hate it? Let us know with a customer review.

AmazonBasics is committed to delivering customer-driven products that live up to your high standards. We encourage you to write a review sharing your experiences with the product.



US: amazon.com/review/review-your-purchases#

UK: amazon.co.uk/review/review-your-purchases#



US: amazon.com/gp/help/customer/contact-us

UK: amazon.co.uk/gp/help/customer/contact-us



Contact Customer Service at +1 877-485-0385



Documents / Resources

	<p>Amazon Basics B079YQPNJS Full Size Wireless Keyboard and Mouse Combo [pdf] User Guide</p> <p>B079YQPNJS Full Size Wireless Keyboard and Mouse Combo, B079YQPNJS, Full Size Wireless Keyboard and Mouse Combo, Keyboard and Mouse Combo, Mouse Combo</p>
---	--