

amazon
basics
B00BBDF500
Corona 2
Drawer Console
Table Solid Pine
Wood



amazon basics B00BBDF500 Corona 2 Drawer Console Table Solid Pine Wood Instruction Manual

[Home](#) » [amazon basics](#) » amazon basics B00BBDF500 Corona 2 Drawer Console Table Solid Pine Wood Instruction Manual 

Contents

- 1 [amazon basics B00BBDF500 Corona 2 Drawer Console Table Solid Pine Wood](#)
- 2 [Important Safety Instructions](#)
- 3 [Before First Use](#)
- 4 [Tools Needed](#)
- 5 [Delivery Content](#)
- 6 [Assembly](#)
- 7 [Cleaning and Maintenance](#)
- 8 [Specifications](#)
- 9 [Feedback and Help](#)
- 10 [Documents / Resources](#)
 - 10.1 [References](#)



amazon basics B00BBDF500 Corona 2 Drawer Console Table Solid Pine Wood



Important Safety Instructions

- Read these instructions carefully and retain them for future use. If this product is passed to a third party, then these instructions must be included.
- When using the product, basic safety precautions should always be followed to reduce the risk of injury including the following:

DANGER Risk of injury or death!

Serious or fatal crushing injuries can occur from product tipping over. To prevent this product from tipping over install tip-over restraint provided.

WARNING Risk of injury!

- The unassembled state contains small parts, sharp edges, and sharp points.
- Do not climb or use the product as a step ladder. The unstable weight may cause the product to tip over.
- **CAUTION Risk of injury!**
The product can tip over. Do not let children climb on or play with the product.
- For domestic use only.
- Be cautious when opening/closing (folding/unfolding) the product. Keep hands away from the folding mechanisms to prevent fingers from being trapped and pinched.
- This product must be assembled by 2 adults.
- Keep children and pets away while assembling the product. Do not let children climb on or play with the product.
- Always use the product on a firm, level ground.
- Do not use this product if any parts are missing, damaged, or worn.
- To avoid scratching the floor, assemble the product on a soft surface, such as a carpet.
- Do not over-tighten the fasteners.
- Regularly examine the product for wear and tear. Stop using the product at the first sign of damage or if parts

become detached.

- Do not use power tools to assemble the product. Power tools may strip or damage the parts.
- Do not sit or stand on the tabletop.
- Do not place hot items directly on the tabletop. Heat can cause chemical changes that may create spotting within the furniture finish. Use a suitable table mat or coaster.
- Take precautions when lifting. Assemble the product near where it is intended to be positioned.
- Assemble the product in a spacious area, preferably on a carpet, near the place where the product is to be located.
- When done assembling the product, place it on a flat surface and make sure it is stable before use.
- Do not set TVs or other heavy objects on top of the product.
- Do not overload the product. Load the product evenly and place the heaviest items on the lower shelves.
- The maximum load of the shelf is 15 kg.
- This product is intended for household use only.
- This product is intended to be used in dry indoor areas only.

Before First Use

DANGER Risk of suffocation!

Keep any packaging materials away from children and pets these materials are a potential source of danger, e.g. suffocation.

- Remove all the packing materials.
- Remove and review all components before assembly.
- Check the product for transport damages.
- When opening the package with a sharp tool like a cutter knife, be careful not to damage the components inside.
- Carefully remove all packaging materials and retain for future use.

Tools Needed

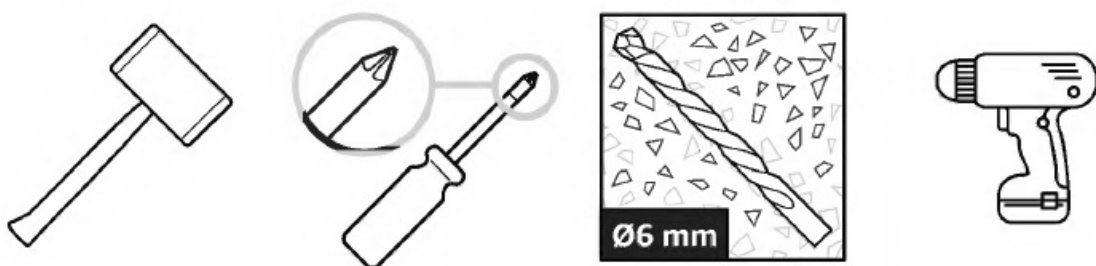

Delivery Content

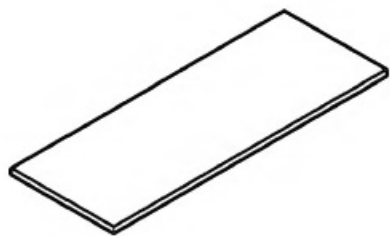

A (x 1)

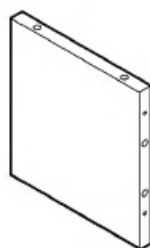

B (x 2)

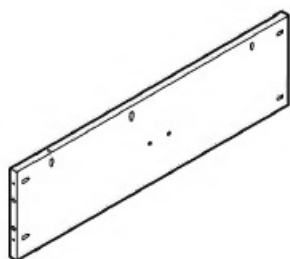

C (x 1)

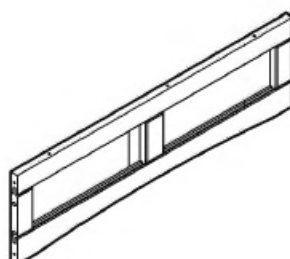

D (x 1)



E (x 2)

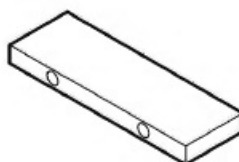

F (x 2)

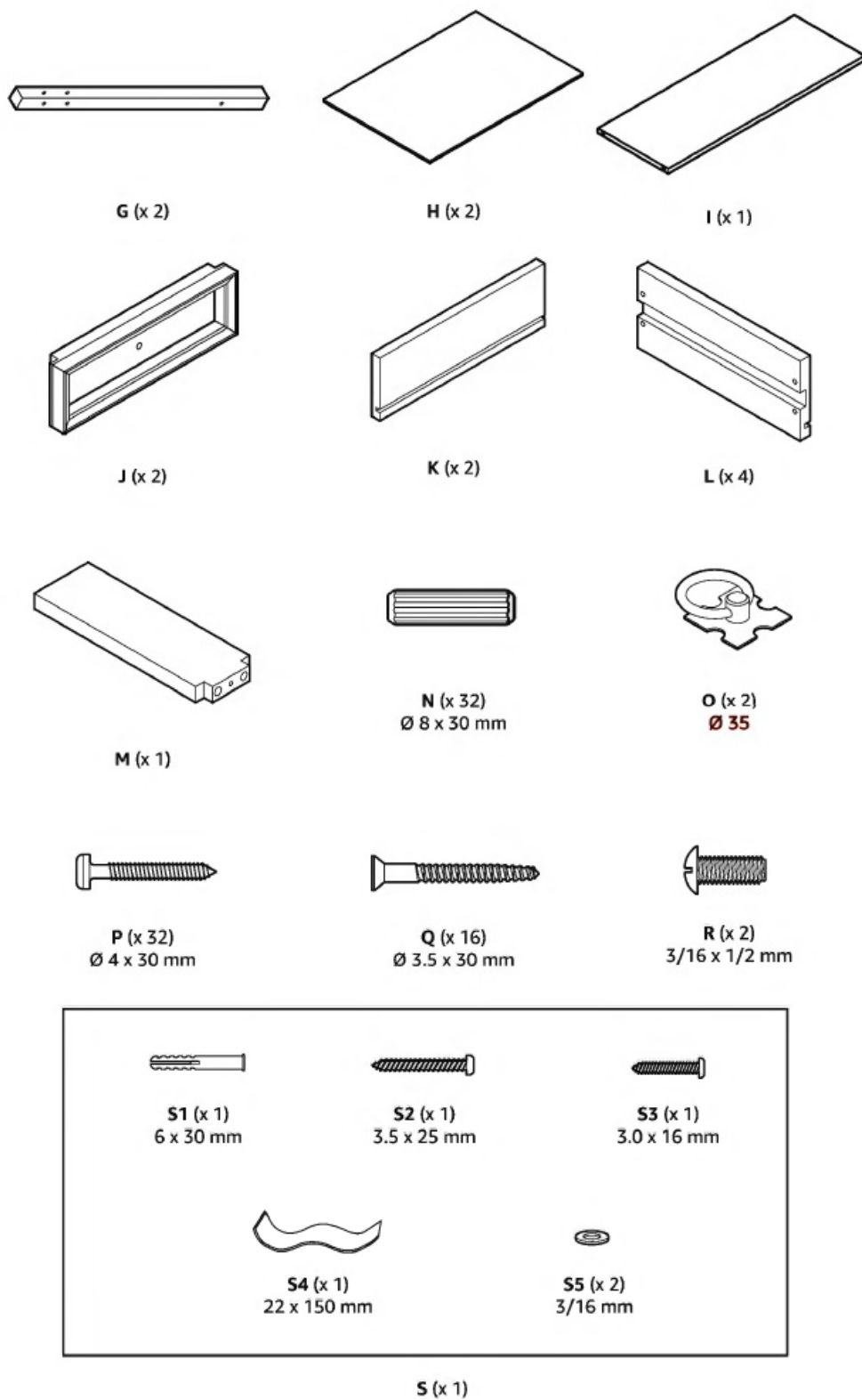

Assembly

For additional illustrated assembly steps, refer to the end of the written instructions.

- Ensure that all required contents are for complete assembly.
- Always assemble the product completely.

1



B (x 2)



C (x 1)

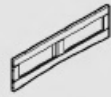

D (x 1)



I (x 1)

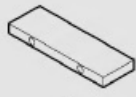

F (x 2)



M (x 1)



N (x 32)

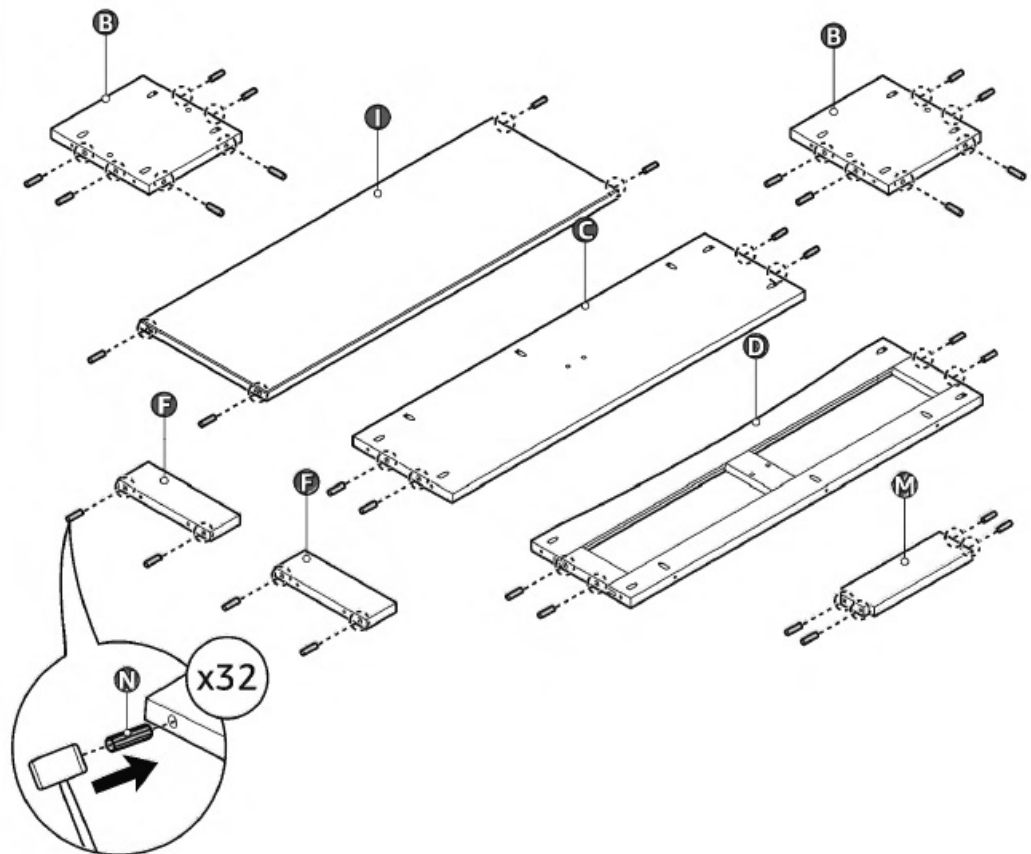
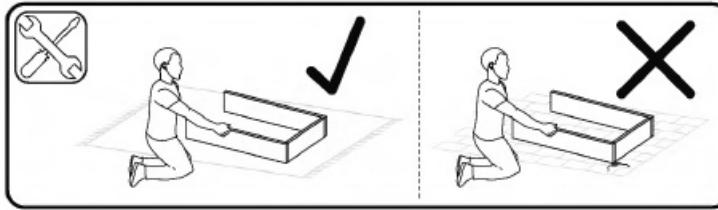

2



E (x 1)

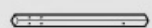

G (x 1)



P (x 4)

x2

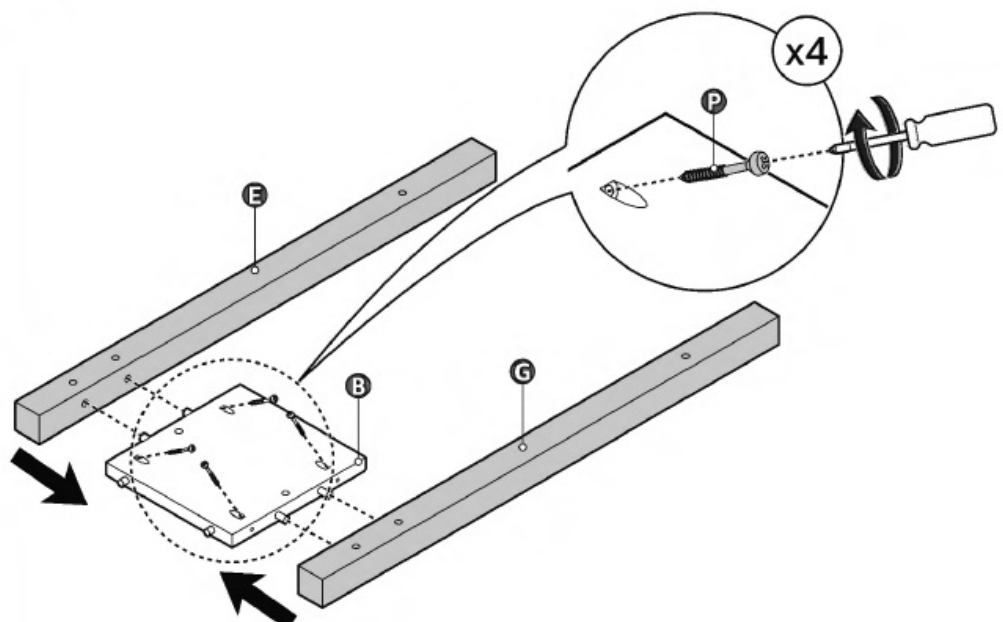

3

x2

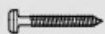

P (x 2)

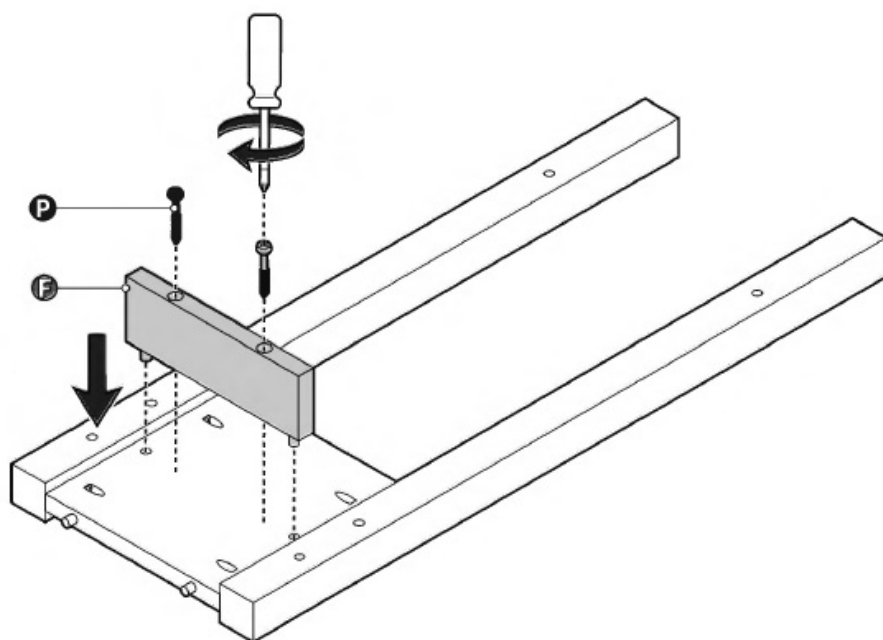

4



P (x 2)

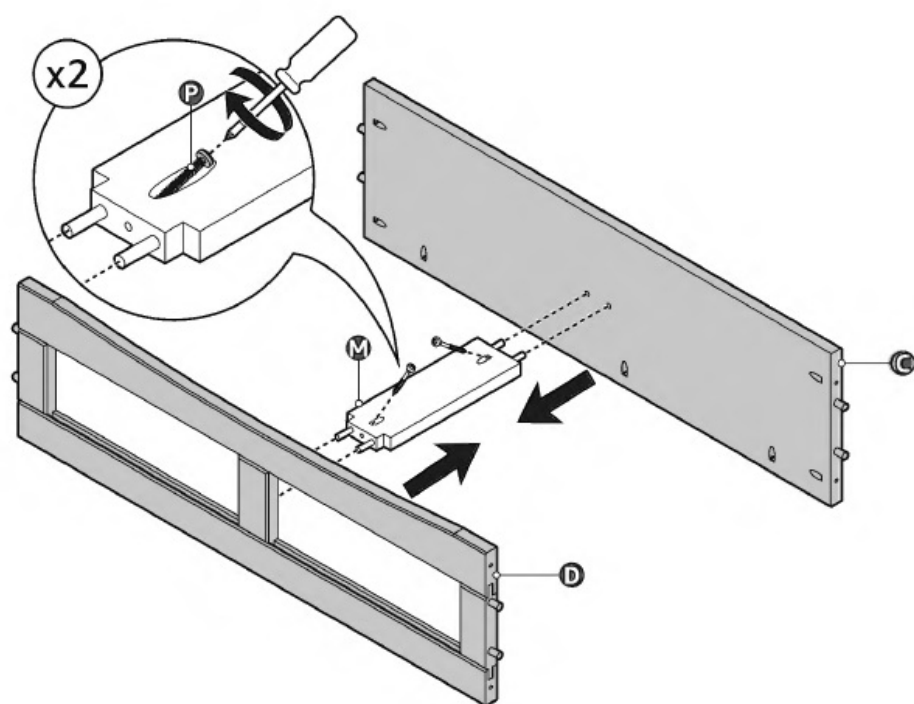

5

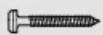

P (x 6)

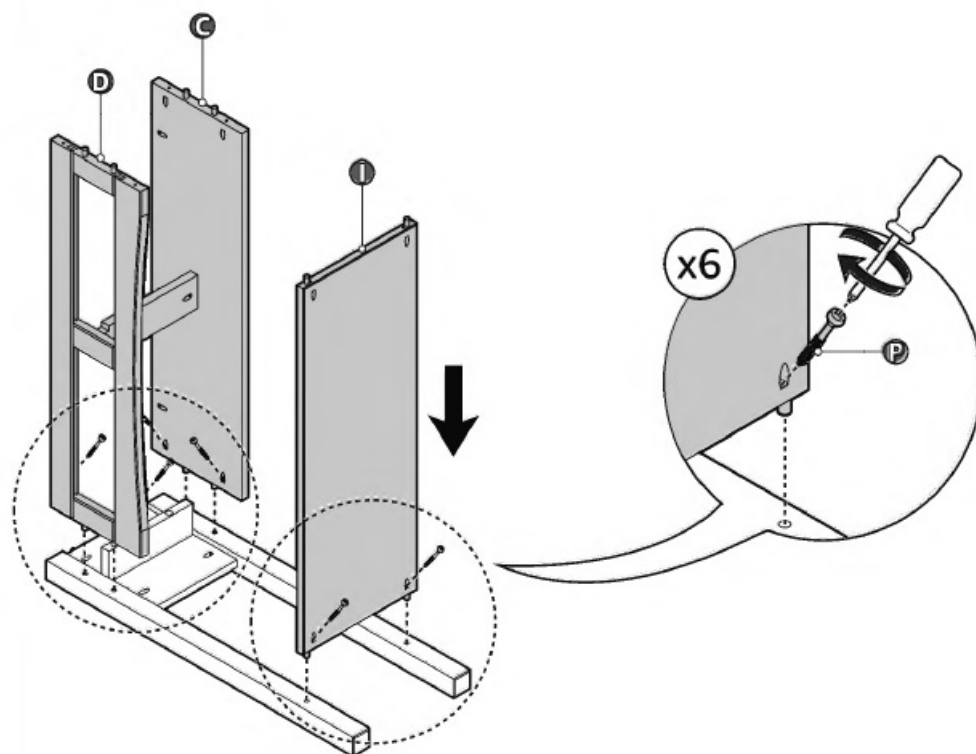

6

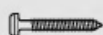

P (x 6)

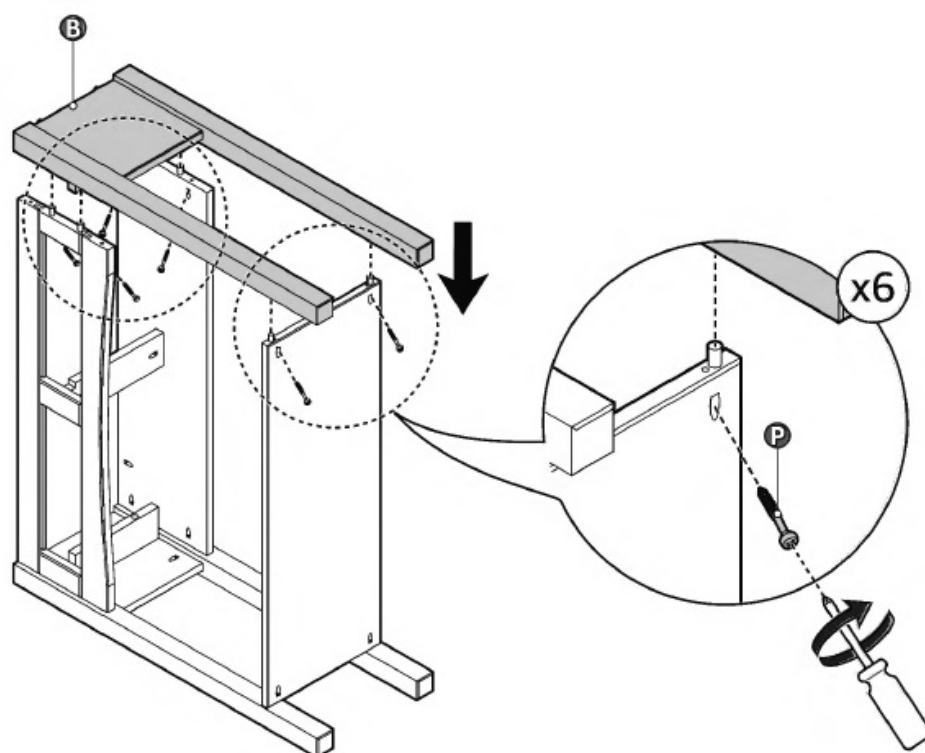

7



A (x 1)



P (x 6)

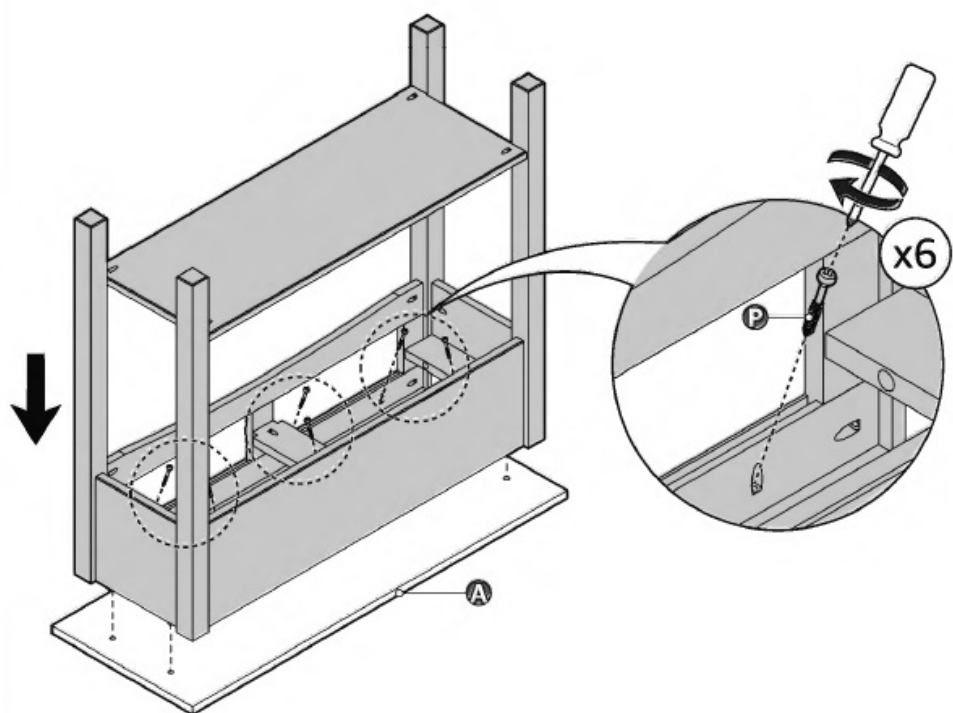

8

x2



J (x 1)



L (x 2)



Q (x 4)

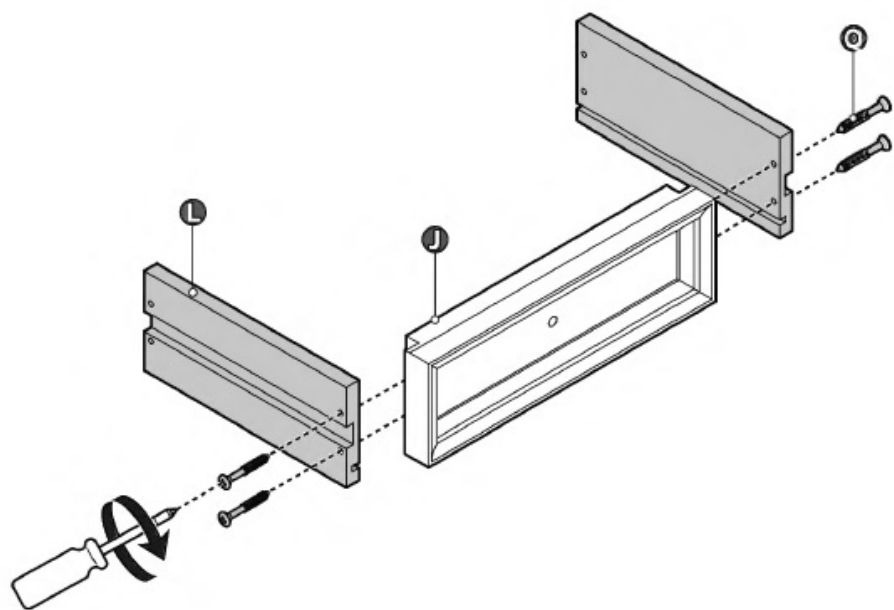

9



H (x 1)

x2

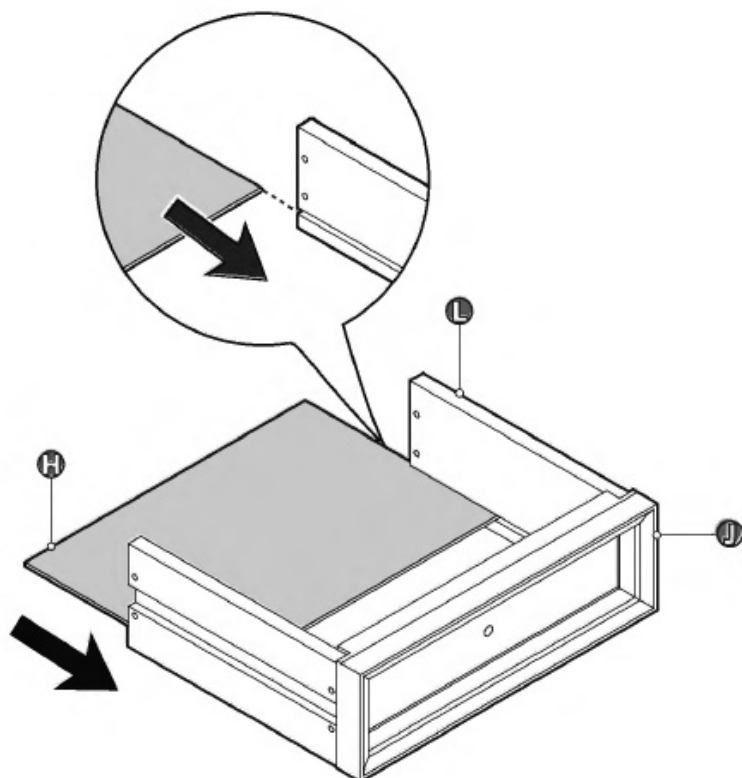

10

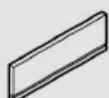

K (x 1)



O (x 1)



Q (x 4)



R (x 1)

x2

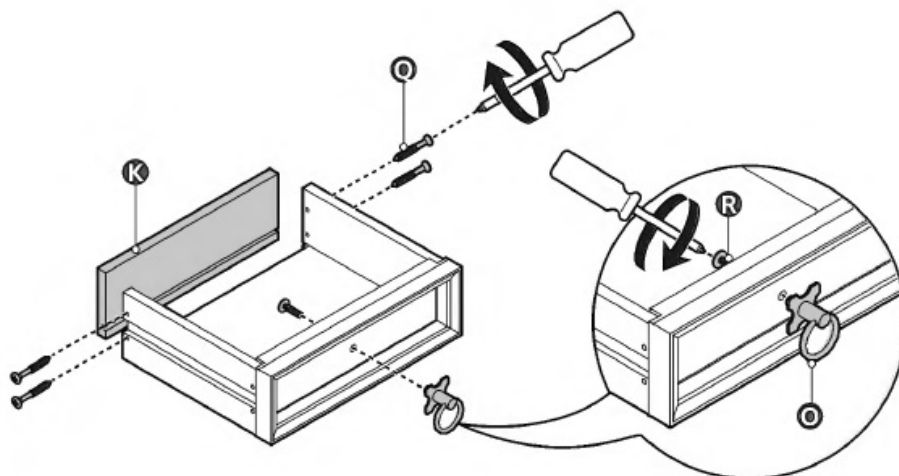

11

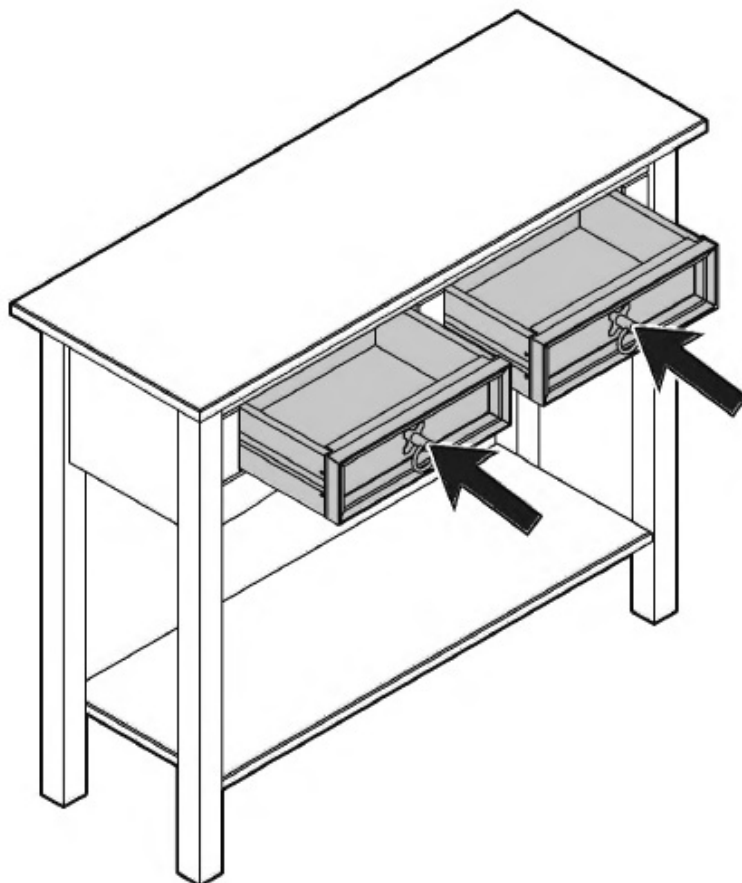

Fixing to the wall

12



S3 (x 1)



S4 (x 1)



S5 (x 1)

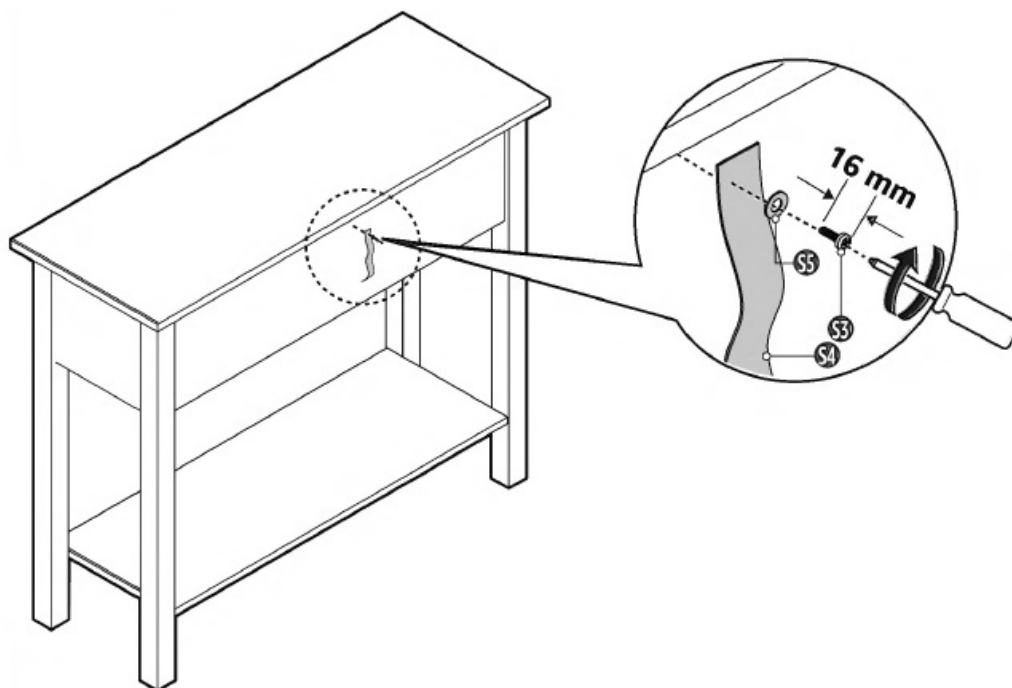

Do not drill into any pipes or power lines beneath the surface during mounting hole preparation. Use a voltage/metal detector before drilling any holes to eliminate any such potential risks.

13

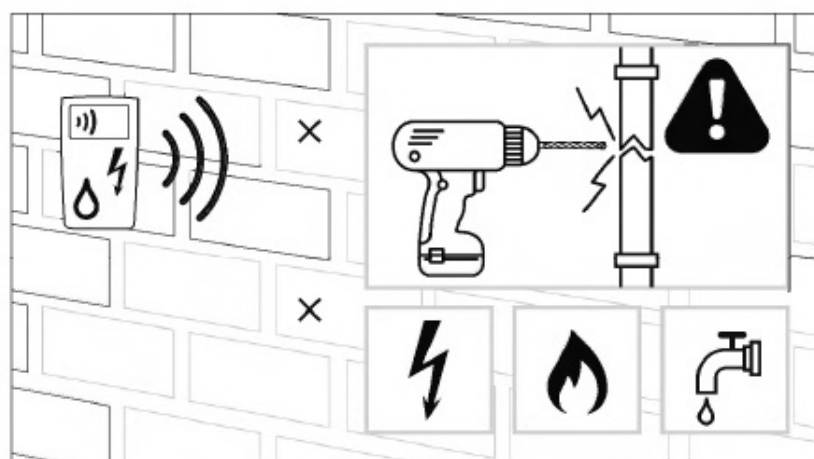

14

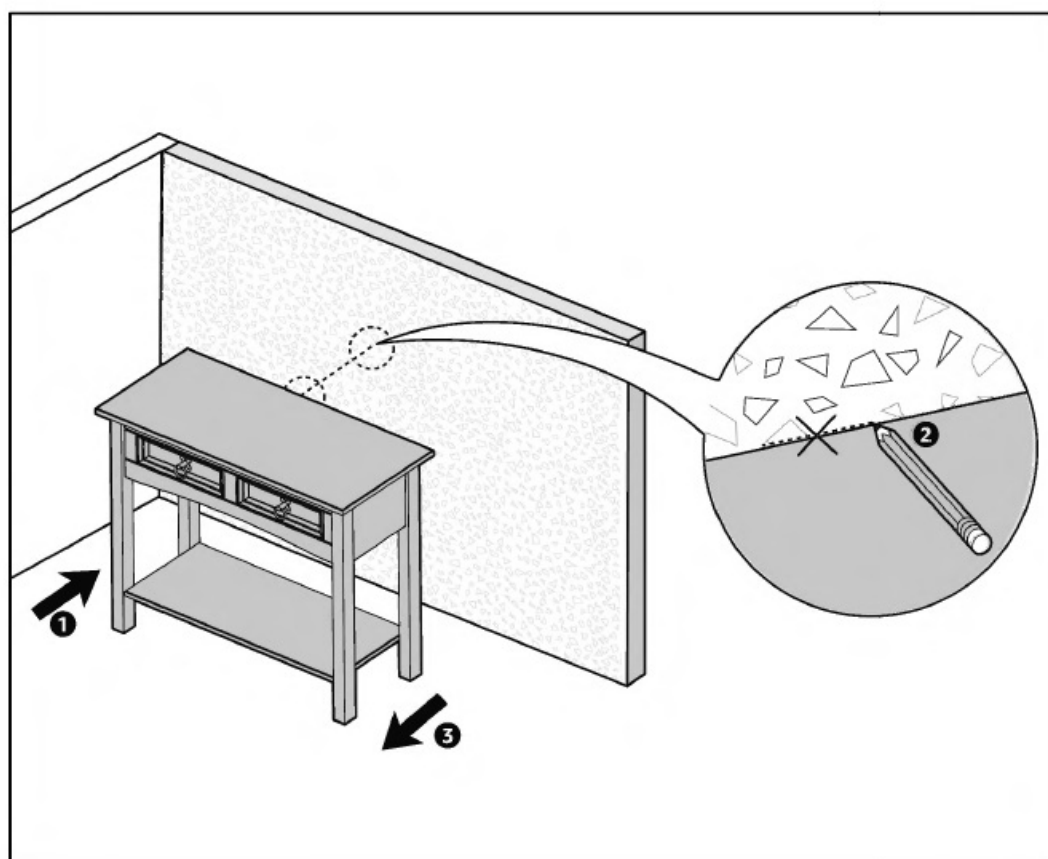

15



S1 (x 1)

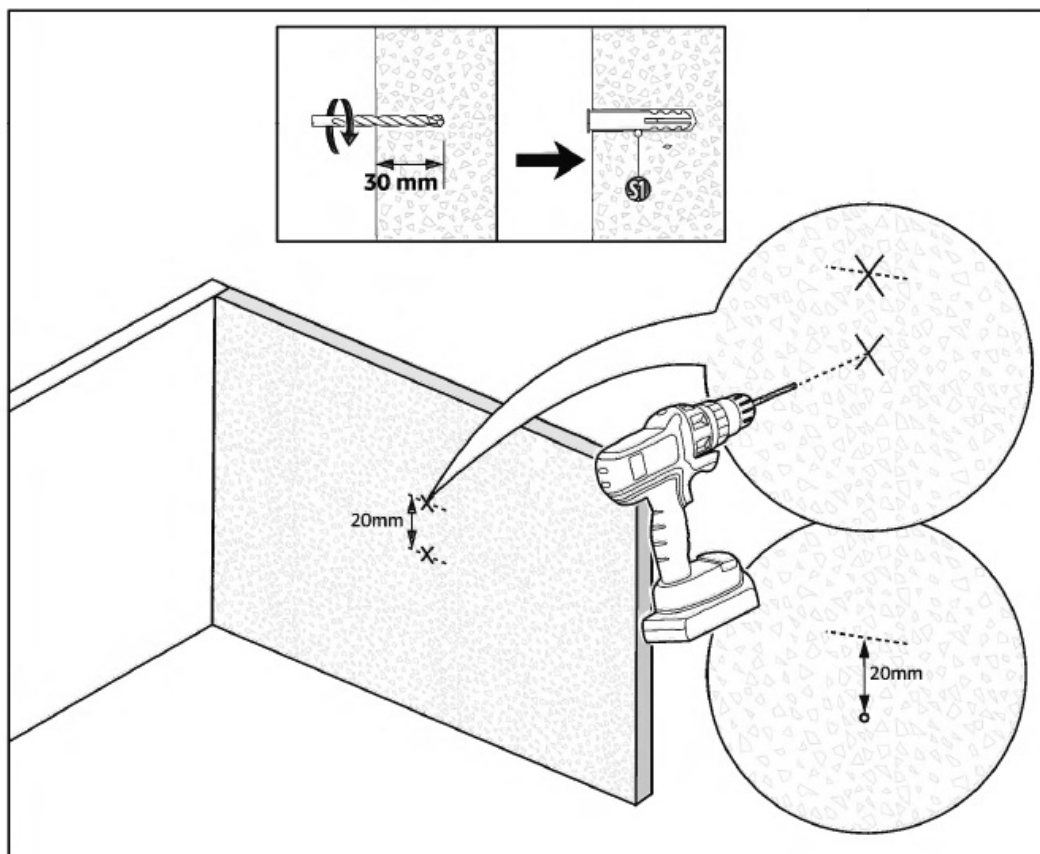

16

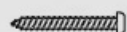

S2 (x 1)



S5 (x 1)

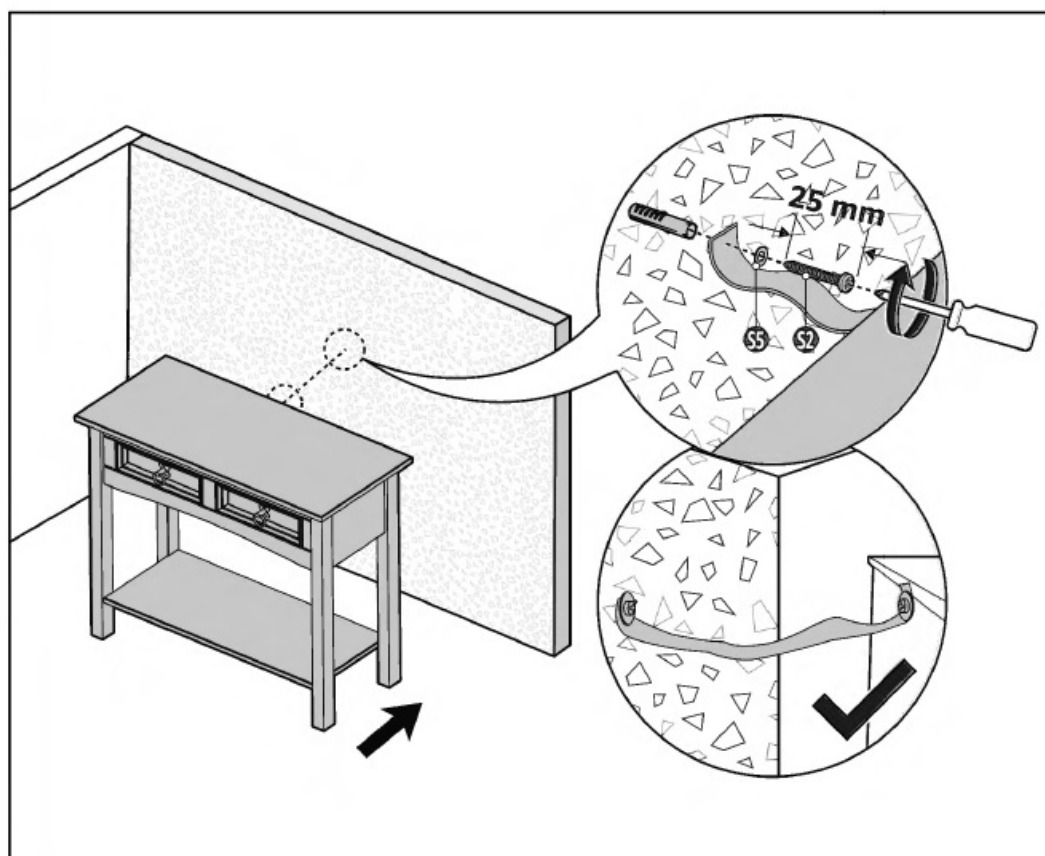

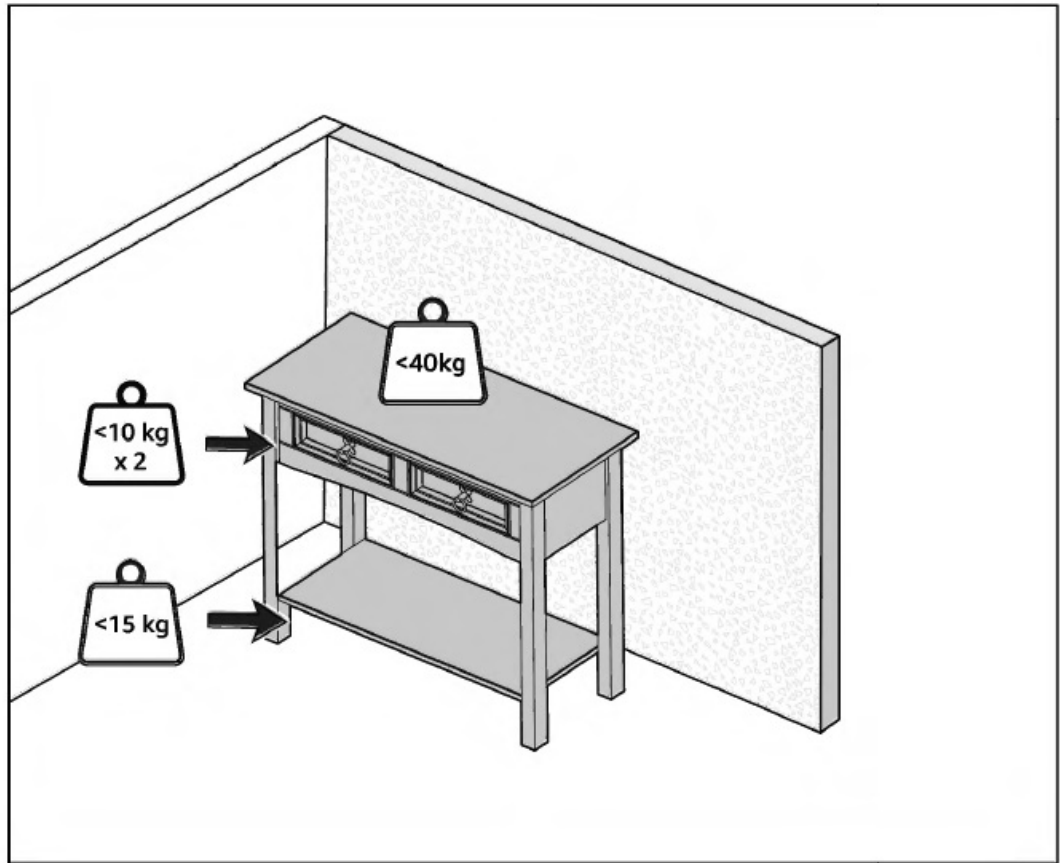

Cleaning and Maintenance

Cleaning

Never use corrosive detergents, wire brushes, abrasive scourers, or metal or sharp utensils to clean the product.

Wood Furniture Care Instructions

- Use a soft, clean cloth that will not scratch the surface when dusting.
- The use of furniture polishes is not necessary. If the need to use polishes arises, test in an inconspicuous area first.
- Using solvents of any kind on the product may damage the product's finish.
- Never use water to clean the product as it may cause damage to the finish.
- Always use coasters under beverage glasses and flowerpots.
- Liquid spills should be removed immediately. Using a soft clean cloth, blot the spill gently. Avoid rubbing.

Storage

- Make sure the product is clean and dry.
- Wrap the product in protective material, such as moving blankets, bubble wrap, or furniture pads. This will prevent scratches and other damage during storage.
- Store the product in a dry, cool place, such as a climate-controlled storage unit or a dry basement. Avoid storing the furniture in areas that are damp, humid, or prone to temperature fluctuations.
- Cover the product with a breathable cover, such as a cotton sheet, to protect it from dust and moisture. Avoid using plastic covers, as they can trap moisture and cause mold and mildew to develop.
- Avoid stacking heavy items on top of each other, as this can cause damage. Instead, place heavy items on the

bottom and lighter items on top.

- If the product can be disassembled, take it apart before storing it. This will make it easier to store and transport, and will also reduce the risk of damage during storage. Be sure to label each piece to know how to reassemble it later.
- If possible, store the product upright to save space. Place larger items, such as sofas and mattresses, against the walls. Stack chairs and smaller items on top of each other.
- Check the product regularly during storage to ensure that it is in good condition. This will help to identify any problems early and prevent them from getting worse.
- Store the product in a safe place that is out of reach of children and pets. Make sure the storage area is clean, dry, and free from any potential hazards.

Maintenance

- Keep the product away from direct heat and sunlight. Prolonged exposure to heat sources may cause glazing, melting, and scorching, or even cause color to fade.
- Regular vacuuming or light brushing helps to remove dirt and prevent soil build-up, which increases the appearance of wear.
- Check the components regularly to make sure all screws and bolts are tightened.

Disposal

Dispose of the product according to local regulations. If in doubt, consult your local authorities.

Specifications

- Capacity approx. 75 kg

Importer Information

	For EU
Postal	Amazon EU S. r.l. 38 avenue John F. Kennedy, L-1855 Luxembourg
Business Reg.	134248
	For UK
Postal	Amazon EU SARL, UK Branch 1 Principal Place, Worship St, London EC2A 2FA, United Kingdom
Business Reg.	BR017427

Feedback and Help

We would love to hear your feedback. To ensure we are providing the best customer experience possible, please consider writing a customer review.

- [amazon.co.uk/review/review-your-purchases#](https://www.amazon.co.uk/review/review-your-purchases#).

If you need help with your AmazonBasics product, please use the website below.

- [amazon.co.uk/gp/help/customer/contact-us](https://www.amazon.co.uk/gp/help/customer/contact-us).

[amazon.com/AmazonBasics](https://www.amazon.com/AmazonBasics)

MADE IN BRAZIL.

Documents / Resources

	<p>amazon basics B00BBDF500 Corona 2 Drawer Console Table Solid Pine Wood [pdf] Instruction Manual</p> <p>B00BBDF500 Corona 2 Drawer Console Table Solid Pine Wood, B00BBDF500, Corona 2 Drawer Console Table Solid Pine Wood, Console Table Solid Pine Wood, Table Solid Pine Wood, Solid Pine Wood</p>
---	--

References

- [User Manual](#)

[Manuals+](#), [Privacy Policy](#)

This website is an independent publication and is neither affiliated with nor endorsed by any of the trademark owners. The "Bluetooth®" word mark and logos are registered trademarks owned by Bluetooth SIG, Inc. The "Wi-Fi®" word mark and logos are registered trademarks owned by the Wi-Fi Alliance. Any use of these marks on this website does not imply any affiliation with or endorsement.