



amazon basics AS0102 USB C Docking Station Dual Monitor Adapter User Manual

[Home](#) » [amazon basics](#) » amazon basics AS0102 USB C Docking Station Dual Monitor Adapter User Manual 

Contents

- [1 amazon basics AS0102 USB C Docking Station Dual Monitor Adapter](#)
- [2 Product Introduction](#)
- [3 Structure Diagram](#)
- [4 Feature](#)
- [5 Connection](#)
- [6 Graphics Settings for window 10](#)
- [7 Graphics Settings for Mac](#)
- [8 FAQ](#)
- [9 Documents / Resources](#)
 - [9.1 References](#)



amazon basics AS0102 USB C Docking Station Dual Monitor Adapter



Product Introduction

This All-in-one multifunction USB-C hub offers convenient access to multiple devices on your USB-C Laptop/MacBook. The hub is equipped with 3 display video outputs. With Triple 4K Ultra HD display simultaneously (2x HDMI & 1x DP), it allows you to split up the content to Triple display devices when the system supports the function. Extended interface: 2x HDMI, 1x DP, 1x RJ45 Gigabit Ethernet, 1x USB-C Data transfer, 1x PD3.0 charging, 2x USB3.0, 3x USB2.0, 1x 3.5mm Audio/Mic, 1x TF & 1x SD card reader. Simply plug and play to expand your Laptop's capabilities.

Structure Diagram

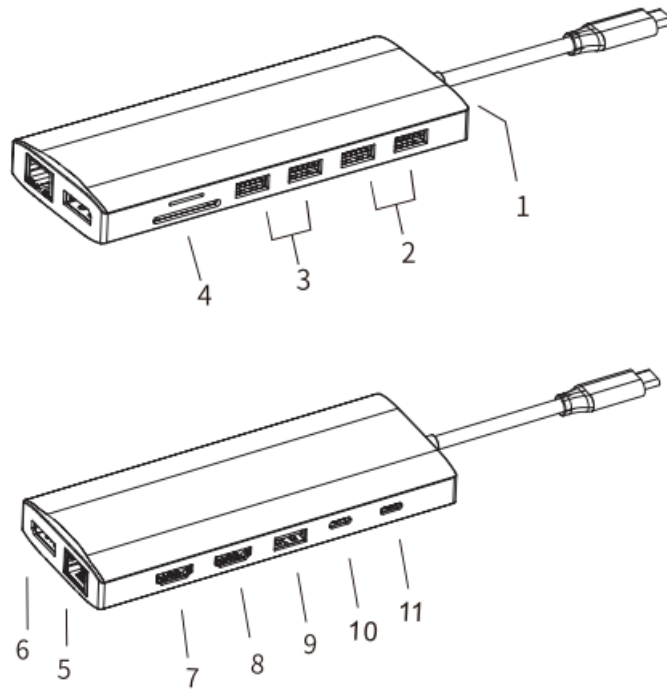

1. Audio/mic
2. USB 3.0
3. USB 2.0
4. SD&TF
5. RJ45
6. DP
7. HDMI 2
8. HDMI 1
9. USB 2.0
10. USB-C Data
11. PD3.0 Power

Feature

1. 3.5mm Audio/Microphone(CTIA Standard)
2. **USB-C Port(PD3.0):** Only for power delivery Upstream charging the source devices such as Laptop/MacBook, charging limited to 87W for safety and affected by different firmware. Support 100W power adapter
3. **HDMI 2:** Up to 4Kx2K 30Hz / 3840x2160

4. **HDMI 1:** Up to 4Kx2K 60Hz / 3840×2160 (work separately or work dual with DP port while the source is Mac OS DP1.4)
5. **DP:** Up to 4Kx2K 60Hz / 3840×2160 (work separately or work dual with HDMI 1 port while the source is Mac OS DP1.4)
6. **USB 3.0 (2 Ports):** Up to 5Gb/s data speed & maximum power output 5V/0.9A, backwards compatible with USB2.0/USB1.1/USB1.0
7. **USB 2.0(3 Ports):** Up to 480Mbps data speed Design for the connection of 2.4 GHz wireless devices, such as wireless keyboards/mouse adapters etc.
8. **RJ45 Gigabit Ethernet:** Up to 1000Mbps, stable wired access
9. **SD / TF Card Reader** (can not work simultaneously)
Read: 25-60MB/s, **Write:** 20-40MB/s, Data transfer rates are subject to the speed of the memory card itself and your computer's USB ports.
10. **USB-C Data:** Support USB3.0 5Gbps transfer rate

Remarks

1. Mac OS only supports SST, and Windows OS supports MST/SST.
2. Under Mac OS, the resolution of 2 or 3 monitors will be 4K 30Hz if connected to HDMI 2 port.
3. Under Windows OS, the resolution of monitors will be always consistent with the laptop's mirror display. And if extended to 2 or 3 monitors, the resolution shows 4K 30Hz on one monitor, and the others will be 1080P.

Connection

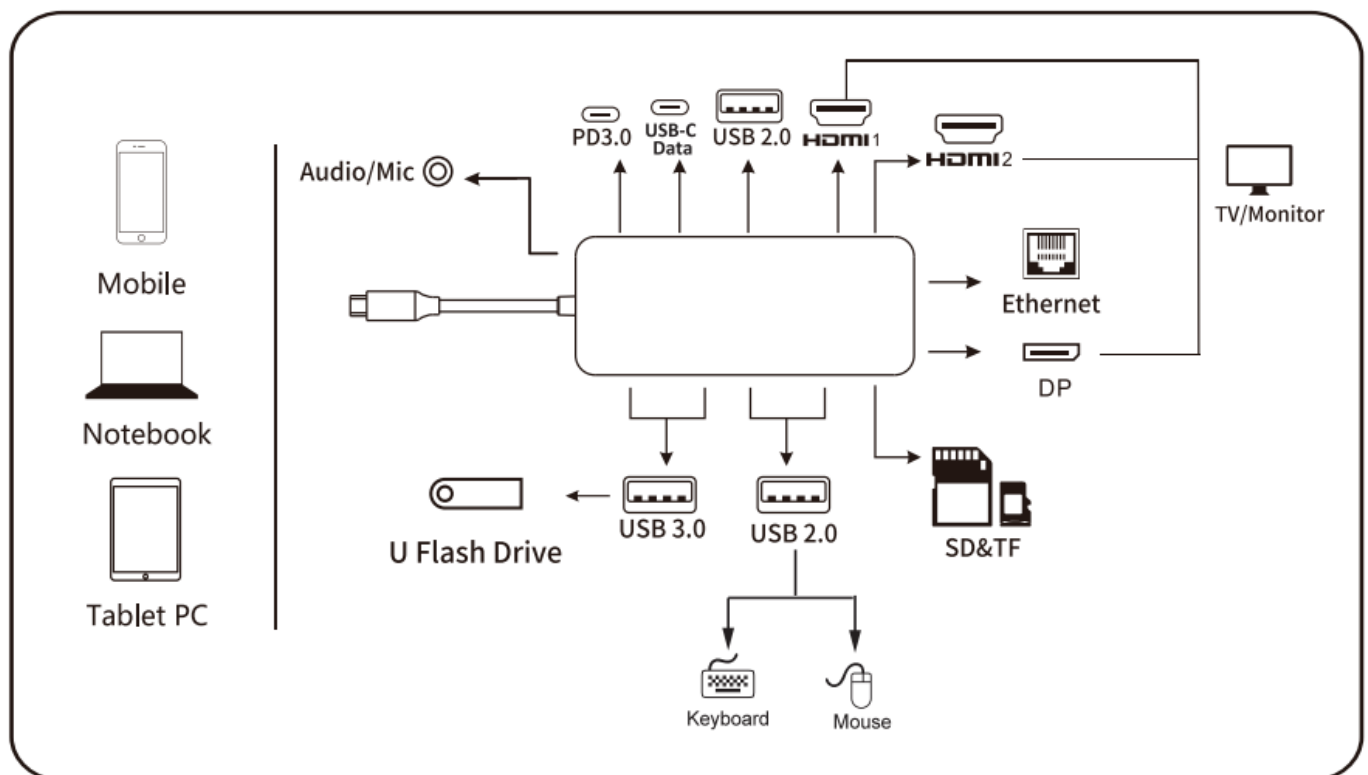

Graphics Settings for window 10

Note: For Windows laptops, only DP1.4(AMD Graphics Card) can support triple display at the same time.

1. Clone mode

Right-click desktop > Graphics Settings > Display

General Settings	Select Display Mode	
Color Settings	Single Display	1 1
Multiple Settings	✓ Clone Display	Detect
Custom Resolutions	Extended Desktop	
DisplayPort Topology	Collage	
<hr/>		
Select One or More Active Displays		
Built-in Display ▼		
HDMI Display ▼		
DP Display ▼		



Source device



HDMI 1 Display



HDMI 2 Display



DP Display

NOTE: The resolution of monitors will be always consistent with the laptop if the mirror is displayed under the Windows system.

2. **Extended Desktop**

Right-click desktop > Graphics Settings > Display

General Settings

Color Settings

Multiple Settings

Custom Resolutions

DisplayPort Topology



Select Display Mode

Single Display

Clone Display

☒ Extended Desktop

Collage

1

2

3

4

Detect

Select One or More Active Displays

Built-in Display

HDMI Display

DP Display



Source device



HDMI 1 Display
4K/30Hz



HDMI 2 Display
1920×1080P/60Hz



DP Display
1920×1080P/60Hz

NOTE: For Wins, when 3 monitors are connected, only one monitor can reach 4K/30Hz resolution(allowing manual setting of any port), and the other two are 1920X1080P/60Hz.

Graphics Settings for Mac

1. Mirror Display

Apple logo> System Preferences > Displays.

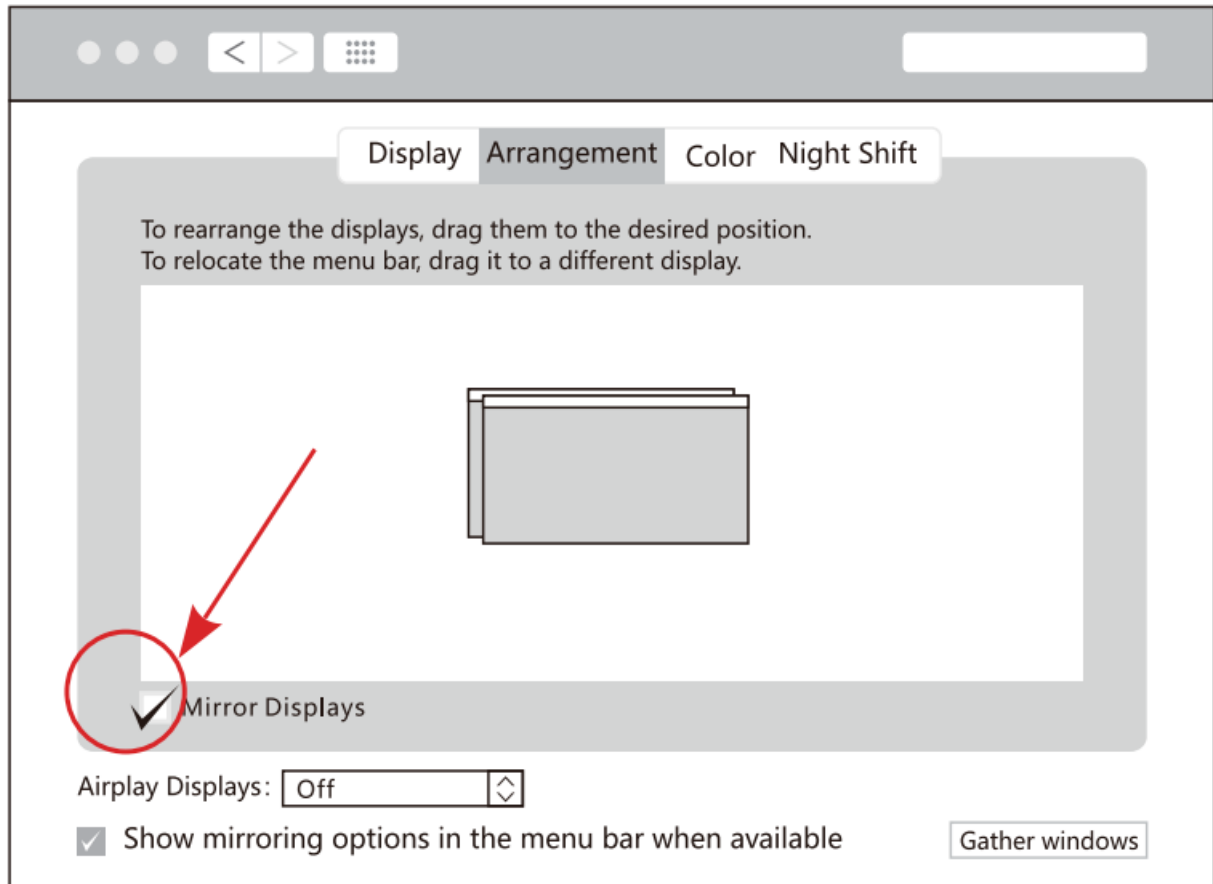



Source device

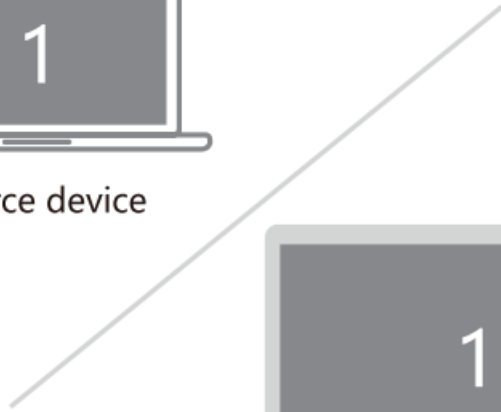

HDMI 1 Display
4K/30Hz



HDMI 2 Display
4K/30Hz



DP Display
4K/30Hz

2. Extend Display

Apple logo > System Preferences > Displays.

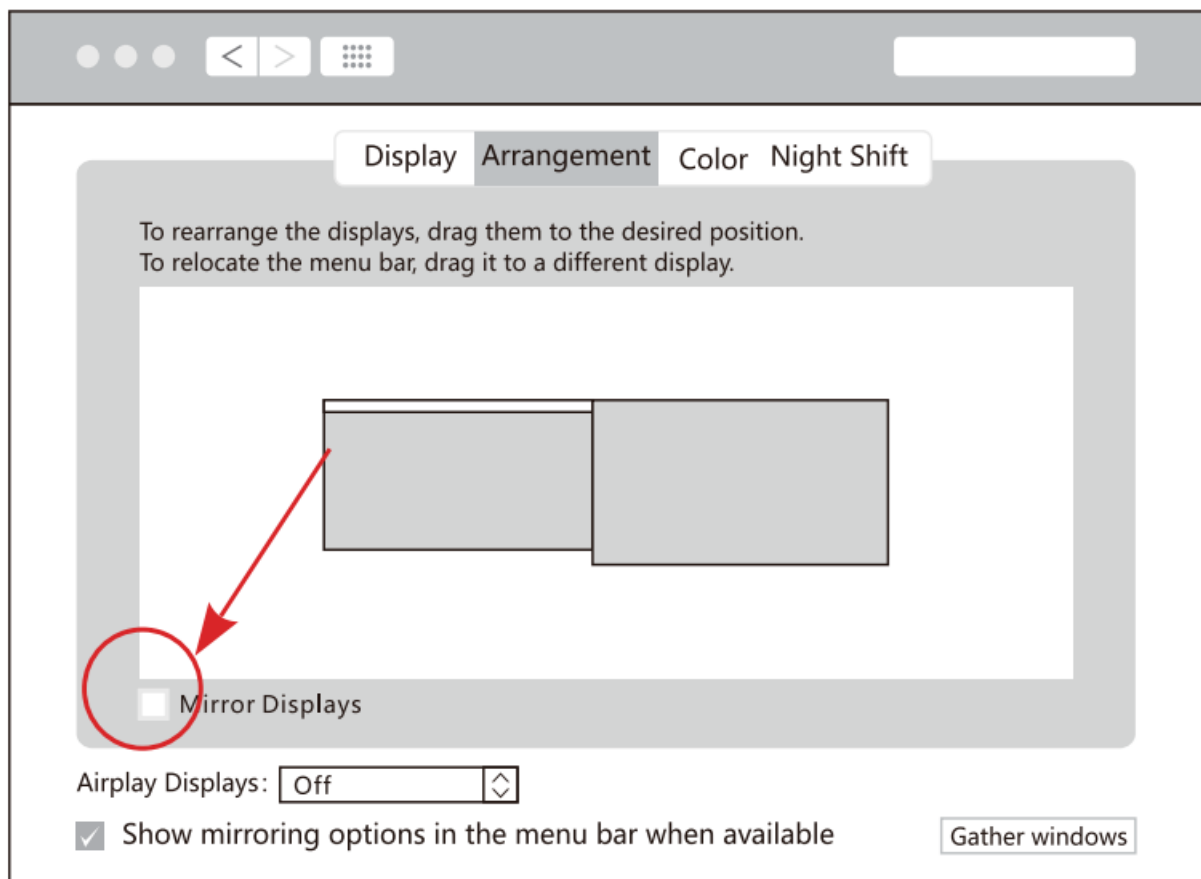

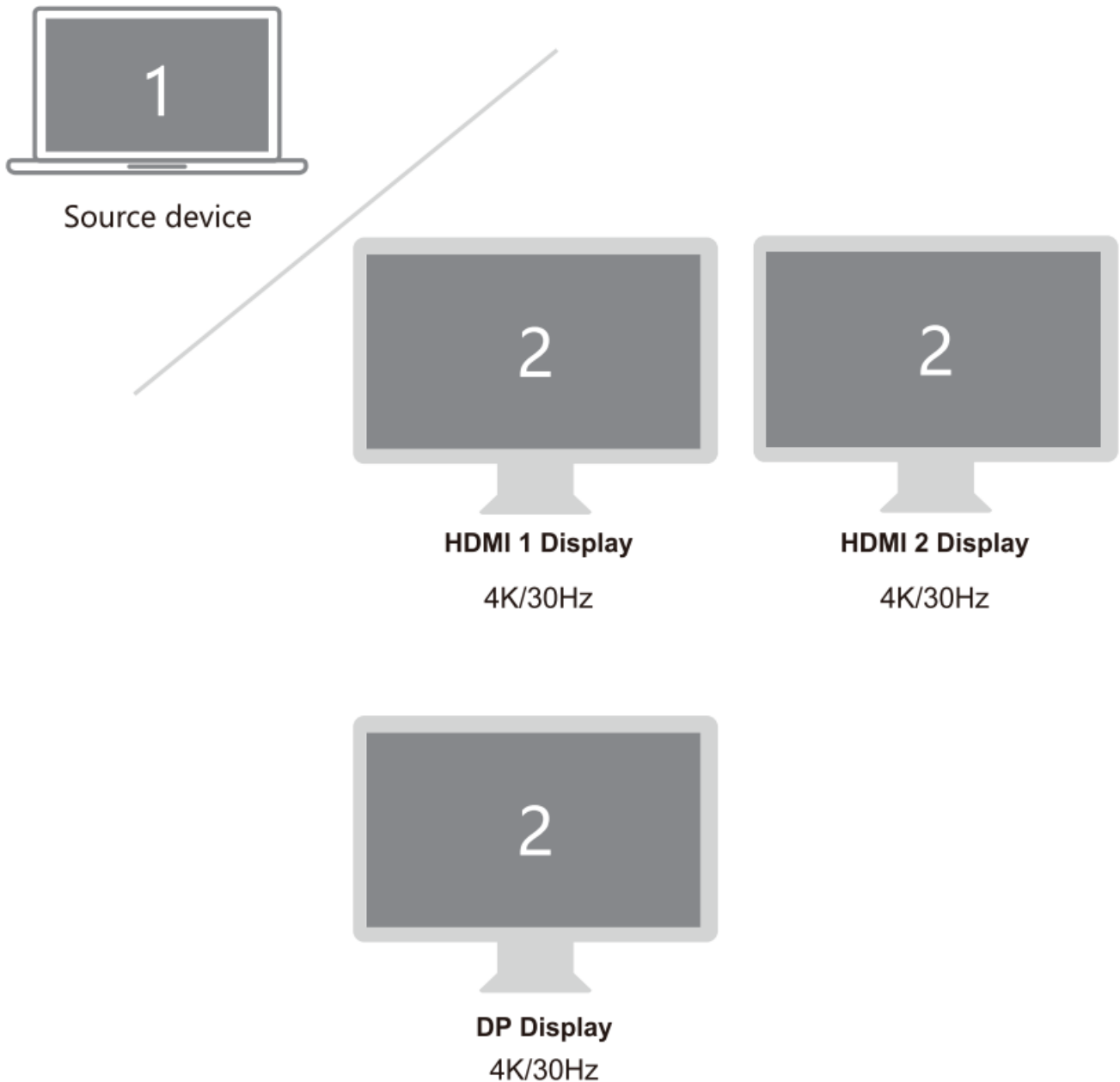

Storage Conditions

- **Ambient Operating Temperature:** 0C to 70 C (32°F to 158°F)
- **Storage Temperature:** -30C to 120 C (-22°F to 248°F)
- **Ambient Operating Humidity:** 20%-80%RH
- **Storage Humidity:** 20%-90%RH

FAQ

- **A. Why is there no video output?**
 - Please make sure the USB-C port of your devices(Laptop/Tablet) supports Video Output.
 - Please check if the cable is well connected.
 - Please use the standard HDMI cable.
- **B. My docking station not charging my laptop?**
 1. Please check the specifications of your Laptop and identify which port has PD charging functionality if multiple USB-C ports are available.

2. Verify if your host system supports PD over USB-C.
3. Please note some old models of computers have USB-C ports, but do not support charging, only can be powered by their original AC/DC power adapter.

• **C. Why is there no audio output from HDMI?**

1. Please make sure there's audio output on the Monitor.
2. Please set the external monitor as the default audio output device.

• **D. What if the WIFI drops when the hard drive has been connected to the hub?**

1. 2.4G is easily interfered with, you can switch to a 5-G network, or try to move the hard drive to a suitable place.

• **E. What if the USB driver can't be identified?**

- Restart the device and connect the hub again.

• **F. What if the display screen drops after connecting a large current hard drive?**

- Please connect your charger to the hub.

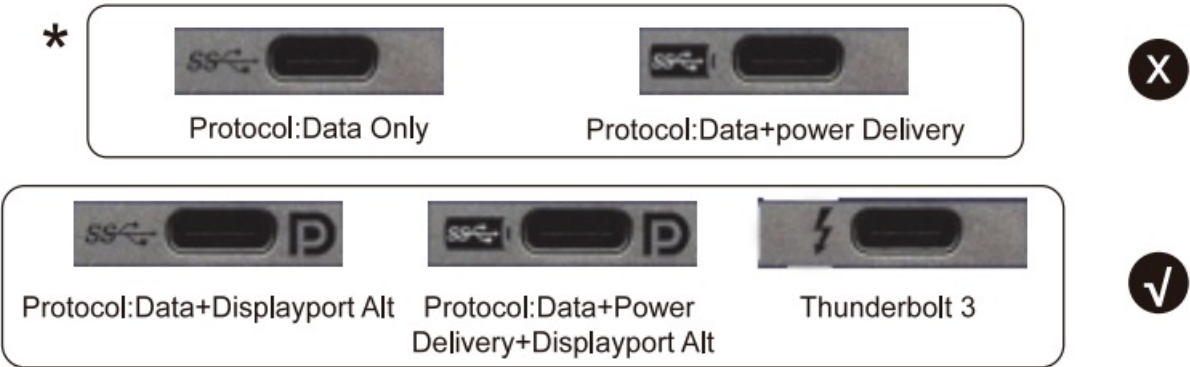

Documents / Resources

	amazon basics AS0102 USB C Docking Station Dual Monitor Adapter [pdf] User Manual B185rq4bdL, AS0103, AS0102, AS0102 USB C Docking Station Dual Monitor Adapter, AS0102, USB C Docking Station Dual Monitor Adapter, Docking Station Dual Monitor Adapter, Station Dual Monitor Adapter, Dual Monitor Adapter, Monitor Adapter, Adapter
---	---

References

- [User Manual](#)