



Amazon Basics AU860XA Credit Card Shredder User Manual

[Home](#) » [amazon basics](#) » Amazon Basics AU860XA Credit Card Shredder User Manual 

Contents

- [1 Amazon Basics AU860XA Credit Card Shredder](#)
- [2 Paper Shredder Operating](#)
- [3 Installation](#)
- [4 Operation](#)
- [5 Maintenance](#)
- [6 Troubleshooting](#)
- [7 FAQs](#)
- [8 Video](#)
- [9 Related Posts](#)



Amazon Basics AU860XA Credit Card Shredder



Safety Instructions



Read instructions before use.



Avoid touching the feed slot with your hands.



The product is not intended for use by children (the product is not a toy).



Do not insert foreign objects into the feed slot



Do not spray or keep any aerosol products in or around the shredder.



Keep loose clothing or jewelry away from the feed slot.



Avoid getting hair near the feed slot.

Do not shred:



- Always turn the shredder off and unplug the power cord from the AC outlet when not in use, before cleaning, moving, or emptying the waste basket.
- **RISK OF FIRE.** Never use any petroleum-based or flammable oils or lubricants in or around the machine as some oils can combust causing serious injury.
- **NEVER** dispose of flammable chemicals or materials that have come into contact with flammable chemicals (for example, nail polish, acetone and gasoline) in the shredder basket.
- A socket outlet should be near the equipment and be easily accessible. Never place the shredder near water or any heat source.
- Do not use the shredder if the power cord is damaged in any way.

Warning:

- Do not attempt to service this product yourself as doing so may expose you to sharp cutting blades and/or electricity and will void the manufacturer's warranty.
- Remove binding from checkbook or notepad before shredding

Bin Full:

The wastebasket will become full around 6~7 shredding passes (12 sheets per pass) of use. Empty the wastebasket when you see shredded materials fill the window to prevent paper jams. Never let the wastebasket become full. This will lead to shredded materials being pulled back up into the shredder and cause jams.



Empty wastebasket when the window is filled

Overfeeding the shredder:

Make sure you do not exceed the sheet count per pass (12 sheets max). Insert paper as straight as possible into the feed slot and release. Shredding beyond the specified sheet capacity can result in extensive damage to the shredder. Overfeeding will strain the machine and quickly wear and break the cutting blades and internal components.



No Trash bag:

If using a plastic bag to line the wastebasket, please remove it. This may cause the shredder not to operate properly.



No Trash bag

Paper Shredder Operating

Sheet Capacity	12 Sheets of 20 lb. bond paper*
Paper Shred Size:	3/16 in. x 1 9/16 in. pieces 5mm x 40mm pieces
Paper Feed Entry Width	8.7 in. (22.0 cm)
Credit Card Capacity	1 at a time
Duty Cycle	7 min. on / 30 min. off
Voltage	120V~60Hz / 3.0 A

Installation

- This model includes a built-in safety interlock mechanism, which requires the shredder to be correctly mounted onto the included wastebasket.
- THE SHREDDER WILL NOT OPERATE UNLESS IT IS PROPERLY MOUNTED AS PICTURED.
- A socket outlet should be near the equipment and be easily accessible.
- Connect the power cord to any standard 120-volt AC outlet.



Caution:

Shredders may have very sharp exposed blades on the underside. Use care when mounting the shredder on the wastebasket.

- Carefully lift and remove the shredder head from the wastebasket



- Gently place the shredder head onto the wastebasket



- Make sure the shredder head is correctly mounted.

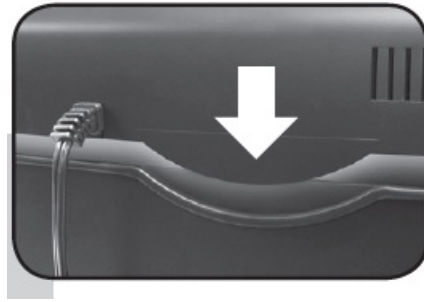

Operation



Control Switch

- Using the switch located on the unit, select one of the following settings by sliding the switch either left or right.

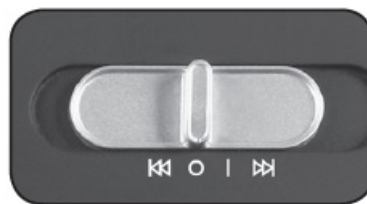

- Auto / On:** This setting allows the shredder to be automatically started by inserting paper into the feed slot. Always feed the paper in as straight as possible. When the paper has passed through, the shredder will automatically stop
- Off:** This setting turns off all features of the shredder. For safety reasons, we recommend that you leave the shredder in the “ off ” position whenever the shredder is unattended or not in use.
- Reverse:** In the unlikely event of a paper jam, the reverse setting can be used to help clear the cutters of paper that did not pass through. Never attempt to clear a jam by using the reverse function until you have emptied the wastebasket
- Forward:** The forward setting can also be used to help clear the cutters in the event of a paper jam. This allows to manually activate the shredder into cutting mode

Auto Reverse Technology

When the shredder detects over-capacity shredding, the motor will immediately stop and reject paper before

actual shredding begins

Paper / Credit Card Entry

- Make sure you do not exceed sheet count per pass (12 sheets max). Insert paper as straight as possible into the feed slot and release
- Insert one credit card at a time into the middle of the feed slot.



LED Status Indicators

- Power On: The Green LED light indicates the shredder is “On” and ready to operate when the paper is inserted.



- Overheat: The Red LED light indicates the shredder has shredded continuously beyond the maximum run time and overheated, the unit will automatically shut off.
- If this happens, switch the shredder Off for 30 minutes or longer before resuming normal operation.
- Overload: The Red LED light indicates when too much paper is inserted. Use the “Reverse” mode to back up and reduce the number of sheets.
- Misaligned: Mount the shredder securely to the rim of the waste basket.

Note:

- Always turn off and unplug the shredder when not in use.
- This shredder will shred staples and small paper clips. It is recommended that you remove paper clips whenever possible to extend the lifespan of your shredder.
- Only shred credit cards by feeding them vertically into the middle of the feed slot, releasing them when shredding begins.
- Never feed more than one credit card at a time.

Maintenance

Warning: Failure to properly maintain your shredder will void the warranty.

- Oil the shredder blades every month with basic vegetable, cooking oil, or shredder oil.
- Follow the oiling procedure below (FIGURE 3). It helps to keep the shredder blades operating well over many years of use.

Oiling procedure:

- Turn off the shredder.
- Apply shredder oil across the feed slot.
- Turn the shredder in reverse mode for 3~5 seconds.

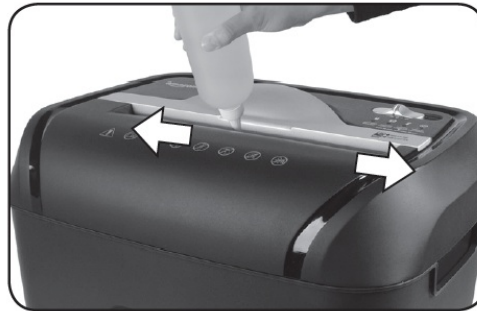

Caution:

- Do not spray or keep any aerosol products in or around the shredder.
- DO NOT USE CANNED AIR ON THE SHREDDER.



Cleaning:

- Never use anything flammable to clean the shredder. This may result in serious injury or damage to the product.
- ALWAYS UNPLUG THE SHREDDER BEFORE CLEANING!
- Only clean the shredder by carefully wiping the unit with a dry soft cloth or towel.
- Do not clean or immerse the shredder in water. Having the unit wet may result in damage or malfunction to the electrical components. If the shredder happens to get wet, be sure to completely dry the unit immediately with a cloth or towel.

Troubleshooting

- If there is a problem with your shredder, check below for the symptoms and steps to resolve. If you continue to have problems, contact customer support at our Service Center.
- **DO NOT ATTEMPT TO REPAIR BY OPENING THE SHREDDER HEAD.** This will completely void the product warranty

There is no power to the shredder

- Make sure the power cord is plugged into a functioning 120V standard household power outlet. Or, try using a different working outlet.
- Check if the head unit portion of the shredder is correctly seated onto the included wastebasket.

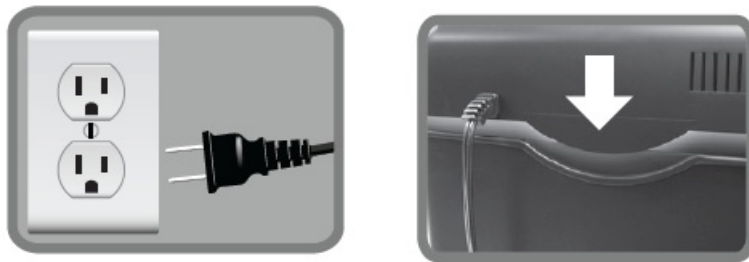

The shredder does not feed or shred paper

- If the Overheat light is lit in red, turn the shredder off and let it cool down for 30 minutes.
- Turn the shredder on, check the Overheat light again, and restart shredding only when the light is not lit

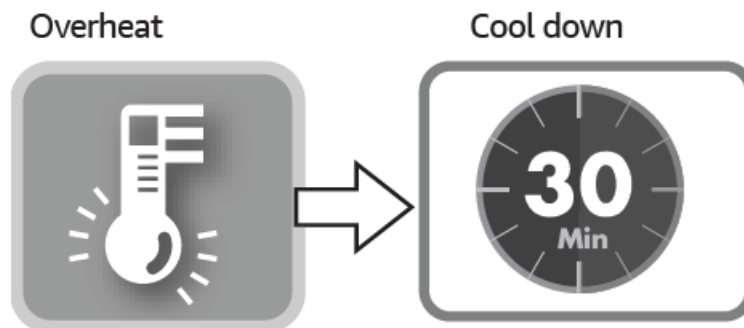

Shredder runs continuously

- Unplug the machine from the wall socket.
- Find the activation sensor in the center of the feed slot.
- Use a cotton swab to gently wipe away any dust or debris that has been collected on the sensor.

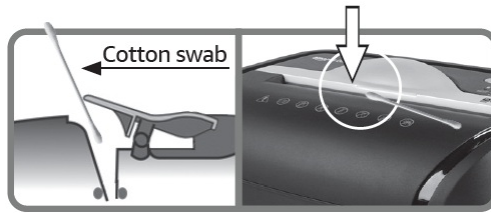
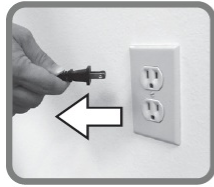

The shredder is jammed and runs in “Reverse” mode only / Overload icon is lit in red

- Empty if basket full. Carefully remove the paper on the shredder’s head bottom.
- Set the switch to reverse for 5 sec.
- Turn off the shredder then pull paper side to side to remove jammed paper (as much as possible).
- Reduce the number of sheets being fed (count pages to be sure not to exceed the maximum sheet count).

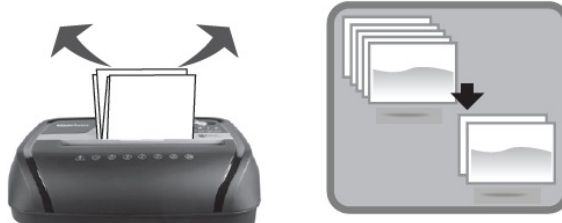

With stubborn situations where the reverse function does not help, follow the steps below:

- Turn off the shredder.
- Apply shredder oil to the feed slot (shredder oil not included).
- Let oil soak into paper and machine for 30 minutes.
- Set the control switch to Auto/On.

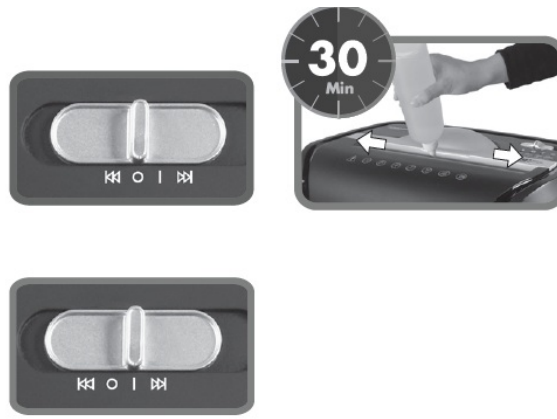

Shredder does not feed or shred credit cards or small piece of paper

- Position the credit card or small piece of paper over the credit card section of the
- Feeder (center position).
- Try again.



Feed in the center

FAQs

What is the Amazon Basics AU860XA Credit Card Shredder?

The Amazon Basics AU860XA Credit Card Shredder is a compact and efficient shredder designed for securely disposing of credit cards, as well as paper documents.

What are the key features of this shredder?

How does cross-cut shredding enhance security?

Cross-cut shredding cuts materials into small, confetti-like pieces, making it difficult to reconstruct shredded documents or credit cards.

What is the maximum capacity for shredding credit cards?

The Amazon Basics AU860XA can typically shred one credit card at a time.

Can I use this shredder for shredding paper documents as well?

Yes, this shredder is versatile and can handle both credit cards and paper documents, making it ideal for home or office use.

What is the shredder's run time before it needs to cool down?

The shredder typically has a continuous run time of up to 30 minutes before it requires a cool-down period.

Is the Amazon Basics AU860XA suitable for personal use or small offices?

Yes, it is designed for personal use and small offices, providing a convenient and secure way to dispose of sensitive documents and credit cards.

How do I maintain and clean the shredder?

To maintain the shredder, oil the cutting blades periodically and empty the waste bin when it becomes full. Cleaning the shredder is as simple as wiping it down with a damp cloth.

What safety features does the shredder have?

This shredder typically includes safety features such as a safety interlock switch that prevents operation when the shredder head is removed and thermal overload protection to prevent overheating.

Does it have a reverse function for clearing paper jams?

Yes, the shredder usually comes equipped with a reverse function to help clear paper jams easily.

What is the size and weight of the Amazon Basics AU860XA?

The dimensions and weight of the shredder may vary, so refer to the product specifications for accurate measurements.

What type of shredding does it perform on paper documents?

This shredder typically performs cross-cut shredding on paper documents, enhancing security by turning them into small, unreadable pieces.

Can I shred staples or paper clips along with documents?

It's recommended to remove staples and paper clips before shredding to prolong the life of the shredder's cutting blades.

What is the warranty for the Amazon Basics AU860XA?

Warranty coverage may vary, so it's advisable to check the warranty details provided by Amazon Basics or the retailer at the time of purchase.

Where can I find additional resources and user manuals for the Amazon Basics AU860XA Credit Card Shredder?

You can find additional resources, user manuals, and customer support information on the official Amazon Basics website and through authorized Amazon Basics dealers.

Video



[Download This PDF Link Amazon Basics AU860XA Credit Card Shredder User Manual Credit-Card-Shredder.mp4](#)

[Manuals+](#).